

Cheyenne, Wyoming 82001

SECTION 32 & 33
TOWNSHIP 4 NORTH
RANGE 64 WEST

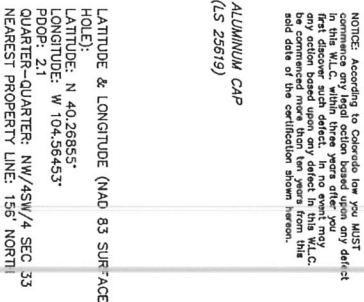

SITE SKETCH - GUTTERSEN C33-31D

SECTION 33
TOWNSHIP 4 NORTH
RANGE 64 WEST

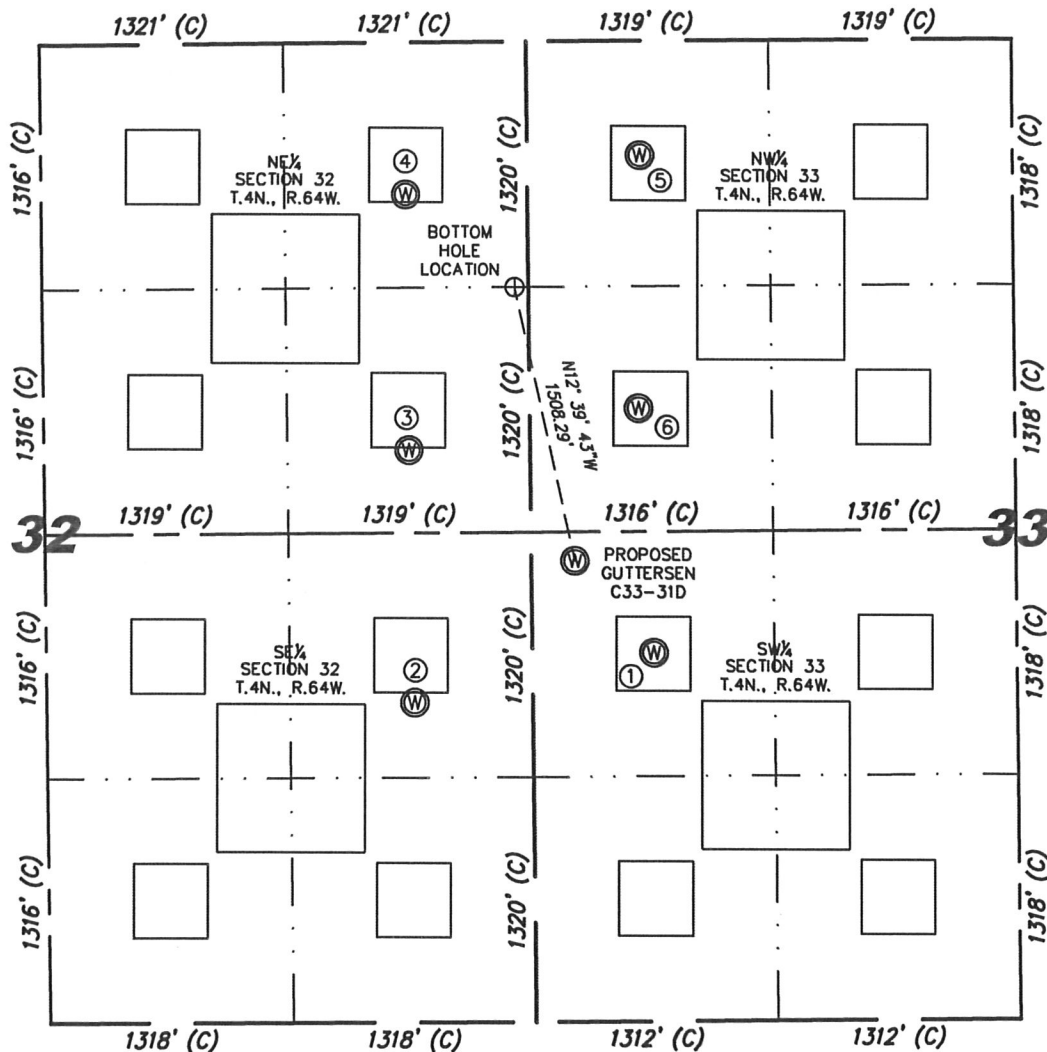

①
LINDSAY
C33-12
NW/SW SEC. 33
1985' FSL
662' FWL
EL 4739'
N 40.26719
W 104.56300
PDOP 3.2

②
PTF C32-9
NE/SE SEC. 32
1724' FSL
641' FEL
EL 4759'
N 40.26648
W 104.56767
PDOP 1.8

③
PTF C32-8
SE/NE SEC. 32
2191' FNL
658' FEL
EL 4759'
N 40.27021
W 104.56774
PDOP 1.9

④
PTF C32-1
NE/NE SEC. 32
817' FNL
663' FEL
EL 4768'
N 40.27398
W 104.56776
PDOP 2.3

⑤
LINDSAY
C33-10
NW/NW SEC. 33
616' FNL
615' FWL
EL 4750'
N 40.27453
W 104.56319
PDOP 2.7

⑥
LINDSAY
C33-11
SW/NW SEC. 33
1976' FNL
594' FWL
EL 4747'
N 40.27080
W 104.56325
PDOP 3.1

NOTES:

- THIS SKETCH DOES NOT REPRESENT A BOUNDARY SURVEY.
- THE DATUM FOR THE LATITUDES AND LONGITUDES ON THIS SKETCH IS NAD83.



0 1000

Scale: 1" = 1000'