

N



T. 8 S.

1568377.81
EASTING (NAD 83)
2278675.86

THE BASIS OF BEARINGS
FOR THIS SURVEY IS
REFERENCED TO THE NORTH
LINE OF THE NE $\frac{1}{4}$ OF
SECTION 12, BEING
MONUMENTED AS SHOWN AND
BEARING S 87° 14' 28" W.

 WELL LOCATION
 FOUND MONUMENT
 DENOTES 90° TIE
 APPROXIMATE BHL
 PROPERTY LINE
 LEASE LINE

I, RONALD C. RENNKE, AN EMPLOYEE AND AGENT ON BEHALF OF D.R. GRIFFIN & ASSOCIATES, INC. STATE THE PLAT HEREON IS A CORRECT REPRESENTATION OF A SURVEY MADE UNDER MY SUPERVISION ON JUNE 17, 2011 OF THE SHOWN HYRUP 12-43A AND THAT THE LOCATION HAS BEEN STAKED ON THE GROUND AS SHOWN ON THE PLAT.

1. GPS OPERATOR RICHARD SEAL OBSERVED A PDOP OF 0.8.
2. ALL GPS OBSERVATIONS ARE IN COMPLIANCE WITH COGCC RULE NO. 215.
3. EXISTING IMPROVEMENTS WITHIN 400' RADIUS OF WELL SITE. SEE EXHIBIT 1B.
4. SURROUNDING SURFACE USE IS NATIVE BRUSH, & NON-CROP RANGELAND.

Notice: In accordance with Colorado State Law, any legal action based upon any defect in this survey plat must commence within three (3) years after first discovery of such defect. In no event, may any action based upon any defect in this survey plat be commenced more than ten (10) years from the date of certification shown hereon.

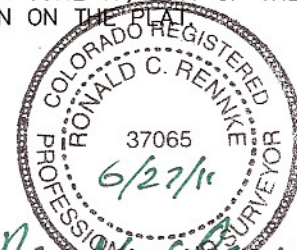

COLORADO PLIS No. 37065

**2286' F/NL & 961' F/EL, SECTION 12,
T. 8 S., R. 96 W., 6 TH P.M.
MESA COUNTY, COLORADO**

EXHIBIT 1