

PROPOSED AREA OF DISTURBANCE: 4.6± ACRES

LOCATION DRAWING

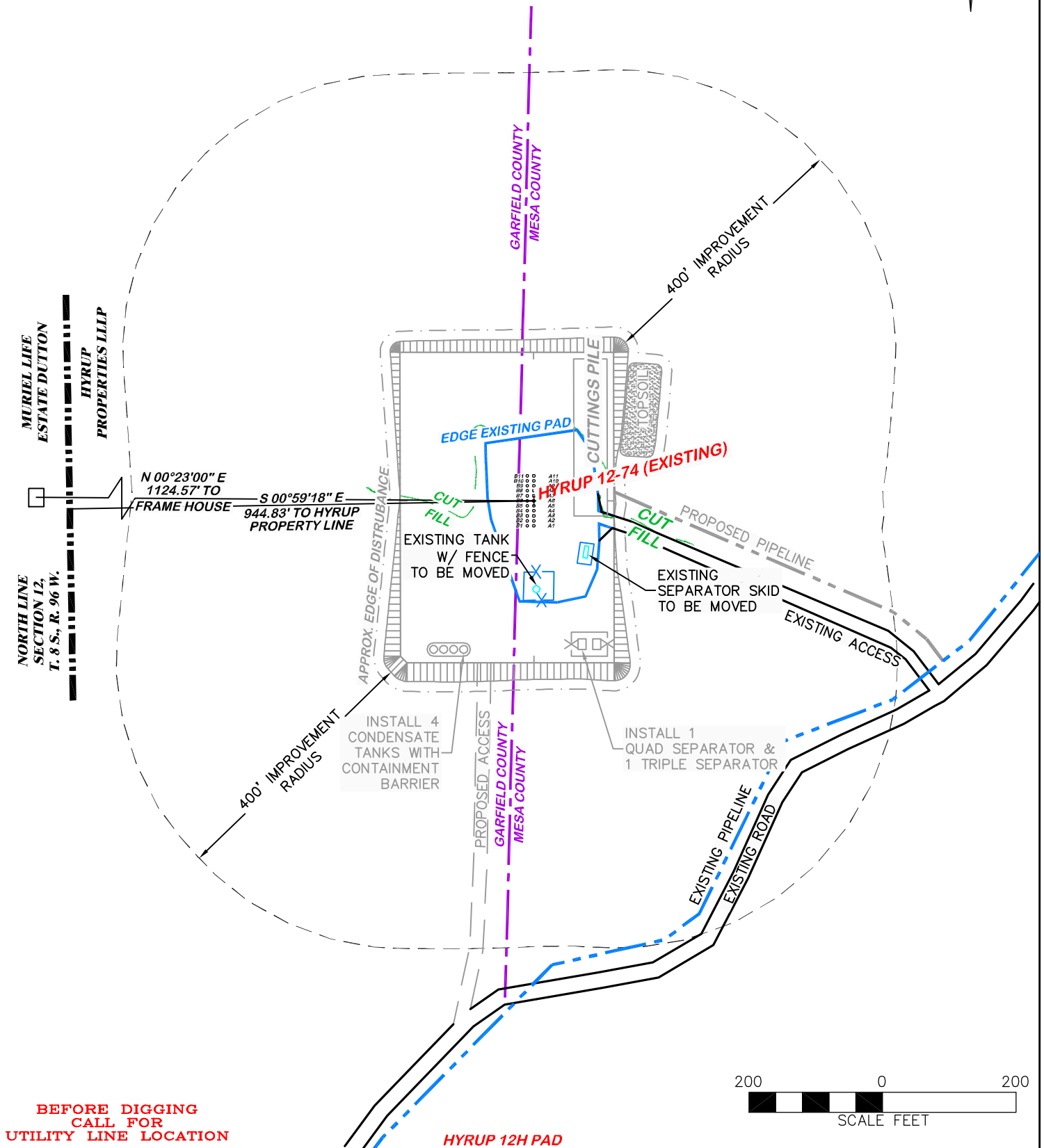
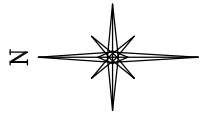

**BEFORE DIGGING
CALL FOR
UTILITY LINE LOCATION**

HYRUP 12H PAD



RIFFIN & ASSOCIATES, INC.

(307) 362-5028

DRAWN: 6/15/11 - TCM

SCALE: 1" = 200'

REVISED: N/A

DRG JOB No. 11321

EXHIBIT 1B

LOCATION DRAWING

**NOBLE ENERGY, INC.
HYRUP 12-33A, 12-33B, 12-42A, 12-42B,
12-42D, 12-3A, 12-43B,
SECTION 12, T. 8 S., R. 96 W., 6th P.M.
MESA COUNTY, COLORADO**