



# KERR MCGEE OIL & GAS ONSHORE LP

Location: COLORADO Slot: SLOT#15 SWEETGRASS 22-14 (2138'FSL & 740'FWL)  
Field: WELD COUNTY (KERR MCGEE) Well: SWEETGRASS 22-14  
Facility: SEC.14-T1N-R68W Wellbore: SWEETGRASS 22-14 PWB



Plot reference wellpath is SWEETGRASS 22-14 (REV-A-0) PWB	
True vertical depths are referenced to XTREME 12 (RKB)	Grid System: NAD83 / Lambert Colorado SP, Northern Zone (501), US feet
Measured depths are referenced to XTREME 12 (RKB)	North Reference: True north
XTREME 12 (RKB) to Mean Sea Level: 5119 feet	Scale: True distance
Mean Sea Level to Mud line (At Slot: SLOT#15 SWEETGRASS 22-14 (2138'FSL & 740'FWL)): 0 feet	Depths are in feet
Coordinates are in feet referenced to Slot	Created by: cookdam on 7/20/2011

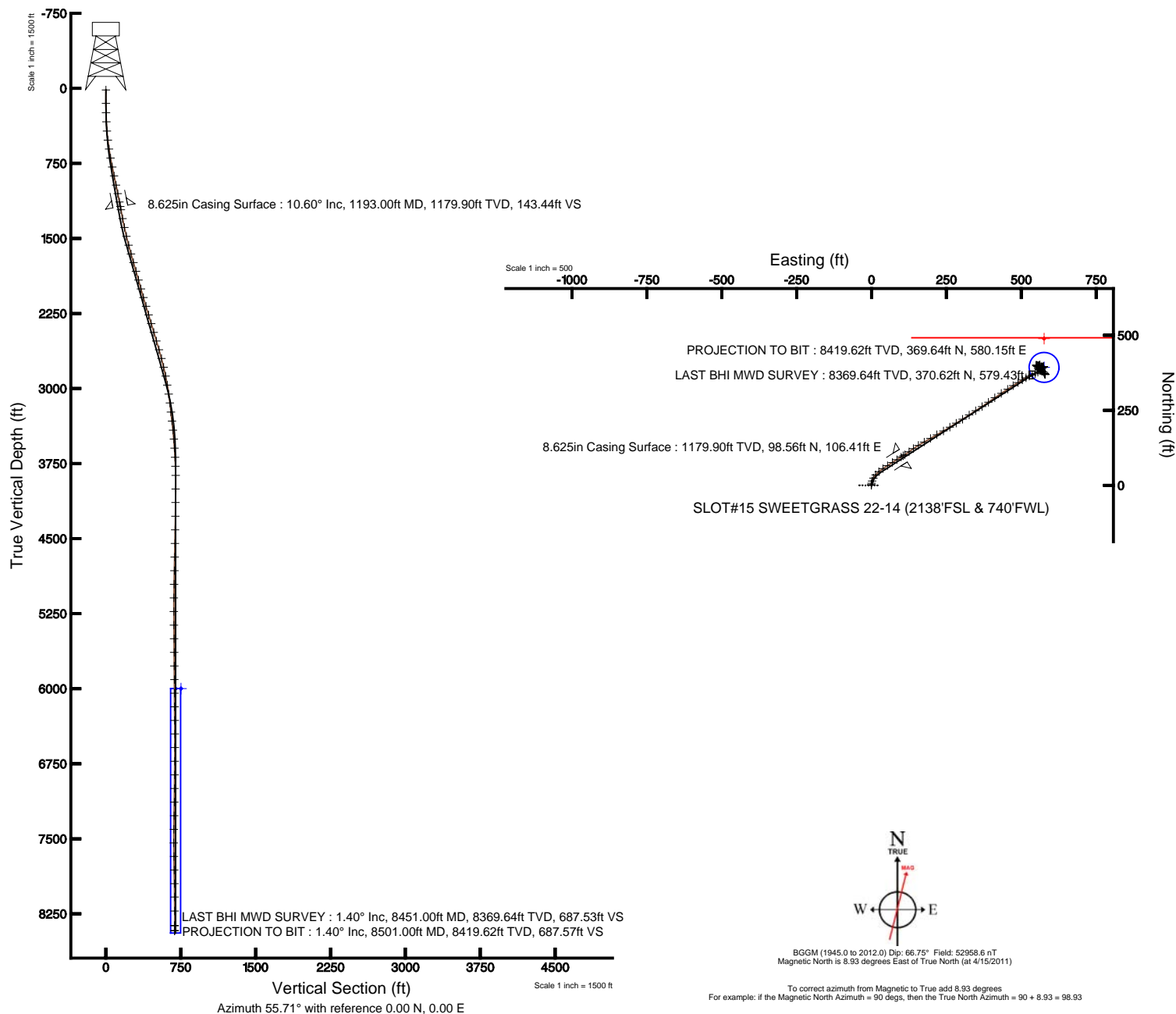



# Actual Wellpath Report

SWEETGRASS 22-14 AWP

Page 1 of 4



REFERENCE WELLPATH IDENTIFICATION			
Operator	KERR MCGEE OIL & GAS ONSHORE LP	Slot	SLOT#15 SWEETGRASS 22-14 (2138'FSL & 740'FWL)
Area	COLORADO	Well	SWEETGRASS 22-14
Field	WELD COUNTY (KERR MCGEE)	Wellbore	SWEETGRASS 22-14 awb
Facility	SEC.14-T1N-R68W		

REPORT SETUP INFORMATION			
Projection System	NAD83 / Lambert Colorado SP, Northern Zone (501), US feet	Software System	WellArchitect® 3.0.0
North Reference	True	User	Cookdanm
Scale	0.999963	Report Generated	7/20/2011 at 10:24:34 PM
Convergence at slot	0.34° East	Database/Source file	WA_DENVER/SWEETGRASS_22-14_awb.xml

WELLPATH LOCATION						
	Local coordinates		Grid coordinates		Geographic coordinates	
	North[ft]	East[ft]	Easting[US ft]	Northing[US ft]	Latitude	Longitude
Slot Location	201.73	-3691.27	3146311.86	1261440.02	40°02'59.489"N	104°58'38.492"W
Facility Reference Pt			3150004.14	1261260.61	40°02'57.498"N	104°57'51.026"W
Field Reference Pt			3197771.84	1268891.29	40°04'09.600"N	104°47'36.000"W

WELLPATH DATUM			
Calculation method	Minimum curvature	XTREME 12 (RKB) to Facility Vertical Datum	5119.00ft
Horizontal Reference Pt	Slot	XTREME 12 (RKB) to Mean Sea Level	5119.00ft
Vertical Reference Pt	XTREME 12 (RKB)	XTREME 12 (RKB) to Mud Line at Slot (SLOT#15 SWEETGRASS 22-14 (2138'FSL & 740'FWL))	5119.00ft
MD Reference Pt	XTREME 12 (RKB)	Section Origin	N 0.00, E 0.00 ft
Field Vertical Reference	Mean Sea Level	Section Azimuth	55.71°



# Actual Wellpath Report

SWEETGRASS 22-14 AWP

Page 2 of 4



## REFERENCE WELLPATH IDENTIFICATION

Operator	KERR MCGEE OIL & GAS ONSHORE LP	Slot	SLOT#15 SWEETGRASS 22-14 (2138'FSL & 740'FWL)
Area	COLORADO	Well	SWEETGRASS 22-14
Field	WELD COUNTY (KERR MCGEE)	Wellbore	SWEETGRASS 22-14 awb
Facility	SEC.14-T1N-R68W		

## WELLPATH DATA (79 stations) † = interpolated/extrapolated station

MD [ft]	Inclination [°]	Azimuth [°]	TVD [ft]	Vert Sect [ft]	North [ft]	East [ft]	DLS [°/100ft]	Comments
0.00†	0.000	292.500	0.00	0.00	0.00	0.00	0.00	
15.00	0.000	292.500	15.00	0.00	0.00	0.00	0.00	
149.00	0.600	292.500	149.00	-0.38	0.27	-0.65	0.45	
242.00	2.000	11.900	241.98	0.52	2.04	-0.76	2.13	
334.00	4.100	9.500	333.84	3.96	6.86	0.11	2.29	
426.00	5.700	19.700	425.50	9.93	14.40	2.19	1.97	
518.00	7.400	27.400	516.90	18.84	23.97	6.46	2.08	
608.00	9.200	40.000	605.96	30.87	34.62	13.75	2.83	
699.00	10.200	49.900	695.67	45.89	45.39	24.59	2.13	
790.00	11.300	56.200	785.07	62.82	55.54	38.17	1.77	
881.00	12.100	58.000	874.18	81.27	65.55	53.66	0.97	
976.00	11.600	56.900	967.15	100.77	76.05	70.11	0.58	
1062.00	11.700	58.300	1051.38	118.12	85.35	84.77	0.35	
1148.00	11.000	59.000	1135.70	135.02	94.16	99.22	0.83	
1226.00	10.300	57.300	1212.36	149.42	101.76	111.47	0.98	
1317.00	11.200	52.700	1301.76	166.38	111.51	125.35	1.37	
1407.00	12.000	54.500	1389.92	184.47	122.24	139.92	0.98	
1498.00	13.500	59.400	1478.68	204.53	133.14	156.76	2.03	
1589.00	14.900	60.800	1566.90	226.78	144.25	176.12	1.58	
1680.00	15.700	59.400	1654.67	250.72	156.23	196.93	0.97	
1770.00	16.100	60.800	1741.23	275.30	168.52	218.31	0.62	
1861.00	16.300	59.800	1828.61	300.61	181.10	240.36	0.38	
1952.00	15.600	58.300	1916.11	325.57	193.95	261.80	0.89	
2043.00	16.000	58.300	2003.67	350.32	206.97	282.89	0.44	
2133.00	16.600	58.300	2090.05	375.56	220.24	304.38	0.67	
2224.00	16.700	55.900	2177.24	401.62	234.40	326.26	0.76	
2315.00	16.600	57.600	2264.43	427.68	248.70	348.07	0.55	
2406.00	15.900	57.300	2351.79	453.14	262.40	369.53	0.77	
2497.00	16.800	54.100	2439.11	478.74	276.85	390.67	1.40	
2587.00	16.700	55.200	2525.29	504.68	291.85	411.83	0.37	
2678.00	17.000	57.300	2612.39	531.05	306.50	433.76	0.75	
2769.00	15.200	56.900	2699.81	556.27	320.20	454.95	1.98	
2859.00	12.900	55.900	2787.11	578.12	332.28	473.15	2.57	
2950.00	11.500	59.400	2876.06	597.33	342.59	489.37	1.74	
3041.00	9.900	59.400	2965.47	614.19	351.19	503.92	1.76	
3132.00	8.000	59.000	3055.36	628.32	358.44	516.08	2.09	
3222.00	7.300	69.200	3144.56	640.13	363.69	526.79	1.69	
3313.00	6.500	68.500	3234.90	650.78	367.64	536.99	0.88	
3404.00	6.900	61.200	3325.28	661.24	372.16	546.57	1.03	
3495.00	6.100	61.500	3415.70	671.50	377.10	555.61	0.88	
3585.00	4.900	47.800	3505.29	680.06	381.96	562.66	1.97	
3676.00	3.700	45.300	3596.03	686.80	386.64	567.63	1.33	
3767.00	2.900	42.900	3686.88	691.93	390.39	571.28	0.89	
3857.00	2.600	29.900	3776.77	695.99	393.83	573.85	0.77	
3948.00	0.400	84.700	3867.74	698.12	395.65	575.20	2.63	
4084.00	0.400	236.200	4003.74	698.07	395.43	575.27	0.57	
4220.00	0.700	264.700	4139.73	696.86	395.08	574.05	0.29	
4357.00	1.100	271.000	4276.71	695.06	395.03	571.91	0.30	
4493.00	1.000	274.200	4412.69	693.06	395.14	569.42	0.09	
4629.00	1.100	270.300	4548.67	691.06	395.23	566.93	0.09	
4765.00	1.500	273.200	4684.63	688.57	395.34	563.84	0.30	
4901.00	1.700	277.000	4820.58	685.65	395.68	560.07	0.17	
5037.00	2.100	278.800	4956.51	682.31	396.31	555.60	0.30	
5173.00	0.900	311.800	5092.46	680.23	397.41	552.34	1.05	
5310.00	1.800	321.700	5229.42	679.82	399.81	550.21	0.68	
5446.00	1.500	113.900	5365.40	680.61	400.77	550.51	2.36	
5582.00	1.200	118.500	5501.36	682.20	399.37	553.39	0.23	
5718.00	0.800	95.300	5637.34	683.59	398.60	555.59	0.41	
5854.00	0.400	109.300	5773.33	684.60	398.35	556.98	0.31	

5990.00	0.400	58.700	5909.33	685.36	398.44	557.83	0.25
---------	-------	--------	---------	--------	--------	--------	------



# Actual Wellpath Report

SWEETGRASS 22-14 AWP

Page 3 of 4



REFERENCE WELLPATH IDENTIFICATION			
Operator	KERR MCGEE OIL & GAS ONSHORE LP	Slot	SLOT#15 SWEETGRASS 22-14 (2138'FSL & 740'FWL)
Area	COLORADO	Well	SWEETGRASS 22-14
Field	WELD COUNTY (KERR MCGEE)	Wellbore	SWEETGRASS 22-14 awb
Facility	SEC.14-T1N-R68W		

WELLPATH DATA (79 stations)								
MD [ft]	Inclination [°]	Azimuth [°]	TVD [ft]	Vert Sect [ft]	North [ft]	East [ft]	DLS [°/100ft]	Comments
6126.00	0.300	65.700	6045.33	686.18	398.84	558.56	0.08	
6262.00	0.400	65.000	6181.32	687.00	399.18	559.32	0.07	
6398.00	0.800	79.800	6317.32	688.33	399.55	560.68	0.31	
6534.00	0.700	60.100	6453.31	690.03	400.13	562.34	0.20	
6670.00	0.400	250.300	6589.30	690.40	400.39	562.61	0.81	
6807.00	0.600	235.500	6726.30	689.22	399.82	561.57	0.17	
6943.00	0.700	229.600	6862.29	687.68	398.88	560.35	0.09	
7079.00	0.600	210.900	6998.28	686.21	397.73	559.35	0.17	
7215.00	0.600	217.600	7134.27	684.88	396.55	558.55	0.05	
7351.00	1.000	210.600	7270.26	683.13	394.97	557.51	0.30	
7487.00	1.800	194.000	7406.22	680.46	391.88	556.39	0.65	
7623.00	1.900	129.000	7542.16	679.52	388.38	557.63	1.46	
7759.00	1.900	115.200	7678.09	681.31	386.00	561.42	0.34	
7895.00	2.500	116.400	7813.99	683.91	383.73	566.12	0.44	
8031.00	2.600	127.300	7949.85	686.33	380.54	571.23	0.36	
8164.00	2.000	136.400	8082.74	687.66	377.03	575.23	0.53	
8304.00	1.400	155.400	8222.68	687.77	373.70	577.62	0.58	
8451.00	1.400	143.800	8369.64	687.53	370.62	579.43	0.19	LAST BHI MWD SURVEY
8501.00	1.400	143.800	8419.62	687.57	369.64	580.15	0.00	PROJECTION TO BIT

HOLE & CASING SECTIONS - Ref Wellbore: SWEETGRASS 22-14 awb      Ref Wellpath: SWEETGRASS 22-14 AWP									
String/Diameter	Start MD [ft]	End MD [ft]	Interval [ft]	Start TVD [ft]	End TVD [ft]	Start N/S [ft]	Start E/W [ft]	End N/S [ft]	End E/W [ft]
12.25in Open Hole	15.00	1203.00	1188.00	15.00	1189.74	0.00	0.00	99.53	107.97
8.625in Casing Surface	15.00	1193.00	1178.00	15.00	1179.90	0.00	0.00	98.56	106.41
7.875in Open Hole	1203.00	8501.00	7298.00	1189.74	8419.62	99.53	107.97	369.64	580.15

TARGETS									
Name	MD [ft]	TVD [ft]	North [ft]	East [ft]	Grid East [US ft]	Grid North [US ft]	Latitude	Longitude	Shape
SWEETGRASS 22-14 GEO TARGET 50' RADIUS (2138'FSL & 740'FWL, REV-1)		6000.00	393.06	576.43	3146885.94	1261836.45	40°03'03.373"N	104°58'31.080"W	circle
SWEETGRASS 22-14 HARDLINE 96'N OF GEO TARGET		6000.00	489.08	576.43	3146885.38	1261932.47	40°03'04.322"N	104°58'31.080"W	point

WELLPATH COMPOSITION - Ref Wellbore: SWEETGRASS 22-14 awb      Ref Wellpath: SWEETGRASS 22-14 AWP				
Start MD [ft]	End MD [ft]	Positional Uncertainty Model	Log Name/Comment	Wellbore
15.00	8451.00	NaviTrak (Standard)	BHI MWD SURVEY <149-8451>	SWEETGRASS 22-14 awb
8451.00	8501.00	Blind Drilling (std)	Projection to bit	SWEETGRASS 22-14 awb



# Actual Wellpath Report

SWEETGRASS 22-14 AWP

Page 4 of 4



## REFERENCE WELLPATH IDENTIFICATION

Operator	KERR MCGEE OIL & GAS ONSHORE LP	Slot	SLOT#15 SWEETGRASS 22-14 (2138'FSL & 740'FWL)
Area	COLORADO	Well	SWEETGRASS 22-14
Field	WELD COUNTY (KERR MCGEE)	Wellbore	SWEETGRASS 22-14 awb
Facility	SEC.14-T1N-R68W		

## WELLPATH COMMENTS

MD [ft]	Inclination [°]	Azimuth [°]	TVD [ft]	Comment
8451.00	1.400	143.800	8369.64	LAST BHI MWD SURVEY
8501.00	1.400	143.800	8419.62	PROJECTION TO BIT