



August 8, 2011

Department of Natural Resources  
Oil and Gas Conservation Commission  
The Chancery Building  
1120 Lincoln St., Suite 801  
Denver, CO 80203

Re: **20 Day Certification Letter - 318A-e**  
BARCLAY 28C-27HZ  
Township 3 North, Range 66 West, Section 27: SW/4SE/4  
Unit Spacing: 03N-66W-27 E/2W/2; W/2E/2  
Weld County, Colorado

Ladies/Gentlemen:

Kerr McGee Oil and Gas Onshore LP ("KMG") hereby certify to the Director that KMG owns one-hundred percent (100%) of the mineral rights in the proposed spacing unit. Therefore, KMG respectfully requests the Director to approve the boundary well.

If you have any questions or issues regarding this permit, please contact Cheryl Light at (720) 929-6461.

Very truly yours,

**KERR-McGEE OIL AND GAS ONSHORE LP**

A handwritten signature in blue ink, appearing to read 'Rebecca Heim'.

**Rebecca Heim**  
**Regulatory Analyst II**



318A Proposed Spacing  
Unit Plan

**T3N, R66W**

NW. COR.  
SEC. 27, T3N, R66W,  
FOUND 3 1/4" ALUM. CAP  
LS 13155

NE. COR.  
SEC. 27, T3N, R66W,  
FOUND 3 1/4" ALUM. CAP  
LS 27269

S 88°54'40" W 5357.58' (M)

2464'

BOTTOM OF HOLE

N 13°20'48" W 4449' GRID  
N 12°52'08" W TRUE  
N 22°10'48" W MAGNETIC

N 00°53'51" W 2621.38' (M)

N 00°31'43" W 5284.14' (M)

W. 1/4 COR.  
SEC. 27, T3N, R66W,  
FOUND 3 1/4" ALUM. CAP  
LS 13155

N 00°53'19" W 2666.70' (M)

**SURFACE POSITION  
NAD 83**  
STPC (CO NORTH)  
N: 1,312,996'  
E: 3,206,571'  
Lat: 40° 11' 24.745"N  
(40.190207°N)  
Lon: 104° 45' 38.092"W  
(104.760581°W)

**BOTTOM HOLE  
NAD 83**  
STPC (CO NORTH)  
N: 1,317,325'  
E: 3,205,544'  
Lat: 40° 12' 07.611"N  
(40.202114°N)  
Lon: 104° 45' 50.864"W  
(104.764129°W)

**SURFACE POSITION  
NAD 27**  
STPC (CO NORTH)  
N: 312,998'  
E: 2,206,723'  
Lat: 40° 11' 24.808"N  
(40.190224°N)  
Lon: 104° 45' 36.203"W  
(104.760056°W)

**BOTTOM HOLE  
NAD 27**  
STPC (CO NORTH)  
N: 317,327'  
E: 2,205,696'  
Lat: 40° 12' 07.674"N  
(40.202132°N)  
Lon: 104° 45' 48.974"W  
(104.763604°W)

**BARCLAY 28C-27HZ**

UNGRADED ELEV= 4957.3'  
SURFACE POSITION

1903'

478'

SW. COR.  
SEC. 27, T3N, R66W,  
FOUND 3 1/4" ALUM. CAP  
LS 13155

S 88°52'22" W 2661.88' (M)

S. 1/4 COR.  
SEC. 27, T3N, R66W,  
SET ALUM. CAP  
LS 38230

S 88°51'37" W 2662.11' (M)

SE. COR.  
SEC. 27, T3N, R66W,  
FOUND 3 1/4" ALUM. CAP  
LS 13155

**NOTES:**

1. ▲ INDICATES FOUND SECTION CORNER
2. ● INDICATES CALCULATED CORNER
3. ELEVATION BASED ON NAVD88 (GEOID09)
4. BASIS OF BEARING DERIVED FROM COLORADO COORDINATE SYSTEM 1983 NORTH ZONE UNLESS OTHERWISE NOTED.
5. ALL MEASURED DISTANCES ARE GRID.  
COMBINED SCALE FACTOR: .99972326
6. OPERATOR: ROB WILSON / PDOP = 1.9
7. SURFACE USE OF LOCATION IS RANGE LAND.
8. SEE ADDENDUM TO WELL LOCATION CERTIFICATE FOR EXISTING IMPROVEMENTS WITHIN 400' OF THE WELL PAD.
9. WELL FOOTAGES ARE MEASURED AT RIGHT ANGLES TO THE SECTION LINES.
10. THE BOTTOM OF HOLE BEARS N13°20'48"W, 4449' FROM THE SURFACE POSITION.

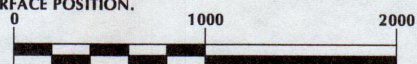

SCALE: 1" = 1000'

**CERTIFICATE OF SURVEYOR:**

THIS IS TO CERTIFY THAT THE ABOVE PLAT WAS PREPARED FROM FIELD NOTES OF ACTUAL SURVEYS MADE BY ME OR UNDER MY SUPERVISION AND THAT THE SAME ARE TRUE AND CORRECT TO THE BEST OF MY KNOWLEDGE AND BELIEF.  
THIS CERTIFICATE DOES NOT REPRESENT A LAND SURVEY PLAT OR IMPROVEMENT SURVEY PLAT AS DEFINED BY C.R.S. 38-50-102 AND CANNOT BE RELIED UPON TO DETERMINE OWNERSHIP.

*John R. Slough*  
JOHN R. SLOUGH  
PROFESSIONAL LAND SURVEYOR  
COLORADO REGISTRATION NUMBER 38230

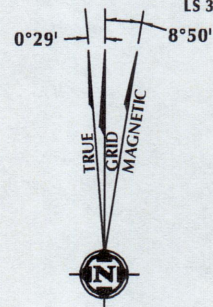

NOTE:  
MAGNETIC NORTH IS CURRENT AS OF 7/14/2011.  
MAGNETIC NORTH CHANGES WEST 0°08' PER YEAR.

**WELL PAD - BARCLAY 15-27**

**BARCLAY 28C-27HZ**  
**WELL LOCATION CERTIFICATE**  
**460' FNL & 2464' FWL (BOTTOM HOLE)**  
**NE1/4 NW1/4, SECTION 27**  
**T3N, R66W, 6TH P.M.**  
**WELD COUNTY, COLORADO**

**Kerr-McGee Oil &  
Gas Onshore L.P.**  
1099 18th Street  
Denver, Colorado 80202



**CONSULTING, LLC**

2155 North Main Street  
Sheridan, Wyoming 82801  
Phone 307-674-0609  
Fax 307-674-0182

|                       |                        |
|-----------------------|------------------------|
| DRAFTED BY: SEA       | CHECKED BY: JRS        |
| DATE DRAFTED: 7/14/11 | DATE SURVEYED: 6/30/11 |
| REVISED:              | FILE NAME: 11-40       |



# **BARCLAY 28C-27HZ** **SWSE Sec. 27 T3N-R66W**

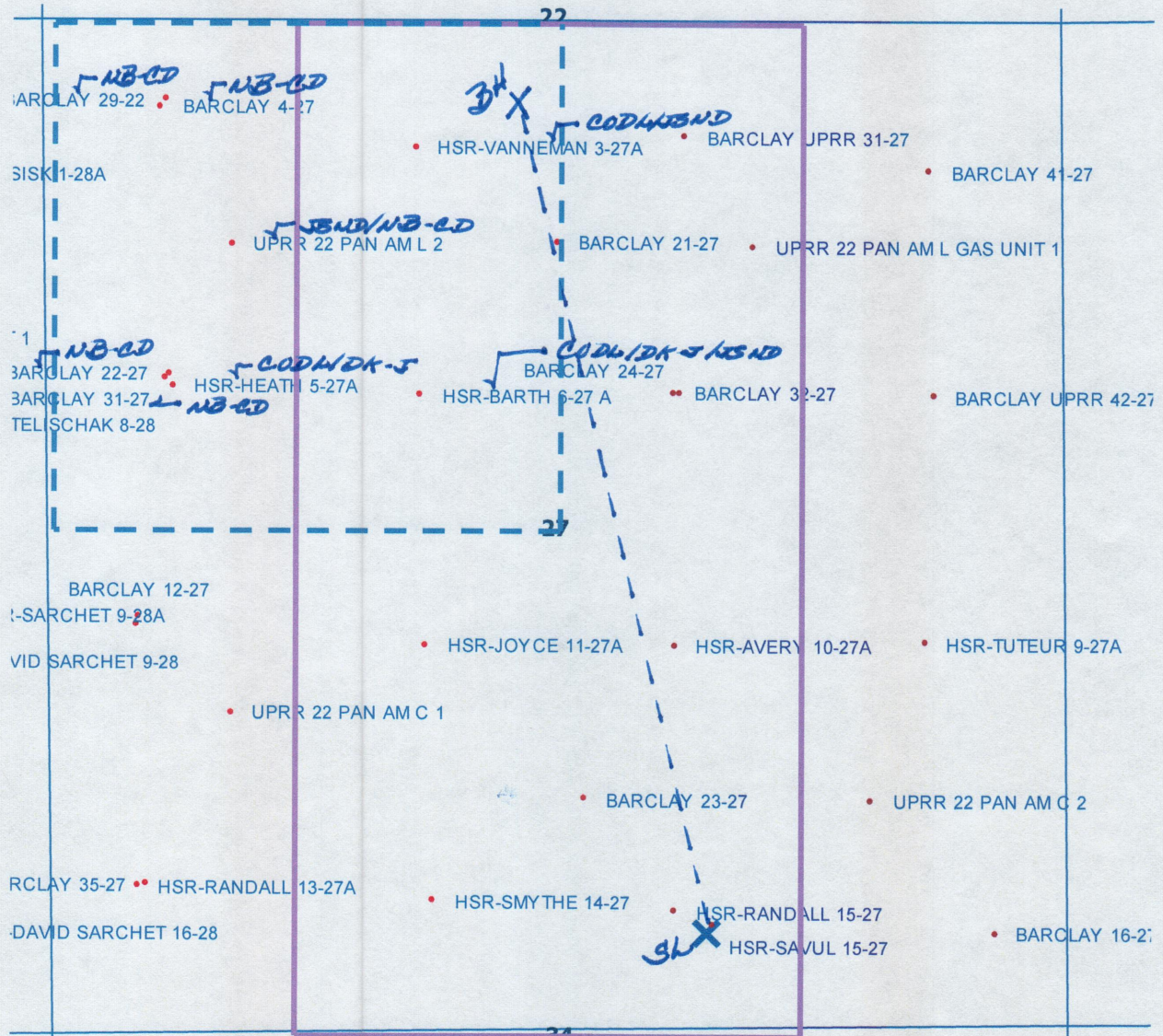

## **LEGEND**



Proposed 160 acre Spacing Unit (Solid line).



Bottom Hole Located NE/4NW/4, Sec.27-T3N-R66W (Dashed line).

**This 1/4 Section has less than 8 bottom hole wells producing from the Codell, Niobrara & J Sand Formations.**