

US ROCKIES REGION PLANNING

COLORADO NORTHERN ZONE - 83

WELD_CAMP PAD

CAMP 3N-25HZ

CAMP 3N-25HZ

Plan: CAMP 3N-25HZ (wp01)

Standard Planning Report

16 August, 2011



Azimuths to True North
Magnetic North: 8.81°

Magnetic Field
Strength: 53014.5nT
Dip Angle: 66.88°
Date: 7/18/2011
Model: IGRF2010

Project: COLORADO NORTHERN ZONE - 83
Site: WELD_CAMP PAD
Well: CAMP 3N-25HZ
Wellbore: CAMP 3N-25HZ
Section: SHL:
Design: CAMP 3N-25HZ (wp01)
Latitude: 40.190778
Longitude: -104.727640
GL: 5002.00
KB: 17' rkb + 5002' gl @ 5019.00ft

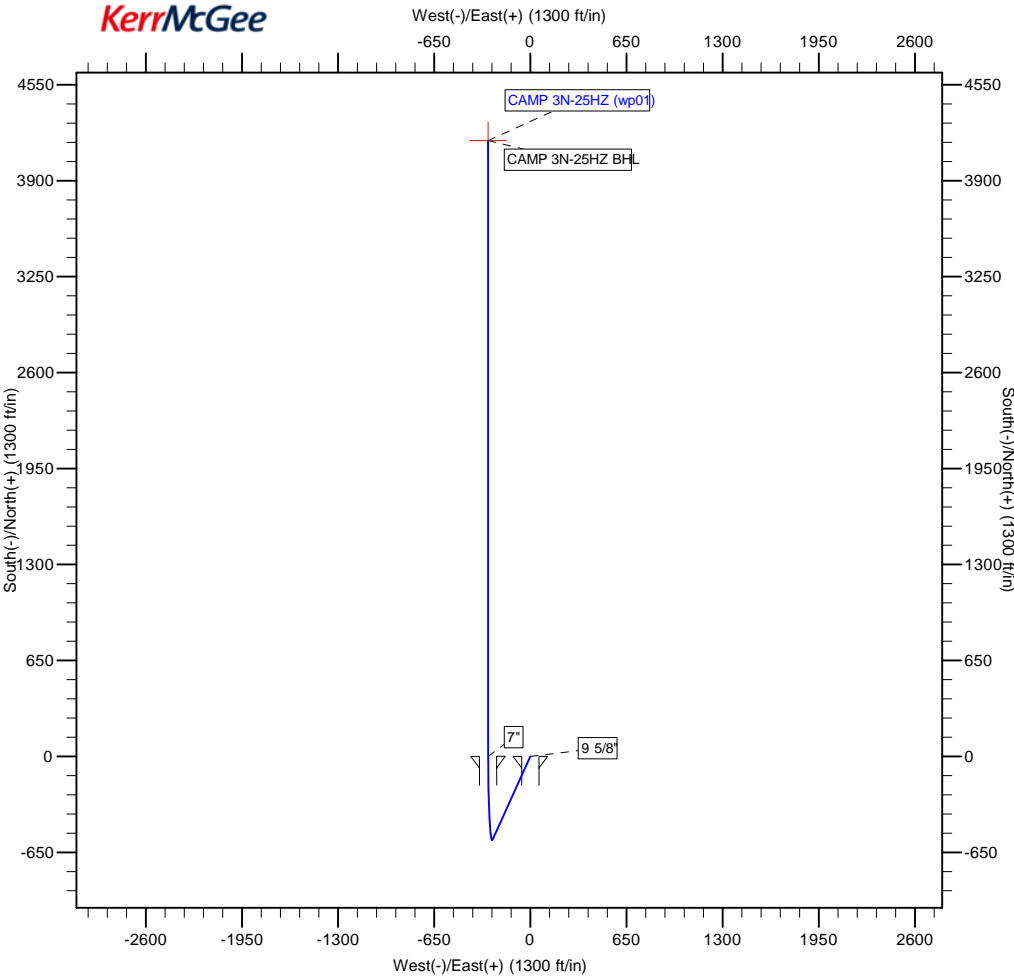

WELL DETAILS: CAMP 3N-25HZ						
+N/-S	+E/-W	Northing	Ground Level: Easting	5002.00 Latitude	Longitude	Slot
0.00	0.00	1313282.72	3215771.39	40.190778	-104.727640	

WELLBORE TARGET DETAILS (MAP CO-ORDINATES AND LAT/LONG)						
Name	TVD	+N/-S	+E/-W	Latitude	Longitude	Shape
CAMP 3N-25HZ BHL	7208.00	4171.84	-286.14	40.202230	-104.728664	Point

SECTION DETAILS									
MD	Inc	Azi	TVD	+N/-S	+E/-W	Dleg	TFace	Vsect	Target
0.00	0.00	0.00	0.00	0.00	0.00	0.00	0.00	0.00	
1000.00	0.00	0.00	1000.00	0.00	0.00	0.00	0.00	0.00	
1328.73	6.57	204.31	1328.01	-17.17	-7.76	2.00	204.31	-16.60	
6573.21	6.57	204.31	6538.00	-564.40	-254.97	0.00	0.00	-545.63	
7527.67	89.46	359.97	7170.00	0.00	-285.00	10.00	155.54	19.50	
7530.18	89.48	359.98	7170.02	2.51	-285.00	1.00	34.97	22.00	
11699.68	89.48	359.98	7208.00	4171.84	-286.14	0.00	0.00	4181.64	CAMP 3N-25HZ BHL

FORMATION TOP DETAILS			
TVDPath	MDPath	Formation	
3299.00	3312.77	PARKMAN	
4435.00	4456.29	SUSSEX	
5216.00	5242.46	SHANNON	
7065.00	7180.45	SHARON SPRINGS	
7135.00	7331.61	NIOBRARA	
7170.00	7527.67	NIOBRARA B CHALK TL	

CASING DETAILS			
TVD	MD	Name	Size
850.00	850.00	9 5/8"	9-5/8
7170.00	7527.67	7"	7

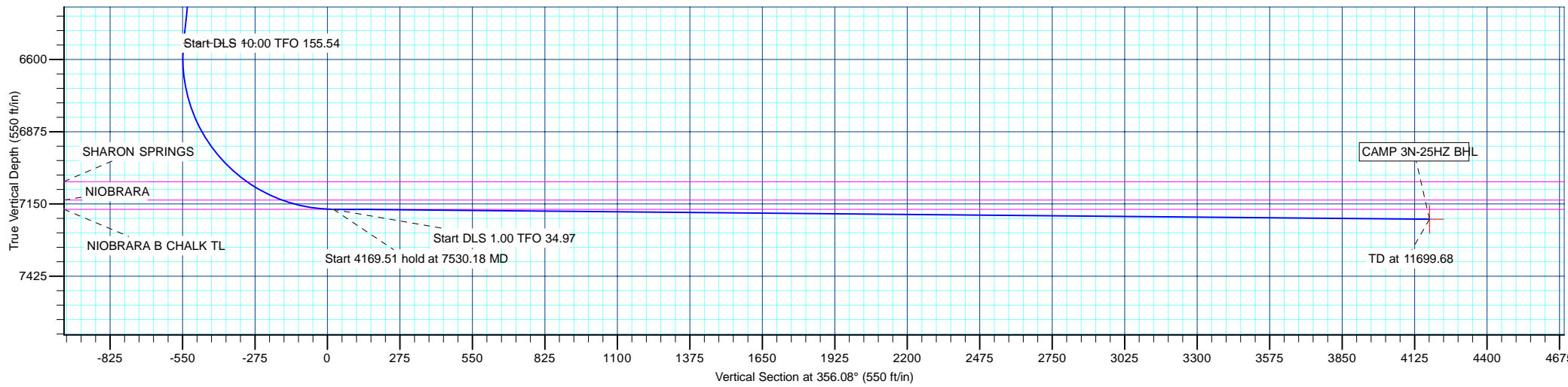

Database:	edm5000p	Local Co-ordinate Reference:	Well CAMP 3N-25HZ
Company:	US ROCKIES REGION PLANNING	TVD Reference:	17' rkb + 5002' gl @ 5019.00ft
Project:	COLORADO NORTHERN ZONE - 83	MD Reference:	17' rkb + 5002' gl @ 5019.00ft
Site:	WELD_CAMP PAD	North Reference:	True
Well:	CAMP 3N-25HZ	Survey Calculation Method:	Minimum Curvature
Wellbore:	CAMP 3N-25HZ		
Design:	CAMP 3N-25HZ (wp01)		

Project	COLORADO NORTHERN ZONE - 83		
Map System:	US State Plane 1983	System Datum:	Mean Sea Level
Geo Datum:	North American Datum 1983		
Map Zone:	Colorado Northern Zone		

Site		WELD_CAMP PAD			
Site Position:		Northing:	1,313,189.35 ft	Latitude:	40.190458
From:	Lat/Long	Easting:	3,218,417.67 ft	Longitude:	-104.718171
Position Uncertainty:	0.00 ft	Slot Radius:	0 "	Grid Convergence:	0.51 °

Well	CAMP 3N-25HZ					
Well Position	+N/-S	116.69 ft	Northing:	1,313,282.72 ft	Latitude:	40.190778
	+E/-W	-2,645.35 ft	Easting:	3,215,771.39 ft	Longitude:	-104.727640
Position Uncertainty		0.00 ft	Wellhead Elevation:		Ground Level:	5,002.00 ft

Wellbore	CAMP 3N-25HZ				
Magnetics	Model Name	Sample Date	Declination (°)	Dip Angle (°)	Field Strength (nT)
	IGRF2010	7/18/2011	8.81	66.88	53,014

Design	CAMP 3N-25HZ (wp01)			
Audit Notes:				
Version:	Phase:	PLAN	Tie On Depth:	0.00
Vertical Section:	Depth From (TVD)	+N/-S	+E/-W	Direction
	(ft)	(ft)	(ft)	(°)
	0.00	0.00	0.00	356.08

Plan Sections										
Measured Depth (ft)	Inclination (°)	Azimuth (°)	Vertical Depth (ft)	+N/-S (ft)	+E/-W (ft)	Dogleg Rate (°/100ft)	Build Rate (°/100ft)	Turn Rate (°/100ft)	TFO (°)	Target
0.00	0.00	0.00	0.00	0.00	0.00	0.00	0.00	0.00	0.00	
1,000.00	0.00	0.00	1,000.00	0.00	0.00	0.00	0.00	0.00	0.00	
1,328.73	6.57	204.31	1,328.01	-17.17	-7.76	2.00	2.00	0.00	204.31	
6,573.21	6.57	204.31	6,538.00	-564.40	-254.97	0.00	0.00	0.00	0.00	
7,527.67	89.46	359.97	7,170.00	0.00	-285.00	10.00	8.68	16.31	155.54	
7,530.18	89.48	359.98	7,170.02	2.51	-285.00	1.00	0.82	0.57	34.97	
11,699.68	89.48	359.98	7,208.00	4,171.84	-286.14	0.00	0.00	0.00	0.00	CAMP 3N-25HZ BHL

Database:	edm5000p	Local Co-ordinate Reference:	Well CAMP 3N-25HZ
Company:	US ROCKIES REGION PLANNING	TVD Reference:	17' rkb + 5002' gl @ 5019.00ft
Project:	COLORADO NORTHERN ZONE - 83	MD Reference:	17' rkb + 5002' gl @ 5019.00ft
Site:	WELD_CAMP PAD	North Reference:	True
Well:	CAMP 3N-25HZ	Survey Calculation Method:	Minimum Curvature
Wellbore:	CAMP 3N-25HZ		
Design:	CAMP 3N-25HZ (wp01)		

Planned Survey									
Measured Depth (ft)	Inclination (°)	Azimuth (°)	Vertical Depth (ft)	+N/-S (ft)	+E/-W (ft)	Vertical Section (ft)	Dogleg Rate (°/100ft)	Build Rate (°/100ft)	Turn Rate (°/100ft)
0.00	0.00	0.00	0.00	0.00	0.00	0.00	0.00	0.00	0.00
100.00	0.00	0.00	100.00	0.00	0.00	0.00	0.00	0.00	0.00
200.00	0.00	0.00	200.00	0.00	0.00	0.00	0.00	0.00	0.00
300.00	0.00	0.00	300.00	0.00	0.00	0.00	0.00	0.00	0.00
400.00	0.00	0.00	400.00	0.00	0.00	0.00	0.00	0.00	0.00
500.00	0.00	0.00	500.00	0.00	0.00	0.00	0.00	0.00	0.00
600.00	0.00	0.00	600.00	0.00	0.00	0.00	0.00	0.00	0.00
700.00	0.00	0.00	700.00	0.00	0.00	0.00	0.00	0.00	0.00
800.00	0.00	0.00	800.00	0.00	0.00	0.00	0.00	0.00	0.00
850.00	0.00	0.00	850.00	0.00	0.00	0.00	0.00	0.00	0.00
9 5/8"									
900.00	0.00	0.00	900.00	0.00	0.00	0.00	0.00	0.00	0.00
1,000.00	0.00	0.00	1,000.00	0.00	0.00	0.00	0.00	0.00	0.00
Start Build 2.00									
1,100.00	2.00	204.31	1,099.98	-1.59	-0.72	-1.54	2.00	2.00	0.00
1,200.00	4.00	204.31	1,199.84	-6.36	-2.87	-6.15	2.00	2.00	0.00
1,300.00	6.00	204.31	1,299.45	-14.30	-6.46	-13.83	2.00	2.00	0.00
1,328.73	6.57	204.31	1,328.01	-17.17	-7.76	-16.60	2.00	2.00	0.00
Start 5244.48 hold at 1328.73 MD									
1,400.00	6.57	204.31	1,398.81	-24.61	-11.12	-23.79	0.00	0.00	0.00
1,500.00	6.57	204.31	1,498.15	-35.04	-15.83	-33.87	0.00	0.00	0.00
1,600.00	6.57	204.31	1,597.50	-45.47	-20.54	-43.96	0.00	0.00	0.00
1,700.00	6.57	204.31	1,696.84	-55.91	-25.26	-54.05	0.00	0.00	0.00
1,800.00	6.57	204.31	1,796.18	-66.34	-29.97	-64.14	0.00	0.00	0.00
1,900.00	6.57	204.31	1,895.52	-76.78	-34.68	-74.22	0.00	0.00	0.00
2,000.00	6.57	204.31	1,994.86	-87.21	-39.40	-84.31	0.00	0.00	0.00
2,100.00	6.57	204.31	2,094.21	-97.65	-44.11	-94.40	0.00	0.00	0.00
2,200.00	6.57	204.31	2,193.55	-108.08	-48.83	-104.49	0.00	0.00	0.00
2,300.00	6.57	204.31	2,292.89	-118.52	-53.54	-114.57	0.00	0.00	0.00
2,400.00	6.57	204.31	2,392.23	-128.95	-58.25	-124.66	0.00	0.00	0.00
2,500.00	6.57	204.31	2,491.58	-139.38	-62.97	-134.75	0.00	0.00	0.00
2,600.00	6.57	204.31	2,590.92	-149.82	-67.68	-144.84	0.00	0.00	0.00
2,700.00	6.57	204.31	2,690.26	-160.25	-72.39	-154.92	0.00	0.00	0.00
2,800.00	6.57	204.31	2,789.60	-170.69	-77.11	-165.01	0.00	0.00	0.00
2,900.00	6.57	204.31	2,888.95	-181.12	-81.82	-175.10	0.00	0.00	0.00
3,000.00	6.57	204.31	2,988.29	-191.56	-86.53	-185.19	0.00	0.00	0.00
3,100.00	6.57	204.31	3,087.63	-201.99	-91.25	-195.27	0.00	0.00	0.00
3,200.00	6.57	204.31	3,186.97	-212.42	-95.96	-205.36	0.00	0.00	0.00
3,300.00	6.57	204.31	3,286.32	-222.86	-100.68	-215.45	0.00	0.00	0.00
3,312.77	6.57	204.31	3,299.00	-224.19	-101.28	-216.74	0.00	0.00	0.00
PARKMAN									
3,400.00	6.57	204.31	3,385.66	-233.29	-105.39	-225.54	0.00	0.00	0.00
3,500.00	6.57	204.31	3,485.00	-243.73	-110.10	-235.62	0.00	0.00	0.00
3,600.00	6.57	204.31	3,584.34	-254.16	-114.82	-245.71	0.00	0.00	0.00
3,700.00	6.57	204.31	3,683.68	-264.60	-119.53	-255.80	0.00	0.00	0.00
3,800.00	6.57	204.31	3,783.03	-275.03	-124.24	-265.88	0.00	0.00	0.00
3,900.00	6.57	204.31	3,882.37	-285.47	-128.96	-275.97	0.00	0.00	0.00
4,000.00	6.57	204.31	3,981.71	-295.90	-133.67	-286.06	0.00	0.00	0.00
4,100.00	6.57	204.31	4,081.05	-306.33	-138.39	-296.15	0.00	0.00	0.00
4,200.00	6.57	204.31	4,180.40	-316.77	-143.10	-306.23	0.00	0.00	0.00
4,300.00	6.57	204.31	4,279.74	-327.20	-147.81	-316.32	0.00	0.00	0.00
4,400.00	6.57	204.31	4,379.08	-337.64	-152.53	-326.41	0.00	0.00	0.00
4,456.29	6.57	204.31	4,435.00	-343.51	-155.18	-332.09	0.00	0.00	0.00
SUSSEX									

Database:	edm5000p	Local Co-ordinate Reference:	Well CAMP 3N-25HZ
Company:	US ROCKIES REGION PLANNING	TVD Reference:	17' rkb + 5002' gl @ 5019.00ft
Project:	COLORADO NORTHERN ZONE - 83	MD Reference:	17' rkb + 5002' gl @ 5019.00ft
Site:	WELD_CAMP PAD	North Reference:	True
Well:	CAMP 3N-25HZ	Survey Calculation Method:	Minimum Curvature
Wellbore:	CAMP 3N-25HZ		
Design:	CAMP 3N-25HZ (wp01)		

Planned Survey									
Measured Depth (ft)	Inclination (°)	Azimuth (°)	Vertical Depth (ft)	+N/-S (ft)	+E/-W (ft)	Vertical Section (ft)	Dogleg Rate (°/100ft)	Build Rate (°/100ft)	Turn Rate (°/100ft)
4,500.00	6.57	204.31	4,478.42	-348.07	-157.24	-336.50	0.00	0.00	0.00
4,600.00	6.57	204.31	4,577.77	-358.51	-161.95	-346.58	0.00	0.00	0.00
4,700.00	6.57	204.31	4,677.11	-368.94	-166.67	-356.67	0.00	0.00	0.00
4,800.00	6.57	204.31	4,776.45	-379.37	-171.38	-366.76	0.00	0.00	0.00
4,900.00	6.57	204.31	4,875.79	-389.81	-176.10	-376.85	0.00	0.00	0.00
5,000.00	6.57	204.31	4,975.14	-400.24	-180.81	-386.93	0.00	0.00	0.00
5,100.00	6.57	204.31	5,074.48	-410.68	-185.52	-397.02	0.00	0.00	0.00
5,200.00	6.57	204.31	5,173.82	-421.11	-190.24	-407.11	0.00	0.00	0.00
5,242.46	6.57	204.31	5,216.00	-425.54	-192.24	-411.39	0.00	0.00	0.00
SHANNON									
5,300.00	6.57	204.31	5,273.16	-431.55	-194.95	-417.20	0.00	0.00	0.00
5,400.00	6.57	204.31	5,372.50	-441.98	-199.66	-427.28	0.00	0.00	0.00
5,500.00	6.57	204.31	5,471.85	-452.42	-204.38	-437.37	0.00	0.00	0.00
5,600.00	6.57	204.31	5,571.19	-462.85	-209.09	-447.46	0.00	0.00	0.00
5,700.00	6.57	204.31	5,670.53	-473.28	-213.80	-457.54	0.00	0.00	0.00
5,800.00	6.57	204.31	5,769.87	-483.72	-218.52	-467.63	0.00	0.00	0.00
5,900.00	6.57	204.31	5,869.22	-494.15	-223.23	-477.72	0.00	0.00	0.00
6,000.00	6.57	204.31	5,968.56	-504.59	-227.95	-487.81	0.00	0.00	0.00
6,100.00	6.57	204.31	6,067.90	-515.02	-232.66	-497.89	0.00	0.00	0.00
6,200.00	6.57	204.31	6,167.24	-525.46	-237.37	-507.98	0.00	0.00	0.00
6,300.00	6.57	204.31	6,266.59	-535.89	-242.09	-518.07	0.00	0.00	0.00
6,400.00	6.57	204.31	6,365.93	-546.32	-246.80	-528.16	0.00	0.00	0.00
6,500.00	6.57	204.31	6,465.27	-556.76	-251.51	-538.24	0.00	0.00	0.00
6,573.21	6.57	204.31	6,538.00	-564.40	-254.97	-545.63	0.00	0.00	0.00
Start DLS 10.00 TFO 155.54									
6,600.00	4.28	219.34	6,564.67	-566.57	-256.23	-547.71	10.00	-8.56	56.08
6,700.00	7.22	337.99	6,664.39	-563.62	-260.96	-544.45	10.00	2.94	118.65
6,800.00	16.90	351.01	6,762.08	-543.39	-265.60	-523.94	10.00	9.69	13.02
6,900.00	26.82	354.61	6,854.78	-506.48	-270.00	-486.81	10.00	9.91	3.60
7,000.00	36.78	356.36	6,939.66	-454.01	-274.04	-434.20	10.00	9.96	1.75
7,100.00	46.75	357.44	7,014.16	-387.59	-277.58	-367.68	10.00	9.97	1.08
7,180.45	54.78	358.08	7,065.00	-325.37	-279.99	-305.45	10.00	9.98	0.79
SHARON SPRINGS									
7,200.00	56.73	358.21	7,076.00	-309.22	-280.52	-289.30	10.00	9.98	0.69
7,300.00	66.72	358.83	7,123.31	-221.29	-282.77	-201.42	10.00	9.99	0.61
7,331.61	69.87	359.00	7,135.00	-191.93	-283.32	-172.10	10.00	9.99	0.55
NIORARA									
7,400.00	76.71	359.35	7,154.65	-126.47	-284.26	-106.73	10.00	9.99	0.52
7,500.00	86.69	359.84	7,169.07	-27.65	-284.95	-8.09	10.00	9.99	0.49
7,527.67	89.46	359.97	7,170.00	0.00	-285.00	19.50	10.00	9.99	0.47
Start DLS 1.00 TFO 34.97 - NIOBRARA B CHALK TL - 7"									
7,530.18	89.48	359.98	7,170.02	2.51	-285.00	22.00	1.00	0.82	0.57
Start 4169.51 hold at 7530.18 MD									
7,600.00	89.48	359.98	7,170.66	72.33	-285.02	91.66	0.00	0.00	0.00
7,700.00	89.48	359.98	7,171.57	172.32	-285.05	191.43	0.00	0.00	0.00
7,800.00	89.48	359.98	7,172.48	272.32	-285.07	291.19	0.00	0.00	0.00
7,900.00	89.48	359.98	7,173.39	372.32	-285.10	390.95	0.00	0.00	0.00
8,000.00	89.48	359.98	7,174.30	472.31	-285.13	490.72	0.00	0.00	0.00
8,100.00	89.48	359.98	7,175.21	572.31	-285.16	590.48	0.00	0.00	0.00
8,200.00	89.48	359.98	7,176.12	672.30	-285.18	690.24	0.00	0.00	0.00
8,300.00	89.48	359.98	7,177.04	772.30	-285.21	790.01	0.00	0.00	0.00
8,400.00	89.48	359.98	7,177.95	872.30	-285.24	889.77	0.00	0.00	0.00
8,500.00	89.48	359.98	7,178.86	972.29	-285.27	989.53	0.00	0.00	0.00

Database:	edm5000p	Local Co-ordinate Reference:	Well CAMP 3N-25HZ
Company:	US ROCKIES REGION PLANNING	TVD Reference:	17' rkb + 5002' gl @ 5019.00ft
Project:	COLORADO NORTHERN ZONE - 83	MD Reference:	17' rkb + 5002' gl @ 5019.00ft
Site:	WELD_CAMP PAD	North Reference:	True
Well:	CAMP 3N-25HZ	Survey Calculation Method:	Minimum Curvature
Wellbore:	CAMP 3N-25HZ		
Design:	CAMP 3N-25HZ (wp01)		

Planned Survey									
Measured Depth (ft)	Inclination (°)	Azimuth (°)	Vertical Depth (ft)	+N/-S (ft)	+E/-W (ft)	Vertical Section (ft)	Dogleg Rate (°/100ft)	Build Rate (°/100ft)	Turn Rate (°/100ft)
8,600.00	89.48	359.98	7,179.77	1,072.29	-285.29	1,089.30	0.00	0.00	0.00
8,700.00	89.48	359.98	7,180.68	1,172.28	-285.32	1,189.06	0.00	0.00	0.00
8,800.00	89.48	359.98	7,181.59	1,272.28	-285.35	1,288.82	0.00	0.00	0.00
8,900.00	89.48	359.98	7,182.50	1,372.27	-285.37	1,388.59	0.00	0.00	0.00
9,000.00	89.48	359.98	7,183.41	1,472.27	-285.40	1,488.35	0.00	0.00	0.00
9,100.00	89.48	359.98	7,184.32	1,572.27	-285.43	1,588.11	0.00	0.00	0.00
9,200.00	89.48	359.98	7,185.23	1,672.26	-285.46	1,687.88	0.00	0.00	0.00
9,300.00	89.48	359.98	7,186.14	1,772.26	-285.48	1,787.64	0.00	0.00	0.00
9,400.00	89.48	359.98	7,187.05	1,872.25	-285.51	1,887.40	0.00	0.00	0.00
9,500.00	89.48	359.98	7,187.96	1,972.25	-285.54	1,987.17	0.00	0.00	0.00
9,600.00	89.48	359.98	7,188.88	2,072.25	-285.57	2,086.93	0.00	0.00	0.00
9,700.00	89.48	359.98	7,189.79	2,172.24	-285.59	2,186.69	0.00	0.00	0.00
9,800.00	89.48	359.98	7,190.70	2,272.24	-285.62	2,286.46	0.00	0.00	0.00
9,900.00	89.48	359.98	7,191.61	2,372.23	-285.65	2,386.22	0.00	0.00	0.00
10,000.00	89.48	359.98	7,192.52	2,472.23	-285.67	2,485.98	0.00	0.00	0.00
10,100.00	89.48	359.98	7,193.43	2,572.22	-285.70	2,585.75	0.00	0.00	0.00
10,200.00	89.48	359.98	7,194.34	2,672.22	-285.73	2,685.51	0.00	0.00	0.00
10,300.00	89.48	359.98	7,195.25	2,772.22	-285.76	2,785.27	0.00	0.00	0.00
10,400.00	89.48	359.98	7,196.16	2,872.21	-285.78	2,885.04	0.00	0.00	0.00
10,500.00	89.48	359.98	7,197.07	2,972.21	-285.81	2,984.80	0.00	0.00	0.00
10,600.00	89.48	359.98	7,197.98	3,072.20	-285.84	3,084.56	0.00	0.00	0.00
10,700.00	89.48	359.98	7,198.89	3,172.20	-285.87	3,184.33	0.00	0.00	0.00
10,800.00	89.48	359.98	7,199.81	3,272.20	-285.89	3,284.09	0.00	0.00	0.00
10,900.00	89.48	359.98	7,200.72	3,372.19	-285.92	3,383.85	0.00	0.00	0.00
11,000.00	89.48	359.98	7,201.63	3,472.19	-285.95	3,483.62	0.00	0.00	0.00
11,100.00	89.48	359.98	7,202.54	3,572.18	-285.97	3,583.38	0.00	0.00	0.00
11,200.00	89.48	359.98	7,203.45	3,672.18	-286.00	3,683.14	0.00	0.00	0.00
11,300.00	89.48	359.98	7,204.36	3,772.17	-286.03	3,782.91	0.00	0.00	0.00
11,400.00	89.48	359.98	7,205.27	3,872.17	-286.06	3,882.67	0.00	0.00	0.00
11,500.00	89.48	359.98	7,206.18	3,972.17	-286.08	3,982.43	0.00	0.00	0.00
11,600.00	89.48	359.98	7,207.09	4,072.16	-286.11	4,082.20	0.00	0.00	0.00
11,699.68	89.48	359.98	7,208.00	4,171.84	-286.14	4,181.64	0.00	0.00	0.00
TD at 11699.68 - CAMP 3N-25HZ BHL									

Design Targets									
Target Name	Dip Angle (°)	Dip Dir. (°)	TVD (ft)	+N/-S (ft)	+E/-W (ft)	Northing (ft)	Easting (ft)	Latitude	Longitude
- hit/miss target									
- Shape									
CAMP 3N-25HZ BHL	0.00	0.00	7,208.00	4,171.84	-286.14	1,317,451.91	3,215,448.92	40.202230	-104.728665
- plan hits target center									
- Point									

Casing Points					
Measured Depth (ft)	Vertical Depth (ft)	Name	Casing Diameter (")	Hole Diameter (")	
850.00	850.00	9 5/8"	9-5/8	12-1/4	
7,527.67	7,170.00	7"	7	8-3/4	

Database:	edm5000p	Local Co-ordinate Reference:	Well CAMP 3N-25HZ
Company:	US ROCKIES REGION PLANNING	TVD Reference:	17' rkb + 5002' gl @ 5019.00ft
Project:	COLORADO NORTHERN ZONE - 83	MD Reference:	17' rkb + 5002' gl @ 5019.00ft
Site:	WELD_CAMP PAD	North Reference:	True
Well:	CAMP 3N-25HZ	Survey Calculation Method:	Minimum Curvature
Wellbore:	CAMP 3N-25HZ		
Design:	CAMP 3N-25HZ (wp01)		

Formations					
Measured Depth (ft)	Vertical Depth (ft)	Name	Lithology	Dip (°)	Dip Direction (°)
3,312.77	3,299.00	PARKMAN		0.00	
4,456.29	4,435.00	SUSSEX		0.00	
5,242.46	5,216.00	SHANNON		0.00	
7,180.45	7,065.00	SHARON SPRINGS		0.00	
7,331.61	7,135.00	NIOBRARA		0.00	
7,527.67	7,170.00	NIOBRARA B CHALK TL		0.00	

Plan Annotations					
Measured Depth (ft)	Vertical Depth (ft)	Local Coordinates			
		+N/-S (ft)	+E/-W (ft)	Comment	
1,000.00	1,000.00	0.00	0.00	Start Build 2.00	
1,328.73	1,328.01	-17.17	-7.76	Start 5244.48 hold at 1328.73 MD	
6,573.21	6,538.00	-564.40	-254.97	Start DLS 10.00 TFO 155.54	
7,527.67	7,170.00	0.00	-285.00	Start DLS 1.00 TFO 34.97	
7,530.18	7,170.02	2.51	-285.00	Start 4169.51 hold at 7530.18 MD	
11,699.68	7,208.00	4,171.84	-286.14	TD at 11699.68	