



# KERR MCGEE OIL & GAS ONSHORE LP

Location: COLORADO Slot: SLOT#09 COOK 32-9 (2454'FNL & 2623'FWL)  
Field: WELD COUNTY (KERR MCGEE) Well: COOK 32-9  
Facility: SEC.09-T2N-R65W Wellbore: COOK 32-9 PWB



Plot reference wellpath is COOK 32-9 (REV-A.2) PWB	
True vertical depths are referenced to XTREME 15 (RKB)	Grid System: NAD83 / Lambert Colorado SP, Northern Zone (501), US feet
Measured depths are referenced to XTREME 15 (RKB)	North Reference: True north
XTREME 15 (RKB) to Mean Sea Level: 4888 feet	Scale: True distance
Mean Sea Level to Mud line (At Slot: SLOT#09 COOK 32-9 (2454'FNL & 2623'FWL)): 0 feet	Depths are in feet
Coordinates are in feet referenced to Slot	Created by: cookdam on 7/26/2011

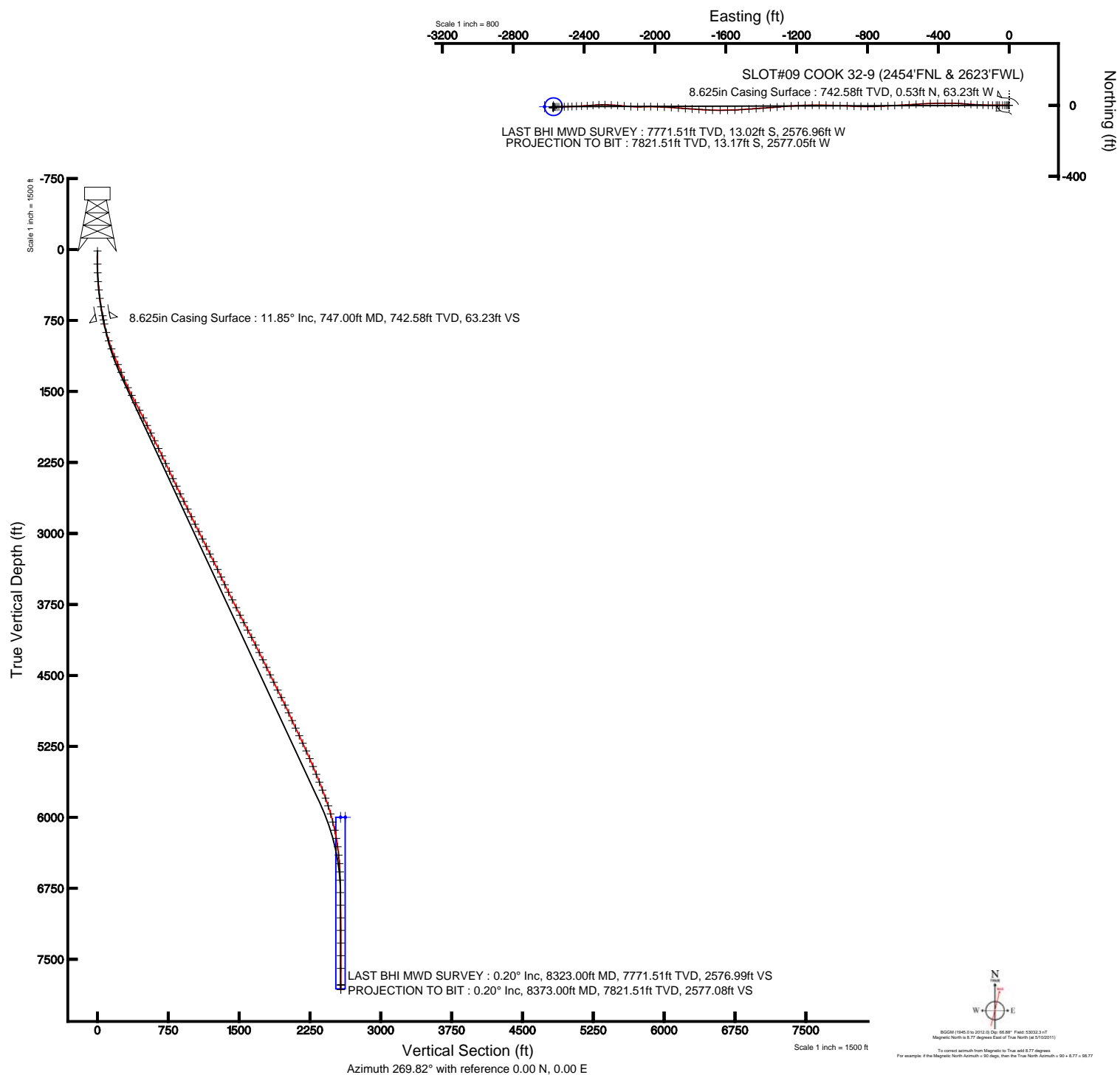



# Actual Wellpath Report

COOK 32-9 AWP

Page 1 of 5



## REFERENCE WELLPATH IDENTIFICATION

Operator	KERR MCGEE OIL & GAS ONSHORE LP	Slot	SLOT#09 COOK 32-9 (2454'FNL & 2623'FWL)
Area	COLORADO	Well	COOK 32-9
Field	WELD COUNTY (KERR MCGEE)	Wellbore	COOK 32-9 AWB
Facility	SEC.09-T2N-R65W		

## REPORT SETUP INFORMATION

Projection System	NAD83 / Lambert Colorado SP, Northern Zone (501), US feet	Software System	WellArchitect® 3.0.1
North Reference	True	User	Cookdanm
Scale	0.999958	Report Generated	7/26/2011 at 5:14:19 PM
Convergence at slot	0.54° East	Database/Source file	WA_DENVER/COOK_32-9_AWB.xml

## WELLPATH LOCATION

	Local coordinates		Grid coordinates		Geographic coordinates	
	North[ft]	East[ft]	Easting[US ft]	Northing[US ft]	Latitude	Longitude
Slot Location	2557.46	2177.01	3232299.96	1299953.21	40°09'13.601"N	104°40'08.134"W
Facility Reference Pt			3230146.88	1297375.76	40°08'48.329"N	104°40'36.170"W
Field Reference Pt			3197771.84	1268891.29	40°04'09.600"N	104°47'36.000"W

## WELLPATH DATUM

Calculation method	Minimum curvature	XTREME 15 (RKB) to Facility Vertical Datum	4888.00ft
Horizontal Reference Pt	Slot	XTREME 15 (RKB) to Mean Sea Level	4888.00ft
Vertical Reference Pt	XTREME 15 (RKB)	XTREME 15 (RKB) to Mud Line at Slot (SLOT#09 COOK 32-9 (2454'FNL & 2623'FWL))	4888.00ft
MD Reference Pt	XTREME 15 (RKB)	Section Origin	N 0.00, E 0.00 ft
Field Vertical Reference	Mean Sea Level	Section Azimuth	269.82°



# Actual Wellpath Report

COOK 32-9 AWP

Page 2 of 5



## REFERENCE WELLPATH IDENTIFICATION

Operator	KERR MCGEE OIL & GAS ONSHORE LP	Slot	SLOT#09 COOK 32-9 (2454'FNL & 2623'FWL)
Area	COLORADO	Well	COOK 32-9
Field	WELD COUNTY (KERR MCGEE)	Wellbore	COOK 32-9 AWB
Facility	SEC.09-T2N-R65W		

## WELLPATH DATA (91 stations) † = interpolated/extrapolated station

MD [ft]	Inclination [°]	Azimuth [°]	TVD [ft]	Vert Sect [ft]	North [ft]	East [ft]	DLS [°/100ft]	Comments
0.00†	0.000	345.300	0.00	0.00	0.00	0.00	0.00	
15.00	0.000	345.300	15.00	0.00	0.00	0.00	0.00	
153.00	0.100	345.300	153.00	0.03	0.12	-0.03	0.07	
246.00	2.500	273.500	245.97	2.08	0.32	-2.08	2.66	
338.00	4.000	271.100	337.82	7.29	0.50	-7.29	1.64	
427.00	5.300	269.300	426.52	14.50	0.51	-14.50	1.47	
517.00	7.100	271.100	515.99	24.22	0.57	-24.22	2.01	
607.00	9.100	269.000	605.09	36.90	0.55	-36.90	2.25	
702.00	11.700	270.400	698.52	54.04	0.49	-54.04	2.75	
792.00	12.000	270.000	786.61	72.52	0.55	-72.53	0.35	
884.00	14.100	269.300	876.22	93.30	0.41	-93.30	2.29	
976.00	17.400	271.800	964.76	118.26	0.71	-118.26	3.66	
1066.00	20.700	272.500	1049.82	147.60	1.83	-147.61	3.68	
1154.00	22.600	272.500	1131.61	180.03	3.24	-180.04	2.16	
1244.00	23.700	273.200	1214.36	215.36	5.01	-215.38	1.26	
1334.00	22.500	276.700	1297.15	250.52	8.03	-250.55	2.03	
1423.00	23.600	271.800	1379.05	285.24	10.57	-285.27	2.48	
1512.00	25.800	270.700	1459.90	322.41	11.37	-322.45	2.53	
1602.00	27.000	269.300	1540.51	362.43	11.36	-362.46	1.50	
1691.00	28.000	269.300	1619.46	403.52	10.86	-403.55	1.12	
1780.00	27.400	268.600	1698.26	444.88	10.10	-444.92	0.77	
1870.00	26.500	266.900	1778.48	485.64	8.51	-485.67	1.32	
1960.00	25.800	265.500	1859.27	525.23	5.89	-525.25	1.04	
2049.00	26.700	266.500	1939.09	564.50	3.15	-564.51	1.13	
2139.00	26.600	267.600	2019.53	604.82	1.07	-604.83	0.56	
2232.00	26.300	266.500	2102.80	646.19	-1.06	-646.19	0.62	
2318.00	26.100	266.200	2179.96	684.09	-3.48	-684.09	0.28	
2408.00	25.200	267.900	2261.09	723.00	-5.49	-722.99	1.29	
2497.00	25.000	267.900	2341.69	760.73	-6.88	-760.72	0.22	
2584.00	26.100	270.700	2420.18	798.24	-7.32	-798.23	1.88	
2673.00	25.300	272.100	2500.38	836.82	-6.38	-836.81	1.13	
2763.00	25.800	272.800	2581.58	875.60	-4.72	-875.59	0.65	
2852.00	26.400	271.800	2661.50	914.72	-3.15	-914.71	0.84	
2942.00	26.200	271.400	2742.18	954.57	-2.04	-954.57	0.30	
3032.00	25.800	271.800	2823.08	994.01	-0.94	-994.01	0.49	
3121.00	26.800	271.100	2902.86	1033.42	0.06	-1033.43	1.18	
3208.00	26.500	271.100	2980.62	1072.44	0.81	-1072.44	0.34	
3296.00	26.900	269.300	3059.24	1111.97	0.94	-1111.98	1.03	
3384.00	26.400	269.000	3137.89	1151.44	0.35	-1151.45	0.59	
3473.00	25.800	265.800	3217.82	1190.55	-1.41	-1190.55	1.72	
3563.00	27.000	266.500	3298.43	1230.48	-4.09	-1230.47	1.38	
3655.00	26.000	265.800	3380.76	1271.44	-6.84	-1271.43	1.14	
3744.00	25.200	264.800	3461.02	1309.78	-9.99	-1309.76	1.02	
3834.00	26.300	266.500	3542.09	1348.77	-12.94	-1348.74	1.47	
3923.00	26.700	265.100	3621.74	1388.38	-15.85	-1388.34	0.83	
4013.00	26.500	265.800	3702.21	1428.56	-19.05	-1428.51	0.41	
4104.00	26.700	267.200	3783.58	1469.24	-21.54	-1469.18	0.72	
4194.00	26.500	265.100	3864.06	1509.45	-24.24	-1509.38	1.07	
4282.00	26.900	267.900	3942.68	1548.91	-26.65	-1548.84	1.50	
4371.00	28.300	269.300	4021.55	1590.13	-27.64	-1590.05	1.73	
4459.00	28.600	270.000	4098.92	1632.05	-27.90	-1631.98	0.51	
4550.00	27.200	271.100	4179.34	1674.63	-27.50	-1674.55	1.64	
4638.00	25.500	273.900	4258.20	1713.64	-25.82	-1713.56	2.39	
4725.00	26.700	274.200	4336.32	1751.81	-23.12	-1751.74	1.39	
4813.00	25.300	272.500	4415.42	1790.30	-20.85	-1790.25	1.80	

4901.00	26.500	274.200	4494.58	1828.66	-18.59	-1828.62	1.60	
4989.00	26.100	275.300	4573.47	1867.51	-15.37	-1867.47	0.72	
5080.00	26.500	273.500	4655.05	1907.70	-12.28	-1907.67	0.98	
5169.00	26.300	272.100	4734.77	1947.21	-10.34	-1947.19	0.73	
5257.00	25.800	272.500	4813.83	1985.82	-8.79	-1985.80	0.60	



# Actual Wellpath Report

COOK 32-9 AWP

Page 3 of 5



## REFERENCE WELLPATH IDENTIFICATION

Operator	KERR MCGEE OIL & GAS ONSHORE LP	Slot	SLOT#09 COOK 32-9 (2454'FNL & 2623'FWL)
Area	COLORADO	Well	COOK 32-9
Field	WELD COUNTY (KERR MCGEE)	Wellbore	COOK 32-9 AWB
Facility	SEC.09-T2N-R65W		

## WELLPATH DATA (91 stations)

MD [ft]	Inclination [°]	Azimuth [°]	TVD [ft]	Vert Sect [ft]	North [ft]	East [ft]	DLS [°/100ft]	Comments
5348.00	24.700	271.100	4896.13	2024.61	-7.56	-2024.60	1.38	
5437.00	24.100	267.600	4977.19	2061.36	-7.97	-2061.35	1.76	
5525.00	25.400	269.700	5057.11	2098.19	-8.82	-2098.17	1.78	
5614.00	25.700	275.300	5137.41	2136.49	-7.14	-2136.48	2.73	
5702.00	24.900	274.600	5216.97	2173.95	-3.89	-2173.95	0.97	
5792.00	23.900	274.600	5298.93	2211.00	-0.91	-2211.01	1.11	
5881.00	23.900	272.800	5380.30	2246.97	1.42	-2246.99	0.82	
5971.00	22.800	271.800	5462.93	2282.61	2.86	-2282.63	1.30	
6061.00	22.000	267.200	5546.15	2316.88	2.58	-2316.90	2.14	
6150.00	21.700	264.400	5628.75	2349.91	0.16	-2349.92	1.22	
6240.00	21.300	266.500	5712.49	2382.79	-2.46	-2382.80	0.96	
6331.00	20.300	267.900	5797.56	2415.07	-4.05	-2415.07	1.23	
6417.00	18.200	266.900	5878.75	2443.40	-5.32	-2443.39	2.47	
6506.00	15.300	266.500	5963.96	2469.01	-6.79	-2469.00	3.26	
6595.00	14.400	269.000	6049.99	2491.80	-7.70	-2491.78	1.24	
6684.00	12.100	268.600	6136.62	2512.19	-8.12	-2512.18	2.59	
6773.00	9.900	268.600	6223.98	2529.17	-8.53	-2529.15	2.47	
6861.00	7.900	269.000	6310.91	2542.78	-8.82	-2542.76	2.27	
6951.00	6.400	267.900	6400.21	2553.98	-9.12	-2553.96	1.67	
7041.00	4.700	267.900	6489.78	2562.68	-9.43	-2562.66	1.89	
7129.00	2.400	273.900	6577.61	2568.12	-9.44	-2568.10	2.64	
7216.00	0.700	307.400	6664.58	2570.36	-8.99	-2570.34	2.13	
7347.00	0.800	311.200	6795.56	2571.68	-7.91	-2571.66	0.09	
7480.00	0.700	270.400	6928.55	2573.19	-7.29	-2573.18	0.40	
7614.00	0.800	252.500	7062.54	2574.90	-7.56	-2574.89	0.19	
7746.00	0.500	208.500	7194.54	2576.05	-8.35	-2576.04	0.42	
7880.00	0.600	194.800	7328.53	2576.52	-9.54	-2576.50	0.12	
8014.00	0.400	179.300	7462.52	2576.69	-10.69	-2576.67	0.18	
8148.00	0.600	184.600	7596.52	2576.75	-11.85	-2576.72	0.15	
8323.00	0.200	212.400	7771.51	2576.99	-13.02	-2576.96	0.25	LAST BHI MWD SURVEY
8373.00	0.200	212.400	7821.51	2577.08	-13.17	-2577.05	0.00	PROJECTION TO BIT

## HOLE & CASING SECTIONS - Ref Wellbore: COOK 32-9 AWB Ref Wellpath: COOK 32-9 AWP

String/Diameter	Start MD [ft]	End MD [ft]	Interval [ft]	Start TVD [ft]	End TVD [ft]	Start N/S [ft]	Start E/W [ft]	End N/S [ft]	End E/W [ft]
12.25in Open Hole	15.00	757.00	742.00	15.00	752.36	0.00	0.00	0.54	-65.28
8.625in Casing Surface	15.00	747.00	732.00	15.00	742.58	0.00	0.00	0.53	-63.23
7.875in Open Hole	757.00	8373.00	7616.00	752.36	7821.51	0.54	-65.28	-13.17	-2577.05



# Actual Wellpath Report

COOK 32-9 AWP

Page 4 of 5



## REFERENCE WELLPATH IDENTIFICATION

Operator	KERR MCGEE OIL & GAS ONSHORE LP	Slot	SLOT#09 COOK 32-9 (2454'FNL & 2623'FWL)
Area	COLORADO	Well	COOK 32-9
Field	WELD COUNTY (KERR MCGEE)	Wellbore	COOK 32-9 AWB
Facility	SEC.09-T2N-R65W		

## TARGETS

Name	MD [ft]	TVD [ft]	North [ft]	East [ft]	Grid East [US ft]	Grid North [US ft]	Latitude	Longitude	Shape
COOK 32-9 GEO TARGET 50' RADIUS (2470'FNL & 50'FWL, REV-10		6000.00	-7.84	-2573.38	3229726.88	1299921.25	40°09'13.522"N	104°40'41.275"W	circle
COOK 32-9 HARDLINE 50' W OF GEO TARGET		6000.00	-7.88	-2623.39	3229676.87	1299920.74	40°09'13.522"N	104°40'41.919"W	point

## WELLPATH COMPOSITION - Ref Wellbore: COOK 32-9 AWB Ref Wellpath: COOK 32-9 AWP

Start MD [ft]	End MD [ft]	Positional Uncertainty Model	Log Name/Comment	Wellbore
15.00	8323.00	NaviTrak (Standard)	BHI MWD SURVEYS <153-8323>	COOK 32-9 AWB
8323.00	8373.00	Blind Drilling (std)	Projection to bit	COOK 32-9 AWB



# Actual Wellpath Report

COOK 32-9 AWP

Page 5 of 5



## REFERENCE WELLPATH IDENTIFICATION

Operator	KERR MCGEE OIL & GAS ONSHORE LP	Slot	SLOT#09 COOK 32-9 (2454'FNL & 2623'FWL)
Area	COLORADO	Well	COOK 32-9
Field	WELD COUNTY (KERR MCGEE)	Wellbore	COOK 32-9 AWB
Facility	SEC.09-T2N-R65W		

## WELLPATH COMMENTS

MD [ft]	Inclination [°]	Azimuth [°]	TVD [ft]	Comment
8323.00	0.200	212.400	7771.51	LAST BHI MWD SURVEY
8373.00	0.200	212.400	7821.51	PROJECTION TO BIT