

Indian Creek 01-05H

Section 5 T6N R78W

Weld County, CO

Surface Location

NAD 1927 (NADCON CONUS) Colorado North 501
 Ground Elevation: 8614.00 RIG @ 8636.00ft (TBD)
 Northing Easting Latitude Longitude
 430245.15 1814965.87 40° 30' 45.140 N 106° 9' 55.670 W

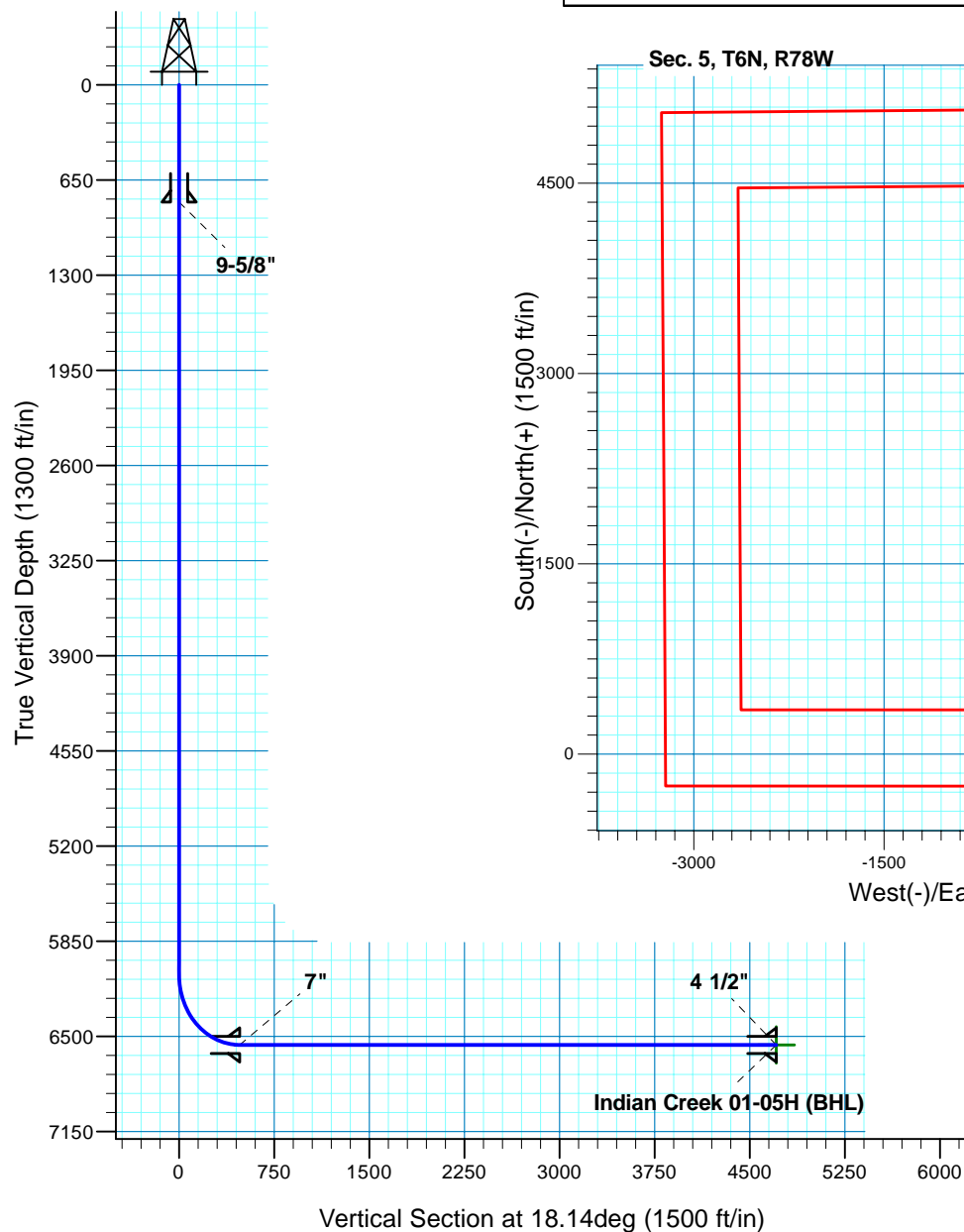

T M
 Azimuths to True North
 Magnetic North: 9.61°
 Magnetic Field
 Strength: 53064.4snT
 Dip Angle: 66.92°
 Date: 2/4/2011
 Model: IGRF200510

Project: Northpark
 Site: Indian Creek
 Well: Indian Creek 01-05H
 Plan: APD Directional Plan

SECTION DETAILS

Sec	MD	Inc	Azi	TVD	+N/-S	+E/-W	DLeg	TFace	VSec	Target
1	0.00	0.00	0.00	0.00	0.00	0.00	0.00	0.00	0.00	
2	6080.53	0.00	0.00	6080.53	0.00	0.00	0.00	0.00	0.00	
3	6830.54	90.00	18.14	6558.00	453.75	148.62	12.00	18.14	477.47	
4	11061.74	90.00	18.14	6558.00	4474.76	1465.65	0.00	0.00	4708.67	Indian Creek 01-05H (BHL)

TARGET DETAILS

Name	TVD	+N/-S	+E/-W	Northing	Easting	Latitude	Longitude	Shape
Indian Creek 01-05H (BHL)	6558.00	4474.76	1465.65	434708.78	1816465.05	40° 31' 29.359 N	106° 9' 36.691 W	Point

Denver Division- Colorado

Northpark

Indian Creek

Indian Creek 01-05H

Sidetrack - Horizontal

Plan: APD Directional Plan

Standard Planning Report

23 March, 2011

EOG Resources Inc

Planning Report

Database:	EDM	Local Co-ordinate Reference:	Well Indian Creek 01-05H
Company:	Denver Division- Colorado	TVD Reference:	RIG @ 8636.00ft (TBD)
Project:	Northpark	MD Reference:	RIG @ 8636.00ft (TBD)
Site:	Indian Creek	North Reference:	True
Well:	Indian Creek 01-05H	Survey Calculation Method:	Minimum Curvature
Wellbore:	Sidetrack - Horizontal		
Design:	APD Directional Plan		

Project	Northpark, Jackson County		
Map System:	US State Plane 1927 (Exact solution)	System Datum:	Mean Sea Level
Geo Datum:	NAD 1927 (NADCON CONUS)		
Map Zone:	Colorado North 501		

Site	Indian Creek		
Site Position:		Northing:	430,245.15 ft
From:	Lat/Long	Easting:	1,814,965.87 ft
Position Uncertainty:	0.00 ft	Slot Radius:	"
		Latitude:	40° 30' 45.140 N
		Longitude:	106° 9' 55.670 W
		Grid Convergence:	-0.43 deg

Well	Indian Creek 01-05H		
Well Position	+N/-S	0.00 ft	Northing:
	+E/-W	0.00 ft	Easting:
Position Uncertainty	0.00 ft	Wellhead Elevation:	ft
		Latitude:	40° 30' 45.140 N
		Longitude:	106° 9' 55.670 W
		Ground Level:	8,614.00 ft

Wellbore	Sidetrack - Horizontal				
Magnetics	Model Name	Sample Date	Declination (deg)	Dip Angle (deg)	Field Strength (nT)
	IGRF200510	2/4/2011	9.61	66.92	53,064

Design	APD Directional Plan			
Audit Notes:				
Version:	Phase:	PROTOTYPE	Tie On Depth:	0.00
Vertical Section:	Depth From (TVD) (ft)	+N/-S (ft)	+E/-W (ft)	Direction (deg)
	0.00	0.00	0.00	18.14

Plan Sections										
Measured Depth (ft)	Inclination (deg)	Azimuth (deg)	Vertical Depth (ft)	+N/-S (ft)	+E/-W (ft)	Dogleg Rate (?/100ft)	Build Rate (?/100ft)	Turn Rate (?/100ft)	TFO (deg)	Target
0.00	0.00	0.00	0.00	0.00	0.00	0.00	0.00	0.00	0.00	
6,080.53	0.00	0.00	6,080.53	0.00	0.00	0.00	0.00	0.00	0.00	
6,830.54	90.00	18.14	6,558.00	453.75	148.62	12.00	12.00	0.00	18.14	
11,061.74	90.00	18.14	6,558.00	4,474.76	1,465.65	0.00	0.00	0.00	0.00	Indian Creek 01-05H

EOG Resources Inc

Planning Report

Database:	EDM	Local Co-ordinate Reference:	Well Indian Creek 01-05H
Company:	Denver Division- Colorado	TVD Reference:	RIG @ 8636.00ft (TBD)
Project:	Northpark	MD Reference:	RIG @ 8636.00ft (TBD)
Site:	Indian Creek	North Reference:	True
Well:	Indian Creek 01-05H	Survey Calculation Method:	Minimum Curvature
Wellbore:	Sidetrack - Horizontal		
Design:	APD Directional Plan		

Planned Survey

Measured Depth (ft)	Inclination (deg)	Azimuth (deg)	Vertical Depth (ft)	+N/-S (ft)	+E/-W (ft)	Vertical Section (ft)	Dogleg Rate (?/100ft)	Build Rate (?/100ft)	Turn Rate (?/100ft)
0.00	0.00	0.00	0.00	0.00	0.00	0.00	0.00	0.00	0.00
100.00	0.00	0.00	100.00	0.00	0.00	0.00	0.00	0.00	0.00
200.00	0.00	0.00	200.00	0.00	0.00	0.00	0.00	0.00	0.00
300.00	0.00	0.00	300.00	0.00	0.00	0.00	0.00	0.00	0.00
400.00	0.00	0.00	400.00	0.00	0.00	0.00	0.00	0.00	0.00
500.00	0.00	0.00	500.00	0.00	0.00	0.00	0.00	0.00	0.00
600.00	0.00	0.00	600.00	0.00	0.00	0.00	0.00	0.00	0.00
700.00	0.00	0.00	700.00	0.00	0.00	0.00	0.00	0.00	0.00
800.00	0.00	0.00	800.00	0.00	0.00	0.00	0.00	0.00	0.00
9-5/8"									
900.00	0.00	0.00	900.00	0.00	0.00	0.00	0.00	0.00	0.00
1,000.00	0.00	0.00	1,000.00	0.00	0.00	0.00	0.00	0.00	0.00
1,100.00	0.00	0.00	1,100.00	0.00	0.00	0.00	0.00	0.00	0.00
1,200.00	0.00	0.00	1,200.00	0.00	0.00	0.00	0.00	0.00	0.00
1,300.00	0.00	0.00	1,300.00	0.00	0.00	0.00	0.00	0.00	0.00
1,400.00	0.00	0.00	1,400.00	0.00	0.00	0.00	0.00	0.00	0.00
1,500.00	0.00	0.00	1,500.00	0.00	0.00	0.00	0.00	0.00	0.00
1,600.00	0.00	0.00	1,600.00	0.00	0.00	0.00	0.00	0.00	0.00
1,700.00	0.00	0.00	1,700.00	0.00	0.00	0.00	0.00	0.00	0.00
1,800.00	0.00	0.00	1,800.00	0.00	0.00	0.00	0.00	0.00	0.00
1,900.00	0.00	0.00	1,900.00	0.00	0.00	0.00	0.00	0.00	0.00
2,000.00	0.00	0.00	2,000.00	0.00	0.00	0.00	0.00	0.00	0.00
2,100.00	0.00	0.00	2,100.00	0.00	0.00	0.00	0.00	0.00	0.00
2,200.00	0.00	0.00	2,200.00	0.00	0.00	0.00	0.00	0.00	0.00
2,300.00	0.00	0.00	2,300.00	0.00	0.00	0.00	0.00	0.00	0.00
2,400.00	0.00	0.00	2,400.00	0.00	0.00	0.00	0.00	0.00	0.00
2,500.00	0.00	0.00	2,500.00	0.00	0.00	0.00	0.00	0.00	0.00
2,600.00	0.00	0.00	2,600.00	0.00	0.00	0.00	0.00	0.00	0.00
2,700.00	0.00	0.00	2,700.00	0.00	0.00	0.00	0.00	0.00	0.00
2,800.00	0.00	0.00	2,800.00	0.00	0.00	0.00	0.00	0.00	0.00
2,900.00	0.00	0.00	2,900.00	0.00	0.00	0.00	0.00	0.00	0.00
3,000.00	0.00	0.00	3,000.00	0.00	0.00	0.00	0.00	0.00	0.00
3,100.00	0.00	0.00	3,100.00	0.00	0.00	0.00	0.00	0.00	0.00
3,200.00	0.00	0.00	3,200.00	0.00	0.00	0.00	0.00	0.00	0.00
3,300.00	0.00	0.00	3,300.00	0.00	0.00	0.00	0.00	0.00	0.00
3,400.00	0.00	0.00	3,400.00	0.00	0.00	0.00	0.00	0.00	0.00
3,500.00	0.00	0.00	3,500.00	0.00	0.00	0.00	0.00	0.00	0.00
3,600.00	0.00	0.00	3,600.00	0.00	0.00	0.00	0.00	0.00	0.00
3,700.00	0.00	0.00	3,700.00	0.00	0.00	0.00	0.00	0.00	0.00
3,800.00	0.00	0.00	3,800.00	0.00	0.00	0.00	0.00	0.00	0.00
3,900.00	0.00	0.00	3,900.00	0.00	0.00	0.00	0.00	0.00	0.00
4,000.00	0.00	0.00	4,000.00	0.00	0.00	0.00	0.00	0.00	0.00
4,100.00	0.00	0.00	4,100.00	0.00	0.00	0.00	0.00	0.00	0.00
4,200.00	0.00	0.00	4,200.00	0.00	0.00	0.00	0.00	0.00	0.00
4,300.00	0.00	0.00	4,300.00	0.00	0.00	0.00	0.00	0.00	0.00
4,400.00	0.00	0.00	4,400.00	0.00	0.00	0.00	0.00	0.00	0.00
4,500.00	0.00	0.00	4,500.00	0.00	0.00	0.00	0.00	0.00	0.00
4,600.00	0.00	0.00	4,600.00	0.00	0.00	0.00	0.00	0.00	0.00
4,700.00	0.00	0.00	4,700.00	0.00	0.00	0.00	0.00	0.00	0.00
4,800.00	0.00	0.00	4,800.00	0.00	0.00	0.00	0.00	0.00	0.00
4,900.00	0.00	0.00	4,900.00	0.00	0.00	0.00	0.00	0.00	0.00
5,000.00	0.00	0.00	5,000.00	0.00	0.00	0.00	0.00	0.00	0.00
5,100.00	0.00	0.00	5,100.00	0.00	0.00	0.00	0.00	0.00	0.00

EOG Resources Inc

Planning Report

Database:	EDM	Local Co-ordinate Reference:	Well Indian Creek 01-05H
Company:	Denver Division- Colorado	TVD Reference:	RIG @ 8636.00ft (TBD)
Project:	Northpark	MD Reference:	RIG @ 8636.00ft (TBD)
Site:	Indian Creek	North Reference:	True
Well:	Indian Creek 01-05H	Survey Calculation Method:	Minimum Curvature
Wellbore:	Sidetrack - Horizontal		
Design:	APD Directional Plan		

Planned Survey

Measured Depth (ft)	Inclination (deg)	Azimuth (deg)	Vertical Depth (ft)	+N/-S (ft)	+E/-W (ft)	Vertical Section (ft)	Dogleg Rate (?/100ft)	Build Rate (?/100ft)	Turn Rate (?/100ft)
5,200.00	0.00	0.00	5,200.00	0.00	0.00	0.00	0.00	0.00	0.00
5,300.00	0.00	0.00	5,300.00	0.00	0.00	0.00	0.00	0.00	0.00
5,400.00	0.00	0.00	5,400.00	0.00	0.00	0.00	0.00	0.00	0.00
5,500.00	0.00	0.00	5,500.00	0.00	0.00	0.00	0.00	0.00	0.00
5,600.00	0.00	0.00	5,600.00	0.00	0.00	0.00	0.00	0.00	0.00
5,700.00	0.00	0.00	5,700.00	0.00	0.00	0.00	0.00	0.00	0.00
5,800.00	0.00	0.00	5,800.00	0.00	0.00	0.00	0.00	0.00	0.00
5,900.00	0.00	0.00	5,900.00	0.00	0.00	0.00	0.00	0.00	0.00
6,000.00	0.00	0.00	6,000.00	0.00	0.00	0.00	0.00	0.00	0.00
6,080.53	0.00	0.00	6,080.53	0.00	0.00	0.00	0.00	0.00	0.00
6,100.00	2.34	18.14	6,099.99	0.38	0.12	0.40	12.00	12.00	0.00
6,200.00	14.34	18.14	6,198.76	14.13	4.63	14.87	12.00	12.00	0.00
6,300.00	26.34	18.14	6,292.35	47.09	15.43	49.56	12.00	12.00	0.00
6,400.00	38.34	18.14	6,376.69	97.83	32.04	102.95	12.00	12.00	0.00
6,500.00	50.34	18.14	6,448.09	164.13	53.76	172.71	12.00	12.00	0.00
6,600.00	62.34	18.14	6,503.42	243.08	79.62	255.78	12.00	12.00	0.00
6,700.00	74.34	18.14	6,540.27	331.24	108.49	348.55	12.00	12.00	0.00
6,800.00	86.34	18.14	6,557.02	424.75	139.12	446.95	12.00	12.00	0.00
6,830.54	90.00	18.14	6,558.00	453.75	148.62	477.47	12.00	12.00	0.00
7"									
6,900.00	90.00	18.14	6,558.00	519.76	170.24	546.93	0.00	0.00	0.00
7,000.00	90.00	18.14	6,558.00	614.79	201.37	646.93	0.00	0.00	0.00
7,100.00	90.00	18.14	6,558.00	709.82	232.49	746.93	0.00	0.00	0.00
7,200.00	90.00	18.14	6,558.00	804.86	263.62	846.93	0.00	0.00	0.00
7,300.00	90.00	18.14	6,558.00	899.89	294.75	946.93	0.00	0.00	0.00
7,400.00	90.00	18.14	6,558.00	994.92	325.87	1,046.93	0.00	0.00	0.00
7,500.00	90.00	18.14	6,558.00	1,089.95	357.00	1,146.93	0.00	0.00	0.00
7,600.00	90.00	18.14	6,558.00	1,184.99	388.13	1,246.93	0.00	0.00	0.00
7,700.00	90.00	18.14	6,558.00	1,280.02	419.25	1,346.93	0.00	0.00	0.00
7,800.00	90.00	18.14	6,558.00	1,375.05	450.38	1,446.93	0.00	0.00	0.00
7,900.00	90.00	18.14	6,558.00	1,470.08	481.51	1,546.93	0.00	0.00	0.00
8,000.00	90.00	18.14	6,558.00	1,565.12	512.63	1,646.93	0.00	0.00	0.00
8,100.00	90.00	18.14	6,558.00	1,660.15	543.76	1,746.93	0.00	0.00	0.00
8,200.00	90.00	18.14	6,558.00	1,755.18	574.88	1,846.93	0.00	0.00	0.00
8,300.00	90.00	18.14	6,558.00	1,850.21	606.01	1,946.93	0.00	0.00	0.00
8,400.00	90.00	18.14	6,558.00	1,945.25	637.14	2,046.93	0.00	0.00	0.00
8,500.00	90.00	18.14	6,558.00	2,040.28	668.26	2,146.93	0.00	0.00	0.00
8,600.00	90.00	18.14	6,558.00	2,135.31	699.39	2,246.93	0.00	0.00	0.00
8,700.00	90.00	18.14	6,558.00	2,230.34	730.52	2,346.93	0.00	0.00	0.00
8,800.00	90.00	18.14	6,558.00	2,325.37	761.64	2,446.93	0.00	0.00	0.00
8,900.00	90.00	18.14	6,558.00	2,420.41	792.77	2,546.93	0.00	0.00	0.00
9,000.00	90.00	18.14	6,558.00	2,515.44	823.90	2,646.93	0.00	0.00	0.00
9,100.00	90.00	18.14	6,558.00	2,610.47	855.02	2,746.93	0.00	0.00	0.00
9,200.00	90.00	18.14	6,558.00	2,705.50	886.15	2,846.93	0.00	0.00	0.00
9,300.00	90.00	18.14	6,558.00	2,800.54	917.28	2,946.93	0.00	0.00	0.00
9,400.00	90.00	18.14	6,558.00	2,895.57	948.40	3,046.93	0.00	0.00	0.00
9,500.00	90.00	18.14	6,558.00	2,990.60	979.53	3,146.93	0.00	0.00	0.00
9,600.00	90.00	18.14	6,558.00	3,085.63	1,010.66	3,246.93	0.00	0.00	0.00
9,700.00	90.00	18.14	6,558.00	3,180.67	1,041.78	3,346.93	0.00	0.00	0.00
9,800.00	90.00	18.14	6,558.00	3,275.70	1,072.91	3,446.93	0.00	0.00	0.00
9,900.00	90.00	18.14	6,558.00	3,370.73	1,104.03	3,546.93	0.00	0.00	0.00
10,000.00	90.00	18.14	6,558.00	3,465.76	1,135.16	3,646.93	0.00	0.00	0.00
10,100.00	90.00	18.14	6,558.00	3,560.79	1,166.29	3,746.93	0.00	0.00	0.00

EOG Resources Inc

Planning Report

Database:	EDM	Local Co-ordinate Reference:	Well Indian Creek 01-05H
Company:	Denver Division- Colorado	TVD Reference:	RIG @ 8636.00ft (TBD)
Project:	Northpark	MD Reference:	RIG @ 8636.00ft (TBD)
Site:	Indian Creek	North Reference:	True
Well:	Indian Creek 01-05H	Survey Calculation Method:	Minimum Curvature
Wellbore:	Sidetrack - Horizontal		
Design:	APD Directional Plan		

Planned Survey

Measured Depth (ft)	Inclination (deg)	Azimuth (deg)	Vertical Depth (ft)	+N/-S (ft)	+E/-W (ft)	Vertical Section (ft)	Dogleg Rate (?/100ft)	Build Rate (?/100ft)	Turn Rate (?/100ft)
10,200.00	90.00	18.14	6,558.00	3,655.83	1,197.41	3,846.93	0.00	0.00	0.00
10,300.00	90.00	18.14	6,558.00	3,750.86	1,228.54	3,946.93	0.00	0.00	0.00
10,400.00	90.00	18.14	6,558.00	3,845.89	1,259.67	4,046.93	0.00	0.00	0.00
10,500.00	90.00	18.14	6,558.00	3,940.92	1,290.79	4,146.93	0.00	0.00	0.00
10,600.00	90.00	18.14	6,558.00	4,035.96	1,321.92	4,246.93	0.00	0.00	0.00
10,700.00	90.00	18.14	6,558.00	4,130.99	1,353.05	4,346.93	0.00	0.00	0.00
10,800.00	90.00	18.14	6,558.00	4,226.02	1,384.17	4,446.93	0.00	0.00	0.00
10,900.00	90.00	18.14	6,558.00	4,321.05	1,415.30	4,546.93	0.00	0.00	0.00
11,000.00	90.00	18.14	6,558.00	4,416.09	1,446.43	4,646.93	0.00	0.00	0.00
11,061.74	90.00	18.14	6,558.00	4,474.76	1,465.64	4,708.67	0.00	0.00	0.00
4 1/2" - Indian Creek 01-05H (BHL)									

Targets

Target Name

- hit/miss target	Dip Angle (deg)	Dip Dir. (deg)	TVD (ft)	+N/-S (ft)	+E/-W (ft)	Northing (ft)	Easting (ft)	Latitude	Longitude
- Shape									
Indian Creek 01-05H (0.00	0.00	6,558.00	4,474.76	1,465.65	434,708.78	1,816,465.05	40° 31' 29.359 N	106° 9' 36.691 W
- plan hits target center									
- Point									

Casing Points

Measured Depth (ft)	Vertical Depth (ft)	Name	Casing Diameter (")	Hole Diameter (")
800.00	800.00	9-5/8"	9-5/8	13-1/2
6,830.54	6,558.00	7"	7	8-3/4
11,061.74	6,558.00	4 1/2"	4-1/2	6