

WELL	Keinath Federal 10-16H	FIELD	CO, Mesa Co.(NAD83UTM13)	STRUCTURE	Encana 16-08S-96W (H16OU)
Magnetic Parameters	Model: BGGM 2010	Dip: 65.824°	Date: June 17, 2011	Surface Location	NAD83 UTM Zone 13N, US Feet
		Mag Dec: 10.383°	FB: S2136.7nT	Lat: N 39 21 3.575	Nothing: 14305525.14 RUS
				Lon: W 108 5 24.732	Grid Conv: -1.87114004°
					Scale Fact: 1.00048259
				Macellaneous	Slot: Well 12
					Plan: R0 27-Jun-11
					TVD Ref: R00(58678 above MSL)
					Srvy Date: June 17, 2011

Target Name	Target Description	Major Axis	NE(X)E	E(X)W	YTD	YBR	NE(X)E	E(X)W
KF 10-16H LP	Point	1.00	14306457.31	761700.85	8880.29	203.67	931.72	-347.42
KF 10-16H TD	Point	0.00	14309063.15	767463.92	9070.23	6448.90	3536.31	5392.85

Quality Control  
Date Drawn: June 29, 2011 10:14:30 AM  
Drawn by: Chondra Salazar  
Checked by:  
Clear OK:

**Proposal**

Critical Point	MD	INCL	AZIM	YTD	YSEC	NE(X)E	E(X)W	DLS
KF 10-16H SHL	0.00	0.00	322.09	0.00	0.00	0.00	0.00	0.00
Make-Mat/Linc	22.00	0.00	322.09	22.00	0.00	0.00	0.00	0.00
KOP, Build 2 DLS	350.00	0.00	322.09	350.00	0.00	0.00	0.00	0.00
Hold	701.51	7.03	322.09	700.63	-1.75	16.99	-33.23	2.00
Ohio Creek (Top Kmv)	2204.00	7.03	322.09	2191.82	-18.67	163.09	-124.22	0.00
Williams Fork Fm	2749.00	7.03	322.09	2752.57	-22.24	216.65	-168.71	0.00
Top Gas	3713.00	7.03	322.09	3685.48	-31.65	307.81	-239.69	0.00
Coal Ridge (Paludal)	4611.00	7.03	322.09	4580.73	-40.57	394.55	-307.22	0.00
Rollins Ss (Iles Fm)	4959.00	7.03	322.09	4926.11	-44.93	428.13	-333.39	0.00
Cozzette	5211.00	7.03	322.09	5176.21	-48.53	452.47	-352.34	0.00
Corcoran	5472.00	7.03	322.09	5435.25	-49.12	477.67	-371.97	0.00
Mancoas A	6173.00	7.03	322.09	6130.98	-56.08	543.37	-424.68	0.00
Buck Tongue	6323.00	7.03	322.09	6288.79	-57.86	566.72	-436.64	0.00
Mancoas B	7009.00	7.03	322.09	6960.70	-64.38	624.10	-487.55	0.00
Prairie Canyon	7448.00	7.03	322.09	7416.25	-68.94	676.42	-522.06	0.00
KOP, Build 8 DLS	8219.01	7.03	322.09	8161.81	-76.40	742.95	-578.54	0.00
Niobrara	8329.00	9.86	22.32	8270.59	-49.16	757.00	-579.10	8.00
Landing Point	9343.25	88.28	65.67	8893.14	822.95	1106.65	10.26	8.00
KF 10-16H TD	15243.25	88.28	65.67	9070.23	8448.90	3536.31	5392.85	0.00



**Rev 0**



Grid North  
Tel Corr (M-G 12.3543°)  
Mag Dec (10.383°)  
Grid Conv (-1.97114004°)

Scale = 1(in):2000(ft)  
0 2000 4000

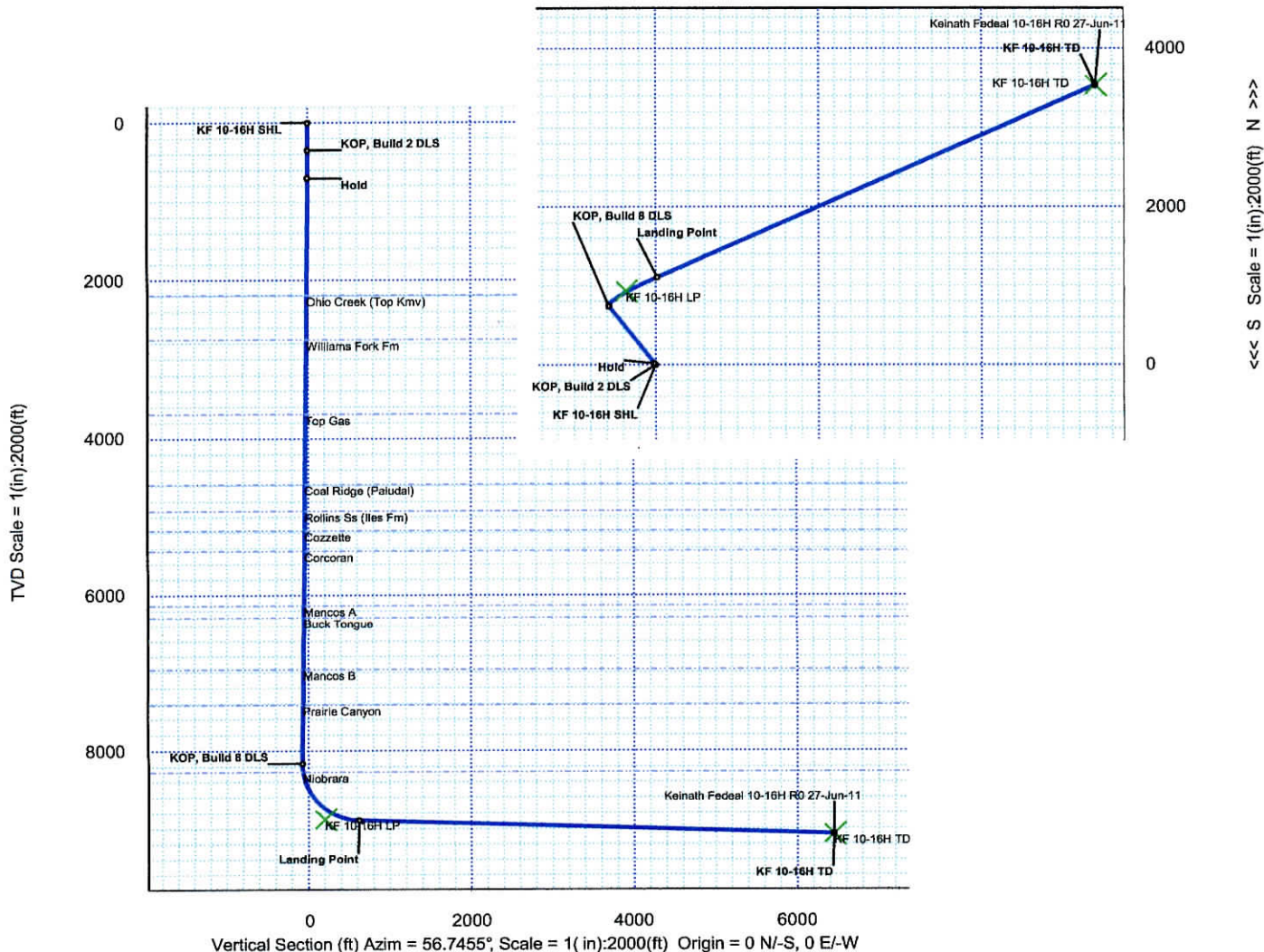



## Keinath Federal 10-16H R0 27-Jun-11 Proposal Report

(Non-Def Plan)

Report Date: June 29, 2011 - 10:47 AM  
 Client: Encana Oil & Gas (USA) Inc.  
 Field: CO, Mesa County (NAD 83 UTM 13) EnCana 2010  
 Structure / Slot: Encana 16-08S-96W (H16OU Pad) / Well 12  
 Well: Keinath Federal 10-16H  
 Borehole: Original Hole  
 UWI / API#: Unknown / Unknown  
 Survey Name: Keinath Federal 10-16H R0 27-Jun-11  
 Survey Date: June 17, 2011  
 Tort / AHD / DDI / ERD Ratio: 96.969 \* / 7551.371 ft / 6.090 / 0.833  
 Coordinate Reference System: NAD83 UTM Zone 13N, US Feet  
 Location Lat / Long: N 39° 21' 3.57480", W 108° 8' 24.73202"  
 Location Grid N/E Y/X: N 14305525.141 RUS, E 762068.483 RUS  
 CRS Grid Convergence Angle: -1.97114004 \*  
 Grid Scale Factor: 1.00048259

Survey / DLS Computation: Minimum Curvature / Lubinski  
 Vertical Section Azimuth: 58.746 \* (Grid North)  
 Vertical Section Origin: 0.000 ft, 0.000 n  
 TVD Reference Datum: RKB  
 TVD Reference Elevation: 5867.000 ft above MSL  
 Seabed / Ground Elevation: 5845.000 ft above MSL  
 Magnetic Declination: 10.383 \*  
 Total Field Strength: 52138.662 nT  
 Magnetic Dip Angle: 65.624 \*  
 Declination Date: June 17, 2011  
 Magnetic Declination Model: BGGM 2010  
 North Reference: Grid North  
 Grid Convergence Used: -1.971 \*  
 Total Corr Mag North->Grid North: 12.354 \*  
 Local Coord Referenced To: Well Head

Comments	MD (ft)	Incl (°)	Azim Grid (°)	TVD (ft)	VSEC (ft)	NS (ft)	EW (ft)	DLS (ft/100ft)	Northing (ftUS)	Easting (ftUS)	Latitude (N/S ° ' ")	Longitude (E/W ° ' ")
KF 10-16H SHL	0.00	0.00	322.09	0.00	0.00	0.00	0.00	N/A	14305525.14	762068.48	N 39 21 3.57	W 108 8 24.73
Marker MudLine	22.00	0.00	322.09	22.00	0.00	0.00	0.00	0.00	14305525.14	762068.48	N 39 21 3.57	W 108 8 24.73
	100.00	0.00	322.09	100.00	0.00	0.00	0.00	0.00	14305525.14	762068.48	N 39 21 3.57	W 108 8 24.73
	200.00	0.00	322.09	200.00	0.00	0.00	0.00	0.00	14305525.14	762068.48	N 39 21 3.57	W 108 8 24.73
	300.00	0.00	322.09	300.00	0.00	0.00	0.00	0.00	14305525.14	762068.48	N 39 21 3.57	W 108 8 24.73
KOP, Build 2 DLS	350.00	0.00	322.09	350.00	0.00	0.00	0.00	0.00	14305525.14	762068.48	N 39 21 3.57	W 108 8 24.73
	400.00	1.00	322.09	400.00	-0.04	0.34	-0.27	2.00	14305525.49	762068.21	N 39 21 3.58	W 108 8 24.74
	500.00	3.00	322.09	499.93	-0.32	3.10	-2.41	2.00	14305528.24	762066.07	N 39 21 3.60	W 108 8 24.76
	600.00	5.00	322.09	599.68	-0.88	8.60	-6.70	2.00	14305533.75	762061.78	N 39 21 3.66	W 108 8 24.82
	700.00	7.00	322.09	699.13	-1.73	16.85	-13.12	2.00	14305542.00	762055.36	N 39 21 3.74	W 108 8 24.91
Hold	701.51	7.03	322.09	700.63	-1.75	16.99	-13.23	2.00	14305542.14	762055.24	N 39 21 3.74	W 108 8 24.91
	800.00	7.03	322.09	798.38	-2.73	26.50	-20.64	0.00	14305551.66	762047.83	N 39 21 3.83	W 108 8 25.01
	900.00	7.03	322.09	897.63	-3.72	36.16	-28.16	0.00	14305561.32	762040.31	N 39 21 3.92	W 108 8 25.11
	1000.00	7.03	322.09	996.87	-4.71	45.82	-35.68	0.00	14305570.98	762032.79	N 39 21 4.02	W 108 8 25.21
	1100.00	7.03	322.09	1096.12	-5.70	55.48	-43.20	0.00	14305580.64	762025.26	N 39 21 4.11	W 108 8 25.31
	1200.00	7.03	322.09	1195.37	-6.70	65.13	-50.72	0.00	14305590.30	762017.74	N 39 21 4.20	W 108 8 25.41
	1300.00	7.03	322.09	1294.62	-7.69	74.79	-58.24	0.00	14305599.97	762010.22	N 39 21 4.29	W 108 8 25.51
	1400.00	7.03	322.09	1393.87	-8.68	84.45	-65.76	0.00	14305609.63	762002.69	N 39 21 4.39	W 108 8 25.61
	1500.00	7.03	322.09	1493.12	-9.68	94.10	-73.28	0.00	14305619.29	761995.17	N 39 21 4.48	W 108 8 25.71
	1600.00	7.03	322.09	1592.36	-10.67	103.76	-80.80	0.00	14305628.95	761987.65	N 39 21 4.57	W 108 8 25.81
	1700.00	7.03	322.09	1691.61	-11.66	113.42	-88.32	0.00	14305638.61	761980.12	N 39 21 4.67	W 108 8 25.91
	1800.00	7.03	322.09	1790.86	-12.66	123.07	-95.84	0.00	14305648.27	761972.60	N 39 21 4.76	W 108 8 26.01
	1900.00	7.03	322.09	1890.11	-13.65	132.73	-103.36	0.00	14305657.93	761965.08	N 39 21 4.85	W 108 8 26.11
	2000.00	7.03	322.09	1989.36	-14.64	142.39	-110.88	0.00	14305667.60	761957.55	N 39 21 4.94	W 108 8 26.21
	2100.00	7.03	322.09	2088.60	-15.63	152.04	-118.40	0.00	14305677.26	761950.03	N 39 21 5.04	W 108 8 26.30
	2200.00	7.03	322.09	2187.85	-16.63	161.70	-125.92	0.00	14305686.92	761942.50	N 39 21 5.13	W 108 8 26.40
Ohio Creek (Top Km)	2204.00	7.03	322.09	2191.82	-16.67	162.09	-126.22	0.00	14305687.31	761942.20	N 39 21 5.13	W 108 8 26.41
	2300.00	7.03	322.09	2287.10	-17.62	171.36	-133.44	0.00	14305696.58	761934.98	N 39 21 5.22	W 108 8 26.50
	2400.00	7.03	322.09	2386.35	-18.61	181.01	-140.96	0.00	14305706.24	761927.46	N 39 21 5.31	W 108 8 26.60
	2500.00	7.03	322.09	2485.60	-19.61	190.67	-148.48	0.00	14305715.90	761919.93	N 39 21 5.41	W 108 8 26.70
	2600.00	7.03	322.09	2584.85	-20.60	200.33	-156.00	0.00	14305725.57	761912.41	N 39 21 5.50	W 108 8 26.80
	2700.00	7.03	322.09	2684.09	-21.59	209.98	-163.52	0.00	14305735.23	761904.89	N 39 21 5.59	W 108 8 26.90
Williams Fork Fm	2769.00	7.03	322.09	2752.57	-22.28	216.65	-168.71	0.00	14305741.89	761899.70	N 39 21 5.66	W 108 8 26.97
	2800.00	7.03	322.09	2783.34	-22.59	219.64	-171.04	0.00	14305744.89	761897.36	N 39 21 5.69	W 108 8 27.00
	2900.00	7.03	322.09	2882.59	-23.58	229.30	-178.56	0.00	14305754.55	761889.84	N 39 21 5.78	W 108 8 27.10
	3000.00	7.03	322.09	2981.84	-24.57	238.96	-186.08	0.00	14305764.21	761882.32	N 39 21 5.87	W 108 8 27.20
	3100.00	7.03	322.09	3081.09	-25.57	248.61	-193.60	0.00	14305773.87	761874.79	N 39 21 5.96	W 108 8 27.30
	3200.00	7.03	322.09	3180.33	-26.56	258.27	-201.12	0.00	14305783.53	761867.27	N 39 21 6.06	W 108 8 27.40
	3300.00	7.03	322.09	3279.58	-27.55	267.93	-208.64	0.00	14305793.20	761859.75	N 39 21 6.15	W 108 8 27.50
	3400.00	7.03	322.09	3378.83	-28.54	277.58	-216.16	0.00	14305802.86	761852.22	N 39 21 6.24	W 108 8 27.60
	3500.00	7.03	322.09	3478.08	-29.54	287.24	-223.68	0.00	14305812.52	761844.70	N 39 21 6.34	W 108 8 27.70
	3600.00	7.03	322.09	3577.33	-30.53	296.90	-231.20	0.00	14305822.18	761837.18	N 39 21 6.43	W 108 8 27.80
	3700.00	7.03	322.09	3676.57	-31.52	306.55	-238.72	0.00	14305831.84	761829.65	N 39 21 6.52	W 108 8 27.90
Top Gas	3713.00	7.03	322.09	3669.48	-31.65	307.81	-239.69	0.00	14305833.10	761828.67	N 39 21 6.53	W 108 8 27.92
	3800.00	7.03	322.09	3775.82	-32.52	316.21	-246.24	0.00	14305841.50	761822.13	N 39 21 6.61	W 108 8 28.00
	3900.00	7.03	322.09	3875.07	-33.51	325.87	-253.76	0.00	14305851.16	761814.61	N 39 21 6.71	W 108 8 28.10
	4000.00	7.03	322.09	3974.32	-34.50	335.52	-261.28	0.00	14305860.83	761807.08	N 39 21 6.80	W 108 8 28.20
	4100.00	7.03	322.09	4073.57	-35.50	345.18	-268.80	0.00	14305870.49	761799.56	N 39 21 6.89	W 108 8 28.30
	4200.00	7.03	322.09	4172.82	-36.49	354.84	-276.32	0.00	14305880.15	761792.03	N 39 21 6.99	W 108 8 28.40
	4300.00	7.03	322.09	4272.06	-37.48	364.49	-283.83	0.00	14305889.81	761784.51	N 39 21 7.08	W 108 8 28.50
	4400.00	7.03	322.09	4371.31	-38.47	374.15	-291.35	0.00	14305899.47	761776.99	N 39 21 7.17	W 108 8 28.60
	4500.00	7.03	322.09	4470.56	-39.47	383.81	-298.87	0.00	14305909.13	761769.46	N 39 21 7.26	W 108 8 28.70
	4600.00	7.03	322.09	4569.81	-40.46	393.46	-306.39	0.00	14305918.79	761761.94	N 39 21 7.36	W 108 8 28.80
Coal Ridge (Paludal)	4611.00	7.03	322.09	4580.73	-40.57	394.53	-307.22	0.00	14305919.86	761761.11	N 39 21 7.37	W 108 8 28.81
	4700.00	7.03	322.09	4689.06	-41.45	403.12	-313.91	0.00	14305928.46	761754.42	N 39 21 7.45	W 108 8 28.90
	4800.00	7.03	322.09	4788.30	-42.45	412.78	-321.43	0.00	14305938.12	761746.89	N 39 21 7.54	W 108 8 29.00
	4900.00	7.03	322.09	4867.55	-43.44	422.43	-328.95	0.00	14305947.78	761739.37	N 39 21 7.64	W 108 8 29.10
Rollins Ss (Iles Fm)	4959.00	7.03	322.09	4926.11	-44.03	428.13	-333.39	0.00	14305953.48	761734.93	N 39 21 7.69	W 108 8 29.16
	5000.00	7.03	322.09	4966.80	-44.43	432.09	-336.47	0.00	14305957.44	761731.85	N 39 21 7.73	W 108 8 29.20
	5100.00	7.03	322.09	5066.05	-45.43	441.75	-343.99	0.00	14305967.10	761724.32	N 39 21 7.82	W 108 8 29.30
	5200.00	7.03	322.09	5165.30	-46.42	451.41	-351.51	0.00	14305976.76	761716.80	N 39 21 7.91	W 108 8 29.40
Cozzetta	5211.00	7.03	322.09	5178.21	-46.53	452.47	-352.34	0.00	14305977.83	761715.97	N 39 21 7.92	W 108 8 29.41
	5300.00	7.03	322.09	5264.55	-47.41	461.06	-359.03	0.00	14305986.43	761709.28	N 39 21 8.01	W 108 8 29.50
	5400.00	7.03	322.09	5363.79	-48.40	470.72	-366.55	0.00	14305996.09	761701.75	N 39 21 8.10	W 108 8 29.60
Corcoran	5472.00	7.03	322.09	5435.25	-49.12	477.67	-371.97	0.00	14306003.04	761696.34	N 39 21 8.17	W 108 8 29.67
	5500.00	7.03	322.09	5463.04	-49.40	480.38	-374.07	0.00	14306005.75	761694.23	N 39 21 8.19	W 108 8 29.70
	5600.00	7.03	322.09	5562.29	-50.39	490.03	-381.59	0.00	14306015.41	761686.71	N 39 21 8.29	W 108 8 29.80
	5700.00	7.03	322.09	5661.54	-51.38	499.69	-389.11	0.00	14306025.07	761679.18	N 39 21 8.38	W 108 8 29.90
	5800.00	7.03	322.09	5760.79	-52.38	509.35	-396.63	0.00	14306034.73	761671.66	N 39 21 8.47	W 108 8 30.00
	5900.00	7.03	322.09	5860.03	-53.37	519.00	-404.15	0.00	14306044.39	761664.14	N 39 21 8.56	W 10

Comments	MD (ft)	Incl (°)	Azim Grid (°)	TVD (ft)	VSEC (ft)	NS (ft)	EW (ft)	DLS (°/100ft)	Northing (ftUS)	Easting (ftUS)	Latitude (N/S ° ' ")	Longitude (E/W ° ' ")
Mancos B	6800.00	7.03	322.09	8554.77	-60.32	588.80	-458.79	0.00	14306112.02	761811.47	N 39 21 9.21	W 108 8 30.80
	6700.00	7.03	322.09	8554.02	-61.31	596.26	-464.31	0.00	14306121.69	761803.95	N 39 21 9.31	W 108 8 30.90
	6600.00	7.03	322.09	8553.27	-62.31	605.91	-471.83	0.00	14306131.35	761596.42	N 39 21 9.40	W 108 8 31.00
	6500.00	7.03	322.09	8552.52	-63.30	615.57	-479.35	0.00	14306141.01	761588.90	N 39 21 9.49	W 108 8 31.10
	7000.00	7.03	322.09	8951.78	-64.29	625.23	-486.87	0.00	14306150.67	761581.38	N 39 21 9.58	W 108 8 31.20
	7009.00	7.03	322.09	8960.70	-64.38	626.10	-487.55	0.00	14306151.54	761580.70	N 39 21 9.59	W 108 8 31.21
	7100.00	7.03	322.09	7051.01	-65.29	634.89	-484.39	0.00	14306160.33	761573.85	N 39 21 9.68	W 108 8 31.30
	7200.00	7.03	322.09	7150.28	-66.28	644.54	-501.91	0.00	14306169.99	761566.33	N 39 21 9.77	W 108 8 31.40
	7300.00	7.03	322.09	7249.51	-67.27	654.20	-509.43	0.00	14306179.65	761558.81	N 39 21 9.86	W 108 8 31.50
	7400.00	7.03	322.09	7348.78	-68.27	663.86	-516.95	0.00	14306189.32	761551.28	N 39 21 9.96	W 108 8 31.60
Prairie Canyon	7468.00	7.03	322.09	7416.25	-68.94	670.42	-522.06	0.00	14306195.89	761546.17	N 39 21 10.02	W 108 8 31.67
	7500.00	7.03	322.09	7448.00	-69.26	673.51	-524.47	0.00	14306198.98	761543.76	N 39 21 10.05	W 108 8 31.70
	7600.00	7.03	322.09	7547.25	-70.25	683.17	-531.99	0.00	14306208.64	761538.24	N 39 21 10.14	W 108 8 31.80
	7700.00	7.03	322.09	7646.50	-71.24	692.83	-539.51	0.00	14306218.30	761528.71	N 39 21 10.23	W 108 8 31.90
	7800.00	7.03	322.09	7745.75	-72.24	702.48	-547.03	0.00	14306227.96	761521.19	N 39 21 10.33	W 108 8 32.00
	7900.00	7.03	322.09	7845.00	-73.23	712.14	-554.55	0.00	14306237.62	761513.67	N 39 21 10.42	W 108 8 32.10
	8000.00	7.03	322.09	7944.25	-74.22	721.80	-562.07	0.00	14306247.29	761506.14	N 39 21 10.51	W 108 8 32.20
	8100.00	7.03	322.09	8043.49	-75.22	731.45	-569.59	0.00	14306256.95	761498.62	N 39 21 10.61	W 108 8 32.30
	8200.00	7.03	322.09	8142.74	-76.21	741.11	-577.11	0.00	14306266.61	761491.10	N 39 21 10.70	W 108 8 32.40
	8219.01	7.03	322.09	8181.81	-76.40	742.95	-578.54	0.00	14306268.45	761489.66	N 39 21 10.72	W 108 8 32.42
KOP, Build 8 DLS	8300.00	8.35	11.15	8241.95	-72.68	752.63	-580.45	8.00	14306278.14	761487.75	N 39 21 10.81	W 108 8 32.45
	8329.00	9.86	22.32	8270.59	-69.16	757.00	-579.10	8.00	14306282.50	761489.10	N 39 21 10.86	W 108 8 32.43
	8400.00	14.49	38.26	8339.99	-55.72	769.60	-571.26	8.00	14306295.11	761496.82	N 39 21 10.98	W 108 8 32.34
	8500.00	21.85	48.50	8434.96	-25.38	791.79	-549.57	8.00	14306317.32	761518.85	N 39 21 11.21	W 108 8 32.07
	8600.00	29.54	53.67	8525.02	17.72	818.77	-515.71	8.00	14306344.31	761552.52	N 39 21 11.49	W 108 8 31.85
	8700.00	37.35	58.85	8608.40	72.76	850.01	-470.38	8.00	14306375.59	761597.87	N 39 21 11.81	W 108 8 31.09
	8800.00	45.22	59.05	8683.49	138.66	884.91	-414.48	8.00	14306404.48	761653.82	N 39 21 12.57	W 108 8 29.68
	8900.00	53.12	60.72	8748.83	214.13	922.78	-348.04	8.00	14306448.37	761719.28	N 39 21 12.99	W 108 8 28.86
	9000.00	61.03	62.07	8803.15	297.72	962.90	-275.39	8.00	14306489.50	761792.97	N 39 21 12.99	W 108 8 28.86
	9100.00	68.97	63.24	8845.37	387.60	1004.47	-194.93	8.00	14306530.09	761873.48	N 39 21 13.43	W 108 8 27.65
Landing Point	9200.00	76.90	64.28	8874.70	482.60	1046.68	-109.25	8.00	14306572.33	761959.18	N 39 21 13.88	W 108 8 26.48
	9300.00	84.84	65.26	8890.55	580.28	1088.73	-20.01	8.00	14306614.39	762048.47	N 39 21 14.32	W 108 8 25.49
	9343.25	88.28	65.67	8893.14	622.95	1108.65	19.26	8.00	14306632.33	762087.75	N 39 21 14.51	W 108 8 24.97
	9400.00	88.28	65.67	8894.84	678.99	1130.02	70.95	0.00	14306655.71	762139.46	N 39 21 14.76	W 108 8 24.32
	9500.00	88.28	65.67	8897.85	777.73	1171.21	162.03	0.00	14306696.91	762230.59	N 39 21 15.20	W 108 8 23.18
	9600.00	88.28	65.67	8900.85	878.48	1212.39	253.10	0.00	14306738.11	762321.71	N 39 21 15.64	W 108 8 22.04
	9700.00	88.28	65.67	8903.85	975.22	1253.57	344.18	0.00	14306779.31	762412.83	N 39 21 16.07	W 108 8 20.90
	9800.00	88.28	65.67	8906.85	1073.97	1294.75	435.26	0.00	14306820.51	762503.95	N 39 21 16.51	W 108 8 19.76
	9900.00	88.28	65.67	8909.85	1172.71	1335.93	526.34	0.00	14306861.71	762595.07	N 39 21 16.95	W 108 8 18.62
	10000.00	88.28	65.67	8912.85	1271.46	1377.11	617.41	0.00	14306902.91	762686.19	N 39 21 17.39	W 108 8 17.48
Survey Type:	10100.00	88.28	65.67	8915.85	1370.20	1418.29	708.49	0.00	14306944.11	762777.32	N 39 21 17.82	W 108 8 16.34
	10200.00	88.28	65.67	8918.86	1468.95	1459.47	799.57	0.00	14306985.31	762868.44	N 39 21 18.26	W 108 8 15.20
	10300.00	88.28	65.67	8921.86	1567.69	1500.85	890.65	0.00	14307026.51	762959.56	N 39 21 18.70	W 108 8 14.06
	10400.00	88.28	65.67	8924.86	1666.44	1541.83	981.72	0.00	14307067.71	763050.68	N 39 21 19.14	W 108 8 12.92
	10500.00	88.28	65.67	8927.86	1765.18	1583.01	1072.80	0.00	14307108.91	763141.80	N 39 21 19.58	W 108 8 11.78
	10600.00	88.28	65.67	8930.86	1863.93	1624.19	1163.88	0.00	14307150.11	763232.92	N 39 21 20.01	W 108 8 10.63
	10700.00	88.28	65.67	8933.86	1962.67	1665.37	1254.96	0.00	14307191.31	763324.04	N 39 21 20.45	W 108 8 9.49
	10800.00	88.28	65.67	8936.87	2061.42	1706.55	1346.04	0.00	14307232.51	763415.17	N 39 21 20.89	W 108 8 8.35
	10900.00	88.28	65.67	8939.87	2160.16	1747.73	1437.11	0.00	14307273.71	763506.29	N 39 21 21.33	W 108 8 7.21
	11000.00	88.28	65.67	8942.87	2258.91	1788.91	1528.19	0.00	14307314.92	763597.41	N 39 21 21.76	W 108 8 6.07
Survey Error Model:	11100.00	88.28	65.67	8945.87	2357.65	1830.10	1619.27	0.00	14307356.12	763688.53	N 39 21 22.20	W 108 8 4.93
	11200.00	88.28	65.67	8948.87	2456.40	1871.28	1710.35	0.00	14307397.32	763779.65	N 39 21 22.64	W 108 8 3.79
	11300.00	88.28	65.67	8951.87	2555.14	1912.46	1801.42	0.00	14307438.52	763870.77	N 39 21 23.08	W 108 8 2.65
	11400.00	88.28	65.67	8954.87	2653.89	1953.64	1892.50	0.00	14307479.72	763961.89	N 39 21 23.51	W 108 8 1.51
	11500.00	88.28	65.67	8957.88	2752.63	1994.82	1983.58	0.00	14307520.92	764053.02	N 39 21 23.95	W 108 8 0.37
	11600.00	88.28	65.67	8960.88	2851.38	2036.00	2074.66	0.00	14307562.12	764144.14	N 39 21 24.39	W 108 8 5.98
	11700.00	88.28	65.67	8963.89	2950.12	2077.18	2165.74	0.00	14307603.32	764235.28	N 39 21 24.83	W 108 8 5.08
	11800.00	88.28	65.67	8966.88	3048.87	2118.36	2256.81	0.00	14307644.52	764326.38	N 39 21 25.27	W 108 8 5.95
	11900.00	88.28	65.67	8969.88	3147.61	2159.54	2347.89	0.00	14307685.72	764417.50	N 39 21 25.70	W 108 8 5.80
	12000.00	88.28	65.67	8972.88	3246.36	2200.72	2438.97	0.00	14307726.92	764508.62	N 39 21 26.14	W 108 8 5.66
Survey Program:	12100.00	88.28	65.67	8975.88	3345.10	2241.90	2530.05	0.00	14307768.12	764599.74	N 39 21 26.58	W 108 8 5.52
	12200.00	88.28	65.67	8978.89	3443.84	2283.08	2621.12	0.00	14307809.32	764690.87	N 39 21 27.02	W 108 8 5.38
	12300.00	88.28	65.67	8981.89	3542.59	2324.26	2712.20	0.00	14307850.52	764781.99	N 39 21 27.45	W 108 8 5.12
	12400.00	88.28	65.67	8984.89	3641.33	2365.44	2803.28	0.00	14307891.72	764873.11	N 39 21 27.89	W 108 8 5.00
	12500.00	88.28	65.67	8987.89	3740.08	2406.62	2894.36	0.00	14307932.92	764964.23	N 39 21 28.33	W 108 8 4.86
	12600.00	88.28	65.67	8990.89	3838.82	2447.80	2985.43	0.00	14307974.12	765055.35	N 39 21 28.77	W 108 8 4.72
	12700.00	88.28	65.67	8993.89	3937.57	2488						