



INTEQ



ENCANA OIL & GAS (USA) INC

Location: COLORADO Slot: Cherokee ME 3-14B(N3E) (896' FSL & 1995' FWL)
Field: GARFIELD COUNTY Well: Cherokee Mountain Estates 3-14B(N3E)
Facility: SEC 3-T7S-R92W Wellbore: Cherokee Mountain Estates 3-14B(N3E) PWB

Plot reference wellpath is Cherokee Mountain Estates 3-14B(N3E) PWB	
True vertical depths are referenced to Xtreme 7 (RT)	Grid System: NAD83 / Lambert Colorado State Planes, Northern Zone (501), US feet
Measured depths are referenced to Xtreme 7 (RT)	North Reference: True north
Xtreme 7 (RT) to Mean Sea Level: 6132 feet	Scale: True distance
Mean Sea Level to Mud line (Facility - SEC 3-T7S-R92W): 0 feet	Depths are in feet
Coordinates are in feet referenced to Slot	Created by: Suzanne Thompson on 12/10/2007

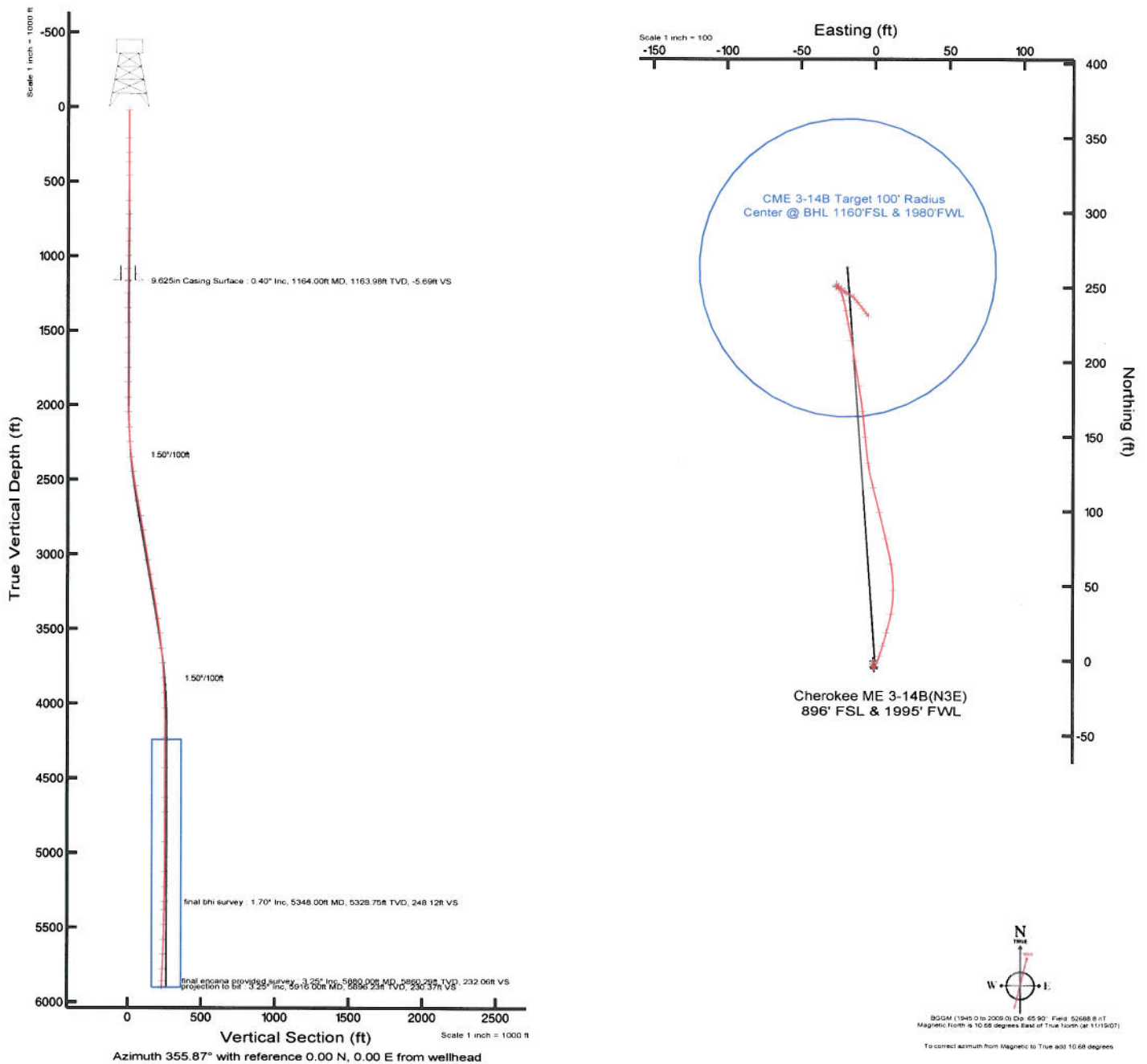



Actual Wellpath Report

Cherokee Mountain Estates 3-14B AWP
Page 1 of 3



REFERENCE WELLPATH IDENTIFICATION

Operator	ENCANA OIL & GAS (USA) INC	Slot	Cherokee ME 3-14B(N3E) (896' FSL & 1995' FWL)
Area	COLORADO	Well	Cherokee Mountain Estates 3-14B(N3E)
Field	GARFIELD COUNTY	Wellbore	Cherokee Mountain Estates 3-14B AWB
Facility	SEC.3-T7S-R92W		

REPORT SETUP INFORMATION

Projection System	NAD83 / Lambert Colorado State Planes, Northern Zone (501), US feet	Software System	WellArchitect™ 1.2
North Reference	True	User	Suzanne Thompson
Scale	1.00005	Report Generated	12/10/07 at 15:48:51
Wellbore last revised	12/10/07	Database/Source file	WA_Denver/Cheroke

WELLPATH LOCATION

	Local coordinates		Grid coordinates		Geographic coordinates	
	North [feet]	East [feet]	Easting [US feet]	Northing [US feet]	Latitude [°]	Longitude [°]
Slot Location	730.64	-2298.49	2391726.35	1057591.42	39 28 16.120N	107 39 16.990W
Facility Reference Pt			2394006.59	1056805.32	39 28 08.900N	107 38 47.680W
Field Reference Pt			3000000.00	4454105.15	48 46 34.315N	105 30 00.000W

WELLPATH DATUM

Calculation method	Minimum curvature	Xtreme 7 (RT) to Installation Vertical Datum	6132.00 feet
Horizontal Reference Pt	Slot	Xtreme 7 (RT) to Mean Sea Level	6132.00 feet
Vertical Reference Pt	Xtreme 7 (RT)	Installation Vertical Datum to Mud Line (Facility)	0.00 feet
MD Reference Pt	Xtreme 7 (RT)	Section Origin	N 0.00, E 0.00 ft
Field Vertical Reference	Mean Sea Level	Section Azimuth	355.87°



Actual Wellpath Report

Cherokee Mountain Estates 3-14B AWP

Page 2 of 3



REFERENCE WELLPATH IDENTIFICATION

Operator	ENCANA OIL & GAS (USA) INC	Slot	Cherokee ME 3-14B(N3E) (896' FSL & 1995' FWL)
Area	COLORADO	Well	Cherokee Mountain Estates 3-14B(N3E)
Field	GARFIELD COUNTY	Wellbore	Cherokee Mountain Estates 3-14B AWP
Facility	SEC.3-T7S-R92W		

WELLPATH DATA (57 stations) † = interpolated/extrapolated station

MD [feet]	Inclination [°]	Azimuth [°]	TVD [feet]	Vert Sect [feet]	North [feet]	East [feet]	Latitude [°]	Longitude [°]	DLS [°/100ft]
0.00†	0.000	0.000	0.00	0.00	0.00	0.00	39 28 16.120N	107 39 16.990W	0.00
20.00	0.000	0.000	20.00	0.00	0.00	0.00	39 28 16.120N	107 39 16.990W	0.00
207.00	0.300	267.000	207.00	0.01	-0.03	-0.49	39 28 16.120N	107 39 16.996W	0.16
308.00	0.400	247.000	308.00	-0.10	-0.18	-1.08	39 28 16.118N	107 39 17.004W	0.15
370.00	0.200	228.000	370.00	-0.24	-0.33	-1.36	39 28 16.117N	107 39 17.007W	0.36
460.00	0.400	178.300	460.00	-0.65	-0.75	-1.46	39 28 16.113N	107 39 17.009W	0.35
630.00	0.400	185.700	629.99	-1.82	-1.94	-1.51	39 28 16.101N	107 39 17.009W	0.03
721.00	0.500	171.000	720.99	-2.53	-2.65	-1.48	39 28 16.094N	107 39 17.009W	0.17
819.00	0.400	182.600	818.99	-3.30	-3.41	-1.42	39 28 16.086N	107 39 17.008W	0.14
902.00	0.400	159.700	901.98	-3.86	-3.97	-1.34	39 28 16.081N	107 39 17.007W	0.19
993.00	0.500	156.900	992.98	-4.54	-4.63	-1.07	39 28 16.074N	107 39 17.004W	0.11
1083.00	0.400	160.600	1082.98	-5.22	-5.29	-0.81	39 28 16.068N	107 39 17.000W	0.12
1170.00	0.400	128.500	1169.98	-5.72	-5.77	-0.47	39 28 16.063N	107 39 16.996W	0.25
1248.00	0.300	15.200	1247.97	-5.71	-5.74	-0.21	39 28 16.063N	107 39 16.993W	0.75
1348.00	0.200	23.430	1347.97	-5.31	-5.33	-0.07	39 28 16.067N	107 39 16.991W	0.11
1448.00	0.300	7.700	1447.97	-4.90	-4.91	0.04	39 28 16.072N	107 39 16.990W	0.12
1548.00	0.400	351.900	1547.97	-4.29	-4.30	0.02	39 28 16.077N	107 39 16.990W	0.14
1648.00	0.200	240.500	1647.97	-4.02	-4.04	-0.18	39 28 16.080N	107 39 16.992W	0.51
1748.00	0.200	195.300	1747.97	-4.26	-4.30	-0.38	39 28 16.078N	107 39 16.995W	0.15
1848.00	0.200	93.800	1847.97	-4.45	-4.48	-0.25	39 28 16.076N	107 39 16.993W	0.31
1948.00	0.600	25.700	1947.97	-4.02	-4.02	0.15	39 28 16.080N	107 39 16.988W	0.56
2048.00	2.300	23.100	2047.93	-1.78	-1.70	1.17	39 28 16.103N	107 39 16.975W	1.70
2148.00	3.400	21.500	2147.81	2.68	2.91	3.04	39 28 16.149N	107 39 16.951W	1.10
2248.00	4.500	15.500	2247.57	9.05	9.45	5.18	39 28 16.213N	107 39 16.924W	1.17
2348.00	6.300	16.800	2347.12	17.87	18.48	7.81	39 28 16.303N	107 39 16.890W	1.80
2448.00	8.600	11.300	2446.27	30.20	31.07	10.86	39 28 16.427N	107 39 16.852W	2.41
2548.00	10.000	0.300	2544.96	46.07	47.08	12.37	39 28 16.585N	107 39 16.832W	2.26
2648.00	10.100	350.400	2643.43	63.45	64.41	10.95	39 28 16.757N	107 39 16.850W	1.73
2748.00	10.200	346.000	2741.87	80.91	81.65	7.35	39 28 16.927N	107 39 16.896W	0.78
2848.00	10.200	345.600	2840.29	98.34	98.82	3.01	39 28 17.097N	107 39 16.952W	0.07
2948.00	9.800	345.000	2938.77	115.41	115.61	-1.40	39 28 17.263N	107 39 17.008W	0.41
3048.00	9.900	351.400	3037.30	132.34	132.33	-4.89	39 28 17.428N	107 39 17.052W	1.10
3148.00	10.000	355.400	3135.80	149.59	149.49	-6.87	39 28 17.597N	107 39 17.078W	0.70
3248.00	9.900	352.900	3234.29	166.86	166.67	-8.63	39 28 17.767N	107 39 17.100W	0.44
3348.00	10.100	350.300	3332.77	184.17	183.85	-11.17	39 28 17.937N	107 39 17.132W	0.49
3448.00	9.100	350.900	3431.37	200.78	200.30	-13.90	39 28 18.100N	107 39 17.167W	1.00
3548.00	7.100	349.000	3530.37	214.79	214.17	-16.33	39 28 18.237N	107 39 17.198W	2.02
3648.00	5.900	349.000	3629.73	226.03	225.29	-18.49	39 28 18.347N	107 39 17.226W	1.20
3748.00	4.500	350.200	3729.31	235.04	234.20	-20.13	39 28 18.435N	107 39 17.247W	1.40
3848.00	3.700	346.700	3829.06	242.13	241.20	-21.54	39 28 18.504N	107 39 17.265W	0.84



Actual Wellpath Report

Cherokee Mountain Estates 3-14B AWP
Page 3 of 3



REFERENCE WELLPATH IDENTIFICATION

Operator	ENCANA OIL & GAS (USA) INC	Slot	Cherokee ME 3-14B(N3E) (896' FSL & 1995' FWL)
Area	COLORADO	Well	Cherokee Mountain Estates 3-14B(N3E)
Field	GARFIELD COUNTY	Wellbore	Cherokee Mountain Estates 3-14B AWP
Facility	SEC.3-T7S-R92W		

WELLPATH DATA (57 stations) † = interpolated/extrapolated station

MD [feet]	Inclination [°]	Azimuth [°]	TVD [feet]	Vert Sect [feet]	North [feet]	East [feet]	Latitude [°]	Longitude [°]	DLS [°/100ft]
3948.00	2.400	339.900	3928.91	247.33	246.31	-23.01	39 28 18.554N	107 39 17.283W	1.35
4048.00	1.400	302.700	4028.86	250.07	248.94	-24.75	39 28 18.580N	107 39 17.306W	1.54
4248.00	0.200	108.400	4228.84	251.40	250.15	-26.48	39 28 18.592N	107 39 17.328W	0.80
4448.00	0.200	316.200	4428.84	251.54	250.29	-26.39	39 28 18.594N	107 39 17.327W	0.19
4648.00	0.100	27.100	4628.84	251.96	250.70	-26.55	39 28 18.598N	107 39 17.329W	0.10
4748.00	0.600	346.800	4728.84	252.55	251.28	-26.63	39 28 18.603N	107 39 17.330W	0.53
4948.00	0.300	106.100	4928.83	253.40	252.16	-26.37	39 28 18.612N	107 39 17.326W	0.40
5148.00	1.000	137.100	5128.82	251.86	250.73	-24.68	39 28 18.598N	107 39 17.305W	0.38
5248.00	1.600	127.900	5228.79	250.24	249.24	-22.98	39 28 18.583N	107 39 17.283W	0.63
5348.00	1.700	138.900	5328.75	248.12	247.26	-20.90	39 28 18.564N	107 39 17.257W	0.33
5400.00	1.500	118.020	5380.73	247.15	246.36	-19.80	39 28 18.555N	107 39 17.242W	1.18
5500.00	1.750	120.170	5480.69	245.59	244.98	-17.32	39 28 18.541N	107 39 17.211W	0.26
5600.00	2.000	132.310	5580.64	243.46	243.04	-14.71	39 28 18.522N	107 39 17.178W	0.47
5700.00	2.750	144.440	5680.55	240.15	239.91	-12.02	39 28 18.491N	107 39 17.143W	0.90
5800.00	3.250	140.590	5780.42	235.79	235.77	-8.83	39 28 18.450N	107 39 17.103W	0.54
5880.00	3.250	141.890	5860.29	232.06	232.23	-5.99	39 28 18.415N	107 39 17.066W	0.09
5916.00†	3.250	141.890	5896.23	230.37	230.63	-4.73	39 28 18.399N	107 39 17.050W	0.00

HOLE & CASING SECTIONS

Ref Wellbore: Cherokee Mountain Estates 3-14B AWP

Ref Wellpath: Cherokee Mountain Estates 3-14B AWP

String/Diameter	Start MD [feet]	End MD [feet]	Interval [feet]	Start TVD [feet]	End TVD [feet]	Start N/S [feet]	Start E/W [feet]	End N/S [feet]	End E/W [feet]
9.625in Casing Surface	20.00	1164.00	1144.00	20.00	1163.98	0.00	0.00	-5.74	-0.51

TARGETS

Name	MD [feet]	TVD [feet]	North [feet]	East [feet]	Grid East [us survey feet]	Grid North [us survey feet]	Latitude [°]	Longitude [°]	Shape
CME 3-14B Target 100' Radius Center @ BHL 1160' FSL & 1980' FWL		4242.00	263.00	-19.00	2391713.74	1057854.81	39 28 18.719N	107 39 17.232W	circle

WELLPATH COMPOSITION

Ref Wellbore: Cherokee Mountain Estates 3-14B AWP

Ref Wellpath: Cherokee Mountain Estates 3-14B AWP

Start MD [feet]	End MD [feet]	Positional Uncertainty Model	Log Name/Comment	Wellbore
20.00	5348.00	NaviTrak (Standard)	BHI MWD <207-5348>	Cherokee Mountain Estates 3-14B AWP
5348.00	5880.00	Photomechanical Magnetic (Standard)	Encana Provided Surveys <5400-5916>	Cherokee Mountain Estates 3-14B AWP
5880.00	5916.00	Blind Drilling (std)	Projection to bit	Cherokee Mountain Estates 3-14B AWP

WELLPATH COMMENTS

MD [feet]	Inclination [degrees]	Azimuth [degrees]	TVD [feet]	Comment
--------------	--------------------------	----------------------	---------------	---------

5348.00	1.700	138.900	5328.75	final bhi survey
5880.00	3.250	141.890	5860.29	final encana provided survey
5916.00	3.250	141.890	5896.23	projection to bit