

# PETROLEUM DEVELOPMENT CORP Weld County CO

Well Name: **Wilson 14-34H**

Surface Location: Wilson 14-34H Pad Sec.34-T7N-R63W  
North American Datum 1983 , US State Plane 1983 , Colorado Northern Zone

Ground Elevation: 4717.0

| +N/-S | +E/-W | Northing   | Easting    | Latitude  | Longitude   | Slot |
|-------|-------|------------|------------|-----------|-------------|------|
| 0.0   | 0.0   | 1435375.46 | 3297452.84 | 40.523580 | -104.430010 |      |

Original Well Elev WELL @ 4732.0ft (Original Well Elev)

## WELLBORE TARGET DETAILS

| Name                  | TVD    | +N/-S  | +E/-W  | Shape   |
|-----------------------|--------|--------|--------|---------|
| BHL HARDLINE 460'FNL  | 1.0    | 4626.8 | -100.0 | Polygon |
| SHL HARDLINE 460'FSL  | 1.0    | 246.0  | -100.0 | Polygon |
| WEST HARDLINE 460'FWL | 1.0    | 246.0  | -100.0 | Polygon |
| BHL 500'FNL, 560'FWL  | 6607.0 | 4586.8 | -27.8  | Point   |

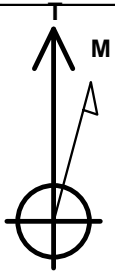

Azimuths to True North  
Magnetic North: 8.69°

Magnetic Field  
Strength: 53228.4snT  
Dip Angle: 67.20°  
Date: 6/30/2011  
Model: IGRF2010

Wilson 14-34H Pad Sec.34-T7N-R63W  
Wilson 14-34H  
Plan #1 (6-30-11)  
18:30, June 30 2011

## ANNOTATIONS

| TVD    | MD     | Annotation   |
|--------|--------|--------------|
| 5853.1 | 5853.1 | KOP          |
| 6617.0 | 7055.1 | End of Build |

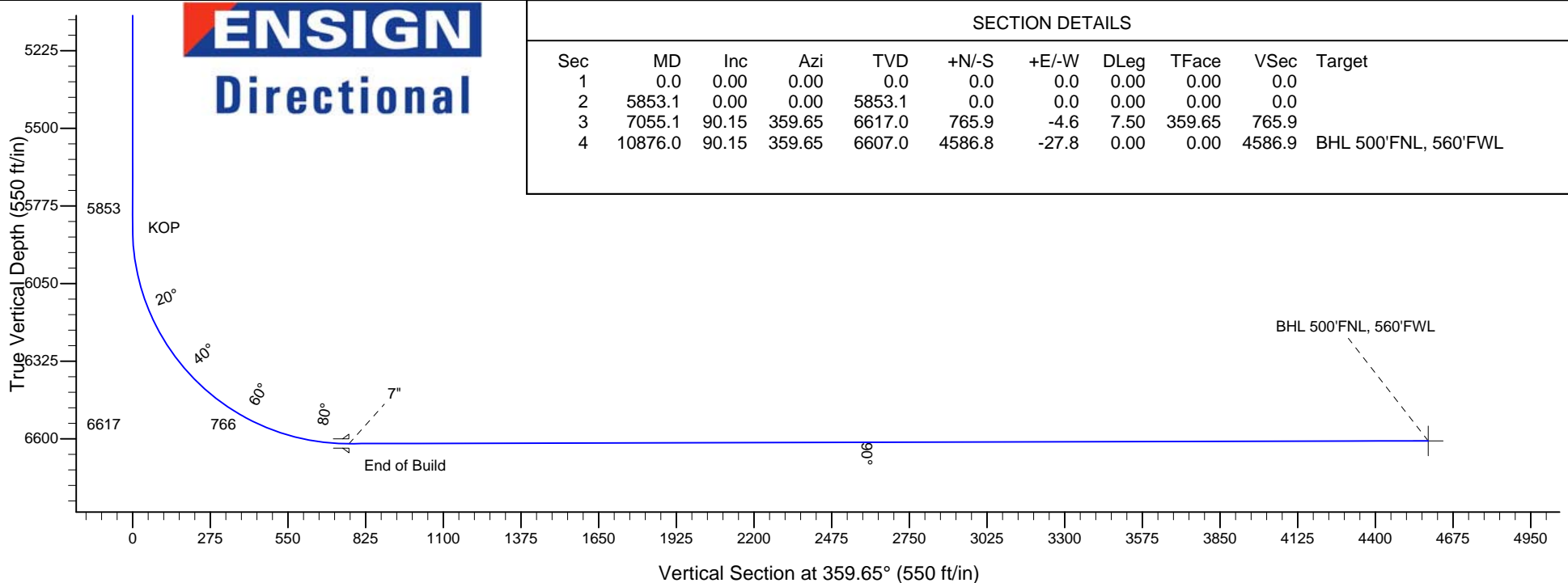
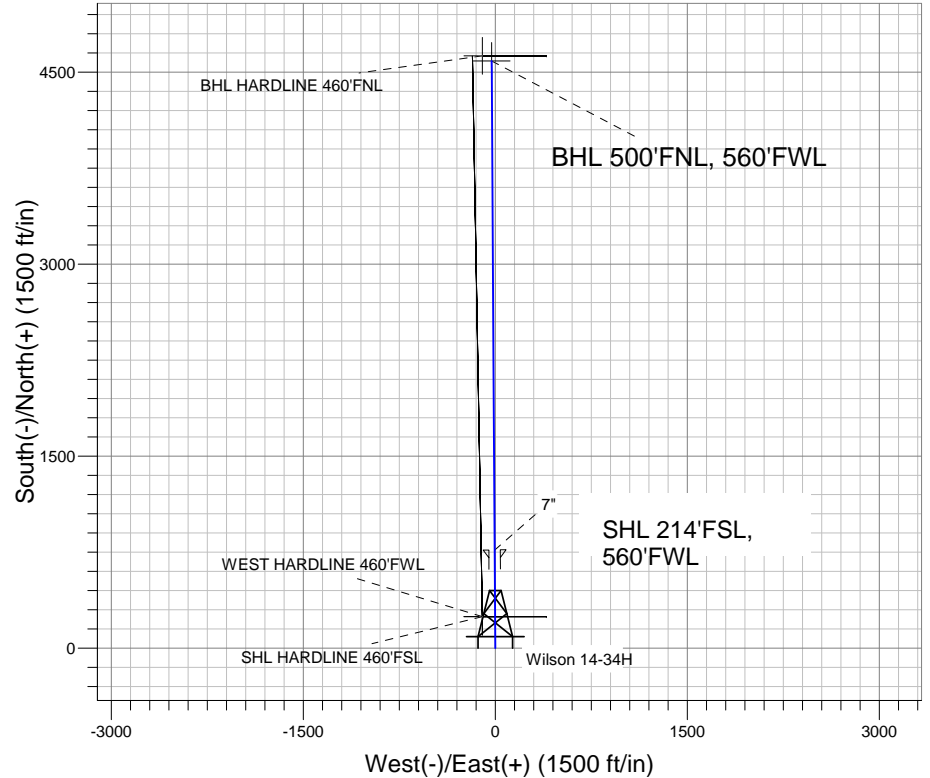

**ENSIGN**  
Directional

## SECTION DETAILS

| Sec | MD      | Inc   | Azi    | TVD    | +N/-S  | +E/-W | DLeg | TFace  | VSec   | Target               |
|-----|---------|-------|--------|--------|--------|-------|------|--------|--------|----------------------|
| 1   | 0.0     | 0.00  | 0.00   | 0.0    | 0.0    | 0.0   | 0.00 | 0.00   | 0.0    |                      |
| 2   | 5853.1  | 0.00  | 0.00   | 5853.1 | 0.0    | 0.0   | 0.00 | 0.00   | 0.0    |                      |
| 3   | 7055.1  | 90.15 | 359.65 | 6617.0 | 765.9  | -4.6  | 7.50 | 359.65 | 765.9  |                      |
| 4   | 10876.0 | 90.15 | 359.65 | 6607.0 | 4586.8 | -27.8 | 0.00 | 0.00   | 4586.9 | BHL 500'FNL, 560'FWL |