

Rem #4472



State of Colorado
Oil and Gas Conservation Commission

1120 Lincoln Street, Suite 801, Denver, Colorado 80203 (303) 894-2100 Fax 894-2109

RECEIVED

AUG 12 2011

COGCC

SITE INVESTIGATION AND REMEDIATION WORKPLAN

This form shall be submitted to the Director for approval prior to the initiation of site investigation and remediation activities. Form 27 is intended to be used whenever possible. Additional documentation will be required when large volumes of soil and groundwater have been impacted or involve large facilities with multiple source areas. See Rule 910. Attach as many pages as needed to fully describe the proposed work.

OGCC Employee:

☐ Spill ☐ Complaint
☐ Inspection ☐ NOAV

Tracking No: 1175664

CAUSE OF CONDITION BEING INVESTIGATED AND REMEDIATED

☒ Spill or Release ☐ Plug & Abandon ☐ Central Facility Closure ☐ Site/Facility Closure ☐ Other (describe):

GENERAL INFORMATION

OGCC Operator Number: 69175 Name of Operator: Petroleum Development Corporation Address: 1775 Sherman Street, Suite 3000 City: Denver State: CO Zip: 80203		Contact Name and Telephone Name: Brandon Bruns No: (303) 860-5800 Fax: (303) 860-5838	
API/Facility No: 05-123-22574 Facility Name: Pfenning 43, 44-31 Well Name: Pfenning		County: Weld Facility Number: Well Number: 44-31	
Location (QtrQtr, Sec, Twp, Rng, Meridian): SESE Sec 31 T7N R64W 6th PM Latitude: Longitude:			

TECHNICAL CONDITIONS

Type of Waste Causing Impact (crude oil, condensate, produced water, etc.): <u>Condensate and Produced Water</u>	
Site Conditions: Is location within a sensitive area (according to Rule 901e)? <input checked="" type="checkbox"/> Y <input type="checkbox"/> N If yes, attach evaluation. Groundwater <20 feet below ground surface.	
Adjacent land use (cultivated, irrigated, dry land farming, industrial, residential, etc.): <u>Agriculture</u>	
Soil type, if not previously identified on Form 2A or Federal Surface Use Plan: <u>Nelson fine sandy loam, 0 to 3 percent slopes</u>	
Potential receptors (water wells within 1/4 mi, surface waters, etc.): <u>Surface water is located 1,800' east of the site; a building is located 550' southeast of the site; a water well is located 1,015' southeast of the site; and depth to groundwater is 5' below ground surface (bgs).</u>	
Description of Impact (if previously provided, refer to that form or document):	
Impacted Media (check): <input checked="" type="checkbox"/> Soils <input type="checkbox"/> Vegetation <input checked="" type="checkbox"/> Groundwater <input type="checkbox"/> Surface water	Extent of Impact: <u>20' N-S x 105' E-W x 6' bgs</u> <u>See attached data</u>
How Determined: <u>Laboratory analysis and field screening of soil samples</u> <u>Laboratory analysis of groundwater samples</u>	

REMEDIALATION WORKPLAN

Describe initial action taken (if previously provided, refer to that form or document): A Form 19 was submitted on September 11, 2008 (Spill #1984344). A Form 27 was submitted on May 28 and July 20, 2009 (Remediation #4472).
Describe how source is to be removed: Described in previous Form 27.
Describe how remediation of existing impacts is to be accomplished, including removal and disposal at an injection well or licensed facility, land treatment on site, removal of impacted groundwater, insitu bioremediation, burning of oily vegetation, etc.: Described in previous Form 27.

State of Colorado
Oil and Gas Conservation Commission1120 Lincoln Street, Suite 801, Denver, Colorado
(303) 894-2100 Fax 894-2109

REMEDIAL WORKPLAN (CONT.)

OGCC Employee:

Axelson

Tracking Number: 1175664
Name of Operator: Petroleum Development Corporation
OGCC Operator No: 69175
Received Date: 8/12/11
Well Name & No: Pfenning 44-31
Facility Name & No.: Pfenning 43, 44-31

If groundwater has been impacted, describe proposed monitoring plan (# of wells or sample points, sampling schedule, analytical methods, etc.):

Monitoring wells MW01 through MW03 were installed at the site on September 24, 2008 (Figure 2). Following installation, each well was developed, purged, and sampled. Groundwater samples were collected from the wells and submitted for laboratory analysis of BTEX by EPA Method 8260B. Laboratory results indicated the benzene concentration in groundwater in monitoring well MW02 was not in compliance with the CDPHE Regulation 41 (Reg. 41) standard. Concentrations of the remaining analytes in MW02 and the BTEX concentrations in groundwater in monitoring wells MW01 and MW03 were in compliance with the Reg. 41 standards (Table 2). Due to difficulties in obtaining offsite access, the installation of a downgradient point of compliance (POC) monitoring well was delayed until April 22, 2009, when monitoring well MW04 installed. Following installation, the well was developed, purged, and sampled. A groundwater sample was collected from the well and submitted for laboratory analysis of BTEX by EPA Method 8260B. Laboratory results indicated the BTEX concentrations at monitoring well MW04 were below laboratory reporting limits and in compliance with the Reg. 41 standards. During the next quarterly sampling event in June 2009, an elevated benzene concentration was observed in monitoring well MW03, and additional downgradient POCs were scheduled for installation (Table 2). Monitoring wells MW05 through MW07 and replacement monitoring well MW04R were installed on August 6, 2009 (Figure 2). Following installation, each well was developed, purged, and sampled. Groundwater samples were collected from the wells and submitted for laboratory analysis of BTEX by EPA Method 8260B. Laboratory results indicated the BTEX concentrations in groundwater in monitoring wells MW04R through MW07 were below laboratory reporting limits and in compliance with the Reg. 41 standards (Table 2). The monitoring wells were sampled on a quarterly basis until April 2011, when it was determined that an additional POC was needed. Monitoring well MW08 was installed on April 13, 2011 (Figure 2). Following installation, the well was developed, purged, and sampled. A groundwater sample was collected from the well and submitted for laboratory analysis of BTEX by EPA Method 8260B. Laboratory results indicated the BTEX concentrations in groundwater in monitoring well MW08 were below laboratory reporting limits and in compliance with the Reg. 41 standards (Table 2). PDC will continue to monitor groundwater concentrations at the site until four consecutive quarters of groundwater analytical results in compliance with Reg. 41 standards are achieved.

PDC conducted enhanced fluid recovery (EFR) on June 30, 2011 to address groundwater impacts at MW01. EFR is an active remediation option that uses high vacuum to extract groundwater and soil gas from the subsurface. Following EFR, sampling on July 5, 2011 indicated the benzene concentration in MW01 had decreased to below Table 910-1 concentration levels. PDC will continue to monitor groundwater concentrations at the site until four consecutive quarters of groundwater analytical results in compliance with Reg. 41 standards are achieved.

Describe reclamation plan. Discuss existing and new grade recontouring; method and testing of compaction alleviation; and reseeding program, including location of new seed, seed mix and noxious weed prevention. Attach diagram or drawing. Use additional sheet for description if required.

The site was restored to pre-release grade. PDC's production facility remains at the site.

Attach samples and analytical results taken to verify remediation of impacts. Show locations of samples on an onsite schematic or drawing.

Is further site investigation required? ☒ Y ☐ N If yes, describe:

Laboratory results from the most recent quarterly sampling event indicate the benzene concentration in groundwater in monitoring well MW01 is not in compliance with the Reg. 41 Standard. Concentrations of the remaining analytes in MW01 and the BTEX concentrations at monitoring wells MW02 through MW08 were below laboratory reporting limits and in compliance with the Reg. 41 Standards (Table 2). PDC will continue to monitor groundwater concentrations at the site until four consecutive quarters of groundwater analytical results in compliance with Reg. 41 standards are achieved.

Final disposition of E&P waste (landtreated and disposed onsite, name of licensed disposal facility, recycling, reuse, etc.):

Described in previous Form 27.

IMPLEMENTATION SCHEDULE

Date Site Investigation Began:	<u>9/4/2008</u>	Date Site Investigation Completed:	<u>TBD</u>	Remediation Plan Submitted:	<u>8/12/2011</u>
Remediation Start Date:	<u>9/8/2008</u>	Anticipated Completion Date:	<u>NA</u>	Actual Completion Date:	<u>TBD</u>

I hereby certify that the statements made in this form are, to the best of my knowledge, true, correct, and complete.

Print Name: Brandon Bruns

Signed:

Title:

Environmental Field Coordinator



Date:

8/12/2011

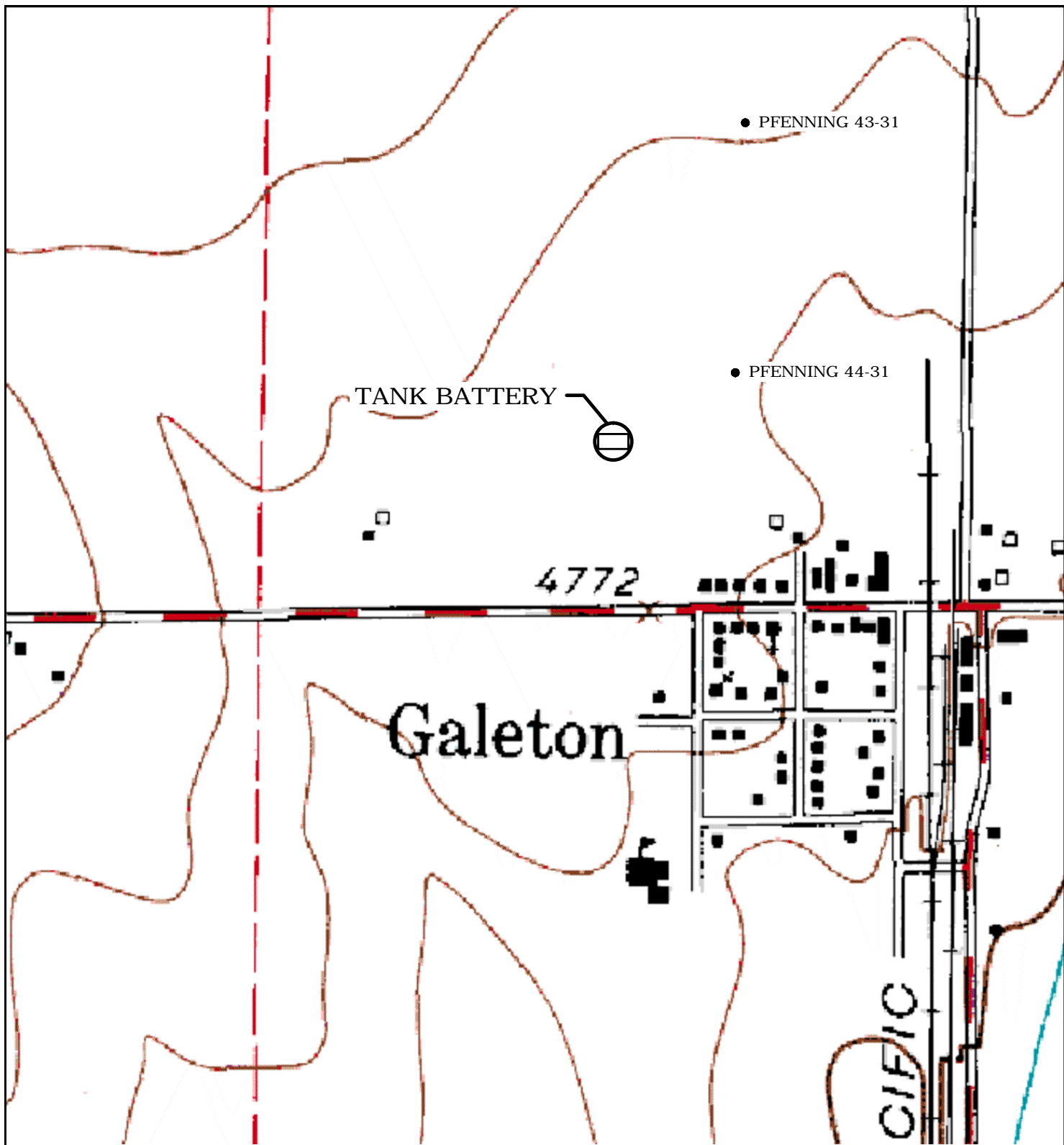
COGCC Approval: EPS 8/16/11



LEGEND

-  TANK BATTERY
-  WELL LOCATION

SOURCE: TOPOZONE.COM
USGS 7.5' QUADRANGLE
(NAD27)

FIGURE 1
SITE LOCATION MAP
PFENNING #43 & 44-31
SESE 31 7N 64W
WELD COUNTY, CO
PETROLEUM DEVELOPMENT CORPORATION



PDC0815901-SL 9/08

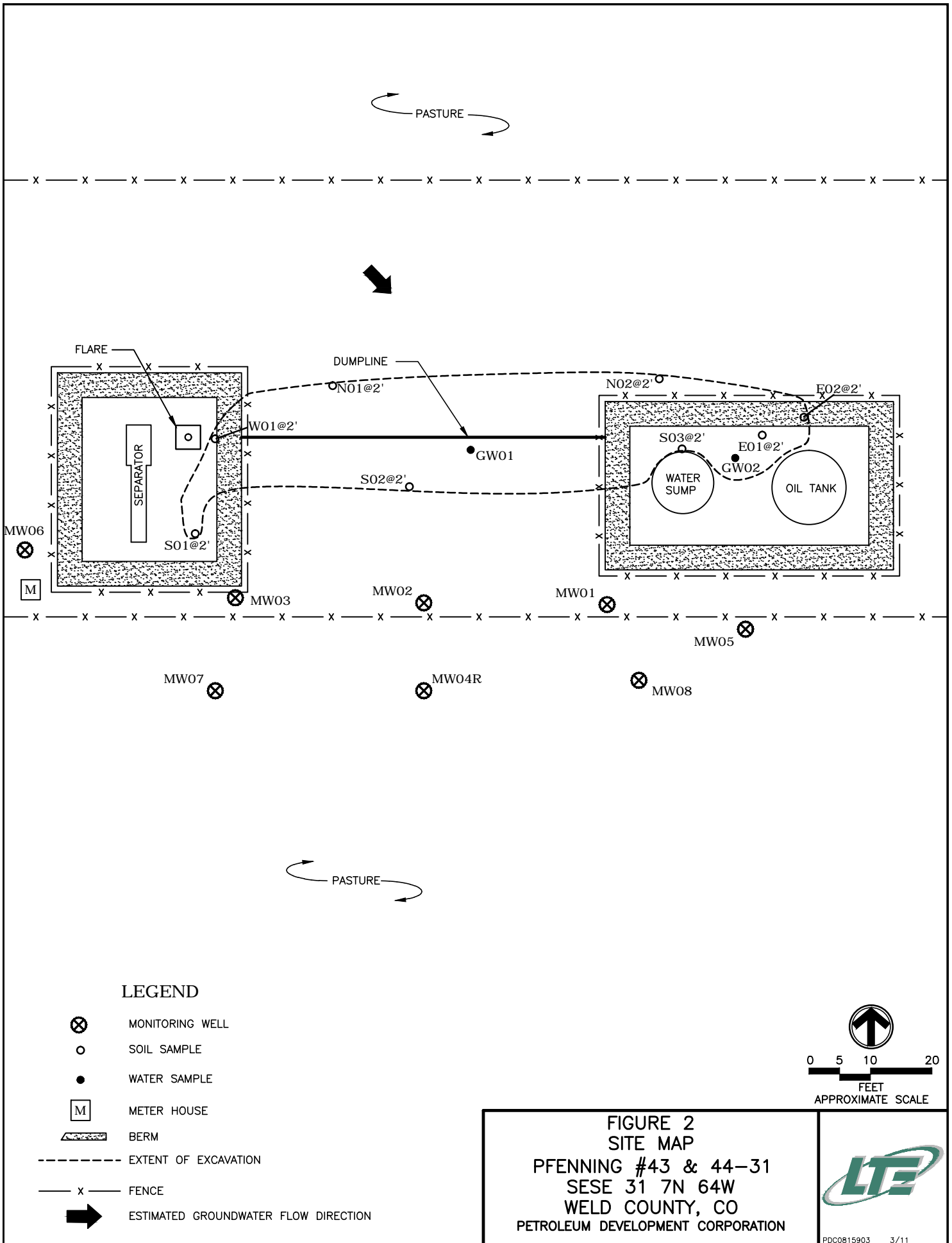

TABLE 1
SOIL SAMPLE ANALYTICAL RESULTS
PFENNING 43 & 44-31 (API No. 05-123-22574)
WELD COUNTY
PETROLEUM DEVELOPMENT CORPORATION

Sample ID	Depth (ft bgs)	Date Sampled	Benzene (mg/kg)	Toluene (mg/kg)	Ethyl- benzene (mg/kg)	Xylenes (mg/kg)	TPH (mg/kg)
E01	2	09/05/2008	NA	NA	NA	NA	<100
E02	2	09/08/2008	NA	NA	NA	NA	<100
N01	2	09/04/2008	NA	NA	NA	NA	265
		09/05/2008	NA	NA	NA	NA	<100
S01	2	09/04/2008	NA	NA	NA	NA	930
S02	2	09/05/2008	NA	NA	NA	NA	<100
S03	2	09/05/2008	NA	NA	NA	NA	<100
W01	2	09/04/2008	NA	NA	NA	NA	360
COGCC Sensitive Area Standard			NS	NS	NS	NS	1000

Notes: < - less than stated laboratory reporting limit

TPH - Total Petroleum Hydrocarbons (C6-C28)

API - American Petroleum Institute

Bold numbers indicate result equalled or exceeded standard.

COGCC Sensitive Area Standard is taken from COGCC Table 910-1, prior to April 1, 2009.

NA - Not Analyzed

NS - No Standard

mg/kg - milligrams per kilogram

ft bgs - feet below ground surface



TABLE 2
GROUNDWATER ANALYTICAL RESULTS AND FIELD PARAMETERS
PFENNING 43 & 44-31 (API No. 05-123-22574)
WELD COUNTY, COLORADO
PETROLEUM DEVELOPMENT CORPORATION

Sample ID	Date Sampled	Benzene (ug/L)	Toluene (ug/L)	Ethyl-benzene (ug/L)	Xylenes (ug/L)	Depth to Water (ft btoc)
GW01	09/05/2008	390	13	3.7	190	NM
GW02	09/08/2008	900	28	<1.0	75	NM
MW01	09/25/2008	<1.0	<1.0	1.4	4.5	NM
	12/23/2008	<1.0	<1.0	<1.0	<1.0	7.91
	03/19/2009	<1.0	<1.0	<1.0	<1.0	7.56
	06/18/2009	<1.0	<1.0	<1.0	<1.0	5.85
	09/23/2009	<1.0	<1.0	<1.0	<1.0	4.78
	12/09/2009	<1.0	<1.0	<1.0	<1.0	5.91
	03/18/2010	220	<1.0	<1.0	1.0	5.50
	06/23/2010	740	<1.0	<1.0	2.4	4.73
	09/08/2010	200	<1.0	<1.0	<1.0	5.80
	12/07/2010	450	<1.0	<1.0	<1.0	7.58
	03/03/2011	100	<1.0	<1.0	<1.0	7.70
	06/06/2011	7.4	<1.0	<1.0	<1.0	5.06
	07/05/2011	1.2	<1.0	<1.0	<1.0	NM
MW02	09/25/2008	36	<1.0	<1.0	3.6	NM
	12/23/2008	60	<1.0	<1.0	<1.0	6.65
	03/19/2009	110	<1.0	<1.0	<1.0	7.11
	06/18/2009	<1.0	<1.0	<1.0	<1.0	5.52
	09/23/2009	6.8	<1.0	<1.0	<1.0	4.95
	12/09/2009	<1.0	<1.0	<1.0	<1.0	5.46
	03/18/2010	<1.0	<1.0	<1.0	<1.0	5.51
	06/23/2010	<1.0	<1.0	<1.0	<1.0	4.51
	09/08/2010	<1.0	<1.0	<1.0	<1.0	5.56
	12/07/2010	<1.0	<1.0	<1.0	<1.0	7.26
	03/03/2011	<1.0	<1.0	<1.0	<1.0	7.24
	06/06/2011	<1.0	<1.0	<1.0	<1.0	4.75
MW03	09/25/2008	<1.0	<1.0	<1.0	11	NM
	12/23/2008	<1.0	<1.0	<1.0	<1.0	7.22
	03/19/2009	<1.0	<1.0	<1.0	<1.0	7.38
	06/18/2009	230	<1.0	<1.0	<1.0	5.55
	09/23/2009	31	<1.0	<1.0	<1.0	5.83
	12/09/2009	23	<1.0	<1.0	<1.0	5.76
	03/18/2010	<1.0	<1.0	<1.0	<1.0	5.16
	06/23/2010	<1.0	<1.0	<1.0	<1.0	4.87
	09/08/2010	<1.0	<1.0	<1.0	<1.0	6.10



TABLE 2 (Continued)
GROUNDWATER ANALYTICAL RESULTS AND FIELD PARAMETERS
PFENNING 43 & 44-31 (API No. 05-123-22574)
WELD COUNTY, COLORADO
PETROLEUM DEVELOPMENT CORPORATION

Sample ID	Date Sampled	Benzene (ug/L)	Toluene (ug/L)	Ethyl-benzene (ug/L)	Xylenes (ug/L)	Depth to Water (ft btoc)
MW03	12/07/2010	<1.0	<1.0	<1.0	<1.0	7.75
	03/03/2011	<1.0	<1.0	<1.0	<1.0	7.60
	06/06/2011	<1.0	<1.0	<1.0	<1.0	5.04
MW04	04/23/2009	<1.0	<1.0	<1.0	<1.0	4.31
	06/18/2009	<1.0	<1.0	<1.0	<1.0	5.90
	09/23/2009	<1.0	<1.0	<1.0	<1.0	2.96
	12/09/2009	<1.0	<1.0	<1.0	<1.0	3.20
	03/18/2010	<1.0	<1.0	<1.0	<1.0	2.98
	06/23/2010	<1.0	<1.0	<1.0	<1.0	2.45
	09/08/2010	<1.0	<1.0	<1.0	<1.0	3.26
	12/07/2010	<1.0	<1.0	<1.0	<1.0	NM
	03/03/2011	<1.0	<1.0	<1.0	<1.0	NM
	06/06/2011	<1.0	<1.0	<1.0	<1.0	NM
MW04R	08/07/2009	<1.0	<1.0	<1.0	<1.0	NM
MW05	08/07/2009	<1.0	<1.0	<1.0	<1.0	NM
	09/23/2009	<1.0	<1.0	<1.0	<1.0	1.94
	12/09/2009	<1.0	<1.0	<1.0	<1.0	3.27
	03/18/2010	<1.0	<1.0	<1.0	<1.0	3.05
	06/23/2010	<1.0	<1.0	<1.0	<1.0	2.27
	09/08/2010	<1.0	<1.0	<1.0	<1.0	2.83
	12/07/2010	<1.0	<1.0	<1.0	<1.0	4.94
	03/03/2011	<1.0	<1.0	<1.0	<1.0	5.23
	06/06/2011	<1.0	<1.0	<1.0	<1.0	2.68
MW06	08/07/2009	<1.0	<1.0	<1.0	<1.0	NM
	09/23/2009	<1.0	<1.0	<1.0	<1.0	6.00
	12/09/2009	<1.0	<1.0	<1.0	<1.0	6.45
	03/18/2010	<1.0	<1.0	<1.0	<1.0	5.62
	06/23/2010	<1.0	<1.0	<1.0	<1.0	5.48
	09/08/2010	<1.0	<1.0	<1.0	<1.0	7.00
	12/07/2010	<1.0	<1.0	<1.0	<1.0	8.83
	03/03/2011	<1.0	<1.0	<1.0	<1.0	8.46
	06/06/2011	<1.0	<1.0	<1.0	<1.0	5.85
MW07	08/07/2009	<1.0	<1.0	<1.0	<1.0	NM
	09/23/2009	200	<1.0	<1.0	<1.0	3.54
	12/09/2009	380	<1.0	<1.0	<1.0	3.34
	03/18/2010	1.4	<1.0	<1.0	<1.0	2.74



TABLE 2 (Continued)
GROUNDWATER ANALYTICAL RESULTS AND FIELD PARAMETERS
PFENNING 43 & 44-31 (API No. 05-123-22574)
WELD COUNTY, COLORADO
PETROLEUM DEVELOPMENT CORPORATION

Sample ID	Date Sampled	Benzene (ug/L)	Toluene (ug/L)	Ethyl-benzene (ug/L)	Xylenes (ug/L)	Depth to Water (ft btoc)
MW07	06/23/2010	22	<1.0	<1.0	<1.0	2.53
	09/08/2010	<1.0	<1.0	<1.0	<1.0	3.76
	12/07/2010	<1.0	<1.0	<1.0	<1.0	5.25
	03/03/2011	<1.0	<1.0	<1.0	<1.0	5.02
	06/06/2011	<1.0	<1.0	<1.0	<1.0	2.74
MW08	04/15/2011	<1.0	<1.0	<1.0	<1.0	4.56
	06/06/2011	<1.0	<1.0	<1.0	<1.0	2.54
Basic Standards for Groundwater:		5	560	700	1400	

Notes:

< - less than

ug/L - micrograms per Liter

NA - Not Analyzed/Not Available

NM - Not measured

API - American Petroleum Institute

ft btoc - feet below top of casing

Basic Standards for Groundwater are taken from the Colorado Department of Health and Environment - Water Quality Control Commission Regulation 41, effective 4/1/2009.

Bold numbers indicate result equaled or exceeded standard.



Summit Scientific

741 Corporate Circle – Suite I ♦ Golden, Colorado 80401

303.277.9310 - laboratory ♦ 303.277.9531 - fax

October 05, 2009

John Peterson
LT Environmental, Inc.
4600 West 60th Avenue
Arvada, CO 80003
RE: PDC - Pfenning # 43 & 44-31

Enclosed are the results of analyses for samples received by Summit Scientific on 09/23/09 16:00. If you have any questions concerning this report, please feel free to contact me.

Sincerely,

A handwritten signature in black ink, appearing to be 'PS' followed by a long, sweeping horizontal line.

Paul Shrewsbury For Ben Shrewsbury
President / Laboratory Director



LT Environmental, Inc.
4600 West 60th Avenue
Arvada CO, 80003

Project: PDC - Pfenning # 43 & 44-31

Project Number: PDC 08159
Project Manager: John Peterson

Reported:
10/05/09 11:31

ANALYTICAL REPORT FOR SAMPLES

Sample ID	Laboratory ID	Matrix	Date Sampled	Date Received
MW01	R909138-01	Water	09/23/09 11:35	09/23/09 16:00
MW02	R909138-02	Water	09/23/09 11:25	09/23/09 16:00
MW03	R909138-03	Water	09/23/09 11:15	09/23/09 16:00
MW04	R909138-04	Water	09/23/09 10:55	09/23/09 16:00
MW05	R909138-05	Water	09/23/09 10:45	09/23/09 16:00
MW06	R909138-06	Water	09/23/09 11:45	09/23/09 16:00
MW07	R909138-07	Water	09/23/09 11:05	09/23/09 16:00

Summit Scientific

The results in this report apply to the samples analyzed in accordance with the chain of custody document. This analytical report must be reproduced in its entirety.

LT Environmental, Inc.
4600 West 60th Avenue
Arvada CO, 80003

Project: PDC - Pfenning # 43 & 44-31

Project Number: PDC 08159
Project Manager: John Peterson

Reported:
10/05/09 11:31

Summit Scientific 2909138

52

741 Corporate Circle Suite I ♦ Golden, Colorado 80401
303-277-9310 ♦ 303-277-9531 Fax

Page 1 of 1

Client: LT Environmental, Inc.

Address: 4600 West 60th Avenue

City/State/Zip: Arvada CO 80003

Phone: (303) 433-9788

File No. (202) 455-7160

Complainant Name: Susan B.

Sampler Name: Sara Burkholder

Project Manager: John Peterson

E-Mail: ipeterson@ltenv.com

Project Name: Penning 43 + 44-3

Project Number: PDC08459

[illegible]

www.s2scientific.com

Summit Scientific

The results in this report apply to the samples analyzed in accordance with the chain of custody document. This analytical report must be reproduced in its entirety.



LT Environmental, Inc.
4600 West 60th Avenue
Arvada CO, 80003

Project: PDC - Pfenning # 43 & 44-31

Project Number: PDC 08159
Project Manager: John Peterson

Reported:
10/05/09 11:31

MW01
R909138-01 (Water)

Summit Scientific

Volatile Organic Compounds by EPA Method 8260B

Date Sampled: **09/23/09 11:35**

Analyte	Result	Reporting		Units	Dilution	Batch	Prepared	Analyzed	Method	Notes
		Limit								
Benzene	ND	1.0		ug/l	1	9092901	09/29/09	09/30/09	EPA 8260B	
Toluene	ND	1.0		"	"	"	"	"	"	
Ethylbenzene	ND	1.0		"	"	"	"	"	"	
Xylenes (total)	ND	1.0		"	"	"	"	"	"	

Date Sampled: **09/23/09 11:35**

Analyte	Result	Reporting		Units	Dilution	Batch	Prepared	Analyzed	Method	Notes
		Limit								
Surrogate: 1,2-Dichloroethane-d4		83.4 %		74.3-129		"	"	"	"	
Surrogate: Toluene-d8		101 %		87.7-110		"	"	"	"	
Surrogate: 4-Bromofluorobenzene		101 %		83.5-115		"	"	"	"	

Summit Scientific

The results in this report apply to the samples analyzed in accordance with the chain of custody document. This analytical report must be reproduced in its entirety.



LT Environmental, Inc.
4600 West 60th Avenue
Arvada CO, 80003

Project: PDC - Pfenning # 43 & 44-31

Project Number: PDC 08159
Project Manager: John Peterson

Reported:
10/05/09 11:31

MW02
R909138-02 (Water)

Summit Scientific

Volatile Organic Compounds by EPA Method 8260B

Date Sampled: **09/23/09 11:25**

Analyte	Result	Reporting		Units	Dilution	Batch	Prepared	Analyzed	Method	Notes
		Limit								
Benzene	6.8	1.0		ug/l	1	9092901	09/29/09	09/30/09	EPA 8260B	
Toluene	ND	1.0		"	"	"	"	"	"	
Ethylbenzene	ND	1.0		"	"	"	"	"	"	
Xylenes (total)	ND	1.0		"	"	"	"	"	"	

Date Sampled: **09/23/09 11:25**

Analyte	Result	Reporting		Units	Dilution	Batch	Prepared	Analyzed	Method	Notes
		Limit								
<i>Surrogate: 1,2-Dichloroethane-d4</i>		80.6 %		74.3-129		"	"	"	"	
<i>Surrogate: Toluene-d8</i>		97.7 %		87.7-110		"	"	"	"	
<i>Surrogate: 4-Bromofluorobenzene</i>		98.9 %		83.5-115		"	"	"	"	

Summit Scientific

The results in this report apply to the samples analyzed in accordance with the chain of custody document. This analytical report must be reproduced in its entirety.



LT Environmental, Inc.
4600 West 60th Avenue
Arvada CO, 80003

Project: PDC - Pfenning # 43 & 44-31

Project Number: PDC 08159
Project Manager: John Peterson

Reported:
10/05/09 11:31

MW03
R909138-03 (Water)

Summit Scientific

Volatile Organic Compounds by EPA Method 8260B

Date Sampled: **09/23/09 11:15**

Analyte	Result	Reporting		Units	Dilution	Batch	Prepared	Analyzed	Method	Notes
		Limit								
Benzene	31	1.0		ug/l	1	9092901	09/29/09	09/30/09	EPA 8260B	
Toluene	ND	1.0		"	"	"	"	"	"	
Ethylbenzene	ND	1.0		"	"	"	"	"	"	
Xylenes (total)	ND	1.0		"	"	"	"	"	"	

Date Sampled: **09/23/09 11:15**

Analyte	Result	Reporting		Units	Dilution	Batch	Prepared	Analyzed	Method	Notes
		Limit								
<i>Surrogate: 1,2-Dichloroethane-d4</i>		86.7 %		74.3-129		"	"	"	"	
<i>Surrogate: Toluene-d8</i>		99.8 %		87.7-110		"	"	"	"	
<i>Surrogate: 4-Bromofluorobenzene</i>		99.3 %		83.5-115		"	"	"	"	

Summit Scientific

The results in this report apply to the samples analyzed in accordance with the chain of custody document. This analytical report must be reproduced in its entirety.



LT Environmental, Inc.
4600 West 60th Avenue
Arvada CO, 80003

Project: PDC - Pfenning # 43 & 44-31

Project Number: PDC 08159
Project Manager: John Peterson

Reported:
10/05/09 11:31

MW04
R909138-04 (Water)

Summit Scientific

Volatile Organic Compounds by EPA Method 8260B

Date Sampled: **09/23/09 10:55**

Analyte	Result	Reporting		Units	Dilution	Batch	Prepared	Analyzed	Method	Notes
		Limit								
Benzene	ND	1.0		ug/l	1	9092901	09/29/09	09/30/09	EPA 8260B	
Toluene	ND	1.0		"	"	"	"	"	"	
Ethylbenzene	ND	1.0		"	"	"	"	"	"	
Xylenes (total)	ND	1.0		"	"	"	"	"	"	

Date Sampled: **09/23/09 10:55**

Analyte	Result	Reporting		Units	Dilution	Batch	Prepared	Analyzed	Method	Notes
		Limit								
Surrogate: 1,2-Dichloroethane-d4		74.3 %		74.3-129		"	"	"	"	
Surrogate: Toluene-d8		95.7 %		87.7-110		"	"	"	"	
Surrogate: 4-Bromofluorobenzene		99.5 %		83.5-115		"	"	"	"	

Summit Scientific

The results in this report apply to the samples analyzed in accordance with the chain of custody document. This analytical report must be reproduced in its entirety.



LT Environmental, Inc.
4600 West 60th Avenue
Arvada CO, 80003

Project: PDC - Pfenning # 43 & 44-31

Project Number: PDC 08159
Project Manager: John Peterson

Reported:
10/05/09 11:31

MW05
R909138-05 (Water)

Summit Scientific

Volatile Organic Compounds by EPA Method 8260B

Date Sampled: **09/23/09 10:45**

Analyte	Result	Reporting		Units	Dilution	Batch	Prepared	Analyzed	Method	Notes
		Limit								
Benzene	ND	1.0		ug/l	1	9092901	09/29/09	09/30/09	EPA 8260B	
Toluene	ND	1.0		"	"	"	"	"	"	
Ethylbenzene	ND	1.0		"	"	"	"	"	"	
Xylenes (total)	ND	1.0		"	"	"	"	"	"	

Date Sampled: **09/23/09 10:45**

Analyte	Result	Reporting		Units	Dilution	Batch	Prepared	Analyzed	Method	Notes
		Limit								
Surrogate: 1,2-Dichloroethane-d4		81.5 %		74.3-129		"	"	"	"	
Surrogate: Toluene-d8		98.0 %		87.7-110		"	"	"	"	
Surrogate: 4-Bromofluorobenzene		102 %		83.5-115		"	"	"	"	

Summit Scientific

The results in this report apply to the samples analyzed in accordance with the chain of custody document. This analytical report must be reproduced in its entirety.



LT Environmental, Inc.
4600 West 60th Avenue
Arvada CO, 80003

Project: PDC - Pfenning # 43 & 44-31

Project Number: PDC 08159
Project Manager: John Peterson

Reported:
10/05/09 11:31

MW06
R909138-06 (Water)

Summit Scientific

Volatile Organic Compounds by EPA Method 8260B

Date Sampled: **09/23/09 11:45**

Analyte	Result	Reporting		Units	Dilution	Batch	Prepared	Analyzed	Method	Notes
		Limit								
Benzene	ND	1.0		ug/l	1	9092901	09/29/09	09/30/09	EPA 8260B	
Toluene	ND	1.0		"	"	"	"	"	"	
Ethylbenzene	ND	1.0		"	"	"	"	"	"	
Xylenes (total)	ND	1.0		"	"	"	"	"	"	

Date Sampled: **09/23/09 11:45**

Analyte	Result	Reporting		Units	Dilution	Batch	Prepared	Analyzed	Method	Notes
		Limit								
Surrogate: 1,2-Dichloroethane-d4		77.6 %		74.3-129		"	"	"	"	
Surrogate: Toluene-d8		96.2 %		87.7-110		"	"	"	"	
Surrogate: 4-Bromofluorobenzene		99.4 %		83.5-115		"	"	"	"	

Summit Scientific

The results in this report apply to the samples analyzed in accordance with the chain of custody document. This analytical report must be reproduced in its entirety.



LT Environmental, Inc.
4600 West 60th Avenue
Arvada CO, 80003

Project: PDC - Pfenning # 43 & 44-31

Project Number: PDC 08159
Project Manager: John Peterson

Reported:
10/05/09 11:31

MW07
R909138-07 (Water)

Summit Scientific

Volatile Organic Compounds by EPA Method 8260B

Date Sampled: **09/23/09 11:05**

Analyte	Result	Reporting		Units	Dilution	Batch	Prepared	Analyzed	Method	Notes
		Limit								
Benzene	200	1.0		ug/l	1	9092901	09/29/09	09/30/09	EPA 8260B	
Toluene	ND	1.0		"	"	"	"	"	"	
Ethylbenzene	ND	1.0		"	"	"	"	"	"	
Xylenes (total)	ND	1.0		"	"	"	"	"	"	

Date Sampled: **09/23/09 11:05**

Analyte	Result	Reporting		Units	Dilution	Batch	Prepared	Analyzed	Method	Notes
		Limit								
<i>Surrogate: 1,2-Dichloroethane-d4</i>		81.9 %		74.3-129		"	"	"	"	
<i>Surrogate: Toluene-d8</i>		101 %		87.7-110		"	"	"	"	
<i>Surrogate: 4-Bromofluorobenzene</i>		103 %		83.5-115		"	"	"	"	

Summit Scientific

The results in this report apply to the samples analyzed in accordance with the chain of custody document. This analytical report must be reproduced in its entirety.



LT Environmental, Inc.
4600 West 60th Avenue
Arvada CO, 80003

Project: PDC - Pfenning # 43 & 44-31

Project Number: PDC 08159
Project Manager: John Peterson

Reported:
10/05/09 11:31

Volatile Organic Compounds by EPA Method 8260B - Quality Control

Summit Scientific

Reporting				Spike	Source		%REC		RPD	
Analyte	Result	Limit	Units	Level	Result	%REC	Limits	RPD	Limit	Notes

Batch 9092901 - EPA 5030 Water MS

Blank (9092901-BLK1)

Prepared: 09/29/09 Analyzed: 09/30/09

Benzene	ND	1.0	ug/l							
Toluene	ND	1.0	"							
Ethylbenzene	ND	1.0	"							
Xylenes (total)	ND	1.0	"							
Surrogate: 1,2-Dichloroethane-d4	11.0		"	13.3		82.6	74.3-129			
Surrogate: Toluene-d8	13.3		"	13.3		99.7	87.7-110			
Surrogate: 4-Bromofluorobenzene	13.2		"	13.3		99.2	83.5-115			

Blank (9092901-BLK2)

Prepared: 09/29/09 Analyzed: 09/30/09

Benzene	ND	1.0	ug/l							
Toluene	ND	1.0	"							
Ethylbenzene	ND	1.0	"							
Xylenes (total)	ND	1.0	"							
Surrogate: 1,2-Dichloroethane-d4	10.8		"	13.3		81.1	74.3-129			
Surrogate: Toluene-d8	13.3		"	13.3		99.6	87.7-110			
Surrogate: 4-Bromofluorobenzene	13.3		"	13.3		99.5	83.5-115			

LCS (9092901-BS1)

Prepared: 09/29/09 Analyzed: 09/30/09

Benzene	29.3	1.0	ug/l	33.3		87.8	70-114		8.14	
Toluene	29.3	1.0	"	33.3		87.8	72.7-116		7.88	
Surrogate: 1,2-Dichloroethane-d4	11.0		"	13.3		82.5	74.3-129			
Surrogate: Toluene-d8	13.4		"	13.3		100	87.7-110			
Surrogate: 4-Bromofluorobenzene	13.5		"	13.3		101	83.5-115			

LCS (9092901-BS2)

Prepared: 09/29/09 Analyzed: 09/30/09

Benzene	29.3	1.0	ug/l	33.3		87.8	70-114		8.14	
Toluene	29.2	1.0	"	33.3		87.5	72.7-116		7.88	
Surrogate: 1,2-Dichloroethane-d4	11.3		"	13.3		84.7	74.3-129			
Surrogate: Toluene-d8	13.3		"	13.3		99.5	87.7-110			
Surrogate: 4-Bromofluorobenzene	13.3		"	13.3		100	83.5-115			

Summit Scientific

The results in this report apply to the samples analyzed in accordance with the chain of custody document. This analytical report must be reproduced in its entirety.



LT Environmental, Inc.
4600 West 60th Avenue
Arvada CO, 80003

Project: PDC - Pfenning # 43 & 44-31

Project Number: PDC 08159
Project Manager: John Peterson

Reported:
10/05/09 11:31

Volatile Organic Compounds by EPA Method 8260B - Quality Control
Summit Scientific

Analyte	Reporting			Spike	Source		%REC		RPD	
	Result	Limit	Units	Level	Result	%REC	Limits	RPD	Limit	Notes

Batch 9092901 - EPA 5030 Water MS

LCS Dup (9092901-BSD1)

Prepared: 09/29/09 Analyzed: 09/30/09

Benzene	30.4	1.0	ug/l	33.3		91.2	70-114	3.82	8.14	
Toluene	30.1	1.0	"	33.3		90.2	72.7-116	2.70	7.88	
Surrogate: 1,2-Dichloroethane-d4	11.2		"	13.3		84.4	74.3-129			
Surrogate: Toluene-d8	13.4		"	13.3		101	87.7-110			
Surrogate: 4-Bromofluorobenzene	13.2		"	13.3		98.9	83.5-115			

LCS Dup (9092901-BSD2)

Prepared: 09/29/09 Analyzed: 09/30/09

Benzene	30.3	1.0	ug/l	33.3		90.8	70-114	3.39	8.14	
Toluene	30.0	1.0	"	33.3		89.9	72.7-116	2.71	7.88	
Surrogate: 1,2-Dichloroethane-d4	11.4		"	13.3		85.6	74.3-129			
Surrogate: Toluene-d8	13.6		"	13.3		102	87.7-110			
Surrogate: 4-Bromofluorobenzene	13.0		"	13.3		97.5	83.5-115			

Matrix Spike (9092901-MS1)

Source: R909171-01

Prepared: 09/29/09 Analyzed: 09/30/09

Benzene	30.8	1.0	ug/l	33.3	ND	92.6	66.8-117		17.8	
Toluene	30.4	1.0	"	33.3	ND	91.3	71.5-117		14.4	
Surrogate: 1,2-Dichloroethane-d4	11.0		"	13.3		82.4	74.3-129			
Surrogate: Toluene-d8	13.3		"	13.3		99.9	87.7-110			
Surrogate: 4-Bromofluorobenzene	13.1		"	13.3		98.0	83.5-115			

Matrix Spike (9092901-MS2)

Source: R909171-01

Prepared: 09/29/09 Analyzed: 09/30/09

Benzene	30.2	1.0	ug/l	33.3	ND	90.8	66.8-117		17.8	
Toluene	29.7	1.0	"	33.3	ND	89.0	71.5-117		14.4	
Surrogate: 1,2-Dichloroethane-d4	11.3		"	13.3		84.5	74.3-129			
Surrogate: Toluene-d8	13.6		"	13.3		102	87.7-110			
Surrogate: 4-Bromofluorobenzene	13.4		"	13.3		101	83.5-115			

Matrix Spike Dup (9092901-MSD1)

Source: R909171-01

Prepared: 09/29/09 Analyzed: 09/30/09

Benzene	29.8	1.0	ug/l	33.3	ND	89.3	66.8-117	3.63	17.8	
Toluene	29.2	1.0	"	33.3	ND	87.5	71.5-117	4.23	14.4	
Surrogate: 1,2-Dichloroethane-d4	11.0		"	13.3		82.6	74.3-129			
Surrogate: Toluene-d8	13.7		"	13.3		103	87.7-110			
Surrogate: 4-Bromofluorobenzene	13.2		"	13.3		99.3	83.5-115			

Summit Scientific

The results in this report apply to the samples analyzed in accordance with the chain of custody document. This analytical report must be reproduced in its entirety.



LT Environmental, Inc.
4600 West 60th Avenue
Arvada CO, 80003

Project: PDC - Pfenning # 43 & 44-31

Project Number: PDC 08159
Project Manager: John Peterson

Reported:
10/05/09 11:31

Volatile Organic Compounds by EPA Method 8260B - Quality Control
Summit Scientific

Analyte	Reporting			Spike	Source		%REC		RPD	
	Result	Limit	Units	Level	Result	%REC	Limits	RPD	Limit	Notes

Batch 9092901 - EPA 5030 Water MS

Matrix Spike Dup (9092901-MSD2)		Source: R909171-01			Prepared: 09/29/09		Analyzed: 09/30/09			
Benzene	30.2	1.0	ug/l	33.3	ND	90.6	66.8-117	0.165	17.8	
Toluene	29.5	1.0	"	33.3	ND	88.5	71.5-117	0.575	14.4	
Surrogate: 1,2-Dichloroethane-d4	10.7		"	13.3		80.0	74.3-129			
Surrogate: Toluene-d8	13.2		"	13.3		99.4	87.7-110			
Surrogate: 4-Bromofluorobenzene	13.3		"	13.3		100	83.5-115			

Summit Scientific

The results in this report apply to the samples analyzed in accordance with the chain of custody document. This analytical report must be reproduced in its entirety.



LT Environmental, Inc.
4600 West 60th Avenue
Arvada CO, 80003

Project: PDC - Pfenning # 43 & 44-31

Project Number: PDC 08159
Project Manager: John Peterson

Reported:
10/05/09 11:31

Notes and Definitions

DET Analyte DETECTED
ND Analyte NOT DETECTED at or above the reporting limit
NR Not Reported
dry Sample results reported on a dry weight basis
RPD Relative Percent Difference

Summit Scientific

A handwritten signature in black ink, appearing to be 'JM' followed by a long horizontal stroke.

The results in this report apply to the samples analyzed in accordance with the chain of custody document. This analytical report must be reproduced in its entirety.

Summit Scientific

741 Corporate Circle – Suite I ♦ Golden, Colorado 80401

303.277.9310 - laboratory ♦ 303.277.9531 - fax

June 28, 2010

Brian Dodek

LT Environmental, Inc.

4600 West 60th Avenue

Arvada, CO 80003

RE: PDC - Pfenning # 43 & 44-31

Enclosed are the results of analyses for samples received by Summit Scientific on 06/23/10 17:00. If you have any questions concerning this report, please feel free to contact me.

Sincerely,

A handwritten signature in blue ink, appearing to be 'LS' followed by a long horizontal stroke.

Logan Shrewsbury For Ben Shrewsbury
President / Laboratory Director



LT Environmental, Inc.
4600 West 60th Avenue
Arvada CO, 80003

Project: PDC - Pfenning # 43 & 44-31

Project Number: PDC 08159
Project Manager: Brian Dodek

Reported:
06/28/10 14:11

ANALYTICAL REPORT FOR SAMPLES

Sample ID	Laboratory ID	Matrix	Date Sampled	Date Received
MW01	R006137-01	Water	06/23/10 13:20	06/23/10 17:00
MW02	R006137-02	Water	06/23/10 13:25	06/23/10 17:00
MW03	R006137-03	Water	06/23/10 13:30	06/23/10 17:00
MW04	R006137-04	Water	06/23/10 13:35	06/23/10 17:00
MW05	R006137-05	Water	06/23/10 13:40	06/23/10 17:00
MW06	R006137-06	Water	06/23/10 13:45	06/23/10 17:00
MW07	R006137-07	Water	06/23/10 13:50	06/23/10 17:00

Summit Scientific

The results in this report apply to the samples analyzed in accordance with the chain of custody document. This analytical report must be reproduced in its entirety.



LT Environmental, Inc.
4600 West 60th Avenue
Arvada CO, 80003

Project: PDC - Pfenning # 43 & 44-31

Project Number: PDC 08159
Project Manager: Brian Dodek

Reported:
06/28/10 14:11

Summit Scientific R006137

741 Corporate Circle Suite 1 • Golden, Colorado 80401
303-277-9310 • 303-277-9531 Fax

Page 1 of 1

Client: LT Environmental, Inc.
Address: 4600 West 60th Avenue
City/State/Zip: Arvada, CO 80003
Phone: (303) 433-9788
Sampler Name: J. Dodek
Project Manager: Brian Dodek
E-Mail: bdodek@ltenv.com
Project Name: PDC 08159
Project Number: PDC 08159

Sample Description	Date Sampled	Time Sampled	Number of Containers	Preservative				Matrix			Analyze For:						Special Instructions														
				HCl	HNO ₃	None	Other (Specify)	Groundwater	Soil	Air - Canister Serial #	Other (Specify)	DRO	GBTEX	BTEX	Table 9.10 Full	Table 9.10 Short		pH / EC	SAR												
MW001	6/23	1330	3	X				X																							
MW002	6/23	1325	3	X				X																							
MW003	6/23	1330	3	X				X																							
MW004	6/23	1335	3	X				X																							
MW005	6/23	1340	3	X				X																							
MW006	6/23	1345	3	X				X																							
MW007	6/23	1350	3	X				X																							
<table border="1"> <tr> <td>Relinquished by: <i>[Signature]</i></td> <td>Date/Time: 6/23</td> <td>Received by: <i>[Signature]</i></td> <td>Date/Time: 6/23/10 1700</td> <td rowspan="3"> Turn Around Time (Check) <input type="checkbox"/> Same Day <input type="checkbox"/> 24 Hours <input checked="" type="checkbox"/> 72 Hours Standard Sample Integrity: Temperature Upon Receipt: 5.4 Intact: Yes No </td> </tr> <tr> <td>Relinquished by: <i>[Signature]</i></td> <td>Date/Time: 6/23</td> <td>Received by: <i>[Signature]</i></td> <td>Date/Time: 6/23/10 1700</td> </tr> <tr> <td>Relinquished by:</td> <td>Date/Time:</td> <td>Received in Lab by:</td> <td>Date/Time:</td> </tr> </table>																			Relinquished by: <i>[Signature]</i>	Date/Time: 6/23	Received by: <i>[Signature]</i>	Date/Time: 6/23/10 1700	Turn Around Time (Check) <input type="checkbox"/> Same Day <input type="checkbox"/> 24 Hours <input checked="" type="checkbox"/> 72 Hours Standard Sample Integrity: Temperature Upon Receipt: 5.4 Intact: Yes No	Relinquished by: <i>[Signature]</i>	Date/Time: 6/23	Received by: <i>[Signature]</i>	Date/Time: 6/23/10 1700	Relinquished by:	Date/Time:	Received in Lab by:	Date/Time:
Relinquished by: <i>[Signature]</i>	Date/Time: 6/23	Received by: <i>[Signature]</i>	Date/Time: 6/23/10 1700	Turn Around Time (Check) <input type="checkbox"/> Same Day <input type="checkbox"/> 24 Hours <input checked="" type="checkbox"/> 72 Hours Standard Sample Integrity: Temperature Upon Receipt: 5.4 Intact: Yes No																											
Relinquished by: <i>[Signature]</i>	Date/Time: 6/23	Received by: <i>[Signature]</i>	Date/Time: 6/23/10 1700																												
Relinquished by:	Date/Time:	Received in Lab by:	Date/Time:																												

www.c2scientific.com

Summit Scientific

The results in this report apply to the samples analyzed in accordance with the chain of custody document. This analytical report must be reproduced in its entirety.

[Signature]



LT Environmental, Inc.
4600 West 60th Avenue
Arvada CO, 80003

Project: PDC - Pfenning # 43 & 44-31

Project Number: PDC 08159
Project Manager: Brian Dodek

Reported:
06/28/10 14:11

MW01
R006137-01 (Water)

Summit Scientific

Volatile Organic Compounds by EPA Method 8260B

Date Sampled: **06/23/10 13:20**

Analyte	Result	Reporting Limit	Units	Dilution	Batch	Prepared	Analyzed	Method	Notes
Benzene	740	10	ug/l	10	0062504	06/25/10	06/26/10	EPA 8260B	
Toluene	ND	1.0	"	1	"	"	"	"	
Ethylbenzene	ND	1.0	"	"	"	"	"	"	
Xylenes (total)	2.4	1.0	"	"	"	"	"	"	

Date Sampled: **06/23/10 13:20**

Analyte	Result	Reporting Limit	Units	Dilution	Batch	Prepared	Analyzed	Method	Notes
<i>Surrogate: 1,2-Dichloroethane-d4</i>		<i>102 %</i>	<i>70.4-127</i>		"	"	"	"	
<i>Surrogate: Toluene-d8</i>		<i>105 %</i>	<i>85.7-111</i>		"	"	"	"	
<i>Surrogate: 4-Bromofluorobenzene</i>		<i>101 %</i>	<i>83.9-116</i>		"	"	"	"	

Summit Scientific

The results in this report apply to the samples analyzed in accordance with the chain of custody document. This analytical report must be reproduced in its entirety.



LT Environmental, Inc.
4600 West 60th Avenue
Arvada CO, 80003

Project: PDC - Pfenning # 43 & 44-31

Project Number: PDC 08159
Project Manager: Brian Dodek

Reported:
06/28/10 14:11

MW02
R006137-02 (Water)

Summit Scientific

Volatile Organic Compounds by EPA Method 8260B

Date Sampled: **06/23/10 13:25**

Analyte	Result	Reporting		Units	Dilution	Batch	Prepared	Analyzed	Method	Notes
		Limit								
Benzene	ND	1.0		ug/l	1	0062504	06/25/10	06/26/10	EPA 8260B	
Toluene	ND	1.0		"	"	"	"	"	"	
Ethylbenzene	ND	1.0		"	"	"	"	"	"	
Xylenes (total)	ND	1.0		"	"	"	"	"	"	

Date Sampled: **06/23/10 13:25**

Analyte	Result	Reporting		Units	Dilution	Batch	Prepared	Analyzed	Method	Notes
		Limit								
Surrogate: 1,2-Dichloroethane-d4		94.2 %		70.4-127		"	"	"	"	
Surrogate: Toluene-d8		99.1 %		85.7-111		"	"	"	"	
Surrogate: 4-Bromofluorobenzene		100 %		83.9-116		"	"	"	"	

Summit Scientific

The results in this report apply to the samples analyzed in accordance with the chain of custody document. This analytical report must be reproduced in its entirety.



LT Environmental, Inc.
4600 West 60th Avenue
Arvada CO, 80003

Project: PDC - Pfenning # 43 & 44-31

Project Number: PDC 08159
Project Manager: Brian Dodek

Reported:
06/28/10 14:11

MW03
R006137-03 (Water)

Summit Scientific

Volatile Organic Compounds by EPA Method 8260B

Date Sampled: **06/23/10 13:30**

Analyte	Result	Reporting		Units	Dilution	Batch	Prepared	Analyzed	Method	Notes
		Limit								
Benzene	ND	1.0		ug/l	1	0062504	06/25/10	06/26/10	EPA 8260B	
Toluene	ND	1.0		"	"	"	"	"	"	
Ethylbenzene	ND	1.0		"	"	"	"	"	"	
Xylenes (total)	ND	1.0		"	"	"	"	"	"	

Date Sampled: **06/23/10 13:30**

Analyte	Result	Reporting		Units	Dilution	Batch	Prepared	Analyzed	Method	Notes
		Limit								
Surrogate: 1,2-Dichloroethane-d4		95.6 %		70.4-127		"	"	"	"	
Surrogate: Toluene-d8		96.9 %		85.7-111		"	"	"	"	
Surrogate: 4-Bromofluorobenzene		97.9 %		83.9-116		"	"	"	"	

Summit Scientific

The results in this report apply to the samples analyzed in accordance with the chain of custody document. This analytical report must be reproduced in its entirety.



LT Environmental, Inc.
4600 West 60th Avenue
Arvada CO, 80003

Project: PDC - Pfenning # 43 & 44-31

Project Number: PDC 08159
Project Manager: Brian Dodek

Reported:
06/28/10 14:11

MW04
R006137-04 (Water)

Summit Scientific

Volatile Organic Compounds by EPA Method 8260B

Date Sampled: **06/23/10 13:35**

Analyte	Result	Reporting		Units	Dilution	Batch	Prepared	Analyzed	Method	Notes
		Limit								
Benzene	ND	1.0		ug/l	1	0062504	06/25/10	06/26/10	EPA 8260B	
Toluene	ND	1.0		"	"	"	"	"	"	
Ethylbenzene	ND	1.0		"	"	"	"	"	"	
Xylenes (total)	ND	1.0		"	"	"	"	"	"	

Date Sampled: **06/23/10 13:35**

Analyte	Result	Reporting		Units	Dilution	Batch	Prepared	Analyzed	Method	Notes
		Limit								
Surrogate: 1,2-Dichloroethane-d4		97.2 %		70.4-127		"	"	"	"	
Surrogate: Toluene-d8		98.0 %		85.7-111		"	"	"	"	
Surrogate: 4-Bromofluorobenzene		102 %		83.9-116		"	"	"	"	

Summit Scientific

The results in this report apply to the samples analyzed in accordance with the chain of custody document. This analytical report must be reproduced in its entirety.



LT Environmental, Inc.
4600 West 60th Avenue
Arvada CO, 80003

Project: PDC - Pfenning # 43 & 44-31

Project Number: PDC 08159
Project Manager: Brian Dodek

Reported:
06/28/10 14:11

MW05
R006137-05 (Water)

Summit Scientific

Volatile Organic Compounds by EPA Method 8260B

Date Sampled: **06/23/10 13:40**

Analyte	Result	Reporting	Units	Dilution	Batch	Prepared	Analyzed	Method	Notes
		Limit							
Benzene	ND	1.0	ug/l	1	0062504	06/25/10	06/26/10	EPA 8260B	
Toluene	ND	1.0	"	"	"	"	"	"	
Ethylbenzene	ND	1.0	"	"	"	"	"	"	
Xylenes (total)	ND	1.0	"	"	"	"	"	"	

Date Sampled: **06/23/10 13:40**

Analyte	Result	Reporting	Units	Dilution	Batch	Prepared	Analyzed	Method	Notes
		Limit							
Surrogate: 1,2-Dichloroethane-d4		97.6 %	70.4-127		"	"	"	"	
Surrogate: Toluene-d8		99.0 %	85.7-111		"	"	"	"	
Surrogate: 4-Bromofluorobenzene		102 %	83.9-116		"	"	"	"	

Summit Scientific

The results in this report apply to the samples analyzed in accordance with the chain of custody document. This analytical report must be reproduced in its entirety.



LT Environmental, Inc.
4600 West 60th Avenue
Arvada CO, 80003

Project: PDC - Pfenning # 43 & 44-31

Project Number: PDC 08159
Project Manager: Brian Dodek

Reported:
06/28/10 14:11

MW06
R006137-06 (Water)

Summit Scientific

Volatile Organic Compounds by EPA Method 8260B

Date Sampled: **06/23/10 13:45**

Analyte	Result	Reporting		Units	Dilution	Batch	Prepared	Analyzed	Method	Notes
		Limit								
Benzene	ND	1.0		ug/l	1	0062504	06/25/10	06/26/10	EPA 8260B	
Toluene	ND	1.0		"	"	"	"	"	"	
Ethylbenzene	ND	1.0		"	"	"	"	"	"	
Xylenes (total)	ND	1.0		"	"	"	"	"	"	

Date Sampled: **06/23/10 13:45**

Analyte	Result	Reporting		Units	Dilution	Batch	Prepared	Analyzed	Method	Notes
		Limit								
Surrogate: 1,2-Dichloroethane-d4		95.6 %		70.4-127		"	"	"	"	
Surrogate: Toluene-d8		97.4 %		85.7-111		"	"	"	"	
Surrogate: 4-Bromofluorobenzene		101 %		83.9-116		"	"	"	"	

Summit Scientific

The results in this report apply to the samples analyzed in accordance with the chain of custody document. This analytical report must be reproduced in its entirety.



LT Environmental, Inc.
4600 West 60th Avenue
Arvada CO, 80003

Project: PDC - Pfenning # 43 & 44-31

Project Number: PDC 08159
Project Manager: Brian Dodek

Reported:
06/28/10 14:11

MW07
R006137-07 (Water)

Summit Scientific

Volatile Organic Compounds by EPA Method 8260B

Date Sampled: **06/23/10 13:50**

Analyte	Result	Reporting Limit	Units	Dilution	Batch	Prepared	Analyzed	Method	Notes
Benzene	22	1.0	ug/l	1	0062504	06/25/10	06/26/10	EPA 8260B	
Toluene	ND	1.0	"	"	"	"	"	"	
Ethylbenzene	ND	1.0	"	"	"	"	"	"	
Xylenes (total)	ND	1.0	"	"	"	"	"	"	

Date Sampled: **06/23/10 13:50**

Analyte	Result	Reporting Limit	Units	Dilution	Batch	Prepared	Analyzed	Method	Notes
<i>Surrogate: 1,2-Dichloroethane-d4</i>		<i>102 %</i>	<i>70.4-127</i>		<i>"</i>	<i>"</i>	<i>"</i>	<i>"</i>	
<i>Surrogate: Toluene-d8</i>		<i>101 %</i>	<i>85.7-111</i>		<i>"</i>	<i>"</i>	<i>"</i>	<i>"</i>	
<i>Surrogate: 4-Bromofluorobenzene</i>		<i>99.6 %</i>	<i>83.9-116</i>		<i>"</i>	<i>"</i>	<i>"</i>	<i>"</i>	

Summit Scientific

The results in this report apply to the samples analyzed in accordance with the chain of custody document. This analytical report must be reproduced in its entirety.



LT Environmental, Inc.
4600 West 60th Avenue
Arvada CO, 80003

Project: PDC - Pfenning # 43 & 44-31

Project Number: PDC 08159
Project Manager: Brian Dodek

Reported:
06/28/10 14:11

Volatile Organic Compounds by EPA Method 8260B - Quality Control

Summit Scientific

Analyte	Reporting			Spike	Source	%REC		RPD		
	Result	Limit	Units	Level	Result	%REC	Limits	RPD	Limit	Notes

Batch 0062504 - EPA 5030 Water MS

Blank (0062504-BLK1)

Prepared & Analyzed: 06/25/10

Benzene	ND	1.0	ug/l							
Toluene	ND	1.0	"							
Ethylbenzene	ND	1.0	"							
Xylenes (total)	ND	1.0	"							
Surrogate: 1,2-Dichloroethane-d4	12.6		"	13.3	94.8	70.4-127				
Surrogate: Toluene-d8	13.4		"	13.3	100	85.7-111				
Surrogate: 4-Bromofluorobenzene	13.0		"	13.3	97.8	83.9-116				

LCS (0062504-BS1)

Prepared & Analyzed: 06/25/10

Benzene	28.8	1.0	ug/l	33.3	86.5	64.2-127			10.9	
Toluene	28.3	1.0	"	33.3	85.0	66.4-125			11.3	
Ethylbenzene	28.7	1.0	"	33.3	86.1	70-130			20	
m,p-Xylene	56.0	2.0	"	66.7	84.0	70-130			20	
o-Xylene	26.3	1.0	"	33.3	78.9	70-130			20	
Surrogate: 1,2-Dichloroethane-d4	13.2		"	13.3	99.0	70.4-127				
Surrogate: Toluene-d8	13.6		"	13.3	102	85.7-111				
Surrogate: 4-Bromofluorobenzene	12.9		"	13.3	97.1	83.9-116				

LCS Dup (0062504-BSD1)

Prepared & Analyzed: 06/25/10

Benzene	28.9	1.0	ug/l	33.3	86.8	64.2-127	0.312		10.9	
Toluene	28.6	1.0	"	33.3	85.7	66.4-125	0.879		11.3	
Ethylbenzene	28.4	1.0	"	33.3	85.3	70-130	0.980		20	
m,p-Xylene	56.1	2.0	"	66.7	84.2	70-130	0.214		20	
o-Xylene	26.4	1.0	"	33.3	79.2	70-130	0.380		20	
Surrogate: 1,2-Dichloroethane-d4	13.1		"	13.3	98.0	70.4-127				
Surrogate: Toluene-d8	13.6		"	13.3	102	85.7-111				
Surrogate: 4-Bromofluorobenzene	13.0		"	13.3	97.6	83.9-116				

Summit Scientific

The results in this report apply to the samples analyzed in accordance with the chain of custody document. This analytical report must be reproduced in its entirety.



LT Environmental, Inc.
4600 West 60th Avenue
Arvada CO, 80003

Project: PDC - Pfenning # 43 & 44-31
Project Number: PDC 08159
Project Manager: Brian Dodek

Reported:
06/28/10 14:11

Volatile Organic Compounds by EPA Method 8260B - Quality Control
Summit Scientific

Analyte	Reporting			Spike	Source		%REC		RPD	
	Result	Limit	Units	Level	Result	%REC	Limits	RPD	Limit	Notes

Batch 0062504 - EPA 5030 Water MS

Matrix Spike (0062504-MS1)		Source: R006136-04			Prepared & Analyzed: 06/25/10					
Benzene	27.5	1.0	ug/l	33.3	ND	82.6	57.4-127		19.3	
Toluene	27.2	1.0	"	33.3	ND	81.5	60.1-123		18.7	
Ethylbenzene	27.4	1.0	"	33.3	ND	82.3	70-130		20	
m,p-Xylene	53.7	2.0	"	66.7	ND	80.5	70-130		20	
o-Xylene	25.4	1.0	"	33.3	ND	76.2	70-130		20	
Surrogate: 1,2-Dichloroethane-d4	13.6		"	13.3		102	70.4-127			
Surrogate: Toluene-d8	13.6		"	13.3		102	85.7-111			
Surrogate: 4-Bromofluorobenzene	13.3		"	13.3		99.8	83.9-116			
Matrix Spike Dup (0062504-MSD1)		Source: R006136-04			Prepared & Analyzed: 06/25/10					
Benzene	28.0	1.0	ug/l	33.3	ND	84.0	57.4-127	1.66	19.3	
Toluene	27.9	1.0	"	33.3	ND	83.7	60.1-123	2.76	18.7	
Ethylbenzene	27.8	1.0	"	33.3	ND	83.5	70-130	1.48	20	
m,p-Xylene	55.2	2.0	"	66.7	ND	82.7	70-130	2.66	20	
o-Xylene	25.7	1.0	"	33.3	ND	77.1	70-130	1.17	20	
Surrogate: 1,2-Dichloroethane-d4	13.5		"	13.3		102	70.4-127			
Surrogate: Toluene-d8	13.5		"	13.3		101	85.7-111			
Surrogate: 4-Bromofluorobenzene	13.1		"	13.3		98.3	83.9-116			

Summit Scientific

The results in this report apply to the samples analyzed in accordance with the chain of custody document. This analytical report must be reproduced in its entirety.



LT Environmental, Inc.
4600 West 60th Avenue
Arvada CO, 80003

Project: PDC - Pfenning # 43 & 44-31

Project Number: PDC 08159
Project Manager: Brian Dodek

Reported:
06/28/10 14:11

Notes and Definitions

DET Analyte DETECTED
ND Analyte NOT DETECTED at or above the reporting limit
NR Not Reported
dry Sample results reported on a dry weight basis
RPD Relative Percent Difference

Summit Scientific

A handwritten signature in black ink, appearing to be 'JD' or similar, with a long horizontal stroke extending to the right.

The results in this report apply to the samples analyzed in accordance with the chain of custody document. This analytical report must be reproduced in its entirety.

Summit Scientific

741 Corporate Circle – Suite I ♦ Golden, Colorado 80401

303.277.9310 - laboratory ♦ 303.277.9531 - fax

September 14, 2010

Brian Dodek
LT Environmental, Inc.
4600 West 60th Avenue
Arvada, CO 80003
RE: PDC - Pfenning # 43 & 44-31

Enclosed are the results of analyses for samples received by Summit Scientific on 09/08/10 17:00. If you have any questions concerning this report, please feel free to contact me.

Sincerely,

A handwritten signature in blue ink, appearing to be 'PS' followed by a long, sweeping horizontal line.

Paul Shrewsbury For Ben Shrewsbury
President / Laboratory Director



LT Environmental, Inc.
4600 West 60th Avenue
Arvada CO, 80003

Project: PDC - Pfenning # 43 & 44-31

Project Number: PDC 08159
Project Manager: Brian Dodek

Reported:
09/14/10 08:35

ANALYTICAL REPORT FOR SAMPLES

Sample ID	Laboratory ID	Matrix	Date Sampled	Date Received
MW01	R009058-01	Water	09/08/10 12:00	09/08/10 17:00
MW02	R009058-02	Water	09/08/10 12:05	09/08/10 17:00
MW03	R009058-03	Water	09/08/10 12:10	09/08/10 17:00
MW04	R009058-04	Water	09/08/10 12:15	09/08/10 17:00
MW05	R009058-05	Water	09/08/10 12:20	09/08/10 17:00
MW06	R009058-06	Water	09/08/10 12:25	09/08/10 17:00
MW07	R009058-07	Water	09/08/10 12:30	09/08/10 17:00

Summit Scientific

The results in this report apply to the samples analyzed in accordance with the chain of custody document. This analytical report must be reproduced in its entirety.



LT Environmental, Inc.
4600 West 60th Avenue
Arvada CO, 80003

Project: PDC - Pfenning # 43 & 44-31

Project Number: PDC 08159
Project Manager: Brian Dodek

Reported:
09/14/10 08:35

Summit Scientific
S₂ 2009058

741 Corporate Circle Suite 1 • Golden, Colorado 80401
303-277-9310 • 303-277-9531 Fax

Client: LT Environmental, Inc. Project Manager: Brian Dodek
Address: 4600 West 60th Avenue E-Mail: btdodek@ltenv.com
City/State/Zip: Arvada, CO 80003
Phone: (303) 433-9788 Fax: (303) 433-1432
Sampler Name: *Sharon* Project Name: *Pfenning 43 & 44-31*
Project Number: *PDC08159*

Page 1 of 1

Sample Description	Date Sampled	Time Sampled	Number of Containers	Preservative				Matrix				Analyze For:						Special Instructions	Notes	
				HCl	HNO ₃	None	Other (Specify)	Groundwater	Soil	Air - Canister Serial #	Other (Specify)	DRO	GBTEX	BTEX 2603	Table 9.10 Full	Table 9.10 Short	pH / EC			SAR
MW01	9/8	1200	3	X				X												
MW02	9/8	1205	3	X				X												
MW03	9/8	1210	3	X				X												
MW04	9/8	1215	3	X				X												
MW05	9/8	1220	3	X				X												
MW06	9/8	1225	3	X				X												
MW07	9/8	1230	3	X				X												
Relinquished by: <i>[Signature]</i>	Date/Time: 9/8			Received by: <i>[Signature]</i>	Date/Time: 9/11/10			Received by: <i>[Signature]</i>	Date/Time: 9/11/10											
Relinquished by: <i>[Signature]</i>	Date/Time: 9/8			Received by: <i>[Signature]</i>	Date/Time: 9/11/10			Received by: <i>[Signature]</i>	Date/Time: 9/11/10											
Relinquished by: <i>[Signature]</i>	Date/Time: 9/8			Received by: <i>[Signature]</i>	Date/Time: 9/11/10			Received by: <i>[Signature]</i>	Date/Time: 9/11/10											

www.e2scientific.com

Summit Scientific

The results in this report apply to the samples analyzed in accordance with the chain of custody document. This analytical report must be reproduced in its entirety.

[Signature]



LT Environmental, Inc.
4600 West 60th Avenue
Arvada CO, 80003

Project: PDC - Pfenning # 43 & 44-31

Project Number: PDC 08159
Project Manager: Brian Dodek

Reported:
09/14/10 08:35

MW01
R009058-01 (Water)

Summit Scientific

Volatile Organic Compounds by EPA Method 8260B

Date Sampled: **09/08/10 12:00**

Analyte	Result	Reporting Limit	Units	Dilution	Batch	Prepared	Analyzed	Method	Notes
Benzene	200	1.0	ug/l	1	0091101	09/11/10	09/11/10	EPA 8260B	
Toluene	ND	1.0	"	"	"	"	"	"	
Ethylbenzene	ND	1.0	"	"	"	"	"	"	
Xylenes (total)	ND	1.0	"	"	"	"	"	"	

Date Sampled: **09/08/10 12:00**

Analyte	Result	Reporting Limit	Units	Dilution	Batch	Prepared	Analyzed	Method	Notes
<i>Surrogate: 1,2-Dichloroethane-d4</i>		<i>130 %</i>	<i>57.9-139</i>		<i>"</i>	<i>"</i>	<i>"</i>	<i>"</i>	
<i>Surrogate: Toluene-d8</i>		<i>101 %</i>	<i>83.1-115</i>		<i>"</i>	<i>"</i>	<i>"</i>	<i>"</i>	
<i>Surrogate: 4-Bromofluorobenzene</i>		<i>100 %</i>	<i>80.8-120</i>		<i>"</i>	<i>"</i>	<i>"</i>	<i>"</i>	

Summit Scientific

The results in this report apply to the samples analyzed in accordance with the chain of custody document. This analytical report must be reproduced in its entirety.



LT Environmental, Inc.
4600 West 60th Avenue
Arvada CO, 80003

Project: PDC - Pfenning # 43 & 44-31

Project Number: PDC 08159
Project Manager: Brian Dodek

Reported:
09/14/10 08:35

MW02
R009058-02 (Water)

Summit Scientific

Volatile Organic Compounds by EPA Method 8260B

Date Sampled: **09/08/10 12:05**

Analyte	Result	Reporting		Units	Dilution	Batch	Prepared	Analyzed	Method	Notes
		Limit								
Benzene	ND	1.0		ug/l	1	0091101	09/11/10	09/11/10	EPA 8260B	
Toluene	ND	1.0		"	"	"	"	"	"	
Ethylbenzene	ND	1.0		"	"	"	"	"	"	
Xylenes (total)	ND	1.0		"	"	"	"	"	"	

Date Sampled: **09/08/10 12:05**

Analyte	Result	Reporting		Units	Dilution	Batch	Prepared	Analyzed	Method	Notes
		Limit								
Surrogate: 1,2-Dichloroethane-d4		117 %		57.9-139		"	"	"	"	
Surrogate: Toluene-d8		96.8 %		83.1-115		"	"	"	"	
Surrogate: 4-Bromofluorobenzene		96.9 %		80.8-120		"	"	"	"	

Summit Scientific

The results in this report apply to the samples analyzed in accordance with the chain of custody document. This analytical report must be reproduced in its entirety.



LT Environmental, Inc.
4600 West 60th Avenue
Arvada CO, 80003

Project: PDC - Pfenning # 43 & 44-31

Project Number: PDC 08159
Project Manager: Brian Dodek

Reported:
09/14/10 08:35

MW03
R009058-03 (Water)

Summit Scientific

Volatile Organic Compounds by EPA Method 8260B

Date Sampled: **09/08/10 12:10**

Analyte	Result	Reporting		Units	Dilution	Batch	Prepared	Analyzed	Method	Notes
		Limit								
Benzene	ND	1.0		ug/l	1	0091101	09/11/10	09/11/10	EPA 8260B	
Toluene	ND	1.0		"	"	"	"	"	"	
Ethylbenzene	ND	1.0		"	"	"	"	"	"	
Xylenes (total)	ND	1.0		"	"	"	"	"	"	

Date Sampled: **09/08/10 12:10**

Analyte	Result	Reporting		Units	Dilution	Batch	Prepared	Analyzed	Method	Notes
		Limit								
Surrogate: 1,2-Dichloroethane-d4		121 %		57.9-139		"	"	"	"	
Surrogate: Toluene-d8		97.6 %		83.1-115		"	"	"	"	
Surrogate: 4-Bromofluorobenzene		99.5 %		80.8-120		"	"	"	"	

Summit Scientific

The results in this report apply to the samples analyzed in accordance with the chain of custody document. This analytical report must be reproduced in its entirety.



LT Environmental, Inc.
4600 West 60th Avenue
Arvada CO, 80003

Project: PDC - Pfenning # 43 & 44-31

Project Number: PDC 08159
Project Manager: Brian Dodek

Reported:
09/14/10 08:35

MW04
R009058-04 (Water)

Summit Scientific

Volatile Organic Compounds by EPA Method 8260B

Date Sampled: **09/08/10 12:15**

Analyte	Result	Reporting	Units	Dilution	Batch	Prepared	Analyzed	Method	Notes
		Limit							
Benzene	ND	1.0	ug/l	1	0091101	09/11/10	09/11/10	EPA 8260B	
Toluene	ND	1.0	"	"	"	"	"	"	
Ethylbenzene	ND	1.0	"	"	"	"	"	"	
Xylenes (total)	ND	1.0	"	"	"	"	"	"	

Date Sampled: **09/08/10 12:15**

Analyte	Result	Reporting	Units	Dilution	Batch	Prepared	Analyzed	Method	Notes
		Limit							
Surrogate: 1,2-Dichloroethane-d4		119 %	57.9-139		"	"	"	"	
Surrogate: Toluene-d8		97.5 %	83.1-115		"	"	"	"	
Surrogate: 4-Bromofluorobenzene		96.7 %	80.8-120		"	"	"	"	

Summit Scientific

The results in this report apply to the samples analyzed in accordance with the chain of custody document. This analytical report must be reproduced in its entirety.



LT Environmental, Inc.
4600 West 60th Avenue
Arvada CO, 80003

Project: PDC - Pfenning # 43 & 44-31

Project Number: PDC 08159
Project Manager: Brian Dodek

Reported:
09/14/10 08:35

MW05
R009058-05 (Water)

Summit Scientific

Volatile Organic Compounds by EPA Method 8260B

Date Sampled: **09/08/10 12:20**

Analyte	Result	Reporting		Dilution	Batch	Prepared	Analyzed	Method	Notes
		Limit	Units						
Benzene	ND	1.0	ug/l	1	0091101	09/11/10	09/11/10	EPA 8260B	
Toluene	ND	1.0	"	"	"	"	"	"	
Ethylbenzene	ND	1.0	"	"	"	"	"	"	
Xylenes (total)	ND	1.0	"	"	"	"	"	"	

Date Sampled: **09/08/10 12:20**

Analyte	Result	Reporting		Dilution	Batch	Prepared	Analyzed	Method	Notes
		Limit	Units						
Surrogate: 1,2-Dichloroethane-d4		122 %	57.9-139		"	"	"	"	
Surrogate: Toluene-d8		96.5 %	83.1-115		"	"	"	"	
Surrogate: 4-Bromofluorobenzene		96.8 %	80.8-120		"	"	"	"	

Summit Scientific

The results in this report apply to the samples analyzed in accordance with the chain of custody document. This analytical report must be reproduced in its entirety.



LT Environmental, Inc.
4600 West 60th Avenue
Arvada CO, 80003

Project: PDC - Pfenning # 43 & 44-31

Project Number: PDC 08159
Project Manager: Brian Dodek

Reported:
09/14/10 08:35

MW06
R009058-06 (Water)

Summit Scientific

Volatile Organic Compounds by EPA Method 8260B

Date Sampled: **09/08/10 12:25**

Analyte	Result	Reporting		Units	Dilution	Batch	Prepared	Analyzed	Method	Notes
		Limit								
Benzene	ND	1.0		ug/l	1	0091101	09/11/10	09/11/10	EPA 8260B	
Toluene	ND	1.0		"	"	"	"	"	"	
Ethylbenzene	ND	1.0		"	"	"	"	"	"	
Xylenes (total)	ND	1.0		"	"	"	"	"	"	

Date Sampled: **09/08/10 12:25**

Analyte	Result	Reporting		Units	Dilution	Batch	Prepared	Analyzed	Method	Notes
		Limit								
Surrogate: 1,2-Dichloroethane-d4		116 %		57.9-139		"	"	"	"	
Surrogate: Toluene-d8		95.9 %		83.1-115		"	"	"	"	
Surrogate: 4-Bromofluorobenzene		98.0 %		80.8-120		"	"	"	"	

Summit Scientific

The results in this report apply to the samples analyzed in accordance with the chain of custody document. This analytical report must be reproduced in its entirety.



LT Environmental, Inc.
4600 West 60th Avenue
Arvada CO, 80003

Project: PDC - Pfenning # 43 & 44-31

Project Number: PDC 08159
Project Manager: Brian Dodek

Reported:
09/14/10 08:35

MW07

R009058-07 (Water)

Summit Scientific

Volatile Organic Compounds by EPA Method 8260B

Date Sampled: **09/08/10 12:30**

Analyte	Result	Reporting		Units	Dilution	Batch	Prepared	Analyzed	Method	Notes
		Limit								
Benzene	ND	1.0		ug/l	1	0091101	09/11/10	09/12/10	EPA 8260B	
Toluene	ND	1.0		"	"	"	"	"	"	
Ethylbenzene	ND	1.0		"	"	"	"	"	"	
Xylenes (total)	ND	1.0		"	"	"	"	"	"	

Date Sampled: **09/08/10 12:30**

Analyte	Result	Reporting		Units	Dilution	Batch	Prepared	Analyzed	Method	Notes
		Limit								
Surrogate: 1,2-Dichloroethane-d4		119 %		57.9-139		"	"	"	"	
Surrogate: Toluene-d8		94.0 %		83.1-115		"	"	"	"	
Surrogate: 4-Bromofluorobenzene		99.8 %		80.8-120		"	"	"	"	

Summit Scientific

The results in this report apply to the samples analyzed in accordance with the chain of custody document. This analytical report must be reproduced in its entirety.



LT Environmental, Inc.
4600 West 60th Avenue
Arvada CO, 80003

Project: PDC - Pfenning # 43 & 44-31

Project Number: PDC 08159
Project Manager: Brian Dodek

Reported:
09/14/10 08:35

Volatile Organic Compounds by EPA Method 8260B - Quality Control

Summit Scientific

Analyte	Reporting			Spike	Source		%REC		RPD	
	Result	Limit	Units	Level	Result	%REC	Limits	RPD	Limit	Notes

Batch 0091101 - EPA 5030 Water MS

Blank (0091101-BLK1)

Prepared & Analyzed: 09/11/10

Benzene	ND	1.0	ug/l							
Toluene	ND	1.0	"							
Ethylbenzene	ND	1.0	"							
Xylenes (total)	ND	1.0	"							
Surrogate: 1,2-Dichloroethane-d4	15.2		"	13.3	114	57.9-139				
Surrogate: Toluene-d8	12.7		"	13.3	95.1	83.1-115				
Surrogate: 4-Bromofluorobenzene	13.1		"	13.3	98.0	80.8-120				

LCS (0091101-BS1)

Prepared & Analyzed: 09/11/10

Benzene	27.1	1.0	ug/l	33.3	81.4	60.1-131			10.9	
Toluene	26.9	1.0	"	33.3	80.6	65.9-127			11.3	
Ethylbenzene	34.6	1.0	"	33.3	104	65.1-129			20	
m,p-Xylene	69.0	2.0	"	66.7	104	66.8-127			20	
o-Xylene	30.3	1.0	"	33.3	91.0	61.2-120			20	
Surrogate: 1,2-Dichloroethane-d4	16.0		"	13.3	120	57.9-139				
Surrogate: Toluene-d8	12.9		"	13.3	96.6	83.1-115				
Surrogate: 4-Bromofluorobenzene	13.3		"	13.3	99.5	80.8-120				

LCS Dup (0091101-BSD1)

Prepared & Analyzed: 09/11/10

Benzene	27.5	1.0	ug/l	33.3	82.5	60.1-131	1.43		10.9	
Toluene	27.1	1.0	"	33.3	81.2	65.9-127	0.742		11.3	
Ethylbenzene	34.2	1.0	"	33.3	103	65.1-129	1.31		20	
m,p-Xylene	66.8	2.0	"	66.7	100	66.8-127	3.34		20	
o-Xylene	29.9	1.0	"	33.3	89.6	61.2-120	1.50		20	
Surrogate: 1,2-Dichloroethane-d4	16.1		"	13.3	121	57.9-139				
Surrogate: Toluene-d8	13.0		"	13.3	97.1	83.1-115				
Surrogate: 4-Bromofluorobenzene	13.0		"	13.3	97.4	80.8-120				

Summit Scientific

The results in this report apply to the samples analyzed in accordance with the chain of custody document. This analytical report must be reproduced in its entirety.



LT Environmental, Inc.
4600 West 60th Avenue
Arvada CO, 80003

Project: PDC - Pfenning # 43 & 44-31

Project Number: PDC 08159
Project Manager: Brian Dodek

Reported:
09/14/10 08:35

Volatile Organic Compounds by EPA Method 8260B - Quality Control
Summit Scientific

Analyte	Reporting			Spike	Source		%REC		RPD	
	Result	Limit	Units	Level	Result	%REC	Limits	RPD	Limit	Notes

Batch 0091101 - EPA 5030 Water MS

Matrix Spike (0091101-MS1)		Source: R009056-01			Prepared & Analyzed: 09/11/10					
Benzene	25.6	1.0	ug/l	33.3	ND	76.7	52.7-130		19.3	
Toluene	25.1	1.0	"	33.3	ND	75.4	57-127		18.7	
Ethylbenzene	33.1	1.0	"	33.3	ND	99.2	59.2-127		20	
m,p-Xylene	65.4	2.0	"	66.7	1.20	96.4	53.2-132		20	
o-Xylene	29.0	1.0	"	33.3	ND	87.0	56.3-117		20	
Surrogate: 1,2-Dichloroethane-d4	15.2		"	13.3		114	57.9-139			
Surrogate: Toluene-d8	12.4		"	13.3		93.1	83.1-115			
Surrogate: 4-Bromofluorobenzene	12.8		"	13.3		95.7	80.8-120			
Matrix Spike Dup (0091101-MSD1)		Source: R009056-01			Prepared & Analyzed: 09/11/10					
Benzene	26.1	1.0	ug/l	33.3	ND	78.2	52.7-130	1.94	19.3	
Toluene	25.5	1.0	"	33.3	ND	76.6	57-127	1.62	18.7	
Ethylbenzene	31.5	1.0	"	33.3	ND	94.4	59.2-127	4.93	20	
m,p-Xylene	61.8	2.0	"	66.7	1.20	90.9	53.2-132	5.75	20	
o-Xylene	27.6	1.0	"	33.3	ND	82.8	56.3-117	5.02	20	
Surrogate: 1,2-Dichloroethane-d4	16.1		"	13.3		121	57.9-139			
Surrogate: Toluene-d8	13.2		"	13.3		99.2	83.1-115			
Surrogate: 4-Bromofluorobenzene	12.7		"	13.3		95.1	80.8-120			

Summit Scientific

The results in this report apply to the samples analyzed in accordance with the chain of custody document. This analytical report must be reproduced in its entirety.



LT Environmental, Inc.
4600 West 60th Avenue
Arvada CO, 80003

Project: PDC - Pfenning # 43 & 44-31

Project Number: PDC 08159
Project Manager: Brian Dodek

Reported:
09/14/10 08:35

Notes and Definitions

DET Analyte DETECTED
ND Analyte NOT DETECTED at or above the reporting limit
NR Not Reported
dry Sample results reported on a dry weight basis
RPD Relative Percent Difference

Summit Scientific

A handwritten signature in black ink, appearing to be 'JD' or similar, with a long horizontal stroke extending to the right.

The results in this report apply to the samples analyzed in accordance with the chain of custody document. This analytical report must be reproduced in its entirety.

Summit Scientific

741 Corporate Circle – Suite I ♦ Golden, Colorado 80401

303.277.9310 - laboratory ♦ 303.277.9531 - fax

December 13, 2010

Brian Dodek

LT Environmental, Inc.

4600 West 60th Avenue

Arvada, CO 80003

RE: PDC - Pfenning # 43 & 44-31

Enclosed are the results of analyses for samples received by Summit Scientific on 12/07/10 17:00. If you have any questions concerning this report, please feel free to contact me.

Sincerely,

A handwritten signature in blue ink, appearing to be 'PS' followed by a long horizontal stroke.

Paul Shrewsbury For Ben Shrewsbury
President / Laboratory Director



LT Environmental, Inc.
4600 West 60th Avenue
Arvada CO, 80003

Project: PDC - Pfenning # 43 & 44-31

Project Number: PDC 08159
Project Manager: Brian Dodek

Reported:
12/13/10 13:12

ANALYTICAL REPORT FOR SAMPLES

Sample ID	Laboratory ID	Matrix	Date Sampled	Date Received
MW01	R012050-01	Water	12/07/10 12:30	12/07/10 17:00
MW02	R012050-02	Water	12/07/10 12:35	12/07/10 17:00
MW03	R012050-03	Water	12/07/10 12:40	12/07/10 17:00
MW04	R012050-04	Water	12/07/10 12:45	12/07/10 17:00
MW05	R012050-05	Water	12/07/10 12:50	12/07/10 17:00
MW06	R012050-06	Water	12/07/10 12:55	12/07/10 17:00
MW07	R012050-07	Water	12/07/10 13:00	12/07/10 17:00

Summit Scientific

The results in this report apply to the samples analyzed in accordance with the chain of custody document. This analytical report must be reproduced in its entirety.

LT Environmental, Inc.
4600 West 60th Avenue
Arvada CO, 80003

Project: PDC - Pfenning # 43 & 44-31

Project Number: PDC 08159
Project Manager: Brian Dodek

Reported:
12/13/10 13:12

Summit Scientific

201050

741 Corporate Circle Suite I ♦ Golden, Colorado 80401
303-277-9310 ♦ 303-277-9531 Fax

Page / of /

Client: LT Environmental, Inc.

Address: 4600 West 60th Avenue

City/State/Zip: Arvada, CO 80003

Phone: (303) 433-9788

Sampler Name: A.D.C.A.

Project Manager: Brian Dodek

E-Mail: bdodek@ltenv.comProject Name: PC no. 43 114-31

Project Number: PAC 08129

[illegible]

www.s2scientific.com

Summit Scientific

The results in this report apply to the samples analyzed in accordance with the chain of custody document. This analytical report must be reproduced in its entirety.



LT Environmental, Inc.
4600 West 60th Avenue
Arvada CO, 80003

Project: PDC - Pfenning # 43 & 44-31

Project Number: PDC 08159
Project Manager: Brian Dodek

Reported:
12/13/10 13:12

MW01
R012050-01 (Water)

Summit Scientific

Volatile Organic Compounds by EPA Method 8260B

Date Sampled: 12/07/10 12:30

Analyte	Result	Reporting Limit	Units	Dilution	Batch	Prepared	Analyzed	Method	Notes
Benzene	450	10	ug/l	10	0121004	12/10/10	12/12/10	EPA 8260B	
Toluene	ND	1.0	"	1	"	"	12/12/10	"	
Ethylbenzene	ND	1.0	"	"	"	"	"	"	
Xylenes (total)	ND	1.0	"	"	"	"	"	"	

Date Sampled: 12/07/10 12:30

Analyte	Result	Reporting Limit	Units	Dilution	Batch	Prepared	Analyzed	Method	Notes
Surrogate: 1,2-Dichloroethane-d4		120 %	57.9-139		"	"	"	"	
Surrogate: Toluene-d8		101 %	83.1-115		"	"	"	"	
Surrogate: 4-Bromofluorobenzene		100 %	80.8-120		"	"	"	"	

Summit Scientific

The results in this report apply to the samples analyzed in accordance with the chain of custody document. This analytical report must be reproduced in its entirety.



LT Environmental, Inc.
4600 West 60th Avenue
Arvada CO, 80003

Project: PDC - Pfenning # 43 & 44-31

Project Number: PDC 08159
Project Manager: Brian Dodek

Reported:
12/13/10 13:12

MW02
R012050-02 (Water)

Summit Scientific

Volatile Organic Compounds by EPA Method 8260B

Date Sampled: 12/07/10 12:35

Analyte	Result	Reporting		Units	Dilution	Batch	Prepared	Analyzed	Method	Notes
		Limit								
Benzene	ND	1.0		ug/l	1	0121004	12/10/10	12/12/10	EPA 8260B	
Toluene	ND	1.0		"	"	"	"	"	"	
Ethylbenzene	ND	1.0		"	"	"	"	"	"	
Xylenes (total)	ND	1.0		"	"	"	"	"	"	

Date Sampled: 12/07/10 12:35

Analyte	Result	Reporting		Units	Dilution	Batch	Prepared	Analyzed	Method	Notes
		Limit								
Surrogate: 1,2-Dichloroethane-d4		111 %		57.9-139		"	"	"	"	
Surrogate: Toluene-d8		95.7 %		83.1-115		"	"	"	"	
Surrogate: 4-Bromofluorobenzene		97.1 %		80.8-120		"	"	"	"	

Summit Scientific

The results in this report apply to the samples analyzed in accordance with the chain of custody document. This analytical report must be reproduced in its entirety.



LT Environmental, Inc.
4600 West 60th Avenue
Arvada CO, 80003

Project: PDC - Pfenning # 43 & 44-31

Project Number: PDC 08159
Project Manager: Brian Dodek

Reported:
12/13/10 13:12

MW03
R012050-03 (Water)

Summit Scientific

Volatile Organic Compounds by EPA Method 8260B

Date Sampled: 12/07/10 12:40

Analyte	Result	Reporting		Units	Dilution	Batch	Prepared	Analyzed	Method	Notes
		Limit								
Benzene	ND	1.0		ug/l	1	0121004	12/10/10	12/12/10	EPA 8260B	
Toluene	ND	1.0		"	"	"	"	"	"	
Ethylbenzene	ND	1.0		"	"	"	"	"	"	
Xylenes (total)	ND	1.0		"	"	"	"	"	"	

Date Sampled: 12/07/10 12:40

Analyte	Result	Reporting		Units	Dilution	Batch	Prepared	Analyzed	Method	Notes
		Limit								
Surrogate: 1,2-Dichloroethane-d4		117 %		57.9-139		"	"	"	"	
Surrogate: Toluene-d8		96.8 %		83.1-115		"	"	"	"	
Surrogate: 4-Bromofluorobenzene		100 %		80.8-120		"	"	"	"	

Summit Scientific

The results in this report apply to the samples analyzed in accordance with the chain of custody document. This analytical report must be reproduced in its entirety.



LT Environmental, Inc.
4600 West 60th Avenue
Arvada CO, 80003

Project: PDC - Pfenning # 43 & 44-31

Project Number: PDC 08159
Project Manager: Brian Dodek

Reported:
12/13/10 13:12

MW04
R012050-04 (Water)

Summit Scientific

Volatile Organic Compounds by EPA Method 8260B

Date Sampled: 12/07/10 12:45

Analyte	Result	Reporting		Units	Dilution	Batch	Prepared	Analyzed	Method	Notes
		Limit								
Benzene	ND	1.0		ug/l	1	0121004	12/10/10	12/12/10	EPA 8260B	
Toluene	ND	1.0		"	"	"	"	"	"	
Ethylbenzene	ND	1.0		"	"	"	"	"	"	
Xylenes (total)	ND	1.0		"	"	"	"	"	"	

Date Sampled: 12/07/10 12:45

Analyte	Result	Reporting		Units	Dilution	Batch	Prepared	Analyzed	Method	Notes
		Limit								
Surrogate: 1,2-Dichloroethane-d4		113 %		57.9-139		"	"	"	"	
Surrogate: Toluene-d8		98.9 %		83.1-115		"	"	"	"	
Surrogate: 4-Bromofluorobenzene		101 %		80.8-120		"	"	"	"	

Summit Scientific

The results in this report apply to the samples analyzed in accordance with the chain of custody document. This analytical report must be reproduced in its entirety.



LT Environmental, Inc.
4600 West 60th Avenue
Arvada CO, 80003

Project: PDC - Pfenning # 43 & 44-31

Project Number: PDC 08159
Project Manager: Brian Dodek

Reported:
12/13/10 13:12

MW05
R012050-05 (Water)

Summit Scientific

Volatile Organic Compounds by EPA Method 8260B

Date Sampled: 12/07/10 12:50

Analyte	Result	Reporting		Units	Dilution	Batch	Prepared	Analyzed	Method	Notes
		Limit								
Benzene	ND	1.0		ug/l	1	0121004	12/10/10	12/12/10	EPA 8260B	
Toluene	ND	1.0		"	"	"	"	"	"	
Ethylbenzene	ND	1.0		"	"	"	"	"	"	
Xylenes (total)	ND	1.0		"	"	"	"	"	"	

Date Sampled: 12/07/10 12:50

Analyte	Result	Reporting		Units	Dilution	Batch	Prepared	Analyzed	Method	Notes
		Limit								
Surrogate: 1,2-Dichloroethane-d4		115 %		57.9-139		"	"	"	"	
Surrogate: Toluene-d8		95.0 %		83.1-115		"	"	"	"	
Surrogate: 4-Bromofluorobenzene		99.5 %		80.8-120		"	"	"	"	

Summit Scientific

The results in this report apply to the samples analyzed in accordance with the chain of custody document. This analytical report must be reproduced in its entirety.



LT Environmental, Inc.
4600 West 60th Avenue
Arvada CO, 80003

Project: PDC - Pfenning # 43 & 44-31

Project Number: PDC 08159
Project Manager: Brian Dodek

Reported:
12/13/10 13:12

MW06
R012050-06 (Water)

Summit Scientific

Volatile Organic Compounds by EPA Method 8260B

Date Sampled: 12/07/10 12:55

Analyte	Result	Reporting Limit	Units	Dilution	Batch	Prepared	Analyzed	Method	Notes
Benzene	ND	1.0	ug/l	1	0121004	12/10/10	12/12/10	EPA 8260B	
Toluene	ND	1.0	"	"	"	"	"	"	
Ethylbenzene	ND	1.0	"	"	"	"	"	"	
Xylenes (total)	ND	1.0	"	"	"	"	"	"	

Date Sampled: 12/07/10 12:55

Analyte	Result	Reporting Limit	Units	Dilution	Batch	Prepared	Analyzed	Method	Notes
Surrogate: 1,2-Dichloroethane-d4		109 %	57.9-139		"	"	"	"	
Surrogate: Toluene-d8		93.5 %	83.1-115		"	"	"	"	
Surrogate: 4-Bromofluorobenzene		91.4 %	80.8-120		"	"	"	"	

Summit Scientific

The results in this report apply to the samples analyzed in accordance with the chain of custody document. This analytical report must be reproduced in its entirety.



LT Environmental, Inc.
4600 West 60th Avenue
Arvada CO, 80003

Project: PDC - Pfenning # 43 & 44-31

Project Number: PDC 08159
Project Manager: Brian Dodek

Reported:
12/13/10 13:12

MW07
R012050-07 (Water)

Summit Scientific

Volatile Organic Compounds by EPA Method 8260B

Date Sampled: 12/07/10 13:00

Analyte	Result	Reporting		Units	Dilution	Batch	Prepared	Analyzed	Method	Notes
		Limit								
Benzene	ND	1.0		ug/l	1	0121004	12/10/10	12/12/10	EPA 8260B	
Toluene	ND	1.0		"	"	"	"	"	"	
Ethylbenzene	ND	1.0		"	"	"	"	"	"	
Xylenes (total)	ND	1.0		"	"	"	"	"	"	

Date Sampled: 12/07/10 13:00

Analyte	Result	Reporting		Units	Dilution	Batch	Prepared	Analyzed	Method	Notes
		Limit								
Surrogate: 1,2-Dichloroethane-d4		113 %		57.9-139		"	"	"	"	
Surrogate: Toluene-d8		97.7 %		83.1-115		"	"	"	"	
Surrogate: 4-Bromofluorobenzene		98.4 %		80.8-120		"	"	"	"	

Summit Scientific

The results in this report apply to the samples analyzed in accordance with the chain of custody document. This analytical report must be reproduced in its entirety.



LT Environmental, Inc.
4600 West 60th Avenue
Arvada CO, 80003

Project: PDC - Pfenning # 43 & 44-31
Project Number: PDC 08159
Project Manager: Brian Dodek

Reported:
12/13/10 13:12

Volatile Organic Compounds by EPA Method 8260B - Quality Control

Summit Scientific

Analyte	Reporting			Spike	Source		%REC		RPD	
	Result	Limit	Units	Level	Result	%REC	Limits	RPD	Limit	Notes

Batch 0121004 - EPA 5030 Water MS

Blank (0121004-BLK1)

Prepared & Analyzed: 12/10/10

Benzene	ND	1.0	ug/l							
Toluene	ND	1.0	"							
Ethylbenzene	ND	1.0	"							
Xylenes (total)	ND	1.0	"							
Surrogate: 1,2-Dichloroethane-d4	14.2		"	13.3	107	57.9-139				
Surrogate: Toluene-d8	12.8		"	13.3	96.2	83.1-115				
Surrogate: 4-Bromofluorobenzene	13.4		"	13.3	101	80.8-120				

Blank (0121004-BLK2)

Prepared & Analyzed: 12/10/10

Benzene	ND	1.0	ug/l							
Toluene	ND	1.0	"							
Ethylbenzene	ND	1.0	"							
Xylenes (total)	ND	1.0	"							
Surrogate: 1,2-Dichloroethane-d4	14.0		"	13.3	105	57.9-139				
Surrogate: Toluene-d8	13.0		"	13.3	97.9	83.1-115				
Surrogate: 4-Bromofluorobenzene	13.4		"	13.3	100	80.8-120				

LCS (0121004-BS1)

Prepared & Analyzed: 12/10/10

Benzene	32.7	1.0	ug/l	33.3	98.2	60.1-131			10.9	
Toluene	32.9	1.0	"	33.3	98.6	65.9-127			11.3	
Ethylbenzene	31.7	1.0	"	33.3	95.2	65.1-129			20	
m,p-Xylene	62.2	2.0	"	66.7	93.3	66.8-127			20	
o-Xylene	31.2	1.0	"	33.3	93.5	61.2-120			20	
Surrogate: 1,2-Dichloroethane-d4	14.6		"	13.3	110	57.9-139				
Surrogate: Toluene-d8	13.7		"	13.3	103	83.1-115				
Surrogate: 4-Bromofluorobenzene	13.6		"	13.3	102	80.8-120				

LCS (0121004-BS2)

Prepared & Analyzed: 12/10/10

Benzene	31.3	1.0	ug/l	33.3	93.8	60.1-131			10.9	
Toluene	31.2	1.0	"	33.3	93.7	65.9-127			11.3	
Ethylbenzene	30.7	1.0	"	33.3	92.2	65.1-129			20	
m,p-Xylene	59.6	2.0	"	66.7	89.3	66.8-127			20	
o-Xylene	30.2	1.0	"	33.3	90.7	61.2-120			20	
Surrogate: 1,2-Dichloroethane-d4	14.3		"	13.3	107	57.9-139				
Surrogate: Toluene-d8	13.2		"	13.3	99.3	83.1-115				
Surrogate: 4-Bromofluorobenzene	13.5		"	13.3	101	80.8-120				

Summit Scientific

The results in this report apply to the samples analyzed in accordance with the chain of custody document. This analytical report must be reproduced in its entirety.



LT Environmental, Inc.
4600 West 60th Avenue
Arvada CO, 80003

Project: PDC - Pfenning # 43 & 44-31

Project Number: PDC 08159
Project Manager: Brian Dodek

Reported:
12/13/10 13:12

Volatile Organic Compounds by EPA Method 8260B - Quality Control
Summit Scientific

Analyte	Reporting			Spike	Source		%REC		RPD	
	Result	Limit	Units	Level	Result	%REC	Limits	RPD	Limit	Notes

Batch 0121004 - EPA 5030 Water MS

LCS Dup (0121004-BSD1)

Prepared & Analyzed: 12/10/10

Benzene	31.9	1.0	ug/l	33.3		95.7	60.1-131	2.54	10.9	
Toluene	32.7	1.0	"	33.3		98.1	65.9-127	0.488	11.3	
Ethylbenzene	31.2	1.0	"	33.3		93.5	65.1-129	1.75	20	
m,p-Xylene	61.4	2.0	"	66.7		92.0	66.8-127	1.41	20	
o-Xylene	30.5	1.0	"	33.3		91.5	61.2-120	2.24	20	
Surrogate: 1,2-Dichloroethane-d4	14.8		"	13.3		111	57.9-139			
Surrogate: Toluene-d8	13.5		"	13.3		101	83.1-115			
Surrogate: 4-Bromofluorobenzene	13.6		"	13.3		102	80.8-120			

LCS Dup (0121004-BSD2)

Prepared & Analyzed: 12/10/10

Benzene	32.7	1.0	ug/l	33.3		98.1	60.1-131	4.50	10.9	
Toluene	32.3	1.0	"	33.3		96.8	65.9-127	3.31	11.3	
Ethylbenzene	31.7	1.0	"	33.3		95.2	65.1-129	3.20	20	
m,p-Xylene	62.0	2.0	"	66.7		93.0	66.8-127	4.01	20	
o-Xylene	31.5	1.0	"	33.3		94.4	61.2-120	3.99	20	
Surrogate: 1,2-Dichloroethane-d4	14.3		"	13.3		107	57.9-139			
Surrogate: Toluene-d8	12.9		"	13.3		97.0	83.1-115			
Surrogate: 4-Bromofluorobenzene	13.5		"	13.3		102	80.8-120			

Matrix Spike (0121004-MS1)

Source: R012048-03

Prepared & Analyzed: 12/10/10

Benzene	31.8	1.0	ug/l	33.3	ND	95.4	52.7-130		19.3	
Toluene	31.8	1.0	"	33.3	ND	95.4	57-127		18.7	
Ethylbenzene	31.1	1.0	"	33.3	ND	93.2	59.2-127		20	
m,p-Xylene	60.6	2.0	"	66.7	ND	90.9	53.2-132		20	
o-Xylene	30.4	1.0	"	33.3	ND	91.3	56.3-117		20	
Surrogate: 1,2-Dichloroethane-d4	14.5		"	13.3		109	57.9-139			
Surrogate: Toluene-d8	13.5		"	13.3		101	83.1-115			
Surrogate: 4-Bromofluorobenzene	14.2		"	13.3		107	80.8-120			

Summit Scientific

The results in this report apply to the samples analyzed in accordance with the chain of custody document. This analytical report must be reproduced in its entirety.



LT Environmental, Inc.
4600 West 60th Avenue
Arvada CO, 80003

Project: PDC - Pfenning # 43 & 44-31

Project Number: PDC 08159
Project Manager: Brian Dodek

Reported:
12/13/10 13:12

Volatile Organic Compounds by EPA Method 8260B - Quality Control
Summit Scientific

Analyte	Reporting			Spike	Source		%REC		RPD	
	Result	Limit	Units	Level	Result	%REC	Limits	RPD	Limit	Notes

Batch 0121004 - EPA 5030 Water MS

Matrix Spike (0121004-MS2)		Source: R012048-04			Prepared: 12/10/10		Analyzed: 12/11/10			
Benzene	31.6	1.0	ug/l	33.3	ND	94.9	52.7-130		19.3	
Toluene	32.0	1.0	"	33.3	ND	95.9	57-127		18.7	
Ethylbenzene	30.5	1.0	"	33.3	ND	91.5	59.2-127		20	
m,p-Xylene	59.0	2.0	"	66.7	ND	88.6	53.2-132		20	
o-Xylene	30.8	1.0	"	33.3	ND	92.5	56.3-117		20	
Surrogate: 1,2-Dichloroethane-d4	14.6		"	13.3		109	57.9-139			
Surrogate: Toluene-d8	13.3		"	13.3		100	83.1-115			
Surrogate: 4-Bromofluorobenzene	13.8		"	13.3		103	80.8-120			

Matrix Spike Dup (0121004-MSD1)		Source: R012048-03			Prepared: 12/10/10		Analyzed: 12/11/10			
Benzene	32.7	1.0	ug/l	33.3	ND	98.1	52.7-130	2.82	19.3	
Toluene	32.5	1.0	"	33.3	ND	97.6	57-127	2.24	18.7	
Ethylbenzene	31.0	1.0	"	33.3	ND	92.9	59.2-127	0.355	20	
m,p-Xylene	59.9	2.0	"	66.7	ND	89.8	53.2-132	1.21	20	
o-Xylene	30.6	1.0	"	33.3	ND	91.7	56.3-117	0.393	20	
Surrogate: 1,2-Dichloroethane-d4	15.1		"	13.3		113	57.9-139			
Surrogate: Toluene-d8	13.4		"	13.3		100	83.1-115			
Surrogate: 4-Bromofluorobenzene	13.4		"	13.3		100	80.8-120			

Matrix Spike Dup (0121004-MSD2)		Source: R012048-04			Prepared: 12/10/10		Analyzed: 12/11/10			
Benzene	30.7	1.0	ug/l	33.3	ND	92.2	52.7-130	2.92	19.3	
Toluene	31.0	1.0	"	33.3	ND	92.9	57-127	3.21	18.7	
Ethylbenzene	30.2	1.0	"	33.3	ND	90.5	59.2-127	1.15	20	
m,p-Xylene	58.6	2.0	"	66.7	ND	87.9	53.2-132	0.816	20	
o-Xylene	29.8	1.0	"	33.3	ND	89.5	56.3-117	3.30	20	
Surrogate: 1,2-Dichloroethane-d4	14.3		"	13.3		107	57.9-139			
Surrogate: Toluene-d8	13.0		"	13.3		97.2	83.1-115			
Surrogate: 4-Bromofluorobenzene	13.3		"	13.3		99.7	80.8-120			

Summit Scientific

The results in this report apply to the samples analyzed in accordance with the chain of custody document. This analytical report must be reproduced in its entirety.



LT Environmental, Inc.
4600 West 60th Avenue
Arvada CO, 80003

Project: PDC - Pfenning # 43 & 44-31

Project Number: PDC 08159
Project Manager: Brian Dodek

Reported:
12/13/10 13:12

Notes and Definitions

DET Analyte DETECTED
ND Analyte NOT DETECTED at or above the reporting limit
NR Not Reported
dry Sample results reported on a dry weight basis
RPD Relative Percent Difference

Summit Scientific

A handwritten signature in black ink, appearing to be 'JD' or similar, with a long horizontal stroke extending to the right.

The results in this report apply to the samples analyzed in accordance with the chain of custody document. This analytical report must be reproduced in its entirety.

Summit Scientific

741 Corporate Circle – Suite I ♦ Golden, Colorado 80401

303.277.9310 - laboratory ♦ 303.277.9531 - fax

March 12, 2011

Brian Dodek
LT Environmental, Inc.
4600 West 60th Avenue
Arvada, CO 80003
RE: PDC - Pfenning # 43 & 44-31

Enclosed are the results of analyses for samples received by Summit Scientific on 03/03/11 16:57. If you have any questions concerning this report, please feel free to contact me.

Sincerely,

A handwritten signature in blue ink, appearing to be 'PS' followed by a long, sweeping horizontal line.

Paul Shrewsbury For Ben Shrewsbury
President / Laboratory Director



LT Environmental, Inc.
4600 West 60th Avenue
Arvada CO, 80003

Project: PDC - Pfenning # 43 & 44-31

Project Number: PDC 08159.01
Project Manager: Brian Dodek

Reported:
03/12/11 14:08

ANALYTICAL REPORT FOR SAMPLES

Sample ID	Laboratory ID	Matrix	Date Sampled	Date Received
MW01	R103031-01	Water	03/03/11 11:25	03/03/11 16:57
MW02	R103031-02	Water	03/03/11 11:30	03/03/11 16:57
MW03	R103031-03	Water	03/03/11 11:35	03/03/11 16:57
MW04	R103031-04	Water	03/03/11 11:40	03/03/11 16:57
MW05	R103031-05	Water	03/03/11 11:45	03/03/11 16:57
MW06	R103031-06	Water	03/03/11 11:50	03/03/11 16:57
MW07	R103031-07	Water	03/03/11 11:55	03/03/11 16:57

Summit Scientific

The results in this report apply to the samples analyzed in accordance with the chain of custody document. This analytical report must be reproduced in its entirety.



LT Environmental, Inc.
4600 West 60th Avenue
Arvada CO, 80003

Project: PDC - Pfenning # 43 & 44-31

Project Number: PDC 08159.01
Project Manager: Brian Dodek

Reported:
03/12/11 14:08

MW01
R103031-01 (Water)

Summit Scientific

Volatile Organic Compounds by EPA Method 8260B

Date Sampled: **03/03/11 11:25**

Analyte	Result	Reporting Limit	Units	Dilution	Batch	Prepared	Analyzed	Method	Notes
Benzene	100	1.0	ug/l	1	1030406	03/04/11	03/10/11	EPA 8260B	
Toluene	ND	1.0	"	"	"	"	"	"	
Ethylbenzene	ND	1.0	"	"	"	"	"	"	
Xylenes (total)	ND	1.0	"	"	"	"	"	"	

Date Sampled: **03/03/11 11:25**

Analyte	Result	Reporting Limit	Units	Dilution	Batch	Prepared	Analyzed	Method	Notes
<i>Surrogate: 1,2-Dichloroethane-d4</i>		<i>105 %</i>	<i>57.9-139</i>		<i>"</i>	<i>"</i>	<i>"</i>	<i>"</i>	
<i>Surrogate: Toluene-d8</i>		<i>103 %</i>	<i>83.1-115</i>		<i>"</i>	<i>"</i>	<i>"</i>	<i>"</i>	
<i>Surrogate: 4-Bromofluorobenzene</i>		<i>96.0 %</i>	<i>80.8-120</i>		<i>"</i>	<i>"</i>	<i>"</i>	<i>"</i>	

Summit Scientific

The results in this report apply to the samples analyzed in accordance with the chain of custody document. This analytical report must be reproduced in its entirety.



LT Environmental, Inc.
4600 West 60th Avenue
Arvada CO, 80003

Project: PDC - Pfenning # 43 & 44-31

Project Number: PDC 08159.01
Project Manager: Brian Dodek

Reported:
03/12/11 14:08

MW02
R103031-02 (Water)

Summit Scientific

Volatile Organic Compounds by EPA Method 8260B

Date Sampled: **03/03/11 11:30**

Analyte	Result	Reporting		Units	Dilution	Batch	Prepared	Analyzed	Method	Notes
		Limit								
Benzene	ND	1.0		ug/l	1	1030406	03/04/11	03/10/11	EPA 8260B	
Toluene	ND	1.0		"	"	"	"	"	"	
Ethylbenzene	ND	1.0		"	"	"	"	"	"	
Xylenes (total)	ND	1.0		"	"	"	"	"	"	

Date Sampled: **03/03/11 11:30**

Analyte	Result	Reporting		Units	Dilution	Batch	Prepared	Analyzed	Method	Notes
		Limit								
Surrogate: 1,2-Dichloroethane-d4		105 %		57.9-139		"	"	"	"	
Surrogate: Toluene-d8		105 %		83.1-115		"	"	"	"	
Surrogate: 4-Bromofluorobenzene		98.6 %		80.8-120		"	"	"	"	

Summit Scientific

The results in this report apply to the samples analyzed in accordance with the chain of custody document. This analytical report must be reproduced in its entirety.



LT Environmental, Inc.
4600 West 60th Avenue
Arvada CO, 80003

Project: PDC - Pfenning # 43 & 44-31

Project Number: PDC 08159.01
Project Manager: Brian Dodek

Reported:
03/12/11 14:08

MW03
R103031-03 (Water)

Summit Scientific

Volatile Organic Compounds by EPA Method 8260B

Date Sampled: **03/03/11 11:35**

Analyte	Result	Reporting		Units	Dilution	Batch	Prepared	Analyzed	Method	Notes
		Limit								
Benzene	ND	1.0		ug/l	1	1030406	03/04/11	03/10/11	EPA 8260B	
Toluene	ND	1.0		"	"	"	"	"	"	
Ethylbenzene	ND	1.0		"	"	"	"	"	"	
Xylenes (total)	ND	1.0		"	"	"	"	"	"	

Date Sampled: **03/03/11 11:35**

Analyte	Result	Reporting		Units	Dilution	Batch	Prepared	Analyzed	Method	Notes
		Limit								
Surrogate: 1,2-Dichloroethane-d4		106 %		57.9-139		"	"	"	"	
Surrogate: Toluene-d8		102 %		83.1-115		"	"	"	"	
Surrogate: 4-Bromofluorobenzene		92.8 %		80.8-120		"	"	"	"	

Summit Scientific

The results in this report apply to the samples analyzed in accordance with the chain of custody document. This analytical report must be reproduced in its entirety.



LT Environmental, Inc.
4600 West 60th Avenue
Arvada CO, 80003

Project: PDC - Pfenning # 43 & 44-31

Project Number: PDC 08159.01
Project Manager: Brian Dodek

Reported:
03/12/11 14:08

MW04
R103031-04 (Water)

Summit Scientific

Volatile Organic Compounds by EPA Method 8260B

Date Sampled: **03/03/11 11:40**

Analyte	Result	Reporting		Dilution	Batch	Prepared	Analyzed	Method	Notes
		Limit	Units						
Benzene	ND	1.0	ug/l	1	1030406	03/04/11	03/10/11	EPA 8260B	
Toluene	ND	1.0	"	"	"	"	"	"	
Ethylbenzene	ND	1.0	"	"	"	"	"	"	
Xylenes (total)	ND	1.0	"	"	"	"	"	"	

Date Sampled: **03/03/11 11:40**

Analyte	Result	Reporting		Dilution	Batch	Prepared	Analyzed	Method	Notes
		Limit	Units						
Surrogate: 1,2-Dichloroethane-d4		105 %	57.9-139		"	"	"	"	
Surrogate: Toluene-d8		102 %	83.1-115		"	"	"	"	
Surrogate: 4-Bromofluorobenzene		97.1 %	80.8-120		"	"	"	"	

Summit Scientific

The results in this report apply to the samples analyzed in accordance with the chain of custody document. This analytical report must be reproduced in its entirety.



LT Environmental, Inc.
4600 West 60th Avenue
Arvada CO, 80003

Project: PDC - Pfenning # 43 & 44-31

Project Number: PDC 08159.01
Project Manager: Brian Dodek

Reported:
03/12/11 14:08

MW05
R103031-05 (Water)

Summit Scientific

Volatile Organic Compounds by EPA Method 8260B

Date Sampled: **03/03/11 11:45**

Analyte	Result	Reporting		Dilution	Batch	Prepared	Analyzed	Method	Notes
		Limit	Units						
Benzene	ND	1.0	ug/l	1	1030406	03/04/11	03/10/11	EPA 8260B	
Toluene	ND	1.0	"	"	"	"	"	"	
Ethylbenzene	ND	1.0	"	"	"	"	"	"	
Xylenes (total)	ND	1.0	"	"	"	"	"	"	

Date Sampled: **03/03/11 11:45**

Analyte	Result	Reporting		Dilution	Batch	Prepared	Analyzed	Method	Notes
		Limit	Units						
Surrogate: 1,2-Dichloroethane-d4		110 %	57.9-139		"	"	"	"	
Surrogate: Toluene-d8		103 %	83.1-115		"	"	"	"	
Surrogate: 4-Bromofluorobenzene		101 %	80.8-120		"	"	"	"	

Summit Scientific

The results in this report apply to the samples analyzed in accordance with the chain of custody document. This analytical report must be reproduced in its entirety.



LT Environmental, Inc.
4600 West 60th Avenue
Arvada CO, 80003

Project: PDC - Pfenning # 43 & 44-31

Project Number: PDC 08159.01
Project Manager: Brian Dodek

Reported:
03/12/11 14:08

MW06
R103031-06 (Water)

Summit Scientific

Volatile Organic Compounds by EPA Method 8260B

Date Sampled: **03/03/11 11:50**

Analyte	Result	Reporting		Units	Dilution	Batch	Prepared	Analyzed	Method	Notes
		Limit								
Benzene	ND	1.0		ug/l	1	1030406	03/04/11	03/10/11	EPA 8260B	
Toluene	ND	1.0		"	"	"	"	"	"	
Ethylbenzene	ND	1.0		"	"	"	"	"	"	
Xylenes (total)	ND	1.0		"	"	"	"	"	"	

Date Sampled: **03/03/11 11:50**

Analyte	Result	Reporting		Units	Dilution	Batch	Prepared	Analyzed	Method	Notes
		Limit								
Surrogate: 1,2-Dichloroethane-d4		104 %		57.9-139		"	"	"	"	
Surrogate: Toluene-d8		102 %		83.1-115		"	"	"	"	
Surrogate: 4-Bromofluorobenzene		99.5 %		80.8-120		"	"	"	"	

Summit Scientific

The results in this report apply to the samples analyzed in accordance with the chain of custody document. This analytical report must be reproduced in its entirety.



LT Environmental, Inc.
4600 West 60th Avenue
Arvada CO, 80003

Project: PDC - Pfenning # 43 & 44-31

Project Number: PDC 08159.01
Project Manager: Brian Dodek

Reported:
03/12/11 14:08

MW07
R103031-07 (Water)

Summit Scientific

Volatile Organic Compounds by EPA Method 8260B

Date Sampled: **03/03/11 11:55**

Analyte	Result	Reporting		Units	Dilution	Batch	Prepared	Analyzed	Method	Notes
		Limit								
Benzene	ND	1.0		ug/l	1	1030406	03/04/11	03/10/11	EPA 8260B	
Toluene	ND	1.0		"	"	"	"	"	"	
Ethylbenzene	ND	1.0		"	"	"	"	"	"	
Xylenes (total)	ND	1.0		"	"	"	"	"	"	

Date Sampled: **03/03/11 11:55**

Analyte	Result	Reporting		Units	Dilution	Batch	Prepared	Analyzed	Method	Notes
		Limit								
Surrogate: 1,2-Dichloroethane-d4		107 %		57.9-139		"	"	"	"	
Surrogate: Toluene-d8		104 %		83.1-115		"	"	"	"	
Surrogate: 4-Bromofluorobenzene		102 %		80.8-120		"	"	"	"	

Summit Scientific

The results in this report apply to the samples analyzed in accordance with the chain of custody document. This analytical report must be reproduced in its entirety.



LT Environmental, Inc.
4600 West 60th Avenue
Arvada CO, 80003

Project: PDC - Pfenning # 43 & 44-31

Project Number: PDC 08159.01
Project Manager: Brian Dodek

Reported:
03/12/11 14:08

Volatile Organic Compounds by EPA Method 8260B - Quality Control

Summit Scientific

Analyte	Reporting			Spike	Source		%REC		RPD	
	Result	Limit	Units	Level	Result	%REC	Limits	RPD	Limit	Notes

Batch 1030406 - EPA 5030 Water MS

Blank (1030406-BLK1)

Prepared: 03/04/11 Analyzed: 03/10/11

Benzene	ND	1.0	ug/l							
Toluene	ND	1.0	"							
Ethylbenzene	ND	1.0	"							
Xylenes (total)	ND	1.0	"							
Surrogate: 1,2-Dichloroethane-d4	13.7		"	13.3	102	57.9-139				
Surrogate: Toluene-d8	13.3		"	13.3	99.8	83.1-115				
Surrogate: 4-Bromofluorobenzene	12.9		"	13.3	96.6	80.8-120				

LCS (1030406-BS1)

Prepared: 03/04/11 Analyzed: 03/10/11

Benzene	38.6	1.0	ug/l	33.3	116	60.1-131			10.9	
Toluene	37.9	1.0	"	33.3	114	65.9-127			11.3	
Ethylbenzene	37.0	1.0	"	33.3	111	65.1-129			20	
m,p-Xylene	76.8	2.0	"	66.7	115	66.8-127			20	
o-Xylene	36.6	1.0	"	33.3	110	61.2-120			20	
Surrogate: 1,2-Dichloroethane-d4	13.6		"	13.3	102	57.9-139				
Surrogate: Toluene-d8	13.9		"	13.3	104	83.1-115				
Surrogate: 4-Bromofluorobenzene	12.6		"	13.3	94.9	80.8-120				

LCS Dup (1030406-BSD1)

Prepared: 03/04/11 Analyzed: 03/10/11

Benzene	32.4	1.0	ug/l	33.3	97.1	60.1-131	17.5		10.9	
Toluene	31.4	1.0	"	33.3	94.2	65.9-127	18.7		11.3	
Ethylbenzene	33.4	1.0	"	33.3	100	65.1-129	9.94		20	
m,p-Xylene	66.7	2.0	"	66.7	100	66.8-127	14.1		20	
o-Xylene	33.7	1.0	"	33.3	101	61.2-120	8.33		20	
Surrogate: 1,2-Dichloroethane-d4	13.8		"	13.3	103	57.9-139				
Surrogate: Toluene-d8	13.9		"	13.3	104	83.1-115				
Surrogate: 4-Bromofluorobenzene	13.8		"	13.3	104	80.8-120				

Summit Scientific

The results in this report apply to the samples analyzed in accordance with the chain of custody document. This analytical report must be reproduced in its entirety.



LT Environmental, Inc.
4600 West 60th Avenue
Arvada CO, 80003

Project: PDC - Pfenning # 43 & 44-31

Project Number: PDC 08159.01
Project Manager: Brian Dodek

Reported:
03/12/11 14:08

Volatile Organic Compounds by EPA Method 8260B - Quality Control
Summit Scientific

Analyte	Reporting			Spike	Source		%REC		RPD	
	Result	Limit	Units	Level	Result	%REC	Limits	RPD	Limit	Notes

Batch 1030406 - EPA 5030 Water MS

Matrix Spike (1030406-MS1)				Source: R103030-01		Prepared: 03/04/11		Analyzed: 03/10/11		
Benzene	34.8	1.0	ug/l	33.3	ND	104	52.7-130		19.3	
Toluene	35.6	1.0	"	33.3	ND	107	57-127		18.7	
Ethylbenzene	36.0	1.0	"	33.3	ND	108	59.2-127		20	
m,p-Xylene	74.6	2.0	"	66.7	1.24	110	53.2-132		20	
o-Xylene	36.0	1.0	"	33.3	ND	108	56.3-117		20	
Surrogate: 1,2-Dichloroethane-d4	13.5		"	13.3		101	57.9-139			
Surrogate: Toluene-d8	13.8		"	13.3		103	83.1-115			
Surrogate: 4-Bromofluorobenzene	13.0		"	13.3		97.1	80.8-120			
Matrix Spike Dup (1030406-MSD1)				Source: R103030-01		Prepared: 03/04/11		Analyzed: 03/10/11		
Benzene	34.4	1.0	ug/l	33.3	ND	103	52.7-130	1.21	19.3	
Toluene	34.3	1.0	"	33.3	ND	103	57-127	3.60	18.7	
Ethylbenzene	34.8	1.0	"	33.3	ND	104	59.2-127	3.47	20	
m,p-Xylene	70.7	2.0	"	66.7	1.24	104	53.2-132	5.42	20	
o-Xylene	34.6	1.0	"	33.3	ND	104	56.3-117	3.80	20	
Surrogate: 1,2-Dichloroethane-d4	14.4		"	13.3		108	57.9-139			
Surrogate: Toluene-d8	13.7		"	13.3		103	83.1-115			
Surrogate: 4-Bromofluorobenzene	12.4		"	13.3		92.7	80.8-120			

Summit Scientific

The results in this report apply to the samples analyzed in accordance with the chain of custody document. This analytical report must be reproduced in its entirety.



LT Environmental, Inc.
4600 West 60th Avenue
Arvada CO, 80003

Project: PDC - Pfenning # 43 & 44-31

Project Number: PDC 08159.01
Project Manager: Brian Dodek

Reported:
03/12/11 14:08

Notes and Definitions

DET Analyte DETECTED
ND Analyte NOT DETECTED at or above the reporting limit
NR Not Reported
dry Sample results reported on a dry weight basis
RPD Relative Percent Difference

Summit Scientific

A handwritten signature in black ink, appearing to be 'JD' or similar, with a long horizontal stroke extending to the right.

The results in this report apply to the samples analyzed in accordance with the chain of custody document. This analytical report must be reproduced in its entirety.

Summit Scientific

741 Corporate Circle – Suite I ♦ Golden, Colorado 80401

303.277.9310 - laboratory ♦ 303.277.9531 - fax

April 21, 2011

Brian Dodek

LT Environmental, Inc.

4600 West 60th Avenue

Arvada, CO 80003

RE: PDC - Pfenning # 43 & 44-31

Enclosed are the results of analyses for samples received by Summit Scientific on 04/15/11 17:00. If you have any questions concerning this report, please feel free to contact me.

Sincerely,

A handwritten signature in blue ink, appearing to be 'PS' followed by a long horizontal flourish.

Paul Shrewsbury For Ben Shrewsbury
President / Laboratory Director

LT Environmental, Inc.
4600 West 60th Avenue
Arvada CO, 80003

Project: PDC - Pfenning # 43 & 44-31

Project Number: PDC 08159
Project Manager: Brian Dodek

Reported:
04/21/11 11:21

ANALYTICAL REPORT FOR SAMPLES

Sample ID	Laboratory ID	Matrix	Date Sampled	Date Received
MW08	R104094-01	Water	04/15/11 11:00	04/15/11 17:00

R104094

Summit Scientific

741 Corporate Circle Suite I ♦ Golden, Colorado 80401
303-277-9310 ♦ 303-277-9531 Fax

Page _____ of _____

Client: LT Environmental, Inc.

Address: 4600 West 60th Avenue

City/State/Zip: Arvada, CO 80003

Phone: (303) 433-9788

Sample Name:	Q	3
--------------	---	---

Sample Name.	Y	Z
1	1	1
2	1	1
3	1	1
4	1	1
5	1	1
6	1	1
7	1	1
8	1	1
9	1	1
10	1	1
11	1	1
12	1	1
13	1	1
14	1	1
15	1	1
16	1	1
17	1	1
18	1	1
19	1	1
20	1	1
21	1	1
22	1	1
23	1	1
24	1	1
25	1	1
26	1	1
27	1	1
28	1	1
29	1	1
30	1	1
31	1	1
32	1	1
33	1	1
34	1	1
35	1	1
36	1	1
37	1	1
38	1	1
39	1	1
40	1	1
41	1	1
42	1	1
43	1	1
44	1	1
45	1	1
46	1	1
47	1	1
48	1	1
49	1	1
50	1	1
51	1	1
52	1	1
53	1	1
54	1	1
55	1	1
56	1	1
57	1	1
58	1	1
59	1	1
60	1	1
61	1	1
62	1	1
63	1	1
64	1	1
65	1	1
66	1	1
67	1	1
68	1	1
69	1	1
70	1	1
71	1	1
72	1	1
73	1	1
74	1	1
75	1	1
76	1	1
77	1	1
78	1	1
79	1	1
80	1	1
81	1	1
82	1	1
83	1	1
84	1	1
85	1	1
86	1	1
87	1	1
88	1	1
89	1	1
90	1	1
91	1	1
92	1	1
93	1	1
94	1	1
95	1	1
96	1	1
97	1	1
98	1	1
99	1	1
100	1	1

Project Manager: Brian Dodek

E-Mail: bdadek@ltern

Project Name: P f e n

[illegible]

Project Number:

[illegible]

www.s2scientific.com

Summit Scientific

The results in this report apply to the samples analyzed in accordance with the chain of custody document. This analytical report must be reproduced in its entirety.



LT Environmental, Inc.
4600 West 60th Avenue
Arvada CO, 80003

Project: PDC - Pfenning # 43 & 44-31

Project Number: PDC 08159
Project Manager: Brian Dodek

Reported:
04/21/11 11:21

MW08
R104094-01 (Water)

Summit Scientific

Volatile Organic Compounds by EPA Method 8260B

Date Sampled: **04/15/11 11:00**

Analyte	Result	Reporting Limit	Units	Dilution	Batch	Prepared	Analyzed	Method	Notes
Benzene	ND	1.0	ug/l	1	1041803	04/18/11	04/18/11	EPA 8260B	
Toluene	ND	1.0	"	"	"	"	"	"	
Ethylbenzene	ND	1.0	"	"	"	"	"	"	
Xylenes (total)	ND	1.0	"	"	"	"	"	"	

Date Sampled: **04/15/11 11:00**

Analyte	Result	Reporting Limit	Units	Dilution	Batch	Prepared	Analyzed	Method	Notes
Surrogate: 1,2-Dichloroethane-d4		118 %	57.9-139		"	"	"	"	
Surrogate: Toluene-d8		108 %	83.1-115		"	"	"	"	
Surrogate: 4-Bromofluorobenzene		109 %	80.8-120		"	"	"	"	

Summit Scientific

The results in this report apply to the samples analyzed in accordance with the chain of custody document. This analytical report must be reproduced in its entirety.



LT Environmental, Inc.
4600 West 60th Avenue
Arvada CO, 80003

Project: PDC - Pfenning # 43 & 44-31

Project Number: PDC 08159
Project Manager: Brian Dodek

Reported:
04/21/11 11:21

Volatile Organic Compounds by EPA Method 8260B - Quality Control

Summit Scientific

Analyte	Reporting			Spike	Source		%REC		RPD	
	Result	Limit	Units	Level	Result	%REC	Limits	RPD	Limit	Notes

Batch 1041803 - EPA 5030 Water MS

Blank (1041803-BLK1)

Prepared & Analyzed: 04/18/11

Benzene	ND	1.0	ug/l							
Toluene	ND	1.0	"							
Ethylbenzene	ND	1.0	"							
Xylenes (total)	ND	1.0	"							
Surrogate: 1,2-Dichloroethane-d4	14.6		"	13.3	109	57.9-139				
Surrogate: Toluene-d8	13.9		"	13.3	104	83.1-115				
Surrogate: 4-Bromofluorobenzene	14.5		"	13.3	109	80.8-120				

LCS (1041803-BS1)

Prepared & Analyzed: 04/18/11

Benzene	33.5	1.0	ug/l	33.3	100	60.1-131		10.9		
Toluene	32.3	1.0	"	33.3	97.0	65.9-127		11.3		
Ethylbenzene	32.5	1.0	"	33.3	97.6	65.1-129		20		
m,p-Xylene	66.2	2.0	"	66.7	99.3	66.8-127		20		
o-Xylene	30.3	1.0	"	33.3	90.9	61.2-120		20		
Surrogate: 1,2-Dichloroethane-d4	15.7		"	13.3	118	57.9-139				
Surrogate: Toluene-d8	14.6		"	13.3	110	83.1-115				
Surrogate: 4-Bromofluorobenzene	14.1		"	13.3	106	80.8-120				

LCS Dup (1041803-BSD1)

Prepared & Analyzed: 04/18/11

Benzene	31.8	1.0	ug/l	33.3	95.3	60.1-131	5.21	10.9		
Toluene	31.1	1.0	"	33.3	93.4	65.9-127	3.78	11.3		
Ethylbenzene	30.8	1.0	"	33.3	92.3	65.1-129	5.56	20		
m,p-Xylene	62.5	2.0	"	66.7	93.7	66.8-127	5.78	20		
o-Xylene	29.0	1.0	"	33.3	87.0	61.2-120	4.45	20		
Surrogate: 1,2-Dichloroethane-d4	15.3		"	13.3	115	57.9-139				
Surrogate: Toluene-d8	14.5		"	13.3	109	83.1-115				
Surrogate: 4-Bromofluorobenzene	14.0		"	13.3	105	80.8-120				

Summit Scientific

The results in this report apply to the samples analyzed in accordance with the chain of custody document. This analytical report must be reproduced in its entirety.



LT Environmental, Inc.
4600 West 60th Avenue
Arvada CO, 80003

Project: PDC - Pfenning # 43 & 44-31
Project Number: PDC 08159
Project Manager: Brian Dodek

Reported:
04/21/11 11:21

Volatile Organic Compounds by EPA Method 8260B - Quality Control
Summit Scientific

Analyte	Reporting			Spike	Source		%REC		RPD	
	Result	Limit	Units	Level	Result	%REC	Limits	RPD	Limit	Notes

Batch 1041803 - EPA 5030 Water MS

Matrix Spike (1041803-MS1)		Source: R104097-01			Prepared & Analyzed: 04/18/11					
Benzene	32.9	1.0	ug/l	33.3	ND	98.7	52.7-130		19.3	
Toluene	31.9	1.0	"	33.3	ND	95.8	57-127		18.7	
Ethylbenzene	32.7	1.0	"	33.3	ND	98.0	59.2-127		20	
m,p-Xylene	65.7	2.0	"	66.7	ND	98.5	53.2-132		20	
o-Xylene	30.2	1.0	"	33.3	ND	90.7	56.3-117		20	
Surrogate: 1,2-Dichloroethane-d4	15.7		"	13.3		118	57.9-139			
Surrogate: Toluene-d8	14.5		"	13.3		109	83.1-115			
Surrogate: 4-Bromofluorobenzene	14.2		"	13.3		107	80.8-120			
Matrix Spike Dup (1041803-MSD1)		Source: R104097-01			Prepared & Analyzed: 04/18/11					
Benzene	33.2	1.0	ug/l	33.3	ND	99.8	52.7-130	1.09	19.3	
Toluene	32.4	1.0	"	33.3	ND	97.2	57-127	1.46	18.7	
Ethylbenzene	32.7	1.0	"	33.3	ND	98.0	59.2-127	0.00	20	
m,p-Xylene	66.5	2.0	"	66.7	ND	99.7	53.2-132	1.21	20	
o-Xylene	30.5	1.0	"	33.3	ND	91.6	56.3-117	0.987	20	
Surrogate: 1,2-Dichloroethane-d4	15.4		"	13.3		116	57.9-139			
Surrogate: Toluene-d8	14.6		"	13.3		110	83.1-115			
Surrogate: 4-Bromofluorobenzene	14.2		"	13.3		106	80.8-120			

Summit Scientific

The results in this report apply to the samples analyzed in accordance with the chain of custody document. This analytical report must be reproduced in its entirety.



LT Environmental, Inc.
4600 West 60th Avenue
Arvada CO, 80003

Project: PDC - Pfenning # 43 & 44-31

Project Number: PDC 08159
Project Manager: Brian Dodek

Reported:
04/21/11 11:21

Notes and Definitions

DET Analyte DETECTED
ND Analyte NOT DETECTED at or above the reporting limit
NR Not Reported
dry Sample results reported on a dry weight basis
RPD Relative Percent Difference

Summit Scientific

A handwritten signature in black ink, appearing to be 'JD' or similar, with a long horizontal stroke extending to the right.

The results in this report apply to the samples analyzed in accordance with the chain of custody document. This analytical report must be reproduced in its entirety.

Summit Scientific

741 Corporate Circle – Suite I ♦ Golden, Colorado 80401

303.277.9310 - laboratory ♦ 303.277.9531 - fax

June 13, 2011

Brian Dodek
LT Environmental, Inc.
4600 West 60th Avenue
Arvada, CO 80003
RE: PDC - Pfenning # 43 & 44-31

Enclosed are the results of analyses for samples received by Summit Scientific on 06/06/11 17:00. If you have any questions concerning this report, please feel free to contact me.

Sincerely,

A handwritten signature in black ink, appearing to read 'P. Shrewsbury', with a stylized, cursive script.

Paul Shrewsbury For Ben Shrewsbury
President / Laboratory Director



LT Environmental, Inc.
4600 West 60th Avenue
Arvada CO, 80003

Project: PDC - Pfenning # 43 & 44-31

Project Number: PDC 08159
Project Manager: Brian Dodek

Reported:
06/13/11 15:04

ANALYTICAL REPORT FOR SAMPLES

Sample ID	Laboratory ID	Matrix	Date Sampled	Date Received
MW01	R106051-01	Water	06/06/11 11:20	06/06/11 17:00
MW02	R106051-02	Water	06/06/11 11:25	06/06/11 17:00
MW03	R106051-03	Water	06/06/11 11:30	06/06/11 17:00
MW04	R106051-04	Water	06/06/11 11:35	06/06/11 17:00
MW05	R106051-05	Water	06/06/11 11:40	06/06/11 17:00
MW06	R106051-06	Water	06/06/11 11:45	06/06/11 17:00
MW07	R106051-07	Water	06/06/11 11:50	06/06/11 17:00
MW08	R106051-08	Water	06/06/11 11:55	06/06/11 17:00

Summit Scientific

The results in this report apply to the samples analyzed in accordance with the chain of custody document. This analytical report must be reproduced in its entirety.



LT Environmental, Inc.
4600 West 60th Avenue
Arvada CO, 80003

Project: PDC - Pfenning # 43 & 44-31

Project Number: PDC 08159
Project Manager: Brian Dodek

Reported:
06/13/11 15:04

R106051

Summit Scientific

741 Corporate Circle Suite 1 • Golden, Colorado 80401
303-277-9310 • 303-277-9531 Fax

Client: LT Environmental, Inc.
Address: 4600 West 60th Avenue
City/State/Zip: Arvada, CO 80003
Phone: (303) 433-9788
Fax: (303) 433-1432
Project Name: PDC 08159
Project Number: PDC 08159
Project Manager: Brian Dodek
E-Mail: bdodek@ltenv.com
Sampler Name: S. Regan
Page 1 of 1

Sample Description	Date Sampled	Time Sampled	Number of Containers	Preservative				Matrix		Analyze For:					Special Instructions			
				HCl	HNO ₃	None	Other (Specify)	Groundwater	Soil	Air - Canister Serial #	Other (Specify)	DRO	GBTEX	BTEX		Table 9.10 Full	Table 9.10 Short	PH / EC
MW01	6/6	1120	3	X	X			X				X	X	X				
MW02		1125	3	X	X			X				X	X	X				
MW03		1130	3	X	X			X				X	X	X				
MW04		1135	3	X	X			X				X	X	X				
MW05		1140	3	X	X			X				X	X	X				
MW06		1145	3	X	X			X				X	X	X				
MW07		1150	3	X	X			X				X	X	X				
MW08		1155	3	X	X			X				X	X	X				
Relinquished by:	Date/Time:			Received by:	Date/Time:			Turn Around Time (Check)						Notes:				
Relinquished by:	Date/Time:			Received by:	Date/Time:			Same Day	72 Hours									
Relinquished by:	Date/Time:			Received by:	Date/Time:			24 Hours	Standard									
Relinquished by:	Date/Time:			Received by:	Date/Time:			48 Hours										
									Sample Integrity:									
									Temperature Upon Receipt:									
									Intact:									
									Yes									
									No									

www.s2scientific.com

Summit Scientific

The results in this report apply to the samples analyzed in accordance with the chain of custody document. This analytical report must be reproduced in its entirety.



LT Environmental, Inc.
4600 West 60th Avenue
Arvada CO, 80003

Project: PDC - Pfenning # 43 & 44-31

Project Number: PDC 08159
Project Manager: Brian Dodek

Reported:
06/13/11 15:04

MW01
R106051-01 (Water)

Summit Scientific

Volatile Organic Compounds by EPA Method 8260B

Date Sampled: **06/06/11 11:20**

Analyte	Result	Reporting Limit	Units	Dilution	Batch	Prepared	Analyzed	Method	Notes
Benzene	7.4	1.0	ug/l	1	1061103	06/11/11	06/12/11	EPA 8260B	
Toluene	ND	1.0	"	"	"	"	"	"	
Ethylbenzene	ND	1.0	"	"	"	"	"	"	
Xylenes (total)	ND	1.0	"	"	"	"	"	"	

Date Sampled: **06/06/11 11:20**

Analyte	Result	Reporting Limit	Units	Dilution	Batch	Prepared	Analyzed	Method	Notes
<i>Surrogate: 1,2-Dichloroethane-d4</i>		<i>102 %</i>	<i>57.9-139</i>		<i>"</i>	<i>"</i>	<i>"</i>	<i>"</i>	
<i>Surrogate: Toluene-d8</i>		<i>97.3 %</i>	<i>83.1-115</i>		<i>"</i>	<i>"</i>	<i>"</i>	<i>"</i>	
<i>Surrogate: 4-Bromofluorobenzene</i>		<i>94.6 %</i>	<i>80.8-120</i>		<i>"</i>	<i>"</i>	<i>"</i>	<i>"</i>	

Summit Scientific

The results in this report apply to the samples analyzed in accordance with the chain of custody document. This analytical report must be reproduced in its entirety.



LT Environmental, Inc.
4600 West 60th Avenue
Arvada CO, 80003

Project: PDC - Pfenning # 43 & 44-31

Project Number: PDC 08159
Project Manager: Brian Dodek

Reported:
06/13/11 15:04

MW02
R106051-02 (Water)

Summit Scientific

Volatile Organic Compounds by EPA Method 8260B

Date Sampled: **06/06/11 11:25**

Analyte	Result	Reporting Limit	Units	Dilution	Batch	Prepared	Analyzed	Method	Notes
Benzene	ND	1.0	ug/l	1	1061103	06/11/11	06/12/11	EPA 8260B	
Toluene	ND	1.0	"	"	"	"	"	"	
Ethylbenzene	ND	1.0	"	"	"	"	"	"	
Xylenes (total)	ND	1.0	"	"	"	"	"	"	

Date Sampled: **06/06/11 11:25**

Analyte	Result	Reporting Limit	Units	Dilution	Batch	Prepared	Analyzed	Method	Notes
Surrogate: 1,2-Dichloroethane-d4		102 %	57.9-139		"	"	"	"	
Surrogate: Toluene-d8		99.8 %	83.1-115		"	"	"	"	
Surrogate: 4-Bromofluorobenzene		96.5 %	80.8-120		"	"	"	"	

Summit Scientific

The results in this report apply to the samples analyzed in accordance with the chain of custody document. This analytical report must be reproduced in its entirety.



LT Environmental, Inc.
4600 West 60th Avenue
Arvada CO, 80003

Project: PDC - Pfenning # 43 & 44-31

Project Number: PDC 08159
Project Manager: Brian Dodek

Reported:
06/13/11 15:04

MW03
R106051-03 (Water)

Summit Scientific

Volatile Organic Compounds by EPA Method 8260B

Date Sampled: **06/06/11 11:30**

Analyte	Result	Reporting		Units	Dilution	Batch	Prepared	Analyzed	Method	Notes
		Limit								
Benzene	ND	1.0		ug/l	1	1061103	06/11/11	06/12/11	EPA 8260B	
Toluene	ND	1.0		"	"	"	"	"	"	
Ethylbenzene	ND	1.0		"	"	"	"	"	"	
Xylenes (total)	ND	1.0		"	"	"	"	"	"	

Date Sampled: **06/06/11 11:30**

Analyte	Result	Reporting		Units	Dilution	Batch	Prepared	Analyzed	Method	Notes
		Limit								
Surrogate: 1,2-Dichloroethane-d4		104 %		57.9-139		"	"	"	"	
Surrogate: Toluene-d8		102 %		83.1-115		"	"	"	"	
Surrogate: 4-Bromofluorobenzene		96.2 %		80.8-120		"	"	"	"	

Summit Scientific

The results in this report apply to the samples analyzed in accordance with the chain of custody document. This analytical report must be reproduced in its entirety.



LT Environmental, Inc.
4600 West 60th Avenue
Arvada CO, 80003

Project: PDC - Pfenning # 43 & 44-31

Project Number: PDC 08159
Project Manager: Brian Dodek

Reported:
06/13/11 15:04

MW04
R106051-04 (Water)

Summit Scientific

Volatile Organic Compounds by EPA Method 8260B

Date Sampled: **06/06/11 11:35**

Analyte	Result	Reporting		Dilution	Batch	Prepared	Analyzed	Method	Notes
		Limit	Units						
Benzene	ND	1.0	ug/l	1	1061103	06/11/11	06/12/11	EPA 8260B	
Toluene	ND	1.0	"	"	"	"	"	"	
Ethylbenzene	ND	1.0	"	"	"	"	"	"	
Xylenes (total)	ND	1.0	"	"	"	"	"	"	

Date Sampled: **06/06/11 11:35**

Analyte	Result	Reporting		Dilution	Batch	Prepared	Analyzed	Method	Notes
		Limit	Units						
Surrogate: 1,2-Dichloroethane-d4		103 %	57.9-139		"	"	"	"	
Surrogate: Toluene-d8		97.2 %	83.1-115		"	"	"	"	
Surrogate: 4-Bromofluorobenzene		95.9 %	80.8-120		"	"	"	"	

Summit Scientific

The results in this report apply to the samples analyzed in accordance with the chain of custody document. This analytical report must be reproduced in its entirety.



LT Environmental, Inc.
4600 West 60th Avenue
Arvada CO, 80003

Project: PDC - Pfenning # 43 & 44-31

Project Number: PDC 08159
Project Manager: Brian Dodek

Reported:
06/13/11 15:04

MW05
R106051-05 (Water)

Summit Scientific

Volatile Organic Compounds by EPA Method 8260B

Date Sampled: **06/06/11 11:40**

Analyte	Result	Reporting		Units	Dilution	Batch	Prepared	Analyzed	Method	Notes
		Limit								
Benzene	ND	1.0		ug/l	1	1061103	06/11/11	06/12/11	EPA 8260B	
Toluene	ND	1.0		"	"	"	"	"	"	
Ethylbenzene	ND	1.0		"	"	"	"	"	"	
Xylenes (total)	ND	1.0		"	"	"	"	"	"	

Date Sampled: **06/06/11 11:40**

Analyte	Result	Reporting		Units	Dilution	Batch	Prepared	Analyzed	Method	Notes
		Limit								
Surrogate: 1,2-Dichloroethane-d4		104 %		57.9-139		"	"	"	"	
Surrogate: Toluene-d8		99.6 %		83.1-115		"	"	"	"	
Surrogate: 4-Bromofluorobenzene		95.4 %		80.8-120		"	"	"	"	

Summit Scientific

The results in this report apply to the samples analyzed in accordance with the chain of custody document. This analytical report must be reproduced in its entirety.



LT Environmental, Inc.
4600 West 60th Avenue
Arvada CO, 80003

Project: PDC - Pfenning # 43 & 44-31
Project Number: PDC 08159
Project Manager: Brian Dodek

Reported:
06/13/11 15:04

MW06
R106051-06 (Water)

Summit Scientific

Volatile Organic Compounds by EPA Method 8260B

Date Sampled: **06/06/11 11:45**

Analyte	Result	Reporting		Dilution	Batch	Prepared	Analyzed	Method	Notes
		Limit	Units						
Benzene	ND	1.0	ug/l	1	1061103	06/11/11	06/12/11	EPA 8260B	
Toluene	ND	1.0	"	"	"	"	"	"	
Ethylbenzene	ND	1.0	"	"	"	"	"	"	
Xylenes (total)	ND	1.0	"	"	"	"	"	"	

Date Sampled: **06/06/11 11:45**

Analyte	Result	Reporting		Dilution	Batch	Prepared	Analyzed	Method	Notes
		Limit	Units						
Surrogate: 1,2-Dichloroethane-d4		101 %	57.9-139		"	"	"	"	
Surrogate: Toluene-d8		95.9 %	83.1-115		"	"	"	"	
Surrogate: 4-Bromofluorobenzene		96.4 %	80.8-120		"	"	"	"	

Summit Scientific

The results in this report apply to the samples analyzed in accordance with the chain of custody document. This analytical report must be reproduced in its entirety.



LT Environmental, Inc.
4600 West 60th Avenue
Arvada CO, 80003

Project: PDC - Pfenning # 43 & 44-31

Project Number: PDC 08159
Project Manager: Brian Dodek

Reported:
06/13/11 15:04

MW07

R106051-07 (Water)

Summit Scientific

Volatile Organic Compounds by EPA Method 8260B

Date Sampled: **06/06/11 11:50**

Analyte	Result	Reporting		Dilution	Batch	Prepared	Analyzed	Method	Notes
		Limit	Units						
Benzene	ND	1.0	ug/l	1	1061103	06/11/11	06/12/11	EPA 8260B	
Toluene	ND	1.0	"	"	"	"	"	"	
Ethylbenzene	ND	1.0	"	"	"	"	"	"	
Xylenes (total)	ND	1.0	"	"	"	"	"	"	

Date Sampled: **06/06/11 11:50**

Analyte	Result	Reporting		Dilution	Batch	Prepared	Analyzed	Method	Notes
		Limit	Units						
Surrogate: 1,2-Dichloroethane-d4		104 %	57.9-139		"	"	"	"	
Surrogate: Toluene-d8		86.6 %	83.1-115		"	"	"	"	
Surrogate: 4-Bromofluorobenzene		96.7 %	80.8-120		"	"	"	"	

Summit Scientific

The results in this report apply to the samples analyzed in accordance with the chain of custody document. This analytical report must be reproduced in its entirety.



LT Environmental, Inc.
4600 West 60th Avenue
Arvada CO, 80003

Project: PDC - Pfenning # 43 & 44-31

Project Number: PDC 08159
Project Manager: Brian Dodek

Reported:
06/13/11 15:04

MW08
R106051-08 (Water)

Summit Scientific

Volatile Organic Compounds by EPA Method 8260B

Date Sampled: **06/06/11 11:55**

Analyte	Result	Reporting		Dilution	Batch	Prepared	Analyzed	Method	Notes
		Limit	Units						
Benzene	ND	1.0	ug/l	1	1061103	06/11/11	06/12/11	EPA 8260B	
Toluene	ND	1.0	"	"	"	"	"	"	
Ethylbenzene	ND	1.0	"	"	"	"	"	"	
Xylenes (total)	ND	1.0	"	"	"	"	"	"	

Date Sampled: **06/06/11 11:55**

Analyte	Result	Reporting		Dilution	Batch	Prepared	Analyzed	Method	Notes
		Limit	Units						
Surrogate: 1,2-Dichloroethane-d4		103 %	57.9-139		"	"	"	"	
Surrogate: Toluene-d8		84.5 %	83.1-115		"	"	"	"	
Surrogate: 4-Bromofluorobenzene		96.1 %	80.8-120		"	"	"	"	

Summit Scientific

The results in this report apply to the samples analyzed in accordance with the chain of custody document. This analytical report must be reproduced in its entirety.



LT Environmental, Inc.
4600 West 60th Avenue
Arvada CO, 80003

Project: PDC - Pfenning # 43 & 44-31

Project Number: PDC 08159
Project Manager: Brian Dodek

Reported:
06/13/11 15:04

Volatile Organic Compounds by EPA Method 8260B - Quality Control

Summit Scientific

Analyte	Reporting			Spike	Source		%REC		RPD	
	Result	Limit	Units	Level	Result	%REC	Limits	RPD	Limit	Notes

Batch 1061103 - EPA 5030 Water MS

Blank (1061103-BLK1)

Prepared: 06/11/11 Analyzed: 06/12/11

Benzene	ND	1.0	ug/l							
Toluene	ND	1.0	"							
Ethylbenzene	ND	1.0	"							
Xylenes (total)	ND	1.0	"							
Surrogate: 1,2-Dichloroethane-d4	13.7		"	13.3	103	57.9-139				
Surrogate: Toluene-d8	12.3		"	13.3	92.6	83.1-115				
Surrogate: 4-Bromofluorobenzene	12.6		"	13.3	94.1	80.8-120				

LCS (1061103-BS1)

Prepared: 06/11/11 Analyzed: 06/12/11

Benzene	32.9	1.0	ug/l	33.3	98.7	60.1-131			10.9	
Toluene	38.1	1.0	"	33.3	114	65.9-127			11.3	
Ethylbenzene	37.4	1.0	"	33.3	112	65.1-129			20	
m,p-Xylene	71.5	2.0	"	66.7	107	66.8-127			20	
o-Xylene	36.7	1.0	"	33.3	110	61.2-120			20	
Surrogate: 1,2-Dichloroethane-d4	14.2		"	13.3	107	57.9-139				
Surrogate: Toluene-d8	15.1		"	13.3	113	83.1-115				
Surrogate: 4-Bromofluorobenzene	12.8		"	13.3	96.2	80.8-120				

LCS Dup (1061103-BSD1)

Prepared: 06/11/11 Analyzed: 06/12/11

Benzene	32.2	1.0	ug/l	33.3	96.7	60.1-131	2.06		10.9	
Toluene	35.6	1.0	"	33.3	107	65.9-127	6.76		11.3	
Ethylbenzene	38.2	1.0	"	33.3	114	65.1-129	2.09		20	
m,p-Xylene	72.4	2.0	"	66.7	109	66.8-127	1.29		20	
o-Xylene	37.0	1.0	"	33.3	111	61.2-120	0.788		20	
Surrogate: 1,2-Dichloroethane-d4	14.1		"	13.3	106	57.9-139				
Surrogate: Toluene-d8	14.3		"	13.3	107	83.1-115				
Surrogate: 4-Bromofluorobenzene	12.9		"	13.3	97.1	80.8-120				

Summit Scientific

The results in this report apply to the samples analyzed in accordance with the chain of custody document. This analytical report must be reproduced in its entirety.



LT Environmental, Inc.
4600 West 60th Avenue
Arvada CO, 80003

Project: PDC - Pfenning # 43 & 44-31

Project Number: PDC 08159
Project Manager: Brian Dodek

Reported:
06/13/11 15:04

Volatile Organic Compounds by EPA Method 8260B - Quality Control
Summit Scientific

Analyte	Reporting			Spike	Source		%REC		RPD	
	Result	Limit	Units	Level	Result	%REC	Limits	RPD	Limit	Notes

Batch 1061103 - EPA 5030 Water MS

Matrix Spike (1061103-MS1)

Source: R106027-01

Prepared: 06/11/11

Analyzed: 06/12/11

Benzene	31.5	1.0	ug/l	33.3	ND	94.4	52.7-130		19.3	
Toluene	29.2	1.0	"	33.3	ND	87.5	57-127		18.7	
Ethylbenzene	38.2	1.0	"	33.3	ND	115	59.2-127		20	
m,p-Xylene	36.3	2.0	"	66.7	ND	54.4	53.2-132		20	
o-Xylene	36.6	1.0	"	33.3	ND	110	56.3-117		20	
Surrogate: 1,2-Dichloroethane-d4	13.7		"	13.3		103	57.9-139			
Surrogate: Toluene-d8	11.8		"	13.3		88.1	83.1-115			
Surrogate: 4-Bromofluorobenzene	12.6		"	13.3		94.5	80.8-120			

Matrix Spike Dup (1061103-MSD1)

Source: R106027-01

Prepared: 06/11/11

Analyzed: 06/12/11

Benzene	31.9	1.0	ug/l	33.3	ND	95.8	52.7-130	1.45	19.3	
Toluene	31.8	1.0	"	33.3	ND	95.5	57-127	8.72	18.7	
Ethylbenzene	38.6	1.0	"	33.3	ND	116	59.2-127	1.22	20	
m,p-Xylene	36.7	2.0	"	66.7	ND	55.1	53.2-132	1.23	20	
o-Xylene	37.3	1.0	"	33.3	ND	112	56.3-117	2.03	20	
Surrogate: 1,2-Dichloroethane-d4	14.1		"	13.3		106	57.9-139			
Surrogate: Toluene-d8	13.8		"	13.3		103	83.1-115			
Surrogate: 4-Bromofluorobenzene	13.1		"	13.3		98.0	80.8-120			

Summit Scientific

The results in this report apply to the samples analyzed in accordance with the chain of custody document. This analytical report must be reproduced in its entirety.



LT Environmental, Inc.
4600 West 60th Avenue
Arvada CO, 80003

Project: PDC - Pfenning # 43 & 44-31

Project Number: PDC 08159
Project Manager: Brian Dodek

Reported:
06/13/11 15:04

Notes and Definitions

DET Analyte DETECTED
ND Analyte NOT DETECTED at or above the reporting limit
NR Not Reported
dry Sample results reported on a dry weight basis
RPD Relative Percent Difference

Summit Scientific

A handwritten signature in black ink, appearing to be 'MSM'.

The results in this report apply to the samples analyzed in accordance with the chain of custody document. This analytical report must be reproduced in its entirety.

Summit Scientific

741 Corporate Circle – Suite I ♦ Golden, Colorado 80401

303.277.9310 - laboratory ♦ 303.277.9531 - fax

July 13, 2011

Brian Dodek

LT Environmental, Inc.

4600 West 60th Avenue

Arvada, CO 80003

RE: PDC - Pfenning # 43 & 44-31

Enclosed are the results of analyses for samples received by Summit Scientific on 07/05/11 17:00. If you have any questions concerning this report, please feel free to contact me.

Sincerely,



Paul Shrewsbury For Ben Shrewsbury
President / Laboratory Director

LT Environmental, Inc.
4600 West 60th Avenue
Arvada CO, 80003

Project: PDC - Pfenning # 43 & 44-31

Project Number: PDC 08159
Project Manager: Brian Dodek

Reported:
07/13/11 15:03

ANALYTICAL REPORT FOR SAMPLES

Sample ID	Laboratory ID	Matrix	Date Sampled	Date Received
MW01	R107014-01	Water	07/05/11 14:30	07/05/11 17:00

Summit Scientific
8107014

741 Corporate Circle Suite I ♦ Golden, Colorado 80401
303-277-9310 ♦ 303-277-9531 Fax

Client:	LT Environmental, Inc.	Project Manager:	John Smith B. Dolek
City/State/Zip:	4600 West 60th Avenue Arvada, CO 80003	E-Mail:	johns@ltemc.com joseph@ltemc.com
Phone:	(303) 433-9788	Project Name:	PT-annoy 437 44-31
Fax:	(303) 433-1432	Project Number:	
Sampler Name:	J Evans		

Page of

Sample Description		Date Sampled	Time Sampled	Number of Containers	Preservative				Matrix			Analyze For:				Special Instructions	Notes	
					HCl	HNO ₃	None	Other (Specify)	Groundwater	Soil	Air - Canister Serial #	Other (Specify)	DRO/ORO	GBTEX	BTEX			PH / EC
MV61		7-5-11	1430	2	X				X				Other (Specify)					
Relinquished by:	Date/Time:	Received by:				Date/Time:				Turn Around Time (Check)				Notes:				
<i>John Kwon</i>	7-5-11 5pm	<i>DFS</i>				7-5-11 5pm				Same Day 24 Hours 48 Hours				72 Hours Standard				
Relinquished by:	Date/Time:	Received by:				Date/Time:				Sample Integrity:				Temperature Upon Receipt:				
										Intact: Yes <input checked="" type="checkbox"/> No <input type="checkbox"/>				S.2 <i>[Signature]</i>				
Relinquished by:	Date/Time:	Received in Lab by:				Date/Time:												

www.s2scientific.com

Summit Scientific

The results in this report apply to the samples analyzed in accordance with the chain of custody document. This analytical report must be reproduced in its entirety.



LT Environmental, Inc.
4600 West 60th Avenue
Arvada CO, 80003

Project: PDC - Pfenning # 43 & 44-31

Project Number: PDC 08159
Project Manager: Brian Dodek

Reported:
07/13/11 15:03

MW01
R107014-01 (Water)

Summit Scientific

Volatile Organic Compounds by EPA Method 8260B

Date Sampled: **07/05/11 14:30**

Analyte	Result	Reporting Limit	Units	Dilution	Batch	Prepared	Analyzed	Method	Notes
Benzene	1.2	1.0	ug/l	1	1070907	07/09/11	07/10/11	EPA 8260B	
Toluene	ND	1.0	"	"	"	"	"	"	
Ethylbenzene	ND	1.0	"	"	"	"	"	"	
Xylenes (total)	ND	1.0	"	"	"	"	"	"	

Date Sampled: **07/05/11 14:30**

Analyte	Result	Reporting Limit	Units	Dilution	Batch	Prepared	Analyzed	Method	Notes
<i>Surrogate: 1,2-Dichloroethane-d4</i>		93.1 %	57.9-139		"	"	"	"	
<i>Surrogate: Toluene-d8</i>		93.1 %	83.1-115		"	"	"	"	
<i>Surrogate: 4-Bromofluorobenzene</i>		99.8 %	80.8-120		"	"	"	"	

Summit Scientific

The results in this report apply to the samples analyzed in accordance with the chain of custody document. This analytical report must be reproduced in its entirety.



LT Environmental, Inc.
4600 West 60th Avenue
Arvada CO, 80003

Project: PDC - Pfenning # 43 & 44-31

Project Number: PDC 08159
Project Manager: Brian Dodek

Reported:
07/13/11 15:03

Volatile Organic Compounds by EPA Method 8260B - Quality Control

Summit Scientific

Analyte	Reporting			Spike	Source		%REC		RPD	
	Result	Limit	Units	Level	Result	%REC	Limits	RPD	Limit	Notes

Batch 1070907 - EPA 5030 Water MS

Blank (1070907-BLK1)

Prepared & Analyzed: 07/09/11

Benzene	ND	1.0	ug/l							
Toluene	ND	1.0	"							
Ethylbenzene	ND	1.0	"							
Xylenes (total)	ND	1.0	"							
Surrogate: 1,2-Dichloroethane-d4	13.6		"	13.3	102	57.9-139				
Surrogate: Toluene-d8	12.7		"	13.3	95.0	83.1-115				
Surrogate: 4-Bromofluorobenzene	13.4		"	13.3	100	80.8-120				

LCS (1070907-BS1)

Prepared & Analyzed: 07/09/11

Benzene	28.4	1.0	ug/l	33.3	85.1	60.1-131		10.9		
Toluene	29.3	1.0	"	33.3	87.8	65.9-127		11.3		
Ethylbenzene	33.2	1.0	"	33.3	99.6	65.1-129		20		
m,p-Xylene	67.0	2.0	"	66.7	101	66.8-127		20		
o-Xylene	32.6	1.0	"	33.3	97.7	61.2-120		20		
Surrogate: 1,2-Dichloroethane-d4	13.5		"	13.3	102	57.9-139				
Surrogate: Toluene-d8	12.7		"	13.3	95.0	83.1-115				
Surrogate: 4-Bromofluorobenzene	13.0		"	13.3	97.3	80.8-120				

LCS Dup (1070907-BSD1)

Prepared & Analyzed: 07/09/11

Benzene	28.4	1.0	ug/l	33.3	85.3	60.1-131	0.247	10.9		
Toluene	29.3	1.0	"	33.3	87.9	65.9-127	0.102	11.3		
Ethylbenzene	33.1	1.0	"	33.3	99.2	65.1-129	0.332	20		
m,p-Xylene	67.6	2.0	"	66.7	101	66.8-127	0.891	20		
o-Xylene	33.0	1.0	"	33.3	99.1	61.2-120	1.40	20		
Surrogate: 1,2-Dichloroethane-d4	13.4		"	13.3	100	57.9-139				
Surrogate: Toluene-d8	12.7		"	13.3	95.2	83.1-115				
Surrogate: 4-Bromofluorobenzene	13.0		"	13.3	97.2	80.8-120				

Summit Scientific

The results in this report apply to the samples analyzed in accordance with the chain of custody document. This analytical report must be reproduced in its entirety.



LT Environmental, Inc.
4600 West 60th Avenue
Arvada CO, 80003

Project: PDC - Pfenning # 43 & 44-31

Project Number: PDC 08159
Project Manager: Brian Dodek

Reported:
07/13/11 15:03

Volatile Organic Compounds by EPA Method 8260B - Quality Control
Summit Scientific

Analyte	Reporting			Spike	Source		%REC		RPD	
	Result	Limit	Units	Level	Result	%REC	Limits	RPD	Limit	Notes

Batch 1070907 - EPA 5030 Water MS

Matrix Spike (1070907-MS1)		Source: R107036-04			Prepared & Analyzed: 07/09/11					
Benzene	27.7	1.0	ug/l	33.3	ND	83.2	52.7-130		19.3	
Toluene	29.7	1.0	"	33.3	ND	89.0	57-127		18.7	
Ethylbenzene	33.4	1.0	"	33.3	ND	100	59.2-127		20	
m,p-Xylene	69.0	2.0	"	66.7	ND	104	53.2-132		20	
o-Xylene	33.9	1.0	"	33.3	ND	102	56.3-117		20	
Surrogate: 1,2-Dichloroethane-d4	13.8		"	13.3		103	57.9-139			
Surrogate: Toluene-d8	12.4		"	13.3		93.4	83.1-115			
Surrogate: 4-Bromofluorobenzene	13.6		"	13.3		102	80.8-120			
Matrix Spike Dup (1070907-MSD1)		Source: R107036-04			Prepared & Analyzed: 07/09/11					
Benzene	26.9	1.0	ug/l	33.3	ND	80.6	52.7-130	3.11	19.3	
Toluene	28.8	1.0	"	33.3	ND	86.3	57-127	3.08	18.7	
Ethylbenzene	33.0	1.0	"	33.3	ND	98.9	59.2-127	1.24	20	
m,p-Xylene	68.5	2.0	"	66.7	ND	103	53.2-132	0.741	20	
o-Xylene	33.1	1.0	"	33.3	ND	99.3	56.3-117	2.39	20	
Surrogate: 1,2-Dichloroethane-d4	13.8		"	13.3		104	57.9-139			
Surrogate: Toluene-d8	12.6		"	13.3		94.7	83.1-115			
Surrogate: 4-Bromofluorobenzene	13.0		"	13.3		97.1	80.8-120			

Summit Scientific

The results in this report apply to the samples analyzed in accordance with the chain of custody document. This analytical report must be reproduced in its entirety.



LT Environmental, Inc.
4600 West 60th Avenue
Arvada CO, 80003

Project: PDC - Pfenning # 43 & 44-31

Project Number: PDC 08159
Project Manager: Brian Dodek

Reported:
07/13/11 15:03

Notes and Definitions

DET Analyte DETECTED
ND Analyte NOT DETECTED at or above the reporting limit
NR Not Reported
dry Sample results reported on a dry weight basis
RPD Relative Percent Difference

Summit Scientific

A handwritten signature in black ink, appearing to be 'MSM'.

The results in this report apply to the samples analyzed in accordance with the chain of custody document. This analytical report must be reproduced in its entirety.