

Well Name: **Wedco 14-21DU**

Surface Location: Walters/Wedco/Ryland Pad Sec.21-T4N-R67W
 North American Datum 1983 US State Plane 1983 Colorado Northern Zone

Ground Elevation: 4940.0

| +N/-S | +E/-W | Northing | Easting | Latitude | Longitude |
|-------|-------|------------|------------|-----------|-------------|
| 0.0 | 0.0 | 1350978.52 | 3167463.48 | 40.295280 | -104.899640 |

Original Well Elev WELL @ 4953.0ft (Original Well Elev)

Slot

PETROLEUM DEVELOPMENT CORP Weld County CO

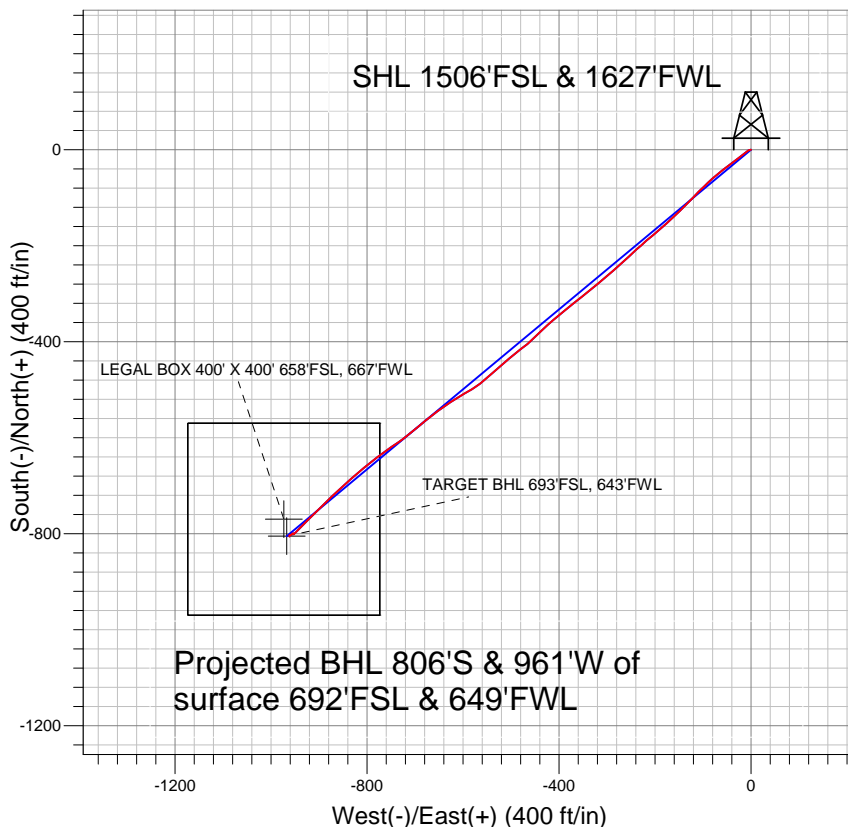
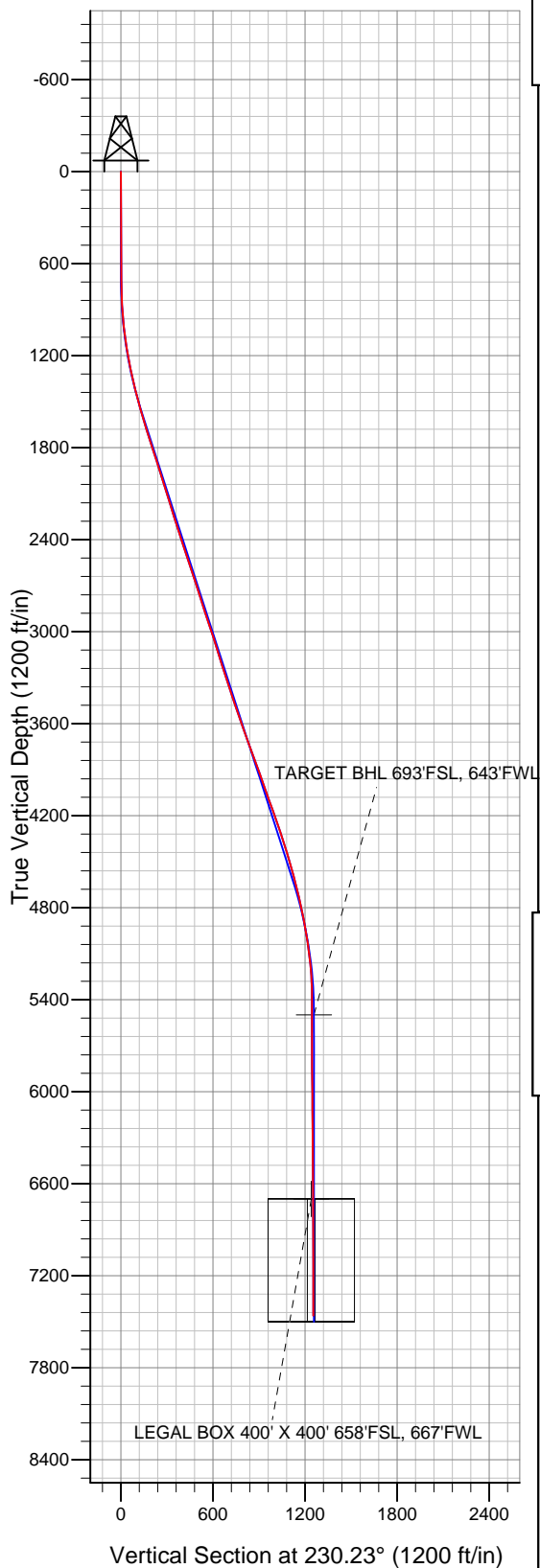

LEGEND

- △ Wedco 14-21DU, Wellbore #1, Plan #1 (6-4-10) V0
- Wellbore #1
- Survey #1

Final Survey Plot

Projected Final Survey -
 7646'MD & 7462'TVD @ 1254'VS
 0.2 deg Inc 127.3 deg AZ

Project: SEC.21-T4N-R67W
 Site: Walters/Wedco/Ryland Pad Sec.21-T4N-R67W
 Well: Wedco 14-21DU
 Plan: Wellbore #1



Directional

PETROLEUM DEVELOPMENT CORP Weld County CO

SEC.21-T4N-R67W

Walters/Wedco/Ryland Pad Sec.21-T4N-R67W

Wedco 14-21DU

Wellbore #1

Survey: Survey #1

Standard Survey Report

18 May, 2011

| | | | |
|------------------|---|-------------------------------------|--------------------------------------|
| Company: | PETROLEUM DEVELOPMENT CORP Weld County CO | Local Co-ordinate Reference: | Well Wedco 14-21DU |
| Project: | SEC.21-T4N-R67W | TVD Reference: | WELL @ 4953.0ft (Original Well Elev) |
| Site: | Walters/Wedco/Ryland Pad Sec.21-T4N-R67W | MD Reference: | WELL @ 4953.0ft (Original Well Elev) |
| Well: | Wedco 14-21DU | North Reference: | True |
| Wellbore: | Wellbore #1 | Survey Calculation Method: | Minimum Curvature |
| Design: | Wellbore #1 | Database: | Landmark |

| | | | |
|--------------------|--|----------------------|-----------------------------|
| Project | SEC.21-T4N-R67W, Weld County, Colorado | | |
| Map System: | US State Plane 1983 | System Datum: | Mean Sea Level |
| Geo Datum: | North American Datum 1983 | | Using Well Reference Point |
| Map Zone: | Colorado Northern Zone | | Using geodetic scale factor |

| | | | | | |
|-----------------------|----------|--|----------------|-------------------|-------------|
| Site | | Walters/Wedco/Ryland Pad Sec.21-T4N-R67W | | | |
| Site Position: | | Northing: | 1,351,058.86ft | Latitude: | 40.295500 |
| From: | Lat/Long | Easting: | 3,167,490.83ft | Longitude: | -104.899540 |
| Position Uncertainty: | 0.0 ft | Slot Radius: | " | Grid Convergence: | 0.39 ° |

| | | | | | | |
|----------------------|---------------|--------|---------------------|-----------------|---------------|-------------|
| Well | Wedco 14-21DU | | | | | |
| Well Position | +N-S | 0.0 ft | Northing: | 1,350,978.52 ft | Latitude: | 40.295280 |
| | +E-W | 0.0 ft | Easting: | 3,167,463.48 ft | Longitude: | -104.899640 |
| Position Uncertainty | | 0.0 ft | Wellhead Elevation: | ft | Ground Level: | 4,940.0 ft |

| | | | | | |
|------------------|-------------------|--------------------|------------------------|----------------------|----------------------------|
| Wellbore | Wellbore #1 | | | | |
| Magnetics | Model Name | Sample Date | Declination (°) | Dip Angle (°) | Field Strength (nT) |
| | IGRF200510 | 12/31/2009 | 9.09 | 67.00 | 53,234 |

| | | | | | |
|--------------------------|------------------------------|-------------------|-------------------|----------------------|-----|
| Design | Wellbore #1 | | | | |
| Audit Notes: | | | | | |
| Version: | 1.0 | Phase: | ACTUAL | Tie On Depth: | 0.0 |
| Vertical Section: | Depth From (TVD) (ft) | +N/-S (ft) | +E/-W (ft) | Direction (°) | |
| | 0.0 | 0.0 | 0.0 | 230.23 | |

| | | | | | |
|-----------------------|-----------------------|--------------------------|------------------|--------------------|--|
| Survey Program | Date 5/18/2011 | | | | |
| From (ft) | To (ft) | Survey (Wellbore) | Tool Name | Description | |
| 704.0 | 7,646.0 | Survey #1 (Wellbore #1) | MWD | MWD - Standard | |

| | | | | | | | | | |
|----------------------------|------------------------|--------------------|----------------------------|-------------------|-------------------|------------------------------|------------------------------|-----------------------------|----------------------------|
| Survey | | | | | | | | | |
| Measured Depth (ft) | Inclination (°) | Azimuth (°) | Vertical Depth (ft) | +N/-S (ft) | +E/-W (ft) | Vertical Section (ft) | Dogleg Rate (°/100ft) | Build Rate (°/100ft) | Turn Rate (°/100ft) |
| 0.0 | 0.00 | 0.00 | 0.0 | 0.0 | 0.0 | 0.0 | 0.00 | 0.00 | 0.00 |
| 704.0 | 0.50 | 258.10 | 704.0 | -0.6 | -3.0 | 2.7 | 0.07 | 0.07 | 0.00 |
| 797.0 | 2.20 | 246.10 | 797.0 | -1.4 | -5.0 | 4.8 | 1.84 | 1.83 | -12.90 |
| 890.0 | 3.30 | 229.80 | 889.9 | -3.9 | -8.7 | 9.2 | 1.44 | 1.18 | -17.53 |
| 983.0 | 5.20 | 232.10 | 982.6 | -8.2 | -14.1 | 16.1 | 2.05 | 2.04 | 2.47 |
| 1,077.0 | 7.50 | 230.80 | 1,076.0 | -14.7 | -22.2 | 26.5 | 2.45 | 2.45 | -1.38 |
| 1,170.0 | 9.40 | 234.60 | 1,168.0 | -22.9 | -33.1 | 40.1 | 2.13 | 2.04 | 4.09 |
| 1,263.0 | 11.30 | 231.70 | 1,259.5 | -33.0 | -46.4 | 56.8 | 2.12 | 2.04 | -3.12 |
| 1,357.0 | 13.10 | 234.20 | 1,351.4 | -44.9 | -62.3 | 76.6 | 2.00 | 1.91 | 2.66 |
| 1,450.0 | 13.80 | 226.10 | 1,441.8 | -58.8 | -78.8 | 98.2 | 2.16 | 0.75 | -8.71 |
| 1,543.0 | 15.90 | 227.30 | 1,531.7 | -75.1 | -96.2 | 122.0 | 2.28 | 2.26 | 1.29 |
| 1,636.0 | 17.40 | 222.30 | 1,620.8 | -94.0 | -114.9 | 148.5 | 2.23 | 1.61 | -5.38 |

| | | | |
|------------------|---|-------------------------------------|--------------------------------------|
| Company: | PETROLEUM DEVELOPMENT CORP Weld County CO | Local Co-ordinate Reference: | Well Wedco 14-21DU |
| Project: | SEC.21-T4N-R67W | TVD Reference: | WELL @ 4953.0ft (Original Well Elev) |
| Site: | Walters/Wedco/Ryland Pad Sec.21-T4N-R67W | MD Reference: | WELL @ 4953.0ft (Original Well Elev) |
| Well: | Wedco 14-21DU | North Reference: | True |
| Wellbore: | Wellbore #1 | Survey Calculation Method: | Minimum Curvature |
| Design: | Wellbore #1 | Database: | Landmark |

| Survey | | | | | | | | | |
|-----------------------------|-----------------|-------------|---------------------|------------|------------|-----------------------|-----------------------|----------------------|---------------------|
| Measured Depth (ft) | Inclination (°) | Azimuth (°) | Vertical Depth (ft) | +N/-S (ft) | +E/-W (ft) | Vertical Section (ft) | Dogleg Rate (°/100ft) | Build Rate (°/100ft) | Turn Rate (°/100ft) |
| 1,729.0 | 17.50 | 225.10 | 1,709.5 | -114.2 | -134.2 | 176.2 | 0.91 | 0.11 | 3.01 |
| 1,823.0 | 17.50 | 227.50 | 1,799.2 | -133.7 | -154.6 | 204.4 | 0.77 | 0.00 | 2.55 |
| 1,916.0 | 17.10 | 226.60 | 1,888.0 | -152.6 | -174.9 | 232.0 | 0.52 | -0.43 | -0.97 |
| 2,010.0 | 17.70 | 230.20 | 1,977.7 | -171.2 | -195.9 | 260.1 | 1.31 | 0.64 | 3.83 |
| 2,103.0 | 17.90 | 229.80 | 2,066.2 | -189.5 | -217.7 | 288.5 | 0.25 | 0.22 | -0.43 |
| 2,196.0 | 17.40 | 226.40 | 2,154.8 | -208.3 | -238.6 | 316.7 | 1.23 | -0.54 | -3.66 |
| 2,290.0 | 17.30 | 227.90 | 2,244.6 | -227.4 | -259.2 | 344.7 | 0.49 | -0.11 | 1.60 |
| 2,383.0 | 17.40 | 230.00 | 2,333.3 | -245.6 | -280.1 | 372.4 | 0.68 | 0.11 | 2.26 |
| 2,476.0 | 17.70 | 227.00 | 2,422.0 | -264.1 | -301.1 | 400.4 | 1.02 | 0.32 | -3.23 |
| 2,569.0 | 18.50 | 232.50 | 2,510.4 | -282.8 | -323.1 | 429.3 | 2.03 | 0.86 | 5.91 |
| 2,662.0 | 18.40 | 230.90 | 2,598.6 | -301.0 | -346.2 | 458.7 | 0.55 | -0.11 | -1.72 |
| 2,755.0 | 18.50 | 230.50 | 2,686.9 | -319.7 | -369.0 | 488.1 | 0.17 | 0.11 | -0.43 |
| 2,848.0 | 17.10 | 230.40 | 2,775.4 | -337.8 | -390.9 | 516.6 | 1.51 | -1.51 | -0.11 |
| 2,941.0 | 18.00 | 230.50 | 2,864.1 | -355.6 | -412.6 | 544.6 | 0.97 | 0.97 | 0.11 |
| 3,034.0 | 18.40 | 225.70 | 2,952.4 | -375.0 | -434.2 | 573.6 | 1.67 | 0.43 | -5.16 |
| 3,127.0 | 18.30 | 227.10 | 3,040.7 | -395.2 | -455.4 | 602.8 | 0.49 | -0.11 | 1.51 |
| 3,219.0 | 17.20 | 230.80 | 3,128.3 | -413.6 | -476.5 | 630.8 | 1.71 | -1.20 | 4.02 |
| 3,313.0 | 17.40 | 233.00 | 3,218.1 | -430.9 | -498.5 | 658.8 | 0.73 | 0.21 | 2.34 |
| 3,406.0 | 17.70 | 227.10 | 3,306.7 | -448.9 | -519.9 | 686.8 | 1.94 | 0.32 | -6.34 |
| 3,499.0 | 18.50 | 228.50 | 3,395.1 | -468.3 | -541.4 | 715.6 | 0.98 | 0.86 | 1.51 |
| 3,592.0 | 19.00 | 232.70 | 3,483.2 | -487.2 | -564.4 | 745.5 | 1.55 | 0.54 | 4.52 |
| 3,685.0 | 19.10 | 239.30 | 3,571.1 | -504.2 | -589.6 | 775.7 | 2.32 | 0.11 | 7.10 |
| 3,779.0 | 19.50 | 239.50 | 3,659.8 | -520.0 | -616.3 | 806.3 | 0.43 | 0.43 | 0.21 |
| 3,872.0 | 20.80 | 233.20 | 3,747.2 | -537.7 | -642.9 | 838.2 | 2.72 | 1.40 | -6.77 |
| 3,965.0 | 20.00 | 232.10 | 3,834.3 | -557.4 | -668.7 | 870.5 | 0.95 | -0.86 | -1.18 |
| 4,058.0 | 19.80 | 230.80 | 3,921.8 | -577.1 | -693.4 | 902.2 | 0.52 | -0.22 | -1.40 |
| 4,152.0 | 19.20 | 230.80 | 4,010.4 | -597.0 | -717.8 | 933.6 | 0.64 | -0.64 | 0.00 |
| 4,245.0 | 19.60 | 237.40 | 4,098.1 | -615.0 | -742.8 | 964.3 | 2.39 | 0.43 | 7.10 |
| 4,338.0 | 20.10 | 231.30 | 4,185.6 | -633.4 | -768.4 | 995.8 | 2.29 | 0.54 | -6.56 |
| 4,432.0 | 19.30 | 232.90 | 4,274.1 | -652.9 | -793.4 | 1,027.5 | 1.03 | -0.85 | 1.70 |
| 4,525.0 | 17.50 | 230.60 | 4,362.3 | -671.1 | -816.4 | 1,056.8 | 2.09 | -1.94 | -2.47 |
| 4,618.0 | 17.40 | 227.80 | 4,451.1 | -689.3 | -837.5 | 1,084.7 | 0.91 | -0.11 | -3.01 |
| 4,711.0 | 15.30 | 227.10 | 4,540.3 | -707.0 | -856.8 | 1,110.8 | 2.27 | -2.26 | -0.75 |
| 4,805.0 | 14.30 | 225.50 | 4,631.2 | -723.5 | -874.2 | 1,134.8 | 1.15 | -1.06 | -1.70 |
| 4,898.0 | 12.70 | 226.30 | 4,721.6 | -738.7 | -889.8 | 1,156.4 | 1.73 | -1.72 | 0.86 |
| 4,991.0 | 12.70 | 225.30 | 4,812.3 | -752.9 | -904.4 | 1,176.8 | 0.24 | 0.00 | -1.08 |
| 5,085.0 | 11.30 | 224.80 | 4,904.3 | -766.7 | -918.3 | 1,196.3 | 1.49 | -1.49 | -0.53 |
| 5,178.0 | 8.80 | 224.00 | 4,995.8 | -778.3 | -929.6 | 1,212.4 | 2.69 | -2.69 | -0.86 |
| 5,271.0 | 6.90 | 223.90 | 5,088.0 | -787.4 | -938.5 | 1,225.0 | 2.04 | -2.04 | -0.11 |
| 5,364.0 | 5.40 | 223.80 | 5,180.4 | -794.6 | -945.4 | 1,234.9 | 1.61 | -1.61 | -0.11 |
| 5,457.0 | 3.40 | 231.60 | 5,273.1 | -799.5 | -950.5 | 1,242.0 | 2.24 | -2.15 | 8.39 |
| 5,550.0 | 0.30 | 303.70 | 5,366.1 | -801.1 | -952.9 | 1,244.9 | 3.57 | -3.33 | 77.53 |
| 5,644.0 | 0.60 | 13.00 | 5,460.1 | -800.5 | -953.0 | 1,244.6 | 0.60 | 0.32 | 73.72 |
| 5,683.9 | 0.51 | 7.22 | 5,499.9 | -800.1 | -952.9 | 1,244.3 | 0.27 | -0.23 | -14.50 |
| TARGET BHL 693'FSL, 643'FWL | | | | | | | | | |
| 5,737.0 | 0.40 | 355.60 | 5,553.1 | -799.7 | -952.9 | 1,244.0 | 0.27 | -0.21 | -21.87 |
| 5,830.0 | 0.50 | 275.10 | 5,646.1 | -799.3 | -953.3 | 1,244.1 | 0.63 | 0.11 | -86.56 |
| 5,923.0 | 0.30 | 256.90 | 5,739.1 | -799.3 | -954.0 | 1,244.6 | 0.25 | -0.22 | -19.57 |
| 6,016.0 | 0.60 | 240.50 | 5,832.1 | -799.6 | -954.6 | 1,245.3 | 0.35 | 0.32 | -17.63 |
| 6,109.0 | 0.70 | 234.50 | 5,925.1 | -800.2 | -955.5 | 1,246.3 | 0.13 | 0.11 | -6.45 |
| 6,203.0 | 0.60 | 227.10 | 6,019.1 | -800.9 | -956.4 | 1,247.4 | 0.14 | -0.11 | -7.87 |
| 6,296.0 | 0.50 | 227.20 | 6,112.1 | -801.5 | -957.0 | 1,248.3 | 0.11 | -0.11 | 0.11 |
| 6,389.0 | 0.40 | 225.70 | 6,205.1 | -802.0 | -957.5 | 1,249.0 | 0.11 | -0.11 | -1.61 |

| | | | |
|------------------|---|-------------------------------------|--------------------------------------|
| Company: | PETROLEUM DEVELOPMENT CORP Weld County CO | Local Co-ordinate Reference: | Well Wedco 14-21DU |
| Project: | SEC.21-T4N-R67W | TVD Reference: | WELL @ 4953.0ft (Original Well Elev) |
| Site: | Walters/Wedco/Ryland Pad Sec.21-T4N-R67W | MD Reference: | WELL @ 4953.0ft (Original Well Elev) |
| Well: | Wedco 14-21DU | North Reference: | True |
| Wellbore: | Wellbore #1 | Survey Calculation Method: | Minimum Curvature |
| Design: | Wellbore #1 | Database: | Landmark |

| Survey | | | | | | | | | |
|---|-----------------|-------------|---------------------|------------|------------|-----------------------|-----------------------|----------------------|---------------------|
| Measured Depth (ft) | Inclination (°) | Azimuth (°) | Vertical Depth (ft) | +N/-S (ft) | +E/-W (ft) | Vertical Section (ft) | Dogleg Rate (°/100ft) | Build Rate (°/100ft) | Turn Rate (°/100ft) |
| 6,482.0 | 0.30 | 237.00 | 6,298.1 | -802.3 | -958.0 | 1,249.6 | 0.13 | -0.11 | 12.15 |
| 6,576.0 | 0.30 | 273.60 | 6,392.0 | -802.4 | -958.4 | 1,250.0 | 0.20 | 0.00 | 38.94 |
| 6,669.0 | 0.50 | 251.30 | 6,485.0 | -802.6 | -959.1 | 1,250.6 | 0.27 | 0.22 | -23.98 |
| 6,762.0 | 0.50 | 251.30 | 6,578.0 | -802.8 | -959.8 | 1,251.3 | 0.00 | 0.00 | 0.00 |
| 6,855.0 | 0.40 | 267.30 | 6,671.0 | -803.0 | -960.5 | 1,251.9 | 0.17 | -0.11 | 17.20 |
| 6,884.0 | 0.33 | 260.70 | 6,700.0 | -803.0 | -960.7 | 1,252.1 | 0.29 | -0.25 | -22.78 |
| LEGAL BOX 400' X 400' 658'FSL, 667'FWL | | | | | | | | | |
| 6,947.0 | 0.20 | 230.70 | 6,763.0 | -803.1 | -961.0 | 1,252.4 | 0.29 | -0.20 | -47.60 |
| 7,040.0 | 0.10 | 257.90 | 6,856.0 | -803.2 | -961.2 | 1,252.6 | 0.13 | -0.11 | 29.25 |
| 7,133.0 | 0.40 | 205.60 | 6,949.0 | -803.5 | -961.4 | 1,253.0 | 0.37 | 0.32 | -56.24 |
| 7,226.0 | 0.30 | 211.40 | 7,042.0 | -804.0 | -961.7 | 1,253.5 | 0.11 | -0.11 | 6.24 |
| 7,319.0 | 0.30 | 169.50 | 7,135.0 | -804.5 | -961.8 | 1,253.8 | 0.23 | 0.00 | -45.05 |
| 7,412.0 | 0.20 | 174.60 | 7,228.0 | -804.9 | -961.7 | 1,254.1 | 0.11 | -0.11 | 5.48 |
| 7,505.0 | 0.30 | 155.60 | 7,321.0 | -805.2 | -961.6 | 1,254.2 | 0.14 | 0.11 | -20.43 |
| 7,599.0 | 0.20 | 127.30 | 7,415.0 | -805.6 | -961.4 | 1,254.2 | 0.17 | -0.11 | -30.11 |
| 7,646.0 | 0.20 | 127.30 | 7,462.0 | -805.7 | -961.2 | 1,254.2 | 0.00 | 0.00 | 0.00 |

| | | |
|-------------------|--------------------|-------------|
| Checked By: _____ | Approved By: _____ | Date: _____ |
|-------------------|--------------------|-------------|