

LEASE MAP  
SCHMIDT PC C06-69HC

S/2S/2 Sec 31, T5N-R64W  
N/2N/2 Sec 6, T4N-R64W  
Weld Co., CO

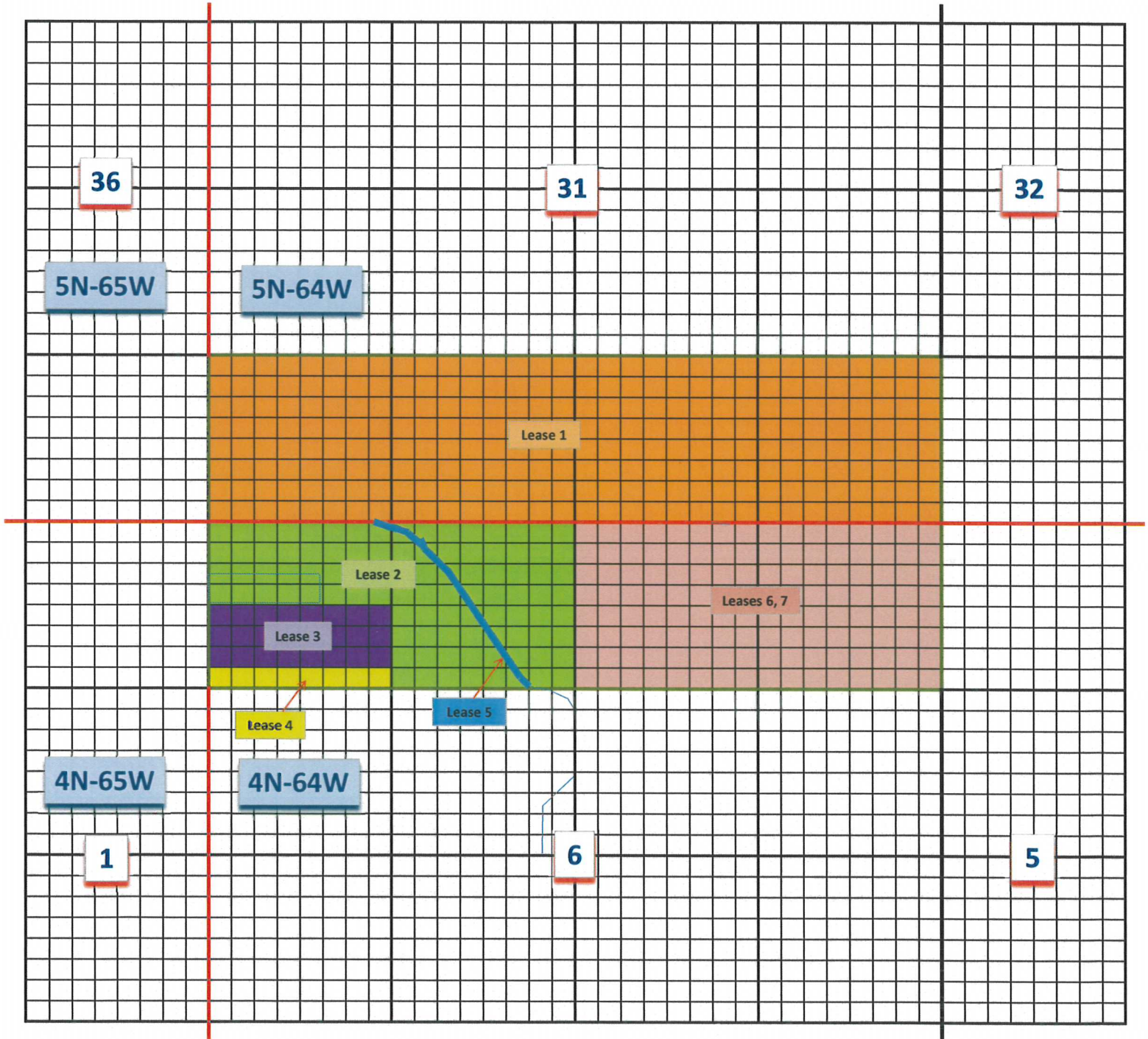

**LEASE MAP - SCHMIDT PC C06-69HN**

S/2S/2 Section 31, T5N-R64W

N/2N/2 Sec 6, T4N-R64W

Weld Co., CO

LEASE NO	TSH-RNG*	SEC	TRACT	GR AC
1	3N-65W	3	Lot 2 (aka NW/4NE/4), S/2NE/4.	120.2600
	4N-65W	25	NW/4, S/2.	480.0000
		33	NW/4, S/2.	480.0000
		35	NW/4, S/2.	480.0000
		4N-64W	7	Lots 1 & 2 (aka W/2W/2), E/2W/2, SE/4.
	17		NW/4, S/2.	480.0000
	19		Lots 1 & 2 (aka W/2W/2), E/2W/2, SE/4.	452.3200
	29		NW/4, S/2.	480.0000
	31		Lots 1 & 2 (aka W/2W/2), E/2W/2, SE/4.	456.7200
	5N-64W	7	Lot 1(aka W/2NW/4).	72.1000
		9	SE/4SW/4.	40.0000
		15	SW/4NE/4, S/2NW/4.	120.0000
		23	NW/4, S/2 except right-of-way.	468.1400
		29	NW/4, S/2.	480.0000
31		NW/4, S/2.	480.0000	
35		W/2SW/4, SE/4SW/4.	120.0000	
2	4N-64W	6	Lot 2, N/2N/2 Lot 3, SE/4NW/4.	95.0000
3	4N-64W	6	11.87 ac tract described as beginning at a point on the west boundary of Section Six 659.49' south of the NW corner of said Section 6, thence N89°31'44"E 1,276.05', thence S02°25'52"W 408.51', thence S89°31'44"W 1,258.72' to a point on the west boundary of Section 6, thence north with said west boundary of Section 6 408.0' to the point of beginning.	11.8700
4	4N-64W	6	Lot 2, Minor Subdivision 1053-6-2-MS-4, located in the NW/4 of Section 6, T4N-R64W, 6th P.M., Weld county, Colorado described as follows: beginning at a point on the west boundary of said Section 6 1,067.49' south of the NW corner of said Section Six, thence N89°31'44"E 1,258.72', thence S02°25'52"W 1,567.23' to a point on the southern boundary of the NW/4, thence S89°16'29"W 1,192.29' with said southern boundary of the NW/4 to a point on the west boundary of Section 6, thence north with said west boundary of Section 6 1,570.47' to the point of beginning, less and except a parcel conveyed by deed dated 10-03-1966 recorded in Book 574, Reception No. 1495631 in the Weld County public records described as beginning at a point 669.88' north of the west quarter corner of Section 6, thence north 200.00', thence east 220.90', thence south 200.00', thence west 220.90' to the point of beginning of such parcel, said parcel being 1.014 acres, more or less.	44.0000
5	4N-64W	6	That part of the Neres Canal situated in the N/2NW/4, Section 6, T4N-R64W, 6th P.M., containing 2.07 acres, more or less.	2.0700
6 & 7	4N-64W	5	W/2W/2NW/4NE/4, part of the NE/4NW/4 situated west and above the Gilmore Canal, SE/4NW/4 except for a strip of land on the west side thereof containing 2.80 acres.	310.0000
		6	NE/4.	
TOTAL GROSS ACRES				6,123.3200

\*of the 6th P.M., Weld Co., CO