

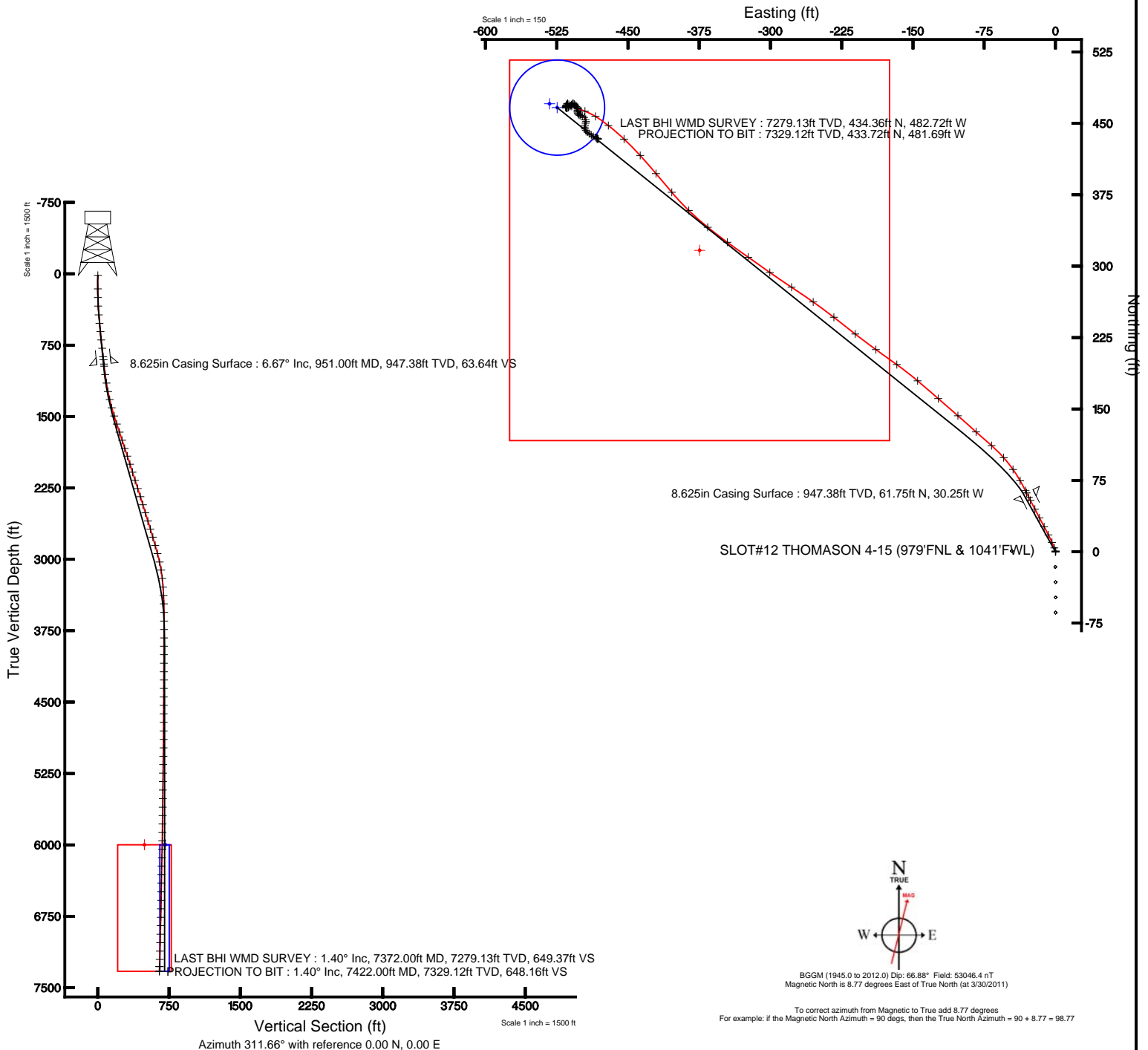

KERR MCGEE OIL & GAS ONSHORE LP

Location: COLORADO Slot: SLOT#12 THOMASON 4-15 (979'FNL & 1041'FWL)
Field: WELD COUNTY (KERR MCGEE) Well: THOMASON 4-15
Facility: SEC.15-T2N-R65W Wellbore: THOMASON 4-15 PWB

Plot reference wellbore is THOMASON 4-15 (REV-A) PWB	
True vertical depths are referenced to XTREME 6 (RKB)	Grid System: NAD83 / Lambert Colorado SP, Northern Zone (501), US feet
Measured depths are referenced to XTREME 6 (RKB)	North Reference: True north
XTREME 6 (RKB) to Mean Sea Level: 4880 feet	Scale: True distance
Mean Sea Level to Mud line (at Slot: SLOT#12 THOMASON 4-15 (979'FNL & 1041'FWL)): 0 feet	Depths are in feet
Coordinates are in feet referenced to Slot	Created by: cookdarn on 7/19/2011





Actual Wellpath Report

THOMASON 4-15 AWP

Page 1 of 4



REFERENCE WELLPATH IDENTIFICATION			
Operator	KERR MCGEE OIL & GAS ONSHORE LP	Slot	SLOT#12 THOMASON 4-15 (979'FNL & 1041'FWL)
Area	COLORADO	Well	THOMASON 4-15
Field	WELD COUNTY (KERR MCGEE)	Wellbore	THOMASON 4-15 AWB
Facility	SEC.15-T2N-R65W		

REPORT SETUP INFORMATION			
Projection System	NAD83 / Lambert Colorado SP, Northern Zone (501), US feet	Software System	WellArchitect® 3.0.0
North Reference	True	User	Cookdanm
Scale	0.999959	Report Generated	7/19/2011 at 3:34:44 PM
Convergence at slot	0.55° East	Database/Source file	WA_DENVER/THOMASON_4-15_AWB.xml

WELLPATH LOCATION						
	Local coordinates		Grid coordinates		Geographic coordinates	
	North[ft]	East[ft]	Easting[US ft]	Northing[US ft]	Latitude	Longitude
Slot Location	279.95	-2909.28	3235972.75	1296166.43	40°08'35.837"N	104°39'21.298"W
Facility Reference Pt			3238884.46	1295914.54	40°08'33.072"N	104°38'43.836"W
Field Reference Pt			3197771.84	1268891.29	40°04'09.600"N	104°47'36.000"W

WELLPATH DATUM			
Calculation method	Minimum curvature	XTREME 6 (RKB) to Facility Vertical Datum	4880.00ft
Horizontal Reference Pt	Slot	XTREME 6 (RKB) to Mean Sea Level	4880.00ft
Vertical Reference Pt	XTREME 6 (RKB)	XTREME 6 (RKB) to Mud Line at Slot (SLOT#12 THOMASON 4-15 (979'FNL & 1041'FWL))	4880.00ft
MD Reference Pt	XTREME 6 (RKB)	Section Origin	N 0.00, E 0.00 ft
Field Vertical Reference	Mean Sea Level	Section Azimuth	311.66°



Actual Wellpath Report

THOMASON 4-15 AWP

Page 2 of 4



REFERENCE WELLPATH IDENTIFICATION

Operator	KERR MCGEE OIL & GAS ONSHORE LP	Slot	SLOT#12 THOMASON 4-15 (979'FNL & 1041'FWL)
Area	COLORADO	Well	THOMASON 4-15
Field	WELD COUNTY (KERR MCGEE)	Wellbore	THOMASON 4-15 AWB
Facility	SEC.15-T2N-R65W		

WELLPATH DATA (86 stations) † = interpolated/extrapolated station

MD [ft]	Inclination [°]	Azimuth [°]	TVD [ft]	Vert Sect [ft]	North [ft]	East [ft]	DLS [°/100ft]	Comments
0.00†	0.000	125.500	0.00	0.00	0.00	0.00	0.00	
16.00	0.000	125.500	16.00	0.00	0.00	0.00	0.00	
157.00	0.400	125.500	157.00	-0.49	-0.29	0.40	0.28	
249.00	1.500	343.800	248.99	0.21	0.68	0.33	1.99	
339.00	3.000	335.400	338.92	3.36	3.96	-0.98	1.70	
431.00	4.900	336.400	430.70	9.14	9.75	-3.56	2.07	
520.00	6.200	332.900	519.28	17.07	17.51	-7.27	1.51	
608.00	6.600	332.200	606.73	26.23	26.21	-11.79	0.46	
697.00	6.900	332.200	695.11	36.03	35.47	-16.67	0.34	
785.00	6.600	332.600	782.50	45.70	44.63	-21.46	0.35	
875.00	6.600	332.600	871.90	55.36	53.82	-26.22	0.00	
906.00	6.800	333.300	902.69	58.73	57.04	-27.87	0.70	
974.00	6.600	332.900	970.23	66.12	64.11	-31.46	0.30	
1063.00	8.700	330.800	1058.43	77.24	74.54	-37.07	2.38	
1153.00	9.200	324.800	1147.34	90.68	86.36	-44.54	1.18	
1243.00	11.100	318.900	1235.93	106.28	98.77	-54.38	2.40	
1330.00	12.800	311.100	1321.04	124.23	111.42	-67.15	2.69	
1419.00	15.600	311.800	1407.32	146.06	125.88	-83.51	3.15	
1509.00	17.400	311.400	1493.61	171.62	142.85	-102.62	2.00	
1598.00	18.500	310.800	1578.27	199.05	160.87	-123.30	1.25	
1688.00	18.600	310.400	1663.60	227.67	179.51	-145.04	0.18	
1777.00	17.800	305.400	1748.15	255.39	196.59	-166.93	1.97	
1866.00	17.600	305.800	1832.94	282.30	212.34	-188.94	0.26	
1953.00	18.900	308.000	1915.56	309.44	228.71	-210.71	1.69	
2043.00	18.100	308.000	2000.91	337.94	246.29	-233.21	0.89	
2131.00	17.800	304.800	2084.63	364.94	262.38	-255.03	1.17	
2221.00	17.800	303.700	2170.32	392.22	277.87	-277.77	0.37	
2311.00	18.000	304.800	2255.96	419.65	293.44	-300.63	0.44	
2401.00	18.000	305.500	2341.56	447.28	309.45	-323.37	0.24	
2490.00	17.300	305.500	2426.37	474.11	325.12	-345.34	0.79	
2579.00	16.700	309.000	2511.48	500.05	340.85	-366.05	1.33	
2669.00	17.800	314.300	2597.44	526.71	358.60	-385.95	2.13	
2758.00	16.500	319.600	2682.48	552.82	377.72	-403.88	2.28	
2847.00	17.100	319.600	2767.68	578.29	397.31	-420.55	0.67	
2936.00	15.900	318.500	2853.02	603.36	416.41	-437.11	1.39	
3026.00	15.300	311.800	2939.71	627.47	433.56	-454.13	2.11	
3117.00	12.500	309.400	3028.04	649.33	447.82	-470.70	3.14	
3204.00	9.600	300.200	3113.42	665.85	457.44	-484.25	3.89	
3292.00	6.500	290.700	3200.55	677.69	462.90	-495.25	3.82	
3383.00	4.800	290.400	3291.10	686.05	466.05	-503.64	1.87	
3472.00	2.800	286.500	3379.90	691.49	467.96	-509.21	2.26	
3560.00	2.200	321.000	3467.82	695.10	469.88	-512.34	1.81	
3650.00	0.300	235.500	3557.80	696.87	471.09	-513.62	2.44	
3741.00	0.800	218.700	3648.79	696.89	470.46	-514.21	0.57	
3830.00	0.800	203.900	3737.79	696.67	469.41	-514.85	0.23	
3918.00	0.600	201.100	3825.78	696.32	468.42	-515.27	0.23	
4005.00	0.400	173.300	3912.78	695.93	467.69	-515.40	0.36	
4094.00	0.500	180.300	4001.77	695.44	466.99	-515.36	0.13	
4184.00	0.400	155.000	4091.77	694.90	466.32	-515.23	0.24	
4274.00	0.200	30.600	4181.77	694.64	466.17	-515.02	0.60	
4360.00	0.400	87.500	4267.77	694.45	466.31	-514.64	0.39	
4449.00	0.600	83.700	4356.76	693.92	466.37	-513.87	0.23	
4539.00	1.000	54.100	4446.76	693.43	466.89	-512.76	0.63	
4626.00	1.000	50.300	4533.74	693.15	467.82	-511.56	0.08	
4716.00	0.900	49.200	4623.73	692.94	468.78	-510.43	0.11	
4805.00	0.600	49.200	4712.72	692.79	469.54	-509.54	0.34	
4896.00	1.200	36.500	4803.71	692.81	470.62	-508.62	0.69	
4984.00	0.600	118.800	4891.70	692.45	471.14	-507.66	1.44	

5073.00	1.100	130.400	4980.69	691.14	470.36	-506.61	0.59	
5162.00	1.100	141.300	5069.68	689.44	469.14	-505.42	0.23	



Actual Wellpath Report

THOMASON 4-15 AWP

Page 3 of 4



REFERENCE WELLPATH IDENTIFICATION

Operator	KERR MCGEE OIL & GAS ONSHORE LP	Slot	SLOT#12 THOMASON 4-15 (979'FNL & 1041'FWL)
Area	COLORADO	Well	THOMASON 4-15
Field	WELD COUNTY (KERR MCGEE)	Wellbore	THOMASON 4-15 AWB
Facility	SEC.15-T2N-R65W		

WELLPATH DATA (86 stations)

MD [ft]	Inclination [°]	Azimuth [°]	TVD [ft]	Vert Sect [ft]	North [ft]	East [ft]	DLS [°/100ft]	Comments
5249.00	1.100	135.000	5156.66	687.78	467.90	-504.31	0.14	
5339.00	1.100	128.300	5246.64	686.06	466.75	-503.02	0.14	
5428.00	1.100	191.900	5335.63	684.78	465.39	-502.52	1.30	
5516.00	0.700	209.200	5423.62	684.25	464.09	-502.96	0.54	
5607.00	0.700	179.300	5514.61	683.75	463.05	-503.23	0.40	
5697.00	0.700	167.300	5604.61	682.94	461.96	-503.10	0.16	
5785.00	0.800	164.900	5692.60	681.99	460.84	-502.82	0.12	
5874.00	0.900	149.800	5781.59	680.80	459.64	-502.31	0.27	
5963.00	0.900	117.100	5870.58	679.46	458.72	-501.33	0.57	
6050.00	1.100	103.700	5957.57	678.06	458.21	-499.91	0.35	
6139.00	1.400	100.900	6046.54	676.37	457.80	-498.02	0.34	
6227.00	1.800	148.700	6134.51	674.13	456.42	-496.24	1.53	
6316.00	1.800	147.600	6223.47	671.45	454.04	-494.77	0.04	
6406.00	1.100	193.700	6313.44	669.68	452.01	-494.21	1.45	
6495.00	1.300	192.300	6402.42	668.79	450.19	-494.63	0.23	
6585.00	1.400	205.700	6492.40	667.98	448.20	-495.33	0.37	
6676.00	1.400	177.500	6583.37	666.90	446.09	-495.76	0.75	
6765.00	1.100	148.000	6672.35	665.33	444.28	-495.26	0.79	
6854.00	1.200	146.200	6761.33	663.61	442.78	-494.29	0.12	
6942.00	1.700	139.600	6849.31	661.42	441.02	-492.93	0.60	
7033.00	1.700	124.400	6940.27	658.74	439.23	-490.94	0.49	
7121.00	1.700	120.600	7028.23	656.17	437.83	-488.74	0.13	
7210.00	1.700	124.400	7117.19	653.56	436.41	-486.51	0.13	
7297.00	1.500	113.200	7204.15	651.20	435.24	-484.40	0.43	
7372.00	1.400	122.000	7279.13	649.37	434.36	-482.72	0.33	LAST BHI WMD SURVEY
7422.00	1.400	122.000	7329.12	648.16	433.72	-481.69	0.00	PROJECTION TO BIT

HOLE & CASING SECTIONS - Ref Wellbore: THOMASON 4-15 AWB Ref Wellpath: THOMASON 4-15 AWP

String/Diameter	Start MD [ft]	End MD [ft]	Interval [ft]	Start TVD [ft]	End TVD [ft]	Start N/S [ft]	Start E/W [ft]	End N/S [ft]	End E/W [ft]
12.25in Open Hole	16.00	951.00	935.00	16.00	947.38	0.00	0.00	61.75	-30.25
8.625in Casing Surface	16.00	951.00	935.00	16.00	947.38	0.00	0.00	61.75	-30.25
7.875in Open Hole	951.00	7422.00	6471.00	947.38	7329.12	61.75	-30.25	433.72	-481.69

TARGETS

Name	MD [ft]	TVD [ft]	North [ft]	East [ft]	Grid East [US ft]	Grid North [US ft]	Latitude	Longitude	Shape
THOMASON 4-15 BHL ON PLAT (510'FNL & 510'FWL, REV-1)		6000.00	470.68	-532.62	3235435.70	1296631.99	40°08'40.488"N	104°39'28.156"W	point
THOMASON 4-15 GEO TARGET 50' RADIUS (514'FNL & 518'FWL, REV-2)		6000.00	466.68	-524.58	3235443.77	1296628.07	40°08'40.449"N	104°39'28.053"W	circle
THOMASON 4-15 LEGAL BOX (50'N,350'S,50'W,350'E OF GEO TARGET)		6000.00	316.68	-374.58	3235595.19	1296479.51	40°08'38.966"N	104°39'26.121"W	square

WELLPATH COMPOSITION - Ref Wellbore: THOMASON 4-15 AWB Ref Wellpath: THOMASON 4-15 AWP

Start MD [ft]	End MD [ft]	Positional Uncertainty Model	Log Name/Comment	Wellbore
16.00	7372.00	NaviTrak (Standard)	BHI WMD SURVEYS <157-7372>	THOMASON 4-15 AWB
7372.00	7422.00	Blind Drilling (std)	Projection to bit	THOMASON 4-15 AWB



Actual Wellpath Report

THOMASON 4-15 AWP

Page 4 of 4



REFERENCE WELLPATH IDENTIFICATION

Operator	KERR MCGEE OIL & GAS ONSHORE LP	Slot	SLOT#12 THOMASON 4-15 (979'FNL & 1041'FWL)
Area	COLORADO	Well	THOMASON 4-15
Field	WELD COUNTY (KERR MCGEE)	Wellbore	THOMASON 4-15 AWB
Facility	SEC.15-T2N-R65W		

WELLPATH COMMENTS

MD [ft]	Inclination [°]	Azimuth [°]	TVD [ft]	Comment
7372.00	1.400	122.000	7279.13	LAST BHI WMD SURVEY
7422.00	1.400	122.000	7329.12	PROJECTION TO BIT