

KERR MCGEE OIL & GAS ONSHORE LP

Location: COLORADO Slot: SLOT#15 MIRACLE 14-12 (2484'FSL & 2641'FEL)
 Field: LARIMER COUNTY Well: MIRACLE 14-12
 Facility: SEC.12-T5N-R68W Wellbore: MIRACLE 14-12 PWB

Plot reference wellpath is MIRACLE 14-12 (REV-A.0) PWB

True vertical depths are referenced to XTREME 6 (RT)	Grid System: NAD83 / Lambert Colorado State Planes, Northern Zone (501), US feet
Measured depths are referenced to XTREME 6 (RT)	North Reference: True north
XTREME 6 (RT) to Mean Sea Level: 4978 feet	Scale: True distance
Mean Sea Level to Mud line (Facility: SEC.12-T5N-R68W): 0 feet	Depths are in feet
Coordinates are in feet referenced to Slot	Created by: nistale on 10/26/2010

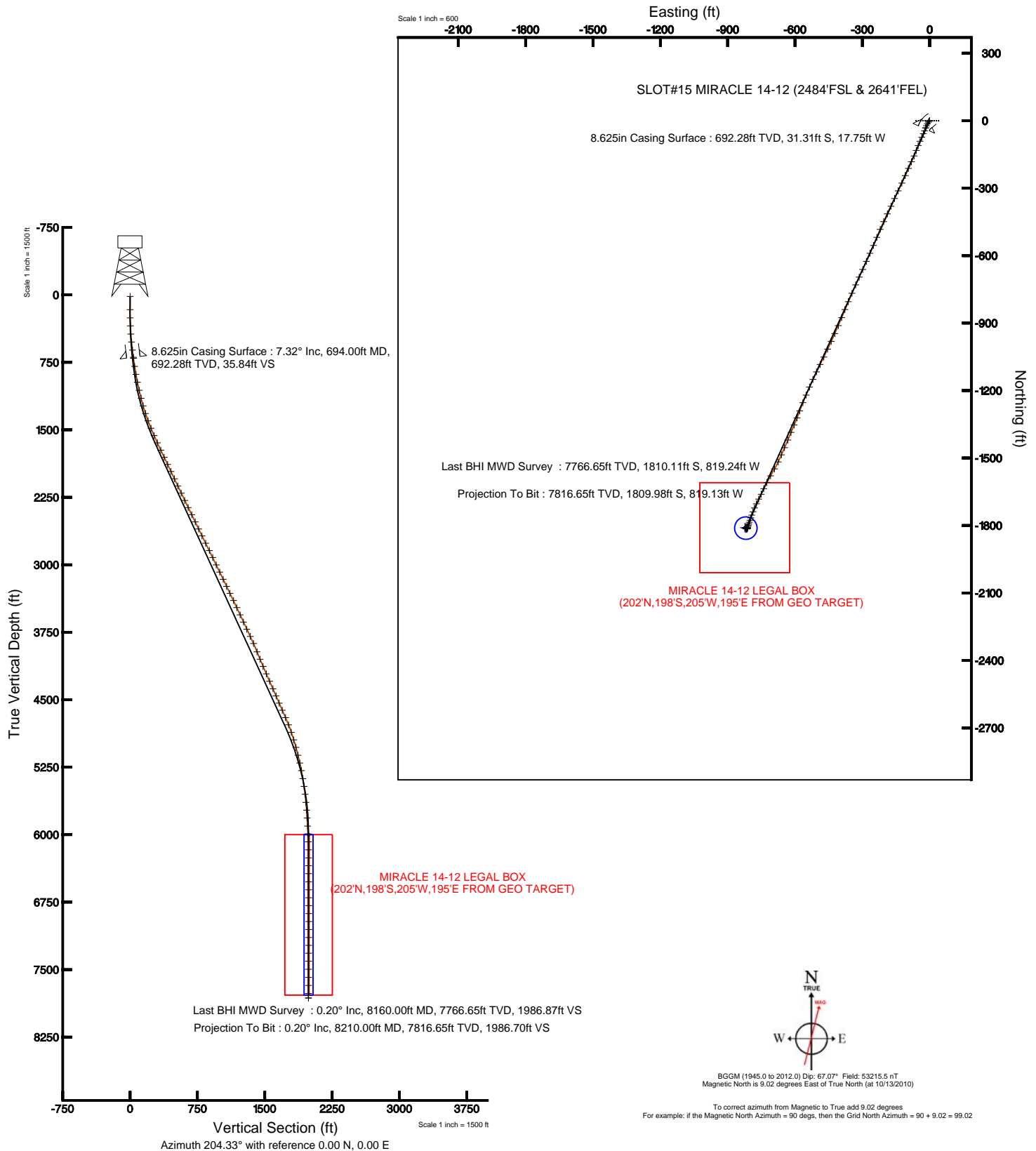



Actual Wellpath Report

MIRACLE 14-12 AWB _awp

Page 1 of 5



INTEQ

REFERENCE WELLPATH IDENTIFICATION

Operator	KERR MCGEE OIL & GAS ONSHORE LP	Slot	SLOT#15 MIRACLE 14-12 (2484'FSL & 2641'FEL)
Area	COLORADO	Well	MIRACLE 14-12
Field	LARIMER COUNTY	Wellbore	MIRACLE 14-12 AWB
Facility	SEC.12-T5N-R68W		

REPORT SETUP INFORMATION

Projection System	NAD83 / Lambert Colorado State Planes, Northern Zone (501), US feet	Software System	WellArchitect@ 2.0
North Reference	True	User	Nistale
Scale	0.999961	Report Generated	10/26/2010 at 4:43:14 PM
Convergence at slot	0.35° East	Database/Source file	Denver Server/MIRACLE_14-12_AWB_.xml

WELLPATH LOCATION

	Local coordinates		Grid coordinates		Geographic coordinates	
	North[ft]	East[ft]	Easting[USft]	Northing[USft]	Latitude	Longitude
Slot Location	46.38	-2365.28	3152055.10	1394095.23	40°24'50.069"N	104°57'14.134"W
Facility Reference Pt			3154420.53	1394063.64	40°24'49.612"N	104°56'43.555"W
Field Reference Pt			3154420.53	1394063.64	40°24'49.612"N	104°56'43.555"W

WELLPATH DATUM

Calculation method	Minimum curvature	XTREME 6 (RT) to Facility Vertical Datum	4978.00ft
Horizontal Reference Pt	Slot	XTREME 6 (RT) to Mean Sea Level	4978.00ft
Vertical Reference Pt	XTREME 6 (RT)	Facility Vertical Datum to Mud Line (Facility)	0.00ft
MD Reference Pt	XTREME 6 (RT)	Section Origin	N 0.00, E 0.00 ft
Field Vertical Reference	Mean Sea Level	Section Azimuth	204.33°



Actual Wellpath Report

MIRACLE 14-12 AWB _awp

Page 2 of 5



INTEQ

REFERENCE WELLPATH IDENTIFICATION

Operator	KERR MCGEE OIL & GAS ONSHORE LP	Slot	SLOT#15 MIRACLE 14-12 (2484'FSL & 2641'FEL)
Area	COLORADO	Well	MIRACLE 14-12
Field	LARIMER COUNTY	Wellbore	MIRACLE 14-12 AWB
Facility	SEC.12-T5N-R68W		

WELLPATH DATA (94 stations) † = interpolated/extrapolated station

MD [ft]	Inclination [°]	Azimuth [°]	TVD [ft]	Vert Sect [ft]	North [ft]	East [ft]	DLS [°/100ft]	Comments
0.00†	0.000	247.400	0.00	0.00	0.00	0.00	0.00	
16.00	0.000	247.400	16.00	0.00	0.00	0.00	0.00	
163.00	0.300	247.400	163.00	0.28	-0.15	-0.36	0.20	
254.00	0.500	243.800	254.00	0.76	-0.41	-0.93	0.22	
343.00	2.500	215.400	342.96	2.97	-2.17	-2.40	2.33	
434.00	4.200	218.200	433.80	8.15	-6.41	-5.62	1.88	
523.00	6.000	211.000	522.45	15.93	-12.95	-10.03	2.14	
614.00	6.800	201.000	612.88	26.04	-22.06	-14.41	1.50	
706.00	7.400	198.500	704.18	37.37	-32.76	-18.24	0.73	
796.00	8.600	202.700	793.30	49.86	-44.47	-22.68	1.48	
886.00	10.100	203.800	882.10	64.48	-57.90	-28.46	1.68	
976.00	11.500	203.800	970.51	81.34	-73.33	-35.26	1.56	
1067.00	13.000	204.000	1059.43	100.65	-90.98	-43.09	1.65	
1158.00	14.300	201.700	1147.86	122.11	-110.77	-51.41	1.55	
1246.00	16.100	200.300	1232.78	145.14	-132.32	-59.66	2.09	
1335.00	18.000	203.100	1317.87	171.20	-156.54	-69.34	2.33	
1422.00	20.600	205.200	1399.97	199.95	-182.76	-81.13	3.09	
1510.00	22.600	204.100	1481.79	232.34	-212.21	-94.63	2.32	
1598.00	24.000	203.400	1562.61	267.15	-244.07	-108.64	1.62	
1687.00	24.700	205.200	1643.69	303.84	-277.50	-123.74	1.15	
1777.00	25.200	206.600	1725.29	341.79	-311.65	-140.33	0.86	
1865.00	25.400	204.100	1804.85	379.38	-345.63	-156.42	1.24	
1953.00	25.900	205.600	1884.18	417.47	-380.19	-172.44	0.93	
2040.00	25.300	205.600	1962.64	455.05	-414.09	-188.68	0.69	
2129.00	25.400	204.900	2043.07	493.15	-448.56	-204.93	0.35	
2218.00	25.300	204.000	2123.50	531.25	-483.24	-220.70	0.45	
2307.00	25.800	201.700	2203.80	569.62	-518.61	-235.60	1.25	
2397.00	25.400	203.400	2284.97	608.49	-554.53	-250.51	0.93	
2485.00	26.300	204.200	2364.16	646.85	-589.63	-266.00	1.10	
2573.00	26.700	204.200	2442.91	686.12	-625.44	-282.09	0.45	
2662.00	26.000	204.200	2522.67	725.62	-661.48	-298.28	0.79	
2749.00	25.200	204.900	2601.13	763.21	-695.67	-313.90	0.98	
2836.00	26.300	203.800	2679.49	801.00	-730.11	-329.48	1.38	
2927.00	27.200	204.500	2760.75	841.96	-767.48	-346.24	1.05	
3017.00	26.500	203.400	2841.04	882.61	-804.62	-362.74	0.95	
3104.00	25.400	202.400	2919.27	920.67	-839.69	-377.56	1.36	
3195.00	25.400	201.700	3001.48	959.67	-875.87	-392.21	0.33	
3283.00	26.000	203.400	3080.77	997.81	-911.10	-406.85	1.08	
3372.00	25.800	204.900	3160.83	1036.68	-946.57	-422.76	0.77	
3460.00	25.700	204.200	3240.09	1074.91	-981.35	-438.64	0.36	
3546.00	26.500	205.200	3317.32	1112.74	-1015.72	-454.45	1.06	
3635.00	26.100	206.300	3397.11	1152.16	-1051.24	-471.58	0.71	
3722.00	24.000	207.000	3475.92	1188.97	-1084.16	-488.10	2.44	
3811.00	24.400	205.600	3557.10	1225.42	-1116.87	-504.26	0.79	
3899.00	25.100	205.000	3637.02	1262.26	-1150.18	-520.00	0.85	



Actual Wellpath Report

MIRACLE 14-12 AWB _awp

Page 3 of 5



INTEQ

REFERENCE WELLPATH IDENTIFICATION

Operator	KERR MCGEE OIL & GAS ONSHORE LP	Slot	SLOT#15 MIRACLE 14-12 (2484'FSL & 2641'FEL)
Area	COLORADO	Well	MIRACLE 14-12
Field	LARIMER COUNTY	Wellbore	MIRACLE 14-12 AWB
Facility	SEC.12-T5N-R68W		

WELLPATH DATA (94 stations)

MD [ft]	Inclination [°]	Azimuth [°]	TVD [ft]	Vert Sect [ft]	North [ft]	East [ft]	DLS [°/100ft]	Comments
3987.00	25.700	203.400	3716.51	1300.00	-1184.60	-535.46	1.04	
4076.00	25.900	202.700	3796.64	1338.73	-1220.25	-550.63	0.41	
4163.00	23.800	202.400	3875.58	1375.27	-1254.01	-564.65	2.42	
4263.00	21.900	200.600	3967.73	1414.05	-1290.12	-578.91	2.02	
4352.00	22.700	201.300	4050.07	1447.76	-1321.66	-590.98	0.95	
4439.00	23.400	203.100	4130.13	1481.80	-1353.19	-603.86	1.14	
4529.00	23.700	202.400	4212.63	1517.74	-1386.35	-617.76	0.46	
4619.00	24.400	203.400	4294.82	1554.41	-1420.14	-632.04	0.90	
4710.00	23.400	203.400	4378.02	1591.27	-1453.97	-646.68	1.10	
4797.00	23.600	203.100	4457.80	1625.96	-1485.85	-660.38	0.27	
4884.00	23.400	206.200	4537.59	1660.64	-1517.37	-674.84	1.44	
4971.00	24.000	209.800	4617.25	1695.52	-1548.23	-691.26	1.80	
5060.00	23.700	209.100	4698.65	1731.36	-1579.56	-708.95	0.46	
5147.00	21.900	208.700	4778.85	1764.96	-1609.07	-725.25	2.08	
5236.00	18.700	205.200	4862.32	1795.79	-1636.55	-739.30	3.84	
5325.00	16.900	205.900	4947.05	1822.99	-1661.10	-751.02	2.04	
5412.00	15.800	207.000	5030.53	1847.46	-1683.03	-761.93	1.31	
5502.00	13.800	205.600	5117.54	1870.43	-1703.63	-772.13	2.26	
5591.00	12.900	203.800	5204.14	1890.98	-1722.29	-780.72	1.11	
5678.00	11.300	200.000	5289.21	1909.19	-1739.19	-787.56	2.05	
5767.00	9.400	200.300	5376.75	1925.14	-1754.20	-793.06	2.14	
5854.00	7.700	197.100	5462.78	1938.01	-1766.43	-797.24	2.03	
5943.00	6.500	200.000	5551.10	1948.95	-1776.87	-800.72	1.41	
6034.00	5.300	199.200	5641.62	1958.27	-1785.68	-803.86	1.32	
6121.00	4.500	198.900	5728.30	1965.67	-1792.70	-806.29	0.92	
6208.00	3.600	197.500	5815.08	1971.78	-1798.53	-808.21	1.04	
6299.00	3.200	193.300	5905.92	1977.11	-1803.73	-809.66	0.52	
6385.00	2.500	196.000	5991.81	1981.32	-1807.87	-810.73	0.83	
6474.00	2.000	196.000	6080.74	1984.78	-1811.23	-811.69	0.56	
6562.00	0.500	211.000	6168.72	1986.68	-1813.03	-812.31	1.73	
6652.00	0.500	201.000	6258.72	1987.46	-1813.74	-812.65	0.10	
6739.00	0.400	205.200	6345.71	1988.14	-1814.37	-812.92	0.12	
6827.00	0.400	219.300	6433.71	1988.75	-1814.88	-813.25	0.11	
6918.00	0.400	258.000	6524.71	1989.24	-1815.19	-813.76	0.29	
7007.00	0.400	269.000	6613.71	1989.56	-1815.26	-814.37	0.09	
7095.00	0.400	267.800	6701.71	1989.83	-1815.28	-814.99	0.01	
7183.00	0.700	282.000	6789.70	1990.08	-1815.18	-815.82	0.37	
7271.00	0.600	285.400	6877.70	1990.27	-1814.95	-816.79	0.12	
7360.00	0.800	293.100	6966.69	1990.35	-1814.58	-817.81	0.25	
7449.00	1.100	312.100	7055.68	1990.10	-1813.76	-819.01	0.48	
7537.00	0.800	325.400	7143.66	1989.53	-1812.69	-819.99	0.42	
7625.00	0.400	340.600	7231.66	1988.99	-1811.89	-820.44	0.49	
7712.00	0.400	16.800	7318.66	1988.47	-1811.32	-820.45	0.29	
7801.00	0.300	33.000	7407.66	1987.93	-1810.82	-820.24	0.16	
7890.00	0.200	90.200	7496.66	1987.64	-1810.63	-819.96	0.29	



Actual Wellpath Report

MIRACLE 14-12 AWB _awp

Page 4 of 5



INTEQ

REFERENCE WELLPATH IDENTIFICATION

Operator	KERR MCGEE OIL & GAS ONSHORE LP	Slot	SLOT#15 MIRACLE 14-12 (2484'FSL & 2641'FEL)
Area	COLORADO	Well	MIRACLE 14-12
Field	LARIMER COUNTY	Wellbore	MIRACLE 14-12 AWB
Facility	SEC.12-T5N-R68W		

WELLPATH DATA (94 stations)

MD [ft]	Inclination [°]	Azimuth [°]	TVD [ft]	Vert Sect [ft]	North [ft]	East [ft]	DLS [°/100ft]	Comments
7981.00	0.200	32.600	7587.65	1987.42	-1810.50	-819.71	0.21	
8071.00	0.200	63.900	7677.65	1987.14	-1810.29	-819.49	0.12	
8160.00	0.200	41.400	7766.65	1986.87	-1810.11	-819.24	0.09	Last BHI MWD Survey
8210.00	0.200	41.400	7816.65	1986.70	-1809.98	-819.13	0.00	Projection To Bit

HOLE & CASING SECTIONS Ref Wellbore: MIRACLE 14-12 AWB Ref Wellpath: MIRACLE 14-12 AWB _awp

String/Diameter	Start MD [ft]	End MD [ft]	Interval [ft]	Start TVD [ft]	End TVD [ft]	Start N/S [ft]	Start E/W [ft]	End N/S [ft]	End E/W [ft]
12.25in Open Hole	16.00	694.00	678.00	16.00	692.28	0.00	0.00	-31.31	-17.75
8.625in Casing Surface	16.00	694.00	678.00	16.00	692.28	0.00	0.00	-31.31	-17.75
7.875in Open Hole	694.00	8210.00	7516.00	692.28	7816.65	-31.31	-17.75	-1809.98	-819.13

TARGETS

Name	MD [ft]	TVD [ft]	North [ft]	East [ft]	Grid East [srv ft]	Grid North [srv ft]	Latitude	Longitude	Shape
MIRACLE 14-12 GEO TARGET 50' RADIUS (658'FSL & 2071'FWL, REV-1)		6000.00	-1811.71	-819.02	3151247.28	1392278.58	40°24'32.166"N	104°57'24.721"W	circle
MIRACLE 14-12 LEGAL BOX (202'N,198'S,205'W,195'E FROM GEO TARGET)		6000.00	-1809.71	-824.02	3151242.28	1392280.56	40°24'32.186"N	104°57'24.786"W	square

WELLPATH COMPOSITION Ref Wellbore: MIRACLE 14-12 AWB Ref Wellpath: MIRACLE 14-12 AWB _awp

Start MD [ft]	End MD [ft]	Positional Uncertainty Model	Log Name/Comment	Wellbore
16.00	614.00	NaviTrak (Standard)	BHI MWD Surveys 12.25 HOLE <0' - 614'>	MIRACLE 14-12 AWB
614.00	8160.00	NaviTrak (Standard)	BHI MWD Surveys 7.875 HOLE <706' - 8210'>	MIRACLE 14-12 AWB
8160.00	8210.00	Blind Drilling (std)	Projection to bit	MIRACLE 14-12 AWB



Actual Wellpath Report

MIRACLE 14-12 AWB _awp

Page 5 of 5



INTEQ

REFERENCE WELLPATH IDENTIFICATION

Operator	KERR MCGEE OIL & GAS ONSHORE LP	Slot	SLOT#15 MIRACLE 14-12 (2484'FSL & 2641'FEL)
Area	COLORADO	Well	MIRACLE 14-12
Field	LARIMER COUNTY	Wellbore	MIRACLE 14-12 AWB
Facility	SEC.12-T5N-R68W		

WELLPATH COMMENTS

MD [ft]	Inclination [°]	Azimuth [°]	TVD [ft]	Comment
8160.00	0.200	41.400	7766.65	Last BHI MWD Survey
8210.00	0.200	41.400	7816.65	Projection To Bit