

KERR MCGEE OIL & GAS ONSHORE LP

Location: COLORADO Slot: SLOT#02 MIRACLE 8-12 (2480'FSL & 285'FEL)
 Field: LARIMER COUNTY Well: MIRACLE 8-12
 Facility: SEC.12-T5N-R68W Wellbore: MIRACLE 8-12 PWB

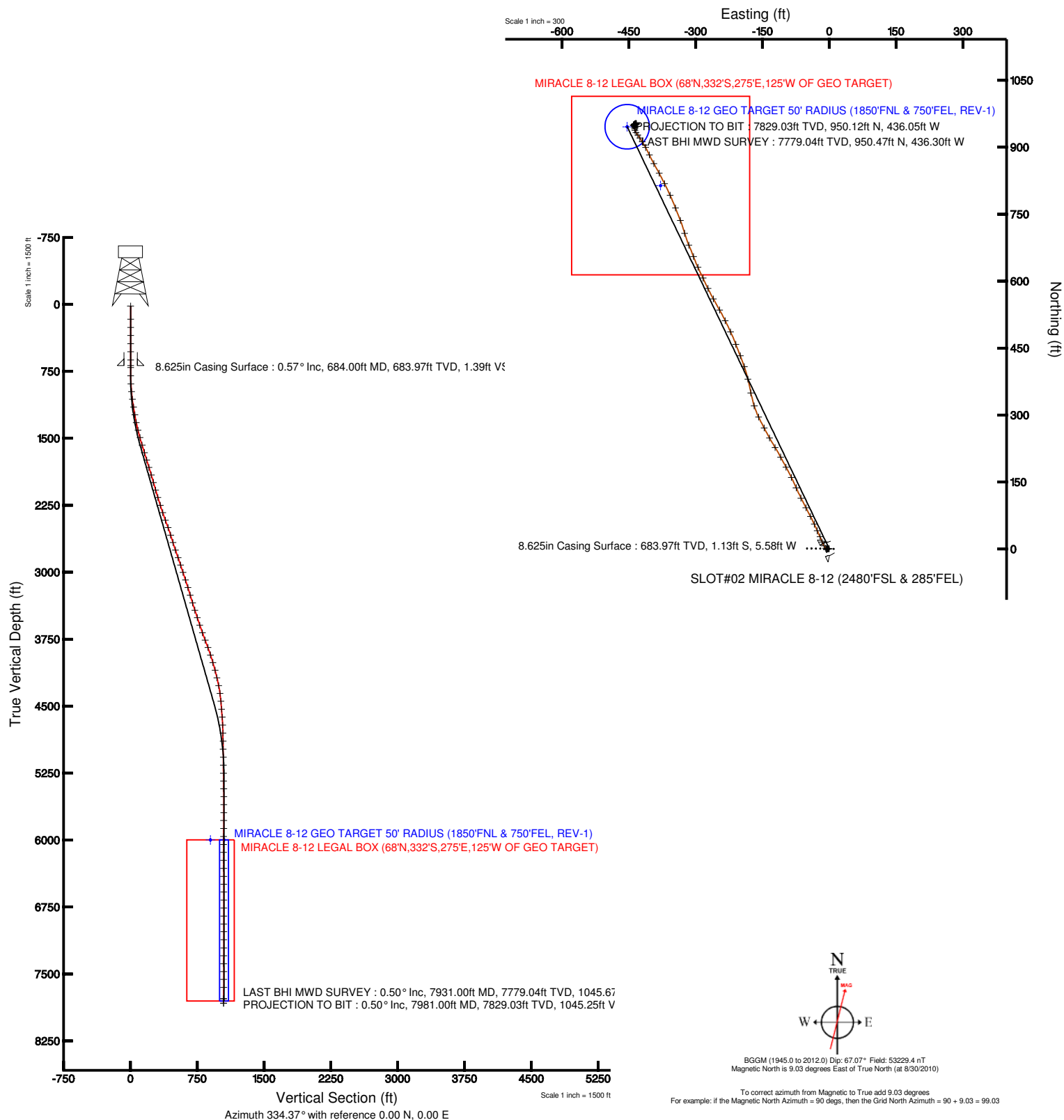

Plot reference wellpath is MIRACLE 8-12 (REV-B.0) PWP	
True vertical depths are referenced to XTREME 6 (RT)	Grid System: NAD83 / Lambert Colorado State Planes, Northern Zone (501), US feet
Measured depths are referenced to XTREME 6 (RT)	North Reference: True north
XTREME 6 (RT) to Mean Sea Level: 4964 feet	Scale: True distance
Mean Sea Level to Mud line (Facility: SEC.12-T5N-R68W): 0 feet	Depths are in feet
Coordinates are in feet referenced to Slot	Created by: bensjacj on 9/2/2010





Actual Wellpath Report

MIRACLE 8-12 AWP

Page 1 of 5



INTEQ

REFERENCE WELLPATH IDENTIFICATION

Operator	KERR MCGEE OIL & GAS ONSHORE LP	Slot	SLOT#02 MIRACLE 8-12 (2480'FSL & 285'FEL)
Area	COLORADO	Well	MIRACLE 8-12
Field	LARIMER COUNTY	Wellbore	MIRACLE 8-12 AWB
Facility	SEC.12-T5N-R68W		

REPORT SETUP INFORMATION

Projection System	NAD83 / Lambert Colorado State Planes, Northern Zone (501), US feet	Software System	WellArchitect® 2.0
North Reference	True	User	Bensjacj
Scale	0.999961	Report Generated	9/2/2010 at 10:39:56 AM
Convergence at slot	0.36° East	Database/Source file	WA_Denver/MIRACLE_8-12_AWB.xml

WELLPATH LOCATION

	Local coordinates		Grid coordinates		Geographic coordinates	
	North[ft]	East[ft]	Easting[USft]	Northing[USft]	Latitude	Longitude
Slot Location	0.36	-10.02	3154410.50	1394063.95	40°24'49.615"N	104°56'43.685"W
Facility Reference Pt			3154420.53	1394063.64	40°24'49.612"N	104°56'43.555"W
Field Reference Pt			3154420.53	1394063.64	40°24'49.612"N	104°56'43.555"W

WELLPATH DATUM

Calculation method	Minimum curvature	XTREME 6 (RT) to Facility Vertical Datum	4964.00ft
Horizontal Reference Pt	Slot	XTREME 6 (RT) to Mean Sea Level	4964.00ft
Vertical Reference Pt	XTREME 6 (RT)	Facility Vertical Datum to Mud Line (Facility)	0.00ft
MD Reference Pt	XTREME 6 (RT)	Section Origin	N 0.00, E 0.00 ft
Field Vertical Reference	Mean Sea Level	Section Azimuth	334.37°



Actual Wellpath Report

MIRACLE 8-12 AWP

Page 2 of 5



REFERENCE WELLPATH IDENTIFICATION

Operator	KERR MCGEE OIL & GAS ONSHORE LP	Slot	SLOT#02 MIRACLE 8-12 (2480'FSL & 285'FEL)
Area	COLORADO	Well	MIRACLE 8-12
Field	LARIMER COUNTY	Wellbore	MIRACLE 8-12 AWB
Facility	SEC.12-T5N-R68W		

WELLPATH DATA (91 stations) † = interpolated/extrapolated station

MD [ft]	Inclination [°]	Azimuth [°]	TVD [ft]	Vert Sect [ft]	North [ft]	East [ft]	DLS [°/100ft]	Comments
0.00†	0.000	262.900	0.00	0.00	0.00	0.00	0.00	
16.00	0.000	262.900	16.00	0.00	0.00	0.00	0.00	
163.00	0.600	262.900	163.00	0.24	-0.10	-0.76	0.41	
256.00	0.700	274.500	255.99	0.68	-0.11	-1.81	0.18	
347.00	0.900	260.400	346.98	1.16	-0.19	-3.07	0.31	
439.00	0.400	267.800	438.98	1.49	-0.32	-4.11	0.55	
530.00	0.300	256.900	529.97	1.67	-0.39	-4.65	0.13	
621.00	0.500	229.100	620.97	1.61	-0.70	-5.19	0.30	
707.00	0.600	211.600	706.97	1.27	-1.33	-5.71	0.23	
798.00	0.600	320.900	797.97	1.48	-1.36	-6.26	1.08	
889.00	3.400	324.100	888.90	4.60	1.19	-8.14	3.08	
976.00	5.100	327.200	975.66	10.97	6.53	-11.75	1.97	
1063.00	7.500	339.800	1062.13	20.46	15.11	-15.80	3.17	
1150.00	9.300	335.300	1148.20	33.14	26.83	-20.70	2.20	
1239.00	9.800	335.700	1235.96	47.91	40.27	-26.82	0.57	
1327.00	11.800	335.000	1322.40	64.39	55.25	-33.71	2.28	
1414.00	13.700	332.800	1407.25	83.59	72.47	-42.18	2.25	
1501.00	15.400	332.100	1491.46	105.43	91.85	-52.29	1.96	
1589.00	16.900	333.900	1575.98	129.90	113.66	-63.39	1.80	
1676.00	17.100	335.300	1659.18	155.33	136.64	-74.30	0.52	
1763.00	17.300	335.000	1742.29	181.06	159.98	-85.11	0.25	
1850.00	17.400	330.700	1825.34	206.97	183.05	-96.94	1.48	
1938.00	16.500	332.100	1909.51	232.59	205.57	-109.23	1.12	
2026.00	16.100	328.300	1993.98	257.21	227.00	-121.49	1.29	
2115.00	16.400	331.100	2079.42	282.03	248.50	-134.05	0.94	
2202.00	17.300	331.800	2162.69	307.21	270.65	-146.10	1.06	
2293.00	17.800	334.300	2249.45	334.64	295.11	-158.52	0.99	
2380.00	18.600	342.300	2332.11	361.69	320.31	-168.51	3.01	
2470.00	20.600	348.700	2416.90	391.25	349.52	-175.98	3.26	
2559.00	20.600	346.200	2500.21	421.74	380.08	-182.78	0.99	
2648.00	17.600	341.600	2584.31	450.42	408.06	-190.76	3.77	
2735.00	17.300	338.100	2667.31	476.38	432.54	-199.74	1.25	
2823.00	19.300	338.800	2750.85	503.94	458.24	-209.88	2.29	
2914.00	19.500	335.300	2836.69	534.12	486.06	-221.67	1.30	
3001.00	18.000	333.900	2919.07	562.08	511.33	-233.65	1.80	
3088.00	18.500	330.000	3001.70	589.29	535.36	-246.46	1.52	
3178.00	18.100	331.100	3087.15	617.49	559.96	-260.36	0.59	
3266.00	16.800	334.600	3171.10	643.85	583.42	-272.42	1.90	
3355.00	17.100	334.900	3256.23	669.80	606.89	-283.49	0.35	
3446.00	17.200	334.600	3343.18	696.63	631.16	-294.94	0.15	
3532.00	18.100	339.500	3425.14	722.65	655.16	-305.07	2.02	
3620.00	18.200	336.700	3508.76	750.00	680.58	-315.29	1.00	
3709.00	19.000	343.900	3593.12	778.18	707.27	-324.81	2.73	
3800.00	19.800	338.800	3678.96	808.16	735.88	-334.49	2.06	
3888.00	20.400	338.500	3761.60	838.32	764.04	-345.50	0.69	



Actual Wellpath Report

MIRACLE 8-12 AWP

Page 3 of 5



REFERENCE WELLPATH IDENTIFICATION

Operator	KERR MCGEE OIL & GAS ONSHORE LP	Slot	SLOT#02 MIRACLE 8-12 (2480'FSL & 285'FEL)
Area	COLORADO	Well	MIRACLE 8-12
Field	LARIMER COUNTY	Wellbore	MIRACLE 8-12 AWP
Facility	SEC.12-T5N-R68W		

WELLPATH DATA (91 stations)

MD [ft]	Inclination [°]	Azimuth [°]	TVD [ft]	Vert Sect [ft]	North [ft]	East [ft]	DLS [°/100ft]	Comments
3976.00	20.500	335.700	3844.06	869.02	792.36	-357.47	1.12	
4064.00	18.000	332.800	3927.13	898.02	818.50	-370.02	3.04	
4153.00	16.400	332.100	4012.15	924.32	841.84	-382.19	1.81	
4243.00	15.400	331.100	4098.71	948.95	863.53	-393.91	1.15	
4330.00	13.600	333.500	4182.93	970.71	882.80	-404.06	2.18	
4419.00	11.000	332.500	4269.88	989.66	899.69	-412.65	2.93	
4508.00	8.100	326.900	4357.64	1004.37	912.48	-420.00	3.42	
4597.00	5.200	326.200	4446.03	1014.58	921.09	-425.66	3.26	
4686.00	4.800	325.500	4534.69	1022.25	927.51	-430.02	0.45	
4775.00	4.100	324.000	4623.43	1029.06	933.15	-434.00	0.80	
4865.00	2.900	342.000	4713.26	1034.48	937.92	-436.59	1.79	
4954.00	1.500	16.400	4802.19	1037.58	941.18	-436.96	2.10	
5044.00	1.100	3.800	4892.17	1039.21	943.17	-436.57	0.54	
5135.00	0.900	352.900	4983.16	1040.65	944.75	-436.60	0.30	
5223.00	0.800	344.400	5071.15	1041.91	946.03	-436.85	0.18	
5314.00	0.600	340.000	5162.14	1043.01	947.09	-437.18	0.23	
5403.00	0.600	338.800	5251.14	1043.94	947.96	-437.51	0.01	
5492.00	0.900	302.000	5340.13	1044.99	948.76	-438.27	0.62	
5579.00	0.800	297.300	5427.12	1046.05	949.41	-439.39	0.14	
5667.00	0.200	299.800	5515.12	1046.67	949.76	-440.07	0.68	
5757.00	0.100	169.700	5605.12	1046.72	949.76	-440.19	0.31	
5846.00	0.200	106.100	5694.12	1046.54	949.64	-440.03	0.20	
5933.00	0.400	73.000	5781.11	1046.40	949.69	-439.59	0.30	
6024.00	0.900	70.200	5872.11	1046.28	950.03	-438.62	0.55	
6114.00	1.000	79.700	5962.10	1046.00	950.41	-437.18	0.21	
6204.00	1.000	72.300	6052.08	1045.68	950.79	-435.66	0.14	
6291.00	0.500	56.200	6139.07	1045.63	951.23	-434.62	0.62	
6381.00	0.500	67.800	6229.07	1045.66	951.59	-433.93	0.11	
6470.00	0.500	342.300	6318.07	1046.03	952.11	-433.69	0.76	
6560.00	0.200	30.500	6408.07	1046.50	952.62	-433.73	0.44	
6647.00	0.300	342.700	6495.07	1046.81	952.97	-433.72	0.26	
6735.00	0.400	278.000	6583.06	1047.21	953.23	-434.09	0.44	
6825.00	0.600	263.200	6673.06	1047.54	953.22	-434.87	0.26	
6916.00	0.700	247.400	6764.06	1047.72	952.95	-435.86	0.22	
7005.00	0.400	253.400	6853.05	1047.80	952.65	-436.66	0.34	
7094.00	0.400	234.800	6942.05	1047.79	952.38	-437.21	0.15	
7181.00	0.800	194.300	7029.04	1047.28	951.62	-437.61	0.64	
7271.00	0.200	224.900	7119.04	1046.74	950.90	-437.87	0.71	
7362.00	0.200	114.500	7210.04	1046.57	950.72	-437.84	0.36	
7450.00	0.200	177.500	7298.04	1046.31	950.50	-437.69	0.24	
7539.00	0.200	45.260	7387.04	1046.22	950.46	-437.58	0.41	
7627.00	0.400	36.500	7475.04	1046.41	950.81	-437.28	0.23	
7715.00	0.200	104.300	7563.04	1046.46	951.02	-436.95	0.42	
7804.00	0.100	110.700	7652.04	1046.30	950.96	-436.73	0.11	
7931.00	0.500	144.100	7779.04	1045.67	950.47	-436.30	0.33	LAST BHI MWD SURVEY



Actual Wellpath Report

MIRACLE 8-12 AWP

Page 4 of 5



INTEQ

REFERENCE WELLPATH IDENTIFICATION

Operator	KERR MCGEE OIL & GAS ONSHORE LP	Slot	SLOT#02 MIRACLE 8-12 (2480'FSL & 285'FEL)
Area	COLORADO	Well	MIRACLE 8-12
Field	LARIMER COUNTY	Wellbore	MIRACLE 8-12 AWB
Facility	SEC.12-T5N-R68W		

WELLPATH DATA (91 stations)

MD [ft]	Inclination [°]	Azimuth [°]	TVD [ft]	Vert Sect [ft]	North [ft]	East [ft]	DLS [°/100ft]	Comments
7981.00	0.500	144.100	7829.03	1045.25	950.12	-436.05	0.00	PROJECTION TO BIT

HOLE & CASING SECTIONS Ref Wellbore: MIRACLE 8-12 AWB Ref Wellpath: MIRACLE 8-12 AWP

String/Diameter	Start MD [ft]	End MD [ft]	Interval [ft]	Start TVD [ft]	End TVD [ft]	Start N/S [ft]	Start E/W [ft]	End N/S [ft]	End E/W [ft]
12.25in Open Hole	16.00	694.00	678.00	16.00	693.97	0.00	0.00	-1.22	-5.63
8.625in Casing Surface	16.00	684.00	668.00	16.00	683.97	0.00	0.00	-1.13	-5.58
7.875in Open Hole	684.00	7981.00	7297.00	683.97	7829.03	-1.13	-5.58	950.12	-436.05

TARGETS

Name	MD [ft]	TVD [ft]	North [ft]	East [ft]	Grid East [srv ft]	Grid North [srv ft]	Latitude	Longitude	Shape
MIRACLE 8-12 GEO TARGET 50' RADIUS (1850'FNL & 750'FEL, REV-1)		6000.00	946.13	-453.88	3153950.73	1395007.18	40°24'58.964"N	104°56'49.553"W	circle
MIRACLE 8-12 LEGAL BOX (68'N,332'S,275'E,125'W OF GEO TARGET)		6000.00	814.13	-378.88	3154026.55	1394875.66	40°24'57.660"N	104°56'48.583"W	square

WELLPATH COMPOSITION Ref Wellbore: MIRACLE 8-12 AWB Ref Wellpath: MIRACLE 8-12 AWP

Start MD [ft]	End MD [ft]	Positional Uncertainty Model	Log Name/Comment	Wellbore
16.00	7931.00	NaviTrak (Standard)	BHI MWD SURVEYS <163-7931>	MIRACLE 8-12 AWB
7931.00	7981.00	Blind Drilling (std)	Projection to bit	MIRACLE 8-12 AWB



Actual Wellpath Report

MIRACLE 8-12 AWP

Page 5 of 5



INTEQ

REFERENCE WELLPATH IDENTIFICATION

Operator	KERR MCGEE OIL & GAS ONSHORE LP	Slot	SLOT#02 MIRACLE 8-12 (2480'FSL & 285'FEL)
Area	COLORADO	Well	MIRACLE 8-12
Field	LARIMER COUNTY	Wellbore	MIRACLE 8-12 AWB
Facility	SEC.12-T5N-R68W		

WELLPATH COMMENTS

MD [ft]	Inclination [°]	Azimuth [°]	TVD [ft]	Comment
7931.00	0.500	144.100	7779.04	LAST BHI MWD SURVEY
7981.00	0.500	144.100	7829.03	PROJECTION TO BIT