



KERR MCGEE OIL & GAS ONSHORE LP

Location: COLORADO Slot: SLOT#28 PINNACLE 34-36 (1072'FNL & 1225'FEL, SEC.2)
Field: WELD COUNTY (KERR MCGEE) Well: PINNACLE 34-36
Facility: SEC.02-T1N-R68W Wellbore: PINNACLE 34-36 PWB



Plot reference wellpath is PINNACLE 34-36 (REV-A.0) PWP	
True vertical depths are referenced to XTREME 12 (RKB)	Grid System: NAD83 / Lambert Colorado State Planes, Northern Zone (501), US feet
Measured depths are referenced to XTREME 12 (RKB)	North Reference: True north
XTREME 12 (RKB) to Mean Sea Level: 4997 feet	Scale: True distance
Mean Sea Level to Mud line (Facility: SEC.02-T1N-R68W): 0 feet	Depths are in feet
Coordinates are in feet referenced to Slot	
Created by: cookdown on 6/9/2011	

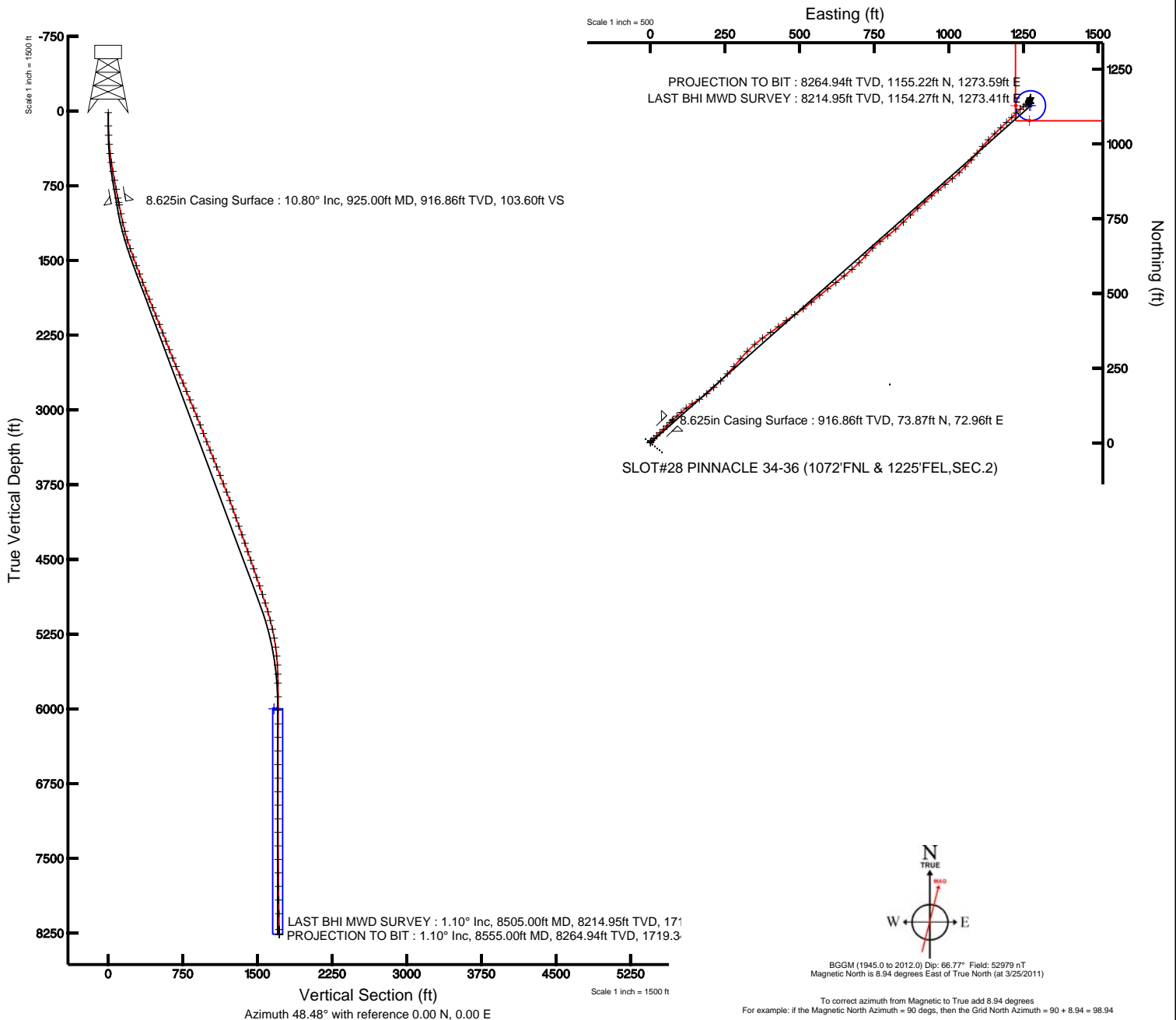



Actual Wellpath Report

PINNACLE 34-36 AWP

Page 1 of 5



INTEQ

REFERENCE WELLPATH IDENTIFICATION

Operator	KERR MCGEE OIL & GAS ONSHORE LP	Slot	SLOT#28 PINNACLE 34-36 (1072'FNL & 1225'FEL,SEC.2)
Area	COLORADO	Well	PINNACLE 34-36
Field	WELD COUNTY (KERR MCGEE)	Wellbore	PINNACLE 34-36 AWB
Facility	SEC.02-T1N-R68W		

REPORT SETUP INFORMATION

Projection System	NAD83 / Lambert Colorado State Planes, Northern Zone (501), US feet	Software System	WellArchitect® 2.0
North Reference	True	User	Cookdanm
Scale	0.999961	Report Generated	6/9/2011 at 9:55:58 AM
Convergence at slot	0.35° East	Database/Source file	WA_DENVER/PINNACLE_34-36_AWB.xml

WELLPATH LOCATION

	Local coordinates		Grid coordinates		Geographic coordinates	
	North[ft]	East[ft]	Easting[USft]	Northing[USft]	Latitude	Longitude
Slot Location	2990.22	2381.52	3149536.32	1274176.36	40°05'05.165"N	104°57'56.041"W
Facility Reference Pt			3147172.67	1271172.18	40°04'35.616"N	104°58'26.681"W
Field Reference Pt			3197771.84	1268891.29	40°04'09.600"N	104°47'36.000"W

WELLPATH DATUM

Calculation method	Minimum curvature	XTREME 12 (RKB) to Facility Vertical Datum	4997.00ft
Horizontal Reference Pt	Slot	XTREME 12 (RKB) to Mean Sea Level	4997.00ft
Vertical Reference Pt	XTREME 12 (RKB)	Facility Vertical Datum to Mud Line (Facility)	0.00ft
MD Reference Pt	XTREME 12 (RKB)	Section Origin	N 0.00, E 0.00 ft
Field Vertical Reference	Mean Sea Level	Section Azimuth	48.48°



Actual Wellpath Report

PINNACLE 34-36 AWP

Page 2 of 5



INTEQ

REFERENCE WELLPATH IDENTIFICATION

Operator	KERR MCGEE OIL & GAS ONSHORE LP	Slot	SLOT#28 PINNACLE 34-36 (1072'FNL & 1225'FEL,SEC.2)
Area	COLORADO	Well	PINNACLE 34-36
Field	WELD COUNTY (KERR MCGEE)	Wellbore	PINNACLE 34-36 AWP
Facility	SEC.02-T1N-R68W		

WELLPATH DATA (87 stations) † = interpolated/extrapolated station

MD [ft]	Inclination [°]	Azimuth [°]	TVD [ft]	Vert Sect [ft]	North [ft]	East [ft]	DLS [°/100ft]	Comments
0.00†	0.000	6.500	0.00	0.00	0.00	0.00	0.00	
15.00	0.000	6.500	15.00	0.00	0.00	0.00	0.00	
149.00	1.000	6.500	148.99	0.87	1.16	0.13	0.75	
242.00	2.400	37.800	241.95	3.39	3.51	1.42	1.75	
334.00	4.600	44.500	333.77	8.96	7.66	5.18	2.43	
427.00	7.100	43.800	426.28	18.41	14.47	11.78	2.69	
518.00	9.100	46.600	516.37	31.21	23.47	20.90	2.24	
608.00	9.900	46.600	605.14	46.06	33.68	31.69	0.89	
699.00	10.600	45.500	694.68	62.23	44.92	43.35	0.80	
790.00	10.300	45.900	784.17	78.72	56.45	55.16	0.34	
880.00	10.800	45.900	872.65	95.18	67.92	66.99	0.56	
950.00	10.800	43.400	941.41	108.26	77.25	76.21	0.67	
1041.00	11.600	49.800	1030.68	125.90	89.35	89.05	1.62	
1131.00	12.900	47.300	1118.63	145.00	102.00	103.35	1.56	
1222.00	15.000	52.700	1206.95	166.90	116.03	120.18	2.71	
1312.00	17.100	56.100	1293.44	191.63	130.47	140.44	2.56	
1403.00	19.500	57.800	1379.83	219.89	146.03	164.40	2.70	
1494.00	20.200	48.700	1465.44	250.59	164.49	189.06	3.48	
1585.00	20.300	48.000	1550.82	282.09	185.43	212.59	0.29	
1675.00	21.200	44.700	1634.98	313.94	207.44	235.64	1.64	
1766.00	20.900	43.400	1719.91	346.52	230.93	258.37	0.61	
1857.00	21.200	41.000	1804.84	379.01	255.14	280.31	1.00	
1948.00	22.200	39.600	1889.39	412.31	280.81	302.07	1.24	
2038.00	22.200	44.500	1972.72	446.07	306.04	324.83	2.06	
2129.00	22.000	50.400	2057.05	480.26	329.17	350.01	2.45	
2220.00	21.400	51.900	2141.60	513.87	350.28	376.21	0.90	
2311.00	21.000	56.000	2226.45	546.61	369.64	402.79	1.69	
2401.00	21.400	51.800	2310.36	578.99	388.81	429.07	1.74	
2492.00	22.000	53.300	2394.91	612.55	409.27	455.78	0.90	
2583.00	22.400	57.100	2479.17	646.68	428.87	484.01	1.64	
2674.00	22.500	52.600	2563.28	681.19	448.87	512.40	1.89	
2765.00	23.100	50.100	2647.17	716.40	470.89	539.93	1.25	
2856.00	22.800	50.800	2730.97	751.87	493.49	567.29	0.45	
2946.00	22.600	52.200	2814.00	786.55	515.11	594.47	0.64	
3037.00	22.400	51.900	2898.07	821.30	536.52	621.93	0.25	
3128.00	23.300	50.500	2981.93	856.60	558.67	649.46	1.16	
3219.00	21.300	49.500	3066.12	891.11	580.85	675.92	2.24	
3309.00	20.400	44.600	3150.23	923.11	602.64	699.36	2.18	
3400.00	22.000	41.000	3235.07	955.84	626.80	721.68	2.27	
3491.00	22.100	45.200	3319.42	989.83	651.73	745.01	1.74	
3582.00	20.600	52.600	3404.19	1022.89	673.52	769.88	3.39	
3672.00	21.900	51.500	3488.07	1055.45	693.58	795.60	1.51	
3763.00	23.100	50.400	3572.14	1090.24	715.53	822.64	1.40	
3854.00	21.000	44.500	3656.49	1124.35	738.54	847.83	3.35	
3945.00	22.100	45.900	3741.13	1157.72	762.09	871.55	1.33	



Actual Wellpath Report

PINNACLE 34-36 AWP

Page 3 of 5



INTEQ

REFERENCE WELLPATH IDENTIFICATION

Operator	KERR MCGEE OIL & GAS ONSHORE LP	Slot	SLOT#28 PINNACLE 34-36 (1072'FNL & 1225'FEL,SEC.2)
Area	COLORADO	Well	PINNACLE 34-36
Field	WELD COUNTY (KERR MCGEE)	Wellbore	PINNACLE 34-36 AWP
Facility	SEC.02-T1N-R68W		

WELLPATH DATA (87 stations)

MD [ft]	Inclination [°]	Azimuth [°]	TVD [ft]	Vert Sect [ft]	North [ft]	East [ft]	DLS [°/100ft]	Comments
4035.00	21.100	48.300	3824.81	1190.84	784.65	895.80	1.48	
4126.00	20.200	48.700	3909.96	1222.93	805.91	919.84	1.00	
4217.00	19.200	46.900	3995.64	1253.60	826.51	942.57	1.29	
4308.00	18.700	50.800	4081.71	1283.13	845.95	964.80	1.50	
4398.00	19.500	51.500	4166.75	1312.55	864.42	987.73	0.92	
4489.00	20.200	50.100	4252.34	1343.42	883.96	1011.67	0.93	
4580.00	19.400	46.900	4337.97	1374.24	904.36	1034.76	1.48	
4671.00	18.400	43.800	4424.06	1403.66	925.05	1055.74	1.56	
4761.00	19.400	42.000	4509.21	1432.67	946.41	1075.57	1.29	
4852.00	18.500	38.500	4595.28	1461.91	968.95	1094.68	1.59	
4943.00	19.500	39.600	4681.32	1491.13	991.95	1113.34	1.17	
5033.00	18.800	44.500	4766.34	1520.44	1013.87	1133.09	1.95	
5124.00	19.100	46.600	4852.41	1549.95	1034.56	1154.18	0.82	
5215.00	17.200	45.200	4938.88	1578.27	1054.27	1174.55	2.14	
5306.00	16.500	47.600	5025.98	1604.62	1072.46	1193.64	1.08	
5396.00	14.700	46.200	5112.66	1628.81	1088.99	1211.32	2.04	
5487.00	12.400	44.500	5201.12	1650.10	1103.95	1226.50	2.56	
5578.00	10.400	48.000	5290.32	1668.06	1116.42	1239.46	2.32	
5669.00	7.700	54.700	5380.18	1682.34	1125.44	1250.54	3.18	
5760.00	5.700	52.600	5470.56	1692.91	1131.70	1259.10	2.21	
5850.00	3.400	57.800	5560.27	1700.00	1135.84	1264.91	2.59	
5941.00	1.700	67.700	5651.17	1703.94	1137.79	1268.45	1.92	
6032.00	1.000	65.200	5742.15	1705.97	1138.64	1270.42	0.77	
6168.00	0.400	36.000	5878.14	1707.57	1139.52	1271.77	0.50	
6304.00	0.300	137.300	6014.14	1708.04	1139.64	1272.29	0.40	
6440.00	0.900	179.300	6150.13	1707.35	1138.31	1272.55	0.52	
6576.00	0.400	196.000	6286.12	1706.26	1136.79	1272.43	0.39	
6713.00	0.300	137.600	6423.12	1705.86	1136.06	1272.54	0.26	
6850.00	0.200	101.800	6560.12	1706.01	1135.75	1273.02	0.13	
6986.00	0.500	333.500	6696.11	1706.30	1136.23	1272.98	0.47	
7122.00	0.500	335.100	6832.11	1706.62	1137.30	1272.47	0.01	
7257.00	0.500	333.500	6967.10	1706.95	1138.36	1271.96	0.01	
7393.00	0.500	312.100	7103.10	1707.03	1139.29	1271.25	0.14	
7529.00	0.800	300.700	7239.09	1706.68	1140.17	1270.00	0.24	
7665.00	0.600	303.100	7375.08	1706.20	1141.05	1268.58	0.15	
7801.00	0.900	9.700	7511.07	1706.84	1142.49	1268.17	0.63	
7937.00	1.000	36.700	7647.05	1708.84	1144.49	1269.06	0.33	
8073.00	1.100	32.100	7783.03	1711.25	1146.55	1270.46	0.10	
8209.00	1.000	21.900	7919.01	1713.57	1148.76	1271.60	0.16	
8346.00	1.200	20.200	8055.98	1715.90	1151.21	1272.54	0.15	
8505.00	1.100	11.100	8214.95	1718.58	1154.27	1273.41	0.13	LAST BHI MWD SURVEY
8555.00	1.100	11.100	8264.94	1719.34	1155.22	1273.59	0.00	PROJECTION TO BIT



Actual Wellpath Report

PINNACLE 34-36 AWP

Page 4 of 5



INTEQ

REFERENCE WELLPATH IDENTIFICATION				
Operator	KERR MCGEE OIL & GAS ONSHORE LP	Slot	SLOT#28 PINNACLE 34-36 (1072'FNL & 1225'FEL,SEC.2)	
Area	COLORADO	Well	PINNACLE 34-36	
Field	WELD COUNTY (KERR MCGEE)	Wellbore	PINNACLE 34-36 AWP	
Facility	SEC.02-T1N-R68W			

HOLE & CASING SECTIONS Ref Wellbore: PINNACLE 34-36 AWP Ref Wellpath: PINNACLE 34-36 AWP									
String/Diameter	Start MD [ft]	End MD [ft]	Interval [ft]	Start TVD [ft]	End TVD [ft]	Start N/S [ft]	Start E/W [ft]	End N/S [ft]	End E/W [ft]
12.25in Open Hole	15.00	935.00	920.00	15.00	926.68	0.00	0.00	75.21	74.27
8.625in Casing Surface	15.00	925.00	910.00	15.00	916.86	0.00	0.00	73.87	72.96
7.875in Open Hole	925.00	8555.00	7630.00	916.86	8264.94	73.87	72.96	1155.22	1273.59

TARGETS									
Name	MD [ft]	TVD [ft]	North [ft]	East [ft]	Grid East [srv ft]	Grid North [srv ft]	Latitude	Longitude	Shape
PINNACLE 34-36 BHL ON PLAT (50'FSL & 46'FWL, REV-1)		6000.00	1128.61	1270.59	3150800.03	1275312.56	40°05'16.318"N	104°57'39.694"W	point
PINNACLE 34-36 HARDLINE 50'S OF GEO TARGET		6000.00	1078.61	1270.59	3150800.33	1275262.56	40°05'15.823"N	104°57'39.694"W	point
PINNACLE 34-36 HARDLINE 50'W OF GEO TARGET		6000.00	1128.61	1224.59	3150754.03	1275312.28	40°05'16.318"N	104°57'40.285"W	point
PINNACLE 34-36 GEO TARGET 50' RADIUS (50'FSL & 50'FWL, SEC.36, REV-2)		6000.00	1128.61	1274.59	3150804.03	1275312.58	40°05'16.318"N	104°57'39.642"W	circle

WELLPATH COMPOSITION Ref Wellbore: PINNACLE 34-36 AWP Ref Wellpath: PINNACLE 34-36 AWP				
Start MD [ft]	End MD [ft]	Positional Uncertainty Model	Log Name/Comment	Wellbore
15.00	880.00	NaviTrak (Standard)	BHI NAVITRAK 12.25 HOLE <149-880>	PINNACLE 34-36 AWP
880.00	8505.00	NaviTrak (Standard)	BHI NAVITRAK 7.875 HOLE <950-8505>	PINNACLE 34-36 AWP
8505.00	8555.00	Blind Drilling (std)	Projection to bit	PINNACLE 34-36 AWP



Actual Wellpath Report

PINNACLE 34-36 AWP

Page 5 of 5



INTEQ

REFERENCE WELLPATH IDENTIFICATION

Operator	KERR MCGEE OIL & GAS ONSHORE LP	Slot	SLOT#28 PINNACLE 34-36 (1072'FNL & 1225'FEL,SEC.2)
Area	COLORADO	Well	PINNACLE 34-36
Field	WELD COUNTY (KERR MCGEE)	Wellbore	PINNACLE 34-36 AWB
Facility	SEC.02-T1N-R68W		

WELLPATH COMMENTS

MD [ft]	Inclination [°]	Azimuth [°]	TVD [ft]	Comment
8505.00	1.100	11.100	8214.95	LAST BHI MWD SURVEY
8555.00	1.100	11.100	8264.94	PROJECTION TO BIT