

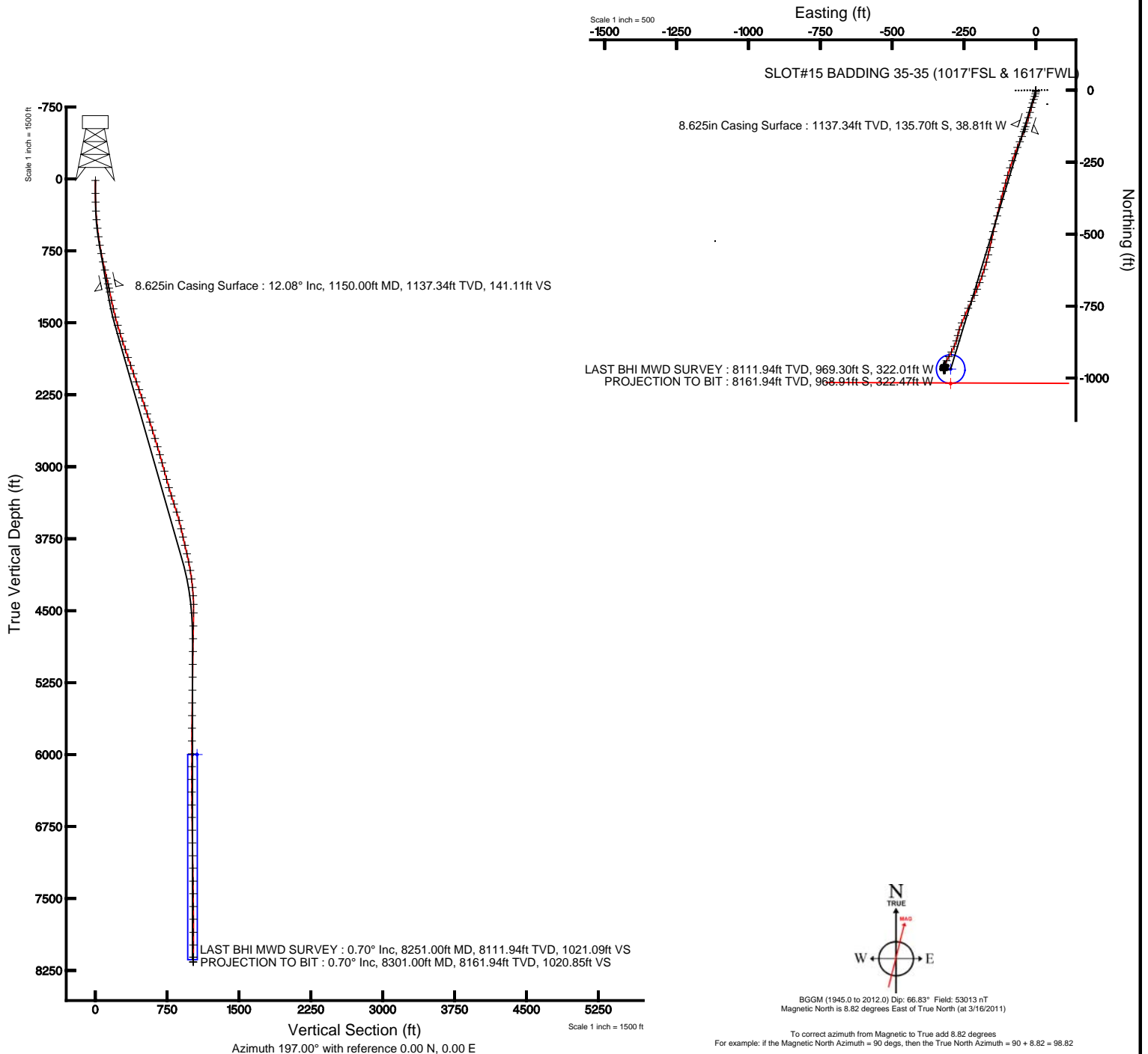

# KERR MCGEE OIL & GAS ONSHORE LP

Location: COLORADO Slot: SLOT#15 BADDING 35-35 (1017'FSL & 1617'FWL)  
Field: WELD COUNTY (KERR MCGEE) Well: BADDING 35-35  
Facility: SEC.35-T2N-R66W Wellbore: BADDING 35-35 PWB

Plot reference wellpath is BADDING 35-35 (REV-A.0) PWB	Grid System: NAD83 / Lambert Colorado SP, Northern Zone (001), US feet
True vertical depths are referenced to XTREME 15 (RKB)	North Reference: True north
Measured depths are referenced to XTREME 15 (RKB)	Scale: True distance
XTREME 15 (RKB) to Mean Sea Level: 5123 feet	Depths are in feet
Mean Sea Level to Mud line (in Slot: SLOT#15 BADDING 35-35 (1017'FSL & 1617'FWL)): 0 feet	Created by: lookdown on 6/23/2011
Coordinates are in feet referenced to Slot	





# Actual Wellpath Report

BADDING 35-35 AWP

Page 1 of 5



## REFERENCE WELLPATH IDENTIFICATION

Operator	<b>KERR MCGEE OIL &amp; GAS ONSHORE LP</b>	Slot	<b>SLOT#15 BADDING 35-35 (1017'FSL &amp; 1617'FWL)</b>
Area	<b>COLORADO</b>	Well	<b>BADDING 35-35</b>
Field	<b>WELD COUNTY (KERR MCGEE)</b>	Wellbore	<b>BADDING 35-35 AWB</b>
Facility	<b>SEC.35-T2N-R66W</b>		

## REPORT SETUP INFORMATION

Projection System	<b>NAD83 / Lambert Colorado SP, Northern Zone (501), US feet</b>	Software System	<b>WellArchitect® 3.0.0</b>
North Reference	<b>True</b>	User	<b>Cookdanm</b>
Scale	<b>0.999961</b>	Report Generated	<b>6/23/2011 at 9:03:03 AM</b>
Convergence at slot	<b>0.49° East</b>	Database/Source file	<b>WA_DENVER/BADDING_35-35_AWB.xml</b>

## WELLPATH LOCATION

	Local coordinates		Grid coordinates		Geographic coordinates	
	North[ft]	East[ft]	Easting[US ft]	Northing[US ft]	Latitude	Longitude
Slot Location	75.49	-2028.79	3210407.77	1276562.48	<b>40°05'24.382"N</b>	<b>104°44'52.631"W</b>
Facility Reference Pt			3212437.05	1276504.37	<b>40°05'23.636"N</b>	<b>104°44'26.527"W</b>
Field Reference Pt			<b>3197771.84</b>	<b>1268891.29</b>	40°04'09.600"N	104°47'36.000"W

## WELLPATH DATUM

Calculation method	<b>Minimum curvature</b>	XTREME 15 (RKB) to Facility Vertical Datum	<b>5123.00ft</b>
Horizontal Reference Pt	<b>Slot</b>	XTREME 15 (RKB) to Mean Sea Level	<b>5123.00ft</b>
Vertical Reference Pt	<b>XTREME 15 (RKB)</b>	XTREME 15 (RKB) to Mud Line at Slot (SLOT#15 BADDING 35-35 (1017'FSL & 1617'FWL))	<b>5123.00ft</b>
MD Reference Pt	<b>XTREME 15 (RKB)</b>	Section Origin	<b>N 0.00, E 0.00 ft</b>
Field Vertical Reference	<b>Mean Sea Level</b>	Section Azimuth	<b>197.00°</b>



# Actual Wellpath Report

BADDING 35-35 AWP

Page 2 of 5



## REFERENCE WELLPATH IDENTIFICATION

Operator	KERR MCGEE OIL & GAS ONSHORE LP	Slot	SLOT#15 BADDING 35-35 (1017'FSL & 1617'FWL)
Area	COLORADO	Well	BADDING 35-35
Field	WELD COUNTY (KERR MCGEE)	Wellbore	BADDING 35-35 AWB
Facility	SEC.35-T2N-R66W		

## WELLPATH DATA (82 stations) † = interpolated/extrapolated station

MD [ft]	Inclination [°]	Azimuth [°]	TVD [ft]	Vert Sect [ft]	North [ft]	East [ft]	DLS [°/100ft]	Comments
0.00†	0.000	154.700	0.00	0.00	0.00	0.00	0.00	
15.00	0.000	154.700	15.00	0.00	0.00	0.00	0.00	
150.00	0.400	154.700	150.00	0.35	-0.43	0.20	0.30	
242.00	1.500	173.700	241.98	1.69	-1.91	0.47	1.23	
335.00	3.300	186.000	334.90	5.44	-5.79	0.32	2.00	
425.00	5.200	194.400	424.65	12.06	-12.31	-0.96	2.22	
515.00	6.700	198.000	514.16	21.38	-21.26	-3.60	1.72	
604.00	7.700	199.400	602.46	32.53	-31.82	-7.18	1.14	
693.00	9.400	196.900	690.47	45.75	-44.40	-11.28	1.95	
781.00	11.200	194.800	777.05	61.48	-59.54	-15.55	2.09	
870.00	12.600	195.500	864.13	79.82	-77.25	-20.35	1.58	
957.00	12.800	197.600	949.00	98.95	-95.58	-25.80	0.58	
1044.00	12.700	197.600	1033.86	118.15	-113.88	-31.61	0.11	
1105.00	12.600	198.300	1093.38	131.50	-126.59	-35.72	0.30	
1191.00	11.600	200.100	1177.47	149.52	-143.62	-41.64	1.24	
1281.00	11.900	201.800	1265.58	167.80	-160.73	-48.20	0.51	
1372.00	13.200	203.100	1354.40	187.48	-179.00	-55.76	1.46	
1460.00	15.000	201.800	1439.75	208.82	-198.82	-63.93	2.08	
1548.00	16.200	201.500	1524.51	232.41	-220.81	-72.66	1.37	
1637.00	17.100	199.000	1609.78	257.86	-244.74	-81.47	1.29	
1724.00	17.800	197.200	1692.77	283.94	-269.53	-89.56	1.02	
1813.00	18.300	196.200	1777.39	311.52	-295.95	-97.49	0.66	
1901.00	18.900	195.800	1860.79	339.58	-322.93	-105.22	0.70	
1990.00	19.400	196.900	1944.87	368.77	-350.94	-113.44	0.69	
2079.00	19.100	193.400	2028.90	398.09	-379.25	-121.11	1.34	
2169.00	19.500	192.700	2113.84	427.76	-408.23	-127.83	0.51	
2257.00	18.700	193.700	2196.99	456.49	-436.26	-134.40	0.98	
2346.00	19.100	195.100	2281.20	485.29	-464.18	-141.57	0.68	
2434.00	18.300	192.000	2364.55	513.44	-491.60	-148.19	1.45	
2523.00	18.200	189.900	2449.08	541.16	-518.96	-153.49	0.75	
2613.00	17.900	194.400	2534.65	568.92	-546.20	-159.35	1.58	
2702.00	16.900	192.300	2619.58	595.48	-572.09	-165.50	1.33	
2791.00	17.500	196.900	2704.60	621.75	-597.53	-172.15	1.67	
2881.00	16.600	196.500	2790.64	648.14	-622.81	-179.73	1.01	
2969.00	15.900	200.100	2875.13	672.75	-646.18	-187.45	1.39	
3056.00	16.100	200.400	2958.76	696.69	-668.68	-195.75	0.25	
3146.00	15.600	201.800	3045.34	721.21	-691.61	-204.59	0.70	
3236.00	14.200	206.400	3132.31	744.16	-712.74	-213.99	2.04	
3325.00	16.300	204.600	3218.17	767.31	-733.87	-224.05	2.42	
3415.00	17.800	205.000	3304.22	793.45	-757.82	-235.12	1.67	
3503.00	19.000	203.900	3387.72	821.00	-783.11	-246.61	1.42	
3592.00	17.600	203.200	3472.21	848.76	-808.73	-257.78	1.59	
3683.00	15.000	196.500	3559.56	874.22	-832.67	-266.55	3.52	
3772.00	12.000	190.900	3646.09	894.94	-852.80	-271.57	3.67	
3860.00	13.000	198.000	3732.01	913.93	-871.20	-276.36	2.08	



# Actual Wellpath Report

BADDING 35-35 AWP

Page 3 of 5



## REFERENCE WELLPATH IDENTIFICATION

Operator	KERR MCGEE OIL & GAS ONSHORE LP	Slot	SLOT#15 BADDING 35-35 (1017'FSL & 1617'FWL)
Area	COLORADO	Well	BADDING 35-35
Field	WELD COUNTY (KERR MCGEE)	Wellbore	BADDING 35-35 AWP
Facility	SEC.35-T2N-R66W		

## WELLPATH DATA (82 stations)

MD [ft]	Inclination [°]	Azimuth [°]	TVD [ft]	Vert Sect [ft]	North [ft]	East [ft]	DLS [°/100ft]	Comments
3949.00	14.200	205.300	3818.52	934.75	-890.59	-284.12	2.35	
4040.00	13.000	207.100	3906.97	955.87	-909.80	-293.55	1.40	
4128.00	11.300	209.200	3992.99	974.04	-926.14	-302.27	2.00	
4217.00	9.800	211.000	4080.48	989.91	-940.24	-310.42	1.73	
4307.00	8.100	202.200	4169.39	1003.66	-952.68	-316.76	2.42	
4396.00	5.300	186.300	4257.78	1013.95	-962.57	-319.58	3.75	
4483.00	3.700	171.200	4344.51	1020.42	-969.34	-319.60	2.27	
4573.00	2.500	207.100	4434.39	1024.97	-973.96	-320.05	2.47	
4663.00	1.600	3.200	4524.36	1025.68	-974.45	-320.87	4.46	
4797.00	1.100	355.800	4658.33	1022.67	-971.30	-320.86	0.39	
4931.00	0.900	358.600	4792.31	1020.47	-968.97	-320.98	0.15	
5065.00	1.000	0.700	4926.29	1018.35	-966.74	-320.99	0.08	
5198.00	0.700	348.800	5059.27	1016.52	-964.79	-321.13	0.26	
5332.00	0.800	349.500	5193.26	1014.97	-963.06	-321.46	0.07	
5468.00	1.200	356.500	5329.24	1012.79	-960.71	-321.72	0.31	
5600.00	1.100	51.300	5461.22	1010.45	-958.54	-320.82	0.80	
5733.00	0.700	6.000	5594.20	1008.60	-956.93	-319.74	0.59	
5864.00	0.700	118.800	5725.20	1007.98	-956.52	-318.95	0.89	
5998.00	0.300	84.400	5859.19	1008.01	-956.88	-317.89	0.36	
6131.00	0.400	339.600	5992.19	1007.51	-956.41	-317.70	0.42	
6265.00	0.400	328.000	6126.19	1006.83	-955.58	-318.11	0.06	
6398.00	0.900	97.400	6259.18	1006.35	-955.32	-317.32	0.90	
6530.00	0.700	113.600	6391.17	1006.27	-955.77	-315.56	0.23	
6664.00	0.400	148.400	6525.16	1006.67	-956.50	-314.56	0.33	
6794.00	0.800	171.200	6655.16	1007.79	-957.78	-314.18	0.35	
6928.00	1.100	211.300	6789.14	1009.88	-959.81	-314.71	0.53	
7060.00	1.200	207.100	6921.11	1012.47	-962.12	-316.00	0.10	
7194.00	1.500	183.500	7055.08	1015.55	-965.12	-316.74	0.47	
7324.00	1.300	176.900	7185.04	1018.59	-968.29	-316.77	0.20	
7458.00	1.000	167.000	7319.01	1021.03	-970.95	-316.42	0.27	
7590.00	0.400	103.700	7451.00	1022.00	-972.18	-315.72	0.68	
7723.00	0.200	245.100	7584.00	1022.13	-972.39	-315.48	0.43	
7856.00	0.600	275.300	7717.00	1022.43	-972.42	-316.38	0.33	
7992.00	1.200	293.600	7852.98	1022.41	-971.78	-318.39	0.48	
8124.00	1.000	309.000	7984.96	1021.82	-970.51	-320.56	0.27	
8251.00	0.700	310.500	8111.94	1021.09	-969.30	-322.01	0.24	LAST BHI MWD SURVEY
8301.00	0.700	310.500	8161.94	1020.85	-968.91	-322.47	0.00	PROJECTION TO BIT



# Actual Wellpath Report

BADDING 35-35 AWP

Page 4 of 5



## REFERENCE WELLPATH IDENTIFICATION

Operator	KERR MCGEE OIL & GAS ONSHORE LP	Slot	SLOT#15 BADDING 35-35 (1017'FSL & 1617'FWL)
Area	COLORADO	Well	BADDING 35-35
Field	WELD COUNTY (KERR MCGEE)	Wellbore	BADDING 35-35 AWB
Facility	SEC.35-T2N-R66W		

## HOLE & CASING SECTIONS - Ref Wellbore: BADDING 35-35 AWB Ref Wellpath: BADDING 35-35 AWP

String/Diameter	Start MD [ft]	End MD [ft]	Interval [ft]	Start TVD [ft]	End TVD [ft]	Start N/S [ft]	Start E/W [ft]	End N/S [ft]	End E/W [ft]
12.25in Open Hole	15.00	1160.00	1145.00	15.00	1147.12	0.00	0.00	-137.66	-39.50
8.625in Casing Surface	15.00	1150.00	1135.00	15.00	1137.34	0.00	0.00	-135.70	-38.81
7.875in Open Hole	1150.00	8301.00	7151.00	1137.34	8161.94	-135.70	-38.81	-968.91	-322.47

## TARGETS

Name	MD [ft]	TVD [ft]	North [ft]	East [ft]	Grid East [US ft]	Grid North [US ft]	Latitude	Longitude	Shape
BADDING GEO TARGET 50' RADIUS (50'FSL & 1320'FWL, REV-1)		6000.00	-969.38	-296.31	3210119.70	1275590.66	40°05'14.802"N	104°44'56.443"W	circle
BADDING 35-35 HARDLINE 50'S OF GEO TARGET		6000.00	-1019.38	-296.31	3210120.12	1275540.67	40°05'14.308"N	104°44'56.443"W	point

## WELLPATH COMPOSITION - Ref Wellbore: BADDING 35-35 AWB Ref Wellpath: BADDING 35-35 AWP

Start MD [ft]	End MD [ft]	Positional Uncertainty Model	Log Name/Comment	Wellbore
15.00	8251.00	NaviTrak (Standard)	BHI MWD SURVEY <150-8251>	BADDING 35-35 AWB
8251.00	8301.00	Blind Drilling (std)	Projection to bit	BADDING 35-35 AWB



# Actual Wellpath Report

BADDING 35-35 AWP

Page 5 of 5



## REFERENCE WELLPATH IDENTIFICATION

Operator	KERR MCGEE OIL & GAS ONSHORE LP	Slot	SLOT#15 BADDING 35-35 (1017'FSL & 1617'FWL)
Area	COLORADO	Well	BADDING 35-35
Field	WELD COUNTY (KERR MCGEE)	Wellbore	BADDING 35-35 AWB
Facility	SEC.35-T2N-R66W		

## WELLPATH COMMENTS

MD [ft]	Inclination [°]	Azimuth [°]	TVD [ft]	Comment
8251.00	0.700	310.500	8111.94	LAST BHI MWD SURVEY
8301.00	0.700	310.500	8161.94	PROJECTION TO BIT