

REFERENCE INFORMATION

Co-ordinate (NE) Reference: Well File 8-2-17, True North
Vertical (TVD) Reference: WELL @ 4895.0ft (Original Well Elev)
Section (VS) Reference: Slot - (0.0N, 0.0E)
Measured Depth Reference: WELL @ 4895.0ft (Original Well Elev)
Calculation Method:

WELL DETAILS: File 8-2-17

+N/-S	+E/-W	Northing	Ground Level:	Easting	Latitude	Longitude	Slot
0.0	0.0	1295263.25	4882.0	3133159.69	40° 8' 34.476 N	105° 1' 25.284 W	

SECTION DETAILS

Sec	MD	Inc	Azi	TVD	+N/-S	+E/-W	DLeg	TFace	VSec	Target
1	0.0	0.00	0.00	0.0	0.0	0.0	0.00	0.00	0.0	
2	600.0	0.00	0.00	600.0	0.0	0.0	0.00	0.00	0.0	
3	1449.5	16.99	101.87	1437.1	-25.7	122.4	2.00	101.87	125.0	
4	6352.3	16.99	101.87	6125.9	-320.3	1524.3	0.00	0.00	1557.6	
5	7201.8	0.00	0.00	6963.0	-346.0	1646.7	2.00	180.00	1682.6	
6	8251.8	0.00	0.00	8013.0	-346.0	1646.7	0.00	0.00	1682.6	File 8-2-17

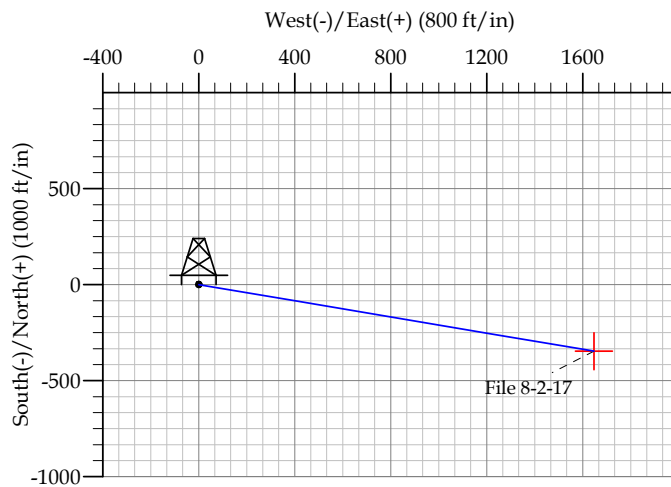

FORMATION TOP DETAILS

TVDPath	MDPath	Formation
4155.0	4291.4	Sussex
5100.0	5279.5	Shannon
7165.0	7403.8	Niobrara
7445.0	7683.8	Codell
7863.0	8101.8	J Sand
7923.0	8161.8	A Marker

CASING DETAILS

TVD	MD	Name	Size
550.0	550.0	Surface	8.625
8013.0	8251.8	Production	4.500

EnCana Corporation

Planning Report - Geographic

Database:	EDM	Local Co-ordinate Reference:	Well File 8-2-17
Company:	DJ/Paradox/WTX	TVD Reference:	WELL @ 4895.0ft (Original Well Elev)
Project:	Wattenberg	MD Reference:	WELL @ 4895.0ft (Original Well Elev)
Site:	New Drills	North Reference:	True
Well:	File 8-2-17	Survey Calculation Method:	Minimum Curvature
Wellbore:	Wellbore #1		
Design:	File 8-2-17		

Project	Wattenberg,		
Map System:	US State Plane 1983	System Datum:	Mean Sea Level
Geo Datum:	North American Datum 1983		
Map Zone:	Colorado Northern Zone		

Site	New Drills					
Site Position:		Northing:	1,278,589.08 ft	Latitude:	40° 5' 49.848 N	
From:	Lat/Long	Easting:	3,130,247.44 ft	Longitude:	105° 2' 3.912 W	
Position Uncertainty:		ft	Slot Radius:	in	Grid Convergence:	0.30 °

Well	File 8-2-17					
Well Position	+N-S	16,658.3 ft	Northing:	1,295,263.25 ft	Latitude:	40° 8' 34.476 N
	+E-W	3,001.8 ft	Easting:	3,133,159.69 ft	Longitude:	105° 1' 25.284 W
Position Uncertainty		ft	Wellhead Elevation:	ft	Ground Level:	4,882.0 ft

Wellbore	Wellbore #1				
Magnetics	Model Name	Sample Date	Declination (°)	Dip Angle (°)	Field Strength (nT)
	IGRF200510	12/31/2009	9.14	66.86	53,140

Design	File 8-2-17				
Audit Notes:					
Version:	Phase:	PROTOTYPE		Tie On Depth:	0.0
Vertical Section:	Depth From (TVD) (ft)	+N-S (ft)	+E-W (ft)	Direction (°)	
	0.0	0.0	0.0	101.87	

Plan Sections										
Measured Depth (ft)	Inclination (°)	Azimuth (°)	Vertical Depth (ft)	+N-S (ft)	+E-W (ft)	Dogleg Rate (°/100ft)	Build Rate (°/100ft)	Turn Rate (°/100ft)	TFO (°)	Target
0.0	0.00	0.00	0.0	0.0	0.0	0.00	0.00	0.00	0.00	
600.0	0.00	0.00	600.0	0.0	0.0	0.00	0.00	0.00	0.00	
1,449.5	16.99	101.87	1,437.1	-25.7	122.4	2.00	2.00	0.00	101.87	
6,352.3	16.99	101.87	6,125.9	-320.3	1,524.3	0.00	0.00	0.00	0.00	
7,201.8	0.00	0.00	6,963.0	-346.0	1,646.7	2.00	-2.00	0.00	180.00	
8,251.8	0.00	0.00	8,013.0	-346.0	1,646.7	0.00	0.00	0.00	0.00	File 8-2-17

EnCana Corporation

Planning Report - Geographic

Database:	EDM	Local Co-ordinate Reference:	Well File 8-2-17
Company:	DJ/Paradox/WTX	TVD Reference:	WELL @ 4895.0ft (Original Well Elev)
Project:	Wattenberg	MD Reference:	WELL @ 4895.0ft (Original Well Elev)
Site:	New Drills	North Reference:	True
Well:	File 8-2-17	Survey Calculation Method:	Minimum Curvature
Wellbore:	Wellbore #1		
Design:	File 8-2-17		

Planned Survey										
Measured Depth (ft)	Inclination (°)	Azimuth (°)	Vertical Depth (ft)	+N/-S (ft)	+E/-W (ft)	Map Northing (ft)	Map Easting (ft)	Latitude	Longitude	
0.0	0.00	0.00	0.0	0.0	0.0	1,295,263.25	3,133,159.69	40° 8' 34.476 N	105° 1' 25.284 W	
550.0	0.00	0.00	550.0	0.0	0.0	1,295,263.25	3,133,159.69	40° 8' 34.476 N	105° 1' 25.284 W	
Surface										
600.0	0.00	0.00	600.0	0.0	0.0	1,295,263.25	3,133,159.69	40° 8' 34.476 N	105° 1' 25.284 W	
1,449.5	16.99	101.87	1,437.1	-25.7	122.4	1,295,238.19	3,133,282.18	40° 8' 34.222 N	105° 1' 23.708 W	
4,291.4	16.99	101.87	4,155.0	-196.5	935.0	1,295,071.80	3,134,095.74	40° 8' 32.534 N	105° 1' 13.244 W	
Sussex										
5,279.5	16.99	101.87	5,100.0	-255.8	1,217.6	1,295,013.95	3,134,378.61	40° 8' 31.947 N	105° 1' 9.605 W	
Shannon										
6,352.3	16.99	101.87	6,125.9	-320.3	1,524.3	1,294,951.14	3,134,685.70	40° 8' 31.310 N	105° 1' 5.656 W	
7,201.8	0.00	0.00	6,963.0	-346.0	1,646.7	1,294,926.09	3,134,808.19	40° 8' 31.056 N	105° 1' 4.080 W	
7,403.8	0.00	0.00	7,165.0	-346.0	1,646.7	1,294,926.09	3,134,808.19	40° 8' 31.056 N	105° 1' 4.080 W	
Niobrara										
7,683.8	0.00	0.00	7,445.0	-346.0	1,646.7	1,294,926.09	3,134,808.19	40° 8' 31.056 N	105° 1' 4.080 W	
Codell										
8,101.8	0.00	0.00	7,863.0	-346.0	1,646.7	1,294,926.09	3,134,808.19	40° 8' 31.056 N	105° 1' 4.080 W	
J Sand										
8,161.8	0.00	0.00	7,923.0	-346.0	1,646.7	1,294,926.09	3,134,808.19	40° 8' 31.056 N	105° 1' 4.080 W	
A Marker										
8,251.8	0.00	0.00	8,013.0	-346.0	1,646.7	1,294,926.09	3,134,808.19	40° 8' 31.056 N	105° 1' 4.080 W	
Production - File 8-2-17										

Design Targets										
Target Name	Dip Angle (°)	Dip Dir. (°)	TVD (ft)	+N/-S (ft)	+E/-W (ft)	Northing (ft)	Easting (ft)	Latitude	Longitude	
- hit/miss target										
- Shape										
File 8-2-17	0.00	0.00	8,013.0	-346.0	1,646.7	1,294,926.09	3,134,808.19	40° 8' 31.056 N	105° 1' 4.080 W	
- plan hits target										
- Point										

Casing Points					
Measured Depth (ft)	Vertical Depth (ft)	Name	Casing Diameter (in)	Hole Diameter (in)	
550.0	550.0	Surface	8.625	12.250	
8,251.8	8,013.0	Production	4.500	7.785	

Formations						
Measured Depth (ft)	Vertical Depth (ft)	Name	Lithology	Dip (°)	Dip Direction (°)	
4,291.4	4,155.0	Sussex		0.00		
5,279.5	5,100.0	Shannon		0.00		
7,403.8	7,165.0	Niobrara		0.00		
7,683.8	7,445.0	Codell		0.00		
8,101.8	7,863.0	J Sand		0.00		
8,161.8	7,923.0	A Marker		0.00		

EnCana Corporation
Planning Report - Geographic

Database:	EDM	Local Co-ordinate Reference:	Well File 8-2-17
Company:	DJ/Paradox/WTX	TVD Reference:	WELL @ 4895.0ft (Original Well Elev)
Project:	Wattenberg	MD Reference:	WELL @ 4895.0ft (Original Well Elev)
Site:	New Drills	North Reference:	True
Well:	File 8-2-17	Survey Calculation Method:	Minimum Curvature
Wellbore:	Wellbore #1		
Design:	File 8-2-17		