

Noble Energy

Weld County, CO (NAD 83)
Sec. 17-T11N-R61W
DF Ranch PC GK17-99HZ

Design: Sperry MWD Survey

Sperry Drilling Services Final Survey Report

17 March, 2011

Well Coordinates: 1,583,597.68 N, 3,349,241.93 E (40° 55' 42.64" N, 104° 14' 10.10" W)
Ground Level: 5,312.00 ft

| | |
|--------------------------|--|
| Local Coordinate Origin: | Centered on Well DF Ranch PC GK17-99HZ |
| Viewing Datum: | RKB 24' @ 5336.00ft (H&P 315) |
| TVDs to System: | N |
| North Reference: | Grid |
| Unit System: | API - US Survey Feet - Custom |

Geodetic Scale Factor Applied
Version: 2003.16 Build: 43I

HALLIBURTON

Design Report for DF Ranch PC GK17-99HZ - Sperry MWD Survey

| Measured Depth (ft) | Inclination (°) | Azimuth (°) | Vertical Depth (ft) | +N/-S (ft) | +E/-W (ft) | Vertical Section (ft) | Dogleg Rate (°/100ft) |
|-------------------------|-----------------|-------------|---------------------|------------|------------|-----------------------|-----------------------|
| 0.00 | 0.00 | 0.00 | 0.00 | 0.00 | 0.00 | 0.00 | 0.00 |
| 1,564.00 | 0.40 | 156.70 | 1,563.99 | -5.01 | 2.16 | 5.11 | 0.03 |
| First Sperry MWD Survey | | | | | | | |
| 1,752.00 | 0.38 | 162.06 | 1,751.98 | -6.21 | 2.61 | 6.28 | 0.02 |
| 1,847.00 | 0.27 | 161.79 | 1,846.98 | -6.72 | 2.78 | 6.77 | 0.12 |
| 1,941.00 | 0.47 | 181.44 | 1,940.98 | -7.32 | 2.84 | 7.24 | 0.25 |
| 2,036.00 | 0.30 | 177.35 | 2,035.98 | -7.96 | 2.84 | 7.70 | 0.18 |
| 2,130.00 | 0.26 | 122.14 | 2,129.98 | -8.32 | 3.03 | 8.09 | 0.28 |
| 2,319.00 | 0.17 | 311.21 | 2,318.98 | -8.36 | 3.18 | 8.23 | 0.23 |
| 2,509.00 | 0.37 | 68.46 | 2,508.97 | -7.95 | 3.54 | 8.18 | 0.25 |
| 2,603.00 | 0.21 | 91.82 | 2,602.97 | -7.84 | 4.00 | 8.42 | 0.21 |
| 2,698.00 | 0.35 | 215.63 | 2,697.97 | -8.08 | 4.00 | 8.60 | 0.52 |
| 2,792.00 | 0.57 | 181.68 | 2,791.97 | -8.78 | 3.82 | 8.98 | 0.36 |
| 2,886.00 | 0.32 | 170.85 | 2,885.97 | -9.51 | 3.85 | 9.52 | 0.28 |
| 2,981.00 | 0.44 | 201.26 | 2,980.96 | -10.11 | 3.76 | 9.89 | 0.24 |
| 3,264.00 | 0.56 | 262.29 | 3,263.96 | -11.31 | 1.99 | 9.53 | 0.18 |
| 3,359.00 | 0.70 | 243.09 | 3,358.95 | -11.64 | 1.02 | 9.09 | 0.26 |
| 3,454.00 | 1.01 | 261.01 | 3,453.94 | -12.03 | -0.33 | 8.44 | 0.43 |
| 3,548.00 | 0.85 | 255.67 | 3,547.93 | -12.33 | -1.82 | 7.62 | 0.19 |
| 3,643.00 | 0.69 | 245.50 | 3,642.92 | -12.74 | -3.03 | 7.08 | 0.22 |
| 3,737.00 | 0.85 | 236.51 | 3,736.91 | -13.36 | -4.12 | 6.77 | 0.21 |
| 3,832.00 | 0.72 | 232.83 | 3,831.90 | -14.11 | -5.18 | 6.57 | 0.15 |
| 3,926.00 | 1.04 | 248.41 | 3,925.89 | -14.78 | -6.45 | 6.17 | 0.42 |
| 4,020.00 | 0.70 | 289.16 | 4,019.88 | -14.91 | -7.78 | 5.34 | 0.73 |
| 4,209.00 | 1.17 | 258.12 | 4,208.86 | -14.93 | -10.76 | 3.28 | 0.36 |
| 4,398.00 | 1.08 | 241.91 | 4,397.82 | -16.16 | -14.22 | 1.77 | 0.17 |
| 4,682.00 | 0.85 | 257.86 | 4,681.78 | -17.87 | -18.64 | -0.07 | 0.12 |
| 4,965.00 | 0.61 | 359.23 | 4,964.77 | -16.80 | -20.72 | -2.27 | 0.40 |
| 5,249.00 | 1.61 | 17.93 | 5,248.71 | -11.49 | -19.51 | -5.26 | 0.37 |
| 5,344.00 | 1.23 | 2.17 | 5,343.68 | -9.20 | -19.06 | -6.59 | 0.57 |
| 5,627.00 | 0.11 | 344.23 | 5,626.66 | -5.91 | -19.02 | -8.94 | 0.40 |
| 5,910.00 | 0.34 | 200.52 | 5,909.65 | -6.43 | -19.39 | -8.81 | 0.15 |
| 6,193.00 | 0.44 | 199.53 | 6,192.65 | -8.24 | -20.04 | -7.97 | 0.04 |
| 6,235.00 | 0.57 | 184.78 | 6,234.65 | -8.60 | -20.11 | -7.76 | 0.44 |
| 6,301.00 | 0.62 | 146.45 | 6,300.64 | -9.23 | -19.94 | -7.19 | 0.60 |
| 6,356.00 | 2.61 | 125.72 | 6,355.62 | -10.21 | -18.76 | -5.66 | 3.71 |
| 6,388.00 | 4.74 | 126.57 | 6,387.55 | -11.42 | -17.11 | -3.64 | 6.66 |
| 6,420.00 | 6.93 | 127.00 | 6,419.38 | -13.37 | -14.51 | -0.43 | 6.85 |
| 6,451.00 | 9.65 | 125.44 | 6,450.06 | -16.00 | -10.89 | 3.97 | 8.80 |
| 6,483.00 | 12.97 | 122.63 | 6,481.43 | -19.49 | -5.68 | 10.10 | 10.51 |
| 6,514.00 | 15.20 | 124.32 | 6,511.50 | -23.66 | 0.60 | 17.46 | 7.31 |
| 6,546.00 | 16.44 | 128.98 | 6,542.29 | -28.88 | 7.59 | 26.06 | 5.54 |
| 6,577.00 | 18.98 | 131.53 | 6,571.82 | -34.98 | 14.77 | 35.44 | 8.57 |
| 6,609.00 | 21.19 | 133.39 | 6,601.87 | -42.40 | 22.87 | 46.41 | 7.19 |
| 6,640.00 | 23.76 | 131.37 | 6,630.51 | -50.38 | 31.63 | 58.23 | 8.66 |
| 6,671.00 | 26.64 | 131.74 | 6,658.56 | -59.14 | 41.51 | 71.39 | 9.30 |
| 6,703.00 | 29.17 | 132.49 | 6,686.83 | -69.18 | 52.61 | 86.33 | 7.98 |
| 6,734.00 | 31.15 | 134.20 | 6,713.64 | -79.88 | 63.93 | 101.88 | 6.96 |
| 6,766.00 | 34.06 | 132.62 | 6,740.59 | -91.72 | 76.46 | 119.10 | 9.47 |
| 6,798.00 | 36.94 | 133.44 | 6,766.64 | -104.40 | 90.04 | 137.66 | 9.12 |

Design Report for DF Ranch PC GK17-99HZ - Sperry MWD Survey

| Measured Depth (ft) | Inclination (°) | Azimuth (°) | Vertical Depth (ft) | +N/-S (ft) | +E/-W (ft) | Vertical Section (ft) | Dogleg Rate (°/100ft) |
|---------------------|-----------------|-------------|---------------------|------------|------------|-----------------------|-----------------------|
| 6,829.00 | 40.29 | 133.21 | 6,790.86 | -117.67 | 104.12 | 156.98 | 10.82 |
| 6,861.00 | 42.77 | 132.56 | 6,814.81 | -132.11 | 119.66 | 178.16 | 7.87 |
| 6,892.00 | 44.99 | 132.85 | 6,837.16 | -146.68 | 135.45 | 199.61 | 7.19 |
| 6,924.00 | 47.84 | 134.35 | 6,859.22 | -162.67 | 152.23 | 222.76 | 9.53 |
| 6,955.00 | 50.18 | 134.29 | 6,879.55 | -179.01 | 168.97 | 246.15 | 7.55 |
| 6,987.00 | 52.89 | 133.92 | 6,899.45 | -196.45 | 186.96 | 271.19 | 8.52 |
| 7,018.00 | 54.54 | 134.86 | 6,917.80 | -213.93 | 204.81 | 296.17 | 5.86 |
| 7,050.00 | 55.67 | 135.31 | 6,936.10 | -232.52 | 223.34 | 322.41 | 3.71 |
| 7,081.00 | 57.41 | 136.79 | 6,953.20 | -251.14 | 241.29 | 348.27 | 6.88 |
| 7,113.00 | 60.19 | 136.71 | 6,969.77 | -271.07 | 260.04 | 375.64 | 8.69 |
| 7,144.00 | 63.20 | 136.12 | 6,984.47 | -290.84 | 278.86 | 402.93 | 9.85 |
| 7,176.00 | 65.65 | 134.75 | 6,998.28 | -311.40 | 299.11 | 431.78 | 8.57 |
| 7,207.00 | 68.56 | 135.08 | 7,010.34 | -331.56 | 319.33 | 460.33 | 9.44 |
| 7,239.00 | 71.81 | 134.22 | 7,021.19 | -352.71 | 340.75 | 490.43 | 10.47 |
| 7,270.00 | 74.18 | 134.46 | 7,030.25 | -373.43 | 361.95 | 520.05 | 7.68 |
| 7,302.00 | 76.58 | 134.07 | 7,038.33 | -395.04 | 384.12 | 551.00 | 7.59 |
| 7,333.00 | 79.67 | 134.24 | 7,044.71 | -416.17 | 405.89 | 581.32 | 9.98 |
| 7,365.00 | 82.39 | 134.55 | 7,049.70 | -438.28 | 428.47 | 612.91 | 8.55 |
| 7,445.00 | 85.30 | 135.20 | 7,058.27 | -494.40 | 484.83 | 692.42 | 3.73 |
| 7,481.00 | 86.41 | 135.76 | 7,060.88 | -520.00 | 510.00 | 728.32 | 3.45 |
| 7,513.00 | 88.15 | 135.58 | 7,062.39 | -542.86 | 532.34 | 760.29 | 5.47 |
| 7,545.00 | 89.75 | 135.10 | 7,062.98 | -565.62 | 554.83 | 792.28 | 5.22 |
| 7,608.00 | 90.06 | 135.19 | 7,063.08 | -610.28 | 599.26 | 855.27 | 0.51 |
| 7,672.00 | 90.00 | 134.82 | 7,063.05 | -655.54 | 644.51 | 919.26 | 0.59 |
| 7,736.00 | 89.81 | 134.76 | 7,063.16 | -700.63 | 689.93 | 983.24 | 0.31 |
| 7,800.00 | 90.68 | 135.12 | 7,062.88 | -745.83 | 735.23 | 1,047.23 | 1.47 |
| 7,863.00 | 90.62 | 134.68 | 7,062.17 | -790.30 | 779.85 | 1,110.21 | 0.70 |
| 7,927.00 | 90.87 | 136.57 | 7,061.34 | -836.04 | 824.61 | 1,174.20 | 2.98 |
| 7,990.00 | 91.23 | 136.98 | 7,060.18 | -881.94 | 867.75 | 1,237.18 | 0.87 |
| 8,054.00 | 89.88 | 136.24 | 7,059.56 | -928.44 | 911.71 | 1,301.18 | 2.41 |
| 8,118.00 | 90.86 | 137.52 | 7,059.15 | -975.15 | 955.45 | 1,365.17 | 2.52 |
| 8,181.00 | 90.93 | 137.27 | 7,058.17 | -1,021.52 | 998.09 | 1,428.14 | 0.41 |
| 8,245.00 | 89.51 | 136.91 | 7,057.92 | -1,068.39 | 1,041.67 | 1,492.13 | 2.29 |
| 8,309.00 | 90.43 | 137.19 | 7,057.95 | -1,115.24 | 1,085.27 | 1,556.12 | 1.50 |
| 8,372.00 | 91.17 | 137.10 | 7,057.07 | -1,161.42 | 1,128.12 | 1,619.10 | 1.18 |
| 8,436.00 | 89.81 | 136.14 | 7,056.53 | -1,207.93 | 1,172.07 | 1,683.09 | 2.60 |
| 8,500.00 | 90.19 | 136.04 | 7,056.53 | -1,254.04 | 1,216.46 | 1,747.09 | 0.61 |
| 8,563.00 | 90.56 | 137.23 | 7,056.11 | -1,299.83 | 1,259.71 | 1,810.09 | 1.98 |
| 8,627.00 | 90.37 | 138.76 | 7,055.59 | -1,347.39 | 1,302.54 | 1,874.05 | 2.41 |
| 8,691.00 | 90.37 | 140.69 | 7,055.18 | -1,396.21 | 1,343.91 | 1,937.91 | 3.02 |
| 8,754.00 | 90.06 | 139.40 | 7,054.94 | -1,444.51 | 1,384.37 | 2,000.76 | 2.11 |
| 8,818.00 | 90.49 | 139.56 | 7,054.64 | -1,493.16 | 1,425.95 | 2,064.65 | 0.72 |
| 8,881.00 | 88.83 | 135.24 | 7,055.01 | -1,539.52 | 1,468.58 | 2,127.61 | 7.35 |
| 8,944.00 | 89.13 | 135.20 | 7,056.13 | -1,584.23 | 1,512.95 | 2,190.60 | 0.48 |
| 9,008.00 | 89.26 | 135.16 | 7,057.03 | -1,629.62 | 1,558.06 | 2,254.58 | 0.21 |
| 9,072.00 | 89.69 | 135.28 | 7,057.62 | -1,675.05 | 1,603.14 | 2,318.57 | 0.70 |
| 9,136.00 | 89.88 | 135.03 | 7,057.86 | -1,720.42 | 1,648.27 | 2,382.56 | 0.49 |
| 9,200.00 | 90.80 | 134.94 | 7,057.48 | -1,765.67 | 1,693.53 | 2,446.55 | 1.44 |
| 9,264.00 | 91.54 | 134.71 | 7,056.17 | -1,810.77 | 1,738.92 | 2,510.52 | 1.21 |
| 9,328.00 | 90.19 | 135.55 | 7,055.21 | -1,856.12 | 1,784.06 | 2,574.50 | 2.48 |
| 9,391.00 | 90.49 | 135.90 | 7,054.83 | -1,901.23 | 1,828.04 | 2,637.50 | 0.73 |

Design Report for DF Ranch PC GK17-99HZ - Sperry MWD Survey

| Measured Depth (ft) | Inclination (°) | Azimuth (°) | Vertical Depth (ft) | +N/-S (ft) | +E/-W (ft) | Vertical Section (ft) | Dogleg Rate (°/100ft) |
|---|-----------------|-------------|---------------------|------------|------------|-----------------------|-----------------------|
| 9,455.00 | 90.37 | 135.78 | 7,054.35 | -1,947.14 | 1,872.63 | 2,701.50 | 0.27 |
| 9,519.00 | 90.68 | 136.11 | 7,053.77 | -1,993.14 | 1,917.13 | 2,765.49 | 0.71 |
| 9,583.00 | 90.56 | 135.84 | 7,053.07 | -2,039.15 | 1,961.60 | 2,829.49 | 0.46 |
| 9,646.00 | 91.05 | 135.26 | 7,052.19 | -2,084.12 | 2,005.72 | 2,892.48 | 1.21 |
| 9,710.00 | 90.25 | 133.72 | 7,051.46 | -2,128.96 | 2,051.37 | 2,956.45 | 2.71 |
| 9,773.00 | 90.80 | 136.84 | 7,050.88 | -2,173.72 | 2,095.69 | 3,019.43 | 5.03 |
| 9,837.00 | 90.37 | 134.29 | 7,050.23 | -2,219.41 | 2,140.49 | 3,083.42 | 4.04 |
| 9,900.00 | 90.49 | 137.06 | 7,049.76 | -2,264.48 | 2,184.50 | 3,146.41 | 4.40 |
| 9,964.00 | 90.31 | 139.39 | 7,049.31 | -2,312.20 | 2,227.14 | 3,210.36 | 3.65 |
| 10,027.00 | 90.06 | 143.24 | 7,049.11 | -2,361.37 | 2,266.51 | 3,273.09 | 6.12 |
| 10,091.00 | 89.94 | 145.11 | 7,049.11 | -2,413.26 | 2,303.96 | 3,336.44 | 2.93 |
| 10,154.00 | 90.00 | 146.05 | 7,049.14 | -2,465.23 | 2,339.57 | 3,398.58 | 1.50 |
| 10,186.00 | 90.19 | 142.57 | 7,049.09 | -2,491.22 | 2,358.24 | 3,430.24 | 10.89 |
| 10,218.00 | 89.38 | 139.59 | 7,049.21 | -2,516.11 | 2,378.34 | 3,462.12 | 9.65 |
| 10,250.00 | 89.51 | 139.14 | 7,049.52 | -2,540.39 | 2,399.18 | 3,494.06 | 1.46 |
| 10,282.00 | 89.69 | 137.81 | 7,049.74 | -2,564.35 | 2,420.39 | 3,526.03 | 4.19 |
| 10,314.00 | 89.63 | 135.31 | 7,049.93 | -2,587.58 | 2,442.39 | 3,558.03 | 7.81 |
| 10,346.00 | 88.64 | 133.51 | 7,050.41 | -2,609.97 | 2,465.25 | 3,590.01 | 6.42 |
| 10,410.00 | 88.52 | 133.92 | 7,052.00 | -2,654.19 | 2,511.49 | 3,653.94 | 0.67 |
| 10,473.00 | 89.69 | 132.46 | 7,052.98 | -2,697.30 | 2,557.42 | 3,716.85 | 2.97 |
| 10,537.00 | 91.61 | 132.51 | 7,052.26 | -2,740.52 | 2,604.61 | 3,780.71 | 3.00 |
| 10,600.00 | 91.92 | 132.56 | 7,050.32 | -2,783.09 | 2,651.01 | 3,843.56 | 0.50 |
| 10,664.00 | 91.61 | 132.99 | 7,048.35 | -2,826.53 | 2,697.97 | 3,907.43 | 0.83 |
| 10,728.00 | 91.67 | 133.01 | 7,046.51 | -2,870.16 | 2,744.75 | 3,971.31 | 0.10 |
| 10,792.00 | 90.99 | 132.97 | 7,045.03 | -2,913.79 | 2,791.55 | 4,035.20 | 1.06 |
| 10,856.00 | 90.99 | 132.82 | 7,043.92 | -2,957.34 | 2,838.43 | 4,099.09 | 0.23 |
| 10,920.00 | 90.49 | 133.34 | 7,043.10 | -3,001.05 | 2,885.18 | 4,163.00 | 1.13 |
| 10,983.00 | 90.74 | 133.42 | 7,042.42 | -3,044.32 | 2,930.96 | 4,225.92 | 0.42 |
| 11,047.00 | 91.30 | 133.28 | 7,041.28 | -3,088.25 | 2,977.49 | 4,289.84 | 0.90 |
| 11,110.00 | 92.53 | 133.33 | 7,039.18 | -3,131.43 | 3,023.31 | 4,352.73 | 1.95 |
| 11,174.00 | 91.05 | 133.57 | 7,037.18 | -3,175.42 | 3,069.75 | 4,416.63 | 2.34 |
| 11,238.00 | 90.62 | 133.86 | 7,036.24 | -3,219.65 | 3,116.01 | 4,480.57 | 0.81 |
| 11,301.00 | 91.05 | 134.25 | 7,035.33 | -3,263.45 | 3,161.28 | 4,543.52 | 0.92 |
| 11,364.00 | 89.94 | 134.58 | 7,034.78 | -3,307.54 | 3,206.27 | 4,606.49 | 1.84 |
| 11,428.00 | 89.32 | 134.60 | 7,035.20 | -3,352.47 | 3,251.85 | 4,670.47 | 0.97 |
| 11,492.00 | 90.19 | 134.83 | 7,035.47 | -3,397.49 | 3,297.33 | 4,734.45 | 1.41 |
| 11,556.00 | 91.11 | 134.30 | 7,034.74 | -3,442.40 | 3,342.92 | 4,798.42 | 1.66 |
| 11,621.00 | 91.30 | 134.98 | 7,033.38 | -3,488.06 | 3,389.16 | 4,863.39 | 1.09 |
| 11,684.00 | 90.68 | 135.96 | 7,032.29 | -3,532.97 | 3,433.34 | 4,926.37 | 1.84 |
| 11,748.00 | 90.56 | 136.14 | 7,031.59 | -3,579.04 | 3,477.75 | 4,990.37 | 0.34 |
| 11,812.00 | 90.74 | 136.21 | 7,030.87 | -3,625.21 | 3,522.07 | 5,054.37 | 0.30 |
| 11,876.00 | 90.49 | 136.89 | 7,030.18 | -3,671.67 | 3,566.08 | 5,118.36 | 1.13 |
| 11,941.00 | 90.19 | 137.67 | 7,029.80 | -3,719.42 | 3,610.17 | 5,183.34 | 1.29 |
| 12,005.00 | 90.99 | 137.57 | 7,029.14 | -3,766.70 | 3,653.31 | 5,247.32 | 1.26 |
| 12,069.00 | 89.44 | 136.73 | 7,028.90 | -3,813.62 | 3,696.83 | 5,311.30 | 2.75 |
| 12,132.00 | 88.95 | 136.23 | 7,029.78 | -3,859.29 | 3,740.21 | 5,374.29 | 1.11 |
| 12,167.00 | 89.44 | 136.01 | 7,030.27 | -3,884.52 | 3,764.47 | 5,409.29 | 1.53 |
| Final Sperry MWD Survey | | | | | | | |
| 12,200.00 | 89.44 | 136.01 | 7,030.60 | -3,908.26 | 3,787.39 | 5,442.29 | 0.00 |
| Straight Line Projection to TD - Estimated BHL: 1242' FSL, 642' FEL | | | | | | | |

Project: Weld County, CO (NAD 83)
 Site: Sec. 17-T11N-R61W
 Well: DF Ranch PC GK17-99HZ

Noble Energy

HALLIBURTON

Sperry Drilling



Azimuths to Grid North
 True North: -0.82°
 Magnetic North: 7.86°

Magnetic Field
 Strength: 53528.0snT
 Dip Angle: 67.60°
 Date: 9/1/2010
 Model: BGGM2010

LEGEND

— DF Ranch PC GK17-99HZ,
 — Sperry MWD Survey

Halliburton Energy Services, Inc. ("Halliburton") recently completed directional drilling and MWD operations at the DF Ranch PC GK17-99HZ well located at Weld County, CO. At the conclusion of the job Halliburton performed a final survey on the well. Noble Energy has requested that Halliburton provide them the distances from BHL to section lines from that final survey to allow Noble Energy to meet its requirements under Colorado law. These distances are generated by a mathematical algorithm based on rough data collected after the well is drilled. Halliburton considers it to be a rough estimate only and it is not to be relied upon in any application where accurate data is required. In consideration for Halliburton releasing this data to Noble Energy, Noble Energy agrees to release Halliburton from any consequences of it or anyone else relying on such data.

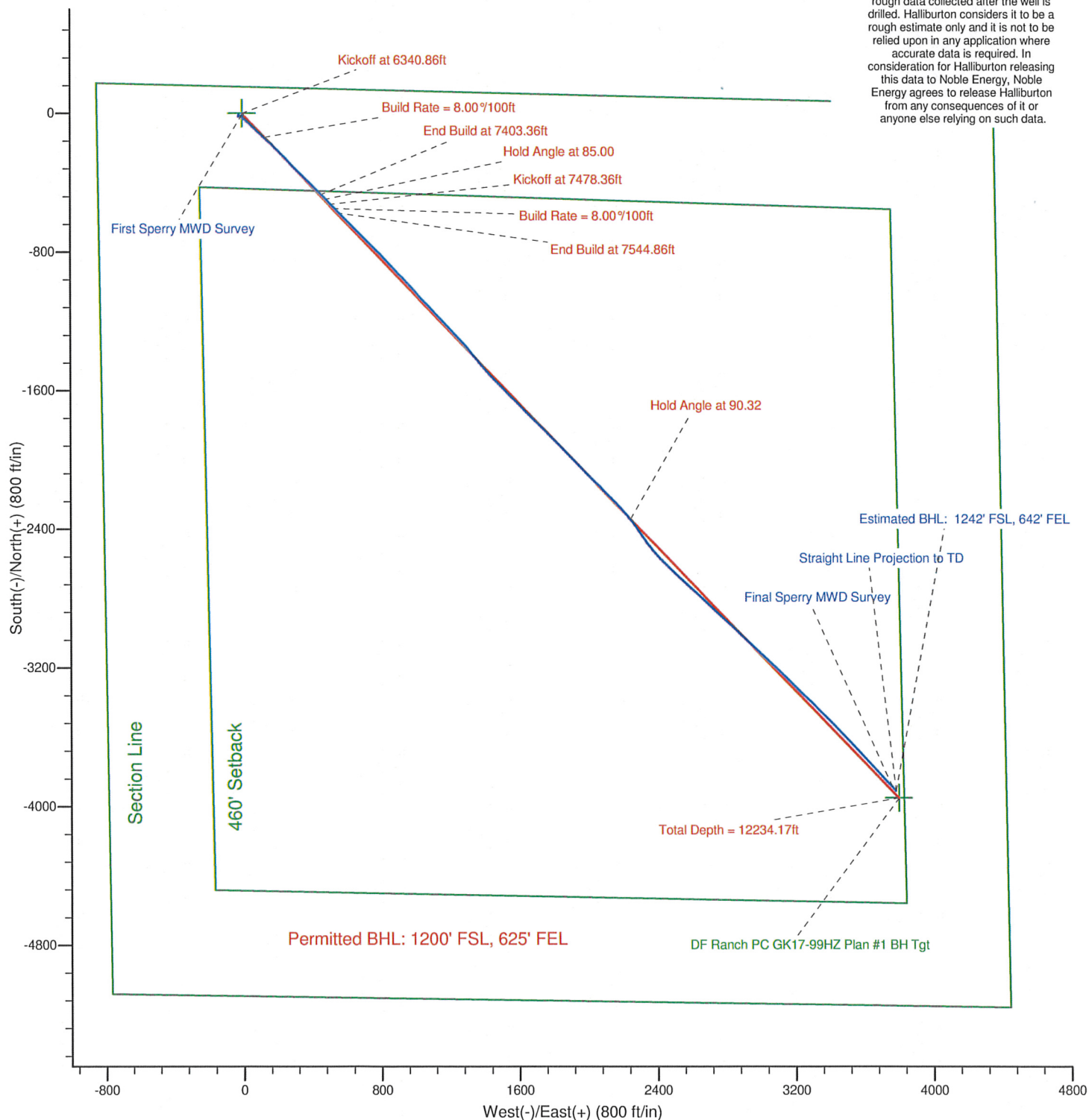

Project: Weld County, CO (NAD 83)
Site: Sec. 17-T11N-R61W
Well: DF Ranch PC GK17-99HZ

Noble Energy

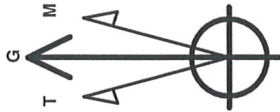

Azimuths to Grid North
True North: -0.82°
Magnetic North: 7.86°
Magnetic Field
Strength: 53528.0snT
Dip Angle: 67.60°
Date: 9/1/2010
Model: BGGM2010

LEGEND

- DF Ranch PC GK17-99HZ,
- Sperry MWD Survey

Halliburton Energy Services, Inc. ("Halliburton") recently completed directional drilling and MWD operations at the DF Ranch PC GK17-99HZ well located at Weld County, CO. At the conclusion of the job Halliburton performed a final survey on the well. Noble Energy has requested that Halliburton provide them the distances from BHL to section lines from that final survey to allow Noble Energy to meet its requirements under Colorado law. These distances are generated by a mathematical algorithm based on rough data collected after the well is drilled. Halliburton considers it to be a rough estimate only and it is not to be relied upon in any application where accurate data is required. In consideration for Halliburton releasing this data to Noble Energy, Noble Energy agrees to release Halliburton from any consequences of it or anyone else relying on such data.

