

Co-ordinate (NE) Reference: Well File 42-17, True North
Vertical (TVD) Reference: WELL @ 4895.0ft (Original Well Elev)
Section (VS) Reference: Slot - (0.0N, 0.0E)
Measured Depth Reference: WELL @ 4895.0ft (Original Well Elev)
Calculation Method:

WELL DETAILS: File 42-17

+N/-S	+E/-W	Northing	Easting	Ground Level:	Latitude	Longitude	Slot
0.0	0.0	1295248.75	3133173.74	4882.0	40° 8' 34.332 N	105° 1' 25.104 W	

SECTION DETAILS

Sec	MD	Inc	Azi	TVD	+N/-S	+E/-W	DLeg	TFace	VSec	Target
1	0.0	0.00	0.00	0.0	0.0	0.0	0.00	0.00	0.0	
2	600.0	0.00	0.00	600.0	0.0	0.0	0.00	0.00	0.0	
3	1372.7	15.45	130.98	1363.4	-67.9	78.2	2.00	130.98	103.6	
4	6390.4	15.45	130.98	6199.6	-944.7	1087.6	0.00	0.00	1440.7	
5	7163.1	0.00	0.00	6963.0	-1012.7	1165.8	2.00	180.00	1544.2	
6	8213.1	0.00	0.00	8013.0	-1012.7	1165.8	0.00	0.00	1544.2	File 42-17

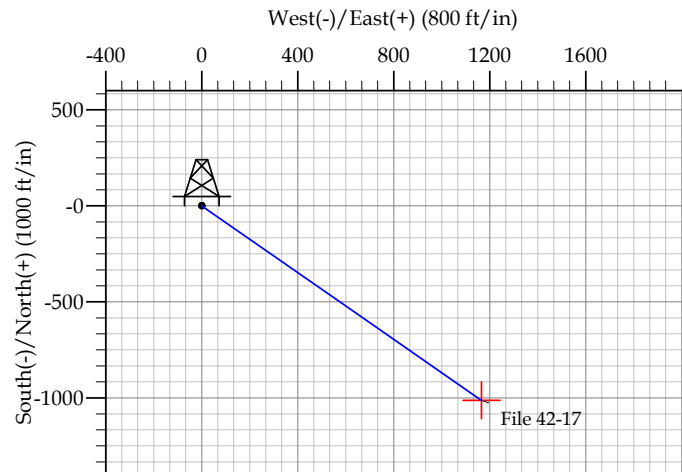

FORMATION TOP DETAILS

TVDPath	MDPath	Formation
4170.0	4284.6	Sussex
5095.0	5244.3	Shannon
7185.0	7385.1	Niobrara
7448.0	7648.1	Codell
7863.0	8063.1	J Sand
7923.0	8123.1	A Marker

CASING DETAILS

TVD	MD	Name	Size
550.0	550.0	Surface	8.625
8013.0	8213.1	Production	4.500

EnCana Corporation

Planning Report - Geographic

Database:	EDM	Local Co-ordinate Reference:	Well File 42-17
Company:	DJ/Paradox/WTX	TVD Reference:	WELL @ 4895.0ft (Original Well Elev)
Project:	Wattenberg	MD Reference:	WELL @ 4895.0ft (Original Well Elev)
Site:	New Drills	North Reference:	True
Well:	File 42-17	Survey Calculation Method:	Minimum Curvature
Wellbore:	Wellbore #1		
Design:	File 42-17		

Project	Wattenberg,		
Map System:	US State Plane 1983	System Datum:	Mean Sea Level
Geo Datum:	North American Datum 1983		
Map Zone:	Colorado Northern Zone		

Site	New Drills					
Site Position:		Northing:	1,278,589.08 ft	Latitude:	40° 5' 49.848 N	
From:	Lat/Long	Easting:	3,130,247.44 ft	Longitude:	105° 2' 3.912 W	
Position Uncertainty:		ft	Slot Radius:	in	Grid Convergence:	0.30 °

Well	File 42-17					
Well Position	+N-S	16,643.7 ft	Northing:	1,295,248.75 ft	Latitude:	40° 8' 34.332 N
	+E-W	3,015.8 ft	Easting:	3,133,173.74 ft	Longitude:	105° 1' 25.104 W
Position Uncertainty		ft	Wellhead Elevation:	ft	Ground Level:	4,882.0 ft

Wellbore	Wellbore #1				
Magnetics	Model Name	Sample Date	Declination (°)	Dip Angle (°)	Field Strength (nT)
	IGRF200510	12/31/2009	9.14	66.86	53,140

Design	File 42-17				
Audit Notes:					
Version:	Phase:	PROTOTYPE	Tie On Depth:	0.0	
Vertical Section:	Depth From (TVD) (ft)	+N-S (ft)	+E-W (ft)	Direction (°)	
	0.0	0.0	0.0	130.98	

Plan Sections										
Measured Depth (ft)	Inclination (°)	Azimuth (°)	Vertical Depth (ft)	+N-S (ft)	+E-W (ft)	Dogleg Rate (°/100ft)	Build Rate (°/100ft)	Turn Rate (°/100ft)	TFO (°)	Target
0.0	0.00	0.00	0.0	0.0	0.0	0.00	0.00	0.00	0.00	
600.0	0.00	0.00	600.0	0.0	0.0	0.00	0.00	0.00	0.00	
1,372.7	15.45	130.98	1,363.4	-67.9	78.2	2.00	2.00	0.00	130.98	
6,390.4	15.45	130.98	6,199.6	-944.7	1,087.6	0.00	0.00	0.00	0.00	
7,163.1	0.00	0.00	6,963.0	-1,012.7	1,165.8	2.00	-2.00	0.00	180.00	
8,213.1	0.00	0.00	8,013.0	-1,012.7	1,165.8	0.00	0.00	0.00	0.00	File 42-17

EnCana Corporation

Planning Report - Geographic

Database:	EDM	Local Co-ordinate Reference:	Well File 42-17
Company:	DJ/Paradox/WTX	TVD Reference:	WELL @ 4895.0ft (Original Well Elev)
Project:	Wattenberg	MD Reference:	WELL @ 4895.0ft (Original Well Elev)
Site:	New Drills	North Reference:	True
Well:	File 42-17	Survey Calculation Method:	Minimum Curvature
Wellbore:	Wellbore #1		
Design:	File 42-17		

Planned Survey									
Measured Depth (ft)	Inclination (°)	Azimuth (°)	Vertical Depth (ft)	+N/-S (ft)	+E/-W (ft)	Map Northing (ft)	Map Easting (ft)	Latitude	Longitude
0.0	0.00	0.00	0.0	0.0	0.0	1,295,248.75	3,133,173.74	40° 8' 34.332 N	105° 1' 25.104 W
550.0	0.00	0.00	550.0	0.0	0.0	1,295,248.75	3,133,173.74	40° 8' 34.332 N	105° 1' 25.104 W
Surface									
600.0	0.00	0.00	600.0	0.0	0.0	1,295,248.75	3,133,173.74	40° 8' 34.332 N	105° 1' 25.104 W
1,372.7	15.45	130.98	1,363.4	-67.9	78.2	1,295,181.24	3,133,252.31	40° 8' 33.661 N	105° 1' 24.097 W
4,284.6	15.45	130.98	4,170.0	-576.8	664.0	1,294,675.56	3,133,840.84	40° 8' 28.632 N	105° 1' 16.554 W
Sussex									
5,244.3	15.45	130.98	5,095.0	-744.5	857.1	1,294,508.90	3,134,034.81	40° 8' 26.975 N	105° 1' 14.068 W
Shannon									
6,390.4	15.45	130.98	6,199.6	-944.7	1,087.6	1,294,309.87	3,134,266.44	40° 8' 24.995 N	105° 1' 11.099 W
7,163.1	0.00	0.00	6,963.0	-1,012.7	1,165.8	1,294,242.37	3,134,345.01	40° 8' 24.324 N	105° 1' 10.092 W
7,385.1	0.00	0.00	7,185.0	-1,012.7	1,165.8	1,294,242.37	3,134,345.01	40° 8' 24.324 N	105° 1' 10.092 W
Niobrara									
7,648.1	0.00	0.00	7,448.0	-1,012.7	1,165.8	1,294,242.37	3,134,345.01	40° 8' 24.324 N	105° 1' 10.092 W
Codell									
8,063.1	0.00	0.00	7,863.0	-1,012.7	1,165.8	1,294,242.37	3,134,345.01	40° 8' 24.324 N	105° 1' 10.092 W
J Sand									
8,123.1	0.00	0.00	7,923.0	-1,012.7	1,165.8	1,294,242.37	3,134,345.01	40° 8' 24.324 N	105° 1' 10.092 W
A Marker									
8,213.1	0.00	0.00	8,013.0	-1,012.7	1,165.8	1,294,242.37	3,134,345.01	40° 8' 24.324 N	105° 1' 10.092 W
Production - File 42-17									

Design Targets									
Target Name	Dip Angle (°)	Dip Dir. (°)	TVD (ft)	+N/-S (ft)	+E/-W (ft)	Northing (ft)	Easting (ft)	Latitude	Longitude
- hit/miss target									
- Shape									
File 42-17	0.00	0.00	8,013.0	-1,012.7	1,165.8	1,294,242.37	3,134,345.01	40° 8' 24.324 N	105° 1' 10.092 W
- plan hits target									
- Point									

Casing Points					
Measured Depth (ft)	Vertical Depth (ft)	Name	Casing Diameter (in)	Hole Diameter (in)	
550.0	550.0	Surface	8.625	12.250	
8,213.1	8,013.0	Production	4.500	7.785	

Formations						
Measured Depth (ft)	Vertical Depth (ft)	Name	Lithology	Dip (°)	Dip Direction (°)	
4,284.6	4,170.0	Sussex		0.00		
5,244.3	5,095.0	Shannon		0.00		
7,385.1	7,185.0	Niobrara		0.00		
7,648.1	7,448.0	Codell		0.00		
8,063.1	7,863.0	J Sand		0.00		
8,123.1	7,923.0	A Marker		0.00		

EnCana Corporation
Planning Report - Geographic

Database:	EDM	Local Co-ordinate Reference:	Well File 42-17
Company:	DJ/Paradox/WTX	TVD Reference:	WELL @ 4895.0ft (Original Well Elev)
Project:	Wattenberg	MD Reference:	WELL @ 4895.0ft (Original Well Elev)
Site:	New Drills	North Reference:	True
Well:	File 42-17	Survey Calculation Method:	Minimum Curvature
Wellbore:	Wellbore #1		
Design:	File 42-17		