



April 25, 2011

Department of Natural Resources  
Oil and Gas Conservation Commission  
The Chancery Building  
1120 Lincoln St., Suite 801  
Denver, CO 80203

Re: **20 Day Certification Letter - 318A-e**  
RIVERBEND 32-13  
Township 1 North, Range 67 West, Section 13: NW/4NW/4  
Unit Spacing: 01N-67W-14 NE/4SE/4; SE/4NE/4  
01N-67W-13 NW/4SW/4; SW/4NW/4  
Weld County, Colorado

Ladies/Gentlemen:

Kerr-McGee Oil and Gas Onshore LP ("KMG") hereby certifies to the Director that a twenty (20) day notice has been given by certified mail to all owners in the proposed wellbore spacing unit. We have not received any objections to such well location, proposed spacing unit, or additional producing formation. KMG hereby requests the Director to approve the boundary well.

If you have any questions or issues regarding this permit, please contact Cheryl Light at (720) 929-6461.

Very truly yours,

**Kerr-McGee Oil and Gas Onshore LP**

A handwritten signature in blue ink that reads 'Rebecca Heim'.

**Rebecca Heim**  
**Regulatory Analyst II**

Enclosure



WELL LOCATION CERTIFICATE: RIVERBEND 32-13

NW SEC. 13  
2½" ALUM. CAP  
LS 11372

N 89°29'52" E 2635.42'

N 89°17'10" E 2622.74'

N 1/4 SEC. 13  
2 1/2" ALUM. CAP  
ILLEGIBLE

NE SEC. 13  
2½" ALUM. CAP  
LS 28286

SURFACE LOCATION  
GROUND ELEVATION= 4953'  
NAD83  
LATITUDE= 40.055769°  
LONGITUDE= 104.847380°

BOTTOM HOLE LOCATION

NAD83  
LATITUDE= 40.051199°  
LONGITUDE= 104.848329°

PDOP= 1.88

GPS OPERATOR: CHRIS PEARSON

W  $\frac{1}{4}$  SEC. 13  
2 $\frac{1}{2}$ " ALUM. CAP  
LS 11372

BH- 2590' FNL  
50' FWL

NOTES:

THIS IS A DIRECTIONAL WELL  
BH LOCATION TO BE 2590' FNL & 50' FWL  
BH LOCATION PROVIDED BY CLIENT.  
LAND SURFACE USE-OPEN FIELD  
TWINNING PROPOSED WELL RIVERBEND  
5-13 TO BE 10' N

~~PROPOSED WELL RIVERBEND 5-13  
TO BE 915' FSL & 320' FWL~~

SEE ATTACHED MAP FOR ADDITIONAL  
IMPROVEMENTS WITHIN 400'.

SW SEC. 13  
" ALUM. CAP  
LS 11372



S 88°09'44" W 2617.84'



S 1/4 SEC. 13  
2 1/2" ALUM. CAP  
LS 11372

SE SEC. 13  
2½" ALUM. CAP  
LS 20671

WELL **RIVERBEND 32-13** TO BE LOCATED 925' FNL AND 320' FWL, SECTION 13, T1N, R67W OF THE 6th P.M.

### LEGEND

 = EXISTING MONUMENT  
 = PROPOSED WELL

 = BOTTOM HOLE  
 = EXISTING WELL

BH = BOTTOM HOLE

0      500      1000

SCALE: 1"=1000'

NOTES:

- NOTES:
1. THIS SURVEY WAS DONE BY GPS METHODS AND CONFORMS TO THE MINIMUM STANDARDS SET BY THE C.O.G.C.C., RULE NO. 215
  2. ELEVATIONS SHOWN AT THE WELL HEAD, AS WELL AS HORIZONTAL CONTROL, ARE BASED ON GPS-RTK VALUES DERIVED FROM DOING 2-HOUR STATIC GPS SESSIONS AND REDUCTIONS USING O.P.U.S. SOLUTIONS.  
VERTICAL = NAVD88; HORIZONTAL = NAD83/92
  3. THE BEARINGS SHOWN HEREON ARE BASED ON GPS OBSERVATIONS BETWEEN THE MONUMENTS SHOWN HEREON AS FOUND ON THE FIELD DATE BELOW.
  4. DISTANCES SHOWN ARE AT GRID LEVEL, AS MEASURED IN THE FIELD, WITH TIES TO WELLS MEASURED AT A PERPENDICULAR TO SECTION LINES.

I, JERRY F. HARCEK JR., A LICENSED PROFESSIONAL LAND SURVEYOR IN THE STATE OF COLORADO DO HEREBY CERTIFY TO KERR-MCGEE OIL & GAS ONSHORE LP, THAT THE SURVEY AND WELL LOCATION CERTIFICATE SHOWN HEREON WERE DONE BY ME OR UNDER MY DIRECT SUPERVISION AND THAT THE DRAWING SHOWN HEREON ACCURATELY DEPICTS THE PROPOSED LOCATION OF THE WELL RIVERBEND 32-13. THIS CERTIFICATE DOES NOT REPRESENT A LAND SURVEY PLAT OR IMPROVEMENT SURVEY PLAT AS DEFINED BY C.R.S. 38-51-102 AND CANNOT BE RELIED UPON TO DETERMINE OWNERSHIP.

JERRY F. HARCEK JR., PLS 34997  
COLORADO LICENSED PROFESSIONAL LAND SURVEYOR  
FOR AND ON BEHALF OF P.F.S., LLC

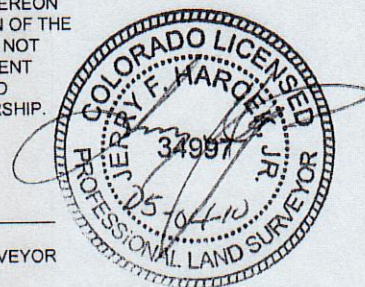

PREPARED BY:



FIELD DATE:  
04-27-10

WELL NAME:  
RIVERBEND 32-13

DRAWING DATE:  
04-30-10

SURFACE LOCATION:  
WELD COUNTY, COLORADO

BY:  
SME

NW 1/4 NW 1/4, SEC. 13, T1N, R67W

NOTICE: ACCORDING TO COLORADO LAW YOU MUST COMMENCE ANY LEGAL ACTION BASED UPON ANY DEFECT IN THIS SURVEY WITHIN THREE YEARS AFTER YOU FIRST DISCOVER SUCH DEFECT. IN NO EVENT MAY ANY ACTION BASED UPON ANY DEFECT IN THIS SURVEY BE COMMENCED MORE THAN TEN YEARS FROM THIS SAID DATE OF THIS CERTIFICATION SHOWN HEREON.



# RIVERBEND 32-13

## NWNW Sec. 13 T1N-R67W

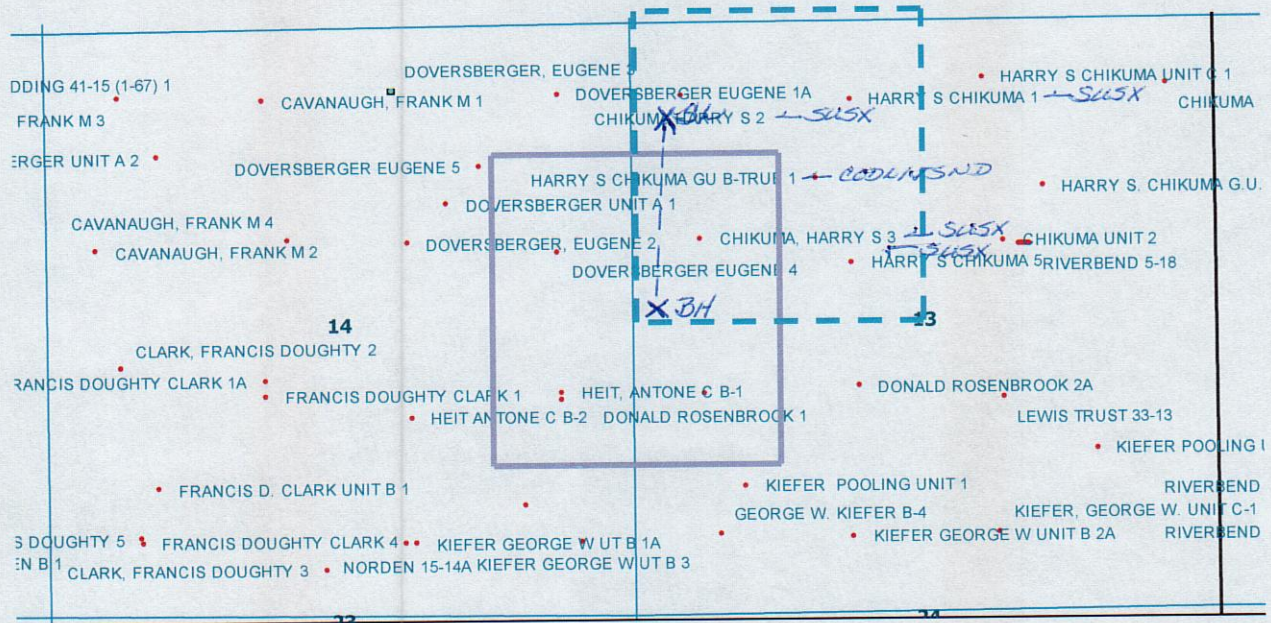

### LEGEND



Proposed 160 acre Spacing Unit (Solid line).



Bottom Hole Located SW/4NW/4, Sec. 13-T1N-R67W (Dashed line).

This 1/4 Section has less than 8 bottom hole wells producing from the Codell, Niobrara & J Sand Formations.