

Location Drawing SATER 2N-13HZ

Horizontal Multi Well Pad

SE¼ SE¼ SECTION 13, TOWNSHIP 4 NORTH, RANGE 64 WEST OF THE 6TH PRINCIPAL MERIDIAN

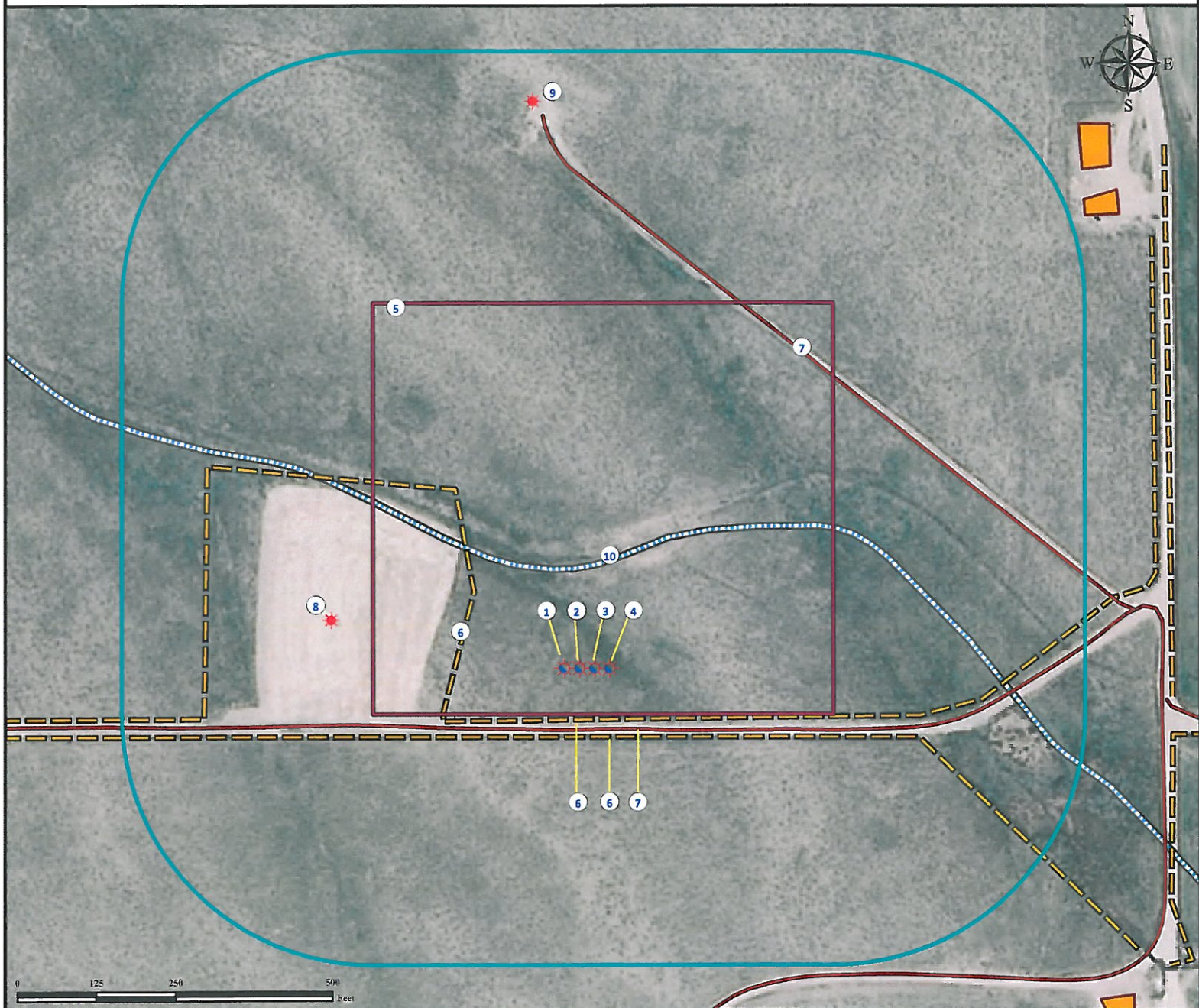

1. Proposed well SATER 28N-13HZ.

4. Proposed well SATER 1N-13HZ.

7. Private roads are ±99' S and ±613' NE.

2. Proposed well SATER 2N-13HZ.

5. Operational Disturbance Area.

8. Existing well SATER C 24-27 is ±400' NW.

3. Proposed well SATER 27N-13HZ.

6. Fences are ±196' W, ±85' S and ±110' S.

9. Existing well UPV 13-1614 is ±904' N.

10. Intermittent stream is ±157' N. Feature dry per field verify.

Legend

- | | | |
|---------------|----------------------|--------------|
| Proposed Well | Facilities Enclosure | Private Road |
| Existing Well | Disturbance Area | Fence |
| 400' Radius | Intermittent Stream | |

Reference Location

** All Measurements are Made from
Reference Well SATER 2N-13HZ **
Lat: 40.305223° Long: -104.493017° (NAD83)
Elevation: 4661 Feet

Surface Use: Rangeland



Use our resources to find yours!
www.petro-fs.com
(303) 928-7128

Field Date: 04/29/2011
Drafting Date: 05/09/2011
Drafter: DMM
Checked By: BHF

Data Sources:

- Aerial courtesy of NAIP (2009)
- Intermittent Stream data courtesy
NDIS 24K layer

Prepared for:



KERR-MCGEE OIL & GAS ONSHORE LP