

Map to Accompany
APPLICATION FOR PERMIT TO DRILL

Access Road Map

Patara Oil & Gas, LLC
HC Fed 31-31B-45-14
API No. 05-113-06243

Surface: 2,166' FSL 570' FWL (NW/4 SW/4)

Sec. 31 T45N R14W

BHL: ±438' FNL ±59' FWL (NENWE) Lot 1

Sec. 1 T44N R14W

San Miguel County, Colorado

Surface: Federal

Federal Mineral Lease: COC24356

LEGEND

- New Construction (BLM) On Lease
- Existing Road (BLM) On Lease
- Existing Road (BLM) Off Lease
- Existing Road (State) Off Lease
- Existing Road (Fee) On Lease

Revised by Banko Petroleum Management, Inc.

SAN MIGUEL CNTY., CO.

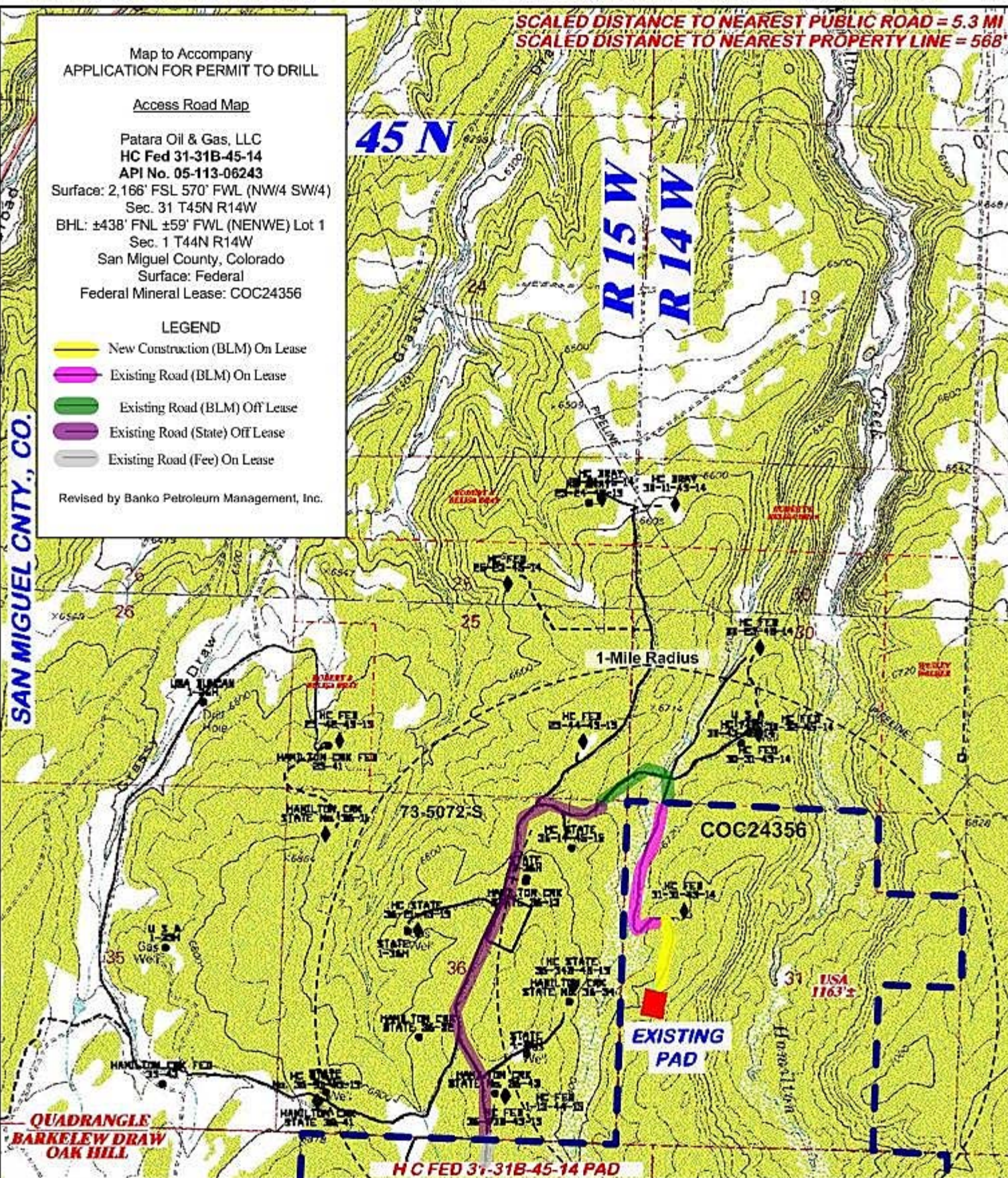

DRG RIFFIN & ASSOCIATES, INC.
1414 ELK ST., ROCK SPRINGS, WY 82901

(307) 382-5028

DRAWN: 3/14/07

SCALE: 1" = 2000'

REVISED: 6/17/11 - DEH

DRG JOB No. 14700

REVISE TITLE BLOCK

EXHIBIT/TOPO MAP 4

EXISTING ACCESS MAP

PATARA OIL & GAS, LLC.

H C FED 31-31B-45-14

NWSW SECTION 31, T. 45 N., R. 14 W., NEW MEXICO

P.M. SAN MIGUEL COUNTY, COLORADO

EXISTING ACCESS

EXISTING ACCESS

EXISTING ROAD