

# LOCATION DRAWING

KLEIN 34-8D

SECTION 8  
TOWNSHIP 4 NORTH  
RANGE 67 WEST

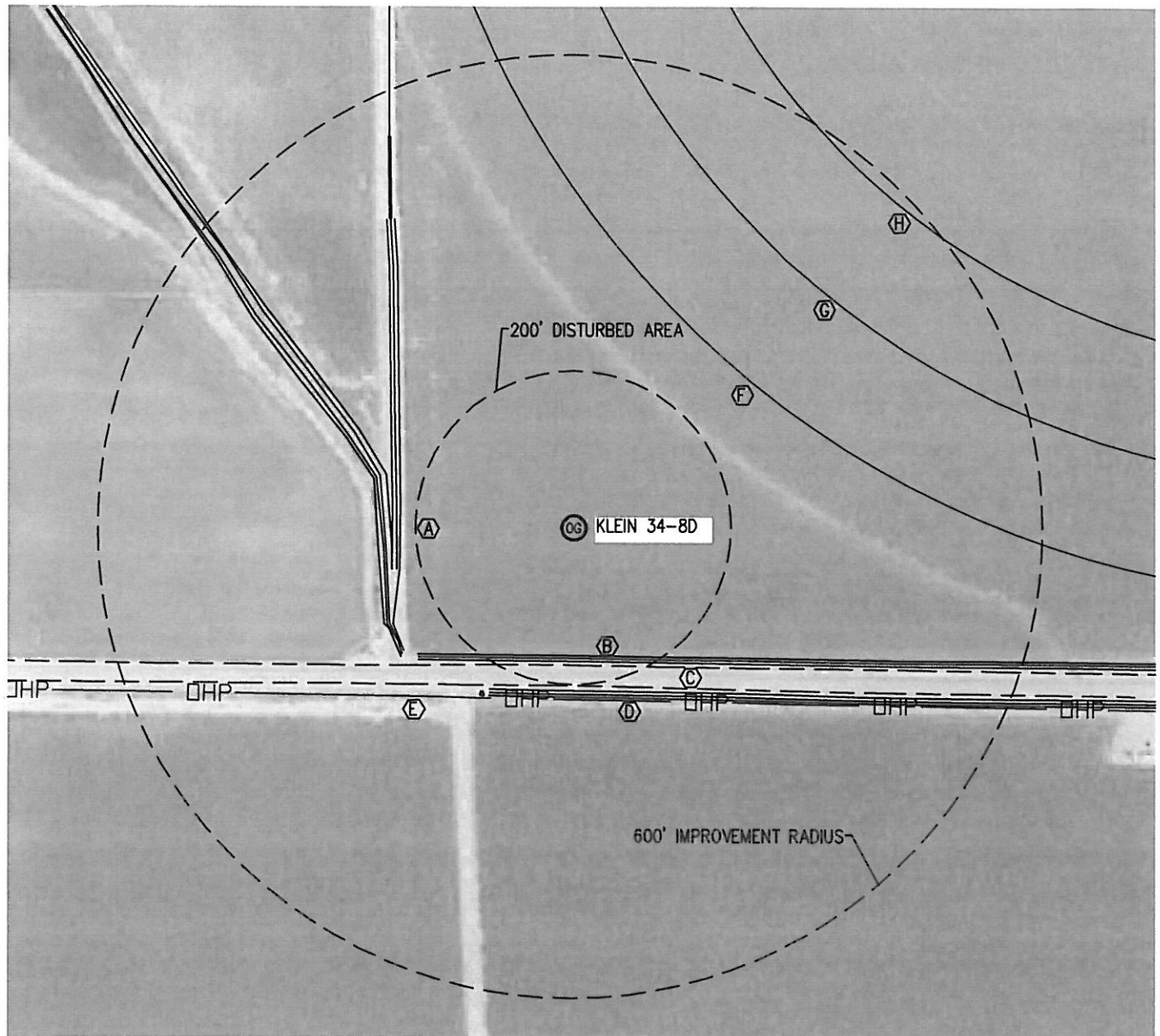

NEAREST: BUILDING 1,446' NW, PUBLIC ROAD 176' S, ABOVE GROUND UTILITY 220' S,  
RAILROAD 2,846' SE, PROPERTY LINE 191' S

## IMPROVEMENTS:

- (A) IRRIGATION DITCH 218' WEST
- (B) IRRIGATION DITCH 164' SOUTH
- (C) GRAVEL ROAD 176' SOUTH
- (D) IRRIGATION DITCH 209' SOUTH
- (E) OVERHEAD POWER 220' SOUTH
- (F) IRRIGATION SPRINKLER TRACK 288' NORTHEAST
- (G) IRRIGATION SPRINKLER TRACK 435' NORTHEAST
- (H) IRRIGATION SPRINKLER TRACK 581' NORTHEAST

## NOTE

The size, type and location of underground utilities shown hereon are approximate, and are based on markings made by utility locate companies. It is not guaranteed that all utilities have been located. It shall be the responsibility of the contractor to verify the existence of all underground utilities in the area of the work before commencing new construction.

