

## REFERENCE INFORMATION

Co-ordinate (NE) Reference: Well Norris 0-6-32, True North  
Vertical (TVD) Reference: WELL @ 4844.0ft (Original Well Elev)  
Section (VS) Reference: Slot - (0.0N, 0.0E)  
Measured Depth Reference: WELL @ 4844.0ft (Original Well Elev)  
Calculation Method:

## WELL DETAILS: Norris 0-6-32

+N/-S	+E/-W	Northing	Ground Level:	Easting	Latitude	Longitude	Slot
0.0	0.0	1308915.75	4831.0	3257028.74	40° 10' 39.756 N	04° 34' 48.468 W	

## SECTION DETAILS

Sec	MD	Inc	Azi	TVD	+N/-S	+E/-W	DLeg	TFace	VSec	Target
1	0.0	0.00	0.00	0.0	0.0	0.0	0.00	0.00	0.0	
2	800.0	0.00	0.00	800.0	0.0	0.0	0.00	0.00	0.0	
3	1461.8	13.24	273.27	1455.9	4.3	-76.0	2.00	273.27	76.1	
4	6102.2	13.24	273.27	5973.1	64.9	-1136.7	0.00	0.00	1138.6	
5	6764.0	0.00	0.00	6629.0	69.3	-1212.7	2.00	180.00	1214.7	
6	7814.0	0.00	0.00	7679.0	69.3	-1212.7	0.00	0.00	1214.7	Norris 0-6-32

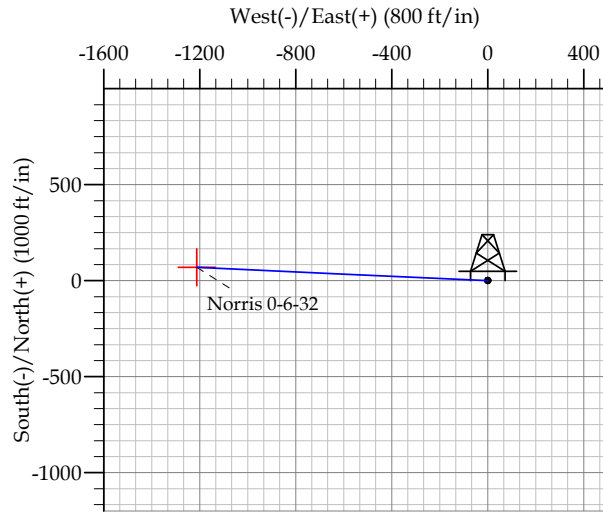

## FORMATION TOP DETAILS

TVDPath	MDPath	Formation
4384.0	4469.8	Sussex
6799.0	6934.0	Niobrara
7064.0	7199.0	Codell
7529.0	7664.0	J Sand
7619.0	7754.0	A Marker

## CASING DETAILS

TVD	MD	Name	Size
750.0	750.0	Surface	8.625
7679.0	7814.0	Production	4.500

# EnCana Corporation

## Planning Report - Geographic

<b>Database:</b>	EDM	<b>Local Co-ordinate Reference:</b>	Well Norris 0-6-32
<b>Company:</b>	DJ/Paradox/WTX	<b>TVD Reference:</b>	WELL @ 4844.0ft (Original Well Elev)
<b>Project:</b>	Wattenberg	<b>MD Reference:</b>	WELL @ 4844.0ft (Original Well Elev)
<b>Site:</b>	New Drills	<b>North Reference:</b>	True
<b>Well:</b>	Norris 0-6-32	<b>Survey Calculation Method:</b>	Minimum Curvature
<b>Wellbore:</b>	Wellbore #1		
<b>Design:</b>	Norris 0-6-32		

<b>Project</b>	Wattenberg,		
<b>Map System:</b>	US State Plane 1983	<b>System Datum:</b>	Mean Sea Level
<b>Geo Datum:</b>	North American Datum 1983		
<b>Map Zone:</b>	Colorado Northern Zone		

Site		New Drills				
Site Position:		Northing:	1,278,589.08ft	Latitude:	40° 5' 49.848 N	
From:	Lat/Long	Easting:	3,130,247.44ft	Longitude:	105° 2' 3.912 W	
Position Uncertainty:		ft	Slot Radius:	in	Grid Convergence:	0.30 °

Well	Norris 0-6-32					
Well Position	+N-S	29,010.0 ft	Northing:	1,308,915.75 ft	Latitude:	40° 10' 39.756 N
	+E-W	127,089.3 ft	Easting:	3,257,028.74 ft	Longitude:	104° 34' 48.468 W
Position Uncertainty		ft	Wellhead Elevation:	ft	Ground Level:	4,831.0 ft

<b>Wellbore</b>	Wellbore #1				
<b>Magnetics</b>	<b>Model Name</b>	<b>Sample Date</b>	<b>Declination (°)</b>	<b>Dip Angle (°)</b>	<b>Field Strength (nT)</b>
	IGRF200510	12/31/2009	8.90	66.96	53,207

<b>Design</b>	Norris 0-6-32				
<b>Audit Notes:</b>					
<b>Version:</b>	<b>Phase:</b>	PROTOTYPE		<b>Tie On Depth:</b>	0.0
<b>Vertical Section:</b>	<b>Depth From (TVD) (ft)</b>	<b>+N/-S (ft)</b>	<b>+E/-W (ft)</b>	<b>Direction (°)</b>	
	0.0	0.0	0.0	273.27	

<b>Plan Sections</b>										
Measured Depth (ft)	Inclination (°)	Azimuth (°)	Vertical Depth (ft)	+N/-S (ft)	+E/-W (ft)	Dogleg Rate (°/100ft)	Build Rate (°/100ft)	Turn Rate (°/100ft)	TFO (°)	Target
0.0	0.00	0.00	0.0	0.0	0.0	0.00	0.00	0.00	0.00	
800.0	0.00	0.00	800.0	0.0	0.0	0.00	0.00	0.00	0.00	
1,461.8	13.24	273.27	1,455.9	4.3	-76.0	2.00	2.00	0.00	273.27	
6,102.2	13.24	273.27	5,973.1	64.9	-1,136.7	0.00	0.00	0.00	0.00	
6,764.0	0.00	0.00	6,629.0	69.3	-1,212.7	2.00	-2.00	0.00	180.00	
7,814.0	0.00	0.00	7,679.0	69.3	-1,212.7	0.00	0.00	0.00	0.00	Norris 0-6-32

# EnCana Corporation

## Planning Report - Geographic

<b>Database:</b>	EDM	<b>Local Co-ordinate Reference:</b>	Well Norris 0-6-32
<b>Company:</b>	DJ/Paradox/WTX	<b>TVD Reference:</b>	WELL @ 4844.0ft (Original Well Elev)
<b>Project:</b>	Wattenberg	<b>MD Reference:</b>	WELL @ 4844.0ft (Original Well Elev)
<b>Site:</b>	New Drills	<b>North Reference:</b>	True
<b>Well:</b>	Norris 0-6-32	<b>Survey Calculation Method:</b>	Minimum Curvature
<b>Wellbore:</b>	Wellbore #1		
<b>Design:</b>	Norris 0-6-32		

Planned Survey									
Measured Depth (ft)	Inclination (°)	Azimuth (°)	Vertical Depth (ft)	+N/-S (ft)	+E/-W (ft)	Map Northing (ft)	Map Easting (ft)	Latitude	Longitude
0.0	0.00	0.00	0.0	0.0	0.0	1,308,915.75	3,257,028.74	40° 10' 39.756 N	104° 34' 48.468 W
750.0	0.00	0.00	750.0	0.0	0.0	1,308,915.75	3,257,028.74	40° 10' 39.756 N	104° 34' 48.468 W
<b>Surface</b>									
800.0	0.00	0.00	800.0	0.0	0.0	1,308,915.75	3,257,028.74	40° 10' 39.756 N	104° 34' 48.468 W
1,461.8	13.24	273.27	1,455.9	4.3	-76.0	1,308,919.30	3,256,952.72	40° 10' 39.799 N	104° 34' 49.447 W
4,469.8	13.24	273.27	4,384.0	43.6	-763.6	1,308,951.43	3,256,264.76	40° 10' 40.187 N	104° 34' 58.306 W
<b>Sussex</b>									
6,102.2	13.24	273.27	5,973.1	64.9	-1,136.7	1,308,968.87	3,255,891.41	40° 10' 40.397 N	104° 35' 3.113 W
6,764.0	0.00	0.00	6,629.0	69.3	-1,212.7	1,308,972.42	3,255,815.39	40° 10' 40.440 N	104° 35' 4.092 W
6,934.0	0.00	0.00	6,799.0	69.3	-1,212.7	1,308,972.42	3,255,815.39	40° 10' 40.440 N	104° 35' 4.092 W
<b>Niobrara</b>									
7,199.0	0.00	0.00	7,064.0	69.3	-1,212.7	1,308,972.42	3,255,815.39	40° 10' 40.440 N	104° 35' 4.092 W
<b>Codell</b>									
7,664.0	0.00	0.00	7,529.0	69.3	-1,212.7	1,308,972.42	3,255,815.39	40° 10' 40.440 N	104° 35' 4.092 W
<b>J Sand</b>									
7,754.0	0.00	0.00	7,619.0	69.3	-1,212.7	1,308,972.42	3,255,815.39	40° 10' 40.440 N	104° 35' 4.092 W
<b>A Marker</b>									
7,814.0	0.00	0.00	7,679.0	69.3	-1,212.7	1,308,972.42	3,255,815.39	40° 10' 40.440 N	104° 35' 4.092 W
<b>Production - Norris 0-6-32</b>									

Design Targets									
Target Name - hit/miss target - Shape	Dip Angle (°)	Dip Dir. (°)	TVD (ft)	+N/-S (ft)	+E/-W (ft)	Northing (ft)	Easting (ft)	Latitude	Longitude
Norris 0-6-32 - plan hits target - Point	0.00	0.00	7,679.0	69.3	-1,212.7	1,308,972.42	3,255,815.39	40° 10' 40.440 N	104° 35' 4.092 W

Casing Points					
Measured Depth (ft)	Vertical Depth (ft)	Name	Casing Diameter (in)	Hole Diameter (in)	
750.0	750.0	Surface	8.625	12.250	
7,814.0	7,679.0	Production	4.500	7.785	

Formations						
Measured Depth (ft)	Vertical Depth (ft)	Name	Lithology	Dip (°)	Dip Direction (°)	
4,469.8	4,384.0	Sussex		0.00		
6,934.0	6,799.0	Niobrara		0.00		
7,199.0	7,064.0	Codell		0.00		
7,664.0	7,529.0	J Sand		0.00		
7,754.0	7,619.0	A Marker		0.00		