

SWEPI LP
DAWSON CREEK #1-25
ROUTT COUNTY, COLORADO
SECTION 25, T6N, R88W, 6th P.M.

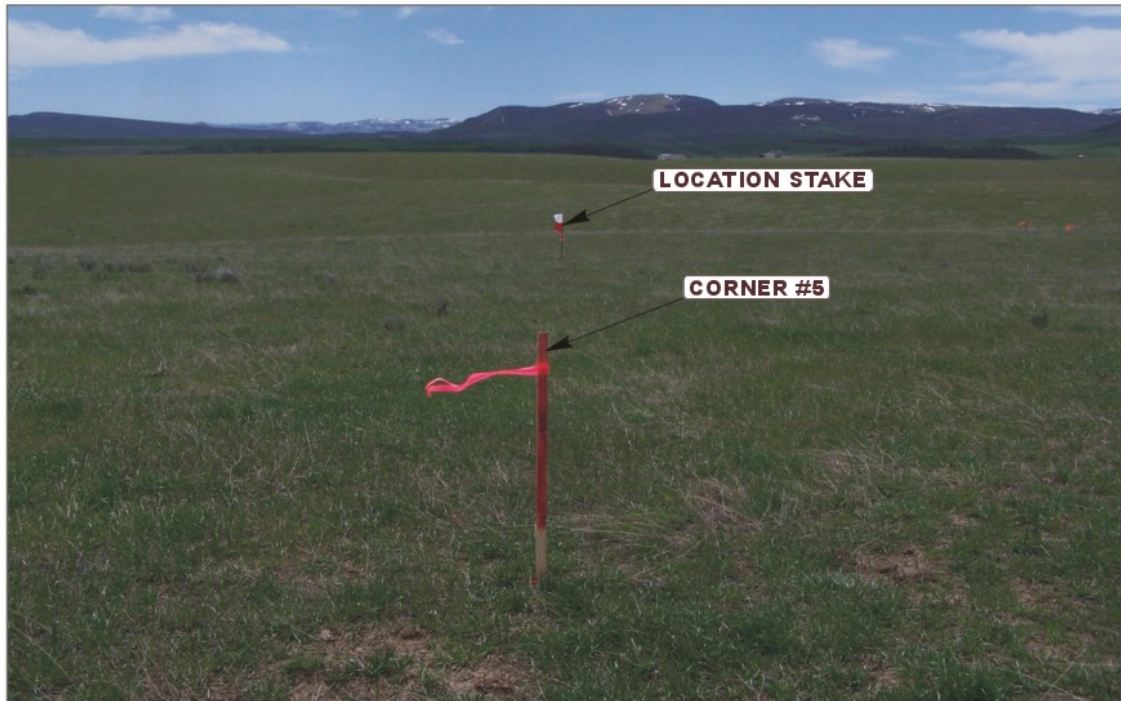

PHOTO: VIEW FROM CORNER #5 TO LOCATION STAKE

CAMERA ANGLE: SOUTHEASTERLY



PHOTO: VIEW FROM BEGINNING OF PROPOSED ACCESS

CAMERA ANGLE: NORTHEASTERLY



- Since 1964 -

UELS

Uintah Engineering & Land Surveying
85 South 200 East Vernal, Utah 84078
(435) 789-1017 * FAX (435) 789-1813

LOCATION PHOTOS

05 **24** **11**
MONTH DAY YEAR

TAKEN BY: B.H.

DRAWN BY: Z.L.

REVISED: 00-00-00

PHOTO
P1

SWEPI LP
DAWSON CREEK #1-25
ROUTT COUNTY, COLORADO
SECTION 25, T6N, R88W, 6th P.M.



PHOTO: VIEW OF LOCATION STAKE

CAMERA ANGLE: NORTHERLY



PHOTO: VIEW OF LOCATION STAKE

CAMERA ANGLE: EASTERLY



- Since 1964 -

U&E Uintah Engineering & Land Surveying
85 South 200 East Vernal, Utah 84078
(435) 789-1017 * FAX (435) 789-1813

LOCATION PHOTOS

05 **24** **11**
MONTH DAY YEAR

TAKEN BY: B.H.

DRAWN BY: Z.L.

REVISED: 00-00-00

PHOTO
P2

SWEPI LP
DAWSON CREEK #1-25
ROUTT COUNTY, COLORADO
SECTION 25, T6N, R88W, 6th P.M.

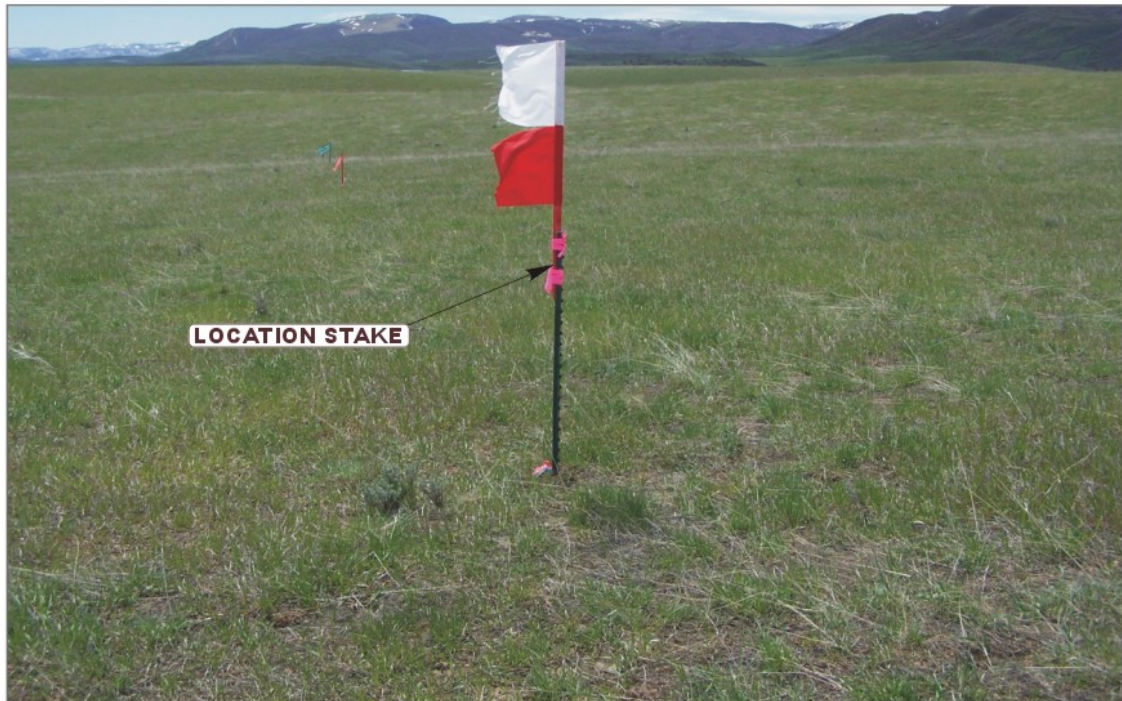

PHOTO: VIEW OF LOCATION STAKE

CAMERA ANGLE: SOUTHERLY



PHOTO: VIEW OF LOCATION STAKE

CAMERA ANGLE: WESTERLY



- Since 1964 -

**U
E
L
S**

Uintah Engineering & Land Surveying
85 South 200 East Vernal, Utah 84078
(435) 789-1017 * FAX (435) 789-1813

LOCATION PHOTOS

05 **24** **11**
MONTH DAY YEAR

TAKEN BY: B.H.

DRAWN BY: Z.L.

REVISED: 00-00-00

PHOTO
P3