

REFERENCE INFORMATION

Co-ordinate (NE) Reference: Well Norris 24-32, True North
Vertical (TVD) Reference: WELL @ 4844.0ft (Original Well Elev)
Section (VS) Reference: Slot - (0.0N, 0.0E)
Measured Depth Reference: WELL @ 4844.0ft (Original Well Elev)
Calculation Method:

WELL DETAILS: Norris 24-32

+N/-S	+E/-W	Northing	Ground Level:	4831.0	Longitude	Slot
0.0	0.0	1308939.07	Easting	3257028.49	40° 10' 39.986 N	04° 34' 48.468 W

SECTION DETAILS

Sec	MD	Inc	Azi	TVD	+N/-S	+E/-W	DLeg	TFace	VSec	Target
1	0.0	0.00	0.00	0.0	0.0	0.0	0.00	0.00	0.0	
2	800.0	0.00	0.00	800.0	0.0	0.0	0.00	0.00	0.0	
3	1392.9	11.86	131.82	1388.7	-40.8	45.6	2.00	131.82	61.1	
4	6125.5	11.86	131.82	6020.3	-689.2	770.4	0.00	0.00	1033.7	
5	6718.5	0.00	0.00	6609.0	-730.0	815.9	2.00	180.00	1094.8	
6	7768.5	0.00	0.00	7659.0	-730.0	815.9	0.00	0.00	1094.8	Norris 24-32

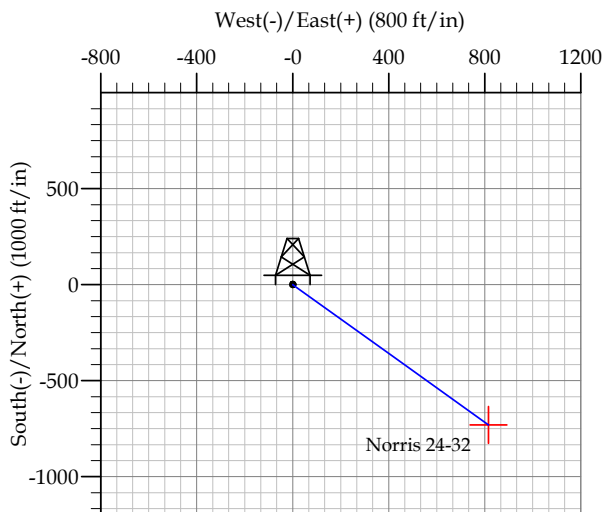

FORMATION TOP DETAILS

TVDPath	MDPath	Formation
5294.0	5383.4	Sussex
6774.0	6883.5	Niobrara
7074.0	7183.5	Codell
7509.0	7618.5	J Sand
7599.0	7708.5	A Marker

CASING DETAILS

TVD	MD	Name	Size
750.0	750.0	Surface	8.625
7659.0	7768.5	Production	4.500

EnCana Corporation

Planning Report - Geographic

Database:	EDM	Local Co-ordinate Reference:	Well Norris 24-32
Company:	DJ/Paradox/WTX	TVD Reference:	WELL @ 4844.0ft (Original Well Elev)
Project:	Wattenberg	MD Reference:	WELL @ 4844.0ft (Original Well Elev)
Site:	New Drills	North Reference:	True
Well:	Norris 24-32	Survey Calculation Method:	Minimum Curvature
Wellbore:	Norris 24-32		
Design:	Norris 24-32		

Project	Wattenberg,		
Map System:	US State Plane 1983	System Datum:	Mean Sea Level
Geo Datum:	North American Datum 1983		
Map Zone:	Colorado Northern Zone		

Site		New Drills				
Site Position:		Northing:	1,278,589.08ft	Latitude:	40° 5' 49.848 N	
From:	Lat/Long	Easting:	3,130,247.44ft	Longitude:	105° 2' 3.912 W	
Position Uncertainty:		ft	Slot Radius:	in	Grid Convergence:	0.30 °

Well	Norris 24-32					
Well Position	+N-S	29,033.3 ft	Northing:	1,308,939.07 ft	Latitude:	40° 10' 39.986 N
	+E-W	127,089.3 ft	Easting:	3,257,028.49 ft	Longitude:	104° 34' 48.468 W
Position Uncertainty		ft	Wellhead Elevation:	ft	Ground Level:	4,831.0 ft

Wellbore	Norris 24-32				
Magnetics	Model Name	Sample Date	Declination (°)	Dip Angle (°)	Field Strength (nT)
	IGRF200510	12/31/2009	8.90	66.96	53,207

Design	Norris 24-32				
Audit Notes:					
Version:	Phase:	PROTOTYPE	Tie On Depth:	0.0	
Vertical Section:	Depth From (TVD) (ft)	+N/-S (ft)	+E/-W (ft)	Direction (°)	
	0.0	0.0	0.0	131.82	

Plan Sections										
Measured Depth (ft)	Inclination (°)	Azimuth (°)	Vertical Depth (ft)	+N/-S (ft)	+E/-W (ft)	Dogleg Rate (°/100ft)	Build Rate (°/100ft)	Turn Rate (°/100ft)	TFO (°)	Target
0.0	0.00	0.00	0.0	0.0	0.0	0.00	0.00	0.00	0.00	
800.0	0.00	0.00	800.0	0.0	0.0	0.00	0.00	0.00	0.00	
1,392.9	11.86	131.82	1,388.7	-40.8	45.6	2.00	2.00	0.00	131.82	
6,125.5	11.86	131.82	6,020.3	-689.2	770.4	0.00	0.00	0.00	0.00	
6,718.5	0.00	0.00	6,609.0	-730.0	815.9	2.00	-2.00	0.00	180.00	
7,768.5	0.00	0.00	7,659.0	-730.0	815.9	0.00	0.00	0.00	0.00	Norris 24-32

EnCana Corporation

Planning Report - Geographic

Database:	EDM	Local Co-ordinate Reference:	Well Norris 24-32
Company:	DJ/Paradox/WTX	TVD Reference:	WELL @ 4844.0ft (Original Well Elev)
Project:	Wattenberg	MD Reference:	WELL @ 4844.0ft (Original Well Elev)
Site:	New Drills	North Reference:	True
Well:	Norris 24-32	Survey Calculation Method:	Minimum Curvature
Wellbore:	Norris 24-32		
Design:	Norris 24-32		

Planned Survey										
Measured Depth (ft)	Inclination (°)	Azimuth (°)	Vertical Depth (ft)	+N/-S (ft)	+E/-W (ft)	Map Northing (ft)	Map Easting (ft)	Latitude	Longitude	
0.0	0.00	0.00	0.0	0.0	0.0	1,308,939.07	3,257,028.49	40° 10' 39.986 N	104° 34' 48.468 W	
750.0	0.00	0.00	750.0	0.0	0.0	1,308,939.07	3,257,028.49	40° 10' 39.986 N	104° 34' 48.468 W	
Surface										
800.0	0.00	0.00	800.0	0.0	0.0	1,308,939.07	3,257,028.49	40° 10' 39.986 N	104° 34' 48.468 W	
1,392.9	11.86	131.82	1,388.7	-40.8	45.6	1,308,898.77	3,257,074.48	40° 10' 39.583 N	104° 34' 47.881 W	
5,383.4	11.86	131.82	5,294.0	-587.5	656.7	1,308,358.37	3,257,691.27	40° 10' 34.180 N	104° 34' 40.007 W	
Sussex										
6,125.5	11.86	131.82	6,020.3	-689.2	770.4	1,308,257.86	3,257,805.97	40° 10' 33.175 N	104° 34' 38.543 W	
6,718.5	0.00	0.00	6,609.0	-730.0	815.9	1,308,217.57	3,257,851.96	40° 10' 32.772 N	104° 34' 37.956 W	
6,883.5	0.00	0.00	6,774.0	-730.0	815.9	1,308,217.57	3,257,851.96	40° 10' 32.772 N	104° 34' 37.956 W	
Niobrara										
7,183.5	0.00	0.00	7,074.0	-730.0	815.9	1,308,217.57	3,257,851.96	40° 10' 32.772 N	104° 34' 37.956 W	
Codell										
7,618.5	0.00	0.00	7,509.0	-730.0	815.9	1,308,217.57	3,257,851.96	40° 10' 32.772 N	104° 34' 37.956 W	
J Sand										
7,708.5	0.00	0.00	7,599.0	-730.0	815.9	1,308,217.57	3,257,851.96	40° 10' 32.772 N	104° 34' 37.956 W	
A Marker										
7,768.5	0.00	0.00	7,659.0	-730.0	815.9	1,308,217.57	3,257,851.96	40° 10' 32.772 N	104° 34' 37.956 W	
Production - Norris 24-32										

Design Targets										
Target Name	Dip Angle (°)	Dip Dir. (°)	TVD (ft)	+N/-S (ft)	+E/-W (ft)	Northing (ft)	Easting (ft)	Latitude	Longitude	
- hit/miss target										
- Shape										
Norris 24-32	0.00	0.00	7,659.0	-730.0	815.9	1,308,217.57	3,257,851.96	40° 10' 32.772 N	104° 34' 37.956 W	
- plan hits target										
- Point										

Casing Points					
Measured Depth (ft)	Vertical Depth (ft)	Name	Casing Diameter (in)	Hole Diameter (in)	
750.0	750.0	Surface	8.625	12.250	
7,768.5	7,659.0	Production	4.500	7.785	

Formations						
Measured Depth (ft)	Vertical Depth (ft)	Name	Lithology	Dip (°)	Dip Direction (°)	
5,383.4	5,294.0	Sussex		0.00		
6,883.5	6,774.0	Niobrara		0.00		
7,183.5	7,074.0	Codell		0.00		
7,618.5	7,509.0	J Sand		0.00		
7,708.5	7,599.0	A Marker		0.00		