

REFERENCE INFORMATION										
Co-ordinate (NE) Reference: Well Norris 13-32, True North										
Vertical (TVD) Reference: WELL @ 4844.0ft (Original Well Elev)										
Section (VS) Reference: Slot - (0.0N, 0.0E)										
Measured Depth Reference: WELL @ 4844.0ft (Original Well Elev)										
Calculation Method:										
WELL DETAILS: Norris 13-32										
+N/-S	+E/-W	Northing		Ground Level: 4831.0		Latitude		Longitude		Slot
0.0	0.0	1308948.54		3257028.40		40° 10' 40.080 N		04° 34' 48.468 W		
SECTION DETAILS										
Sec	MD	Inc	Azi	TVD	+N/-S	+E/-W	DLeg	TFace	VSec	Target
1	0.0	0.00	0.00	0.0	0.0	0.0	0.00	0.00	0.0	
2	800.0	0.00	0.00	800.0	0.0	0.0	0.00	0.00	0.0	
3	1407.6	12.15	321.15	1403.0	50.0	-40.3	2.00	321.15	64.2	
4	6108.8	12.15	321.15	5999.0	820.7	-661.1	0.00	0.00	1053.8	
5	6716.4	0.00	0.00	6602.0	870.7	-701.3	2.00	180.00	1118.0	
6	7766.4	0.00	0.00	7652.0	870.7	-701.3	0.00	0.00	1118.0	Norris 13-32

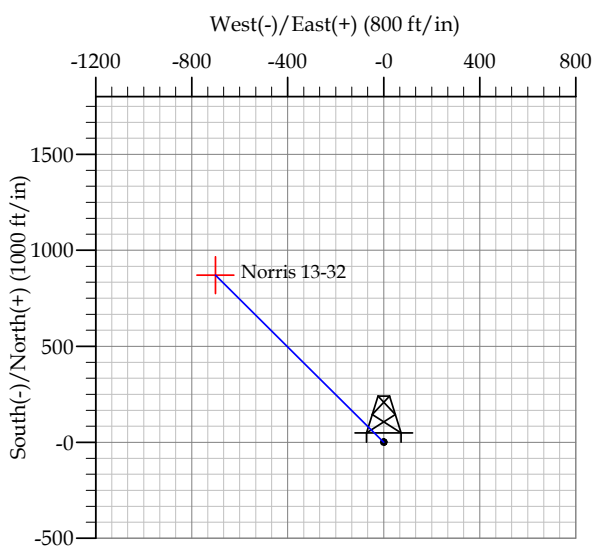

FORMATION TOP DETAILS			
TVDPath	MDPath	Formation	
5249.0	5341.7	Sussex	
6844.0	6958.4	Niobrara	
7062.0	7176.4	Codell	
7502.0	7616.4	J Sand	
7592.0	7706.4	A Marker	
CASING DETAILS			
TVD	MD	Name	Size
750.0	750.0	Surface	8.625
7652.0	7766.4	Production	4.500

# EnCana Corporation

## Planning Report - Geographic

<b>Database:</b>	EDM	<b>Local Co-ordinate Reference:</b>	Well Norris 13-32
<b>Company:</b>	DJ/Paradox/WTX	<b>TVD Reference:</b>	WELL @ 4844.0ft (Original Well Elev)
<b>Project:</b>	Wattenberg	<b>MD Reference:</b>	WELL @ 4844.0ft (Original Well Elev)
<b>Site:</b>	New Drills	<b>North Reference:</b>	True
<b>Well:</b>	Norris 13-32	<b>Survey Calculation Method:</b>	Minimum Curvature
<b>Wellbore:</b>	Wellbore #1		
<b>Design:</b>	Norris 13-32		

<b>Project</b>	Wattenberg,		
<b>Map System:</b>	US State Plane 1983	<b>System Datum:</b>	Mean Sea Level
<b>Geo Datum:</b>	North American Datum 1983		
<b>Map Zone:</b>	Colorado Northern Zone		

Site	New Drills				
Site Position:		Northing:	1,278,589.08ft	Latitude:	40° 5' 49.848 N
From:	Lat/Long	Easting:	3,130,247.44ft	Longitude:	105° 2' 3.912 W
Position Uncertainty:	ft	Slot Radius:	in	Grid Convergence:	0.30 °

Well	Norris 13-32					
Well Position	+N-S	29,042.7 ft	Northing:	1,308,948.54 ft	Latitude:	40° 10' 40.080 N
	+E-W	127,089.3 ft	Easting:	3,257,028.40 ft	Longitude:	104° 34' 48.468 W
Position Uncertainty		ft	Wellhead Elevation:	ft	Ground Level:	4,831.0 ft

<b>Wellbore</b>	Wellbore #1				
<b>Magnetics</b>	<b>Model Name</b>	<b>Sample Date</b>	<b>Declination (°)</b>	<b>Dip Angle (°)</b>	<b>Field Strength (nT)</b>
	IGRF200510	12/31/2009	8.90	66.96	53,207

<b>Design</b>	Norris 13-32				
<b>Audit Notes:</b>					
<b>Version:</b>	<b>Phase:</b>	PROTOTYPE	<b>Tie On Depth:</b>	0.0	
<b>Vertical Section:</b>	<b>Depth From (TVD)</b>	<b>+N/-S</b>	<b>+E/-W</b>	<b>Direction</b>	
	(ft)	(ft)	(ft)	(°)	
	0.0	0.0	0.0	321.15	

Plan Sections											
Measured											
Depth	Inclination	Azimuth	Vertical	+N/-S	+E/-W	Dogleg	Build	Turn	TFO	Target	
(ft)	(°)	(°)	Depth	(ft)	(ft)	Rate	Rate	Rate	(°)		
			(ft)			(°/100ft)	(°/100ft)	(°/100ft)			
0.0	0.00	0.00	0.0	0.0	0.0	0.00	0.00	0.00	0.00		
800.0	0.00	0.00	800.0	0.0	0.0	0.00	0.00	0.00	0.00		
1,407.6	12.15	321.15	1,403.0	50.0	-40.3	2.00	2.00	0.00	321.15		
6,108.8	12.15	321.15	5,999.0	820.7	-661.1	0.00	0.00	0.00	0.00		
6,716.4	0.00	0.00	6,602.0	870.7	-701.3	2.00	-2.00	0.00	180.00		
7,766.4	0.00	0.00	7,652.0	870.7	-701.3	0.00	0.00	0.00	0.00	Norris 13-32	

# EnCana Corporation

## Planning Report - Geographic

<b>Database:</b>	EDM	<b>Local Co-ordinate Reference:</b>	Well Norris 13-32
<b>Company:</b>	DJ/Paradox/WTX	<b>TVD Reference:</b>	WELL @ 4844.0ft (Original Well Elev)
<b>Project:</b>	Wattenberg	<b>MD Reference:</b>	WELL @ 4844.0ft (Original Well Elev)
<b>Site:</b>	New Drills	<b>North Reference:</b>	True
<b>Well:</b>	Norris 13-32	<b>Survey Calculation Method:</b>	Minimum Curvature
<b>Wellbore:</b>	Wellbore #1		
<b>Design:</b>	Norris 13-32		

Planned Survey									
Measured Depth (ft)	Inclination (°)	Azimuth (°)	Vertical Depth (ft)	+N/-S (ft)	+E/-W (ft)	Map Northing (ft)	Map Easting (ft)	Latitude	Longitude
0.0	0.00	0.00	0.0	0.0	0.0	1,308,948.54	3,257,028.40	40° 10' 40.080 N	104° 34' 48.468 W
750.0	0.00	0.00	750.0	0.0	0.0	1,308,948.54	3,257,028.40	40° 10' 40.080 N	104° 34' 48.468 W
Surface									
800.0	0.00	0.00	800.0	0.0	0.0	1,308,948.54	3,257,028.40	40° 10' 40.080 N	104° 34' 48.468 W
1,407.6	12.15	321.15	1,403.0	50.0	-40.3	1,308,998.10	3,256,987.61	40° 10' 40.574 N	104° 34' 48.987 W
5,341.7	12.15	321.15	5,249.0	694.9	-559.8	1,309,637.60	3,256,461.46	40° 10' 46.947 N	104° 34' 55.680 W
Sussex									
6,108.8	12.15	321.15	5,999.0	820.7	-661.1	1,309,762.30	3,256,358.86	40° 10' 48.190 N	104° 34' 56.985 W
6,716.4	0.00	0.00	6,602.0	870.7	-701.3	1,309,811.87	3,256,318.07	40° 10' 48.684 N	104° 34' 57.504 W
6,958.4	0.00	0.00	6,844.0	870.7	-701.3	1,309,811.87	3,256,318.07	40° 10' 48.684 N	104° 34' 57.504 W
Niobrara									
7,176.4	0.00	0.00	7,062.0	870.7	-701.3	1,309,811.87	3,256,318.07	40° 10' 48.684 N	104° 34' 57.504 W
Codell									
7,616.4	0.00	0.00	7,502.0	870.7	-701.3	1,309,811.87	3,256,318.07	40° 10' 48.684 N	104° 34' 57.504 W
J Sand									
7,706.4	0.00	0.00	7,592.0	870.7	-701.3	1,309,811.87	3,256,318.07	40° 10' 48.684 N	104° 34' 57.504 W
A Marker									
7,766.4	0.00	0.00	7,652.0	870.7	-701.3	1,309,811.87	3,256,318.07	40° 10' 48.684 N	104° 34' 57.504 W
Production - Norris 13-32									

Design Targets										
Target Name	Dip Angle (°)	Dip Dir. (°)	TVD (ft)	+N/-S (ft)	+E/-W (ft)	Northing (ft)	Easting (ft)	Latitude	Longitude	
Norris 13-32	0.00	0.00	7,652.0	870.7	-701.3	1,309,811.87	3,256,318.07	40° 10' 48.684 N	104° 34' 57.504 W	
- hit/miss target										
- Shape										
- Point										

Casing Points					
Measured Depth (ft)	Vertical Depth (ft)	Name	Casing Diameter (in)	Hole Diameter (in)	
750.0	750.0	Surface	8.625	12.250	
7,766.4	7,652.0	Production	4.500	7.785	

Formations						
Measured Depth (ft)	Vertical Depth (ft)	Name	Lithology	Dip (°)	Dip Direction (°)	
5,341.7	5,249.0	Sussex		0.00		
6,958.4	6,844.0	Niobrara		0.00		
7,176.4	7,062.0	Codell		0.00		
7,616.4	7,502.0	J Sand		0.00		
7,706.4	7,592.0	A Marker		0.00		