

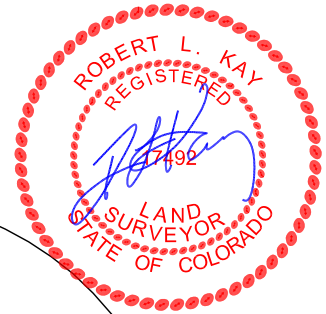

EOG RESOURCES, INC.
ADDENDUM TO LEGAL PLAT FOR
DUTCH LAKE 12-14H
SECTION 14, T6N, R62W, 6th. P.M.
501' FSL 1200' FWL

SCALE: 1" = 200'
DATE: 3-9-11
DRAWN BY: S.R.L.



400' Offset
from Edge of
Disturbance

Well Head DUTCH LAKE #12-14H
(NAD 83)
Lat: 40.481650°
Long: 104.294269°

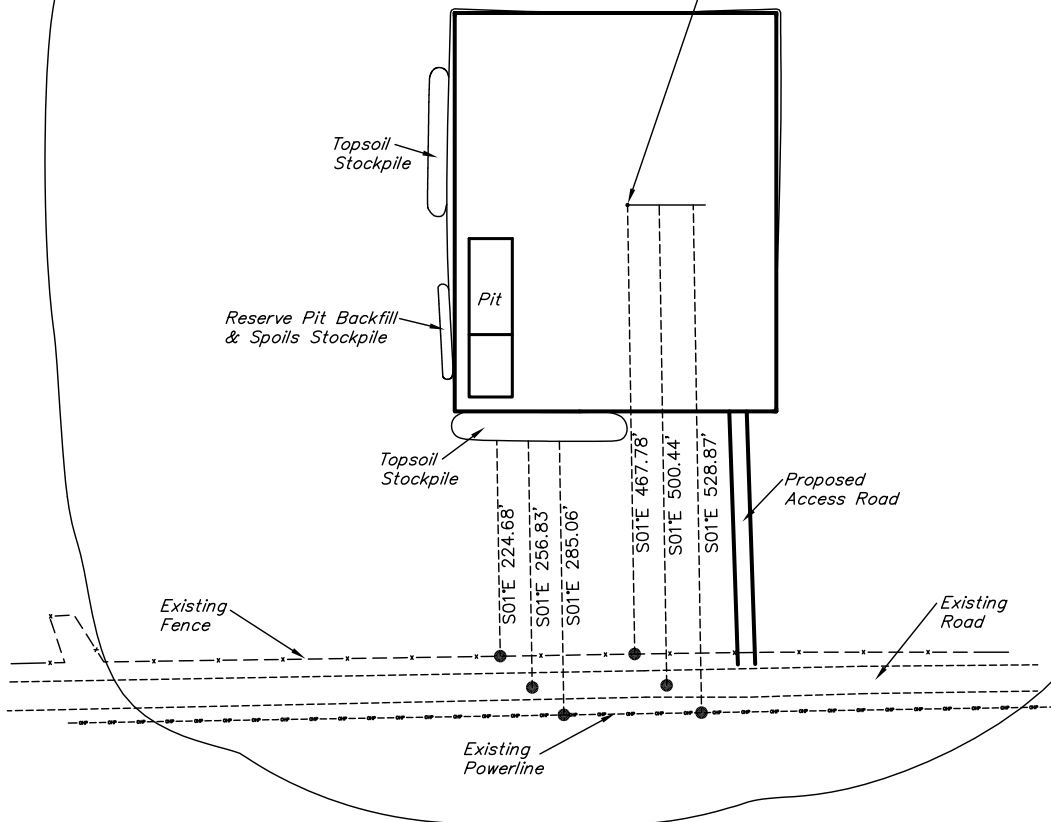

EOG RESOURCES, INC.

CONSTRUCTION LAYOUT FOR

DUTCH LAKE 12-14H
SECTION 14, T6N, R62W, 6th. P.M.
501' FSL 1200' FWL

FIGURE #1

SCALE: 1" = 60'

DATE: 3-9-11

DRAWN BY: S.R.L.

The diagram illustrates the construction layout for Dutch Lake 12-14H, Section 14, T6N, R62W, 6th. P.M. The layout includes several key features and dimensions:

- Topsoil Stockpile:** Located at the top left, with an elevation of 23.0' (C-2.8').
- FLARE PIT (4' Deep):** A 40' x 30' pit located near the center, with a note stating it is to be located a minimum of 100' from the Well Head.
- RESERVE PITS (3' Deep):** A large rectangular pit with a 1 1/2:1 slope, measuring 100' x 45', with a total capacity of 3,380 Bbls. ± and a total volume of 700 Cu. Yds. It is located at an elevation of 21.0' (C-0.8').
- Topsoil Stockpile:** Located at the bottom left, with an elevation of 20.0' (F-0.2').
- Proposed Access Road:** Indicated at the bottom right.
- Survey Points and Elevations:**
 - Point 6: El. 23.0' (C-2.8')
 - Point 7: El. 20.7' (C-0.5')
 - Point 8: El. 17.4' (F-2.8')
 - Point 5: El. 25.7' (C-5.5')
 - Point 4: El. 20.0' (F-0.2')
 - Point 3: El. 20.5' (C-0.3')
 - Point 2: El. 19.7' (F-0.5')
 - Point 1: El. 18.3' (F-1.9')
 - Point 0: El. 20.2' (GRADE)
 - Point A: El. 20.6' (C-3.4') (Btm. Pit)
 - Point B: El. 25.2' (C-8.0') (Btm. Pit)
 - Point C: El. 23.9' (C-3.7')
 - Point D: El. 21.0' (C-0.8')
- Distances and Dimensions:**
 - 180' horizontal distance between points 6 and 7.
 - 155' horizontal distance between points 7 and 1.
 - 120' horizontal distance between points 5 and 4.
 - 215' vertical distance between points 5 and 4.
 - 40' width of the Flare Pit.
 - 30' depth of the Flare Pit.
 - 45' width of the Reserve Pits.
 - 100' length of the Reserve Pits.
 - 65' depth of the Reserve Pits.
 - 3' High Berm around the Reserve Pits.
- Other Features:**
 - Approx. Top of Cut Slope (indicated by a dashed line).
 - Approx. Toe of Fill Slope (indicated by a dashed line).
 - Cut/Fill Transition Line (indicated by a dashed line).
 - AREA OF MAX. DISTURBANCE (indicated by a dashed line).
 - Topsoil Stockpile (indicated by a dashed line).
 - Reserve Pit Backfill & Spoils Stockpile (indicated by a dashed line).
 - Proposed Access Road (indicated by a dashed line).

Surveyor's Seal: ROBERT L. KAY, REGISTERED LAND SURVEYOR, STATE OF COLORADO, No. 47492.

Notes:

- NOTE: Flare Pit is to be located a min. of 100' from the Well Head.
- NOTE: Reserve Pits (3' Deep) 1 1/2:1 Slope.

Stations: Sta. 4+15, Sta. 2+15, Sta. 1+00, Sta. 0+00.

Legend:

- Prevailing Winds (indicated by arrows).
- Approx. Top of Cut Slope (indicated by a dashed line).
- Approx. Toe of Fill Slope (indicated by a dashed line).
- Cut/Fill Transition Line (indicated by a dashed line).
- AREA OF MAX. DISTURBANCE (indicated by a dashed line).
- Topsoil Stockpile (indicated by a dashed line).
- Reserve Pit Backfill & Spoils Stockpile (indicated by a dashed line).
- Proposed Access Road (indicated by a dashed line).

Elev. Ungraded Ground At Loc. Stake = 4720.2'
FINISHED GRADE ELEV. AT LOC. STAKE = 4720.2'

UINTAH ENGINEERING & LAND SURVEYING
85 So. 200 East * Vernal, Utah 84078 * (435) 789-1017

UINTAH ENGINEERING & LAND SURVEYING
85 So. 200 East * Vernal, Utah 84078 * (435) 789-1017

EOG RESOURCES, INC.

CONSTRUCTION LAYOUT CROSS SECTIONS FOR DUTCH LAKE 12-14H SECTION 14, T6N, R62W, 6th. P.M. 501' FSL 1200' FWL

FIGURE #2

1" = 40'
X-Section
Scale
1" = 100'
DATE: 3-9-11
DRAWN BY: S.R.L.

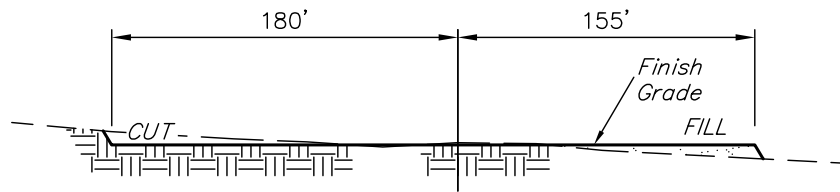

STA. 4+15

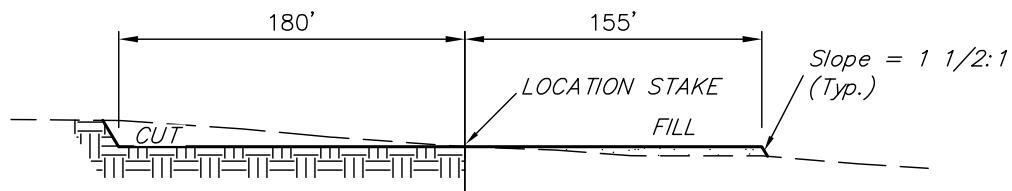

STA. 2+15

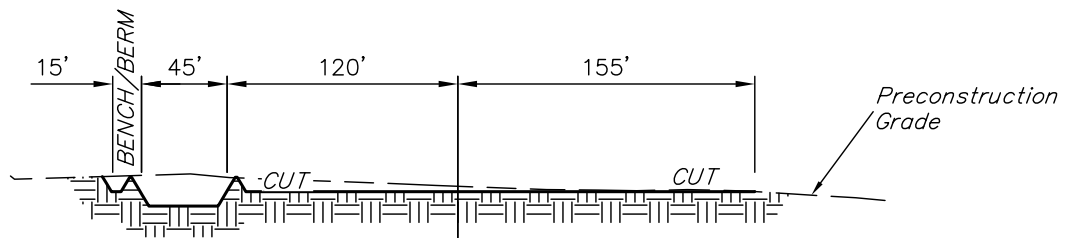

STA. 1+00

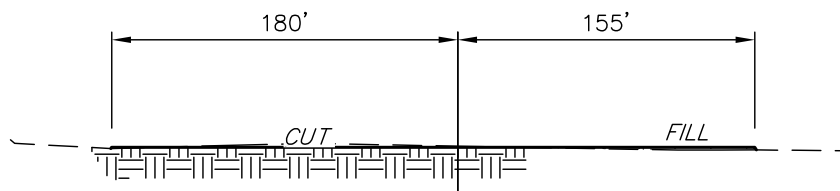

STA. 0+00

NOTE:

Topsoil should not be Stripped Below Finished Grade on Substructure Area.

APPROXIMATE ACREAGES

WELL SITE DISTURBANCE = ± 4.028 ACRES
ACCESS ROAD DISTURBANCE = ± 0.180 ACRES
TOTAL = ± 4.208 ACRES

* NOTE:
FILL QUANTITY INCLUDES 5% FOR COMPACTION

APPROXIMATE YARDAGES

(6") Topsoil Stripping = 2,690 Cu. Yds.
Remaining Location = 4,650 Cu. Yds.
TOTAL CUT = 7,340 CU.YDS.
FILL = 4,300 CU.YDS.

EXCESS MATERIAL = 3,040 Cu. Yds.
Topsoil & Pit Backfill = 3,040 Cu. Yds.
(1/2 Pit Vol.)
EXCESS UNBALANCE = 0 Cu. Yds.
(After Interim Rehabilitation)

UINTAH ENGINEERING & LAND SURVEYING
85 So. 200 East * Vernal, Utah 84078 * (435) 789-1017



EOG RESOURCES, INC.
TYPICAL RIG LAYOUT FOR
DUTCH LAKE 12-14H
SECTION 14, T6N, R62W, 6th. P.M.
501' FSL 1200' FWL

FIGURE #3

SCALE: 1" = 60'
DATE: 3-9-11
DRAWN BY: S.R.L.

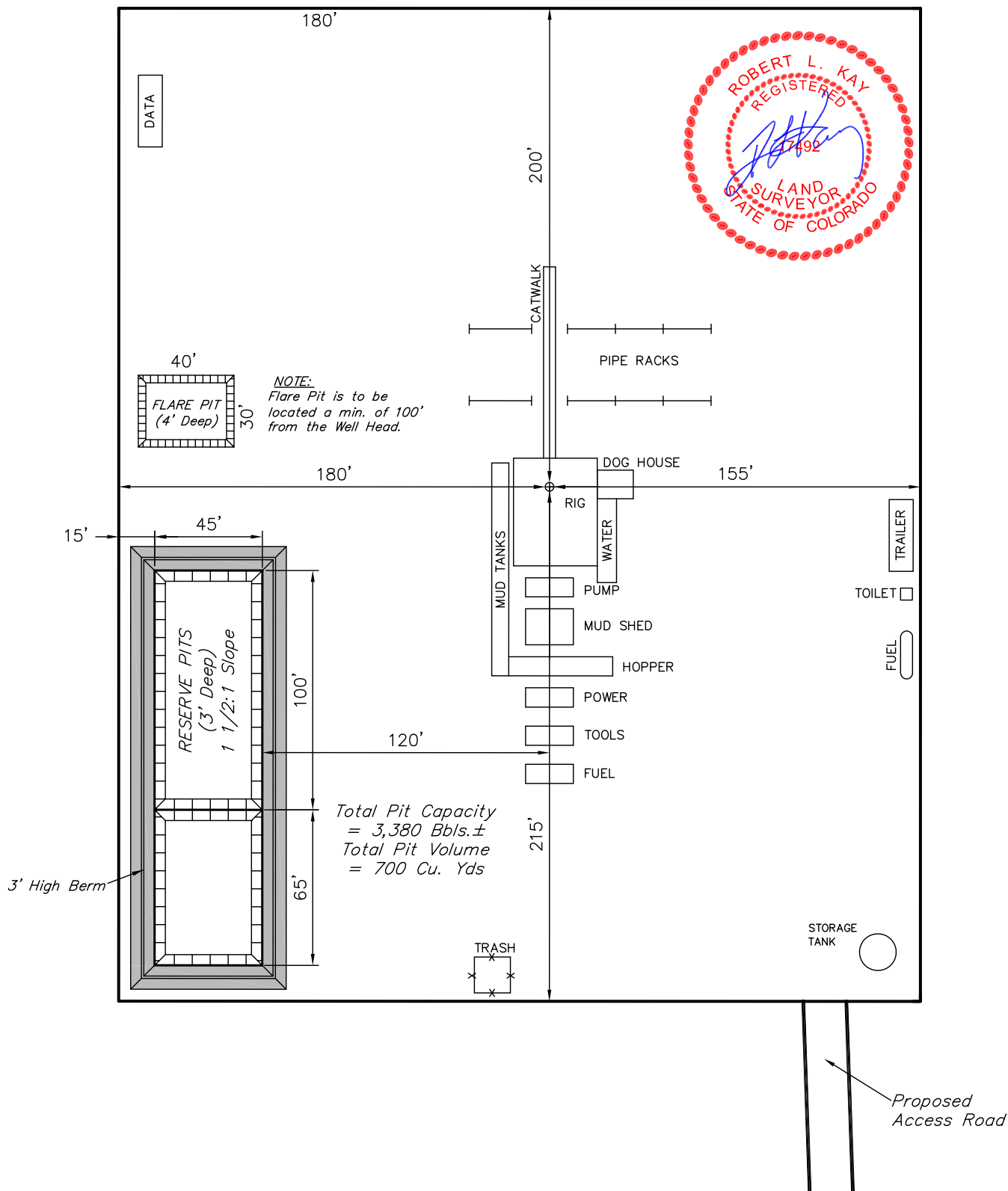



EOG RESOURCES, INC.
RECLAMATION DIAGRAM FOR
DUTCH LAKE 12-14H
SECTION 14, T6N, R62W, 6th. P.M.
501' FSL 1200' FWL

FIGURE #4
SCALE: 1" = 60'
DATE: 3-9-11
DRAWN BY: S.R.L.

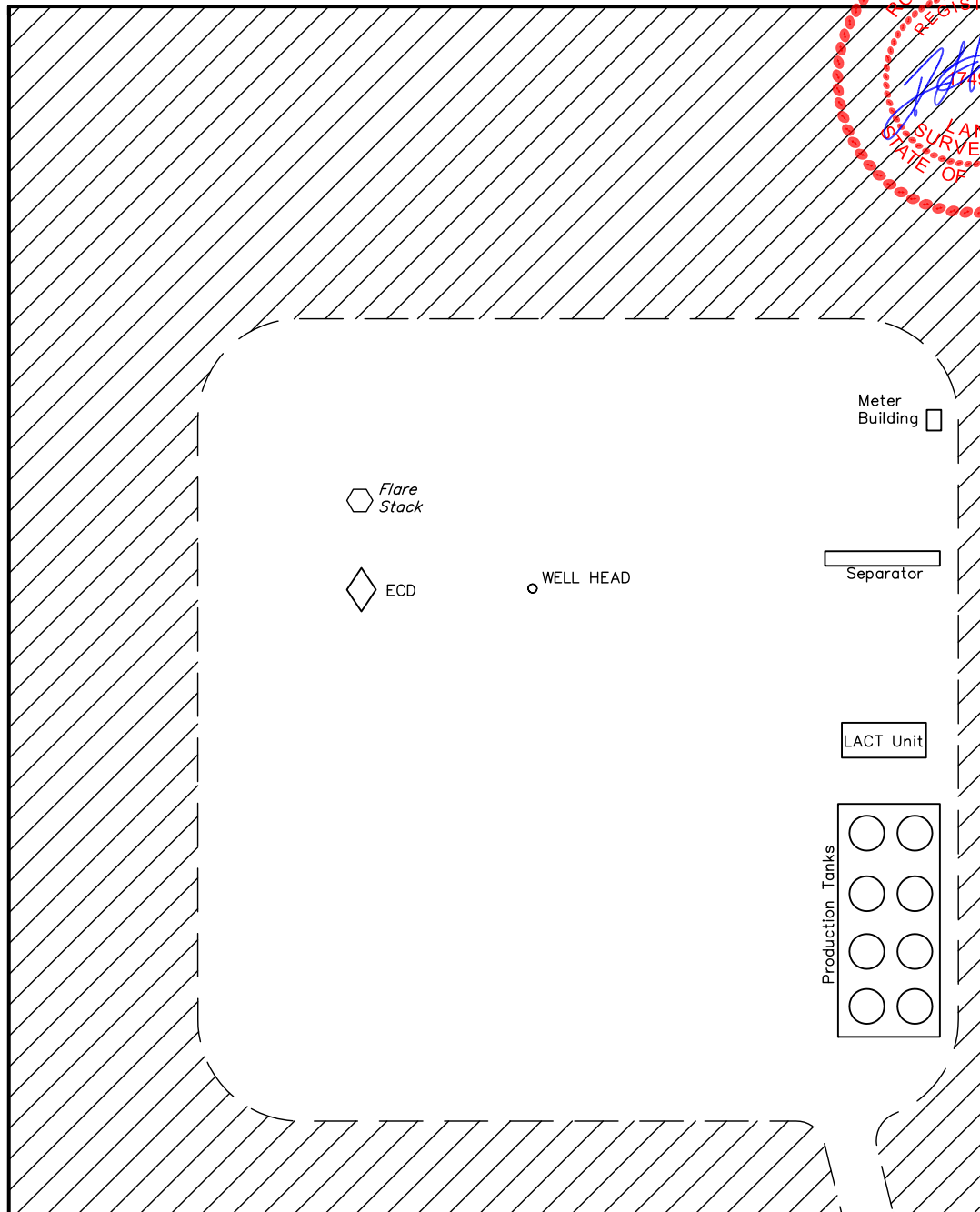
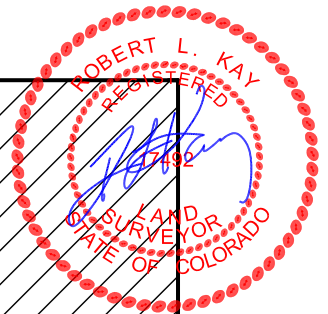

APPROXIMATE ACREAGES
UN-RECLAIMED = ± 1.644 ACRES

Access Road

 RECLAIMED AREA

UINTAH ENGINEERING & LAND SURVEYING
85 So. 200 East * Vernal, Utah 84078 * (435) 789-1017

EOG RESOURCES, INC.

LOCATION DRAWING FOR
DUTCH LAKE #12-14H
SECTION 14, T6N, R62W, 6th. P.M.
501' FSL 1200' FWL

FIGURE #5



NW COR SEC 14
1996 Alum. Cap,
0.3' Below Ground
LS#12374
Lat: 40.494447°
Long: 104.298475°

1996 Alum. Cap,
0.5' Below Ground
LS#12374
Lat: 40.487333°
Long: 104.298536°

1/4 Section Line

14

Section Line

1/16 Section Line

LINE TABLE			
LINE	FEATURE	DIRECTION	LENGTH
L1	COUNTY ROAD	S01°E	500.96'
L2	POWER LINE	S01°E	529.98'
L3	PROPERTY LINE	S01°E	500.96'

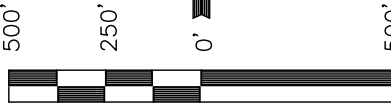

SCALE
DATE: 03-09-11
DRAWN BY: S.R.L.

1/16 Section Line

CARL R.
HALE

CARL R.
HALE

1996 Private Alum. Cap,
1.3' Below Gravel Road
LS#12374
Lat: 40.480219°
Long: 104.298594°

1996 Private Alum. Cap,
1.2' Below Gravel Road
LS#12374
Lat: 40.480336°
Long: 104.289358°

SE COR SEC 14
1996 Alum. Cap,
0.5' Below Ground
LS#12374
Lat: 40.480447°
Long: 104.280119°

County Road #68
S89°05'43"W - 2570.96' (Meas.)

S89°06'07"W
2570.89' (Meas.)

PLANT COMMUNITY

- ☐ DISTURBED GRASSLAND
- ☐ NATIVE GRASSLAND
- ☐ SHRUB LAND
- ☐ PLAINS RIPARIAN
- ☐ MOUNTAIN RIPARIAN
- ☐ FOREST LAND
- ☐ WETLANDS AQUATIC
- ☐ ALPINE
- ☐ OTHER (Describe): _____

CURRENT LAND USE

- CROP LAND: ☐ IRRIGATED ☐ DRY LAND ☐ IMPROVED PASTURE ☐ HAY MEADOW ☐ CRP
- NON-CROP LAND: ☐ RANGELAND ☐ TIMBER ☐ RECREATIONAL ☐ OTHER (Describe) _____
- SUBDIVIDED: ☐ INDUSTRIAL ☐ COMMERCIAL ☐ RESIDENTIAL _____

FUTURE LAND USE

- CROP LAND: ☐ IRRIGATED ☐ DRY LAND ☐ IMPROVED PASTURE ☐ HAY MEADOW ☐ CRP
- NON-CROP LAND: ☐ RANGELAND ☐ TIMBER ☐ RECREATIONAL ☐ OTHER (Describe) _____
- SUBDIVIDED: ☐ INDUSTRIAL ☐ COMMERCIAL ☐ RESIDENTIAL _____