

EOG RESOURCES, INC.

ADDENDUM TO LEGAL PLAT FOR

SNOW DRAW #05-07H
SECTION 7, T8N, R60W, 6th P.M.
501' FSL 501' FEL

SCALE: 1" = 200'

DATE: 03-01-11

DRAWN BY: K.O.

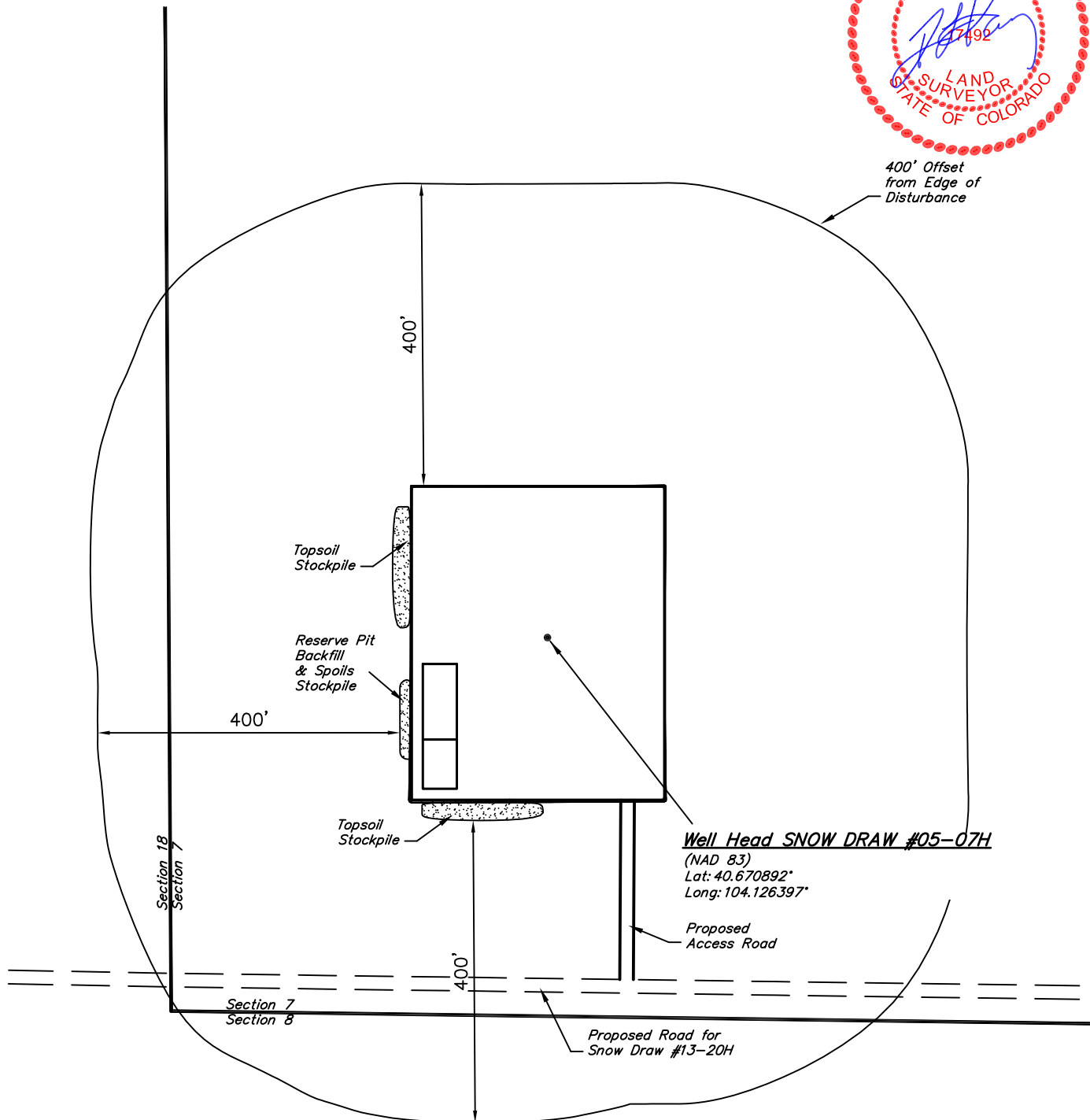

EOG RESOURCES, INC.

CONSTRUCTION LAYOUT FOR

SNOW DRAW #05-07H

SECTION 7, T8N, R60W, 6th P.M.

501' FSL 501' FEL

FIGURE #1

SCALE: 1" = 60'

DATE: 03-01-11

DRAWN BY: K.O.

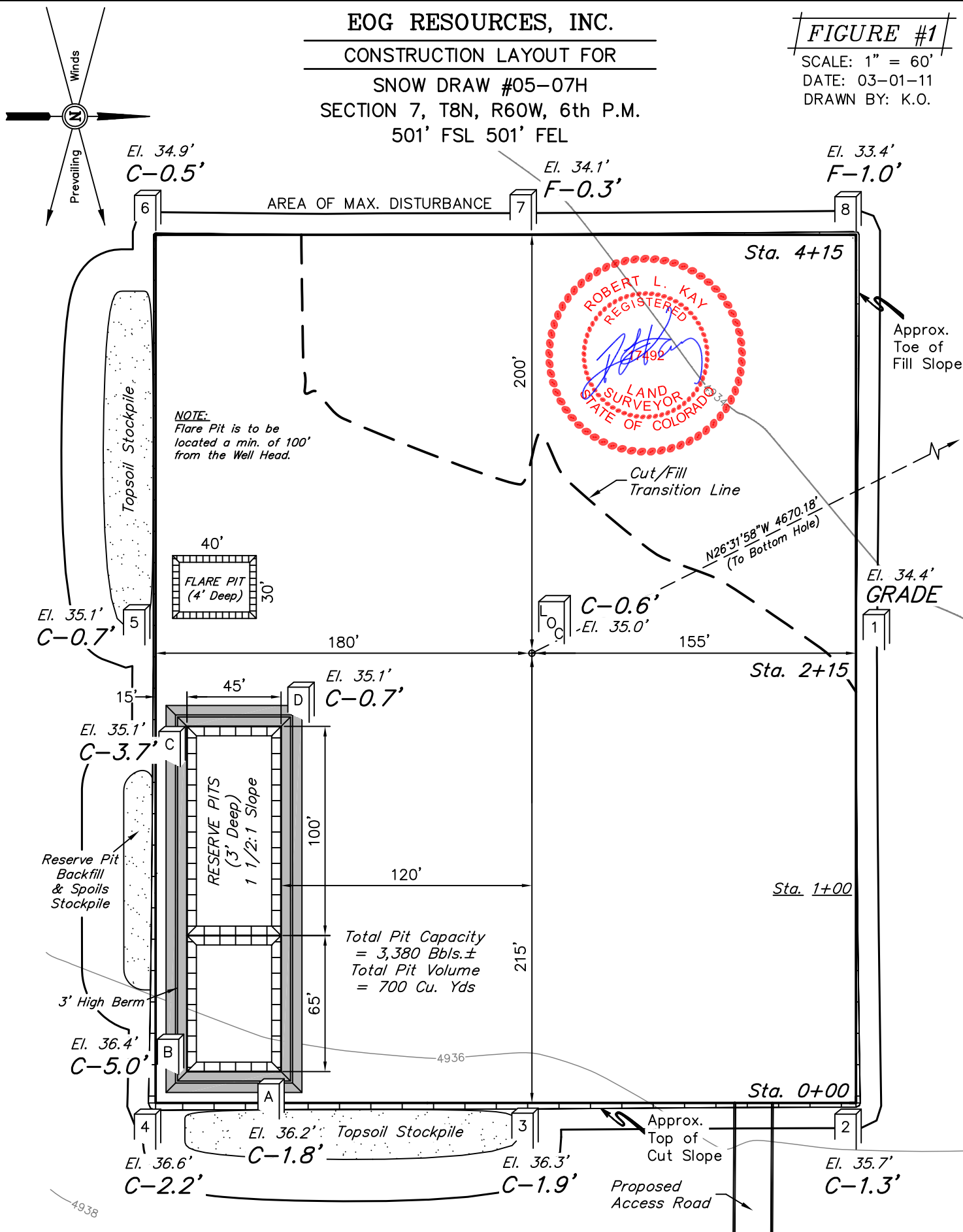

Elev. Ungraded Ground At Loc. Stake = 4935.0'
FINISHED GRADE ELEV. AT LOC. STAKE = 4934.4'

UINTAH ENGINEERING & LAND SURVEYING
85 So. 200 East * Vernal, Utah 84078 * (435) 789-1017

1" = 40'
X-Section
Scale
1" = 100'
DATE: 03-01-11
DRAWN BY: K.O.

EOG RESOURCES, INC.
CONSTRUCTION LAYOUT CROSS SECTIONS FOR
SNOW DRAW #05-07H
SECTION 7, T8N, R60W, 6th P.M.
501' FSL 501' FEL

FIGURE #2

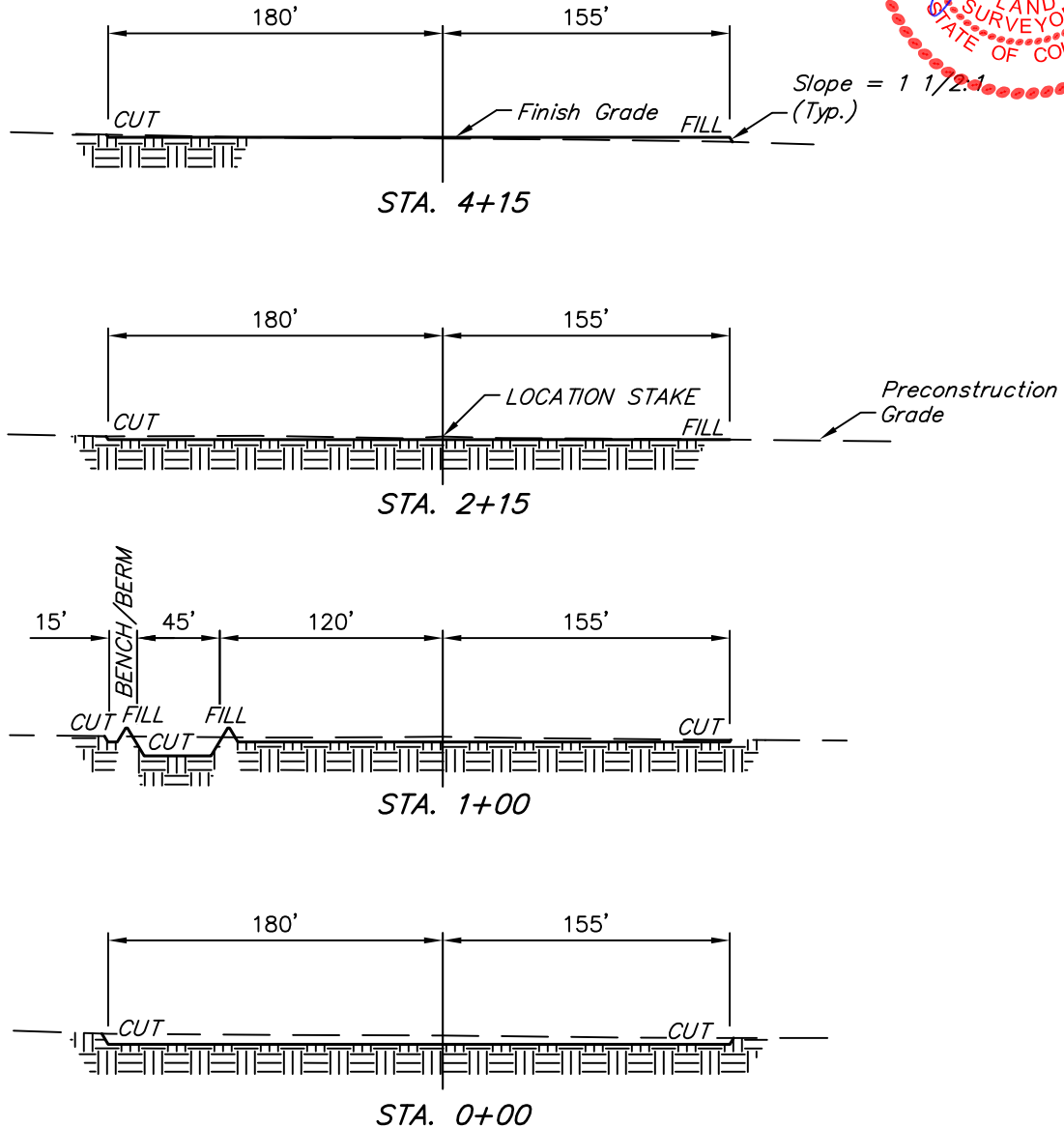
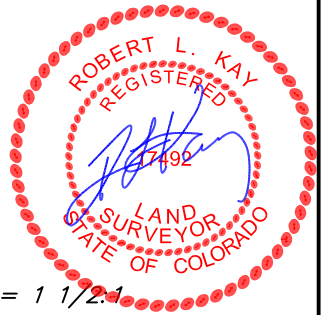

NOTE:

Topsoil should not be Stripped Below Finished Grade on Substructure Area.

APPROXIMATE ACREAGES
WELL SITE DISTURBANCE = ± 3.942 ACRES
ACCESS ROAD DISTURBANCE = ± 0.163 ACRES
TOTAL = ± 4.105 ACRES

* NOTE:
FILL QUANTITY INCLUDES 5% FOR COMPACTION

APPROXIMATE YARDAGES

(6") Topsoil Stripping = 2,640 Cu. Yds.
Remaining Location = 1,920 Cu. Yds.
TOTAL CUT = 4,560 CU.YDS.
FILL = 1,570 CU.YDS.

EXCESS MATERIAL = 2,990 Cu. Yds.
Topsoil & Pit Backfill = 2,990 Cu. Yds.
(1/2 Pit Vol.)
EXCESS UNBALANCE = 0 Cu. Yds.
(After Interim Rehabilitation)

UINTAH ENGINEERING & LAND SURVEYING
85 So. 200 East * Vernal, Utah 84078 * (435) 789-1017

FIGURE #3

SCALE: 1" = 60'
DATE: 03-01-11
DRAWN BY: K.O.

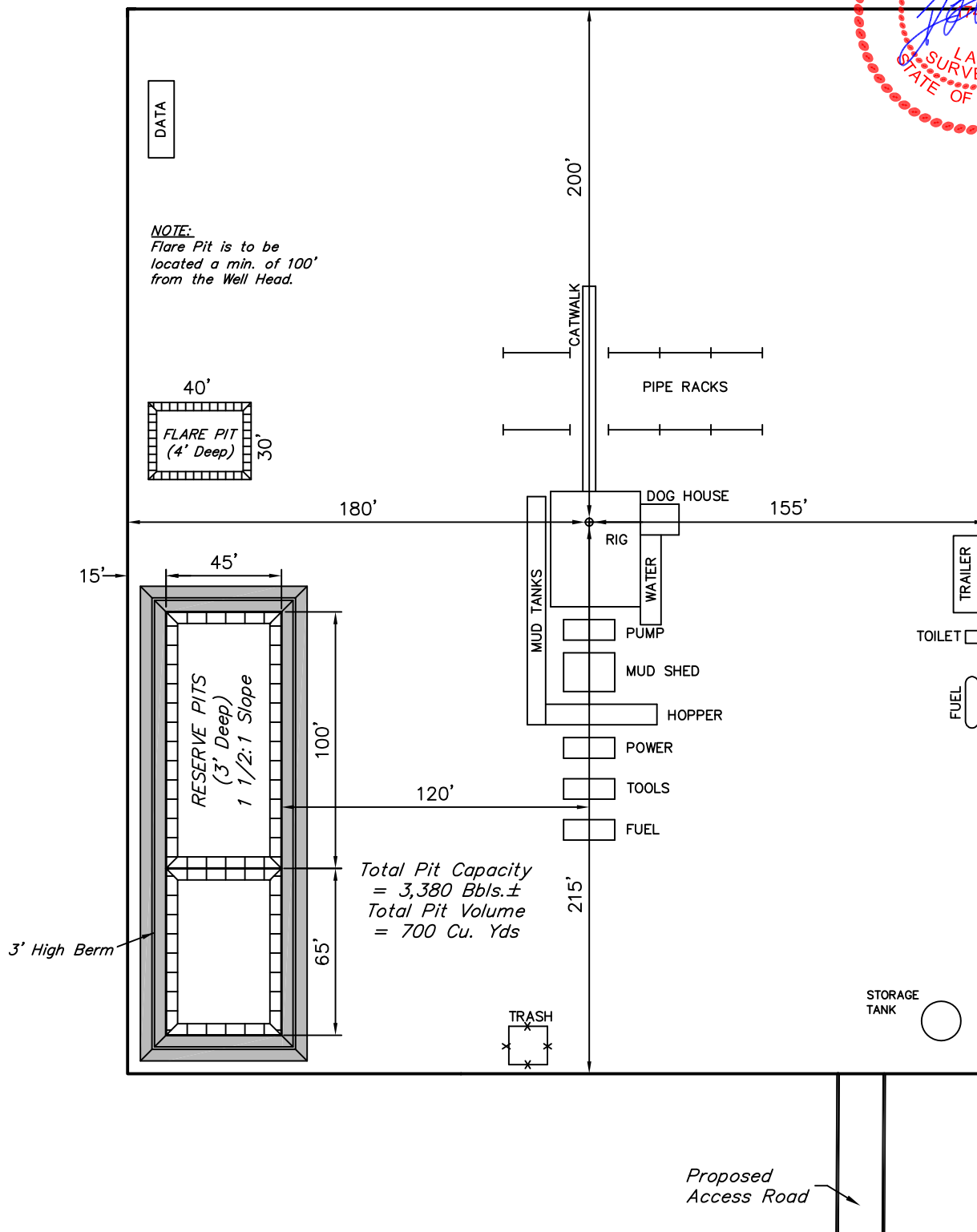

UINTAH ENGINEERING & LAND SURVEYING
85 So. 200 East * Vernal, Utah 84078 * (435) 789-1017

EOG RESOURCES, INC.

RECLAMATION DIAGRAM FOR

SNOW DRAW #05-07H
SECTION 7, T8N, R60W, 6th P.M.
501' FSL 501' FEL

FIGURE #4

SCALE: 1" = 60'

DATE: 03-01-11

DRAWN BY: K.O.

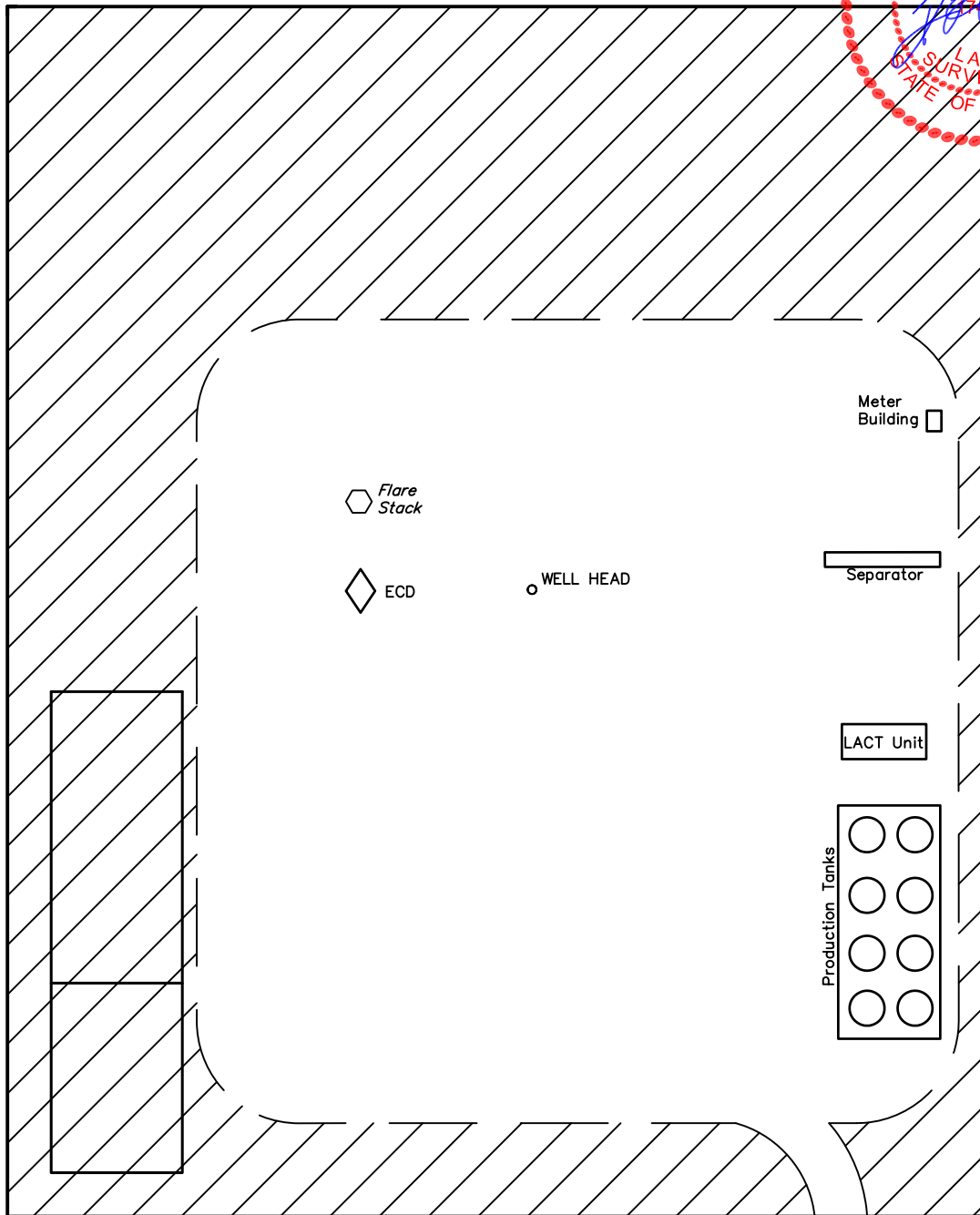

APPROXIMATE ACREAGES
UN-RECLAIMED = ± 1.545 ACRES



RECLAIMED AREA

Access Road

UINTAH ENGINEERING & LAND SURVEYING
85 So. 200 East * Vernal, Utah 84078 * (435) 789-1017

EOG RESOURCES, INC.

LOCATION DRAWING FOR

SNOW DRAW #05-07H
SECTION 7, T8N, R60W, 6th P.M.
501' FSL 501' FEL

FIGURE #5



1/4 Section Line

7



SCALE
DATE: 03-01-11
DRAWN BY: K.O.

1/16 Section Line

1/16 Section Line

1/4 Section Line

2011 Alum. Cap, 0.5'
Below Ground, PLS 18475,
Steel Fence Post
Lat: 40.669486°
Long: 104.134142°

S75°W 31.68 Miles
(To Railroad)

SE 1/4

N45°W 6506'
(To Building)

N09°W 4803'
(To Power Line)

NORTH 4786'
(To County Road #96)

Set Marked Stone
Lat: 40.676772°
Long: 104.124481°

N25°E 4179'
(To Water Well)

ROBIN T.
WALTER

S45°E 702'
(To Property Line)

N00°47'47"E - 2641.75' (Meas.)

N89°40'31"E - 2642.48' (Meas.)

2000 Private Alum.
Cap, 0.3' Below
Ground, PLS 10855
Lat: 40.669525°
Long: 104.124619°

PLANT COMMUNITY

- ☐ DISTURBED GRASSLAND
- ☐ NATIVE GRASSLAND
- ☐ SHRUB LAND
- ☐ PLAINS RIPARIAN
- ☐ MOUNTAIN RIPARIAN
- ☐ FOREST LAND
- ☐ WETLANDS AQUATIC
- ☐ ALPINE
- ☐ OTHER (Describe): _____

CURRENT LAND USE

- CROP LAND: ☐ IRRIGATED ☐ DRY LAND ☐ IMPROVED PASTURE ☐ HAY MEADOW ☐ CRP
- NON-CROP LAND: ☐ RANGELAND ☐ TIMBER ☐ RECREATIONAL ☐ OTHER (Describe) _____
- SUBDIVIDED: ☐ INDUSTRIAL ☐ COMMERCIAL ☐ RESIDENTIAL _____

FUTURE LAND USE

- CROP LAND: ☐ IRRIGATED ☐ DRY LAND ☐ IMPROVED PASTURE ☐ HAY MEADOW ☐ CRP
- NON-CROP LAND: ☐ RANGELAND ☐ TIMBER ☐ RECREATIONAL ☐ OTHER (Describe) _____
- SUBDIVIDED: ☐ INDUSTRIAL ☐ COMMERCIAL ☐ RESIDENTIAL _____