



KERR MCGEE OIL & GAS ONSHORE LP

Location: COLORADO Slot: SLOT#04 SATER 7-8 (2466'FNL & 2506'FEL)
Field: WELD COUNTY (KERR MCGEE) Well: SATER 7-8
Facility: SEC.08-T2N-R67W Wellbore: SATER 7-8 PWB



INTEQ

Plot reference wellpath is SATER 7-8 (REV-8.0) PWB	Grid System: NAD83 / Lambert Colorado State Planes, Northern Zone (501), US feet
True vertical depths are referenced to XTREME 15 (RKB)	North Reference: True north
Measured depths are referenced to XTREME 15 (RKB)	Scale: True distance
XTREME 15 (RKB) to Mean Sea Level: 4024 feet	Depths are in feet
Mean Sea Level to Mud line (Facility: SEC.08-T2N-R67W): 0 feet	Coordinates are in feet referenced to Slot
Created by: cookdamm on 5/20/2011	

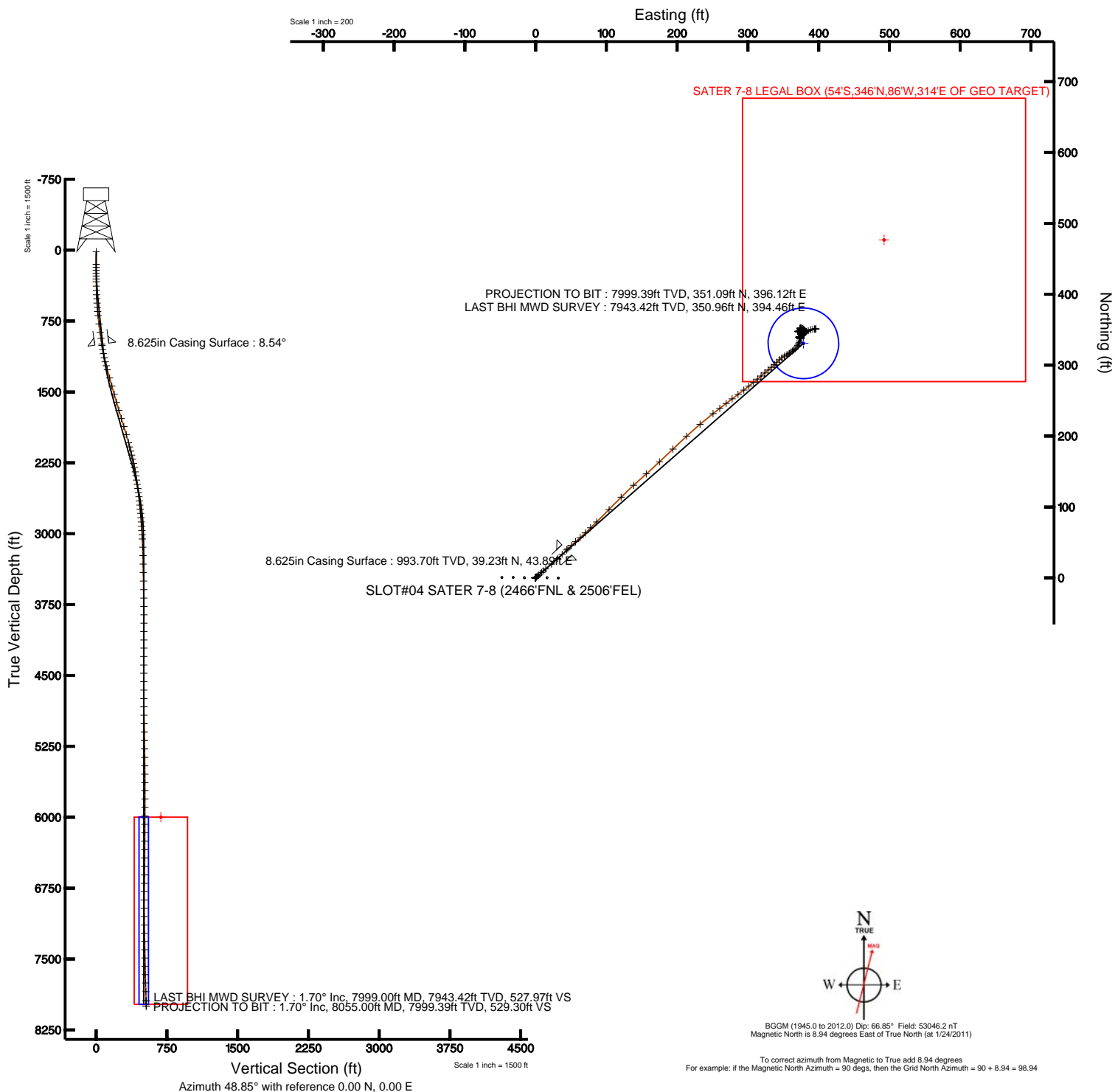



Actual Wellpath Report

SATER 7-8 AWP

Page 1 of 6



INTEQ

REFERENCE WELLPATH IDENTIFICATION

Operator	KERR MCGEE OIL & GAS ONSHORE LP	Slot	SLOT#04 SATER 7-8 (2466'FNL & 2506'FEL)
Area	COLORADO	Well	SATER 7-8
Field	WELD COUNTY (KERR MCGEE)	Wellbore	SATER 7-8 AWB
Facility	SEC.08-T2N-R67W		

REPORT SETUP INFORMATION

Projection System	NAD83 / Lambert Colorado State Planes, Northern Zone (501), US feet	Software System	WellArchitect® 2.0
North Reference	True	User	Cookdanm
Scale	0.999958	Report Generated	5/20/2011 at 10:28:12 AM
Convergence at slot	0.38° East	Database/Source file	Denver Server/SATER_7-8_AWB.xml

WELLPATH LOCATION

	Local coordinates		Grid coordinates		Geographic coordinates	
	North[ft]	East[ft]	Easting[USft]	Northing[USft]	Latitude	Longitude
Slot Location	-0.36	47.80	3163930.96	1299302.90	40°09'12.575"N	104°54'48.704"W
Facility Reference Pt			3163883.16	1299302.95	40°09'12.578"N	104°54'49.320"W
Field Reference Pt			3197771.84	1268891.29	40°04'09.600"N	104°47'36.000"W

WELLPATH DATUM

Calculation method	Minimum curvature	XTREME 15 (RKB) to Facility Vertical Datum	4924.00ft
Horizontal Reference Pt	Slot	XTREME 15 (RKB) to Mean Sea Level	4924.00ft
Vertical Reference Pt	XTREME 15 (RKB)	Facility Vertical Datum to Mud Line (Facility)	0.00ft
MD Reference Pt	XTREME 15 (RKB)	Section Origin	N 0.00, E 0.00 ft
Field Vertical Reference	Mean Sea Level	Section Azimuth	48.85°



Actual Wellpath Report

SATER 7-8 AWP

Page 2 of 6



INTEQ

REFERENCE WELLPATH IDENTIFICATION

Operator	KERR MCGEE OIL & GAS ONSHORE LP	Slot	SLOT#04 SATER 7-8 (2466'FNL & 2506'FEL)
Area	COLORADO	Well	SATER 7-8
Field	WELD COUNTY (KERR MCGEE)	Wellbore	SATER 7-8 AWP
Facility	SEC.08-T2N-R67W		

WELLPATH DATA (115 stations) † = interpolated/extrapolated station

MD [ft]	Inclination [°]	Azimuth [°]	TVD [ft]	Vert Sect [ft]	North [ft]	East [ft]	DLS [°/100ft]	Comments
0.00†	0.000	250.500	0.00	0.00	0.00	0.00	0.00	
15.00	0.000	250.500	15.00	0.00	0.00	0.00	0.00	
149.00	0.400	250.500	149.00	-0.43	-0.16	-0.44	0.30	
181.00	0.400	275.400	181.00	-0.62	-0.18	-0.66	0.54	
212.00	0.400	270.900	212.00	-0.77	-0.17	-0.87	0.10	
242.00	0.300	282.800	242.00	-0.89	-0.15	-1.05	0.41	
272.00	0.400	72.600	272.00	-0.84	-0.10	-1.03	2.25	
304.00	0.500	89.100	304.00	-0.64	-0.07	-0.79	0.51	
334.00	0.900	61.000	333.99	-0.31	0.05	-0.45	1.72	
380.00	1.100	64.100	379.99	0.47	0.42	0.27	0.45	
425.00	1.700	54.600	424.97	1.55	0.99	1.20	1.43	
471.00	2.600	53.600	470.94	3.27	2.01	2.59	1.96	
514.00	3.100	48.000	513.89	5.41	3.36	4.24	1.33	
560.00	3.800	45.500	559.80	8.17	5.26	6.25	1.56	
605.00	4.000	44.100	604.70	11.23	7.44	8.41	0.49	
649.00	4.900	50.100	648.57	14.63	9.74	10.92	2.30	
693.00	6.200	50.100	692.36	18.89	12.47	14.18	2.95	
781.00	7.600	50.100	779.72	29.46	19.25	22.29	1.59	
870.00	7.700	46.900	867.93	41.30	27.10	31.16	0.49	
934.00	7.800	46.200	931.34	49.92	33.04	37.43	0.21	
1011.00	8.700	46.200	1007.55	60.96	40.69	45.40	1.17	
1054.00	10.000	46.900	1049.97	67.94	45.49	50.48	3.03	
1098.00	10.800	48.700	1093.25	75.88	50.82	56.36	1.96	
1142.00	11.900	48.000	1136.39	84.54	56.58	62.83	2.52	
1187.00	13.400	45.900	1180.30	94.39	63.31	70.02	3.49	
1230.00	14.900	46.900	1221.99	104.89	70.56	77.64	3.53	
1275.00	15.700	46.600	1265.39	116.76	78.69	86.29	1.79	
1365.00	16.200	43.400	1351.93	141.42	96.18	103.76	1.12	
1454.00	15.600	45.200	1437.53	165.72	113.63	120.78	0.87	
1544.00	15.800	47.300	1524.17	190.05	130.47	138.38	0.67	
1632.00	16.000	48.700	1608.80	214.15	146.60	156.29	0.49	
1721.00	16.800	47.300	1694.18	239.28	163.42	174.96	1.00	
1811.00	17.300	45.500	1780.23	265.64	181.62	194.06	0.81	
1900.00	17.300	48.000	1865.20	292.08	199.75	213.34	0.84	
1989.00	15.800	49.400	1950.51	317.43	216.49	232.37	1.74	
2079.00	14.900	51.800	2037.30	341.24	231.62	250.77	1.22	
2125.00	15.300	52.500	2081.71	353.20	238.97	260.23	0.96	
2170.00	14.200	51.800	2125.23	364.64	246.00	269.28	2.48	
2214.00	13.700	52.900	2167.93	375.23	252.48	277.67	1.29	
2259.00	13.500	53.200	2211.67	385.78	258.84	286.13	0.47	
2304.00	12.300	52.900	2255.53	395.80	264.88	294.16	2.67	
2349.00	11.100	51.800	2299.60	404.91	270.45	301.39	2.71	
2395.00	9.900	51.100	2344.83	413.28	275.67	307.94	2.62	
2439.00	9.000	49.700	2388.23	420.50	280.27	313.51	2.11	
2484.00	8.400	48.700	2432.71	427.31	284.72	318.67	1.38	



Actual Wellpath Report

SATER 7-8 AWP

Page 3 of 6



INTEQ

REFERENCE WELLPATH IDENTIFICATION

Operator	KERR MCGEE OIL & GAS ONSHORE LP	Slot	SLOT#04 SATER 7-8 (2466'FNL & 2506'FEL)
Area	COLORADO	Well	SATER 7-8
Field	WELD COUNTY (KERR MCGEE)	Wellbore	SATER 7-8 AWP
Facility	SEC.08-T2N-R67W		

WELLPATH DATA (115 stations)

MD [ft]	Inclination [°]	Azimuth [°]	TVD [ft]	Vert Sect [ft]	North [ft]	East [ft]	DLS [°/100ft]	Comments
2529.00	8.600	50.400	2477.22	433.96	289.03	323.73	0.71	
2574.00	7.900	49.400	2521.75	440.41	293.19	328.67	1.59	
2618.00	7.300	49.400	2565.36	446.23	296.97	333.09	1.36	
2662.00	7.100	47.300	2609.02	451.74	300.64	337.21	0.75	
2705.00	6.500	45.900	2651.71	456.83	304.13	340.91	1.45	
2751.00	6.000	45.200	2697.44	461.83	307.64	344.49	1.10	
2794.00	5.800	56.800	2740.21	466.23	310.41	347.90	2.81	
2839.00	5.400	59.600	2785.00	470.56	312.73	351.63	1.08	
2884.00	4.900	60.300	2829.82	474.52	314.75	355.12	1.12	
2930.00	4.200	57.800	2875.67	478.11	316.62	358.25	1.58	
2975.00	3.700	53.600	2920.57	481.19	318.36	360.82	1.28	
3020.00	3.300	54.600	2965.48	483.92	319.98	363.04	0.90	
3065.00	3.000	50.800	3010.41	486.39	321.47	365.01	0.81	
3110.00	2.700	45.900	3055.36	488.62	322.95	366.68	0.86	
3198.00	2.100	36.400	3143.28	492.27	325.69	369.13	0.82	
3286.00	1.500	25.800	3231.24	494.90	328.03	370.59	0.78	
3376.00	1.200	26.900	3321.21	496.86	329.93	371.53	0.33	
3466.00	1.400	26.500	3411.19	498.75	331.75	372.44	0.22	
3556.00	1.700	2.300	3501.16	500.69	334.07	372.99	0.79	
3647.00	2.100	5.100	3592.11	502.82	337.08	373.19	0.45	
3736.00	0.700	3.000	3681.08	504.38	339.25	373.36	1.57	
3825.00	0.900	102.100	3770.07	505.17	339.64	374.08	1.38	
3913.00	0.400	99.600	3858.07	505.78	339.45	375.05	0.57	
4002.00	0.300	228.000	3947.07	505.74	339.24	375.19	0.71	
4090.00	0.700	250.500	4035.06	505.01	338.91	374.51	0.50	
4179.00	1.100	325.700	4124.05	504.61	339.43	373.52	1.28	
4265.00	0.800	251.500	4210.04	504.15	339.92	372.48	1.36	
4354.00	0.200	94.000	4299.04	503.69	339.71	372.05	1.11	
4445.00	0.500	188.200	4390.04	503.50	339.31	372.15	0.61	
4532.00	1.000	112.700	4477.04	503.55	338.64	372.79	1.15	
4621.00	0.900	114.400	4566.02	504.18	338.05	374.15	0.12	
4710.00	0.400	151.700	4655.02	504.40	337.49	374.93	0.71	
4800.00	0.800	309.500	4745.01	504.23	337.61	374.60	1.31	
4887.00	0.800	354.900	4832.01	504.49	338.61	374.07	0.71	
4976.00	1.500	18.100	4920.99	505.85	340.33	374.38	0.93	
5066.00	1.300	57.100	5010.96	507.88	342.01	375.60	1.06	
5155.00	1.100	50.800	5099.94	509.73	343.09	377.11	0.27	
5243.00	0.900	51.800	5187.93	511.26	344.06	378.31	0.23	
5333.00	0.900	63.100	5277.92	512.65	344.81	379.50	0.20	
5422.00	0.500	36.400	5366.91	513.71	345.44	380.35	0.57	
5512.00	0.600	39.200	5456.91	514.56	346.12	380.88	0.12	
5600.00	0.500	359.100	5544.91	515.26	346.86	381.17	0.44	
5689.00	0.700	353.100	5633.90	515.82	347.79	381.09	0.24	
5776.00	0.800	317.300	5720.89	516.10	348.77	380.62	0.54	
5864.00	0.800	312.300	5808.89	516.01	349.63	379.75	0.08	



Actual Wellpath Report

SATER 7-8 AWP

Page 4 of 6



INTEQ

REFERENCE WELLPATH IDENTIFICATION

Operator	KERR MCGEE OIL & GAS ONSHORE LP	Slot	SLOT#04 SATER 7-8 (2466'FNL & 2506'FEL)
Area	COLORADO	Well	SATER 7-8
Field	WELD COUNTY (KERR MCGEE)	Wellbore	SATER 7-8 AWB
Facility	SEC.08-T2N-R67W		

WELLPATH DATA (115 stations)

MD [ft]	Inclination [°]	Azimuth [°]	TVD [ft]	Vert Sect [ft]	North [ft]	East [ft]	DLS [°/100ft]	Comments
5953.00	1.000	305.000	5897.87	515.76	350.49	378.65	0.26	
6043.00	0.700	309.900	5987.86	515.48	351.30	377.59	0.34	
6131.00	0.900	289.500	6075.86	515.06	351.87	376.52	0.39	
6221.00	1.000	302.500	6165.84	514.49	352.53	375.19	0.26	
6310.00	0.400	222.300	6254.84	513.97	352.72	374.33	1.14	
6400.00	0.400	243.100	6344.84	513.35	352.34	373.84	0.16	
6488.00	0.800	157.300	6432.83	512.86	351.64	373.80	0.99	
6577.00	0.400	119.000	6521.83	512.77	350.91	374.31	0.61	
6667.00	1.600	220.200	6611.82	511.63	349.80	373.78	1.91	
6755.00	1.200	245.200	6699.79	509.53	348.48	372.15	0.82	
6843.00	0.800	270.500	6787.78	508.19	348.10	370.70	0.67	
6933.00	1.100	135.500	6877.77	507.77	347.48	370.67	1.95	
7020.00	0.800	111.200	6964.76	508.10	346.67	371.83	0.57	
7107.00	0.600	59.900	7051.75	508.83	346.68	372.79	0.73	
7196.00	1.800	109.800	7140.73	509.97	346.44	374.50	1.67	
7283.00	1.500	96.100	7227.70	511.40	345.85	376.92	0.57	
7370.00	1.400	72.600	7314.67	513.15	346.05	379.07	0.69	
7459.00	0.900	70.500	7403.65	514.79	346.61	380.77	0.56	
7546.00	0.600	71.500	7490.65	515.85	346.98	381.84	0.35	
7635.00	0.700	58.900	7579.64	516.81	347.41	382.75	0.20	
7722.00	3.100	67.700	7666.59	519.56	348.58	385.38	2.77	
7810.00	1.900	72.600	7754.50	523.15	349.92	388.97	1.38	
7902.00	1.600	79.600	7846.46	525.65	350.61	391.69	0.40	
7999.00	1.700	85.600	7943.42	527.97	350.96	394.46	0.21	LAST BHI MWD SURVEY
8055.00	1.700	85.600	7999.39	529.30	351.09	396.12	0.00	PROJECTION TO BIT

HOLE & CASING SECTIONS Ref Wellbore: SATER 7-8 AWP Ref Wellpath: SATER 7-8 AWP

String/Diameter	Start MD [ft]	End MD [ft]	Interval [ft]	Start TVD [ft]	End TVD [ft]	Start N/S [ft]	Start E/W [ft]	End N/S [ft]	End E/W [ft]
12.25in Open Hole	15.00	997.00	982.00	15.00	993.70	0.00	0.00	39.23	43.89
8.625in Casing Surface	15.00	997.00	982.00	15.00	993.70	0.00	0.00	39.23	43.89
7.875in Open Hole	997.00	8055.00	7058.00	993.70	7999.39	39.23	43.89	351.09	396.12



Actual Wellpath Report

SATER 7-8 AWP

Page 5 of 6



INTEQ

REFERENCE WELLPATH IDENTIFICATION

Operator	KERR MCGEE OIL & GAS ONSHORE LP	Slot	SLOT#04 SATER 7-8 (2466'FNL & 2506'FEL)
Area	COLORADO	Well	SATER 7-8
Field	WELD COUNTY (KERR MCGEE)	Wellbore	SATER 7-8 AWB
Facility	SEC.08-T2N-R67W		

TARGETS

Name	MD [ft]	TVD [ft]	North [ft]	East [ft]	Grid East [srv ft]	Grid North [srv ft]	Latitude	Longitude	Shape
SATER 7-8 GEO TARGET 50' RADIUS (2130'FNL & 2130'FEL, REV-1)		6000.00	330.78	378.49	3164307.24	1299636.17	40°09'15.844"N	104°54'43.830"W	circle
SATER 7-8 LEGAL BOX (54'S,346'N,86'W,314'E OF GEO TARGET)		6000.00	476.78	492.49	3164420.27	1299782.91	40°09'17.286"N	104°54'42.362"W	square

WELLPATH COMPOSITION Ref Wellbore: SATER 7-8 AWB Ref Wellpath: SATER 7-8 AWP

Start MD [ft]	End MD [ft]	Positional Uncertainty Model	Log Name/Comment	Wellbore
15.00	934.00	NaviTrak (Standard)	BHI MWD SURVEY 12.25 HOLE <149-934>	SATER 7-8 AWB
934.00	7999.00	NaviTrak (Standard)	BHI MWD SURVEYS 7.875 HOLE <1011-7999>	SATER 7-8 AWB
7999.00	8055.00	Blind Drilling (std)	Projection to bit	SATER 7-8 AWB



Actual Wellpath Report

SATER 7-8 AWP

Page 6 of 6



INTEQ

REFERENCE WELLPATH IDENTIFICATION

Operator	KERR MCGEE OIL & GAS ONSHORE LP	Slot	SLOT#04 SATER 7-8 (2466'FNL & 2506'FEL)
Area	COLORADO	Well	SATER 7-8
Field	WELD COUNTY (KERR MCGEE)	Wellbore	SATER 7-8 AWB
Facility	SEC.08-T2N-R67W		

WELLPATH COMMENTS

MD [ft]	Inclination [°]	Azimuth [°]	TVD [ft]	Comment
7999.00	1.700	85.600	7943.42	LAST BHI MWD SURVEY
8055.00	1.700	85.600	7999.39	PROJECTION TO BIT