



KERR MCGEE OIL & GAS ONSHORE LP

Location: COLORADO Slot: SLOT#06 SATER 8-8 (2466'FNL & 2474'FEL)
Field: WELD COUNTY (KERR MCGEE) Well: SATER 8-8
Facility: SEC.08-T2N-R67W Wellbore: SATER 8-8 PWB



INTEQ

Plot reference wellpath is SATER 8-8 (REV-8.0) PWP	
True vertical depths are referenced to XTREME 15 (RKB)	Grid System: NAD83 / Lambert Colorado State Planes, Northern Zone (501), US feet
Measured depths are referenced to XTREME 15 (RKB)	North Reference: True north
XTREME 15 (RKB) to Mean Sea Level: 4924 feet	Scale: True distance
Mean Sea Level to Mud line (Facility: SEC.08-T2N-R67W): 0 feet	Depths are in feet
Coordinates are in feet referenced to Slot	Created by: cookdarm on 5/20/2011

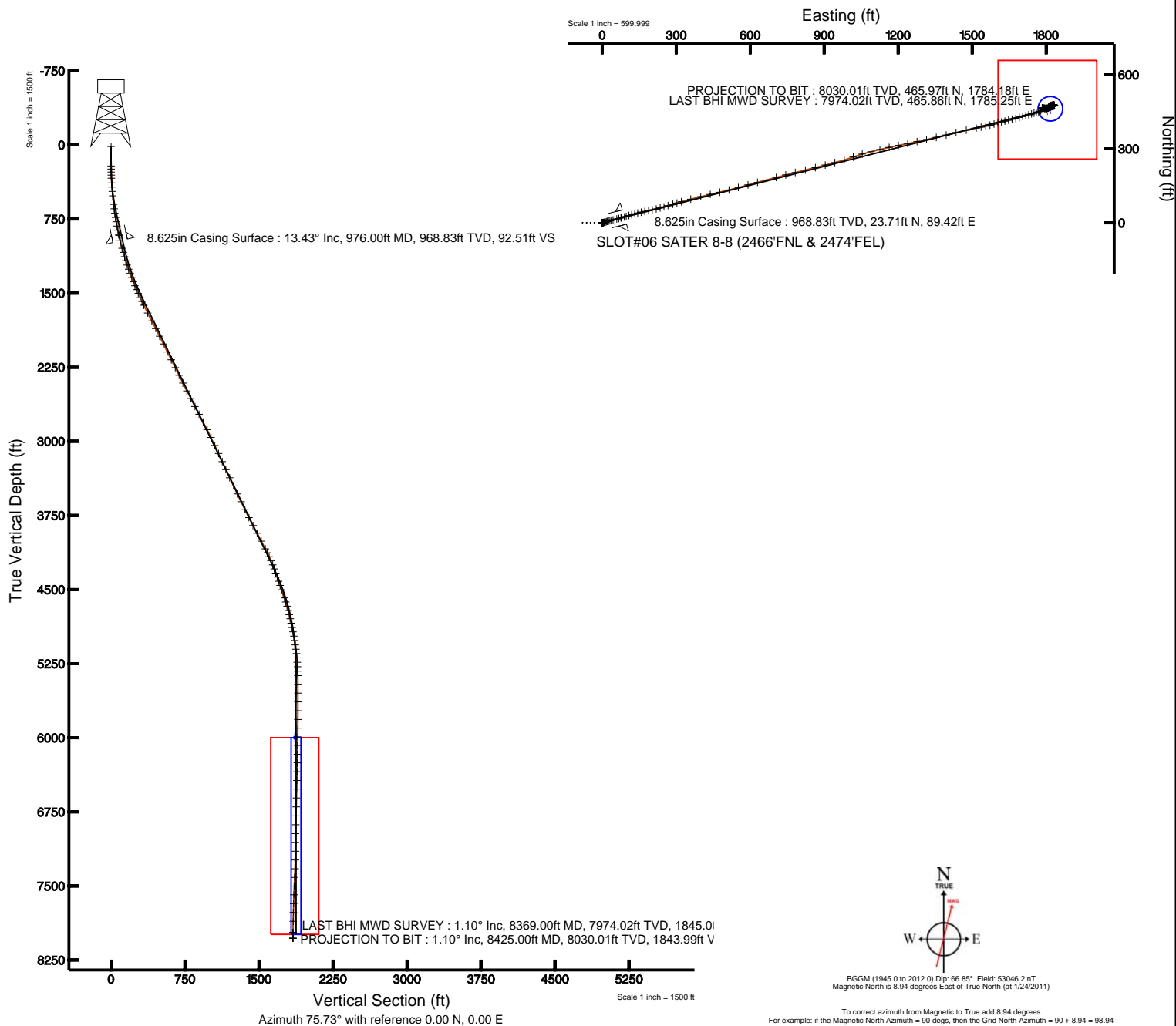



Actual Wellpath Report

SATER 8-8 AWP

Page 1 of 6



INTEQ

REFERENCE WELLPATH IDENTIFICATION

Operator	KERR MCGEE OIL & GAS ONSHORE LP	Slot	SLOT#06 SATER 8-8 (2466'FNL & 2474'FEL)
Area	COLORADO	Well	SATER 8-8
Field	WELD COUNTY (KERR MCGEE)	Wellbore	SATER 8-8 AWB
Facility	SEC.08-T2N-R67W		

REPORT SETUP INFORMATION

Projection System	NAD83 / Lambert Colorado State Planes, Northern Zone (501), US feet	Software System	WellArchitect® 2.0
North Reference	True	User	Cookdanm
Scale	0.999958	Report Generated	5/20/2011 at 11:31:50 AM
Convergence at slot	0.38° East	Database/Source file	Denver Server/SATER_8-8_AWB.xml

WELLPATH LOCATION

	Local coordinates		Grid coordinates		Geographic coordinates	
	North[ft]	East[ft]	Easting[USft]	Northing[USft]	Latitude	Longitude
Slot Location	-0.73	79.95	3163963.11	1299302.75	40°09'12.571"N	104°54'48.290"W
Facility Reference Pt			3163883.16	1299302.95	40°09'12.578"N	104°54'49.320"W
Field Reference Pt			3197771.84	1268891.29	40°04'09.600"N	104°47'36.000"W

WELLPATH DATUM

Calculation method	Minimum curvature	XTREME 15 (RKB) to Facility Vertical Datum	4924.00ft
Horizontal Reference Pt	Slot	XTREME 15 (RKB) to Mean Sea Level	4924.00ft
Vertical Reference Pt	XTREME 15 (RKB)	Facility Vertical Datum to Mud Line (Facility)	0.00ft
MD Reference Pt	XTREME 15 (RKB)	Section Origin	N 0.00, E 0.00 ft
Field Vertical Reference	Mean Sea Level	Section Azimuth	75.73°



Actual Wellpath Report

SATER 8-8 AWP

Page 2 of 6



INTEQ

REFERENCE WELLPATH IDENTIFICATION

Operator	KERR MCGEE OIL & GAS ONSHORE LP	Slot	SLOT#06 SATER 8-8 (2466'FNL & 2474'FEL)
Area	COLORADO	Well	SATER 8-8
Field	WELD COUNTY (KERR MCGEE)	Wellbore	SATER 8-8 AWP
Facility	SEC.08-T2N-R67W		

WELLPATH DATA (130 stations) † = interpolated/extrapolated station

MD [ft]	Inclination [°]	Azimuth [°]	TVD [ft]	Vert Sect [ft]	North [ft]	East [ft]	DLS [°/100ft]	Comments
0.00†	0.000	55.300	0.00	0.00	0.00	0.00	0.00	
15.00	0.000	55.300	15.00	0.00	0.00	0.00	0.00	
151.00	0.300	55.300	151.00	0.33	0.20	0.29	0.22	
182.00	0.500	79.200	182.00	0.54	0.27	0.49	0.83	
213.00	0.500	62.700	213.00	0.81	0.36	0.75	0.46	
244.00	0.900	79.600	244.00	1.19	0.47	1.11	1.44	
274.00	1.200	80.600	273.99	1.73	0.56	1.65	1.00	
305.00	1.900	81.000	304.98	2.57	0.69	2.47	2.26	
336.00	2.600	74.300	335.95	3.78	0.97	3.66	2.41	
383.00	3.500	75.400	382.89	6.28	1.62	6.07	1.92	
426.00	4.100	74.700	425.79	9.13	2.35	8.83	1.40	
470.00	5.200	72.900	469.65	12.70	3.35	12.25	2.52	
515.00	5.600	74.000	514.45	16.93	4.56	16.31	0.92	
558.00	6.500	73.600	557.21	21.46	5.82	20.66	2.10	
602.00	6.700	74.300	600.92	26.51	7.22	25.52	0.49	
647.00	7.300	74.000	645.58	32.00	8.72	30.80	1.34	
692.00	8.400	75.700	690.16	38.14	10.32	36.73	2.50	
735.00	9.600	77.100	732.63	44.87	11.90	43.27	2.84	
780.00	10.300	76.100	776.95	52.64	13.70	50.83	1.60	
824.00	11.000	76.400	820.19	60.77	15.63	58.73	1.60	
867.00	11.400	76.400	862.37	69.12	17.60	66.85	0.93	
912.00	12.200	75.400	906.42	78.32	19.84	75.77	1.83	
923.00	12.400	74.700	917.17	80.67	20.45	78.04	2.27	
1010.00	14.100	72.600	1001.85	100.59	26.08	97.16	2.03	
1055.00	15.400	71.500	1045.37	112.02	29.61	108.06	2.96	
1098.00	16.200	72.900	1086.74	123.71	33.19	119.20	2.06	
1143.00	16.900	74.000	1129.88	136.52	36.84	131.49	1.70	
1186.00	17.500	77.100	1170.96	149.23	40.01	143.80	2.55	
1232.00	18.500	77.500	1214.70	163.44	43.13	157.67	2.19	
1277.00	19.600	78.200	1257.24	178.11	46.22	172.03	2.50	
1323.00	20.300	77.900	1300.48	193.80	49.47	187.38	1.54	
1368.00	20.700	78.200	1342.63	209.54	52.73	202.80	0.92	
1413.00	21.500	76.400	1384.61	225.73	56.30	218.60	2.29	
1457.00	22.500	74.300	1425.41	242.21	60.47	234.54	2.89	
1498.00	23.600	74.000	1463.13	258.26	64.86	249.99	2.70	
1541.00	24.500	73.300	1502.40	275.77	69.79	266.80	2.20	
1589.00	25.000	74.000	1545.99	295.85	75.45	286.08	1.21	
1630.00	25.300	73.600	1583.10	313.27	80.31	302.82	0.84	
1673.00	26.200	73.600	1621.83	331.94	85.58	320.74	2.09	
1761.00	27.300	75.700	1700.42	371.53	96.05	358.93	1.65	
1851.00	27.500	76.100	1780.32	412.95	106.14	399.10	0.30	
1938.00	27.100	77.100	1857.63	452.85	115.39	437.91	0.70	
2025.00	26.500	77.500	1935.28	492.06	124.02	476.18	0.72	
2113.00	25.700	75.000	2014.31	530.76	133.20	513.78	1.55	
2203.00	26.600	75.400	2095.10	570.42	143.33	552.13	1.02	



Actual Wellpath Report

SATER 8-8 AWP

Page 3 of 6



INTEQ

REFERENCE WELLPATH IDENTIFICATION

Operator	KERR MCGEE OIL & GAS ONSHORE LP	Slot	SLOT#06 SATER 8-8 (2466'FNL & 2474'FEL)
Area	COLORADO	Well	SATER 8-8
Field	WELD COUNTY (KERR MCGEE)	Wellbore	SATER 8-8 AWB
Facility	SEC.08-T2N-R67W		

WELLPATH DATA (130 stations)

MD [ft]	Inclination [°]	Azimuth [°]	TVD [ft]	Vert Sect [ft]	North [ft]	East [ft]	DLS [°/100ft]	Comments
2292.00	27.100	75.000	2174.51	610.62	153.60	590.99	0.60	
2381.00	26.500	75.000	2253.94	650.74	163.99	629.75	0.67	
2468.00	26.600	75.700	2331.77	689.63	173.82	667.38	0.38	
2556.00	26.500	75.000	2410.49	728.96	183.77	705.43	0.37	
2645.00	26.900	75.000	2490.00	768.95	194.12	744.06	0.45	
2732.00	27.500	76.100	2567.38	808.71	204.04	782.57	0.90	
2822.00	28.200	77.100	2646.96	850.75	213.78	823.46	0.94	
2911.00	28.000	75.700	2725.47	892.67	223.64	864.21	0.77	
3000.00	27.700	75.000	2804.16	934.24	234.15	904.43	0.50	
3087.00	27.500	75.700	2881.26	974.55	244.34	943.43	0.44	
3176.00	25.100	73.300	2961.04	1013.96	254.85	981.43	2.95	
3265.00	25.600	70.800	3041.47	1051.98	266.59	1017.67	1.33	
3355.00	24.900	72.900	3122.87	1090.28	278.56	1054.14	1.26	
3445.00	23.900	76.100	3204.84	1127.43	288.51	1089.95	1.84	
3535.00	24.600	77.100	3286.90	1164.39	297.07	1125.91	0.90	
3626.00	25.300	77.100	3369.40	1202.77	305.64	1163.32	0.77	
3716.00	25.200	78.600	3450.81	1241.13	313.72	1200.85	0.72	
3806.00	25.700	78.900	3532.07	1279.75	321.27	1238.78	0.57	
3894.00	26.300	77.500	3611.17	1318.29	329.16	1276.54	0.98	
3984.00	26.000	77.500	3691.95	1357.93	337.75	1315.27	0.33	
4074.00	27.300	78.600	3772.39	1398.27	346.10	1354.76	1.54	
4164.00	27.300	74.700	3852.37	1439.52	355.62	1394.90	1.99	
4253.00	28.000	76.100	3931.21	1480.82	366.03	1434.87	1.07	
4343.00	28.200	78.600	4010.60	1523.18	375.30	1476.22	1.33	
4431.00	27.800	77.900	4088.30	1564.46	383.72	1516.67	0.59	
4475.00	26.000	78.200	4127.54	1584.35	387.84	1536.15	4.10	
4520.00	24.500	77.500	4168.24	1603.53	391.88	1554.91	3.40	
4564.00	23.400	76.100	4208.45	1621.38	395.95	1572.30	2.81	
4609.00	21.900	74.000	4249.98	1638.71	400.41	1589.04	3.79	
4653.00	20.200	74.330	4291.04	1654.51	404.72	1604.25	3.87	
4698.00	19.300	75.400	4333.40	1669.71	408.70	1618.92	2.16	
4741.00	19.300	75.700	4373.98	1683.92	412.24	1632.69	0.23	
4786.00	19.600	75.400	4416.41	1698.91	415.98	1647.20	0.70	
4831.00	19.500	77.500	4458.82	1713.96	419.51	1661.83	1.58	
4877.00	19.800	75.700	4502.14	1729.43	423.10	1676.88	1.47	
4922.00	19.600	74.000	4544.51	1744.59	427.06	1691.52	1.35	
4965.00	18.200	74.700	4585.19	1758.52	430.82	1704.93	3.30	
5008.00	17.100	74.300	4626.16	1771.55	434.30	1717.49	2.57	
5052.00	16.300	72.600	4668.31	1784.18	437.90	1729.61	2.13	
5097.00	14.300	72.900	4711.71	1796.04	441.42	1740.95	4.45	
5141.00	13.100	74.000	4754.46	1806.45	444.40	1750.94	2.79	
5184.00	13.000	73.300	4796.35	1816.16	447.13	1760.26	0.43	
5229.00	12.000	71.500	4840.28	1825.88	450.07	1769.54	2.38	
5274.00	12.000	69.800	4884.30	1835.20	453.17	1778.37	0.79	
5319.00	11.700	70.100	4928.34	1844.39	456.34	1787.05	0.68	



Actual Wellpath Report

SATER 8-8 AWP

Page 4 of 6



INTEQ

REFERENCE WELLPATH IDENTIFICATION

Operator	KERR MCGEE OIL & GAS ONSHORE LP	Slot	SLOT#06 SATER 8-8 (2466'FNL & 2474'FEL)
Area	COLORADO	Well	SATER 8-8
Field	WELD COUNTY (KERR MCGEE)	Wellbore	SATER 8-8 AWP
Facility	SEC.08-T2N-R67W		

WELLPATH DATA (130 stations)

MD [ft]	Inclination [°]	Azimuth [°]	TVD [ft]	Vert Sect [ft]	North [ft]	East [ft]	DLS [°/100ft]	Comments
5363.00	10.800	69.800	4971.49	1852.93	459.28	1795.11	2.05	
5408.00	10.000	68.100	5015.75	1861.00	462.19	1802.69	1.90	
5453.00	8.900	68.000	5060.14	1868.32	464.95	1809.55	2.44	
5498.00	7.500	66.200	5104.68	1874.67	467.44	1815.46	3.16	
5542.00	6.500	62.000	5148.35	1879.92	469.77	1820.29	2.55	
5586.00	5.100	68.000	5192.12	1884.27	471.67	1824.30	3.46	
5631.00	3.800	77.900	5236.99	1887.75	472.73	1827.61	3.35	
5676.00	3.000	72.900	5281.91	1890.41	473.39	1830.20	1.89	
5721.00	1.900	81.000	5326.87	1892.33	473.85	1832.06	2.56	
5766.00	0.800	59.600	5371.85	1893.38	474.13	1833.07	2.65	
5853.00	0.100	70.500	5458.85	1894.04	474.46	1833.66	0.81	
5943.00	0.400	38.100	5548.85	1894.36	474.74	1833.93	0.36	
6032.00	0.400	333.400	5637.85	1894.54	475.26	1833.98	0.48	
6121.00	0.800	322.200	5726.84	1894.23	476.03	1833.46	0.47	
6210.00	0.400	355.200	5815.84	1894.03	476.83	1833.06	0.58	
6298.00	1.200	305.300	5903.83	1893.48	477.67	1832.28	1.13	
6385.00	1.100	283.500	5990.81	1892.15	478.39	1830.72	0.51	
6473.00	0.700	224.100	6078.80	1890.95	478.20	1829.53	1.09	
6562.00	0.700	251.200	6167.80	1889.94	477.63	1828.63	0.37	
6649.00	1.000	251.500	6254.79	1888.66	477.22	1827.41	0.34	
6738.00	1.100	265.200	6343.77	1887.04	476.90	1825.82	0.30	
6827.00	1.500	267.000	6432.75	1885.06	476.77	1823.81	0.45	
6915.00	2.100	251.900	6520.71	1882.32	476.21	1821.13	0.86	
7005.00	1.500	242.700	6610.66	1879.52	475.16	1818.51	0.74	
7094.00	1.300	219.500	6699.64	1877.57	473.84	1816.83	0.67	
7185.00	1.600	232.200	6790.61	1875.58	472.27	1815.17	0.48	
7275.00	1.900	238.500	6880.56	1873.00	470.72	1812.91	0.40	
7365.00	1.800	223.000	6970.52	1870.39	468.91	1810.67	0.57	
7454.00	0.900	104.900	7059.50	1869.82	467.70	1810.39	2.65	
7544.00	0.900	184.700	7149.50	1870.21	466.82	1811.02	1.28	
7632.00	1.800	246.600	7237.47	1868.62	465.58	1809.69	1.81	
7721.00	3.100	264.900	7326.39	1864.86	464.81	1806.01	1.69	
7809.00	2.300	264.200	7414.29	1860.77	464.42	1801.89	0.91	
7897.00	2.400	271.600	7502.22	1857.25	464.29	1798.29	0.36	
7985.00	2.100	273.000	7590.15	1853.94	464.43	1794.84	0.35	
8075.00	1.800	277.900	7680.10	1851.05	464.71	1791.79	0.38	
8164.00	1.400	277.500	7769.06	1848.75	465.04	1789.33	0.45	
8254.00	1.100	286.300	7859.04	1846.98	465.43	1787.41	0.39	
8369.00	1.100	276.100	7974.02	1845.00	465.86	1785.25	0.17	LAST BHI MWD SURVEY
8425.00	1.100	276.100	8030.01	1843.99	465.97	1784.18	0.00	PROJECTION TO BIT



Actual Wellpath Report

SATER 8-8 AWP

Page 5 of 6



INTEQ

REFERENCE WELLPATH IDENTIFICATION			
Operator	KERR MCGEE OIL & GAS ONSHORE LP	Slot	SLOT#06 SATER 8-8 (2466'FNL & 2474'FEL)
Area	COLORADO	Well	SATER 8-8
Field	WELD COUNTY (KERR MCGEE)	Wellbore	SATER 8-8 AWB
Facility	SEC.08-T2N-R67W		

HOLE & CASING SECTIONS Ref Wellbore: SATER 8-8 AWB Ref Wellpath: SATER 8-8 AWP									
String/Diameter	Start MD [ft]	End MD [ft]	Interval [ft]	Start TVD [ft]	End TVD [ft]	Start N/S [ft]	Start E/W [ft]	End N/S [ft]	End E/W [ft]
12.25in Open Hole	15.00	986.00	971.00	15.00	978.55	0.00	0.00	24.38	91.66
8.625in Casing Surface	15.00	976.00	961.00	15.00	968.83	0.00	0.00	23.71	89.42
7.875in Open Hole	976.00	8425.00	7449.00	968.83	8030.01	23.71	89.42	465.97	1784.18

TARGETS									
Name	MD [ft]	TVD [ft]	North [ft]	East [ft]	Grid East [srv ft]	Grid North [srv ft]	Latitude	Longitude	Shape
SATER 8-8 GEO TARGET 50' RADIUS (1980'FNL & 660'FEL, REV-1)		6000.00	462.36	1817.50	3165777.44	1299777.10	40°09'17.140"N	104°54'24.883"W	circle
SATER 8-8 LEGAL BOX (196'N,204'S,188'E,212'W OF GEO TARGET)		6000.00	458.36	1805.50	3165765.46	1299773.02	40°09'17.100"N	104°54'25.038"W	square

WELLPATH COMPOSITION Ref Wellbore: SATER 8-8 AWB Ref Wellpath: SATER 8-8 AWP				
Start MD [ft]	End MD [ft]	Positional Uncertainty Model	Log Name/Comment	Wellbore
15.00	515.00	NaviTrak (Standard)	BHI MWD SURVEY 12.25 HOLE <151-515>	SATER 8-8 AWB
515.00	8369.00	NaviTrak (Standard)	BHI MWD SURVEYS 7.875 HOLE <558-8369>	SATER 8-8 AWB
8369.00	8425.00	Blind Drilling (std)	Projection to bit	SATER 8-8 AWB



Actual Wellpath Report

SATER 8-8 AWP

Page 6 of 6



INTEQ

REFERENCE WELLPATH IDENTIFICATION

Operator	KERR MCGEE OIL & GAS ONSHORE LP	Slot	SLOT#06 SATER 8-8 (2466'FNL & 2474'FEL)
Area	COLORADO	Well	SATER 8-8
Field	WELD COUNTY (KERR MCGEE)	Wellbore	SATER 8-8 AWB
Facility	SEC.08-T2N-R67W		

WELLPATH COMMENTS

MD [ft]	Inclination [°]	Azimuth [°]	TVD [ft]	Comment
8369.00	1.100	276.100	7974.02	LAST BHI MWD SURVEY
8425.00	1.100	276.100	8030.01	PROJECTION TO BIT