

PROPOSED WILDLIFE BMP'S

Hocker #3-35 1,000' FSL & 1,216' FEL SESE Sec. 35, T33N, R7W, N.M.P.M

General Operating Practices

- ❖ The Hocker #3-35 will be drilled from the existing Ute #A 1R Govt well pad to reduce surface disturbance impacts.
 - Reduces area necessary for well pad construction.
 - Utilize existing infrastructure for operations.
- ❖ A closed-loop mud system will be used during drilling operations.
- ❖ Surface equipment that could be potentially damaging to wildlife will be fenced with cattle panels.
 - Prevents wildlife entry to potentially harmful equipment.
- ❖ The access road will be gated in order to restrict general public access.
- ❖ Construction, drilling and completion activities will be scheduled to avoid critical winter use periods for deer and elk December 1 - April 15.
- ❖ Recycle drilling fluids.
 - Mud systems are dewatered, recycled and water is reused during drilling operations, reducing the amount of water needed to be trucked for drilling operations.
 - Mud can be transported to next drilling location, reducing truck traffic to dispose of drilling fluids.
- ❖ Adhere to the developed weed management plan pursuant to both the La Plata County Land Use Code and Colorado Noxious Weed Act.
 - Protects the productivity of adjacent wildlife habitats.
- ❖ Screen exhaust and vent stacks to preclude avian perching.
- ❖ Standard wildlife friendly seed mixes developed by the CDOW specifically for the San Juan Basin will be used for reclamation.
- ❖ Educate employees and contractors on wildlife conservation practices, including no harassment or feeding of wildlife.
- ❖ Forbid use of firearms and dogs on location.
- ❖ Utilize bear proof dumpsters and trash receptacles for food related trash at all facilities that generate such trash.

SURFACE OWNER RESPONSE
TO COLORADO DEPARTMENT OF WILDLIFE
CONDITIONS OF APPROVAL

C. R.S. 34-60-128(3)(b) provides for surface owner consent of certain permit specific conditions of wildlife habitat protection.

Jess Leroy Hocker and Glenda E. Hocker as record title Surface Owner of a tract of land in the East ½ of Section 35, Township 33 North, Range 07 West, N.M.P.M., being more particularly described under that certain Quit Claim Deed dated May 6, 2010, recorded May 7, 2010, Reception No.1013836, La Plata County, Colorado are aware of the following Colorado Department of Wildlife's recommended Conditions of Approval ("COA") for XTO Energy Inc. Application for Permit to Drill the Hocker #3-35 Well:

No.

1. All fired vessel and heat transfer stacks, vents, or other openings shall be equipped with screens or other appropriate equipment to prevent entry by wildlife, including migratory birds.

The above Condition of Approval is currently addressed by existing rule 604.b.(7) and Migratory Bird Policy of the Colorado Oil and Gas Conservation Commission and is not open for discussion by the Operator or the Surface Owner.

2. Do not place staging, refueling, or chemical storage areas within riparian zones and floodplains.
3. Use wildlife-appropriate fencing at this facility if acceptable to Surface Owner.
4. Use wildlife-appropriate seed mixes at this facility if acceptable to Surface Owner.
5. Gate the access road to this facility and limit public access if acceptable to Surface Owner.

Surface Owner does hereby:

CONSENT to the implementation of the following COA's: Jess Leroy and Glenda E Hocker

DOES NOT CONSENT to the implementation of the following COA's: _____

Propose(s) the attached alternative(s) to the following COA(s): _____

Surface Owner:

Dated: MARCH 9TH 2011

By: Jess Leroy Hocker
Jess Leroy Hocker

By: Glenda E. Hocker
Glenda E. Hocker

**PROPOSED BMP'S
XTO ENERGY, INC.**

**Certificate to Discharge Under CDPS General Permit No. COR-03000
Stormwater Discharges Associated with Construction Certification No.
COR03C483**

- A Field Wide Stormwater Management Plan (SWMP) for the La Plata Infill Program is on file at the XTO Energy Inc. office. A Site Specific SWMP with a Site Plan will be developed for each location.
- Inspections of the project site and maintenance of BMP's installed shall be conducted in accordance with the CDPHE CDPS permit & field wide plan.
- Spill Prevention and Counter Measures (SPCC) for the La Plata Infill Program is on file at the XTO Energy Inc. office. The Field SWMP and Site Specific SWMP each address SPCC during construction operations.
- See attached diagram for site specific BMP's.

TABLE 3
STRUCTURAL AND NON-STRUCTURAL BMP CLASSIFICATION

LA PLATA INFILL PROGRAM
XTO ENERGY, INC.

NON-STRUCTURAL BMPs		
Program Oversight	Construction Site Planning and Management	Good Housekeeping/Materials Management
Construction Phase Plan Review Contractor Training and Certification Database Development and Maintenance	Timing of projects Construction Sequencing Site Operator BMP Inspection and Maintenance Training Preserving Natural Vegetation/Buffer Minimize Final Pad Site Acreage	General Construction Site Waste Management Spill Prevention, Control Plan and Countermeasures

STRUCTURAL BMPs		
Erosion Control	Sediment Control	Runoff Control
Dust Control Erosion Control Blanket Gravel Surfacing Mulching Retaining Wall Revegetation Riprap Slope Stabilization Surface Roughening/Ripping Terracing Vegetated Buffer	Brush Matting Filter Berm Land Grading Level Spreader Silt Fence Stabilized Construction Entrance Straw Bale Barrier Vegetated Buffer Wattle Wind Fence	Berm Check Dam Culverts Culvert Protection Diversion Ditch/Ditch&Berm Drainage Dip Roadside Ditch Slope Drain Turnout Water Bar



TABLE 2
BMP SELECTION GUIDELINES

LA PLATA INFILL PROGRAM
XTO ENERGY, INC.

ACTIVE	COMPLETED	FINAL STABILIZATION
Compressor Station, Pipelines		
Berm Brush Matting Check Dams Culverts Culvert Protection Diversion Ditch/Ditch&Berm Drainage Dip Erosion Control Blanket Filter Berm Gravel Surfacing Land Grading Level Spreader Retaining Wall Revegetation Riprap Roadside Ditches Silt Fence Slope Drain Stabilized Construction Entrance Straw Bale Barrier Surface Roughening / Ripping Terracing Turnouts Vegetated Buffer Water Bar Wattles Wind Fence	Berm Brush Matting Check Dams Culverts Culvert Protection Diversion Ditch/Ditch&Berm Drainage Dip Erosion Control Blanket Filter Berm Gravel Surfacing Level Spreader Retaining Wall Riprap Roadside Ditches Silt Fence Slope Drain Straw Bale Barrier Terracing Vegetated Buffer Water Bar Wattles Wind Fence	Berm Check Dams Culverts Culvert Protection Diversion Ditch/Ditch&Berm Drainage Dip Filter Berm Gravel Surfacing Retaining Wall Revegetation Riprap Roadside Ditches Slope Drain Terracing Water Bar
Access Roads		
Berm Brush Matting Check Dams Culverts Culvert Protection Diversion Ditch/Ditch&Berm Drainage Dip Erosion Control Blanket Filter Berm Gravel Surfacing Land Grading Level Spreader Retaining Wall Revegetation Riprap Roadside Ditches Silt Fence	Berm Brush Matting Check Dams Culverts Culvert Protection Diversion Ditch/Ditch&Berm Drainage Dip Erosion Control Blanket Filter Berm Gravel Surfacing Level Spreader Retaining Wall Riprap Roadside Ditches Silt Fence Slope Drain Straw Bale Barrier	Berm Check Dams Culverts Culvert Protection Diversion Ditch/Ditch&Berm Drainage Dip Filter Berm Gravel Surfacing Retaining Wall Revegetation Riprap Roadside Ditches Slope Drain Water Bar



TABLE 2
BMP SELECTION GUIDELINES

LA PLATA INFILL PROGRAM
XTO ENERGY, INC.

ACTIVE	COMPLETED	FINAL STABILIZATION
Access Roads (continued)		
Slope Drain	Vegetated Buffer	
Stabilized Construction Entrance	Water Bar	
Straw Bale Barrier	Wattles	
Surface Roughening/Ripping	Wind Fence	
Turnouts		
Vegetated Buffer		
Water Bar		
Wattles		
Wind Fence		

Notes:

BMP = Best Management Practice



GRADING AND DRAINAGE PLAN
XTO ENERGY INC. HOCKER #3-35
SURFACE HOLE: 1000' FSL, 1,216,' FEL
SECTION 35, T-33-N, R-07-W, N.M.P.M.,
LA PLATA COUNTY, COLORADO

LEGEND	
	SLOPE DIRECTION
	8" DIKE W/ EXCELSIOR
	CONVEYANCE CHANNEL
	PROPOSED_PIPELINE
	EDGE EXIST TRAVEL SURFACE
	EXISTING FENCE
	PAD_DIMENSION
	EXISTING PIPE
	EXISTING_STRUCTURES
	PROPOSED EQUIPMENT
	FILL SLOPE
	CUT 2:1 SLOPE
	CUT FILL CATCH
	EDGE DISTURBANCE
	EXISTING DISTURBANCE

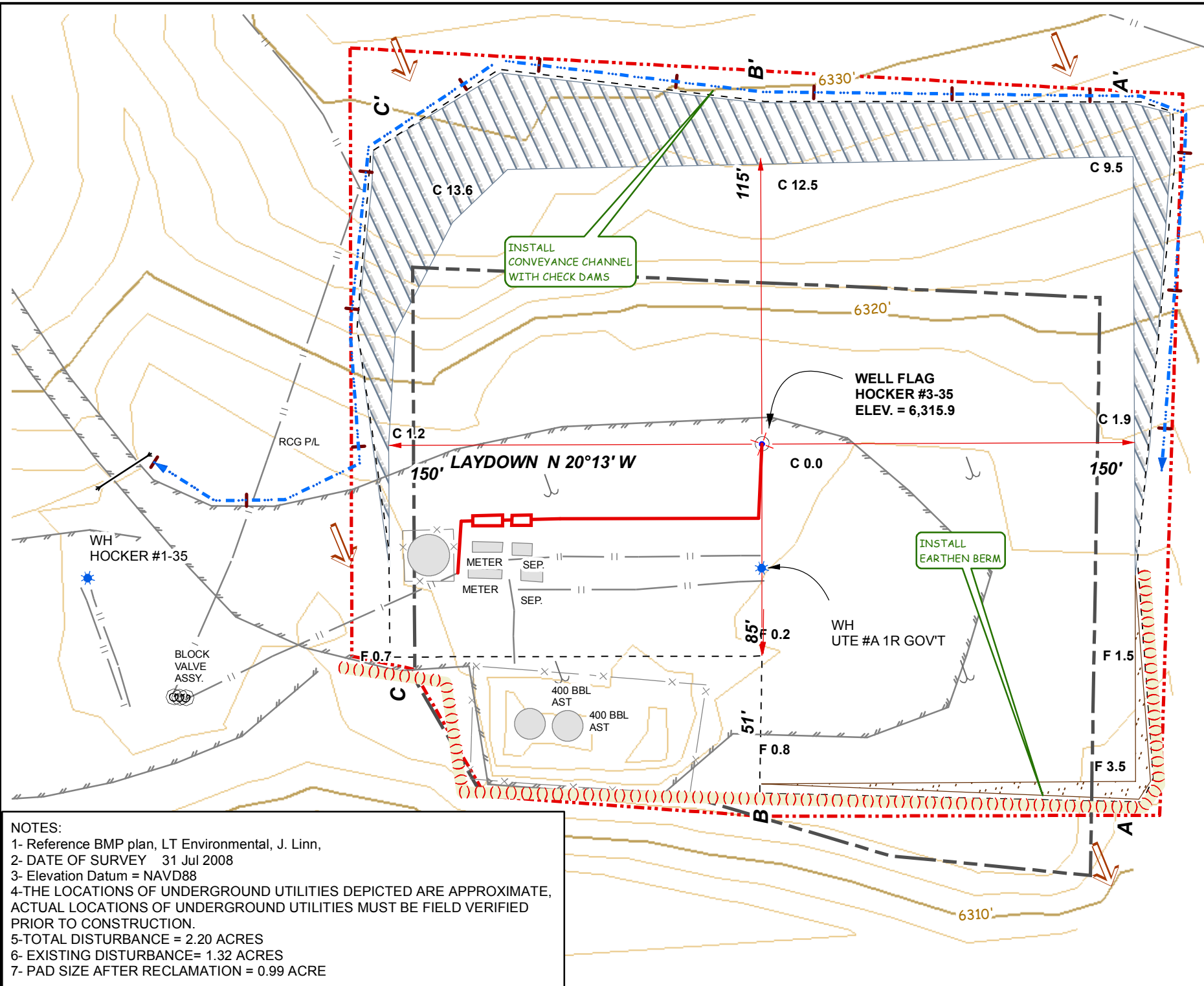

0 25 50 Feet
 1 inch equals 50 feet

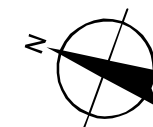

8-16-10
 XTO031 GRADING AND DRAINAGE PLAN.MXD

JMAS
 JOHNSON MAPPING
 AND SURVEYING, LLC
 PO BOX 2174
 FARMINGTON NM 87499-2174
 505-360-8029
 ALEX@JOHNSONMAPPING.BIZ