



Project: Kimball Mtn  
Site: Section 8 (C08 799)  
Well: DH7A-32 C08 799  
Wellbore: HZ  
Design: Plan #2



#### SECTION DETAILS

Sec	MD	Inc	Azi	TVD	+N/-S	+E/-W	Dleg	TFace	VSec	Target
1	0.0	0.00	0.00	0.0	0.0	0.0	0.00	0.00	0.0	
2	400.0	0.00	0.00	400.0	0.0	0.0	0.00	0.00	0.0	
3	656.5	10.26	258.80	655.1	-4.4	-22.5	4.00	258.80	-1.7	
4	7287.8	10.26	258.80	7180.4	-233.8	-1181.1	0.00	0.00	-90.2	
5	8217.2	91.00	359.82	7763.3	348.4	-1288.4	10.00	100.66	500.6	DH7A-32 C08 799 LP
6	18800.0	91.00	359.82	7578.3	10929.5	-1322.4	0.00	0.00	11009.2	DH7A-32 C08 799 PBHL

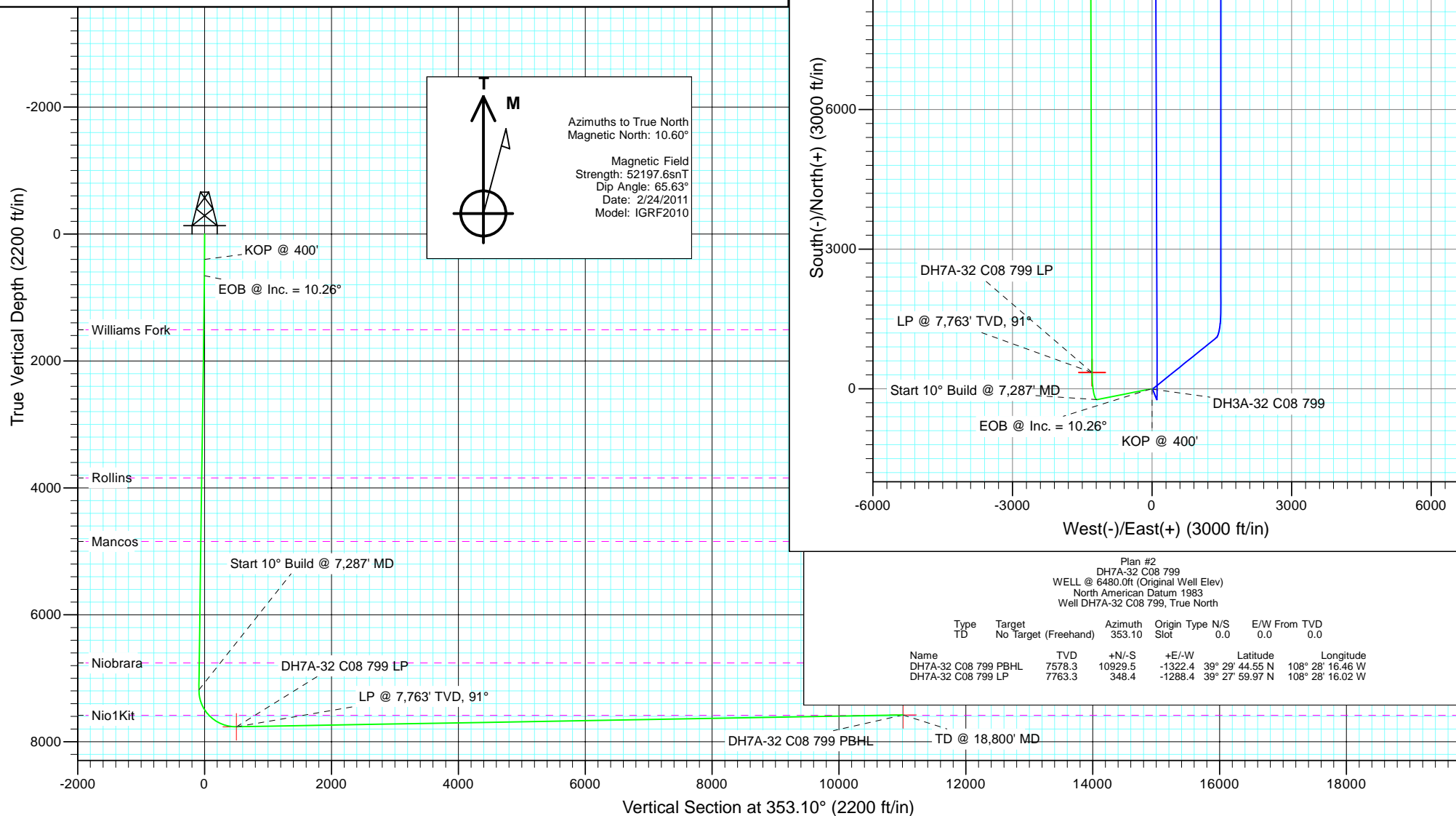



Project: Kimball Mtn  
Site: Section 8 (C08 799)  
Well: DH7A-32 C08 799  
Wellbore: HZ  
Design: Plan #2

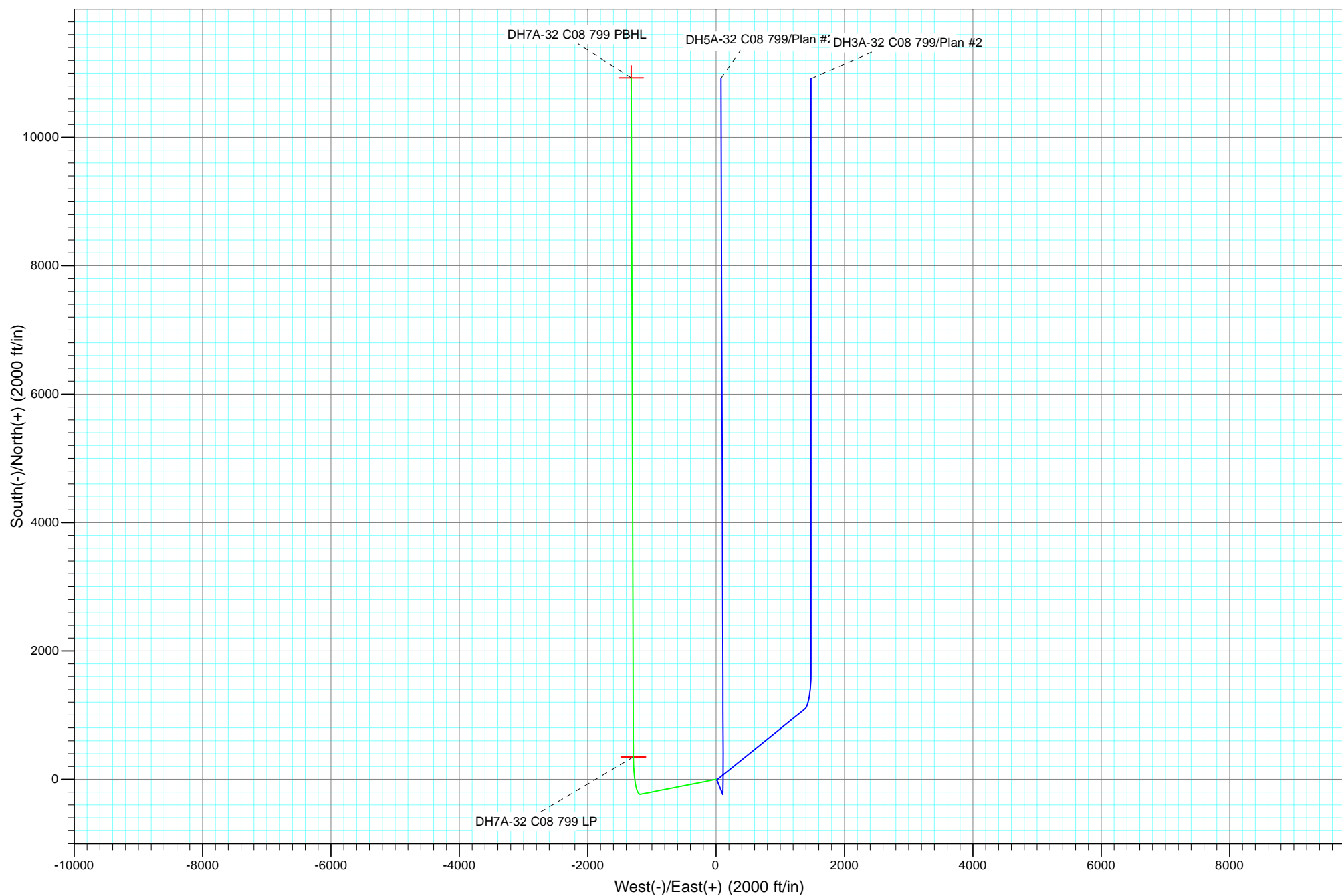



Project: Kimball Mtn  
Site: Section 8 (C08 799)  
Well: DH7A-32 C08 799  
Wellbore: HZ  
Design: Plan #2

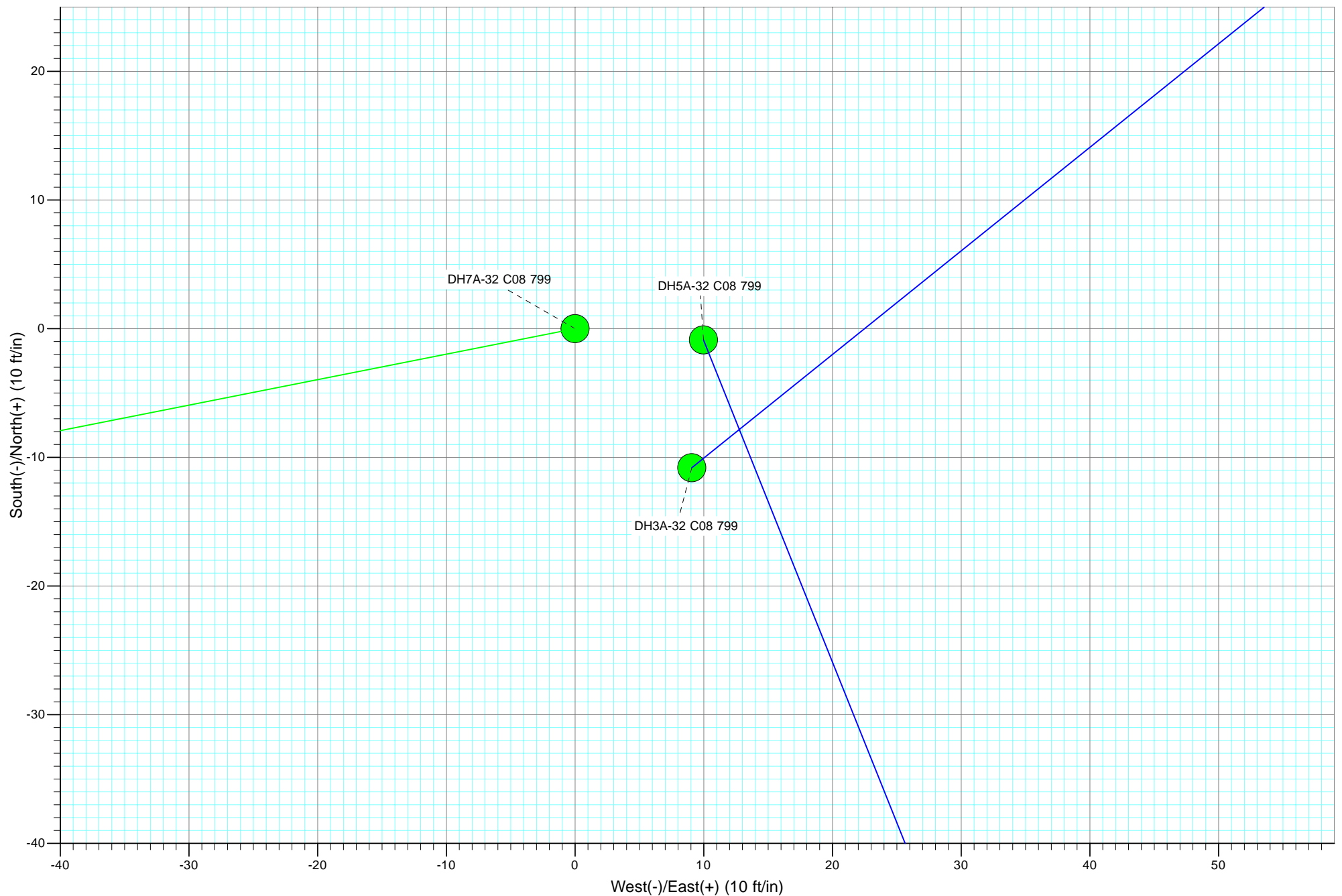

# Cathedral Energy Services

## Planning Report

<b>Database:</b>	EDM 5000.1 US Multi Users DB	<b>Local Co-ordinate Reference:</b>	Well DH7A-32 C08 799
<b>Company:</b>	EnCana Oil & Gas (USA) Inc	<b>TVD Reference:</b>	WELL @ 6480.0ft (Original Well Elev)
<b>Project:</b>	Kimball Mtn	<b>MD Reference:</b>	WELL @ 6480.0ft (Original Well Elev)
<b>Site:</b>	Section 8 (C08 799)	<b>North Reference:</b>	True
<b>Well:</b>	DH7A-32 C08 799	<b>Survey Calculation Method:</b>	Minimum Curvature
<b>Wellbore:</b>	HZ		
<b>Design:</b>	Plan #2		

<b>Project</b>	Kimball Mtn		
<b>Map System:</b>	US State Plane 1983	<b>System Datum:</b>	Mean Sea Level
<b>Geo Datum:</b>	North American Datum 1983		
<b>Map Zone:</b>	Colorado Central Zone		

<b>Site</b>	Section 8 (C08 799)			
<b>Site Position:</b>		<b>Northing:</b>	1,608,176.57 ft	<b>Latitude:</b> 39° 27' 56.42 N
<b>From:</b>	Lat/Long	<b>Easting:</b>	2,162,638.87 ft	<b>Longitude:</b> 108° 27' 59.47 W
<b>Position Uncertainty:</b>	0.0 ft	<b>Slot Radius:</b>	13.200 in	<b>Grid Convergence:</b> -1.87 °

<b>Well</b>	DH7A-32 C08 799			
<b>Well Position</b>	<b>+N/-S</b>	0.0 ft	<b>Northing:</b>	1,608,187.66 ft
	<b>+E/-W</b>	0.0 ft	<b>Easting:</b>	2,162,630.16 ft
<b>Position Uncertainty</b>		0.0 ft	<b>Wellhead Elevation:</b>	ft
			<b>Ground Level:</b>	6,460.0 ft

<b>Wellbore</b>	HZ				
<b>Magnetics</b>	<b>Model Name</b>	<b>Sample Date</b>	<b>Declination (°)</b>	<b>Dip Angle (°)</b>	<b>Field Strength (nT)</b>
	IGRF2010	2/24/2011	10.60	65.63	52,198

<b>Design</b>	Plan #2			
<b>Audit Notes:</b>				
<b>Version:</b>	<b>Phase:</b>	PLAN	<b>Tie On Depth:</b>	0.0
<b>Vertical Section:</b>	<b>Depth From (TVD) (ft)</b>	<b>+N/-S (ft)</b>	<b>+E/-W (ft)</b>	<b>Direction (°)</b>
	0.0	0.0	0.0	353.10

<b>Plan Sections</b>										
Measured Depth (ft)	Inclination (°)	Azimuth (°)	Vertical Depth (ft)	+N/-S (ft)	+E/-W (ft)	Dogleg Rate (°/100ft)	Build Rate (°/100ft)	Turn Rate (°/100ft)	TFO (°)	Target
0.0	0.00	0.00	0.0	0.0	0.0	0.00	0.00	0.00	0.00	
400.0	0.00	0.00	400.0	0.0	0.0	0.00	0.00	0.00	0.00	
656.5	10.26	258.80	655.1	-4.4	-22.5	4.00	4.00	0.00	258.80	
7,287.8	10.26	258.80	7,180.4	-233.8	-1,181.1	0.00	0.00	0.00	0.00	
8,217.2	91.00	359.82	7,763.3	348.4	-1,288.4	10.00	8.69	10.87	100.66	DH7A-32 C08 799 LP
18,800.0	91.00	359.82	7,578.3	10,929.5	-1,322.4	0.00	0.00	0.00	0.00	DH7A-32 C08 799 PE

# Cathedral Energy Services

## Planning Report

<b>Database:</b>	EDM 5000.1 US Multi Users DB	<b>Local Co-ordinate Reference:</b>	Well DH7A-32 C08 799
<b>Company:</b>	EnCana Oil & Gas (USA) Inc	<b>TVD Reference:</b>	WELL @ 6480.0ft (Original Well Elev)
<b>Project:</b>	Kimball Mtn	<b>MD Reference:</b>	WELL @ 6480.0ft (Original Well Elev)
<b>Site:</b>	Section 8 (C08 799)	<b>North Reference:</b>	True
<b>Well:</b>	DH7A-32 C08 799	<b>Survey Calculation Method:</b>	Minimum Curvature
<b>Wellbore:</b>	HZ		
<b>Design:</b>	Plan #2		

### Planned Survey

Measured Depth (ft)	Inclination (°)	Azimuth (°)	Vertical Depth (ft)	+N/-S (ft)	+E/-W (ft)	Vertical Section (ft)	Dogleg Rate (°/100ft)	Build Rate (°/100ft)	Comments / Formations
0.0	0.00	0.00	0.0	0.0	0.0	0.0	0.00	0.00	
100.0	0.00	0.00	100.0	0.0	0.0	0.0	0.00	0.00	
200.0	0.00	0.00	200.0	0.0	0.0	0.0	0.00	0.00	
300.0	0.00	0.00	300.0	0.0	0.0	0.0	0.00	0.00	
400.0	0.00	0.00	400.0	0.0	0.0	0.0	0.00	0.00	KOP @ 400'
500.0	4.00	258.80	499.9	-0.7	-3.4	-0.3	4.00	4.00	
600.0	8.00	258.80	599.4	-2.7	-13.7	-1.0	4.00	4.00	
656.5	10.26	258.80	655.1	-4.4	-22.5	-1.7	4.00	4.00	EOB @ Inc. = 10.26°
700.0	10.26	258.80	697.9	-6.0	-30.1	-2.3	0.00	0.00	
800.0	10.26	258.80	796.3	-9.4	-47.5	-3.6	0.00	0.00	
900.0	10.26	258.80	894.7	-12.9	-65.0	-5.0	0.00	0.00	
1,000.0	10.26	258.80	993.1	-16.3	-82.5	-6.3	0.00	0.00	
1,100.0	10.26	258.80	1,091.5	-19.8	-100.0	-7.6	0.00	0.00	
1,200.0	10.26	258.80	1,189.9	-23.2	-117.4	-9.0	0.00	0.00	
1,300.0	10.26	258.80	1,288.3	-26.7	-134.9	-10.3	0.00	0.00	
1,400.0	10.26	258.80	1,386.7	-30.2	-152.4	-11.6	0.00	0.00	
1,500.0	10.26	258.80	1,485.1	-33.6	-169.8	-13.0	0.00	0.00	
1,525.3	10.26	258.80	1,510.0	-34.5	-174.3	-13.3	0.00	0.00	Williams Fork
1,600.0	10.26	258.80	1,583.5	-37.1	-187.3	-14.3	0.00	0.00	
1,700.0	10.26	258.80	1,681.9	-40.5	-204.8	-15.6	0.00	0.00	
1,800.0	10.26	258.80	1,780.3	-44.0	-222.3	-17.0	0.00	0.00	
1,900.0	10.26	258.80	1,878.7	-47.5	-239.7	-18.3	0.00	0.00	
2,000.0	10.26	258.80	1,977.1	-50.9	-257.2	-19.6	0.00	0.00	
2,100.0	10.26	258.80	2,075.5	-54.4	-274.7	-21.0	0.00	0.00	
2,200.0	10.26	258.80	2,174.0	-57.8	-292.2	-22.3	0.00	0.00	
2,300.0	10.26	258.80	2,272.4	-61.3	-309.6	-23.6	0.00	0.00	
2,400.0	10.26	258.80	2,370.8	-64.7	-327.1	-25.0	0.00	0.00	
2,500.0	10.26	258.80	2,469.2	-68.2	-344.6	-26.3	0.00	0.00	
2,600.0	10.26	258.80	2,567.6	-71.7	-362.0	-27.7	0.00	0.00	
2,700.0	10.26	258.80	2,666.0	-75.1	-379.5	-29.0	0.00	0.00	
2,800.0	10.26	258.80	2,764.4	-78.6	-397.0	-30.3	0.00	0.00	
2,900.0	10.26	258.80	2,862.8	-82.0	-414.5	-31.7	0.00	0.00	
3,000.0	10.26	258.80	2,961.2	-85.5	-431.9	-33.0	0.00	0.00	
3,100.0	10.26	258.80	3,059.6	-88.9	-449.4	-34.3	0.00	0.00	
3,200.0	10.26	258.80	3,158.0	-92.4	-466.9	-35.7	0.00	0.00	
3,300.0	10.26	258.80	3,256.4	-95.9	-484.4	-37.0	0.00	0.00	
3,400.0	10.26	258.80	3,354.8	-99.3	-501.8	-38.3	0.00	0.00	
3,500.0	10.26	258.80	3,453.2	-102.8	-519.3	-39.7	0.00	0.00	
3,600.0	10.26	258.80	3,551.6	-106.2	-536.8	-41.0	0.00	0.00	
3,700.0	10.26	258.80	3,650.0	-109.7	-554.2	-42.3	0.00	0.00	
3,800.0	10.26	258.80	3,748.4	-113.2	-571.7	-43.7	0.00	0.00	
3,897.2	10.26	258.80	3,844.0	-116.5	-588.7	-45.0	0.00	0.00	Rollins
3,900.0	10.26	258.80	3,846.8	-116.6	-589.2	-45.0	0.00	0.00	
4,000.0	10.26	258.80	3,945.2	-120.1	-606.7	-46.3	0.00	0.00	
4,100.0	10.26	258.80	4,043.6	-123.5	-624.1	-47.7	0.00	0.00	
4,200.0	10.26	258.80	4,142.0	-127.0	-641.6	-49.0	0.00	0.00	
4,300.0	10.26	258.80	4,240.4	-130.4	-659.1	-50.3	0.00	0.00	
4,400.0	10.26	258.80	4,338.8	-133.9	-676.5	-51.7	0.00	0.00	
4,500.0	10.26	258.80	4,437.2	-137.4	-694.0	-53.0	0.00	0.00	
4,600.0	10.26	258.80	4,535.6	-140.8	-711.5	-54.3	0.00	0.00	
4,700.0	10.26	258.80	4,634.0	-144.3	-729.0	-55.7	0.00	0.00	
4,800.0	10.26	258.80	4,732.4	-147.7	-746.4	-57.0	0.00	0.00	

# Cathedral Energy Services

## Planning Report

<b>Database:</b>	EDM 5000.1 US Multi Users DB	<b>Local Co-ordinate Reference:</b>	Well DH7A-32 C08 799
<b>Company:</b>	EnCana Oil & Gas (USA) Inc	<b>TVD Reference:</b>	WELL @ 6480.0ft (Original Well Elev)
<b>Project:</b>	Kimball Mtn	<b>MD Reference:</b>	WELL @ 6480.0ft (Original Well Elev)
<b>Site:</b>	Section 8 (C08 799)	<b>North Reference:</b>	True
<b>Well:</b>	DH7A-32 C08 799	<b>Survey Calculation Method:</b>	Minimum Curvature
<b>Wellbore:</b>	HZ		
<b>Design:</b>	Plan #2		

Planned Survey									
Measured Depth (ft)	Inclination (°)	Azimuth (°)	Vertical Depth (ft)	+N/-S (ft)	+E/-W (ft)	Vertical Section (ft)	Dogleg Rate (°/100ft)	Build Rate (°/100ft)	Comments / Formations
4,900.0	10.26	258.80	4,830.8	-151.2	-763.9	-58.3	0.00	0.00	
4,913.4	10.26	258.80	4,844.0	-151.7	-766.3	-58.5	0.00	0.00	Mancos
5,000.0	10.26	258.80	4,929.2	-154.7	-781.4	-59.7	0.00	0.00	
5,100.0	10.26	258.80	5,027.6	-158.1	-798.9	-61.0	0.00	0.00	
5,200.0	10.26	258.80	5,126.0	-161.6	-816.3	-62.3	0.00	0.00	
5,300.0	10.26	258.80	5,224.4	-165.0	-833.8	-63.7	0.00	0.00	
5,400.0	10.26	258.80	5,322.8	-168.5	-851.3	-65.0	0.00	0.00	
5,500.0	10.26	258.80	5,421.2	-171.9	-868.7	-66.4	0.00	0.00	
5,600.0	10.26	258.80	5,519.6	-175.4	-886.2	-67.7	0.00	0.00	
5,700.0	10.26	258.80	5,618.0	-178.9	-903.7	-69.0	0.00	0.00	
5,800.0	10.26	258.80	5,716.4	-182.3	-921.2	-70.4	0.00	0.00	
5,900.0	10.26	258.80	5,814.8	-185.8	-938.6	-71.7	0.00	0.00	
6,000.0	10.26	258.80	5,913.2	-189.2	-956.1	-73.0	0.00	0.00	
6,100.0	10.26	258.80	6,011.6	-192.7	-973.6	-74.4	0.00	0.00	
6,200.0	10.26	258.80	6,110.0	-196.2	-991.1	-75.7	0.00	0.00	
6,300.0	10.26	258.80	6,208.4	-199.6	-1,008.5	-77.0	0.00	0.00	
6,400.0	10.26	258.80	6,306.8	-203.1	-1,026.0	-78.4	0.00	0.00	
6,500.0	10.26	258.80	6,405.2	-206.5	-1,043.5	-79.7	0.00	0.00	
6,600.0	10.26	258.80	6,503.6	-210.0	-1,060.9	-81.0	0.00	0.00	
6,700.0	10.26	258.80	6,602.0	-213.4	-1,078.4	-82.4	0.00	0.00	
6,800.0	10.26	258.80	6,700.4	-216.9	-1,095.9	-83.7	0.00	0.00	
6,859.6	10.26	258.80	6,759.0	-219.0	-1,106.3	-84.5	0.00	0.00	Niobrara
6,900.0	10.26	258.80	6,798.8	-220.4	-1,113.4	-85.0	0.00	0.00	
7,000.0	10.26	258.80	6,897.2	-223.8	-1,130.8	-86.4	0.00	0.00	
7,100.0	10.26	258.80	6,995.6	-227.3	-1,148.3	-87.7	0.00	0.00	
7,200.0	10.26	258.80	7,094.0	-230.7	-1,165.8	-89.0	0.00	0.00	
7,287.8	10.26	258.80	7,180.4	-233.8	-1,181.1	-90.2	0.00	0.00	Start 10° Build @ 7,287' MD
7,300.0	10.10	265.65	7,192.4	-234.1	-1,183.3	-90.2	10.00	-1.27	
7,400.0	13.68	312.73	7,290.5	-226.7	-1,200.7	-80.8	10.00	3.58	
7,500.0	21.69	333.08	7,385.7	-202.1	-1,217.8	-54.4	10.00	8.00	
7,600.0	30.84	342.32	7,475.4	-161.1	-1,234.0	-11.7	10.00	9.15	
7,700.0	40.37	347.57	7,556.6	-104.9	-1,248.8	45.8	10.00	9.53	
7,735.6	43.80	348.96	7,583.0	-81.6	-1,253.7	69.6	10.00	9.65	Nio1Kit
7,800.0	50.06	351.08	7,627.0	-35.3	-1,261.8	116.6	10.00	9.71	
7,900.0	59.82	353.70	7,684.3	45.8	-1,272.5	198.3	10.00	9.77	
8,000.0	69.63	355.85	7,727.0	135.7	-1,280.6	288.6	10.00	9.81	
8,100.0	79.47	357.74	7,753.6	231.8	-1,286.0	384.6	10.00	9.83	
8,200.0	89.31	359.52	7,763.4	331.2	-1,288.3	483.6	10.00	9.84	
8,217.2	91.00	359.82	7,763.3	348.4	-1,288.4	500.6	10.00	9.85	LP @ 7,763' TVD, 91° - DH7A-32 C08 799 LP
8,300.0	91.00	359.82	7,761.9	431.2	-1,288.7	582.9	0.00	0.00	
8,400.0	91.00	359.82	7,760.1	531.2	-1,289.0	682.2	0.00	0.00	
8,500.0	91.00	359.82	7,758.4	631.2	-1,289.3	781.5	0.00	0.00	
8,600.0	91.00	359.82	7,756.6	731.1	-1,289.7	880.8	0.00	0.00	
8,700.0	91.00	359.82	7,754.9	831.1	-1,290.0	980.1	0.00	0.00	
8,800.0	91.00	359.82	7,753.1	931.1	-1,290.3	1,079.4	0.00	0.00	
8,900.0	91.00	359.82	7,751.4	1,031.1	-1,290.6	1,178.7	0.00	0.00	
9,000.0	91.00	359.82	7,749.6	1,131.1	-1,290.9	1,278.0	0.00	0.00	
9,100.0	91.00	359.82	7,747.9	1,231.1	-1,291.3	1,377.3	0.00	0.00	
9,200.0	91.00	359.82	7,746.1	1,331.1	-1,291.6	1,476.6	0.00	0.00	
9,300.0	91.00	359.82	7,744.4	1,431.0	-1,291.9	1,575.9	0.00	0.00	
9,400.0	91.00	359.82	7,742.6	1,531.0	-1,292.2	1,675.2	0.00	0.00	
9,500.0	91.00	359.82	7,740.9	1,631.0	-1,292.5	1,774.5	0.00	0.00	

# Cathedral Energy Services

## Planning Report

<b>Database:</b>	EDM 5000.1 US Multi Users DB	<b>Local Co-ordinate Reference:</b>	Well DH7A-32 C08 799
<b>Company:</b>	EnCana Oil & Gas (USA) Inc	<b>TVD Reference:</b>	WELL @ 6480.0ft (Original Well Elev)
<b>Project:</b>	Kimball Mtn	<b>MD Reference:</b>	WELL @ 6480.0ft (Original Well Elev)
<b>Site:</b>	Section 8 (C08 799)	<b>North Reference:</b>	True
<b>Well:</b>	DH7A-32 C08 799	<b>Survey Calculation Method:</b>	Minimum Curvature
<b>Wellbore:</b>	HZ		
<b>Design:</b>	Plan #2		

Planned Survey									
Measured Depth (ft)	Inclination (°)	Azimuth (°)	Vertical Depth (ft)	+N/-S (ft)	+E/-W (ft)	Vertical Section (ft)	Dogleg Rate (°/100ft)	Build Rate (°/100ft)	Comments / Formations
9,600.0	91.00	359.82	7,739.1	1,731.0	-1,292.9	1,873.7	0.00	0.00	
9,700.0	91.00	359.82	7,737.4	1,831.0	-1,293.2	1,973.0	0.00	0.00	
9,800.0	91.00	359.82	7,735.6	1,931.0	-1,293.5	2,072.3	0.00	0.00	
9,900.0	91.00	359.82	7,733.9	2,030.9	-1,293.8	2,171.6	0.00	0.00	
10,000.0	91.00	359.82	7,732.1	2,130.9	-1,294.2	2,270.9	0.00	0.00	
10,100.0	91.00	359.82	7,730.4	2,230.9	-1,294.5	2,370.2	0.00	0.00	
10,200.0	91.00	359.82	7,728.7	2,330.9	-1,294.8	2,469.5	0.00	0.00	
10,300.0	91.00	359.82	7,726.9	2,430.9	-1,295.1	2,568.8	0.00	0.00	
10,400.0	91.00	359.82	7,725.2	2,530.9	-1,295.4	2,668.1	0.00	0.00	
10,500.0	91.00	359.82	7,723.4	2,630.8	-1,295.8	2,767.4	0.00	0.00	
10,600.0	91.00	359.82	7,721.7	2,730.8	-1,296.1	2,866.7	0.00	0.00	
10,700.0	91.00	359.82	7,719.9	2,830.8	-1,296.4	2,966.0	0.00	0.00	
10,800.0	91.00	359.82	7,718.2	2,930.8	-1,296.7	3,065.3	0.00	0.00	
10,900.0	91.00	359.82	7,716.4	3,030.8	-1,297.0	3,164.6	0.00	0.00	
11,000.0	91.00	359.82	7,714.7	3,130.8	-1,297.4	3,263.9	0.00	0.00	
11,100.0	91.00	359.82	7,712.9	3,230.8	-1,297.7	3,363.2	0.00	0.00	
11,200.0	91.00	359.82	7,711.2	3,330.7	-1,298.0	3,462.5	0.00	0.00	
11,300.0	91.00	359.82	7,709.4	3,430.7	-1,298.3	3,561.8	0.00	0.00	
11,400.0	91.00	359.82	7,707.7	3,530.7	-1,298.6	3,661.1	0.00	0.00	
11,500.0	91.00	359.82	7,705.9	3,630.7	-1,299.0	3,760.4	0.00	0.00	
11,600.0	91.00	359.82	7,704.2	3,730.7	-1,299.3	3,859.7	0.00	0.00	
11,700.0	91.00	359.82	7,702.4	3,830.7	-1,299.6	3,959.0	0.00	0.00	
11,800.0	91.00	359.82	7,700.7	3,930.6	-1,299.9	4,058.3	0.00	0.00	
11,900.0	91.00	359.82	7,698.9	4,030.6	-1,300.2	4,157.6	0.00	0.00	
12,000.0	91.00	359.82	7,697.2	4,130.6	-1,300.6	4,256.9	0.00	0.00	
12,100.0	91.00	359.82	7,695.4	4,230.6	-1,300.9	4,356.2	0.00	0.00	
12,200.0	91.00	359.82	7,693.7	4,330.6	-1,301.2	4,455.5	0.00	0.00	
12,300.0	91.00	359.82	7,691.9	4,430.6	-1,301.5	4,554.8	0.00	0.00	
12,400.0	91.00	359.82	7,690.2	4,530.5	-1,301.9	4,654.1	0.00	0.00	
12,500.0	91.00	359.82	7,688.4	4,630.5	-1,302.2	4,753.4	0.00	0.00	
12,600.0	91.00	359.82	7,686.7	4,730.5	-1,302.5	4,852.7	0.00	0.00	
12,700.0	91.00	359.82	7,685.0	4,830.5	-1,302.8	4,952.0	0.00	0.00	
12,800.0	91.00	359.82	7,683.2	4,930.5	-1,303.1	5,051.3	0.00	0.00	
12,900.0	91.00	359.82	7,681.5	5,030.5	-1,303.5	5,150.6	0.00	0.00	
13,000.0	91.00	359.82	7,679.7	5,130.5	-1,303.8	5,249.9	0.00	0.00	
13,100.0	91.00	359.82	7,678.0	5,230.4	-1,304.1	5,349.2	0.00	0.00	
13,200.0	91.00	359.82	7,676.2	5,330.4	-1,304.4	5,448.5	0.00	0.00	
13,300.0	91.00	359.82	7,674.5	5,430.4	-1,304.7	5,547.8	0.00	0.00	
13,400.0	91.00	359.82	7,672.7	5,530.4	-1,305.1	5,647.1	0.00	0.00	
13,500.0	91.00	359.82	7,671.0	5,630.4	-1,305.4	5,746.4	0.00	0.00	
13,600.0	91.00	359.82	7,669.2	5,730.4	-1,305.7	5,845.7	0.00	0.00	
13,700.0	91.00	359.82	7,667.5	5,830.3	-1,306.0	5,945.0	0.00	0.00	
13,800.0	91.00	359.82	7,665.7	5,930.3	-1,306.3	6,044.3	0.00	0.00	
13,900.0	91.00	359.82	7,664.0	6,030.3	-1,306.7	6,143.6	0.00	0.00	
14,000.0	91.00	359.82	7,662.2	6,130.3	-1,307.0	6,242.9	0.00	0.00	
14,100.0	91.00	359.82	7,660.5	6,230.3	-1,307.3	6,342.2	0.00	0.00	
14,200.0	91.00	359.82	7,658.7	6,330.3	-1,307.6	6,441.5	0.00	0.00	
14,300.0	91.00	359.82	7,657.0	6,430.2	-1,307.9	6,540.8	0.00	0.00	
14,400.0	91.00	359.82	7,655.2	6,530.2	-1,308.3	6,640.1	0.00	0.00	
14,500.0	91.00	359.82	7,653.5	6,630.2	-1,308.6	6,739.4	0.00	0.00	
14,600.0	91.00	359.82	7,651.7	6,730.2	-1,308.9	6,838.7	0.00	0.00	
14,700.0	91.00	359.82	7,650.0	6,830.2	-1,309.2	6,938.0	0.00	0.00	

# Cathedral Energy Services

## Planning Report

<b>Database:</b>	EDM 5000.1 US Multi Users DB	<b>Local Co-ordinate Reference:</b>	Well DH7A-32 C08 799
<b>Company:</b>	EnCana Oil & Gas (USA) Inc	<b>TVD Reference:</b>	WELL @ 6480.0ft (Original Well Elev)
<b>Project:</b>	Kimball Mtn	<b>MD Reference:</b>	WELL @ 6480.0ft (Original Well Elev)
<b>Site:</b>	Section 8 (C08 799)	<b>North Reference:</b>	True
<b>Well:</b>	DH7A-32 C08 799	<b>Survey Calculation Method:</b>	Minimum Curvature
<b>Wellbore:</b>	HZ		
<b>Design:</b>	Plan #2		

Planned Survey									
Measured Depth (ft)	Inclination (°)	Azimuth (°)	Vertical Depth (ft)	+N/-S (ft)	+E/-W (ft)	Vertical Section (ft)	Dogleg Rate (°/100ft)	Build Rate (°/100ft)	Comments / Formations
14,800.0	91.00	359.82	7,648.2	6,930.2	-1,309.6	7,037.3	0.00	0.00	
14,900.0	91.00	359.82	7,646.5	7,030.2	-1,309.9	7,136.6	0.00	0.00	
15,000.0	91.00	359.82	7,644.8	7,130.1	-1,310.2	7,235.9	0.00	0.00	
15,100.0	91.00	359.82	7,643.0	7,230.1	-1,310.5	7,335.2	0.00	0.00	
15,200.0	91.00	359.82	7,641.3	7,330.1	-1,310.8	7,434.5	0.00	0.00	
15,300.0	91.00	359.82	7,639.5	7,430.1	-1,311.2	7,533.8	0.00	0.00	
15,400.0	91.00	359.82	7,637.8	7,530.1	-1,311.5	7,633.1	0.00	0.00	
15,500.0	91.00	359.82	7,636.0	7,630.1	-1,311.8	7,732.4	0.00	0.00	
15,600.0	91.00	359.82	7,634.3	7,730.0	-1,312.1	7,831.7	0.00	0.00	
15,700.0	91.00	359.82	7,632.5	7,830.0	-1,312.4	7,931.0	0.00	0.00	
15,800.0	91.00	359.82	7,630.8	7,930.0	-1,312.8	8,030.3	0.00	0.00	
15,900.0	91.00	359.82	7,629.0	8,030.0	-1,313.1	8,129.6	0.00	0.00	
16,000.0	91.00	359.82	7,627.3	8,130.0	-1,313.4	8,228.9	0.00	0.00	
16,100.0	91.00	359.82	7,625.5	8,230.0	-1,313.7	8,328.2	0.00	0.00	
16,200.0	91.00	359.82	7,623.8	8,329.9	-1,314.0	8,427.5	0.00	0.00	
16,300.0	91.00	359.82	7,622.0	8,429.9	-1,314.4	8,526.8	0.00	0.00	
16,400.0	91.00	359.82	7,620.3	8,529.9	-1,314.7	8,626.1	0.00	0.00	
16,500.0	91.00	359.82	7,618.5	8,629.9	-1,315.0	8,725.4	0.00	0.00	
16,600.0	91.00	359.82	7,616.8	8,729.9	-1,315.3	8,824.7	0.00	0.00	
16,700.0	91.00	359.82	7,615.0	8,829.9	-1,315.7	8,924.0	0.00	0.00	
16,800.0	91.00	359.82	7,613.3	8,929.8	-1,316.0	9,023.3	0.00	0.00	
16,900.0	91.00	359.82	7,611.5	9,029.8	-1,316.3	9,122.6	0.00	0.00	
17,000.0	91.00	359.82	7,609.8	9,129.8	-1,316.6	9,221.9	0.00	0.00	
17,100.0	91.00	359.82	7,608.0	9,229.8	-1,316.9	9,321.2	0.00	0.00	
17,200.0	91.00	359.82	7,606.3	9,329.8	-1,317.3	9,420.5	0.00	0.00	
17,300.0	91.00	359.82	7,604.5	9,429.8	-1,317.6	9,519.8	0.00	0.00	
17,400.0	91.00	359.82	7,602.8	9,529.8	-1,317.9	9,619.1	0.00	0.00	
17,500.0	91.00	359.82	7,601.1	9,629.7	-1,318.2	9,718.4	0.00	0.00	
17,600.0	91.00	359.82	7,599.3	9,729.7	-1,318.5	9,817.7	0.00	0.00	
17,700.0	91.00	359.82	7,597.6	9,829.7	-1,318.9	9,917.0	0.00	0.00	
17,800.0	91.00	359.82	7,595.8	9,929.7	-1,319.2	10,016.3	0.00	0.00	
17,900.0	91.00	359.82	7,594.1	10,029.7	-1,319.5	10,115.6	0.00	0.00	
18,000.0	91.00	359.82	7,592.3	10,129.7	-1,319.8	10,214.9	0.00	0.00	
18,100.0	91.00	359.82	7,590.6	10,229.6	-1,320.1	10,314.2	0.00	0.00	
18,200.0	91.00	359.82	7,588.8	10,329.6	-1,320.5	10,413.4	0.00	0.00	
18,300.0	91.00	359.82	7,587.1	10,429.6	-1,320.8	10,512.7	0.00	0.00	
18,400.0	91.00	359.82	7,585.3	10,529.6	-1,321.1	10,612.0	0.00	0.00	
18,500.0	91.00	359.82	7,583.6	10,629.6	-1,321.4	10,711.3	0.00	0.00	
18,600.0	91.00	359.82	7,581.8	10,729.6	-1,321.7	10,810.6	0.00	0.00	
18,700.0	91.00	359.82	7,580.1	10,829.5	-1,322.1	10,909.9	0.00	0.00	
18,800.0	91.00	359.82	7,578.3	10,929.5	-1,322.4	11,009.2	0.00	0.00	TD @ 18,800' MD - DH7A-32 C08 799 PBHL



# Cathedral Energy Services

## Planning Report

<b>Database:</b>	EDM 5000.1 US Multi Users DB	<b>Local Co-ordinate Reference:</b>	Well DH7A-32 C08 799
<b>Company:</b>	EnCana Oil & Gas (USA) Inc	<b>TVD Reference:</b>	WELL @ 6480.0ft (Original Well Elev)
<b>Project:</b>	Kimball Mtn	<b>MD Reference:</b>	WELL @ 6480.0ft (Original Well Elev)
<b>Site:</b>	Section 8 (C08 799)	<b>North Reference:</b>	True
<b>Well:</b>	DH7A-32 C08 799	<b>Survey Calculation Method:</b>	Minimum Curvature
<b>Wellbore:</b>	HZ		
<b>Design:</b>	Plan #2		

Targets									
Target Name	Dip Angle	Dip Dir.	TVD	+N/-S	+E/-W	Northing	Easting	Latitude	Longitude
- hit/miss target	(°)	(°)	(ft)	(ft)	(ft)	(ft)	(ft)		
- Shape									
DH7A-32 C08 799 LP	0.00	0.00	7,763.3	348.4	-1,288.4	1,608,577.91	2,161,353.79	39° 27' 59.97 N	108° 28' 16.02 W
- plan hits target center									
- Point									
DH7A-32 C08 799 PBHL	0.00	0.00	7,578.3	10,929.5	-1,322.4	1,619,154.52	2,161,665.32	39° 29' 44.55 N	108° 28' 16.46 W
- plan hits target center									
- Point									

Formations						
Measured Depth	Vertical Depth	Name	Lithology	Dip	Dip Direction	
(ft)	(ft)			(°)	(°)	
1,525.3	1,510.0	Williams Fork				
3,897.2	3,844.0	Rollins				
4,913.4	4,844.0	Mancos				
6,859.6	6,759.0	Niobrara				
7,735.6	7,583.0	Nio1Kit				

Plan Annotations					
Measured Depth	Vertical Depth	Local Coordinates			
(ft)	(ft)	+N/-S	+E/-W	Comment	
(ft)	(ft)	(ft)	(ft)		
400.0	400.0	0.0	0.0	KOP @ 400'	
656.5	655.1	-4.4	-22.5	EOB @ Inc. = 10.26°	
7,287.8	7,180.4	-233.8	-1,181.1	Start 10° Build @ 7,287' MD	
8,217.2	7,763.3	348.4	-1,288.4	LP @ 7,763' TVD, 91°	
18,800.0	7,578.3	10,929.5	-1,322.4	TD @ 18,800' MD	