

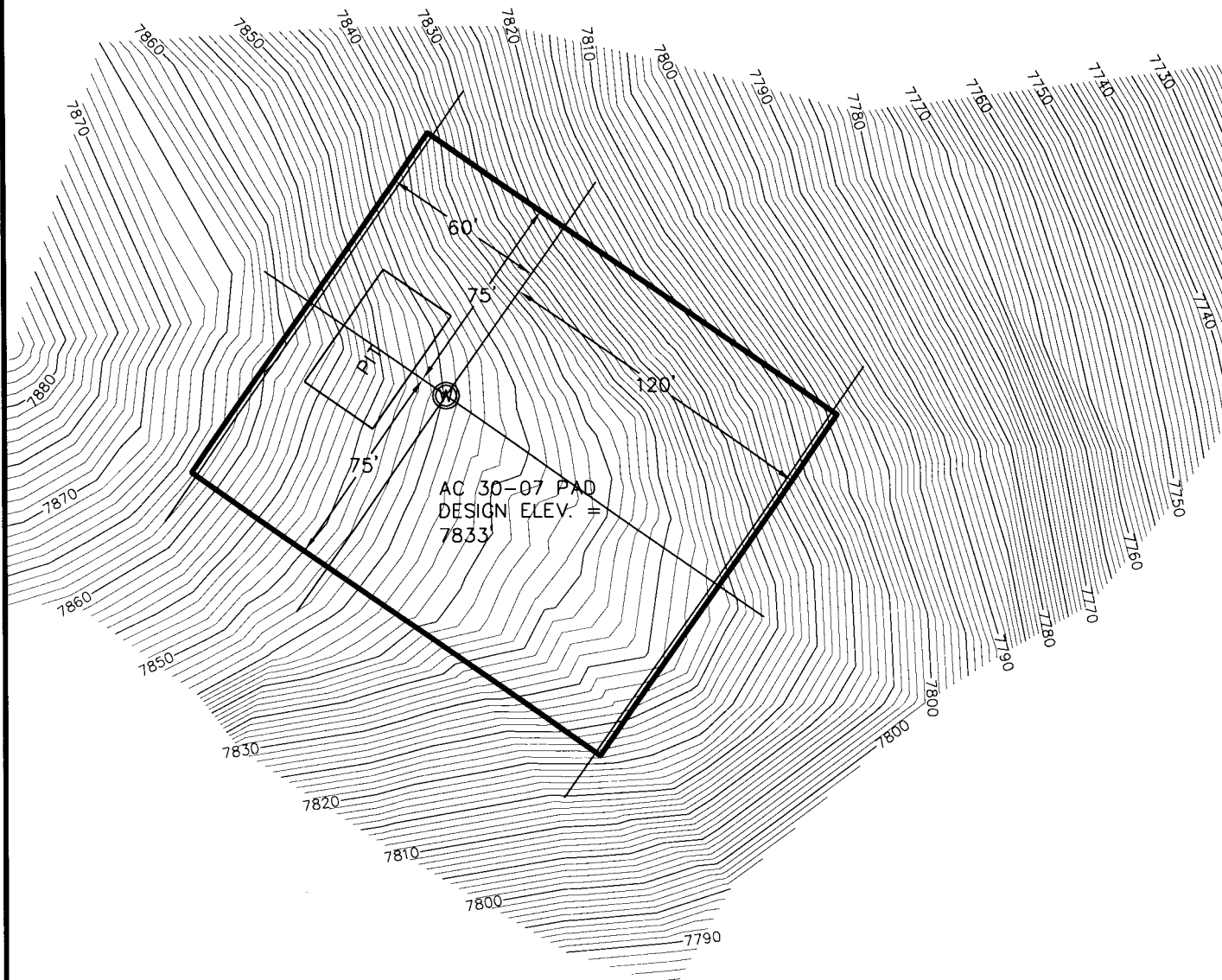

SCALE: 1" = 60'

CONSTRUCTION LAYOUT DRAWING

AC 30-07



NOTES:

1. UNGRADED ELEVATION AT WELLHEAD: 7845'
2. GRADED ELEVATION AT WELLHEAD: 7833'



DRAWN BY: NLE
DATE: 02/02/2011
AC 30-07 -CONST
DRAWING NAME:

APACHE CANYON 30-07
WELL PAD PLAN
XTO ENERGY INC.
LAS ANIMAS COUNTY, COLORADO

PAGE 1/4
REV A



SCALE: 1" = 60'

CONSTRUCTION LAYOUT DRAWING

AC 30-07

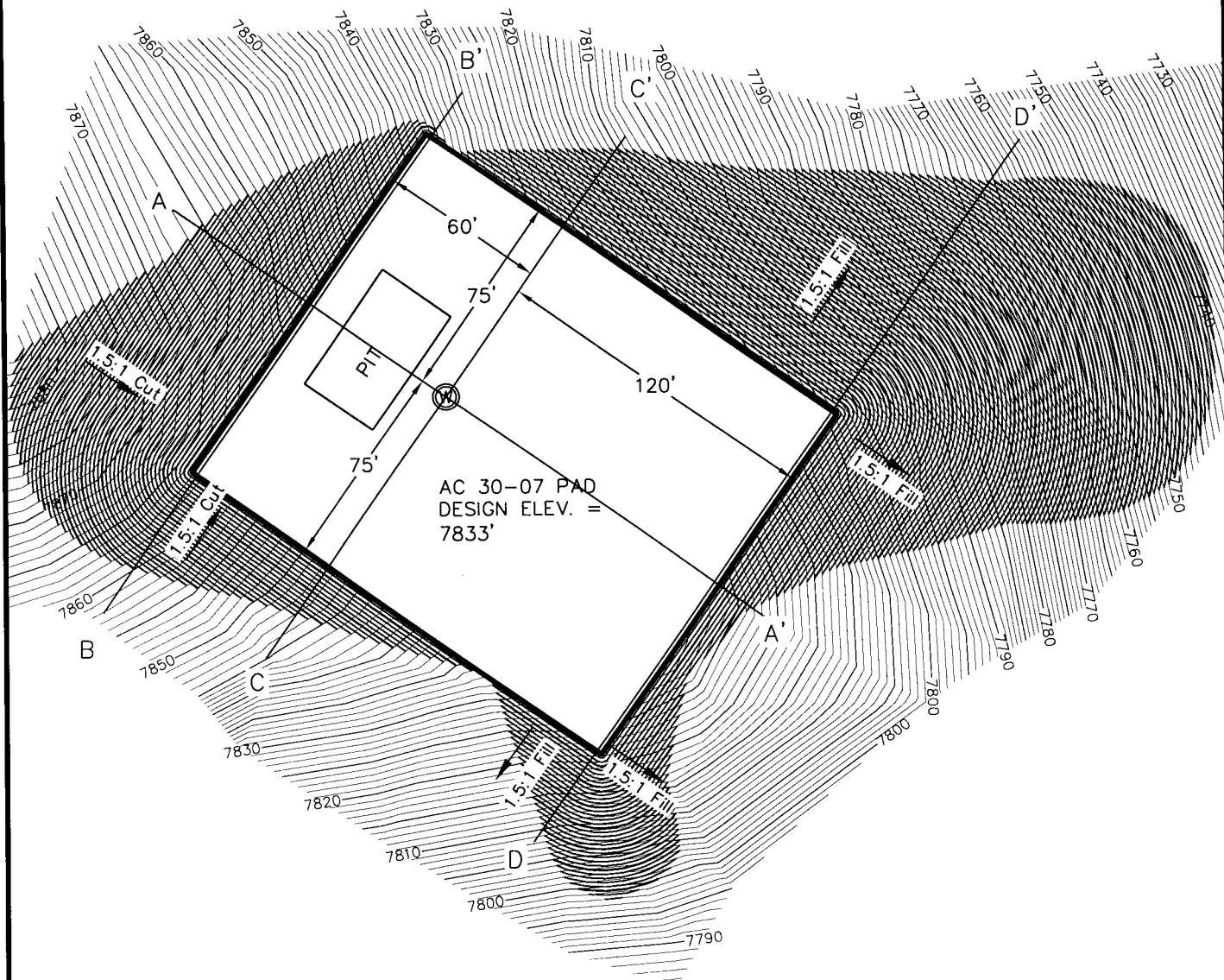

DRAWN BY: NLE
DATE: 02/02/2011
AC 30-07 -CONST
DRAWING NAME:

APACHE CANYON 30-07
WELL PAD PLAN
XTO ENERGY INC.
LAS ANIMAS COUNTY, COLORADO

PAGE
2/4
REV
A



SCALE: 1" = 60'

CONSTRUCTION LAYOUT DRAWING

AC 30-07

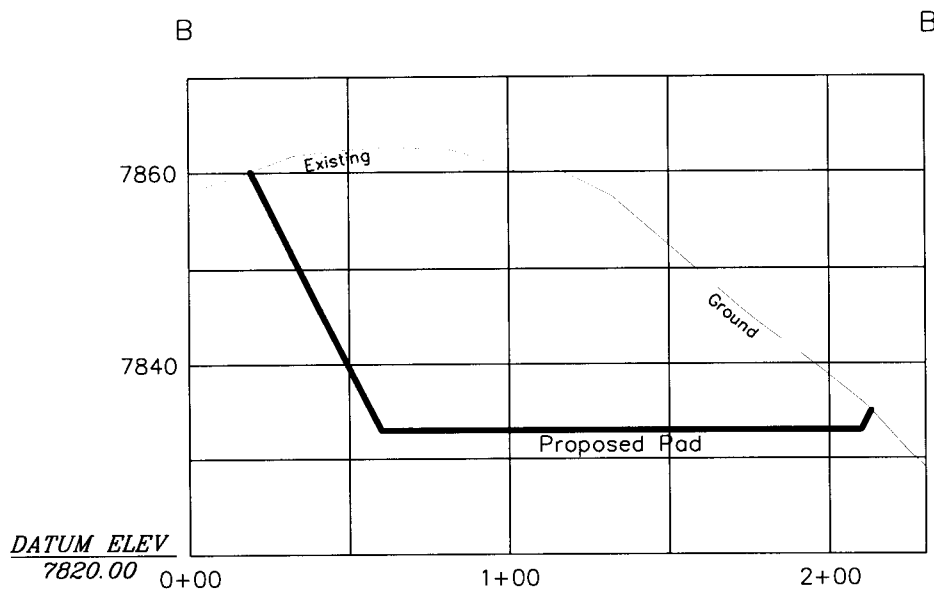
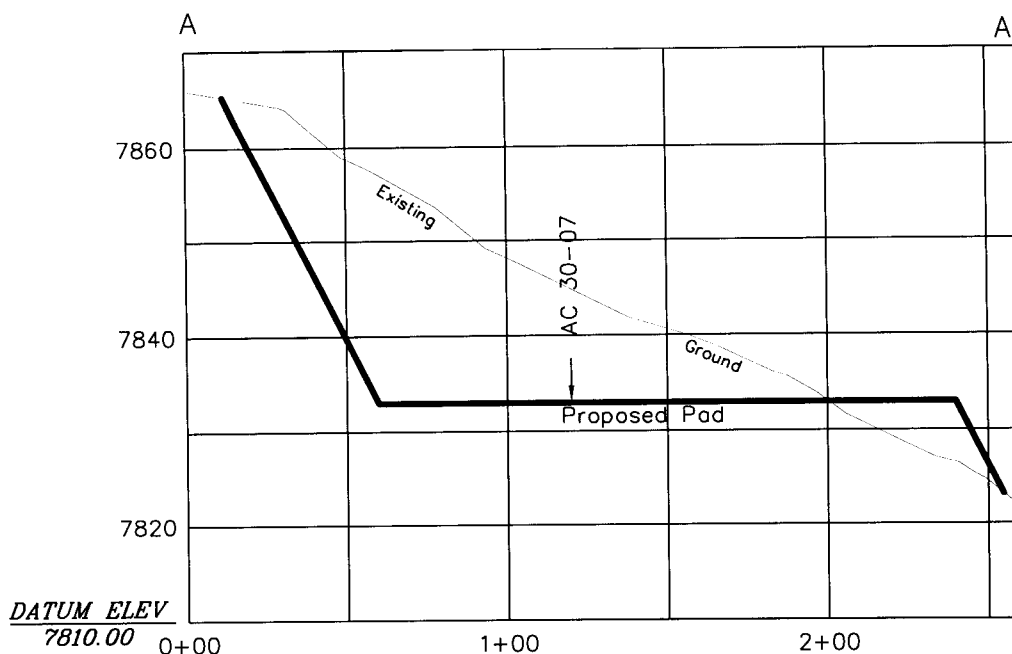

HORIZONTAL SCALE: 1" = 60'
VERTICAL SCALE: 1" = 20'



DRAWN BY: NLE
DATE: 02/02/2011
AC 30-07 -CONST
DRAWING NAME:

APACHE CANYON 30-07
WELL PAD PLAN
XTO ENERGY INC.
LAS ANIMAS COUNTY, COLORADO

PAGE
3/4
REV
A



SCALE: 1" = 60'

CONSTRUCTION LAYOUT DRAWING

AC 30-07

C

C'

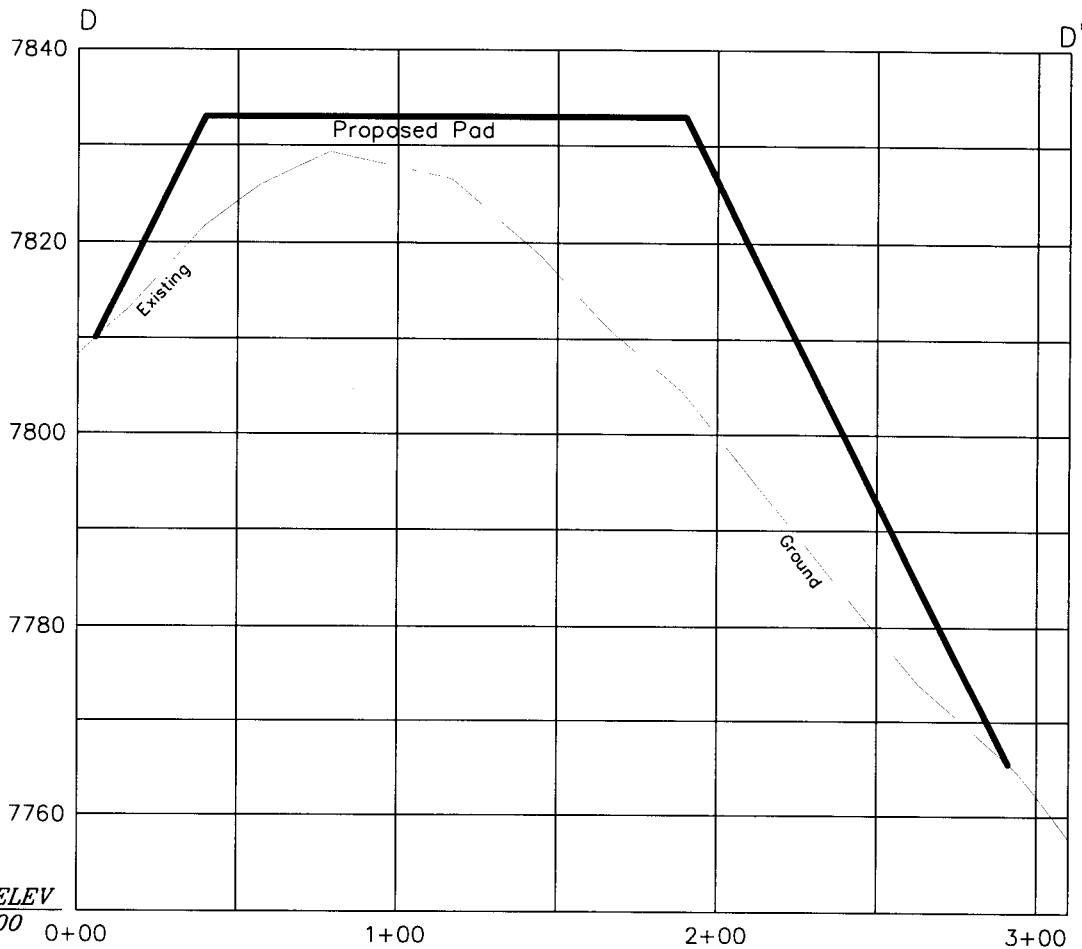
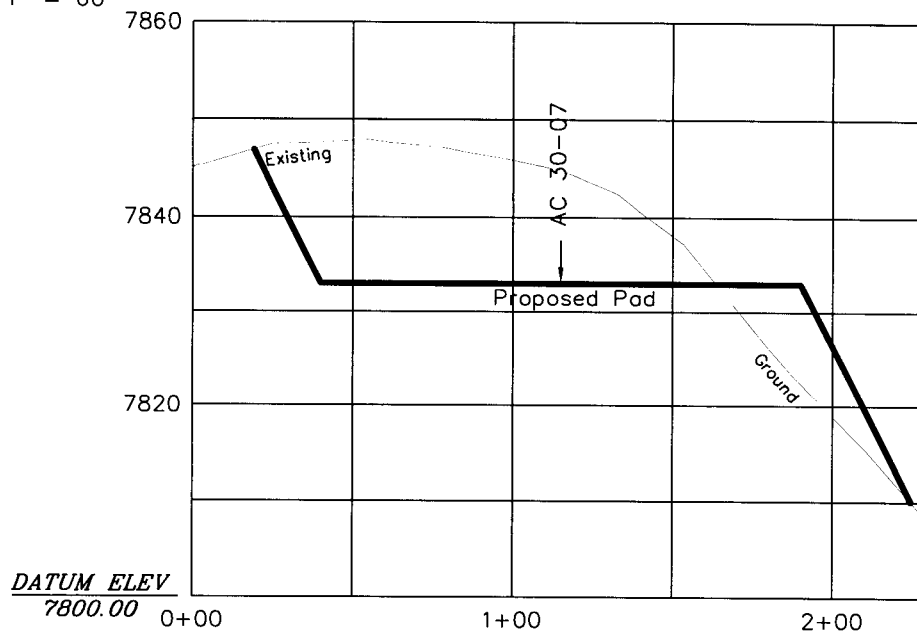

HORIZONTAL SCALE: 1" = 60'
VERTICAL SCALE: 1" = 20'



DRAWN BY: NLE
DATE: 02/02/2011
AC 30-07-CONST
DRAWING NAME:

APACHE CANYON 30-07
WELL PAD PLAN
XTO ENERGY INC.
LAS ANIMAS COUNTY, COLORADO

PAGE
4/4
REV
A