

804 Grand Ave.
Platteville, CO 80651



Tel: 970.785.5000
After Hours: 303.939.8585
Fax: 970.785.5099
www.nobleenergyinc.com

North America Division

Remediation #5137

May 2, 2011

Mr. Bob Chesson
Department Of Natural Resources
Oil & Gas Conservation Commission
1120 Lincoln St., Suite 801
Denver CO 80203-2136

RE: Ground water monitoring report and closure request letter
McClellan 3-31, 32, 35
API 05-123-11347
NESW Sec. 3, T4N R65W
Weld County, Colorado

Dear Mr. Chesson:

Please find attached the fourth quarter ground water monitor report for the McClellan 3-1, 32, 35. Based on the site remedial activities and the attached laboratory analytical results, Noble Energy, Inc. is requesting that the COGCC consider this location closed, requiring no further action.

Noble Energy Inc. would like to claim business confidentiality protection for the information submitted in this letter, the supporting materials attached and all previous and subsequent correspondence related to this matter. Please contact the Noble Energy Environmental Department at (970) 785-5000 if you have any questions or require additional information.

Sincerely,

A handwritten signature in black ink, appearing to read 'Mike Cox'.

Mike Cox
Environmental Coordinator

A handwritten signature in blue ink, appearing to read 'Todd Cullum'.

Todd Cullum
Environmental Specialist

Attachments



GROUNDWATER MONITORING REPORT/ NO FURTHER ACTION REQUEST APRIL 2011

McCLELLAN 3-1, 3-32, 3-35

LT Environmental, Inc. (LTE), under the direction of Noble Energy, Inc. (Noble), conducted groundwater monitoring at the McClellan 3-1, 3-32, 3-35 Tank Battery (Site) on April 5, 2011. This monitoring event constitutes the fourth post-remediation monitoring event at this Site. Site history, remediation activities, well installation, and performance monitoring results have been described in preceding reports.

Monitoring wells (MW01, MW02, and MW03) were installed on July 15, 2010. A Site Map is presented as Figure 1. Groundwater level measurements were collected from the monitoring wells and are summarized in Table 1.

Depth to groundwater, which ranged from 3.76 feet below top of casing (btoc) in MW03 to 4.58 feet btoc in MW01, was used to calculate well-specific purge volumes. Following purging, samples were submitted to Origins Laboratory, Inc. of Denver, Colorado for analysis of benzene, toluene, ethylbenzene, and total xylenes (BTEX) by United States Environmental Protection Agency Method 8260C.

Groundwater analytical results, presented in Table 1, indicate BTEX concentrations are in compliance with Colorado Department of Public Health and Environment-Water Quality Control Commission Regulation 41 (WQCC Reg 41). The laboratory analytical report is included in the Appendix.

As detailed in the *Remediation Summary Report* (July 2010), soil impacts have been removed to below the regulatory standards. The April 2011 groundwater monitoring event constitutes the fourth consecutive quarterly monitoring event in which groundwater analytical results have been in compliance with WQCC Reg 41. As soil and groundwater have been remediated to achieve cleanup goals, Noble requests that the Colorado Oil and Gas Conservation Commission grant a No Further Action status for the McClellan 3-1, 3-32, 3-35 Tank Battery.

FIGURE

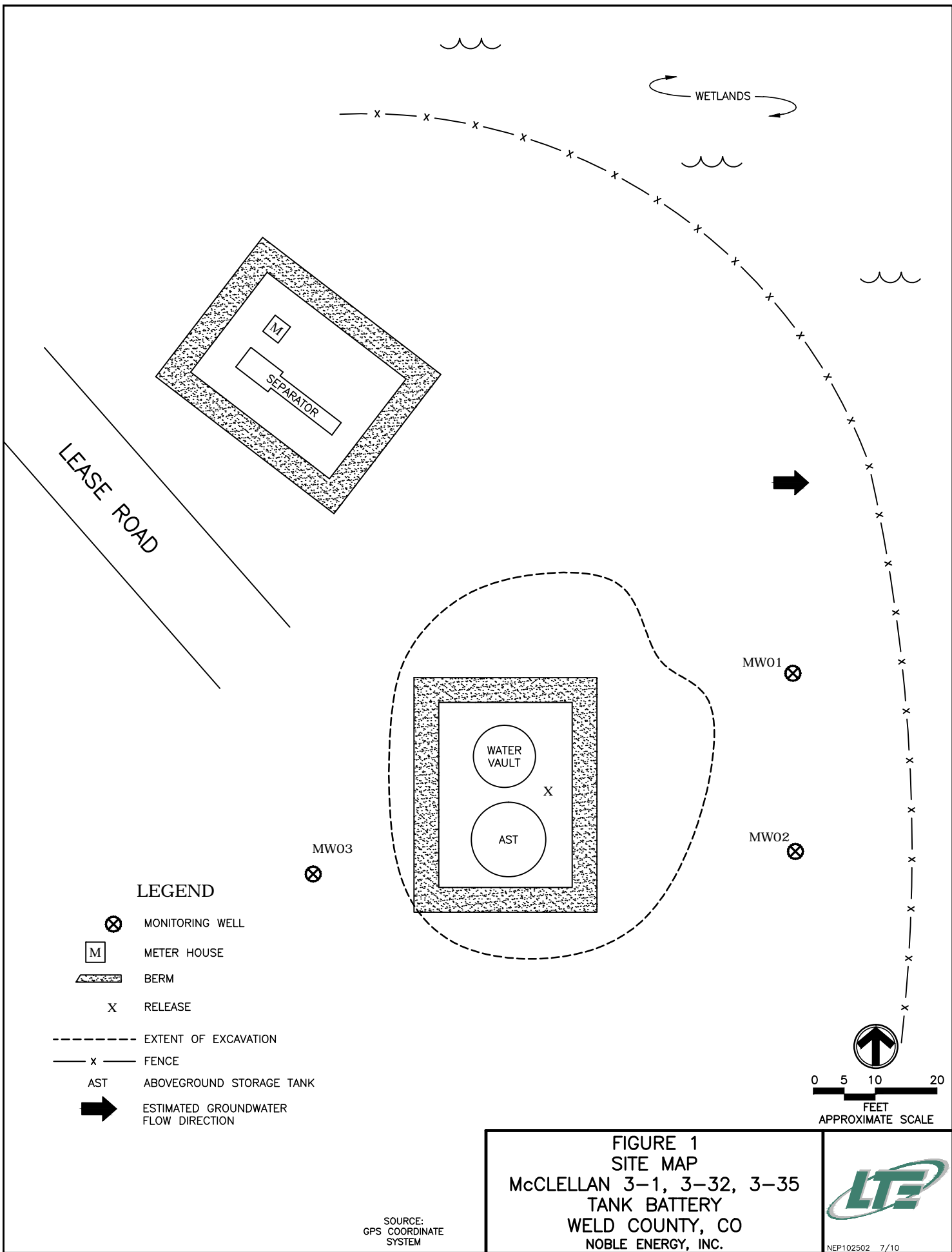

TABLE

TABLE 1

**GROUNDWATER ANALYTICAL DATA
McCLELLAN 3-1, 3-32, 3-35 TANK BATTERY
WELD COUNTY, COLORADO
NOBLE ENERGY, INC.**

MONITORING WELL	DATE	DEPTH TO WATER (feet btoc)	BENZENE (µg/L)	TOLUENE (µg/L)	ETHYLBENZENE (µg/L)	TOTAL XYLENES (µg/L)
MW01	7/20/2010	4.36	<1.0	<1.0	<1.0	<1.0
	10/21/2010	4.24	<1.0	<1.0	<1.0	<3.0
	1/12/2011	4.69	<1.0	<1.0	<1.0	<1.0
	4/5/2011	4.58	<1.0	<1.0	<1.0	<3.0
MW02	7/20/2010	3.23	<1.0	<1.0	<1.0	<1.0
	10/21/2010	3.17	<1.0	<1.0	<1.0	<3.0
	1/12/2011	3.71	<1.0	<1.0	<1.0	<1.0
	4/5/2011	4.31	<1.0	<1.0	<1.0	<3.0
MW03	7/20/2010	3.41	<1.0	<1.0	<1.0	<1.0
	10/21/2010	3.20	<1.0	<1.0	<1.0	<3.0
	1/12/2011	3.87	<1.0	<1.0	<1.0	<1.0
	4/5/2011	3.76	<1.0	<1.0	<1.0	<3.0
CDPHE WQCC Reg 41			5.0	560	700	1,400

NOTES:

btoc - below top of casing

µg/L - micrograms per liter

< - indicates result is less than the stated laboratory method reporting limit

CDPHE WQCC Reg 41 - Colorado Department of Public Health and Environment - Water Quality Control

Commission Regulation 41 covering Basic Standards for Ground Water

Benzene, toluene, ethylbenzene, and total xylenes analyzed by EPA Method 8260B and 8260C, based on dates.

APPENDIX
ANALYTICAL REPORT



April 08, 2011

LT Environmental, Inc.

Rob Rebel

4600 West 60th Avenue

Arvada CO 80003

Project Name - Noble - McClellan 3-1

Project Number - NEP1025

Attached are you analytical results for Noble - McClellan 3-1 received by Origins Laboratory, Inc. April 05, 2011. This project is associated with Origins project number X104037-01.

The analytical results in the following report were analyzed under the guidelines of EPA Methods specified in SW-846. The analytical results apply specifically to the samples and analyses specified per the attached Chain of Custody.

Thank you for selecting Origins for your analytical needs. Please contact us with any questions concerning this report, or if we can help with anything at all.

Origins Laboratory, Inc.
303.433.1322
o-squad@oelabinc.com



LT Environmental, Inc.
4600 West 60th Avenue
Arvada CO 80003

Project Number: NEP1025
Project Name: Noble - McClellan 3-1

CROSS REFERENCE REPORT

Sample ID	Laboratory ID	Matrix	Date Sampled	Date Received
MW-01	X104037-01	Water	April 5, 2011 13:50	04/05/2011 16:15
MW-02	X104037-02	Water	April 5, 2011 13:55	04/05/2011 16:15
MW-03	X104037-03	Water	April 5, 2011 14:05	04/05/2011 16:15

Origins Laboratory, Inc.



Noelle E Doyle, President

The results in this report apply to the samples analyzed in accordance with the chain of custody document. This analytical report must be reproduced in its entirety.

LT Environmental, Inc.
4600 West 60th Avenue
Arvada CO 80003

Project Number: NEP1025
Project Name: Noble - McClellan 3-1

www.originslaboratory.com

104037 page 1 of 1

Client: LTE
Address:
Telephone Number:
Email Address:

Project Manager: Rob Rebe
Project Name: McClellan 3-1, 3-22, 3-35
Project Number: NEP1025
Samples Collected By: D Burns, L Howell

1725 Elk Place | Denver, CO 80211 | Phone: 303.433.1322 | Fax: 303.265.9645

Sample ID Description	Date Sampled	Time Sampled	# of Containers	Preservative				Matrix			Analysis	Sample Instructions	
				Unpreserved	HCl	HNO ₃	Other	Groundwater	Soil	Air Summ #			Other
M1001	4.5.11	1350	2	X				X					1
M1002	4.5.11	1355	2	X				X					2
M1003	4.5.11	1405	2	X				X					3
													4
													5
													6
													7
													8
													9
													10

Relinquished By:	Date:	Time:	Received By:	Date:	Time:	Turnaround Time:
<u>[Signature]</u>	4.5.11	1615	<u>[Signature]</u>	4.5.11	1615	Same Day <input type="checkbox"/> 24 Hr <input type="checkbox"/> 48 Hr <input type="checkbox"/> 72 Hr <input checked="" type="checkbox"/> Standard <input type="checkbox"/>

Origins Laboratory, Inc.

Noelle E Doyle

Noelle E Doyle, President

The results in this report apply to the samples analyzed in accordance with the chain of custody document. This analytical report must be reproduced in its entirety.

LT Environmental, Inc.
4600 West 60th Avenue
Arvada CO 80003

Project Number: NEP1025
Project Name: Noble - McClellan 3-1

MW-01

4/5/2011 1:50:00PM

Analyte	Result	Reporting Limit	Units	Dilution	Batch	Prepared	Analyzed	Notes
---------	--------	--------------------	-------	----------	-------	----------	----------	-------

Origins Laboratory, Inc.
X104037-01 (Water)

BTEX by EPA 8260C

Benzene	ND	1.00	ug/L	1	1D06006	04/06/2011	04/07/2011
Toluene	ND	1.00	"	"	"	"	"
Ethylbenzene	ND	1.00	"	"	"	"	"
Xylenes, total	ND	3.00	"	"	"	"	"

Surrogate: 1,2-Dichloroethane-d4	97.9 %	70-130	"	"	"
Surrogate: Toluene-d8	104 %	70-130	"	"	"
Surrogate: 4-Bromofluorobenzene	109 %	70-130	"	"	"

Origins Laboratory, Inc.



Noelle E Doyle, President

The results in this report apply to the samples analyzed in accordance with the chain of custody document. This analytical report must be reproduced in its entirety.

LT Environmental, Inc.
4600 West 60th Avenue
Arvada CO 80003

Project Number: NEP1025
Project Name: Noble - McClellan 3-1

MW-02
4/5/2011 1:55:00PM

Analyte	Result	Reporting Limit	Units	Dilution	Batch	Prepared	Analyzed	Notes
---------	--------	--------------------	-------	----------	-------	----------	----------	-------

Origins Laboratory, Inc.
X104037-02 (Water)

BTEX by EPA 8260C

Benzene	ND	1.00	ug/L	1	1D06006	04/06/2011	04/07/2011
Toluene	ND	1.00	"	"	"	"	"
Ethylbenzene	ND	1.00	"	"	"	"	"
Xylenes, total	ND	3.00	"	"	"	"	"

Surrogate: 1,2-Dichloroethane-d4	97.9 %	70-130	"	"	"
Surrogate: Toluene-d8	104 %	70-130	"	"	"
Surrogate: 4-Bromofluorobenzene	109 %	70-130	"	"	"

Origins Laboratory, Inc.



The results in this report apply to the samples analyzed in accordance with the chain of custody document. This analytical report must be reproduced in its entirety.

Noelle E Doyle, President

LT Environmental, Inc.
4600 West 60th Avenue
Arvada CO 80003

Project Number: NEP1025
Project Name: Noble - McClellan 3-1

MW-03

4/5/2011 2:05:00PM

Analyte	Result	Reporting Limit	Units	Dilution	Batch	Prepared	Analyzed	Notes
---------	--------	--------------------	-------	----------	-------	----------	----------	-------

Origins Laboratory, Inc.
X104037-03 (Water)

BTEX by EPA 8260C

Benzene	ND	1.00	ug/L	1	1D06006	04/06/2011	04/07/2011
Toluene	ND	1.00	"	"	"	"	"
Ethylbenzene	ND	1.00	"	"	"	"	"
Xylenes, total	ND	3.00	"	"	"	"	"

Surrogate: 1,2-Dichloroethane-d4	100 %	70-130	"	"	"
Surrogate: Toluene-d8	103 %	70-130	"	"	"
Surrogate: 4-Bromofluorobenzene	110 %	70-130	"	"	"

Origins Laboratory, Inc.



Noelle E Doyle, President

The results in this report apply to the samples analyzed in accordance with the chain of custody document. This analytical report must be reproduced in its entirety.

LT Environmental, Inc.
4600 West 60th Avenue

Arvada CO 80003

Project Number: NEP1025

Project Name: Noble - McClellan 3-1

Volatile Organic Compounds by GC/MS SW846 8260C - Quality Control
Origins Laboratory, Inc.

Analyte	Result	Reporting Limit	Units	Spike Level	Source Result	%REC	%REC Limits	RPD	RPD Limit	Notes
---------	--------	-----------------	-------	-------------	---------------	------	-------------	-----	-----------	-------

Batch 1D06006 - EPA 5030B

Blank (1D06006-BLK1)

Prepared: 04/06/2011 Analyzed: 04/06/2011

Benzene	ND	1.00	ug/L							
Toluene	ND	1.00	"							
Ethylbenzene	ND	1.00	"							
m,p-Xylene	ND	2.00	"							
o-Xylene	ND	1.00	"							
Surrogate: 1,2-Dichloroethane-d4	56.0		"	62.5		89.6	70-130			
Surrogate: Toluene-d8	63.5		"	62.5		102	70-130			
Surrogate: 4-Bromofluorobenzene	68.3		"	62.5		109	70-130			

Origins Laboratory, Inc.



Noelle E Doyle, President

The results in this report apply to the samples analyzed in accordance with the chain of custody document. This analytical report must be reproduced in its entirety.

LT Environmental, Inc.
4600 West 60th Avenue

Arvada CO 80003

Project Number: NEP1025

Project Name: Noble - McClellan 3-1

Volatile Organic Compounds by GC/MS SW846 8260C - Quality Control
Origins Laboratory, Inc.

Analyte	Result	Reporting Limit	Units	Spike Level	Source Result	%REC	%REC Limits	RPD	RPD Limit	Notes
---------	--------	--------------------	-------	----------------	------------------	------	----------------	-----	--------------	-------

Batch 1D06006 - EPA 5030B

LCS (1D06006-BS1)

Prepared: 04/06/2011 Analyzed: 04/06/2011

Benzene	47.7	1.00	ug/L	50.0		95.4	70-130			
Toluene	49.5	1.00	"	50.0		99.0	70-130			
Ethylbenzene	49.1	1.00	"	50.0		98.2	70-130			
m,p-Xylene	95.8	2.00	"	100		95.8	70-130			
o-Xylene	49.5	1.00	"	50.0		99.0	70-130			
Surrogate: 1,2-Dichloroethane-d4	57.9		"	62.5		92.6	70-130			
Surrogate: Toluene-d8	64.0		"	62.5		102	70-130			
Surrogate: 4-Bromofluorobenzene	64.7		"	62.5		104	70-130			

Origins Laboratory, Inc.



The results in this report apply to the samples analyzed in accordance with the chain of custody document. This analytical report must be reproduced in its entirety.

Noelle E Doyle, President

LT Environmental, Inc.
4600 West 60th Avenue

Arvada CO 80003

Project Number: NEP1025

Project Name: Noble - McClellan 3-1

Volatile Organic Compounds by GC/MS SW846 8260C - Quality Control
Origins Laboratory, Inc.

Analyte	Result	Reporting Limit	Units	Spike Level	Source Result	%REC	%REC Limits	RPD	RPD Limit	Notes
---------	--------	-----------------	-------	-------------	---------------	------	-------------	-----	-----------	-------

Batch 1D06006 - EPA 5030B

Matrix Spike (1D06006-MS1)		Source: X104013-02			Prepared: 04/06/2011 Analyzed: 04/06/2011					
Benzene	48.3	1.00	ug/L	50.0	ND	96.5	70-130			
Toluene	49.0	1.00	"	50.0	ND	98.0	70-130			
Ethylbenzene	48.7	1.00	"	50.0	ND	97.3	70-130			
m,p-Xylene	99.9	2.00	"	100	ND	99.9	70-130			
o-Xylene	50.2	1.00	"	50.0	ND	100	70-130			
Surrogate: 1,2-Dichloroethane-d4	59.5		"	62.5		95.2	70-130			
Surrogate: Toluene-d8	62.7		"	62.5		100	70-130			
Surrogate: 4-Bromofluorobenzene	64.6		"	62.5		103	70-130			

Origins Laboratory, Inc.



The results in this report apply to the samples analyzed in accordance with the chain of custody document. This analytical report must be reproduced in its entirety.

Noelle E Doyle, President

LT Environmental, Inc.
4600 West 60th Avenue

Arvada CO 80003

Project Number: NEP1025

Project Name: Noble - McClellan 3-1

Volatile Organic Compounds by GC/MS SW846 8260C - Quality Control
Origins Laboratory, Inc.

Analyte	Result	Reporting Limit	Units	Spike Level	Source Result	%REC	%REC Limits	RPD	RPD Limit	Notes
---------	--------	-----------------	-------	-------------	---------------	------	-------------	-----	-----------	-------

Batch 1D06006 - EPA 5030B

Matrix Spike Dup (1D06006-MSD1)		Source: X104013-02			Prepared: 04/06/2011 Analyzed: 04/06/2011					
Benzene	46.9	1.00	ug/L	50.0	ND	93.8	70-130	2.84	20	
Toluene	48.7	1.00	"	50.0	ND	97.3	70-130	0.696	20	
Ethylbenzene	46.8	1.00	"	50.0	ND	93.5	70-130	3.98	20	
m,p-Xylene	85.0	2.00	"	100	ND	85.0	70-130	16.0	20	
o-Xylene	48.3	1.00	"	50.0	ND	96.6	70-130	3.96	20	
Surrogate: 1,2-Dichloroethane-d4	59.6		"	62.5		95.3	70-130			
Surrogate: Toluene-d8	63.9		"	62.5		102	70-130			
Surrogate: 4-Bromofluorobenzene	65.6		"	62.5		105	70-130			

Origins Laboratory, Inc.



The results in this report apply to the samples analyzed in accordance with the chain of custody document. This analytical report must be reproduced in its entirety.

Noelle E Doyle, President

LT Environmental, Inc.

4600 West 60th Avenue

Arvada

CO

80003

Project Number: NEP1025

Project Name: Noble - McClellan 3-1

Notes and Definitions

ND Analyte NOT DETECTED at or above the reporting limit

RPD Relative Percent Difference

Origins Laboratory, Inc.



The results in this report apply to the samples analyzed in accordance with the chain of custody document. This analytical report must be reproduced in its entirety.

Noelle E Doyle, President