



April 8, 2011

Department of Natural Resources
Oil and Gas Conservation Commission
The Chancery Building
1120 Lincoln St., Suite 801
Denver, CO 80203

Re: **20 Day Certification Letter - 318A-e**
GUERRERO 33-7
Township 2 North, Range 65 West, Section 7: SW/4SW/4
Unit Spacing: 02N-65W-7 W/2SW/4; 02N-66W-12 E/2SE/4
Weld County, Colorado

Ladies/Gentlemen:

Kerr-McGee Oil and Gas Onshore LP ("KMG") hereby certifies to the Director that a twenty (20) day notice has been given by certified mail to all owners in the proposed wellbore spacing unit. We have not received any objections to such well location, proposed spacing unit, or additional producing formation. KMG hereby requests the Director to approve the boundary well.

If you have any questions or issues regarding this permit, please contact Cheryl Light at (720) 929-6461.

Very truly yours,

Kerr-McGee Oil and Gas Onshore LP

A handwritten signature in blue ink that reads 'Rebecca Heim'.

Rebecca Heim
Regulatory Analyst II

Enclosure

WELL LOCATION CERTIFICATE: GUERRERO 33-7

SECTION 7, TOWNSHIP 2 NORTH, RANGE 65 WEST, 6TH P.M.

N 88°11'57" E 5242.75'

NW SEC. 7
2" ALUM. CAP
LS 23027

NE SEC. 7
2" ALUM. CAP
LS 25937

NOTES:

THIS IS A DIRECTIONAL WELL
BH LOCATION TO BE 1320' FSL & 50' FWL
BH LOCATION PROVIDED BY CLIENT.
LAND SURFACE USE-OPEN FIELD
TWINNING PROPOSED WELL GUERRERO 13-7
TO BE 16' E
PROPOSED WELL GUERRERO 13-7
TO BE 519' FSL & 526' FWL
SEE ATTACHED MAP FOR ADDITIONAL
IMPROVEMENTS WITHIN 400'.

(BASIS OF BEARINGS) SEE NOTE 3
N 00°34'14" W 5199.34'

S 00°01'02" W 5296.29'

7

SURFACE LOCATION

GROUND ELEVATION= 4985'
NAD83
LATITUDE= 40.147332°
LONGITUDE= 104.714003°

BOTTOM HOLE LOCATION

NAD83
LATITUDE= 40.149526°
LONGITUDE= 104.715651°

PDOP= 1.78

GPS OPERATOR: CHRIS PEARSON

BH- 1320' FSL
50' FWL

GUERRERO 33-7

GUERRERO 13-7

S ¼ SEC. 7
2 ½" ALUM. CAP
LS 23027

SE SEC. 7
2 ½" ALUM. CAP
LS 23027

SW SEC. 7
2 ½" ALUM. CAP
ILLEGIBLE

S 89°14'40" W 2541.41'

S 89°15'47" W 2645.83'

WELL GUERRERO 33-7 TO BE LOCATED 519' FSL AND 510' FWL, SECTION 7, T2N, R65W OF THE 6th P.M.

LEGEND

⊕ = EXISTING MONUMENT ♦ = BOTTOM HOLE BH = BOTTOM HOLE
● = PROPOSED WELL ◆ = EXISTING WELL

0 500 1000
SCALE: 1"=1000'

NOTES:

- THIS SURVEY WAS DONE BY GPS METHODS AND CONFORMS TO THE MINIMUM STANDARDS SET BY THE C.O.G.C.C., RULE NO. 215
- ELEVATIONS SHOWN AT THE WELL HEAD, AS WELL AS HORIZONTAL CONTROL, ARE BASED ON GPS-RTK VALUES DERIVED FROM DOING 2-HOUR STATIC GPS SESSIONS AND REDUCTIONS USING O.P.U.S. SOLUTIONS.
VERTICAL = NAVD88; HORIZONTAL = NAD83/92
- THE BEARINGS SHOWN HEREON ARE BASED ON GPS OBSERVATIONS BETWEEN THE MONUMENTS SHOWN HEREON AS FOUND ON THE FIELD DATE BELOW.
- DISTANCES SHOWN ARE AT GROUND LEVEL, AS MEASURED IN THE FIELD, WITH TIES TO WELLS MEASURED AT A PERPENDICULAR TO SECTION LINES.

I, JERRY F. HARCEK JR., A LICENSED PROFESSIONAL LAND SURVEYOR IN THE STATE OF COLORADO DO HEREBY CERTIFY TO KERR-MCGEE OIL & GAS ONSHORE LP, THAT THE SURVEY AND WELL LOCATION CERTIFICATE SHOWN HEREON WERE DONE BY ME OR UNDER MY DIRECT SUPERVISION AND THAT THE DRAWING SHOWN HEREON ACCURATELY DEPICTS THE PROPOSED LOCATION OF THE WELL GUERRERO 33-7. THIS CERTIFICATE DOES NOT REPRESENT A LAND SURVEY PLAT OR IMPROVEMENT SURVEY PLAT AS DEFINED BY C.R.S. 38-51-102 AND CANNOT BE RELIED UPON TO DETERMINE OWNERSHIP.

JERRY F. HARCEK JR., PLS 34997
COLORADO LICENSED PROFESSIONAL LAND SURVEYOR
FOR AND ON BEHALF OF P.F.S., LLC

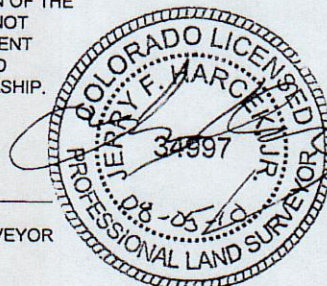

PREPARED BY:



FIELD DATE:

07-29-10

WELL NAME:

GUERRERO 33-7

DRAWING DATE:

08-03-10

SURFACE LOCATION:

WELD COUNTY, COLORADO

BY:

SMF

SW 1/4 SW 1/4, SEC. 7, T2N, R65W

NOTICE: ACCORDING TO COLORADO LAW YOU MUST COMMENCE ANY LEGAL ACTION BASED UPON ANY DEFECT IN THIS SURVEY WITHIN THREE YEARS AFTER YOU FIRST DISCOVER SUCH DEFECT. IN NO EVENT MAY ANY ACTION BASED UPON ANY DEFECT IN THIS SURVEY BE COMMENCED MORE THAN TEN YEARS FROM THIS SAID DATE OF THIS CERTIFICATION SHOWN HEREON.

GUERRERO 33-7 SWSW Sec. 7 T2N-R65W

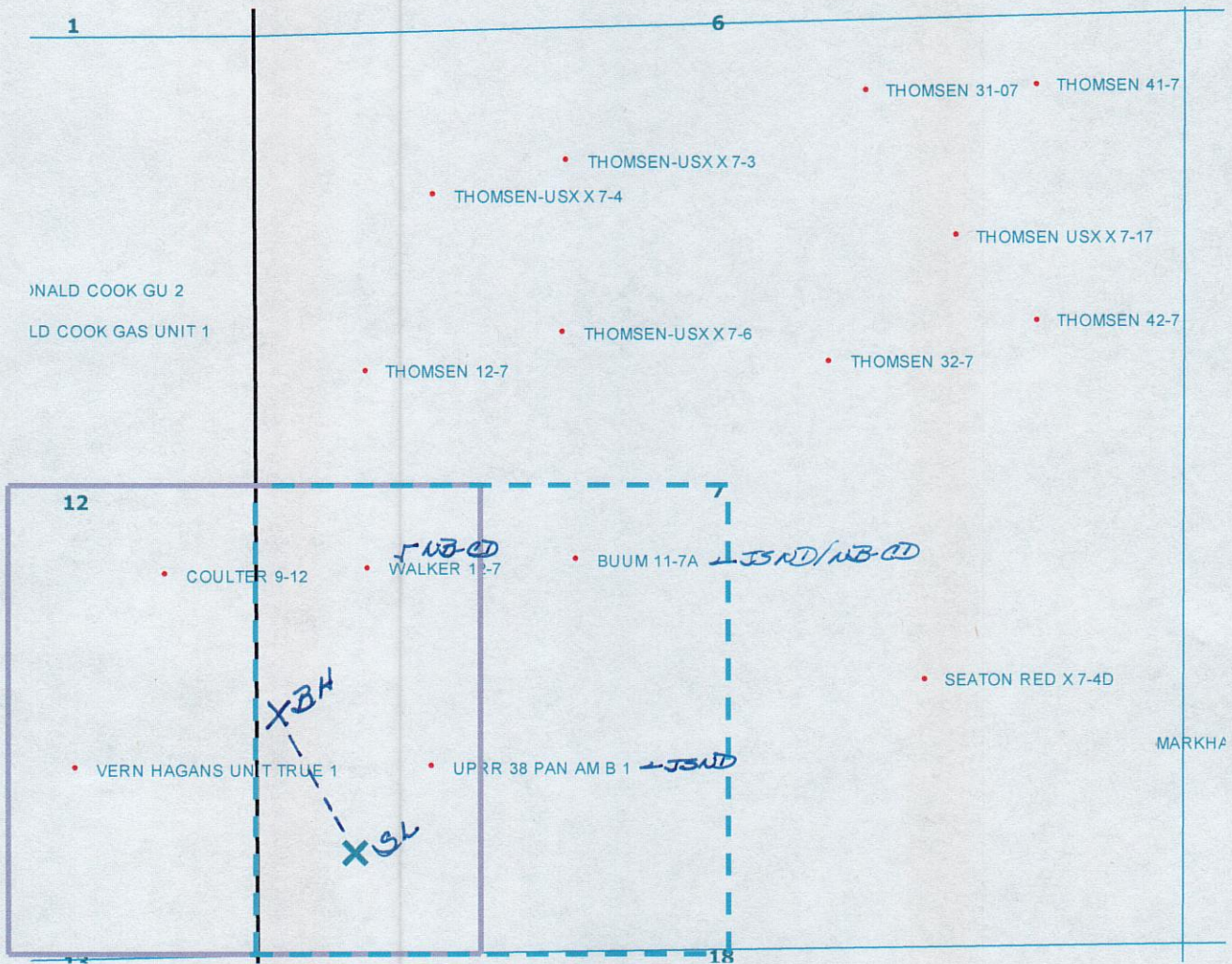

LEGEND



Proposed 160 acre Spacing Unit (Solid line).



Bottom Hole Located NW/4SW/4, Sec. 7-T2N-R65W (Dashed line).

This 1/4 Section has less than 8 bottom hole wells producing from the Codell, Niobrara & J Sand Formations.