

# STREAR V03-73HN

## Proposed Spacing Unit – Noble Energy, Inc

### E/2 of Section 3, Township 2 North, Range 67 West

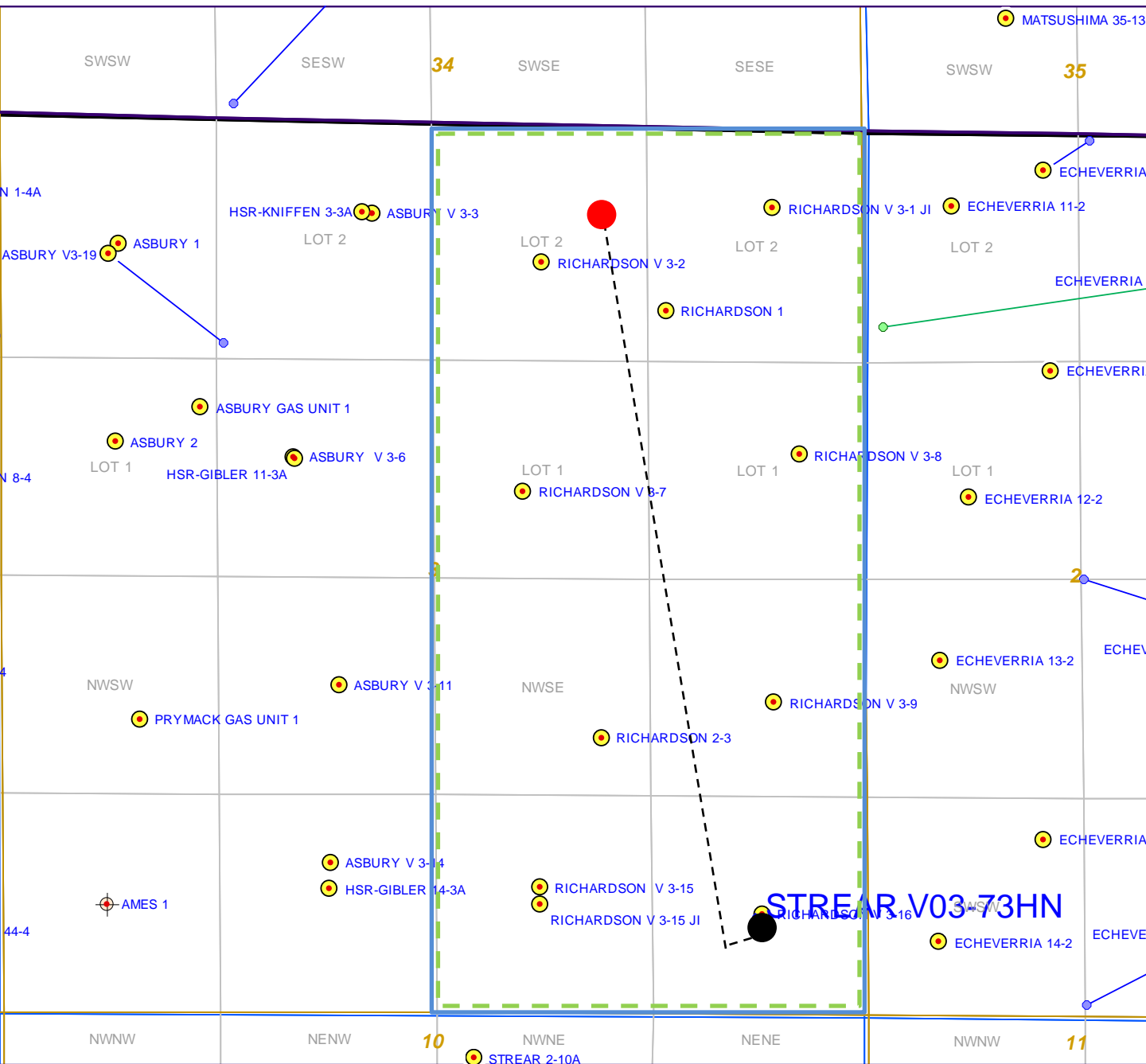

#### Legend



Proposed 320 acre spacing unit



Bottom Hole Location



Bottom Hole Located SE/4, NE/4 of Section 3, Township 2 North, Range 67 West

**The governmental ¼ Section has less than 8 bottom hole wells producing from the  
Codell, Niobrara, and J-Sand formations.**