

Denver Division- Colorado

DJ - Hereford Ranch

Dutch Lake 23-35H

Dutch Lake 23-35H

Original Wellbore

Plan: APD Directional Plot

Standard Planning Report

14 March, 2011

EOG Resources Inc

Planning Report

| | | | |
|------------------|---------------------------|-------------------------------------|------------------------|
| Database: | EDM | Local Co-ordinate Reference: | Site Dutch Lake 23-35H |
| Company: | Denver Division- Colorado | TVD Reference: | RIG @ 5695.00ft (TBD) |
| Project: | DJ - Hereford Ranch | MD Reference: | RIG @ 5695.00ft (TBD) |
| Site: | Dutch Lake 23-35H | North Reference: | True |
| Well: | Dutch Lake 23-35H | Survey Calculation Method: | Minimum Curvature |
| Wellbore: | Original Wellbore | | |
| Design: | APD Directional Plot | | |

| | | | |
|--------------------|--------------------------------------|----------------------|----------------|
| Project | DJ - Hereford Ranch, Weld County | | |
| Map System: | US State Plane 1927 (Exact solution) | System Datum: | Mean Sea Level |
| Geo Datum: | NAD 1927 (NADCON CONUS) | | |
| Map Zone: | Colorado North 501 | | |

| | | | |
|------------------------------|-------------------|--------------------------|-------------------|
| Site | Dutch Lake 23-35H | | |
| Site Position: | | Northing: | 408,996.43 ft |
| From: | Lat/Long | Easting: | 2,334,716.55 ft |
| Position Uncertainty: | 0.00 ft | Slot Radius: | " |
| | | Latitude: | 40° 26' 59.590 N |
| | | Longitude: | 104° 17' 50.280 W |
| | | Grid Convergence: | 0.78 deg |

| | | | |
|-----------------------------|-------------------|----------------------------|---------------------------------|
| Well | Dutch Lake 23-35H | | |
| Well Position | +N/-S | 0.00 ft | Northing: 408,996.43 ft |
| | +E/-W | 0.00 ft | Easting: 2,334,716.55 ft |
| Position Uncertainty | 0.00 ft | Wellhead Elevation: | ft |
| | | Latitude: | 40° 26' 59.590 N |
| | | Longitude: | 104° 17' 50.280 W |
| | | Ground Level: | 5,673.00 ft |

| | | | | | |
|------------------|-------------------|--------------------|--------------------------|------------------------|----------------------------|
| Wellbore | Original Wellbore | | | | |
| Magnetics | Model Name | Sample Date | Declination (deg) | Dip Angle (deg) | Field Strength (nT) |
| | IGRF200510 | 3/14/2011 | 8.61 | 67.19 | 53,247 |

| | | | | |
|--------------------------|------------------------------|-------------------|----------------------|------------------------|
| Design | APD Directional Plot | | | |
| Audit Notes: | | | | |
| Version: | Phase: | PROTOTYPE | Tie On Depth: | 0.00 |
| Vertical Section: | Depth From (TVD) (ft) | +N/-S (ft) | +E/-W (ft) | Direction (deg) |
| | 0.00 | 0.00 | 0.00 | 153.51 |

| Plan Sections | | | | | | | | | | |
|----------------------|-------------------|---------------|---------------------|------------|------------|-----------------------|----------------------|---------------------|-----------|-------------------|
| Measured Depth (ft) | Inclination (deg) | Azimuth (deg) | Vertical Depth (ft) | +N/-S (ft) | +E/-W (ft) | Dogleg Rate (?/100ft) | Build Rate (?/100ft) | Turn Rate (?/100ft) | TFO (deg) | Target |
| 0.00 | 0.00 | 0.00 | 0.00 | 0.00 | 0.00 | 0.00 | 0.00 | 0.00 | 0.00 | |
| 5,816.53 | 0.00 | 0.00 | 5,816.53 | 0.00 | 0.00 | 0.00 | 0.00 | 0.00 | 0.00 | |
| 6,566.54 | 90.00 | 153.51 | 6,294.00 | -427.34 | 212.97 | 12.00 | 12.00 | 0.00 | 153.51 | |
| 10,649.73 | 90.00 | 153.51 | 6,294.00 | -4,081.84 | 2,034.25 | 0.00 | 0.00 | 0.00 | 0.00 | Dutch Lake 23-35H |

EOG Resources Inc

Planning Report

| | | | |
|------------------|---------------------------|-------------------------------------|------------------------|
| Database: | EDM | Local Co-ordinate Reference: | Site Dutch Lake 23-35H |
| Company: | Denver Division- Colorado | TVD Reference: | RIG @ 5695.00ft (TBD) |
| Project: | DJ - Hereford Ranch | MD Reference: | RIG @ 5695.00ft (TBD) |
| Site: | Dutch Lake 23-35H | North Reference: | True |
| Well: | Dutch Lake 23-35H | Survey Calculation Method: | Minimum Curvature |
| Wellbore: | Original Wellbore | | |
| Design: | APD Directional Plot | | |

Planned Survey

| Measured Depth (ft) | Inclination (deg) | Azimuth (deg) | Vertical Depth (ft) | +N/-S (ft) | +E/-W (ft) | Vertical Section (ft) | Dogleg Rate (?/100ft) | Build Rate (?/100ft) | Turn Rate (?/100ft) |
|---------------------|-------------------|---------------|---------------------|------------|------------|-----------------------|-----------------------|----------------------|---------------------|
| 0.00 | 0.00 | 0.00 | 0.00 | 0.00 | 0.00 | 0.00 | 0.00 | 0.00 | 0.00 |
| 100.00 | 0.00 | 0.00 | 100.00 | 0.00 | 0.00 | 0.00 | 0.00 | 0.00 | 0.00 |
| 200.00 | 0.00 | 0.00 | 200.00 | 0.00 | 0.00 | 0.00 | 0.00 | 0.00 | 0.00 |
| 300.00 | 0.00 | 0.00 | 300.00 | 0.00 | 0.00 | 0.00 | 0.00 | 0.00 | 0.00 |
| 400.00 | 0.00 | 0.00 | 400.00 | 0.00 | 0.00 | 0.00 | 0.00 | 0.00 | 0.00 |
| 500.00 | 0.00 | 0.00 | 500.00 | 0.00 | 0.00 | 0.00 | 0.00 | 0.00 | 0.00 |
| 600.00 | 0.00 | 0.00 | 600.00 | 0.00 | 0.00 | 0.00 | 0.00 | 0.00 | 0.00 |
| 700.00 | 0.00 | 0.00 | 700.00 | 0.00 | 0.00 | 0.00 | 0.00 | 0.00 | 0.00 |
| 800.00 | 0.00 | 0.00 | 800.00 | 0.00 | 0.00 | 0.00 | 0.00 | 0.00 | 0.00 |
| 9-5/8" | | | | | | | | | |
| 900.00 | 0.00 | 0.00 | 900.00 | 0.00 | 0.00 | 0.00 | 0.00 | 0.00 | 0.00 |
| 1,000.00 | 0.00 | 0.00 | 1,000.00 | 0.00 | 0.00 | 0.00 | 0.00 | 0.00 | 0.00 |
| 1,100.00 | 0.00 | 0.00 | 1,100.00 | 0.00 | 0.00 | 0.00 | 0.00 | 0.00 | 0.00 |
| 1,200.00 | 0.00 | 0.00 | 1,200.00 | 0.00 | 0.00 | 0.00 | 0.00 | 0.00 | 0.00 |
| 1,300.00 | 0.00 | 0.00 | 1,300.00 | 0.00 | 0.00 | 0.00 | 0.00 | 0.00 | 0.00 |
| 1,400.00 | 0.00 | 0.00 | 1,400.00 | 0.00 | 0.00 | 0.00 | 0.00 | 0.00 | 0.00 |
| 1,500.00 | 0.00 | 0.00 | 1,500.00 | 0.00 | 0.00 | 0.00 | 0.00 | 0.00 | 0.00 |
| 1,600.00 | 0.00 | 0.00 | 1,600.00 | 0.00 | 0.00 | 0.00 | 0.00 | 0.00 | 0.00 |
| 1,700.00 | 0.00 | 0.00 | 1,700.00 | 0.00 | 0.00 | 0.00 | 0.00 | 0.00 | 0.00 |
| 1,800.00 | 0.00 | 0.00 | 1,800.00 | 0.00 | 0.00 | 0.00 | 0.00 | 0.00 | 0.00 |
| 1,900.00 | 0.00 | 0.00 | 1,900.00 | 0.00 | 0.00 | 0.00 | 0.00 | 0.00 | 0.00 |
| 2,000.00 | 0.00 | 0.00 | 2,000.00 | 0.00 | 0.00 | 0.00 | 0.00 | 0.00 | 0.00 |
| 2,100.00 | 0.00 | 0.00 | 2,100.00 | 0.00 | 0.00 | 0.00 | 0.00 | 0.00 | 0.00 |
| 2,200.00 | 0.00 | 0.00 | 2,200.00 | 0.00 | 0.00 | 0.00 | 0.00 | 0.00 | 0.00 |
| 2,300.00 | 0.00 | 0.00 | 2,300.00 | 0.00 | 0.00 | 0.00 | 0.00 | 0.00 | 0.00 |
| 2,400.00 | 0.00 | 0.00 | 2,400.00 | 0.00 | 0.00 | 0.00 | 0.00 | 0.00 | 0.00 |
| 2,500.00 | 0.00 | 0.00 | 2,500.00 | 0.00 | 0.00 | 0.00 | 0.00 | 0.00 | 0.00 |
| 2,600.00 | 0.00 | 0.00 | 2,600.00 | 0.00 | 0.00 | 0.00 | 0.00 | 0.00 | 0.00 |
| 2,700.00 | 0.00 | 0.00 | 2,700.00 | 0.00 | 0.00 | 0.00 | 0.00 | 0.00 | 0.00 |
| 2,800.00 | 0.00 | 0.00 | 2,800.00 | 0.00 | 0.00 | 0.00 | 0.00 | 0.00 | 0.00 |
| 2,900.00 | 0.00 | 0.00 | 2,900.00 | 0.00 | 0.00 | 0.00 | 0.00 | 0.00 | 0.00 |
| 3,000.00 | 0.00 | 0.00 | 3,000.00 | 0.00 | 0.00 | 0.00 | 0.00 | 0.00 | 0.00 |
| 3,100.00 | 0.00 | 0.00 | 3,100.00 | 0.00 | 0.00 | 0.00 | 0.00 | 0.00 | 0.00 |
| 3,200.00 | 0.00 | 0.00 | 3,200.00 | 0.00 | 0.00 | 0.00 | 0.00 | 0.00 | 0.00 |
| 3,300.00 | 0.00 | 0.00 | 3,300.00 | 0.00 | 0.00 | 0.00 | 0.00 | 0.00 | 0.00 |
| 3,400.00 | 0.00 | 0.00 | 3,400.00 | 0.00 | 0.00 | 0.00 | 0.00 | 0.00 | 0.00 |
| 3,500.00 | 0.00 | 0.00 | 3,500.00 | 0.00 | 0.00 | 0.00 | 0.00 | 0.00 | 0.00 |
| 3,600.00 | 0.00 | 0.00 | 3,600.00 | 0.00 | 0.00 | 0.00 | 0.00 | 0.00 | 0.00 |
| 3,700.00 | 0.00 | 0.00 | 3,700.00 | 0.00 | 0.00 | 0.00 | 0.00 | 0.00 | 0.00 |
| 3,800.00 | 0.00 | 0.00 | 3,800.00 | 0.00 | 0.00 | 0.00 | 0.00 | 0.00 | 0.00 |
| 3,900.00 | 0.00 | 0.00 | 3,900.00 | 0.00 | 0.00 | 0.00 | 0.00 | 0.00 | 0.00 |
| 4,000.00 | 0.00 | 0.00 | 4,000.00 | 0.00 | 0.00 | 0.00 | 0.00 | 0.00 | 0.00 |
| 4,100.00 | 0.00 | 0.00 | 4,100.00 | 0.00 | 0.00 | 0.00 | 0.00 | 0.00 | 0.00 |
| 4,200.00 | 0.00 | 0.00 | 4,200.00 | 0.00 | 0.00 | 0.00 | 0.00 | 0.00 | 0.00 |
| 4,300.00 | 0.00 | 0.00 | 4,300.00 | 0.00 | 0.00 | 0.00 | 0.00 | 0.00 | 0.00 |
| 4,400.00 | 0.00 | 0.00 | 4,400.00 | 0.00 | 0.00 | 0.00 | 0.00 | 0.00 | 0.00 |
| 4,500.00 | 0.00 | 0.00 | 4,500.00 | 0.00 | 0.00 | 0.00 | 0.00 | 0.00 | 0.00 |
| 4,600.00 | 0.00 | 0.00 | 4,600.00 | 0.00 | 0.00 | 0.00 | 0.00 | 0.00 | 0.00 |
| 4,700.00 | 0.00 | 0.00 | 4,700.00 | 0.00 | 0.00 | 0.00 | 0.00 | 0.00 | 0.00 |
| 4,800.00 | 0.00 | 0.00 | 4,800.00 | 0.00 | 0.00 | 0.00 | 0.00 | 0.00 | 0.00 |
| 4,900.00 | 0.00 | 0.00 | 4,900.00 | 0.00 | 0.00 | 0.00 | 0.00 | 0.00 | 0.00 |
| 5,000.00 | 0.00 | 0.00 | 5,000.00 | 0.00 | 0.00 | 0.00 | 0.00 | 0.00 | 0.00 |
| 5,100.00 | 0.00 | 0.00 | 5,100.00 | 0.00 | 0.00 | 0.00 | 0.00 | 0.00 | 0.00 |

EOG Resources Inc

Planning Report

| | | | |
|------------------|---------------------------|-------------------------------------|------------------------|
| Database: | EDM | Local Co-ordinate Reference: | Site Dutch Lake 23-35H |
| Company: | Denver Division- Colorado | TVD Reference: | RIG @ 5695.00ft (TBD) |
| Project: | DJ - Hereford Ranch | MD Reference: | RIG @ 5695.00ft (TBD) |
| Site: | Dutch Lake 23-35H | North Reference: | True |
| Well: | Dutch Lake 23-35H | Survey Calculation Method: | Minimum Curvature |
| Wellbore: | Original Wellbore | | |
| Design: | APD Directional Plot | | |

Planned Survey

| Measured Depth (ft) | Inclination (deg) | Azimuth (deg) | Vertical Depth (ft) | +N/-S (ft) | +E/-W (ft) | Vertical Section (ft) | Dogleg Rate (?/100ft) | Build Rate (?/100ft) | Turn Rate (?/100ft) |
|---------------------|-------------------|---------------|---------------------|------------|------------|-----------------------|-----------------------|----------------------|---------------------|
| 5,200.00 | 0.00 | 0.00 | 5,200.00 | 0.00 | 0.00 | 0.00 | 0.00 | 0.00 | 0.00 |
| 5,300.00 | 0.00 | 0.00 | 5,300.00 | 0.00 | 0.00 | 0.00 | 0.00 | 0.00 | 0.00 |
| 5,400.00 | 0.00 | 0.00 | 5,400.00 | 0.00 | 0.00 | 0.00 | 0.00 | 0.00 | 0.00 |
| 5,500.00 | 0.00 | 0.00 | 5,500.00 | 0.00 | 0.00 | 0.00 | 0.00 | 0.00 | 0.00 |
| 5,600.00 | 0.00 | 0.00 | 5,600.00 | 0.00 | 0.00 | 0.00 | 0.00 | 0.00 | 0.00 |
| 5,700.00 | 0.00 | 0.00 | 5,700.00 | 0.00 | 0.00 | 0.00 | 0.00 | 0.00 | 0.00 |
| 5,800.00 | 0.00 | 0.00 | 5,800.00 | 0.00 | 0.00 | 0.00 | 0.00 | 0.00 | 0.00 |
| 5,816.53 | 0.00 | 0.00 | 5,816.53 | 0.00 | 0.00 | 0.00 | 0.00 | 0.00 | 0.00 |
| 5,900.00 | 10.02 | 153.51 | 5,899.58 | -6.51 | 3.25 | 7.28 | 12.00 | 12.00 | 0.00 |
| 6,000.00 | 22.02 | 153.51 | 5,995.52 | -31.16 | 15.53 | 34.82 | 12.00 | 12.00 | 0.00 |
| 6,100.00 | 34.02 | 153.51 | 6,083.64 | -73.12 | 36.44 | 81.70 | 12.00 | 12.00 | 0.00 |
| 6,200.00 | 46.02 | 153.51 | 6,160.09 | -130.57 | 65.07 | 145.88 | 12.00 | 12.00 | 0.00 |
| 6,300.00 | 58.02 | 153.51 | 6,221.52 | -200.98 | 100.16 | 224.56 | 12.00 | 12.00 | 0.00 |
| 6,400.00 | 70.02 | 153.51 | 6,265.25 | -281.29 | 140.19 | 314.29 | 12.00 | 12.00 | 0.00 |
| 6,500.00 | 82.02 | 153.51 | 6,289.37 | -367.98 | 183.39 | 411.15 | 12.00 | 12.00 | 0.00 |
| 6,566.54 | 90.00 | 153.51 | 6,294.00 | -427.34 | 212.97 | 477.47 | 12.00 | 12.00 | 0.00 |
| 7" | | | | | | | | | |
| 6,600.00 | 90.00 | 153.51 | 6,294.00 | -457.29 | 227.90 | 510.93 | 0.00 | 0.00 | 0.00 |
| 6,700.00 | 90.00 | 153.51 | 6,294.00 | -546.79 | 272.50 | 610.93 | 0.00 | 0.00 | 0.00 |
| 6,800.00 | 90.00 | 153.51 | 6,294.00 | -636.29 | 317.11 | 710.93 | 0.00 | 0.00 | 0.00 |
| 6,900.00 | 90.00 | 153.51 | 6,294.00 | -725.79 | 361.71 | 810.93 | 0.00 | 0.00 | 0.00 |
| 7,000.00 | 90.00 | 153.51 | 6,294.00 | -815.29 | 406.31 | 910.93 | 0.00 | 0.00 | 0.00 |
| 7,100.00 | 90.00 | 153.51 | 6,294.00 | -904.79 | 450.92 | 1,010.93 | 0.00 | 0.00 | 0.00 |
| 7,200.00 | 90.00 | 153.51 | 6,294.00 | -994.30 | 495.52 | 1,110.93 | 0.00 | 0.00 | 0.00 |
| 7,300.00 | 90.00 | 153.51 | 6,294.00 | -1,083.80 | 540.13 | 1,210.93 | 0.00 | 0.00 | 0.00 |
| 7,400.00 | 90.00 | 153.51 | 6,294.00 | -1,173.30 | 584.73 | 1,310.93 | 0.00 | 0.00 | 0.00 |
| 7,500.00 | 90.00 | 153.51 | 6,294.00 | -1,262.80 | 629.34 | 1,410.93 | 0.00 | 0.00 | 0.00 |
| 7,600.00 | 90.00 | 153.51 | 6,294.00 | -1,352.30 | 673.94 | 1,510.93 | 0.00 | 0.00 | 0.00 |
| 7,700.00 | 90.00 | 153.51 | 6,294.00 | -1,441.80 | 718.54 | 1,610.93 | 0.00 | 0.00 | 0.00 |
| 7,800.00 | 90.00 | 153.51 | 6,294.00 | -1,531.30 | 763.15 | 1,710.93 | 0.00 | 0.00 | 0.00 |
| 7,900.00 | 90.00 | 153.51 | 6,294.00 | -1,620.80 | 807.75 | 1,810.93 | 0.00 | 0.00 | 0.00 |
| 8,000.00 | 90.00 | 153.51 | 6,294.00 | -1,710.30 | 852.36 | 1,910.93 | 0.00 | 0.00 | 0.00 |
| 8,100.00 | 90.00 | 153.51 | 6,294.00 | -1,799.81 | 896.96 | 2,010.93 | 0.00 | 0.00 | 0.00 |
| 8,200.00 | 90.00 | 153.51 | 6,294.00 | -1,889.31 | 941.57 | 2,110.93 | 0.00 | 0.00 | 0.00 |
| 8,300.00 | 90.00 | 153.51 | 6,294.00 | -1,978.81 | 986.17 | 2,210.93 | 0.00 | 0.00 | 0.00 |
| 8,400.00 | 90.00 | 153.51 | 6,294.00 | -2,068.31 | 1,030.77 | 2,310.93 | 0.00 | 0.00 | 0.00 |
| 8,500.00 | 90.00 | 153.51 | 6,294.00 | -2,157.81 | 1,075.38 | 2,410.93 | 0.00 | 0.00 | 0.00 |
| 8,600.00 | 90.00 | 153.51 | 6,294.00 | -2,247.31 | 1,119.98 | 2,510.93 | 0.00 | 0.00 | 0.00 |
| 8,700.00 | 90.00 | 153.51 | 6,294.00 | -2,336.81 | 1,164.59 | 2,610.93 | 0.00 | 0.00 | 0.00 |
| 8,800.00 | 90.00 | 153.51 | 6,294.00 | -2,426.31 | 1,209.19 | 2,710.93 | 0.00 | 0.00 | 0.00 |
| 8,900.00 | 90.00 | 153.51 | 6,294.00 | -2,515.81 | 1,253.80 | 2,810.93 | 0.00 | 0.00 | 0.00 |
| 9,000.00 | 90.00 | 153.51 | 6,294.00 | -2,605.32 | 1,298.40 | 2,910.93 | 0.00 | 0.00 | 0.00 |
| 9,100.00 | 90.00 | 153.51 | 6,294.00 | -2,694.82 | 1,343.00 | 3,010.93 | 0.00 | 0.00 | 0.00 |
| 9,200.00 | 90.00 | 153.51 | 6,294.00 | -2,784.32 | 1,387.61 | 3,110.93 | 0.00 | 0.00 | 0.00 |
| 9,300.00 | 90.00 | 153.51 | 6,294.00 | -2,873.82 | 1,432.21 | 3,210.93 | 0.00 | 0.00 | 0.00 |
| 9,400.00 | 90.00 | 153.51 | 6,294.00 | -2,963.32 | 1,476.82 | 3,310.93 | 0.00 | 0.00 | 0.00 |
| 9,500.00 | 90.00 | 153.51 | 6,294.00 | -3,052.82 | 1,521.42 | 3,410.93 | 0.00 | 0.00 | 0.00 |
| 9,600.00 | 90.00 | 153.51 | 6,294.00 | -3,142.32 | 1,566.03 | 3,510.93 | 0.00 | 0.00 | 0.00 |
| 9,700.00 | 90.00 | 153.51 | 6,294.00 | -3,231.82 | 1,610.63 | 3,610.93 | 0.00 | 0.00 | 0.00 |
| 9,800.00 | 90.00 | 153.51 | 6,294.00 | -3,321.33 | 1,655.23 | 3,710.93 | 0.00 | 0.00 | 0.00 |
| 9,900.00 | 90.00 | 153.51 | 6,294.00 | -3,410.83 | 1,699.84 | 3,810.93 | 0.00 | 0.00 | 0.00 |
| 10,000.00 | 90.00 | 153.51 | 6,294.00 | -3,500.33 | 1,744.44 | 3,910.93 | 0.00 | 0.00 | 0.00 |
| 10,100.00 | 90.00 | 153.51 | 6,294.00 | -3,589.83 | 1,789.05 | 4,010.93 | 0.00 | 0.00 | 0.00 |

EOG Resources Inc

Planning Report

| | | | |
|------------------|---------------------------|-------------------------------------|------------------------|
| Database: | EDM | Local Co-ordinate Reference: | Site Dutch Lake 23-35H |
| Company: | Denver Division- Colorado | TVD Reference: | RIG @ 5695.00ft (TBD) |
| Project: | DJ - Hereford Ranch | MD Reference: | RIG @ 5695.00ft (TBD) |
| Site: | Dutch Lake 23-35H | North Reference: | True |
| Well: | Dutch Lake 23-35H | Survey Calculation Method: | Minimum Curvature |
| Wellbore: | Original Wellbore | | |
| Design: | APD Directional Plot | | |

| Planned Survey | | | | | | | | | |
|-------------------------|-------------------|---------------|---------------------|------------|------------|-----------------------|-----------------------|----------------------|---------------------|
| Measured Depth (ft) | Inclination (deg) | Azimuth (deg) | Vertical Depth (ft) | +N/-S (ft) | +E/-W (ft) | Vertical Section (ft) | Dogleg Rate (?/100ft) | Build Rate (?/100ft) | Turn Rate (?/100ft) |
| 10,200.00 | 90.00 | 153.51 | 6,294.00 | -3,679.33 | 1,833.65 | 4,110.93 | 0.00 | 0.00 | 0.00 |
| 10,300.00 | 90.00 | 153.51 | 6,294.00 | -3,768.83 | 1,878.26 | 4,210.93 | 0.00 | 0.00 | 0.00 |
| 10,400.00 | 90.00 | 153.51 | 6,294.00 | -3,858.33 | 1,922.86 | 4,310.93 | 0.00 | 0.00 | 0.00 |
| 10,500.00 | 90.00 | 153.51 | 6,294.00 | -3,947.83 | 1,967.46 | 4,410.93 | 0.00 | 0.00 | 0.00 |
| 10,600.00 | 90.00 | 153.51 | 6,294.00 | -4,037.33 | 2,012.07 | 4,510.93 | 0.00 | 0.00 | 0.00 |
| 10,649.73 | 90.00 | 153.51 | 6,294.00 | -4,081.84 | 2,034.25 | 4,560.66 | 0.00 | 0.00 | 0.00 |
| Dutch Lake 23-35H (BHL) | | | | | | | | | |

| Targets | | | | | | | | | |
|---------------------------|-----------------|----------------|----------|------------|------------|---------------|--------------|------------------|-------------------|
| Target Name | Dip Angle (deg) | Dip Dir. (deg) | TVD (ft) | +N/-S (ft) | +E/-W (ft) | Northing (ft) | Easting (ft) | Latitude | Longitude |
| - hit/miss target | | | | | | | | | |
| - Shape | | | | | | | | | |
| Dutch Lake 23-35H (E | 0.00 | 0.00 | 6,294.00 | -4,081.84 | 2,034.25 | 404,942.56 | 2,336,805.97 | 40° 26' 19.252 N | 104° 17' 23.971 W |
| - plan hits target center | | | | | | | | | |
| - Point | | | | | | | | | |

| Casing Points | | | | | |
|---------------------|---------------------|--------|---------------------|-------------------|--|
| Measured Depth (ft) | Vertical Depth (ft) | Name | Casing Diameter (") | Hole Diameter (") | |
| 800.00 | 800.00 | 9-5/8" | 9-5/8 | 13-1/2 | |
| 6,566.54 | 6,294.00 | 7" | 7 | 8-3/4 | |
| 10,649.73 | 6,294.00 | 4 1/2" | 4-1/2 | 6 | |

Dutch Lake 23-35H

Section 35 T6N R62W

Weld County, CO

Surface Location

NAD 1927 (NADCON CONUS) Colorado North 501
Ground Elevation: 5673.00 RIG @ 5695.00ft (TBD)
Northing Easting Latitude Longitude
408996.43 2334716.55 40° 26' 59.590 N 104° 17' 50.280 W

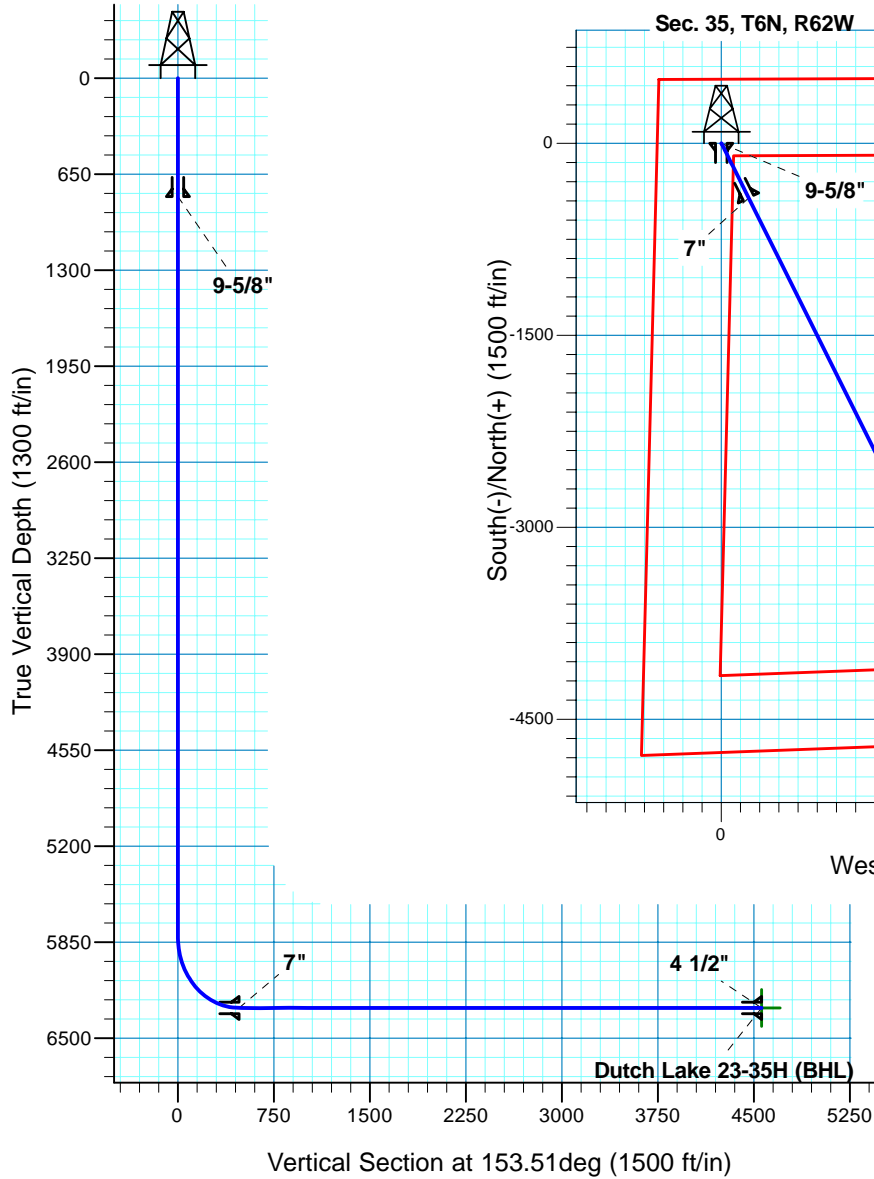

T M
Azimuths to True North
Magnetic North: 8.61°
Magnetic Field
Strength: 53247.4snT
Dip Angle: 67.19°
Date: 3/14/2011
Model: IGRF200510

Project: DJ - Hereford Ranch
Site: Dutch Lake 23-35H
Well: Dutch Lake 23-35H
Plan: APD Directional Plot

SECTION DETAILS

| Sec | MD | Inc | Azi | TVD | +N/-S | +E/-W | DLeg | TFace | VSec | Target |
|-----|----------|-------|--------|---------|----------|---------|-------|--------|---------|-------------------------|
| 1 | 0.00 | 0.00 | 0.00 | 0.00 | 0.00 | 0.00 | 0.00 | 0.00 | 0.00 | |
| 2 | 5816.53 | 0.00 | 0.00 | 5816.53 | 0.00 | 0.00 | 0.00 | 0.00 | 0.00 | |
| 3 | 6566.54 | 90.00 | 153.51 | 6294.00 | -427.34 | 212.97 | 12.00 | 153.51 | 477.47 | |
| 4 | 10649.73 | 90.00 | 153.51 | 6294.00 | -4081.84 | 2034.25 | 0.00 | 0.00 | 4560.66 | Dutch Lake 23-35H (BHL) |

TARGET DETAILS

| Name | TVD | +N/-S | +E/-W | Northing | Easting | Latitude | Longitude | Shape |
|-------------------------|---------|----------|---------|-----------|------------|------------------|-------------------|-------|
| Dutch Lake 23-35H (BHL) | 6294.00 | -4081.84 | 2034.25 | 404942.56 | 2336805.97 | 40° 26' 19.252 N | 104° 17' 23.971 W | Point |