

Serial Register Page	Go	
----------------------	----	--



DEPARTMENT OF THE INTERIOR  
BUREAU OF LAND MANAGEMENT  
CASE RECORDATION  
(MASS) Serial Register Page

Run Time 01:19 PM

Page 1 of 7

Run Date: 02/22/11

01 02-25-1920;041STAT0437;30USC181ETSEQ NILS-PARCEL2/map.jsp?  
Case Type 311211: O&G LSE SIMO PUBLIC LAND Nils-Parcel2/map.jsp?  
Commodity 459: OIL & GAS L dminregion=CO&id=3404028  
Case Disposition: AUTHORIZED SN=COC--- - 022373

Total Acres  
318.520Serial Number  
COC--- - 022373

Serial Number: COC--- - 022373

Name & Address	Int Rel	% Interest
KINDER MORGAN CO2 CO LP QEP ENERGY CO	PO BOX 281304 1050 17TH ST STE 500 LAKEWOOD CO 80228 DENVER CO 802651050	OPERATING RIGHTS LESSEE 0.000000000 100.000000000

Serial Number: COC--- - 022373

Mer Twp	Rng	Sec	STyp	SNr Suff	Subdivision	District/Field Office	County	Mgmt Agency
23 0370N 0180W 032			ALIO		NE,N2SE:	MONTROSE SAN JUAN	MONTEZUMA	BUREAU OF LAND MGMT
23 0370N 0180W 032			LOTS		3,4:	MONTROSE SAN JUAN	MONTEZUMA	BUREAU OF LAND MGMT

Serial Number: COC--- - 022373

Act Date	Code	Action	Action Remark	Pending Office
01/15/1971	387	CASE ESTABLISHED	COC12038	
02/01/1971	530	RLTY RATE - 12 1/2%		
02/01/1971	868	EFFECTIVE DATE		
01/14/1975	209	CASE CREATED BY SEGR	OUT OF COC12038	
05/13/1976	932	TRF OPER RGTS FILED	01	
06/11/1976	933	TRF OPER RGTS APPROVED	01 EFF 06/01/76	
01/27/1977	140	ASGN FILED	1)	
04/04/1977	899	TRF OF ORR FILED	01	
04/26/1977	139	ASGN APPROVED	1)EFF 02/01/77	
08/28/1978	232	LEASE COMMITTED TO UNIT	WOODS	
12/12/1978	510	KMA CLASSIFIED	SAND CANYON KGS	
03/10/1979	659	LOCATED IN PROD UNIT	WOODS	
06/21/1979	102	NOTICE SENT-PROD STATUS	ROSWELL, EFF 03/10/79	
06/29/1979	315	RENTAL RATE DET/ADJ	\$2.00; EFF 02/01/80	
11/17/1980	899	TRF OF ORR FILED	02	
04/01/1983	232	LEASE COMMITTED TO UNIT	COC47653X:MCELMO DOME	
04/01/1983	651	HELD BY PROD - ALLOCATED	VER, 05/25/90,SJRA	
04/01/1983	660	MEMO OF 1ST PROD-ALLOC	COC47653A:MISS-LEADVL	
04/02/1983	336	UNIT AGMT TERMINATED	WOODS	
10/21/1983	140	ASGN FILED	2)	
10/28/1983	899	TRF OF ORR FILED	03	
12/05/1983	932	TRF OPER RGTS FILED	02	
01/21/1985	139	ASGN APPROVED	2)EFF 01/01/84	
01/21/1985	933	TRF OPER RGTS APPROVED	02 EFF 01/01/84	
05/30/1992	974	AUTOMATED RECORD VERIF	PNO	
04/01/1993	940	NAME CHANGE RECOGNIZED	CHORNEY/EST R CHORNEY	
07/28/1994	899	TRF OF ORR FILED		
10/19/1998	932	TRF OPER RGTS FILED		
10/19/1998	933	TRF OPER RGTS APPROVED	EFF 11/01/98;	
02/29/2000	932	TRF OPER RGTS FILED		
02/29/2000	933	TRF OPER RGTS APPROVED	EFF 03/01/00;	
04/10/2000	940	NAME CHANGE RECOGNIZED	SHELLCO2/KMCO2;	
11/03/2000	817	MERGER RECOGNIZED	CELSIUS/QUESTAR;	

NO WARRANTY IS MADE BY BLM FOR USE OF THE DATA FOR PURPOSES NOT INTENDED BY BLM

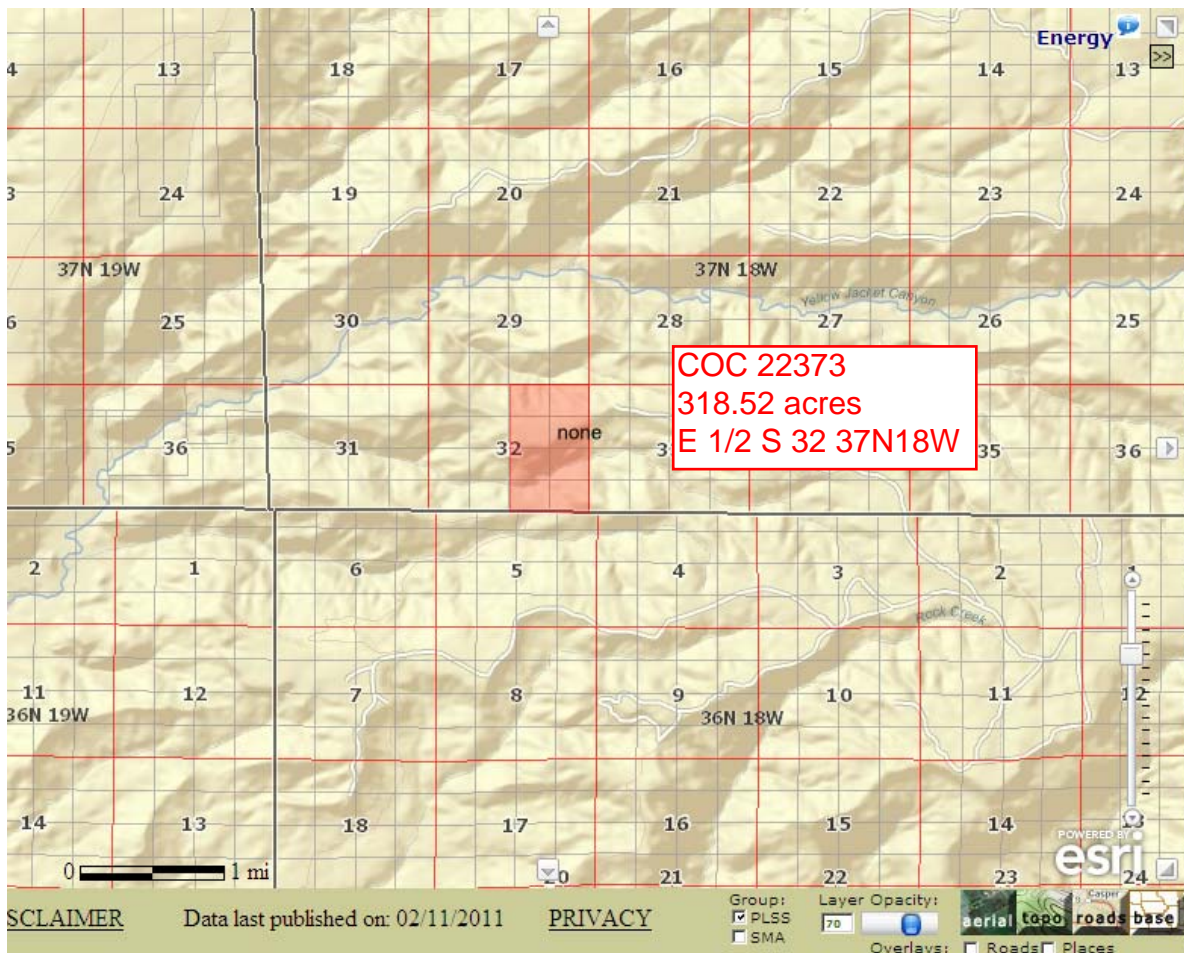

Serial Register Page	Go	
----------------------	----	--



DEPARTMENT OF THE INTERIOR  
BUREAU OF LAND MANAGEMENT  
CASE RECORDATION  
(MASS) Serial Register Page

Run Time 01:51 PM

Page 1 of 1

Run Date: 02/22/11

01 02-25-1920;041STAT0437;30USC181ETSEQ NLS-PARCEL2/map.jsp?  
Case Type 311211: O&G LSE SIMO PUBLIC LAND dory=BLM&casetype=311211&a  
Commodity 459: OIL & GAS L dminregion=CO&id=3487301  
Case Disposition: AUTHORIZED SN=COC--- - 019464

Total Acres  
320.000Serial Number  
COC--- - 019464

Serial Number: COC--- - 019464

Name & Address	Int Rel	% Interest
KINDER MORGAN CO2 CO PO BOX 281304 LAKEWOOD CO 80225	LESSEE	100.000000000

Serial Number: COC--- - 019464

Mer Twp	Rng	Sec	STyp	SNr Suff	Subdivision	District/Field Office	County	Mgmt Agency
23 0370N	0180W	029	ALIO	E2:		MONTROSE SAN JUAN	MONTEZUMA	BUREAU OF LAND MGMT

Serial Number: COC--- - 019464

Act Date	Code	Action	Action Remark	Pending Office
10/01/1973	387	CASE ESTABLISHED	PARCEL 225	
10/26/1973	888	DRAWING HELD		
11/08/1973	111	RENTAL RECEIVED	\$160.00;	
11/12/1973	237	LEASE ISSUED		
12/01/1973	496	FUND CODE	05;145003	
12/01/1973	530	RLTY RATE - 12 1/2%		
12/01/1973	868	EFFECTIVE DATE		
03/25/1976	140	ASGN FILED	1)	
05/27/1976	139	ASGN APPROVED	1)EFF 04/01/76	
08/28/1978	232	LEASE COMMITTED TO UNIT	WOODS	
03/08/1979	659	LOCATED IN PROD UNIT	WOODS	
06/06/1979	315	RENTAL RATE DET/ADJ	\$2.00; EFF 12/01/79	
06/06/1979	510	KMA CLASSIFIED	SAND CANYON KGS	
07/03/1979	102	NOTICE SENT-PROD STATUS	ROSWELL, EFF 03/08/79	
04/01/1983	232	LEASE COMMITTED TO UNIT	COC47653X:MCELMO DOME	
04/01/1983	651	HELD BY PROD - ALLOCATED	VER,06/19/90,921A	
04/01/1983	660	MEMO OF 1ST PROD-ALLOC	COC47653A:MISS-LEADVL	
04/02/1983	336	UNIT AGRMT TERMINATED	WOODS	
12/05/1983	140	ASGN FILED	2)	
03/05/1984	139	ASGN APPROVED	2)EFF 01/01/84	
10/19/1998	932	TRF OPER RGTS FILED		
10/19/1998	933	TRF OPER RGTS APPROVED	EFF 1//01/98;	
02/29/2000	140	ASGN FILED		
02/29/2000	932	TRF OPER RGTS FILED		
02/29/2000	933	TRF OPER RGTS APPROVED	EFF 03/01/2000;	
04/20/2000	139	ASGN APPROVED	EFF 03/01/00;	
07/20/2000	940	NAME CHANGE RECOGNIZED	SHELL/KMCO2;	
09/24/2007	932	TRF OPER RGTS FILED	1	
11/30/2007	933	TRF OPER RGTS APPROVED	EFF 10/01/07;	

Line Nr	Remarks
---------	---------

Serial Number: COC--- - 019464

NO WARRANTY IS MADE BY BLM FOR USE OF THE DATA FOR PURPOSES NOT INTENDED BY BLM

