

LOCATION DRAWING

RUTHERFORD 1-5H

SECTION 5
TOWNSHIP 9 NORTH
RANGE 61 WEST

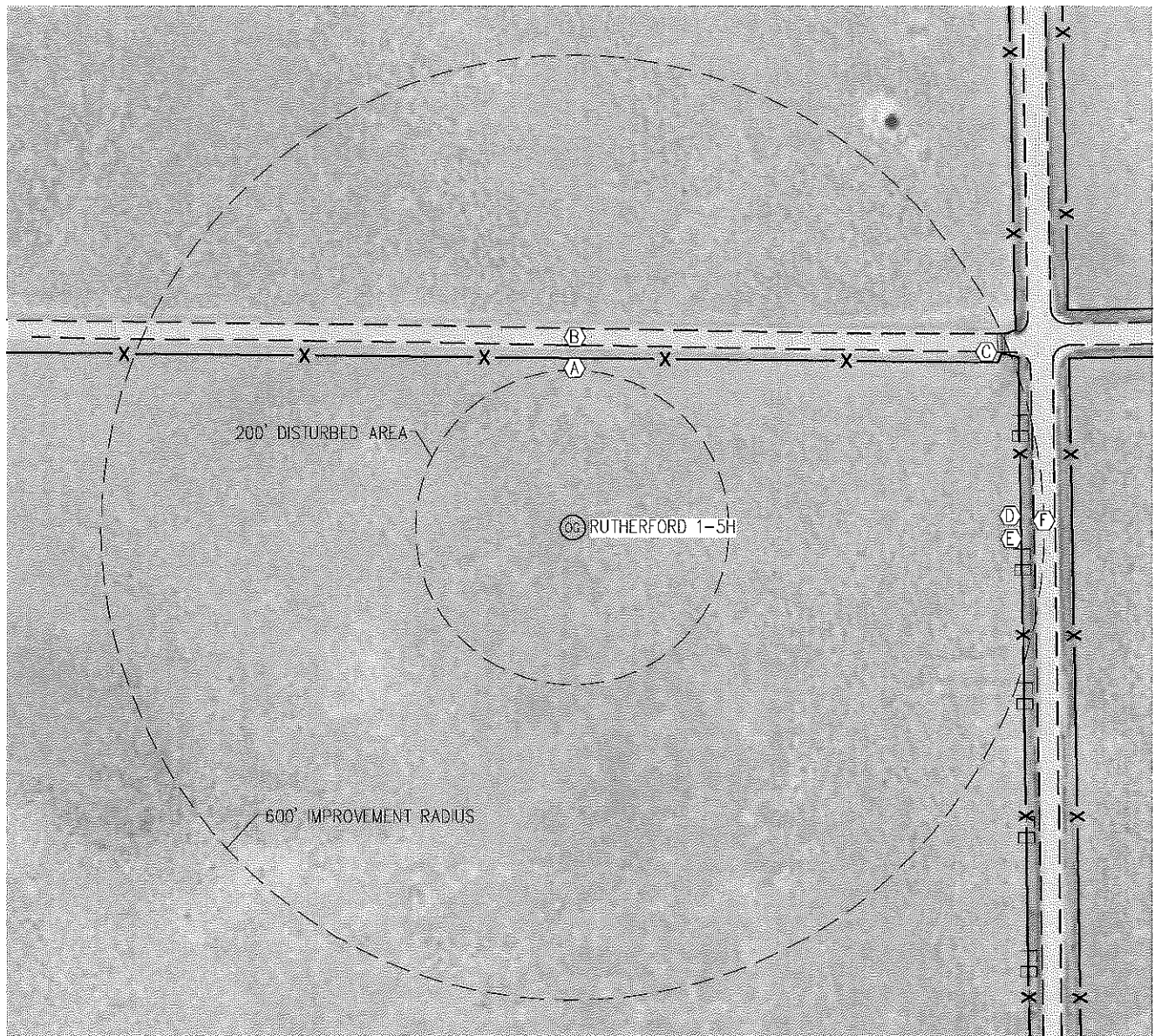

NO WATER WELLS OR DITCHES WITHIN 400'

NEAREST: BUILDING 5280'+, PUBLIC ROAD 232' N, ABOVE GROUND UTILITY 4800' W,
RAILROAD 5280'+, PROPERTY LINE 250' N

IMPROVEMENTS:

- (A) FENCE: 215' N
- (B) EDGE OF GRAVEL (WCR 110): 232' N
- (C) CATTLE GUARD: 586' NE
- (D) FENCE: 572' E
- (E) UNDERGROUND FIBER OPTIC LINE: 572' E
- (F) EDGE OF GRAVEL (WCR 89): 588' E

NOTE

The size, type and location of underground utilities shown hereon are approximate, and are based on markings made by utility locate companies. It is not guaranteed that all utilities have been located. It shall be the responsibility of the contractor to verify the existence of all underground utilities in the area of the work before commencing new construction.

