

## LOCATION DRAWING

LORENZ PC F22-33D

SECTION: 21  
TOWNSHIP: 5N  
RANGE: 65W

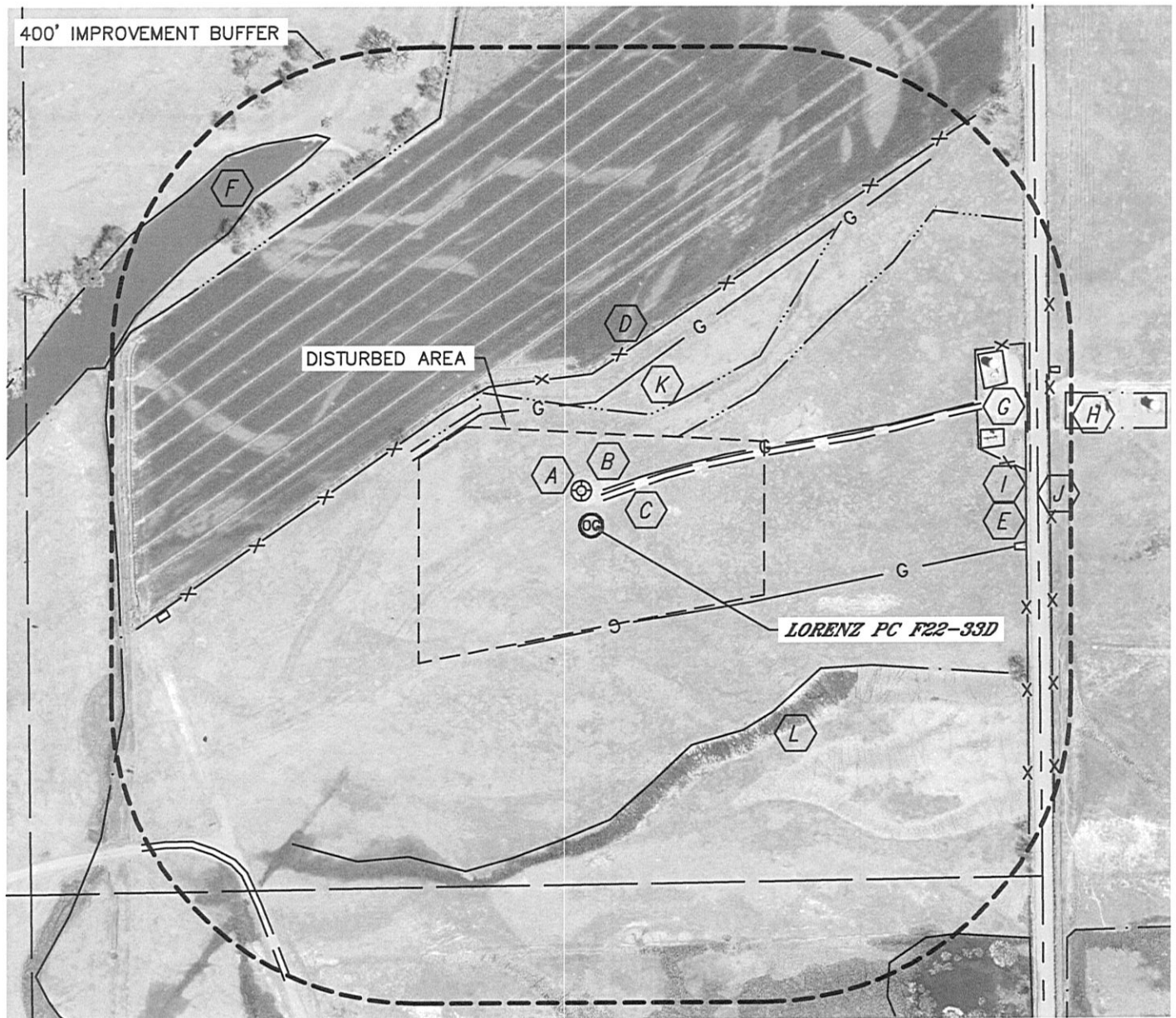

### IMPROVEMENTS:

- |  |  |
|--|--|
| <b>A</b> ENZUP 21-41 47' N                           | <b>G</b> PRODUCTION FACILITY (NOBLE) 520' NE |
| <b>B</b> GAS LINE 135' S, 39' N, 160' N              | <b>H</b> PRODUCTION FACILITY (MERIT) 630' NE |
| <b>C</b> FIELD ROAD 40' N, 635' SW                   | <b>I</b> COUNTY ROAD 43 572' E               |
| <b>D</b> FENCE 196' N, 514' E, 598' E                | <b>J</b> BARROW DITCH 570' E, 595' E         |
| <b>E</b> GAS LINE CLEAN OUT 560' E, 560' SW, 630' NE | <b>K</b> DITCH 150' NE, 160' NE, 550' NW     |
| <b>F</b> POND 600' NW                                | <b>L</b> WET AREA 320' SE, 620' W, 690' SE   |

NEAREST: BUILDING 920' NE, PUBLIC ROAD (CR 43) 572' E,  
ABOVE GROUND UTILITY 1000' NE, RAILROAD 5280'+, PROPERTY LINE 582' E

