

EOG RESOURCES, INC.
IGO CREEK #13-19H
LOCATED IN WELD COUNTY, COLORADO
SECTION 19, T9N, R59W, 6th P.M.

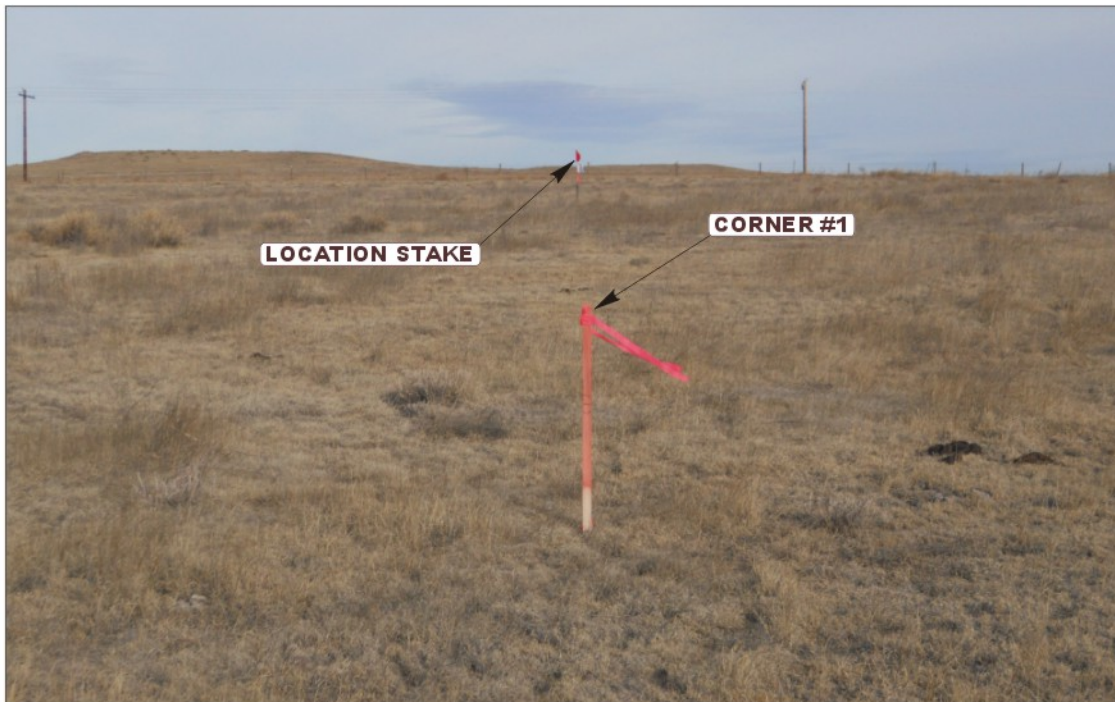

PHOTO: VIEW FROM CORNER #1 TO LOCATION STAKE

CAMERA ANGLE: NORTHERLY



PHOTO: VIEW FROM BEGINNING OF PROPOSED ACCESS

CAMERA ANGLE: SOUTHERLY



UELS Uintah Engineering & Land Surveying
85 South 200 East Vernal, Utah 84078
(435) 789-1017 * FAX (435) 789-1813

LOCATION PHOTOS

02 **11** **11**
MONTH DAY YEAR

TAKEN BY: B.B.

DRAWN BY: C.A.G.

REVISED: 00-00-00

PHOTO
P1

EOG RESOURCES, INC.
IGO CREEK #13-19H
LOCATED IN WELD COUNTY, COLORADO
SECTION 19, T9N, R59W, 6th P.M.



PHOTO: VIEW OF LOCATION STAKE

CAMERA ANGLE: NORTHERLY



PHOTO: VIEW OF LOCATION STAKE

CAMERA ANGLE: EASTERLY



UELS Uintah Engineering & Land Surveying
85 South 200 East Vernal, Utah 84078
(435) 789-1017 * FAX (435) 789-1813

LOCATION PHOTOS

02
MONTH

11
DAY

11
YEAR

PHOTO
P2

TAKEN BY: B.B.

DRAWN BY: C.A.G.

REVISED: 00-00-00

EOG RESOURCES, INC.
IGO CREEK #13-19H
LOCATED IN WELD COUNTY, COLORADO
SECTION 19, T9N, R59W, 6th P.M.



PHOTO: VIEW OF LOCATION STAKE

CAMERA ANGLE: SOUTHERLY



PHOTO: VIEW OF LOCATION STAKE

CAMERA ANGLE: WESTERLY



UELS Uintah Engineering & Land Surveying
85 South 200 East Vernal, Utah 84078
(435) 789-1017 * FAX (435) 789-1813

LOCATION PHOTOS

02 **11** **11**
MONTH DAY YEAR

TAKEN BY: B.B. DRAWN BY: C.A.G. REVISED: 00-00-00

PHOTO
P3