

EOG RESOURCES, INC.
IGO CREEK #26-34H
SECTION 34, T9N, R59W, 6th P.M.

PROCEED IN A SOUTHWESTERLY, THEN NORTHWESTERLY DIRECTION FROM RAYMER, COLORADO ALONG HIGHWAY 14 APPROXIMATELY 7.5 MILES TO THE JUNCTION OF THIS ROAD AND COUNTY ROAD 115 TO THE NORTH; TURN RIGHT AND PROCEED IN A NORTHERLY DIRECTION APPROXIMATELY 5.3 MILES TO THE BEGINNING OF THE PROPOSED ACCESS FOR IGO CREEK #24-30H TO THE NORTH; FOLLOW ROAD FLAGS IN A NORTHERLY, THEN NORTHWESTERLY DIRECTION APPROXIMATELY 5,877' TO THE BEGINNING OF THE PROPOSED ACCESS FOR IGO CREEK #20-26H TO THE NORTH; FOLLOW ROAD FLAGS IN A NORTHERLY, THEN NORTHEASTERLY DIRECTION APPROXIMATELY 861' TO THE BEGINNING OF THE PROPOSED ACCESS TO THE SOUTH; FOLLOW ROAD FLAGS IN A SOUTHERLY DIRECTION APPROXIMATELY 66' TO THE PROPOSED LOCATION.

TOTAL DISTANCE FROM RAYMER, COLORADO TO THE PROPOSED LOCATION IS APPROXIMATELY 14.1 MILES.

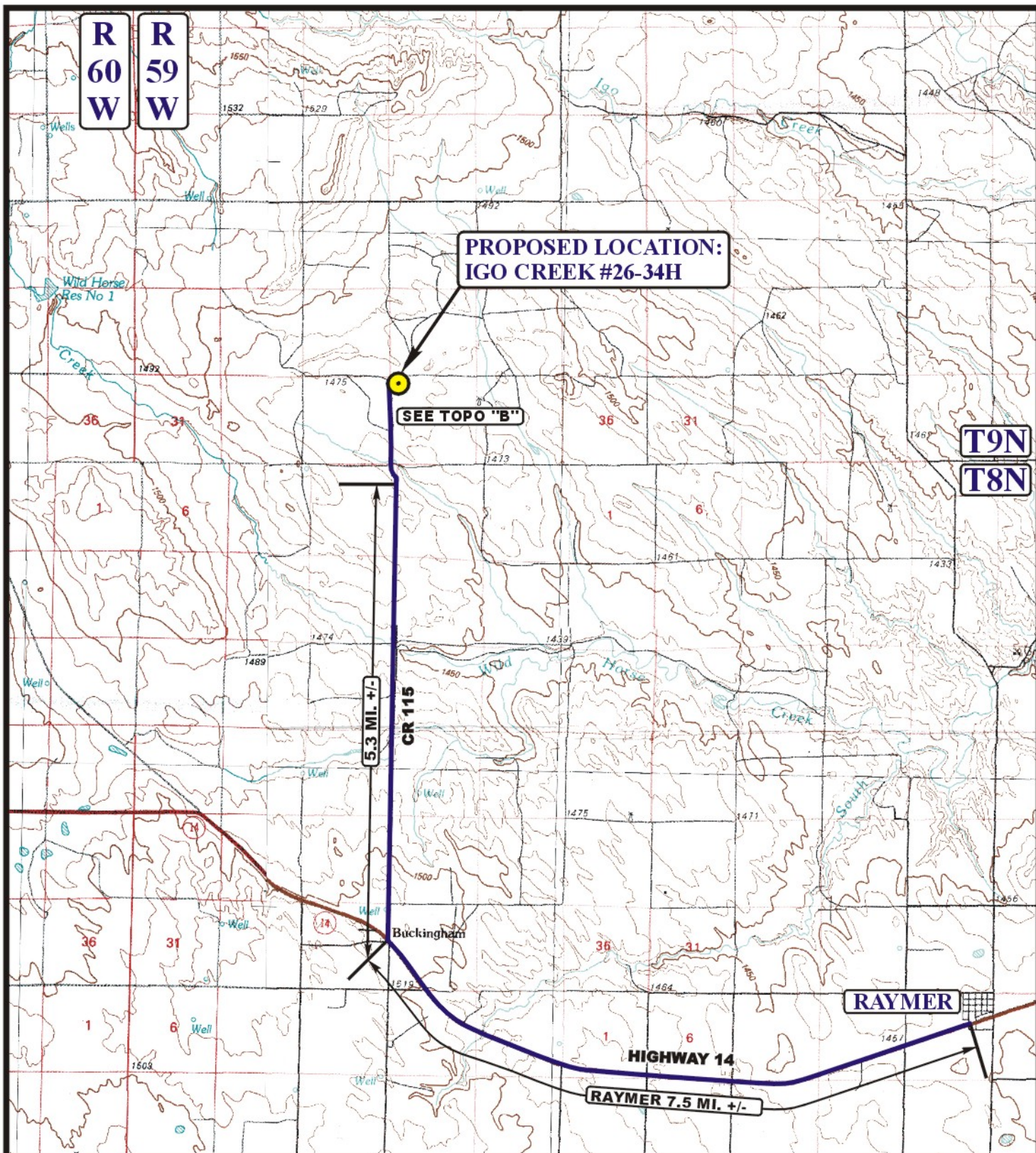

LEGEND:

● PROPOSED LOCATION

EOG RESOURCES, INC.

IGO CREEK #26-34H
SECTION 34, T9N, R59W, 6th P.M.
401' FNL 501' FWL



Uintah Engineering & Land Surveying
85 South 200 East Vernal, Utah 84078
(435) 789-1017 * FAX (435) 789-1813



**ACCESS ROAD
MAP**

01 17 11
MONTH DAY YEAR

SCALE: 1:100,000 **DRAWN BY: S.F.** **REVISED: 00-00-00**

**A
TOPO**

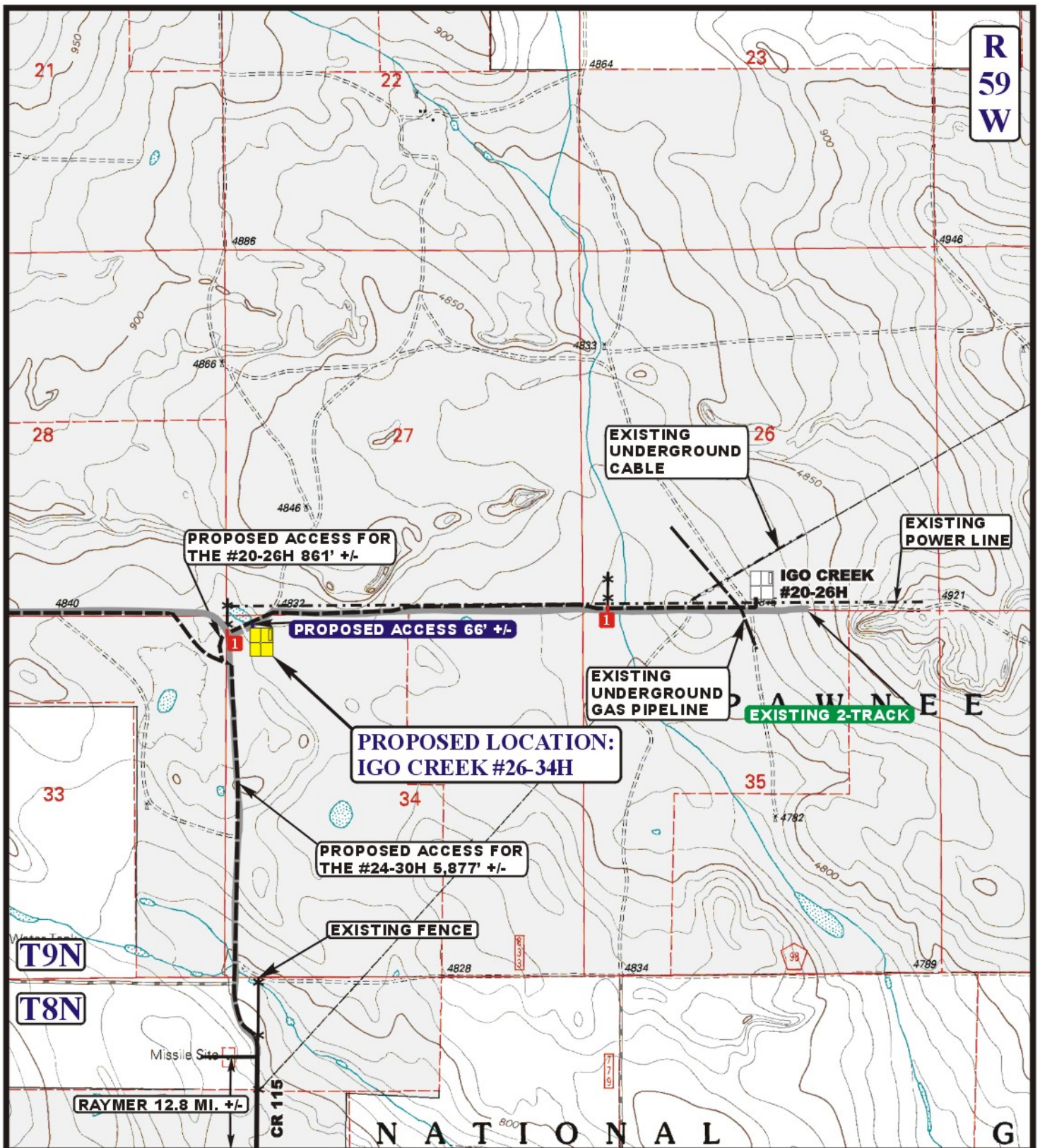

LEGEND:

- EXISTING ROAD
- PROPOSED ACCESS ROAD
- EXISTING FENCE
- EXISTING POWERLINE
- EXISTING PIPELINE
- INSTALL CATTLE GUARD



Utah Engineering & Land Surveying
85 South 200 East Vernal, Utah 84078
(435) 789-1017 * FAX (435) 789-1813



EOG RESOURCES, INC.

IGO CREEK #26-34H
SECTION 34, T9N, R59W, 6th P.M.
401' FNL 501' FWL

ACCESS ROAD
MAP

11 17 11
MONTH DAY YEAR

B
TOPO

SCALE: 1" = 2000' DRAWN BY: S.F. REVISED: 00-00-00