

LOCATION DRAWING

MILLER X31-06

SECTION: 31
TOWNSHIP: 2N
RANGE: 65W

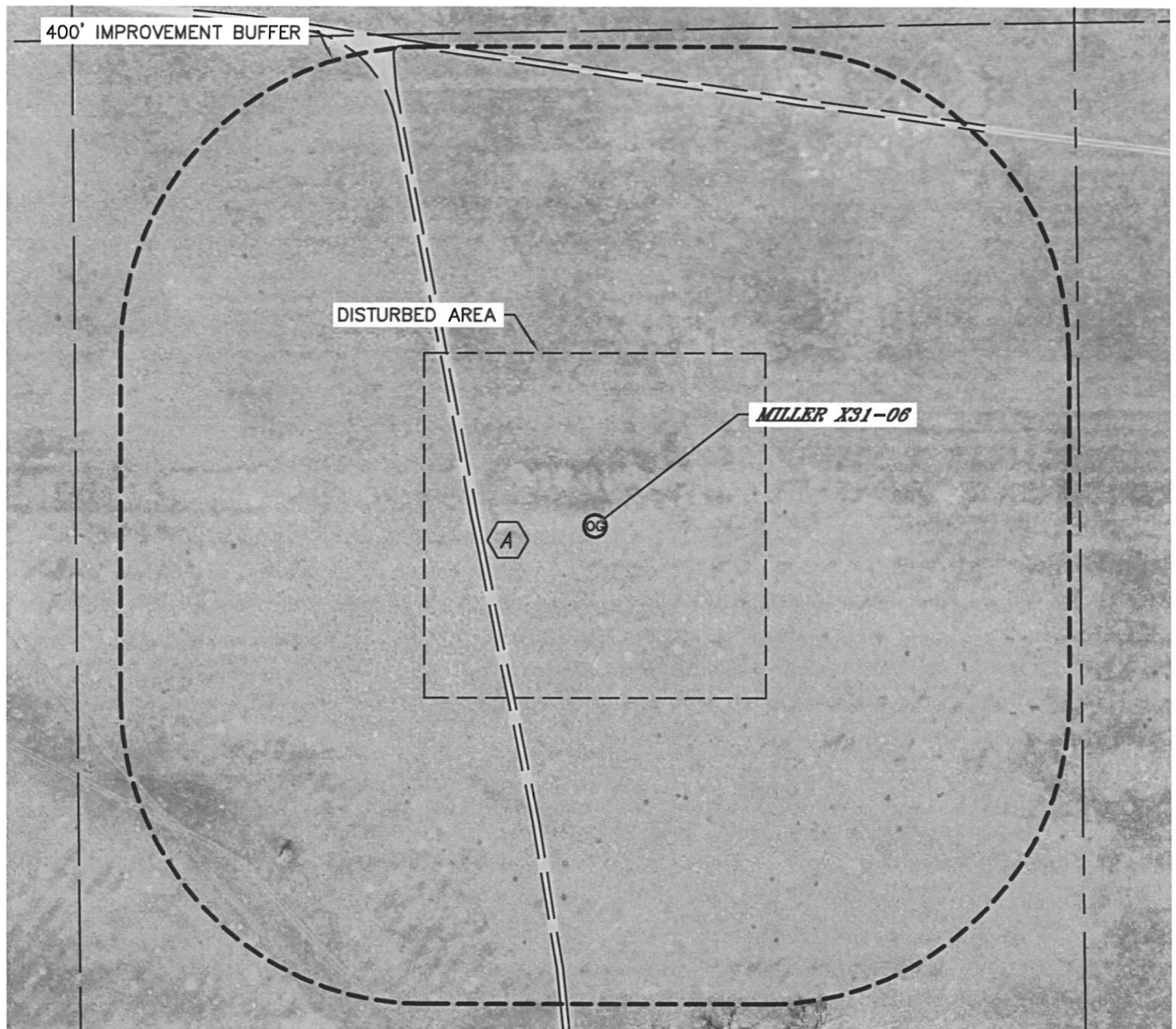

IMPROVEMENTS:



FIELD ROAD 149' WEST, 583' NE

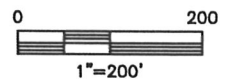

NEAREST: BUILDING 1840' NW, PUBLIC ROAD 1968' WEST (CR 37),
ABOVE GROUND UTILITY 1958' WEST, RAILROAD 5280'+, PROPERTY LINE 639' EAST