

KERR MCGEE OIL & GAS ONSHORE LP

Location: COLORADO Slot: SLOT#03 REIGLE 17-4 (2251'FNL & 2514'FWL)
 Field: WELD COUNTY (KERR MCGEE) Well: REIGLE 17-4X
 Facility: SEC.04-T2N-R65W Wellbore: REGILE 17-4X PWB



Well Profile Data

Design Comment	MD (ft)	Inc (°)	Az (°)	TVD (ft)	Local N (ft)	Local E (ft)	DLS (°/100ft)	VS (ft)
Tie On	3843.00	20.200	54.500	3645.19	628.13	912.93	0.00	1099.38
3D Arc (S)	4208.85	21.000	33.725	3988.10	719.46	1000.87	2.00	1225.80
End of Tangent (S)	5118.08	21.000	33.725	4836.95	990.46	1181.78	0.00	1541.21
Drop (S)	6168.08	0.000	33.725	5863.60	1148.72	1287.42	2.00	1725.40
End of Tangent	7659.49	0.000	33.725	7355.00	1148.72	1287.42	0.00	1725.40

Location Information

Facility Name			Grid East (USft)	Grid North (USft)	Latitude	Longitude
SEC.04-T2N-R65W			3232187.433	1305339.375	40°10'06.838"N	104°40'08.933"W
Slot	Local N (ft)	Local E (ft)	Grid East (USft)	Grid North (USft)	Latitude	Longitude
SLOT#03 REIGLE 17-4 (2251'FNL & 2514'FWL)	-31.69	-0.56	3232187.171	1305307.679	40°10'06.524"N	104°40'08.940"W
XTREME 6 (RKB) to Mud line (Facility: SEC.04-T2N-R65W)					4877ft	
Mean Sea Level to Mud line (Facility: SEC.04-T2N-R65W)					0ft	
XTREME 6 (RKB) to Mean Sea Level					4877ft	

Targets

Name	MD (ft)	Local N (ft)	Local E (ft)	Grid East (USft)	Grid North (USft)	Latitude	Longitude
REIGLE 17-4 GEO TARGET 50' RADIUS (1280'FNL & 1380'FEL, REV-1)	6000.00	962.15	1404.30	3233562.33	1306282.90	40°10'16.032"N	104°39'50.850"W
REIGLE 17-4 LEGAL BOX (496N,364S,342W,488E OF GEO TARGET)	6000.00	998.15	1346.30	3233524.00	1306318.35	40°10'16.388"N	104°39'51.597"W
REIGLE 17-4X GEO TARGET 50' RADIUS (1103'FNL & 1497'FEL, REV-2)	6000.00	1148.72	1287.42	3233463.72	1306468.36	40°10'17.876"N	104°39'52.356"W
REIGLE 17-4X GEO TARGET 50' RADIUS (1035'FNL & 1520'FEL, REV-1)	6000.00	1146.84	1272.66	3233448.98	1306466.34	40°10'17.857"N	104°39'52.548"W
REIGLE 17-4X LEGAL BOX (249N,551S,225W,575E OF GEO TARGET)	6000.00	997.00	1462.00	3233639.70	1306318.29	40°10'16.376"N	104°39'50.107"W

Plot reference wellpath is REGILE 17-4X (REV-B.0) PWP

True vertical depths are referenced to XTREME 6 (RKB)	Grid System: NAD83 / Lambert Colorado State Planes, Northern Zone (501), US feet
Measured depths are referenced to XTREME 6 (RKB)	North Reference: True north
XTREME 6 (RKB) to Mean Sea Level: 4877 feet	Scale: True distance
Mean Sea Level to Mud line (Facility: SEC.04-T2N-R65W): 0 feet	Depths are in feet
Coordinates are in feet referenced to Slot	Created by: cookdanm on 3/23/2011

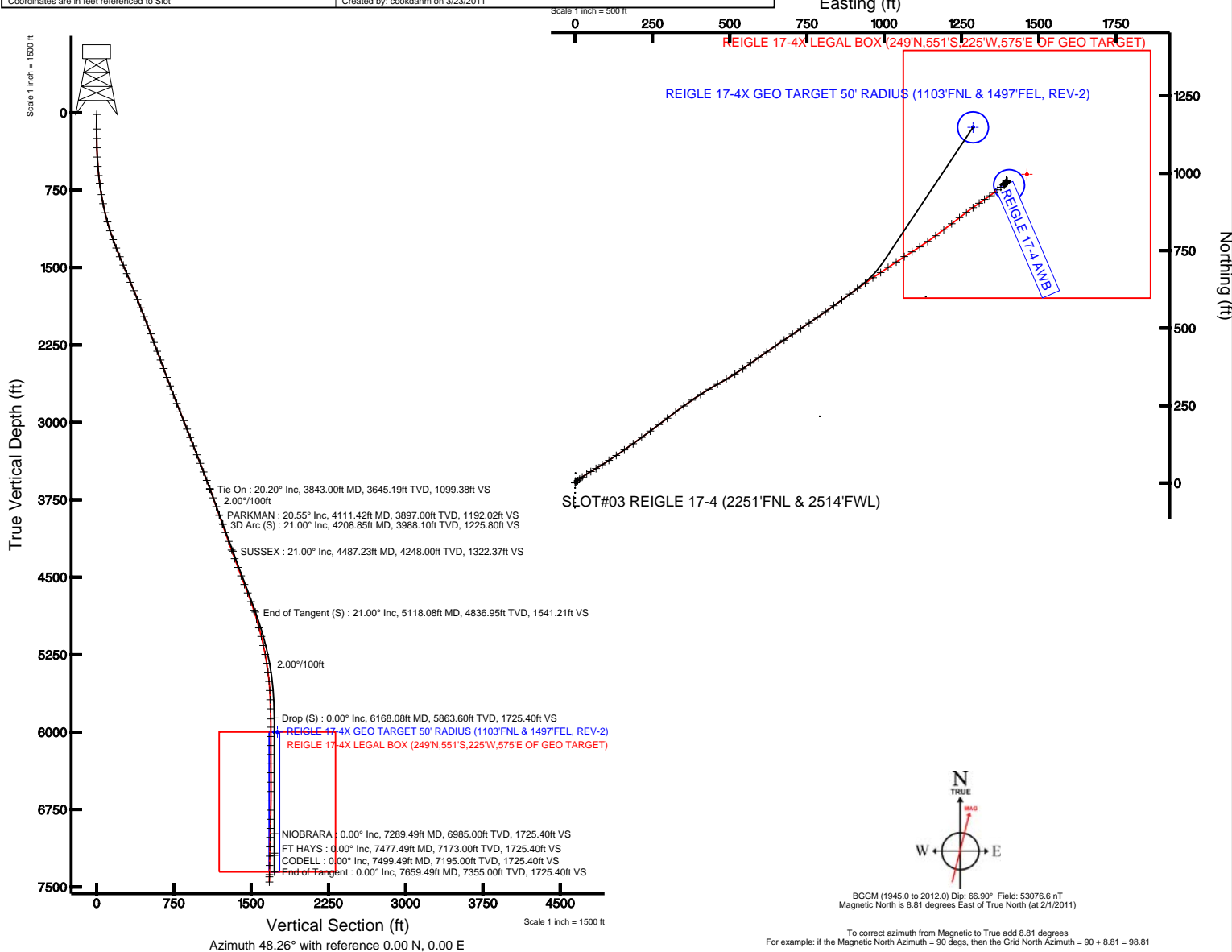



Planned Wellpath Report

REGILE 17-4X (REV-B.0) PWP

Page 1 of 4



INTEQ

REFERENCE WELLPATH IDENTIFICATION

Operator	KERR MCGEE OIL & GAS ONSHORE LP	Slot	SLOT#03 REIGLE 17-4 (2251'FNL & 2514'FWL)
Area	COLORADO	Well	REIGLE 17-4X
Field	WELD COUNTY (KERR MCGEE)	Wellbore	REGILE 17-4X PWB
Facility	SEC.04-T2N-R65W	Sidetrack from	REIGLE 17-4 AWB at 3843.00 MD

REPORT SETUP INFORMATION

Projection System	NAD83 / Lambert Colorado State Planes, Northern Zone (501), US feet	Software System	WellArchitect® 2.0
North Reference	True	User	Cookdanm
Scale	0.999958	Report Generated	3/23/2011 at 11:40:26 PM
Convergence at slot	0.54° East	Database/Source file	Denver Server/REGILE_17-4X_PWB.xml

WELLPATH LOCATION

	Local coordinates		Grid coordinates		Geographic coordinates	
	North[ft]	East[ft]	Easting[USft]	Northing[USft]	Latitude	Longitude
Slot Location	-31.69	-0.56	3232187.17	1305307.68	40°10'06.524"N	104°40'08.940"W
Facility Reference Pt			3232187.43	1305339.38	40°10'06.838"N	104°40'08.933"W
Field Reference Pt			3197771.84	1268891.29	40°04'09.600"N	104°47'36.000"W

WELLPATH DATUM

Calculation method	Minimum curvature	XTREME 6 (RKB) to Facility Vertical Datum	4877.00ft
Horizontal Reference Pt	Slot	XTREME 6 (RKB) to Mean Sea Level	4877.00ft
Vertical Reference Pt	XTREME 6 (RKB)	Facility Vertical Datum to Mud Line (Facility)	0.00ft
MD Reference Pt	XTREME 6 (RKB)	Section Origin	N 0.00, E 0.00 ft
Field Vertical Reference	Mean Sea Level	Section Azimuth	48.26°



Planned Wellpath Report

REGILE 17-4X (REV-B.0) PWP

Page 2 of 4



INTEQ

REFERENCE WELLPATH IDENTIFICATION

Operator	KERR MCGEE OIL & GAS ONSHORE LP	Slot	SLOT#03 REIGLE 17-4 (2251'FNL & 2514'FWL)
Area	COLORADO	Well	REIGLE 17-4X
Field	WELD COUNTY (KERR MCGEE)	Wellbore	REGILE 17-4X PWB
Facility	SEC.04-T2N-R65W	Sidetrack from	REIGLE 17-4 AWB at 3843.00 MD

WELLPATH DATA (48 stations) † = interpolated/extrapolated station

MD [ft]	Inclination [°]	Azimuth [°]	TVD [ft]	Vert Sect [ft]	North [ft]	East [ft]	DLS [°/100ft]	Comments
3843.00	20.200	54.500	3645.19	1099.38	628.13	912.93	0.00	Tie On
3943.00†	20.171	48.702	3739.06	1133.79	649.54	939.94	2.00	
4043.00†	20.331	42.941	3832.89	1168.33	673.64	964.73	2.00	
4111.42†	20.547	39.071	3897.00	1192.02	691.66	980.40	2.00	PARKMAN
4143.00†	20.676	37.314	3926.56	1202.96	700.40	987.27	2.00	
4208.85	21.000	33.725	3988.10	1225.80	719.46	1000.87	2.00	3D Arc (S)
4243.00†	21.000	33.725	4019.99	1237.64	729.64	1007.66	0.00	
4343.00†	21.000	33.725	4113.35	1272.33	759.44	1027.56	0.00	
4443.00†	21.000	33.725	4206.70	1307.02	789.25	1047.46	0.00	
4487.23†	21.000	33.725	4248.00	1322.37	802.43	1056.26	0.00	SUSSEX
4543.00†	21.000	33.725	4300.06	1341.71	819.05	1067.35	0.00	
4643.00†	21.000	33.725	4393.42	1376.40	848.86	1087.25	0.00	
4743.00†	21.000	33.725	4486.78	1411.09	878.67	1107.15	0.00	
4843.00†	21.000	33.725	4580.14	1445.79	908.47	1127.04	0.00	
4943.00†	21.000	33.725	4673.49	1480.48	938.28	1146.94	0.00	
5043.00†	21.000	33.725	4766.85	1515.17	968.08	1166.84	0.00	
5118.08	21.000	33.725	4836.95	1541.21	990.46	1181.78	0.00	End of Tangent (S)
5143.00†	20.502	33.725	4860.25	1549.76	997.81	1186.68	2.00	
5243.00†	18.502	33.725	4954.51	1582.07	1025.57	1205.21	2.00	
5343.00†	16.502	33.725	5049.87	1611.18	1050.58	1221.91	2.00	
5443.00†	14.502	33.725	5146.23	1637.05	1072.81	1236.75	2.00	
5543.00†	12.502	33.725	5243.46	1659.65	1092.23	1249.71	2.00	
5643.00†	10.502	33.725	5341.45	1678.95	1108.81	1260.78	2.00	
5743.00†	8.502	33.725	5440.07	1694.93	1122.54	1269.94	2.00	
5843.00†	6.502	33.725	5539.21	1707.57	1133.40	1277.19	2.00	
5943.00†	4.502	33.725	5638.75	1716.85	1141.37	1282.51	2.00	
6043.00†	2.502	33.725	5738.55	1722.76	1146.45	1285.90	2.00	
6143.00†	0.502	33.725	5838.51	1725.29	1148.63	1287.36	2.00	
6168.08	0.000	33.725	5863.60 [†]	1725.40	1148.72	1287.42	2.00	Drop (S)
6243.00†	0.000	33.725	5938.51	1725.40	1148.72	1287.42	0.00	
6343.00†	0.000	33.725	6038.51	1725.40	1148.72	1287.42	0.00	
6443.00†	0.000	33.725	6138.51	1725.40	1148.72	1287.42	0.00	
6543.00†	0.000	33.725	6238.51	1725.40	1148.72	1287.42	0.00	
6643.00†	0.000	33.725	6338.51	1725.40	1148.72	1287.42	0.00	
6743.00†	0.000	33.725	6438.51	1725.40	1148.72	1287.42	0.00	
6843.00†	0.000	33.725	6538.51	1725.40	1148.72	1287.42	0.00	
6943.00†	0.000	33.725	6638.51	1725.40	1148.72	1287.42	0.00	
7043.00†	0.000	33.725	6738.51	1725.40	1148.72	1287.42	0.00	
7143.00†	0.000	33.725	6838.51	1725.40	1148.72	1287.42	0.00	
7243.00†	0.000	33.725	6938.51	1725.40	1148.72	1287.42	0.00	
7289.49†	0.000	33.725	6985.00	1725.40	1148.72	1287.42	0.00	NIOBRARA
7343.00†	0.000	33.725	7038.51	1725.40	1148.72	1287.42	0.00	
7443.00†	0.000	33.725	7138.51	1725.40	1148.72	1287.42	0.00	
7477.49†	0.000	33.725	7173.00	1725.40	1148.72	1287.42	0.00	FT HAYS
7499.49†	0.000	33.725	7195.00	1725.40	1148.72	1287.42	0.00	CODELL



Planned Wellpath Report

REGILE 17-4X (REV-B.0) PWP

Page 3 of 4



INTEQ

REFERENCE WELLPATH IDENTIFICATION

Operator	KERR MCGEE OIL & GAS ONSHORE LP	Slot	SLOT#03 REIGLE 17-4 (2251'FNL & 2514'FWL)
Area	COLORADO	Well	REIGLE 17-4X
Field	WELD COUNTY (KERR MCGEE)	Wellbore	REGILE 17-4X PWB
Facility	SEC.04-T2N-R65W	Sidetrack from	REIGLE 17-4 AWB at 3843.00 MD

WELLPATH DATA (48 stations) † = interpolated/extrapolated station

MD [ft]	Inclination [°]	Azimuth [°]	TVD [ft]	Vert Sect [ft]	North [ft]	East [ft]	DLS [°/100ft]	Comments
7543.00†	0.000	33.725	7238.51	1725.40	1148.72	1287.42	0.00	
7643.00†	0.000	33.725	7338.51	1725.40	1148.72	1287.42	0.00	
7659.49	0.000	33.725	7355.00	1725.40	1148.72	1287.42	0.00	End of Tangent

TARGETS

Name	MD [ft]	TVD [ft]	North [ft]	East [ft]	Grid East [srv ft]	Grid North [srv ft]	Latitude	Longitude	Shape
REIGLE 17-4 GEO TARGET 50' RADIUS (1290'FNL & 1380'FEL, REV-1)		6000.00	962.15	1404.30	3233582.33	1306282.90	40°10'16.032"N	104°39'50.850"W	circle
REIGLE 17-4 LEGAL BOX (436'N,364'S,342'W,458'E OF GEO TARGET)		6000.00	998.15	1346.30	3233524.00	1306318.35	40°10'16.388"N	104°39'51.597"W	square
1) REIGLE 17-4X GEO TARGET 50' RADIUS (1103'FNL & 1497'FEL, REV-2)		6000.00	1148.72	1287.42	3233463.72	1306468.36	40°10'17.876"N	104°39'52.356"W	circle
REIGLE 17-4X GEO TARGET 50' RADIUS (1035'FNL & 1520'FEL, REV-1)		6000.00	1146.84	1272.66	3233448.98	1306466.34	40°10'17.857"N	104°39'52.546"W	circle
REIGLE 17-4X LEGAL BOX (249'N,551'S,225'W,575'E OF GEO TARGET)		6000.00	997.00	1462.00	3233639.70	1306318.29	40°10'16.376"N	104°39'50.107"W	square

SURVEY PROGRAM Ref Wellbore: REGILE 17-4X PWB Ref Wellpath: REGILE 17-4X (REV-B.0) PWP

Start MD [ft]	End MD [ft]	Positional Uncertainty Model	Log Name/Comment	Wellbore
16.00	685.00	NaviTrak (Standard)		REIGLE 17-4 AWB
685.00	3843.00	NaviTrak (Standard)		REIGLE 17-4 AWB
3843.00	7659.52	NaviTrak (Standard)		REGILE 17-4X PWB



Planned Wellpath Report

REGILE 17-4X (REV-B.0) PWP

Page 4 of 4



REFERENCE WELLPATH IDENTIFICATION

Operator	KERR MCGEE OIL & GAS ONSHORE LP	Slot	SLOT#03 REIGLE 17-4 (2251'FNL & 2514'FWL)
Area	COLORADO	Well	REIGLE 17-4X
Field	WELD COUNTY (KERR MCGEE)	Wellbore	REGILE 17-4X PWB
Facility	SEC.04-T2N-R65W	Sidetrack from	REIGLE 17-4 AWB at 3843.00 MD

WELLPATH COMMENTS

MD [ft]	Inclination [°]	Azimuth [°]	TVD [ft]	Comment
4111.42	20.547	39.071	3897.00	PARKMAN
4487.23	21.000	33.725	4248.00	SUSSEX
7289.49	0.000	33.725	6985.00	NIOBRARA
7477.49	0.000	33.725	7173.00	FT HAYS
7499.49	0.000	33.725	7195.00	CODELL