

PROPOSED PAD LAYOUT TEBO 32-1M

SECTION 32, TOWNSHIP 4 SOUTH, RANGE 64 WEST OF THE 6TH PRINCIPAL MERIDIAN

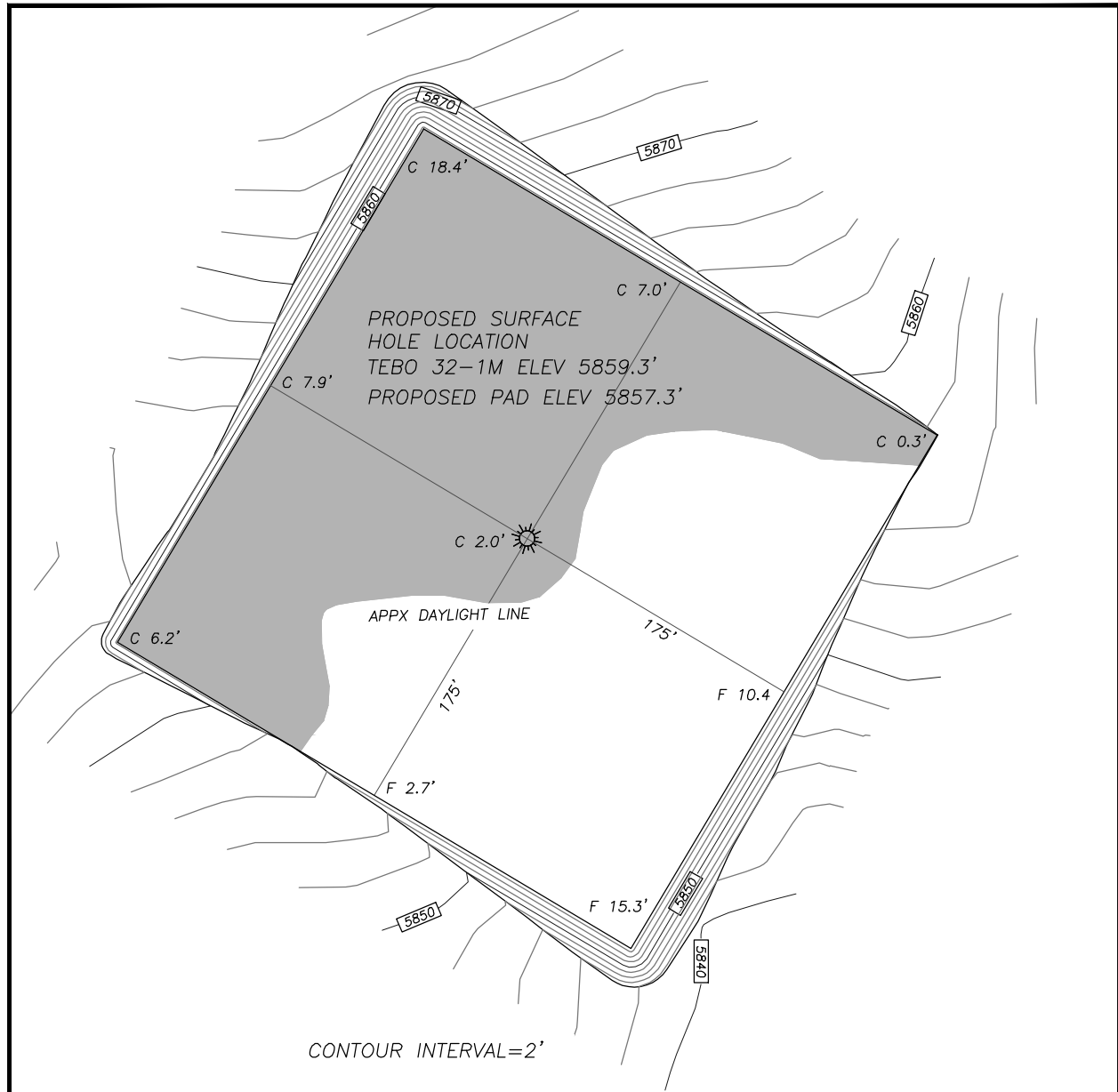

TEBO 32-1M PAD

Top of pad elevation: 5857.3'

Cut slope ratio: 1.50

Fill slope ratio: 1.50

Cut Swell Factor: 1.00

Fill Shrink Factor: 1.00

Pad Earthwork Volumes

Total cut: 14,583 C.Y.

Total fill: 13,083 C.Y.

Balance Export: 1,500 C.Y. (Topsoil)

Area: 3.2 Acres

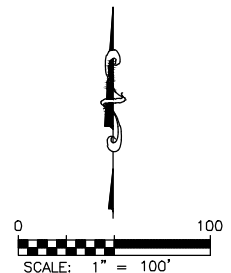

PROPOSED PAD CROSS SECTIONS TEBO 32-1M
SECTION 32, TOWNSHIP 4 SOUTH, RANGE 64 WEST OF THE 6TH PRINCIPAL MERIDIAN

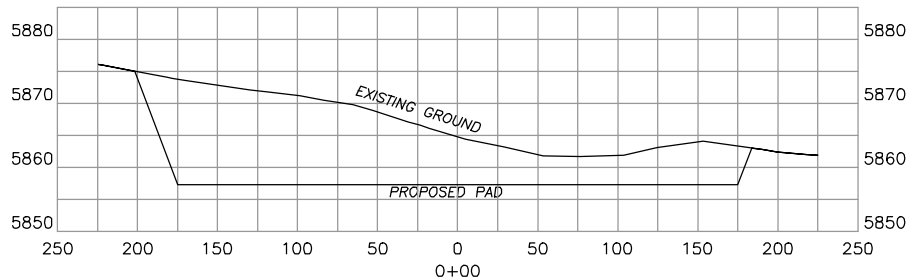
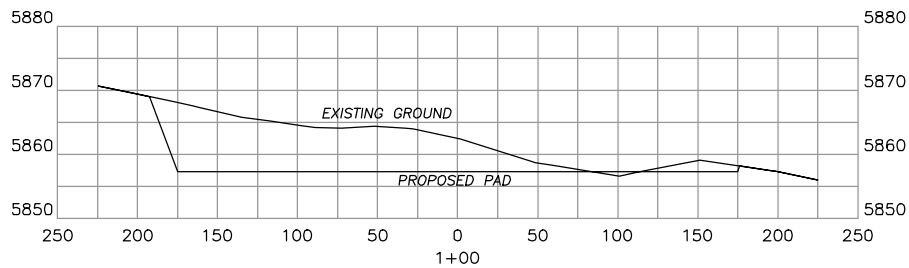
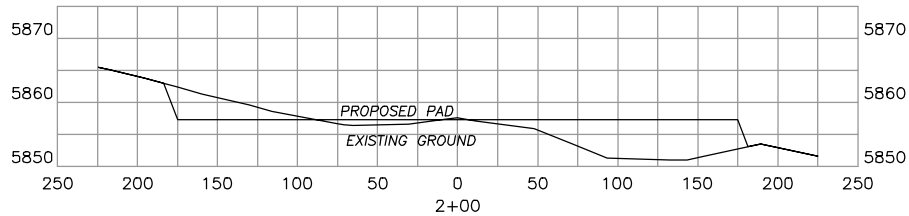
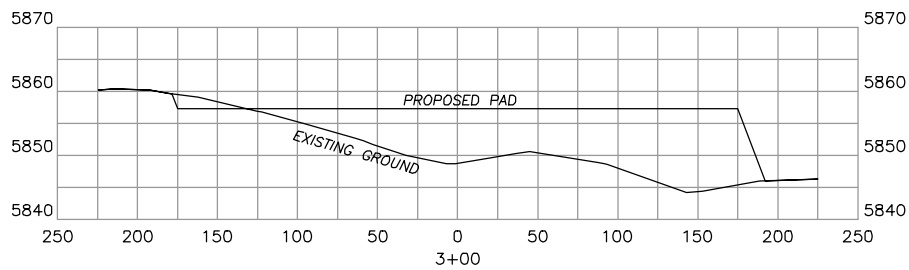
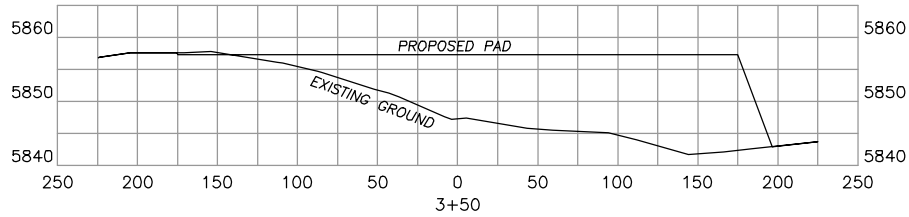

Horizontal Scale 20
Vertical Scale 5

DALEY LAND SURVEYING, INC.

PARKER, CO. 80134

303 953 9841

PROPOSED RIG LAYOUT TEBO 32-1M

SECTION 32, TOWNSHIP 4 SOUTH, RANGE 64 WEST OF THE 6TH PRINCIPAL MERIDIAN

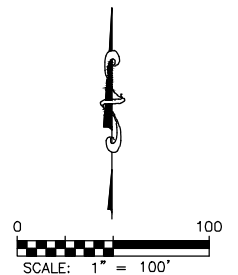
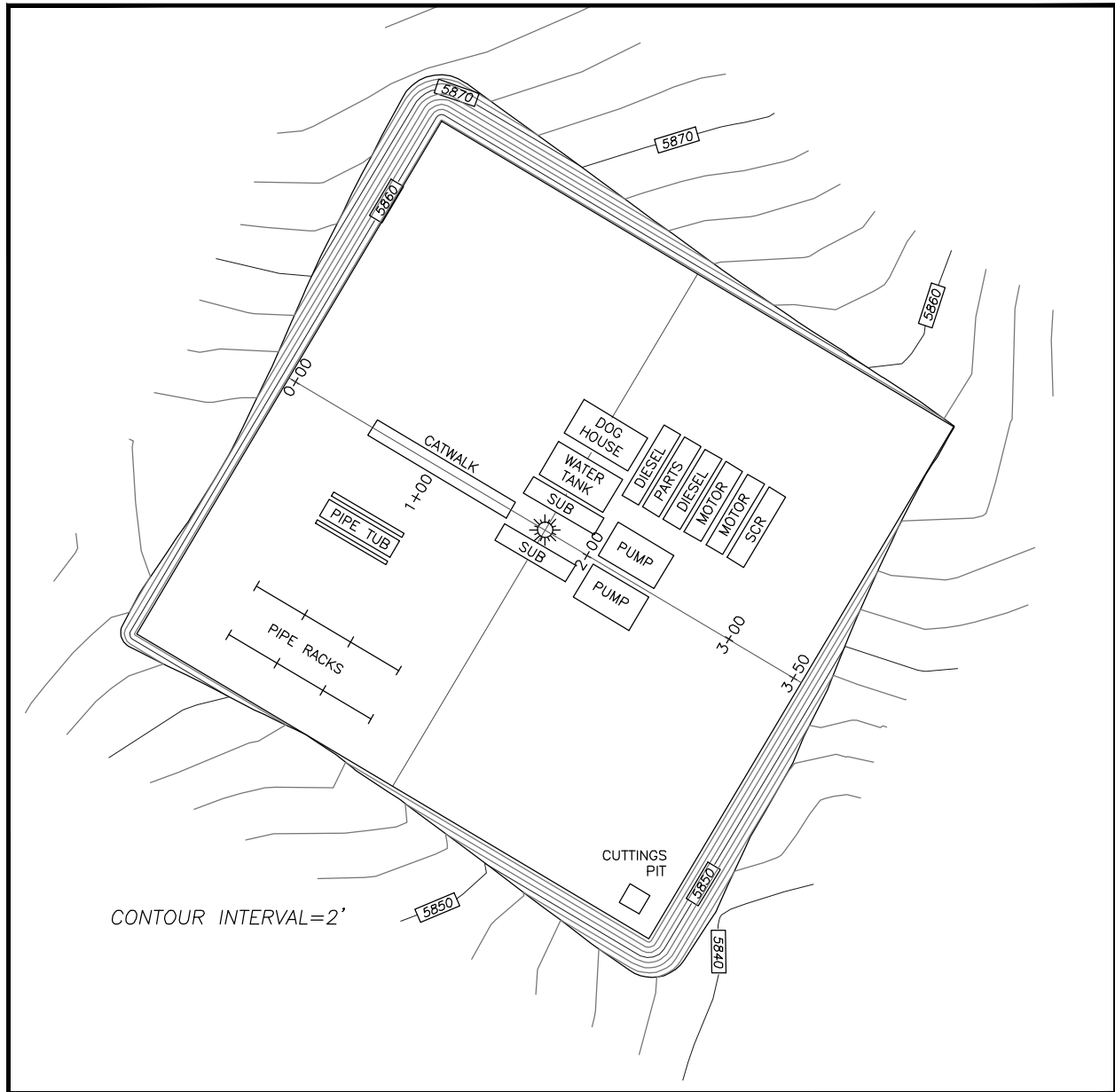

PROPOSED RECLAMATION DIAGRAM TEBO 32-1M

SECTION 32, TOWNSHIP 4 SOUTH, RANGE 64 WEST OF THE 6TH PRINCIPAL MERIDIAN

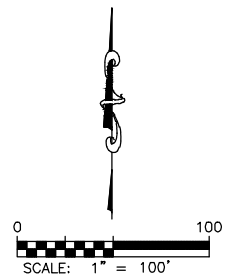
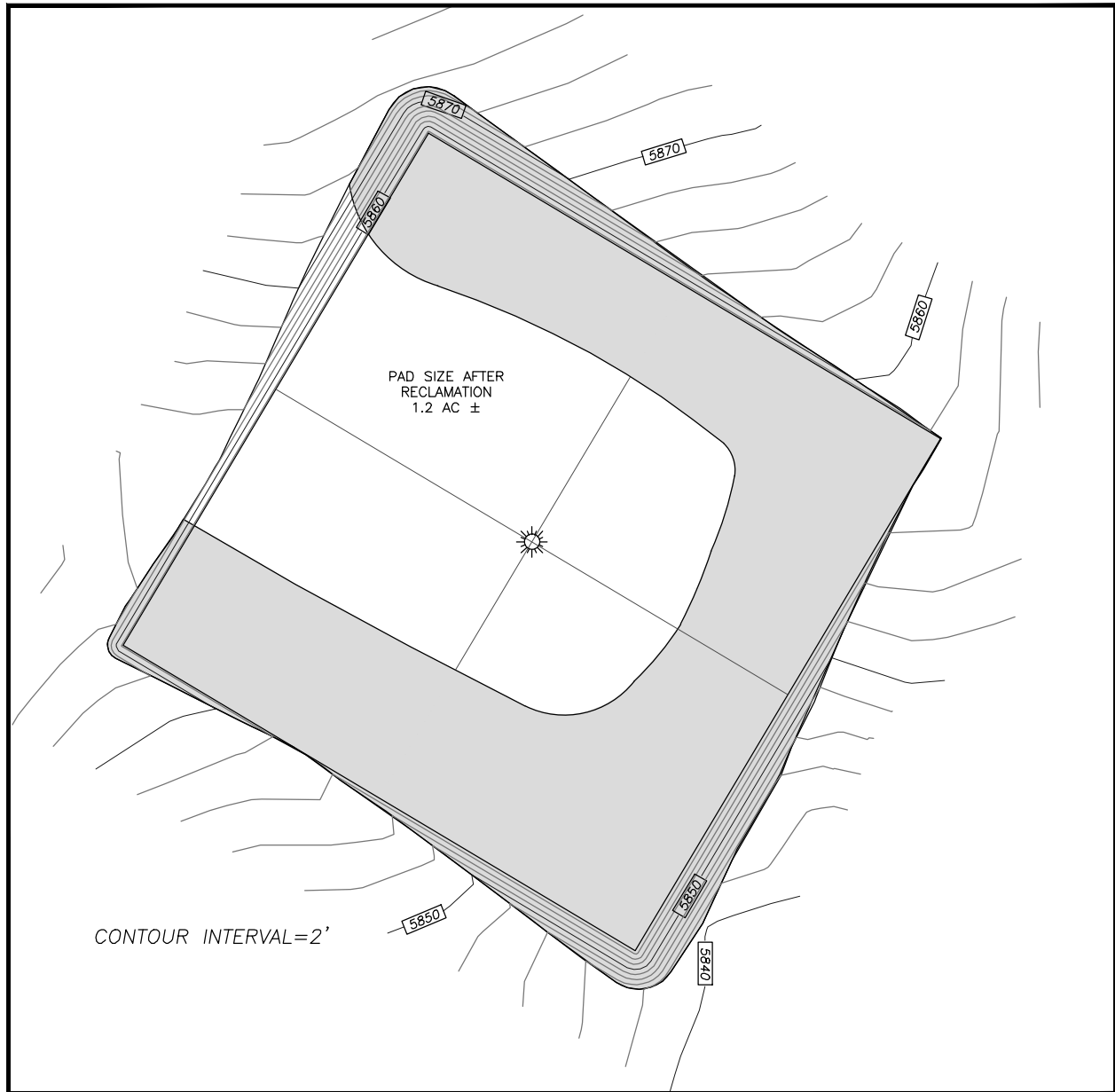

DALEY LAND SURVEYING, INC.

PARKER, CO. 80134

303 953 9841

LOCATION DRAWING TEBO 32-1M

SECTION 32, TOWNSHIP 4 SOUTH, RANGE 64 WEST OF THE 6TH PRINCIPAL MERIDIAN



IMPROVEMENTS

1. INTERMITTENT STREAM (DRY): 525'± S

DISTANCE TO NEAREST:

BUILDING:	4100'± E
PUBLIC ROAD:	3965'± E
ABOVE GRND UTILITY:	3990'± E
RAILROAD:	5280'+
PROP. LINE:	1300'± E