



March 11, 2011

Colorado Oil & Gas Conservation Commission  
The Chancery Building  
1120 Lincoln Street, Suite 801  
Denver, CO 80203

Attn: Mr. David Neslin, Director

RE: McConahay 1A-34H  
Niobrara New Drill  
Township 2 North, Range 66 West, 6<sup>th</sup> P.M.  
Section 34: 766' FNL, 274' FEL (Surface Location)  
Section 34: 837' FNL, 486' FEL (Beginning of Lateral)  
Section 34: 2190' FNL, 690' FWL (End of Lateral)  
Weld County, Colorado

Mr. Neslin,

Encana Oil & Gas (USA) Inc. ("Encana") is planning to drill the captioned boundary well in accordance with the provisions of COGCC Rule 318A.e.

Encana's proposed wellbore spacing unit consists of the N/2 of Section 34, T2N, R66W, creating a 320-acre wellbore spacing unit for the Niobrara formation. Encana is the only working interest owner within the proposed spacing unit, therefore Encana hereby attests that no notice letters are required under COGCC Rule 318A.e.(6).

Enclosed is a copy of the map illustrating the proposed wellbore spacing unit to assist you in your review and approval of Encana's proposed APD for the captioned well.

Thank you for your time and attention to this matter. Encana respectfully requests that the COGCC review the enclosed information and approve the Application for Permit to Drill the captioned well.

Sincerely,

A handwritten signature in blue ink, appearing to read "Jennifer Lind".

Jennifer Lind  
Regulatory Analyst

**Encana Oil & Gas (USA) Inc.**

Republic Plaza  
370 – 17 Street, Suite 1700  
Denver, Colorado  
United States 80202

t 303.623.2300

f 303.623.2400

[www.encana.com](http://www.encana.com)

McConahay 1A-34H  
NENE SEC 34 T2N-R66W

Purple outline = Proposed 320 acre spacing unit in the N/2 of Sec. 34  
Green dashed outline = N/2 (location of surface/bottom hole)

Bottom hole located at the Southwest Corner of NW/4 Section 34 T2N-R6W

These quarter-sections have less than 8 bottom hole wells producing from the Niobrara formation in each quarter section.

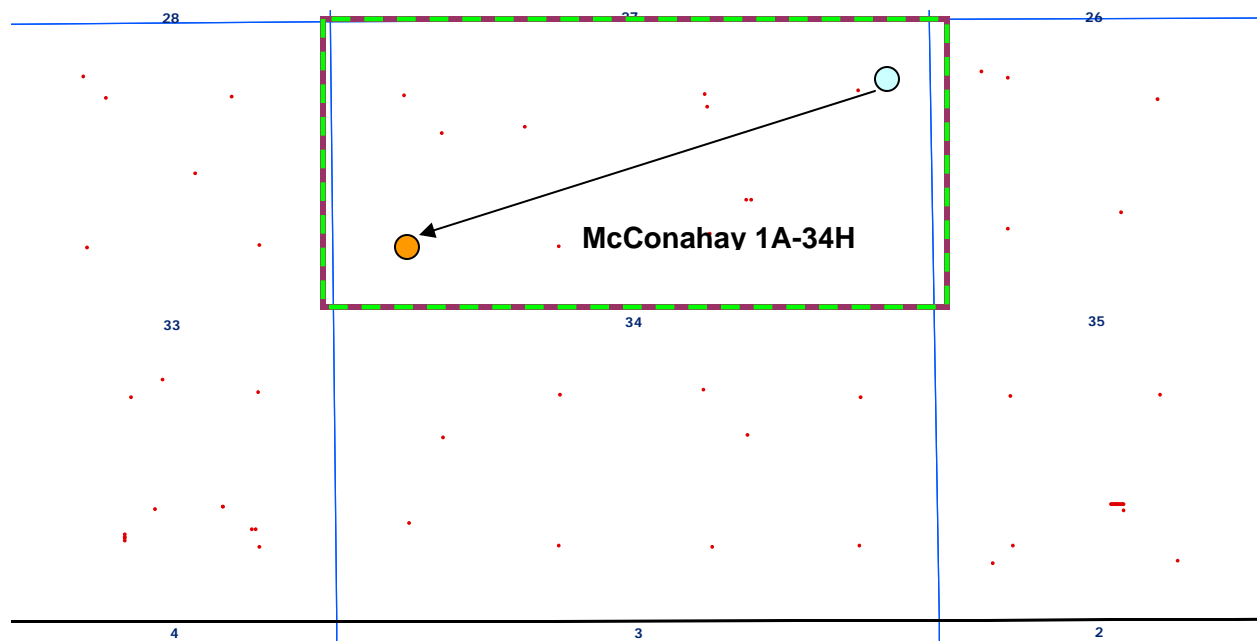

○ = Surface location

● = Bottom hole location